

# Assembly & Installation Instructions

## CAUTION:

Read instructions carefully and ensure a dry and lighted assembly area.

## WARNING

Wires and cables are all attached "further wiring is not needed from consumer". When unpacking product, be careful to not pull wires as it may result as a bad connection. Do not plug into electrical outlet until lamp is fully assembled.

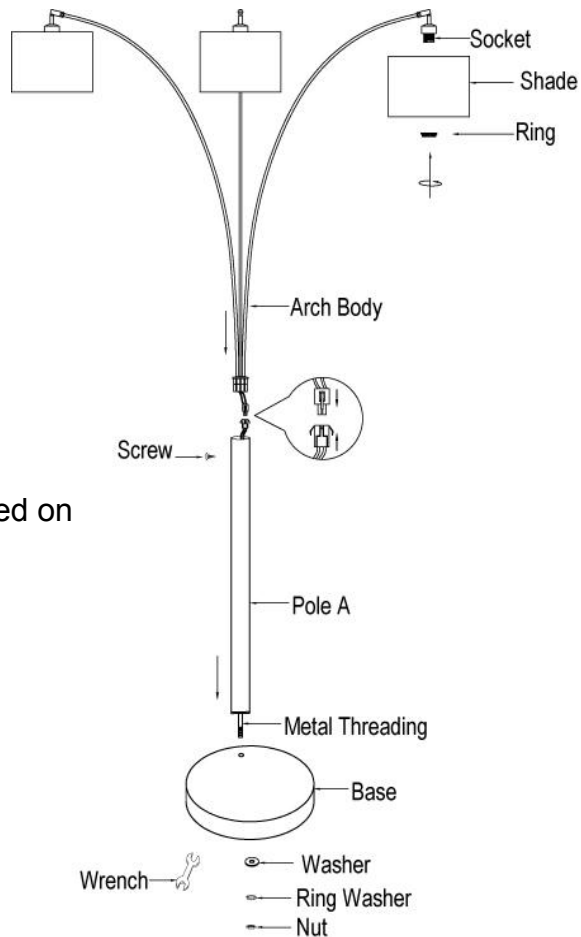

### Enclosed:

- 3 Ring
- 1 Flat Washer
- 1 Nut
- 1 Screw
- 1 Wrench
- 3 Lamp Shade
- 1 Small Screw (attached on "Arch Body")

## Assembly Instructions:

\*Unpack and place all parts on surface or floor

1. Insert the threaded side of "Pole A" into the "Base".  
**\*NOTE:** The threaded bottom portion of "Pole A" can be extended by unscrewing. Adjust accordingly to ensure that "Pole A" and the "Base" are securely fastened.
2. Tighten the pole from the bottom of the "Base" with the nut and washer.
3. Use screwdriver to unscrew the "Screw" located on "Arch Body".
4. Connect the wires in "Pole A" with the wires in the "Arch Body".
5. Attach the "Arch Body" to "Pole A" then use the screwdriver to fasten the screw back onto the "Arch body".
6. Place the "Lamp Shade" onto the "Socket" then tighten it up with the plastic "Ring".

**LAMP MODEL 6939ES IS TO BE USED IN A CORNER WALL SURFACE ONLY**

## Additional Note:

Turn the power off (unplug from the wall outlet) before replacing the bulb. Make sure the bulb has sufficient time to cool down.

## Cleaning:

Use only soft cloth to dust and clean fixture. Never use chemicals or abrasive cleaners as it may damage finish.

## ASSEMBLY INSTRUCTION FOR K/D SHADE

PLEASE READ AND SAVE THESE INSTRUCTIONS

**Parts:** Remove every parts from box and place on to a clean surface before assembly.



(A)  
Open-end Shade



(B)  
LIGHT FILTER

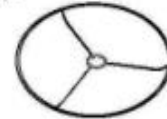

(C)  
Spider Fitter Ring

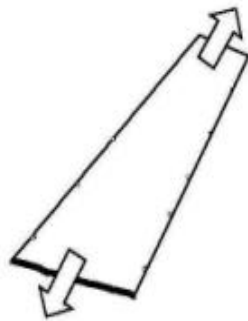

### Step 1:

Take the shade (A) out from the box and expand it open, put on a clean surface before assembly. The side of shade with clips should face up.

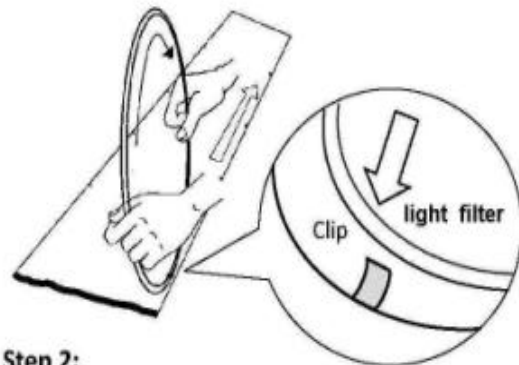

### Step 2:

Start by fixing the light filter (B) into the first shade clip (A). Roll the ring to each clip and fix each clip to the ring.

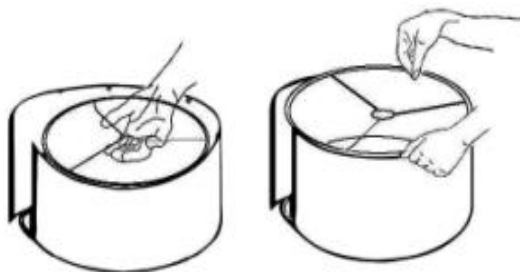

### Step 3:

Insert the Spider Fitter Ring (C) into the shade (A). Pull the Spider Fitter Ring (C) up, and clip into the position.

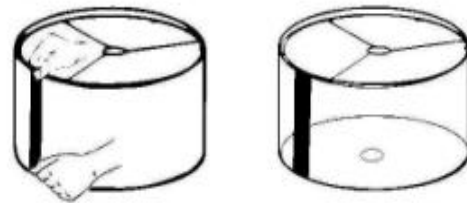

### Step 4:

Make sure both ends of the shades align straight. Then secure it by sticking both ends of the Velcro together.

**Patent Pending Product**