

IMPORTANT SAFETY INSTRUCTIONS

- To avoid injury or damage, mount only on a surface that is sturdy.
- To avoid electric shock, make sure the electricity is turned off at the main circuit breaker panel. If you are replacing an existing fixture, turn off the following in order: fixture, wall switch, and main fuse or breaker box.
Note: Some types of fuses must be unscrewed to shut the power off.
- If you are unclear as to how to proceed, please consult a licensed electrician.

UNPACK THE LAMP: Check the contents of the box. Box should contain all items on the parts diagram.



For any replacement parts or installation issues, please Contact Us!

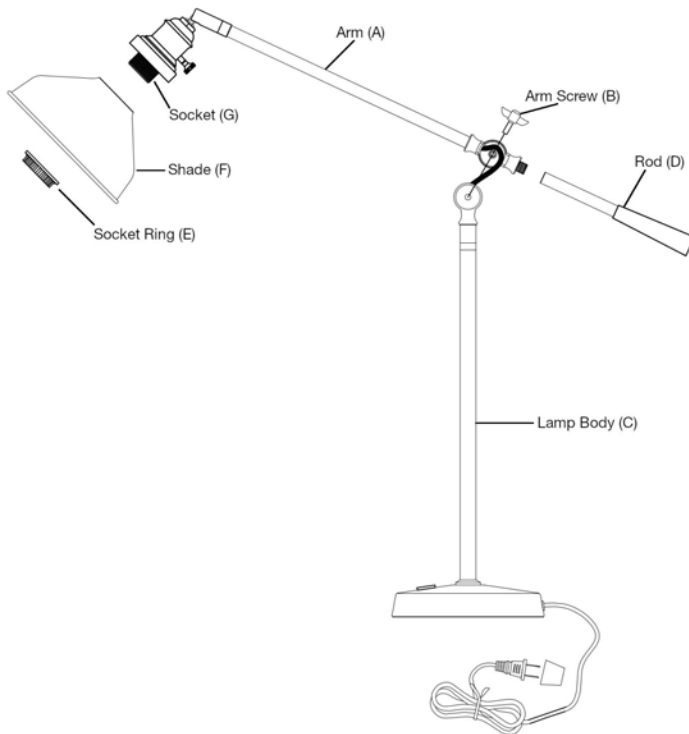

ASSEMBLY INSTRUCTIONS

1. Secure Arm (A) to Lamp Body (C) with Arm Screw (B).
2. Secure Rod (D) to the back of Arm (A) by turning clockwise.
3. Remove Socket Ring (E) from Socket (G) by turning counter-clockwise.
4. Secure Shade (F) onto Socket (G) with Socket Ring (E) by turning clockwise.
5. Install light bulb (included).

Enjoy your new lamp!