

Thank you for choosing Wovier products. In order to install and use Wovier products easily, please read this instruction carefully.

All Wovier products meet the GB18145-2018 standard and GB/T23447-2018 standard, use high quality, advanced surface treatment technology with sophisticated ceramic valve core installed inside. Wovier faucets have been tested for up to 500,000 life cycles. If product has water leak problem, we could offer free provide the necessary replacement parts.

CARE AND MAINTENANCE

- Use the handle gently.
 - Wash faucet with clean water, and wipe with soft cotton cloth. Avoid using cleaning powder, harsh cleaning chemical brushes, and cloth with coarse surface to prevent scratching and corrosion.
 - In daily use, if the flow is less or no water come out, check the cold/hot water pressure first. If it is ok , then close the main body switch, remove the aerator wrench, check whether it is blocked with impurities or not. If this does not work, close the hot and cold supply source, unscrew the fitting of inlet flexible hose, then check whether there is some impurities in pipe or not.If have, clean the pipe by water . If all these methods are not usable, you need to ask help from a professional maintenance worker.
 - All materials included in this instruction should be subject to the newest products printed. Wovier reserves the right of final explanation of product feature, packing and supply position, which shall be subject to any changes without additional notices.
- Note:** This warranty is not responsible for damage from failure to follow instructions. In this case , we will take charge for the repairing.

Wovier

CE ISO 9001

Global Leading Sanitary Ware Brand
Enjoy Life From Choosing Us!



Wovier Sanitary Ware Co., Ltd.

Web: www.wovier.com



Facebook Search: Wovier

Facebook Link: <https://www.facebook.com/Wovier/>

To obtain service or information
Please email to:
service@wovier.com

FAUCET INSTALLATION AND OPERATION INSTRUCTIONS

BEFORE INSTALLATION

Note: When you open package, check all parts available .If not, contact with the Dealer when the accessories are missing or broken. This Instruction is only for installation , all products as per the material subjects.

- Pre-drilled hole size requirement: 32mm(min)-40mm(max)
Max countertop thickness without deck plate: 38mm
Max countertop thickness with deck plate:25.4mm

■ Ensure that pipe is cleaned by water beofre installing the angle valve. Also enure that no impurtites in pipe, or it will be leak or blocked.

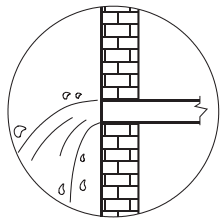

Clean the pipe

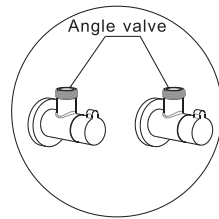

Install the angle valve

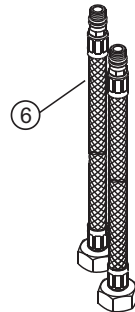
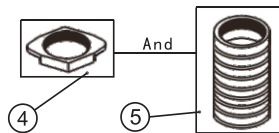
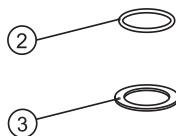
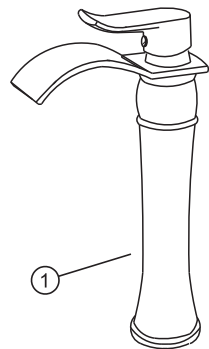

① Faucet body

② Rubber gasket at bottom of faucet

③ Rubber washer

④ Nut

⑤ Fixing screw

⑥ Two hoses

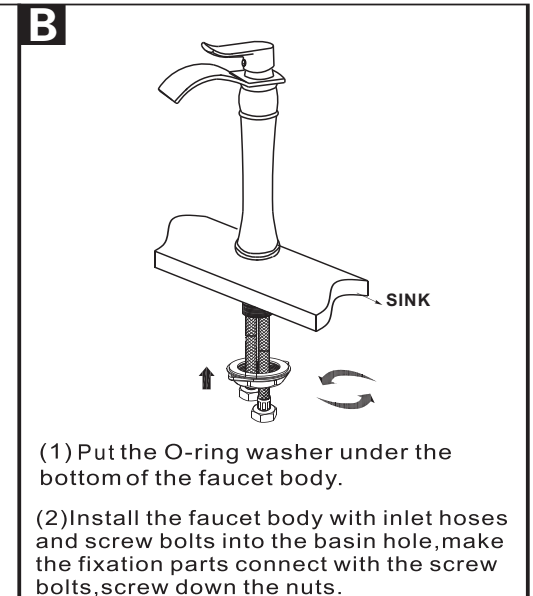
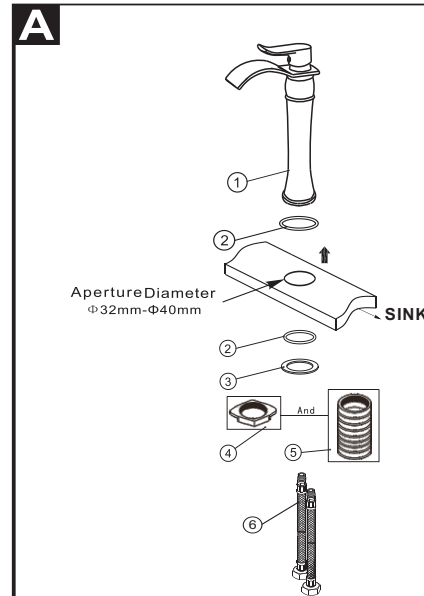

(1) Put the O-ring washer under the bottom of the faucet body.

(2) Install the faucet body with inlet hoses and screw bolts into the basin hole, make the fixation parts connect with the screw bolts, screw down the nuts.



1. Make sure that the sealing pad is in the inlet hose before connecting, then connect the flexible hoses according to the cold/hot water signs with angle valve.
2. Open angle valve switch, turn on the faucet and adjust the water temperature, then check the water temperature adjustment direction is consistent with the leading indicator of faucet. If not, change the 2 pieces hoses with angle valve, then installation is completed.



Note: This installation step is carried out at the bottom of the table. Do not twist the flexible in case of shorting hose life and causing leaking problems.

Note: If leaking, Cause: 1. Cartridge or parts has come to loose 2. O-ring is dirty or damaged. Action: 1. Re-install the cartridge or tighten the retainer nut. 2. Clear or replace o-ring.

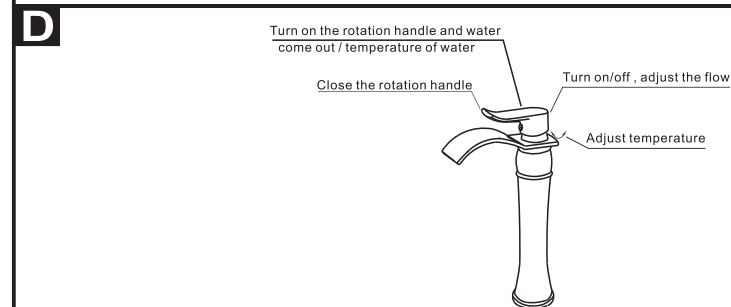

Note: Do not disassemble faucet by yourself. Check every joints are connected closely. (Too loose or too tight is not proper. Too tight will cause connections damaged)