

WARNING

(To reduce the risk of fire, electric shock, or injury to persons):

1. We suggest installation by a licensed electrician.
2. Please read the instruction carefully and save it as you may need it at later time.
3. Before you start, NEVER attempt any work without shutting off the electricity until the work is done. A). Go to the main fuse, or circuit breaker, box in your home. Place the main power switch in the "OFF" position. B). Place the wall switch in the "OFF" position.
4. Mounting surface should be clean, dry, flat, strong enough and 1/4" larger than the canopy on all side. Any gaps between the mounting surface and canopy exceeding 3/16" should be corrected as required.
5. Make sure that the ceiling or wall can bear the weight of the lamp before fixture.
6. Make sure the voltage you are using is 120V. The maximum wattage is 60W per bulb.
7. Keep the lamp away from acidic objects in case of damaging the surface of the lamp.
8. When replacing bulb, you should turn off or unplug the lamp and you must wait until it is cool as bulbs get hot quickly.
9. The safety instructions appearing in this manual are not meant to cover all possible conditions that may occur. It must be understood that common sense, caution and care must be used with any electrical products.
10. Do not touch the bulb or lamp shade during the lighting fixture working.

Image for finished product:

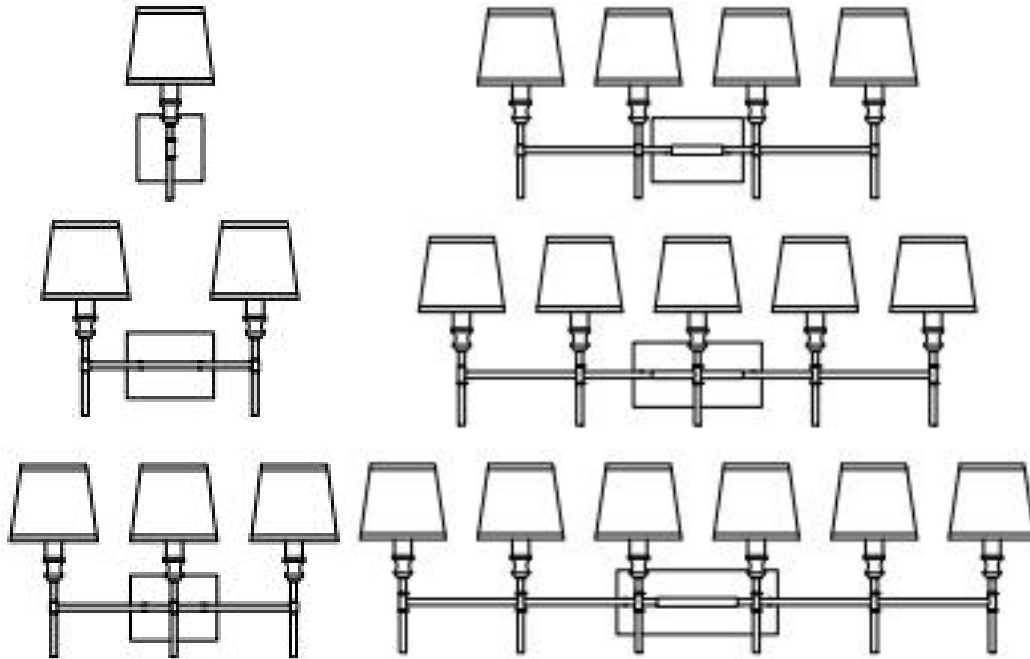

Accessories Display

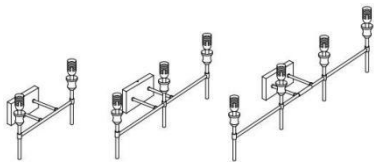

lamp body



mounting plate



socket ring



lampshade



metal tube

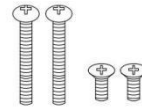

screws



wire nut

AFTER - SALES SERVICE

Our team is always there to support our products. Our constant goal is to ensure that our customers are satisfied. In the event that the light fixture you receive is broken. (for example, a broken socket base or lampshade), scratched, or not working; missing accessories; difficulty installing; damage from workmanship and quality issues; or just plain dissatisfaction, please send us a picture and get in touch with us through messages (go to "Your Orders," locate our product's order, and click "Contact Seller.>"). We'll exert every effort to make sure you're satisfied.

Installation Procedures:

First:

- A) Open the package and take out all the parts or accessories, then place them on a clean flat place.
- B) Please turn off the power.

Connect Black or Red Supply Wire to:	Connect White Supply Wire to:
Black	White
*Parallel cord (round & smooth)	*Parallel cord (square & ridged)
Clear, Brown, Gold or Black without tracer	Clear, Brown, Gold or Black with tracer
Insulated wire (other than green) with copper conductor	Insulated wire (other than green) with silver conductor

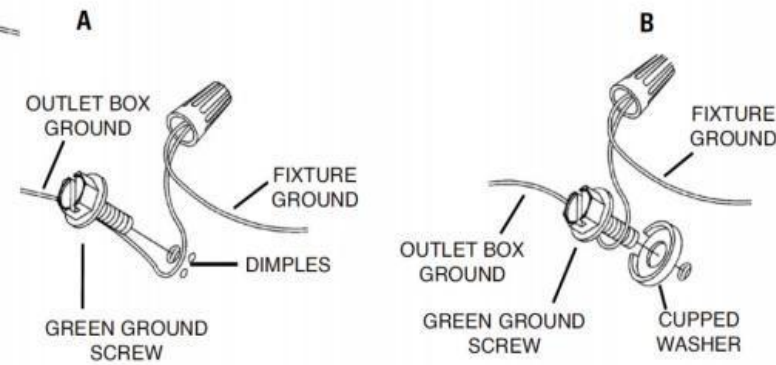

*Note: When parallel wires (SPT I & SPT II) are used. The neutral wire is square shaped or ridged and the other wire will be round in shape or smooth (see illus.)

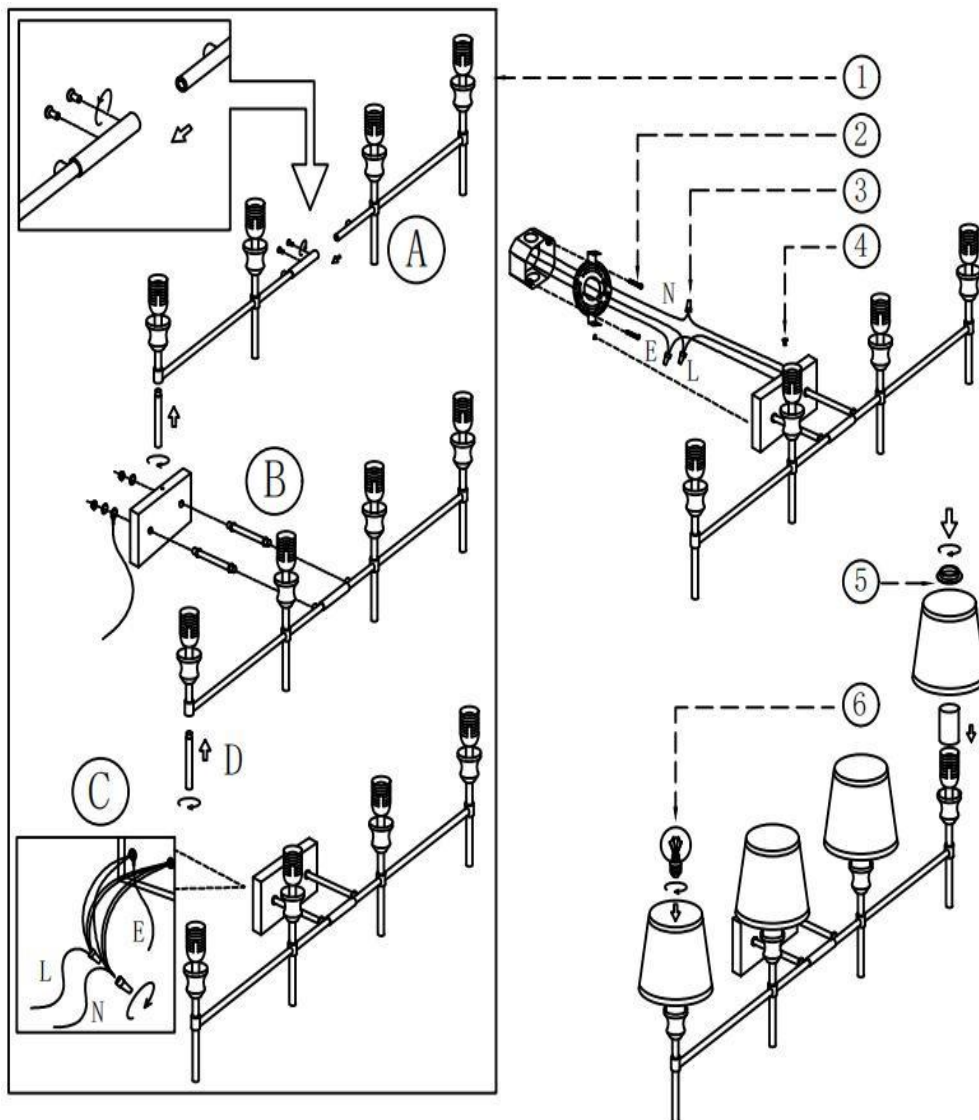
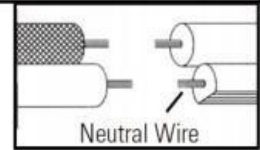

1. Assembly of lamp body:

Step A: Connect the two lamp bodies and tighten them with screws. (Skip step A for products with 1-Light, 2-light and 3-light.)

Step B: Thread the wires of the lamp body through the metal tube, use hexnut and gasket to lock the metal tube and ground wire tightly on the base plate, and lock the decorative metal tube (D) onto the lamp body.

Step C: Connect the main power wire (Black/White) to the lamp head wire.

2. Turn off the power and install the mounting plate on the junction box with screws.
3. Connect the Live Wire (L) , Naught Wire (N) and Earth Wire (E) to the junction box.
4. Install the lamp body onto the mounting plate and secure it with screws.
5. Insert a metal tube into the lamp head, then insert the lampshade and lock it with the socket ring.
6. Install the E12 bulb (Bulbs are not included).