

Assembly Instructions for
PUB TABLE TOP
PUB TABLE BASE

Caution: Please read instructions thoroughly before unpacking assembly parts. Sharp, exposed staple tips can cause injury, therefore, for your protection, please remove any exposed staples used in packing.

1. We recommend that you should assemble this product with the assistance of another person; this will make assembly easier, and will help to eliminate damage to the product or injury to persons during assembly.
2. Be sure to check all packing materials carefully for small parts that may have come loose inside the carton during shipment.
3. Please do not over tighten screws or bolts.
4. Please put all parts on a non-abrasive floor before assembly, and follow the assembly steps to assemble your newly purchased product correctly and efficiently.

PART LIST		
No.	PART DESC.	Q'TY
A	Pub Dining Table Top	1
B	Pub Dining Table Legs	4
C	Pub Dining Table Base Bottom	1
D	Pub Dining Table Base Shelf	1
E	Pub Dining Table Base Side Panel	3
F	Pub Dining Table Base Door	1
G	Pub Dining Table Base Stretcher	1

HARDWARE LIST			
No.		HARDWARE DESC	Q'TY
1		Short bolt (1/4" x 40mm)	14
2		Hex nut (5/16")	4
3		Spring washer (5/16")	4
4		Flat Washer (5/16" x19mm)	4
5		Spring washer (1/4")	14
6		Flat Washer (1/4" x19mm)	14
7		Wrench	1
8		Allen key M4	1
9		Hinge	2
10		Screw (#3 x 12mm)	12
11		Small Bolt (5/32"x15mm)	1
12		Knob	1

STEP:1

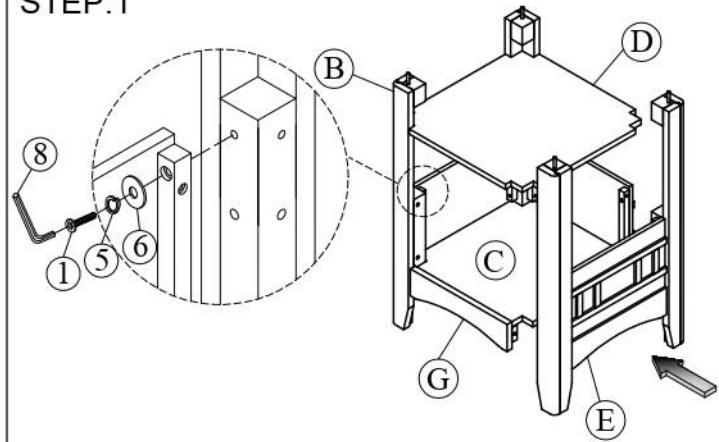

STEP:2

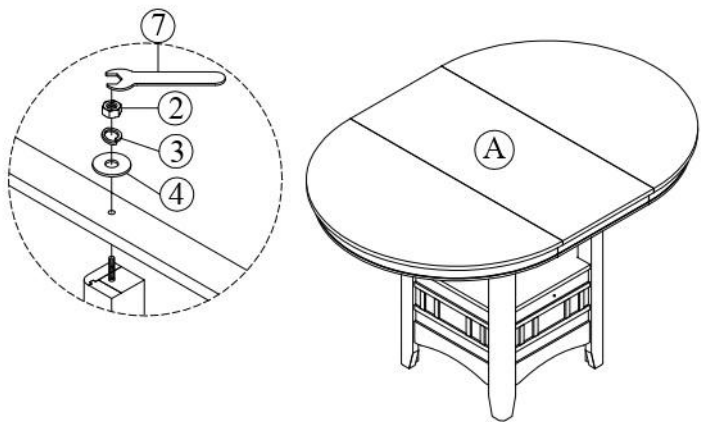

STEP:3

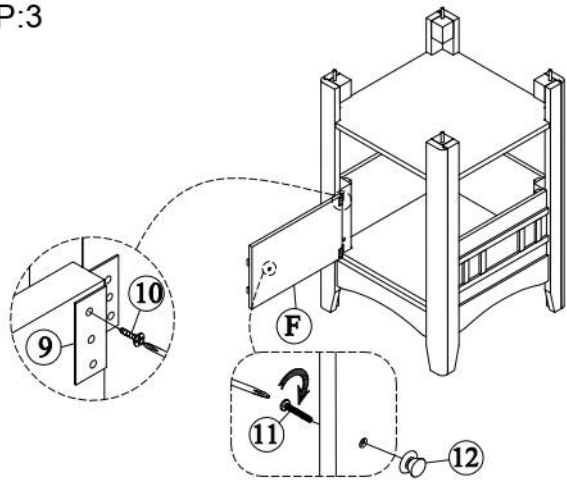

COMPLETED

