

Aquariums

Congratulations on Your New Aquarium

Included in your kit is the following.

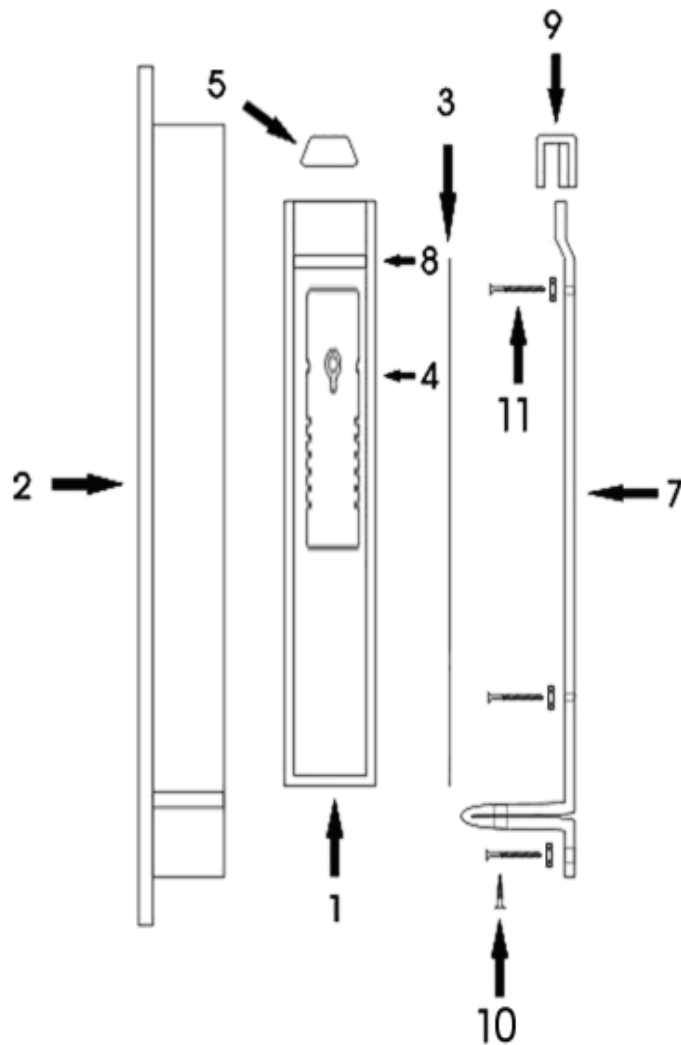

1. Glass Aquarium
2. Aquarium Frame (pre-attached to Aquarium)
3. Backdrop paper (up to 3 different options – may come pre-attached)
4. Multi-function submersible water filter x 1 or 2 (depending on tank size)
5. Light (Not submersible) x 1 or 2 (depending on tank size)
6. Light power cord (not pictured)
7. Wall Brackets x 2 (for most models) or x 3 (for mega and panoramic)
8. Pre-cut Lid x 1
9. Wall Toggle Clips x 2 (for most models) or x 3 (for mega and panoramic). Remove these and #10 screws to free brackets for mounting then replace when aquarium is set in place.
10. Short Screws x 2 or 3 depending on model. Remove these to free brackets for mounting then replace when aquarium is set in place.
11. Long screws (with washers) x 6 (for most models) or x 9 (for mega and panoramic).
12. Fish net
13. Siphon cleaner (not included with all models)
14. Grabber Tongs (not included with all models)
15. Adhesive tape for backdrop (not included with all models)

Tools And Materials Required:

1. Phillips Screwdriver. (depending what type wall you are mounting your aquarium on you may need new hardware)
2. Pencil
3. Level
4. Stud Finder (recommended)
5. Hand Drill With Phillips screwdriver head

NOTE: It is highly recommended that 2 people install any aquarium larger than 2 gallons.

SAFETY INSTRUCTIONS:

To guard against injury, basic safety precautions must be observed, including but not limited to the following:

1. If the light or any other electrical component (excluding submersible pump filtration part) falls into the water, DO NOT reach for it! First, carefully unplug it and then remove. Make sure components have not been damaged before attempting to reuse. If a non submersible component gets wet, carefully unplug from the wall and proceed to remove the moisture. The filter is submersible however the plug portion is not so it must not get wet!
2. The light should not be plugged in if there is any water on its parts not intended to be wet.
3. Always inspect the cord and plug for tears, abrasions, or abnormal wear.
4. DO NOT USE plug or cord if they seem to malfunction in any way.
5. Before removing your light or filter, unplug from the wall. Use appliances only for intended use. Using attachments not recommended for use in this type of aquarium may cause unsafe conditions for you and your pets.
6. Read and observe all notices and instructions on your filter and light that are included in your aquarium.
7. If it is necessary to use an extension cord, always use the same gauge cord and plug. A cord that is rated for less amperes or watts than the component you are using may overheat.
8. Never attempt to lift the aquarium off of wall when full of water.
9. Never lift your aquarium with wet hands.
10. Never lift your aquarium from the top only, always support the bottom.
11. CLOSE SUPERVISION IS VITAL WHEN ANY APPLIANCE IS USED NEAR OR BY CHILDREN.
12. It is highly recommended that any outlets that you plug your aquarium into as well as any outlets below your aquarium be GFI outlets. These outlets protect you in case of accidental spillage or breakage which would expose water to the outlet.

INSTALLATION

Read All Directions Before Installing

Now that you understand the safety instructions and have examined the box for contents, you are ready to mount your new wall aquarium. Your aquarium has been designed to fit into virtually any room of your home or office.

1. Before hanging your aquarium, consider the following.
 - a. Check for drafty areas where heat or air-conditioning might affect the temperature of your water. Fluctuations in water temperature can cause considerable stress to your pets and in some cases, even death. Consult an aquarium expert to determine if you should add a heater for your fish.
 - b. Keep out of the direct sunlight, as this will cause water temperature to change and cause unsightly algae growth. Too much natural or artificial light can cause overheating of the water and create algae growth which requires more maintenance.
 - c. You will need a flat wall to mount the aquarium with an electrical outlet nearby. We recommend you have a certified electrician install a clock outlet (recessed outlet) which enables you to hide all your cords. This type of outlet is the same that is used for flat screen televisions.
 - d. As with any cord, you need to use extreme caution as to where you place the cord. Cords can cause serious injury and even death to small children. Be aware of this hazard and install accordingly.

2. Mounting your wall brackets.

- a. Let us first explain that every home, office or other building is going to have different construction types. Some buildings have a wood foundation with wood studs every 16" while office buildings often times are constructed of steel and have steel studs every 16 or 24". Others are made of concrete or brick and have all sorts of different foundations and stud types. We've included in this aquarium one particular type of hardware. More than likely you will need to purchase additional screws, washers, etc. to accommodate the type building you are mounting you aquarium in. We always recommend you have your aquarium professionally installed.

- b. Decide the exact location and height for your wall aquarium. Making sure there is power nearby but not necessarily directly below your tank. If you are raising an outlet we recommend the lower outlet be converted to a GFI outlet to prevent fires and other unsafe conditions. We recommend you have a certified electrician install a clock outlet (recessed outlet) which enables you to hide all your cords similar to the outlet installed for most flat screen televisions. Alternatively, you can also use a cord cover or plant to hide the cords and run the cords down your wall to a regular outlet which has been converted to a GFI outlet. See images for recommended location and positioning of the recessed outlet. It is recommended that you wait until after you have mounted your brackets to install a GFI recessed outlet since the height and positioning is critical.

- c. Locate the studs in the wall by using a stud finder (which can be purchased at your local hardware store) (Note: Normally studs are every 16" in residential and up to 24" in commercial buildings). We recommend that every bracket be secured to studs. On smaller models such as the porthole, verticali and mini view, there is only 10-16" between the two brackets making it impossible to secure all brackets to studs. In those situations we highly recommend at least one bracket is secured to a stud and the other is secured using either

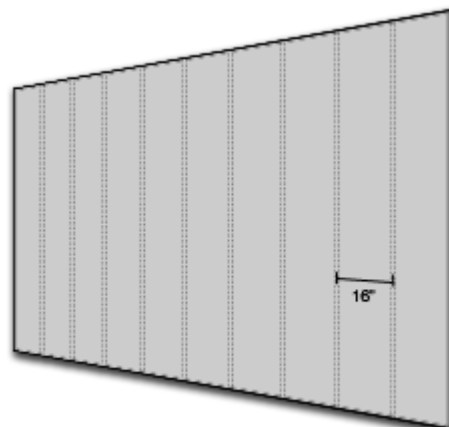

drywall toggle bolts or drywall anchors with screws. Make sure your drywall bolts/anchors are rated up to at least 50 lbs. for security. Mark the locations of a few studs to predetermine how you will center your aquarium.

d. Choose the exact location on your wall that you want to center your aquarium. You will begin mounting by first securing the brackets to your studs. Identify a few studs in your wall and use these as your guide to determine how you can center your aquarium safely on 2 or 3 studs.

e. Using a level, draw a straight line from one stud X to the other stud X. It is extremely important to keep the wall support bracket level on the wall. If your brackets are not level the water line will show on an angle.

f. Remove the brackets from your aquarium. There are plastic toggle clips on top and small screws locking them in place on the aquarium. Note that you do not need to have the brackets returned to the same location on the back of the aquarium. The aquarium can be centered or slightly offset depending on how you need it positioned on your wall.

g. It is highly recommended that you only drill into studs and not use drywall anchors for your brackets unless you have a smaller aquarium sized mentioned in 1c. For these aquariums in 1c, we highly recommend at least one bracket be secured to a stud and the other bracket be mounted using heavy duty drywall anchors or toggle bolts. The weight of the models cannot be supported by drywall anchors.

h. Using a hand drill, screw in a long screw in the top of the first bracket. If washers are provided it is recommended you use them. Do not over tighten the top screw as over-tightening will make it difficult to replace the toggle clip. Repeat with other bracket(s).

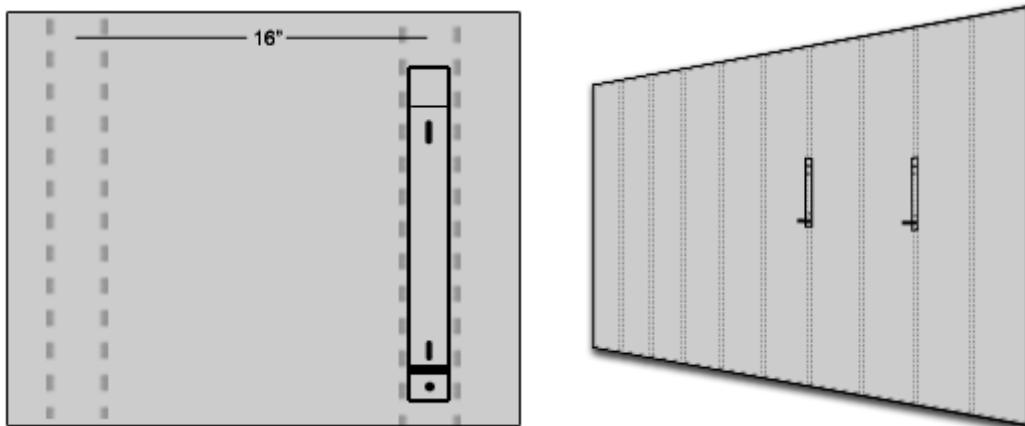

i. Fasten remaining screws to the bottom portion of the brackets using a level to make sure your brackets are both horizontally and vertically level. Use of washers on bottommost hole on brackets is highly recommended.

j. (Optional) Once the brackets are up you should now install your recessed outlet or standard outlet if you want to hide your power cords. The outlet should be installed horizontally and will line up with the bottom of your aquarium. The aquarium rests on top of the bracket shelf and there is a space below the aquarium that the aluminum frame will mostly hide. The side aluminum panels also extend about $\frac{1}{4}$ " beyond the glass aquarium creating a space to feed the light and filter cords from the top of the aquarium down to the bottom while being hidden by the glass aquarium. Since the power cords can be fed to the

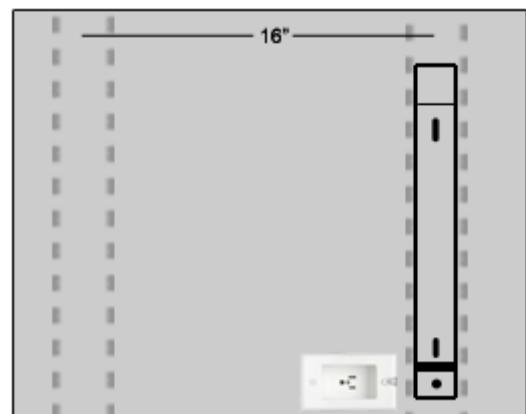

bottom of the aquarium you'll want to line up the outlet horizontally along the bottom where it will be accessible and also hidden. If you install the outlet too high it will be blocked behind the glass. If you install it so the outlet opening is starts at the same height as where the bracket shelf is located as seen in the above picture. The end result of your bracket and recessed outlet installation should look like the image below although the horizontal placement of the outlet can be almost anywhere you want as long as it will be hidden behind the aquarium. The outlet can be in between both brackets as well. We recommend this for smaller models.



k. At this point you need to make a decision. Our newest aquariums come with up to 3 different backgrounds and a roll of adhesive tape to secure them to the glass. Smaller models may come with one background preattached and will include 1 or 2 additional ones if you choose to switch it. This enables you to choose one of the included backgrounds or even make your own! To avoid the possibility of water damaging your background it is important to seal the entire length of the background paper to the top of your aquarium. This paper is water resistant but should not be submerged in water. To make your background look realistic it is important to try to get it as smooth as possible. You should put your aquarium face down on the ground on top of the foam padding which came in your original box to prevent any scratching. You'll want to first lay out the background onto the glass and start by taping the top since it is most critical. The tape should be about half on the paper and half on the glass and the top should be lined up exactly with the top of the aquarium. Once the entire top has been secured you should then tape smaller sections on the sides and bottom slowly while pulling it tight to ensure that it is smooth. It's now time to hang the aquarium!

l. Before you secure the aquarium to the wall, remove the toggle clips and put the light and filter in place. Feed the light and filter cords behind the aquarium before securing to the wall. Place the aquarium onto the brackets being sure that the wires are behind the glass. The male ends of these cords will plug into the outlet you may have installed or can plug into an extension cord and run down your wall to an outlet below. You do not need to put the filter or light into their final locations just yet as you'll need to adjust things as you

go.

m. Secure the toggle clips to the brackets. If you over-tightened the top screw on the brackets it may be difficult to replace the toggle clip. Do not force or bend the clip. These clips only go one way according to the design. You may need to loosen the top screw on the brackets a few turns if you over-tightened them in order to get the toggle clips back on.

n. On the bottom of the aquarium you can replace the small screws which held the brackets in place when you first opened the aquarium. When you replace small bottom screws you will probably create 2 new holes by doing so since it is unlikely that your studs lined up with the original bracket locations. It is recommended that you install the small screws by hand and do not over-tighten them as you can crack the glass on the base of the aquarium! That's it! It's now on the wall and secured!

3. Adding the Water.

a. Use only water at room temperature to fill aquarium.

b. We recommend you use spring/distilled water or de-chlorinated tap water as chlorine or chloramines found in most water can be harmful to your new pet.

c. Check with local professional dealer for the water conditioner that works best in your area.

CAUTION: NEVER ADD UNTREATED WATER TO YOUR AQUARIUM AS IT CAN KILL YOUR PET.

d. Slowly fill the aquarium to about half full. Make sure when you fill your tank with water that the light does not get submerged in water!

e. If you plan to decorate your tank with gravel, plants and other ornaments you may want to consider adding these before filling your tank all the way to the top. Gravel, decorations and any other additions should be thoroughly washed before adding them to the tank. Many products contain chemicals which can kill your fish.

f. After adding all the decorations you can then fill the remainder of the aquarium with water. The water line should be just above the viewing area.

g. If you purchased fish from a store, the fish will usually come in plastic bags. It is recommended to float those bags so the fish may acclimatize to the new water temperature in the tank. Ask your local pet supply expert for more information.

4. The Filter - Multifunction filters vary by the type of aquarium that you purchased. Your multifunction filter may come with many elbows and attachments for alternate uses however there are 2 basic setup positions. The setup and the air line tube setup. These filters are designed to be used with basic freshwater fish that do not require high levels of filtration and special care. You can upgrade your filter to several different market bio-filters which your sales person can recommend.

a. The setup will use one or more attachments including a output tube. The idea of this setup is simple. Water is drawn in through the canister and will pass through one or more media which filter the water before being release back into the aquarium. The output tube should be just out of the water which will create air bubbles in your aquarium which oxygenate the water. The remaining powerhead and canister will be fully submerged. Mount the filter inside your tank using the attached suction cups. Be sure to keep the plug portion of the cord out of water at all times! It is highly recommended that you unplug the light and filter before ever reaching your hands inside the tank. The images below show the approximate position that the filter should be placed in. This method is recommended only for aquariums where the output tube will span a good portion of the water surface. Some aquariums come with 2 filters. You can set up one filter with each method or both with the same method. You should consult your aquarium expert who can assist you.

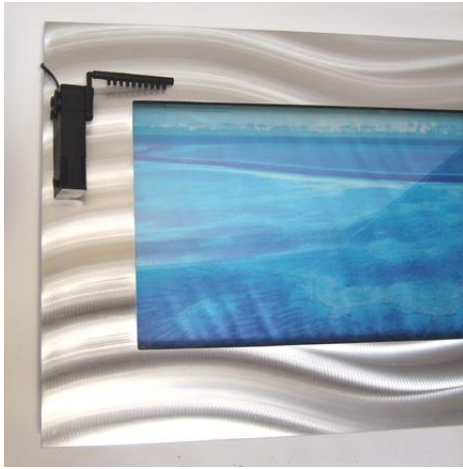

b. The air line tube setup uses a flexible air tube that has an end cap (air valve) which will allow you to control the amount of air that is being drawn into the aquarium as well as an air tube clip to pinch the air intake. To set up the air line tube method, just attach the flexible tube to the air valve and the opposite end of the air tube to the nipple part of the cylindrical air tube attachment. This cylindrical attachment will then attach to the powerhead and the opposite end with the control valve will actually be outside the aquarium to aerate the water. Mount the filter inside your tank using the attached suction cups. Be sure to keep the plug portion of the cord out of water at all times! It is highly recommended that you unplug the light and filter before ever reaching your hands inside the tank. For this setup the top of the powerhead should be at least ½" underwater. The images below show the approximate position that the filter should be placed in with this method. This method is recommended for larger aquariums since the output is blown straight across the water creating a whirlpool effect. Some aquariums come with 2 filters. You can set up one filter with each method or both with the same method.



5. Light and Lid

Our newest aquariums come with various types of lids. The most common form is a pre-cut lid made of acrylic or glass. The lights may come with wall mounting clips to mount your light to the wall just above the aquarium lid. Make sure when you fill your tank with water that the light does not get submerged in water!

Suggestion: As a finishing touch to hide the cords (if you did not install a recessed outlet) you can purchase a cord cover from your local building supply store. It usually comes in white or off white, and alternatively can be painted to match your walls or some silver versions are available to match your tank. They usually have a self-adhesive backing that is applied to the wall. Push the cord firmly into the cord cover.

Taking Care Of Your Tank.

Never handle the aquarium with wet hands. Be careful whenever handling the aquarium while adding gravel, sand, rocks or any other decorations. Never clean the inside with anything other than an algae scraper, sponge (or algae pad) and warm water. When using the siphon cleaner to stir through the gravel or sand move the siphon head gently through the base.

To empty tank or change water using siphon hose and bucket.

a. Disconnect all power.

b. Remove light (if not mounted), glass lid and filter.

Submerge siphon hose into tank (keeping away from the fish) and siphon water into a receptacle. If necessary lift hose above tank level to stop flow. Never leave aquarium unattended during this process. The included siphon has a gravel vacuum attachment. You can run this part through the gravel to stir up the algae and it will filter the algae out of the gravel without removing the gravel from the aquarium. Do not jab at the gravel as you can weaken the silicone seals and possibly create a leak.

c. Empty 1/4 to 1/2 of the water for a water change. Do not remove too much water as the water contains bacteria needed for your pets to survive. If your water is very dirty do this process once a day repeatedly over a few days until the water is cleared.

d. Wipe with scraper, sponge or algae pad.

e. Slowly refill tank. Use more chlorine remover whenever refilling your tank.

If your aquarium is located in direct sunlight during part of the day it will accumulate a considerable amount of algae. Your algae will continue to bloom if you leave your light on overnight or for a longer duration of time. You will probably need to scrape the walls of your aquarium once every two to three weeks. We recommend that you fully clean your aquarium once every 6-12 weeks at a minimum. We offer professional maintenance programs in certain areas or you can contact your local aquarium maintenance company to inquire about monthly or bimonthly maintenance.

TO CLEAN THE ALUMINIUM FACE USE A DAMP CLOTH. DO NOT USE ANY ASTRINGENTS.

Disclaimer:

We takes no responsibility for installation or any damages caused during or thereafter. We provides this installation manual as a guide to mount an Aussie Aquarium to a common wall. Affixing this type aquarium to residential wall, commercial walls and non-standard walls such as concrete and steel beam walls may require alternative hardware not included in our basic aquarium set. It is recommended that you consult your local hardware store for proper hardware if you are in any way unsure of the wall type. Vandue recommends owners to have their tanks professionally installed by a licensed and bonded handyman, all electric work done by a bonded electrician and all maintenance done by a knowledgeable aquarium expert. Vandue is not responsible for damage caused by faulty installations or lack of maintenance.

One Year Limited Warranty

We committed to providing its customers with premium quality products and superior customer support. Aquariums are warranted to the original purchaser to be free from defects in materials and workmanship under normal use for a period of 1 year from the date of purchase.

This warranty does not apply to the deterioration of the product due to apparent abuse, misuse, accidental damage and any manner not consistent with its original purpose. It also does not cover light bulbs or other components that require replacement due to normal wear and tear. No merchandise can be accepted for return without prior approval and is subject to exchange or repair only. It is the purchaser's responsibility to ensure the return freight of the returned merchandise and is in its original package and be accompanied by the original invoice and warranty certificate.

Please allow up to 8 weeks for the repair or replacement of the product. For any warranty questions please contact us directly.

