

As this item contains many parts, please read the installation instruction carefully before installation . Please use tools properly and carefully. If you have any questions about the product and installation, please contact us.

Our professional after-sales team will serve you online all day.

Before You Start

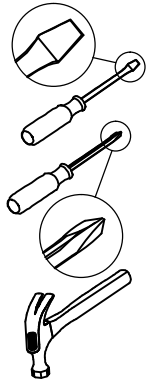

- ✓ Read through each step carefully and follow the proper order
- ✓ Separate and count all your parts and hardware
- ✓ Give yourself enough room for the assembly process
- ✓ Have the following tools: Flat Head Screwdriver, #2 Phillips Head Screwdriver
- ✓ Caution: If using a power drill or power screwdriver for screwing, please be aware of to slow down and stop when screw is tight. Failure to do so may result in stripping the screw.

Helpful Hints

PEOPLE NEEDED FOR ASSEMBLY: 2

- Open your item in the area you plan to keep it to avoid excessive heavy lifting.
- Identify, sort and count the parts before attempting assembly.
- Do NOT use harsh chemicals or abrasive cleaners on this item.
- Never push, pull, or drag your furniture.



Part List

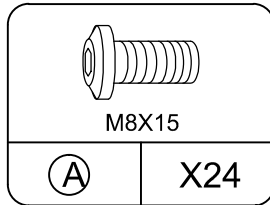

BOLT
spare:2

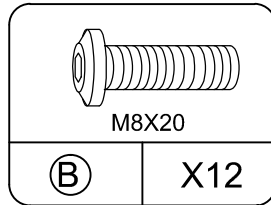

BOLT
spare:2

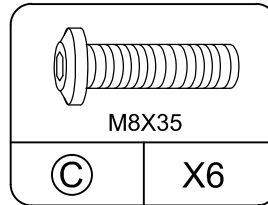

BOLT
spare:2

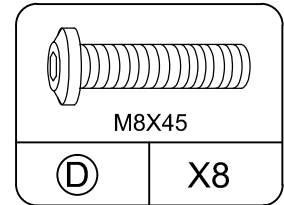

BOLT
spare:1

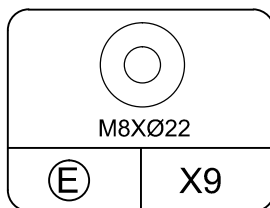

GASKET
spare:1

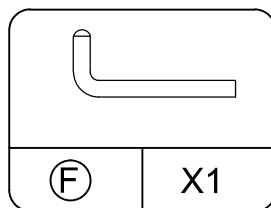

SPANNER

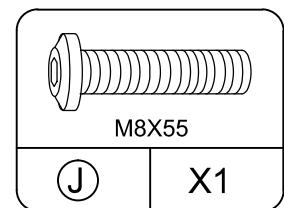
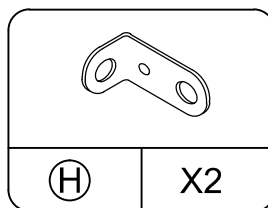

BOLT
spare:1

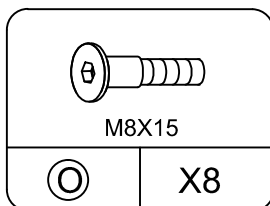

BOLT
spare:2

Product explosion diagram

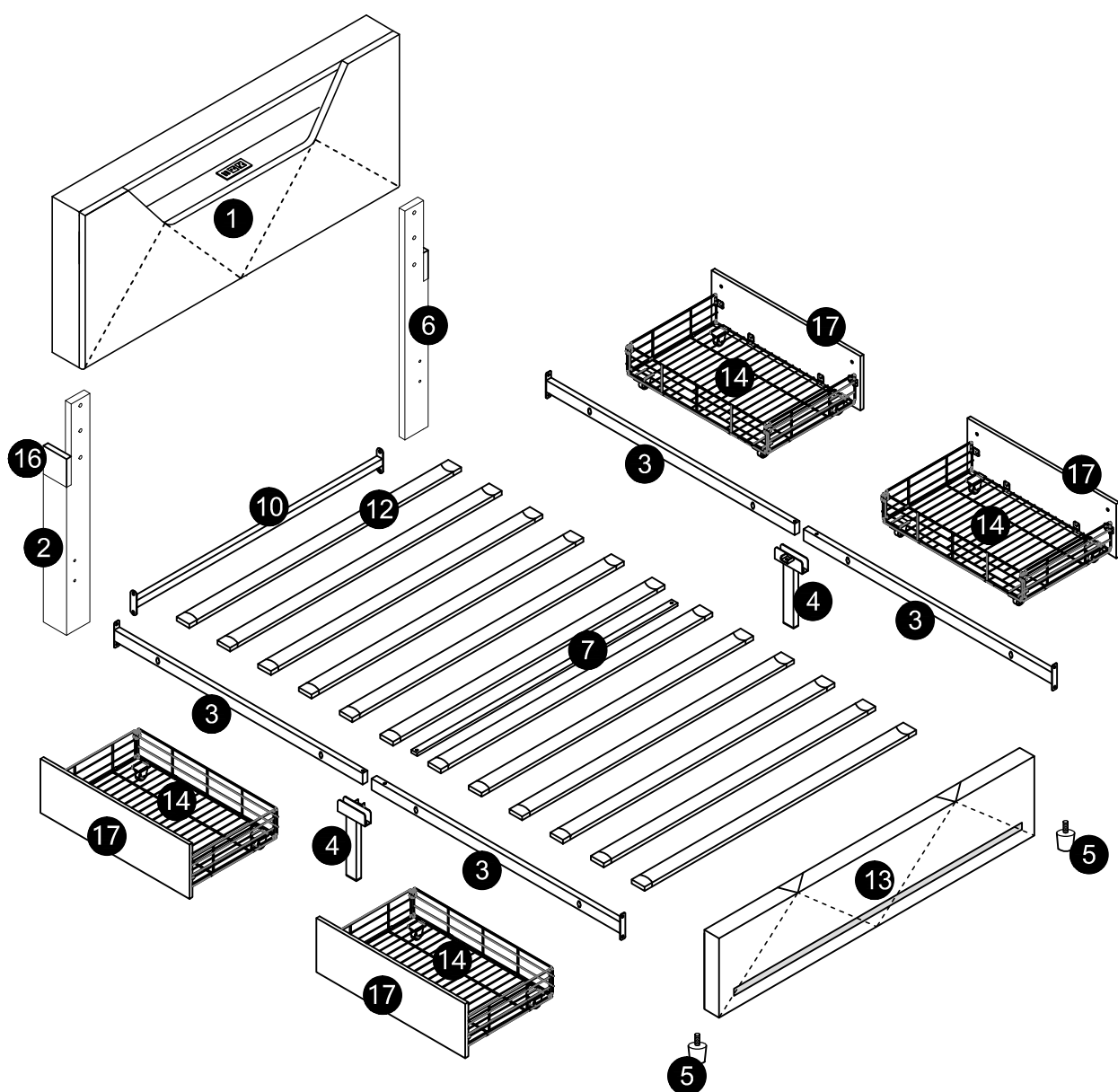

Part List

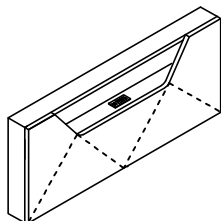

Headboard

1 1PC



Headboard leg

2 1PC

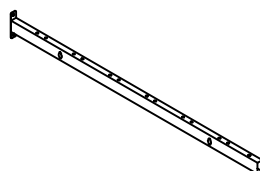

Side tube

3 4PCS



Side leg

4 2PCS



Foot

5 2PCS



Headboard leg

6 1PC

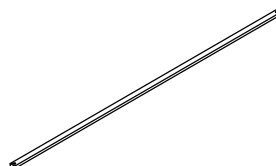

Mid-connecting tube

7 1PC

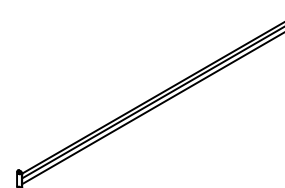

Headboard Leg connecting tube

10 1PC

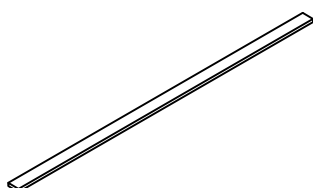

Sparerib strip

12 12PCS

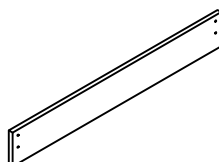

Foot panel

13 1PC

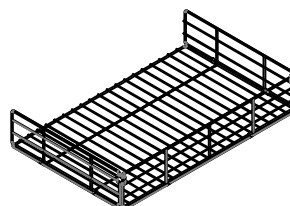

Wire basket

14 4PCS

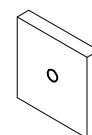

Wooden block

16 2PCS

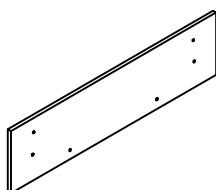

Drawer board

17 4PCS

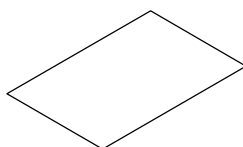

Drawer bottom panel

18 4PCS



Iron buckle

19 16PCS



Sparerib strip plug

21 26PCS

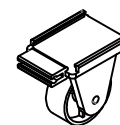

Pulley

22 16PCS



Plastic buckle

23 8PCS



Plastic buckle

24 8PCS

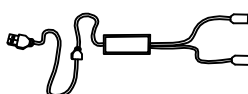

Power cord

28 1PC

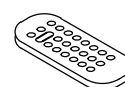

Remote control

29 1PC



Strap magic tape

30 8PCS

Board Identification

Not actual size

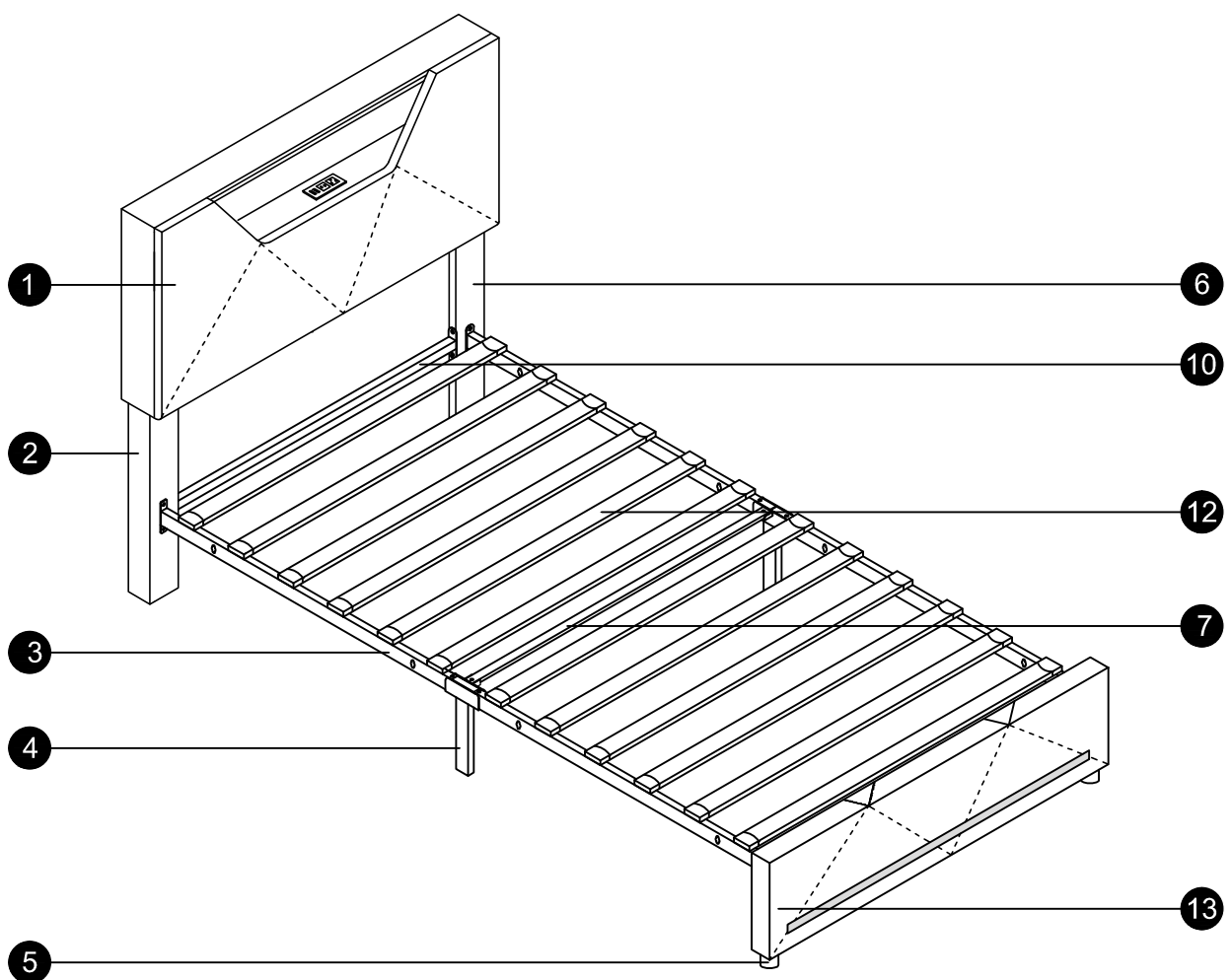

STEP1

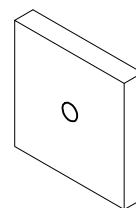
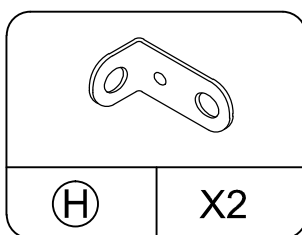
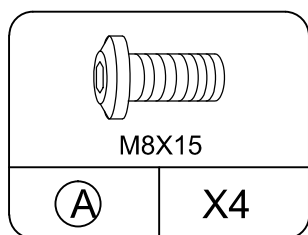

Wooden block

16 2PCS

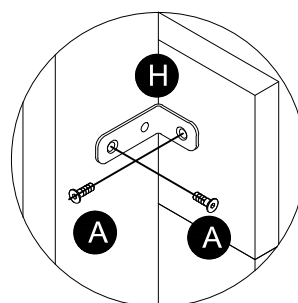
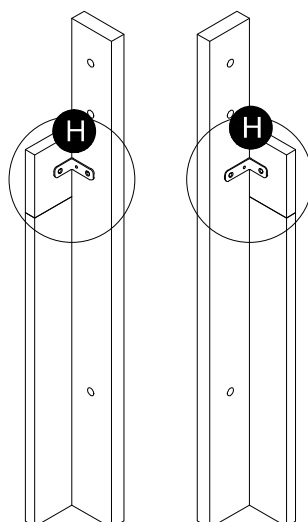
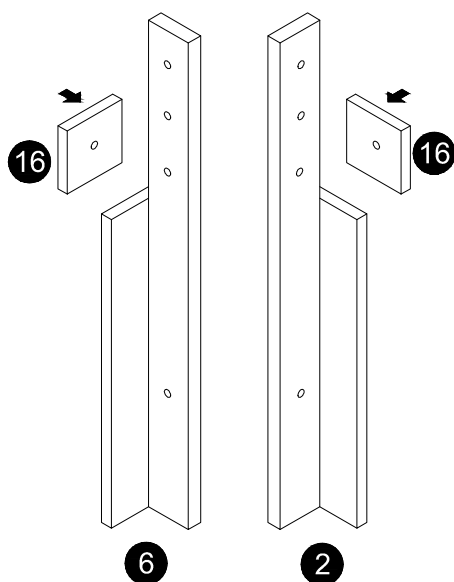

STEP2

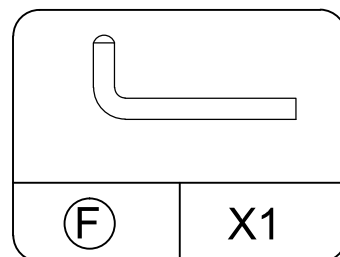
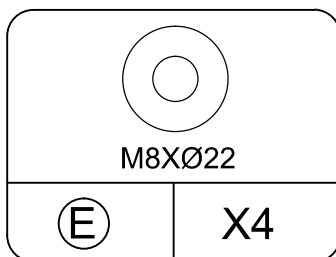
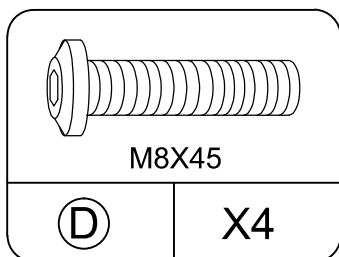

Due to the heavy head of the bed, two or more people must participate in the install ! ! !

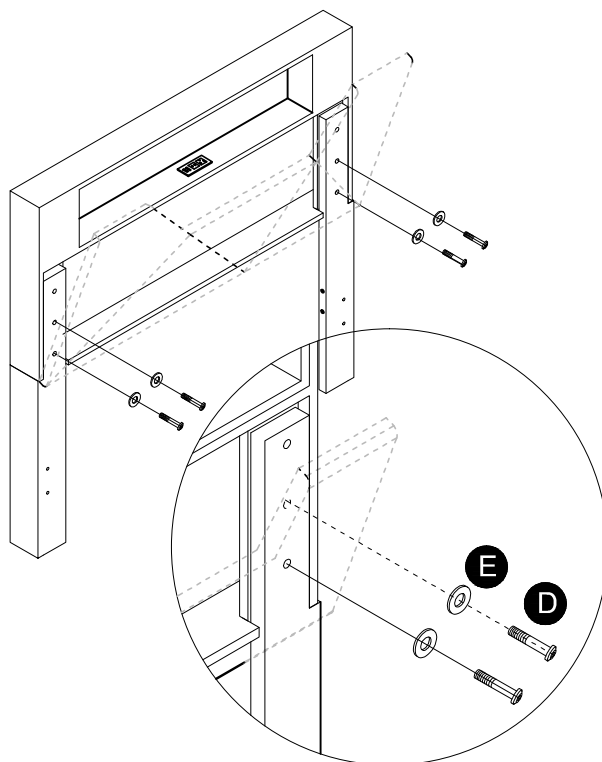
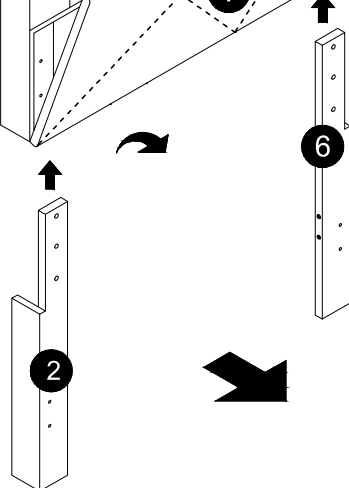
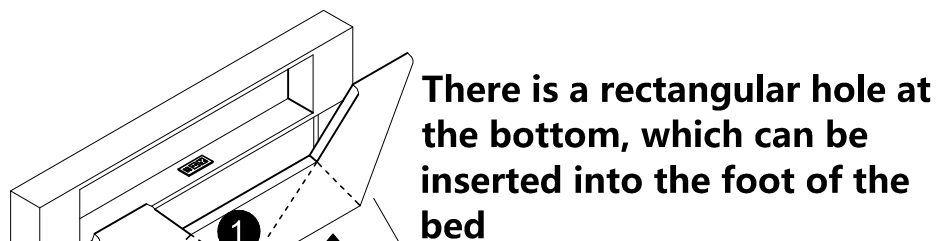

Please install the headboard (1) on the legs (2) (6) with bolt (D). (The height of the bed head is adjustable. If your mattress height is 11 inches or shorter, please align the 2 holes on the bed head with the second and third holes of the legs. If your mattress height is 12-14 inches, please align the two holes with the first and second holes on the legs).

STEP3

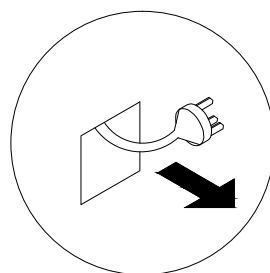
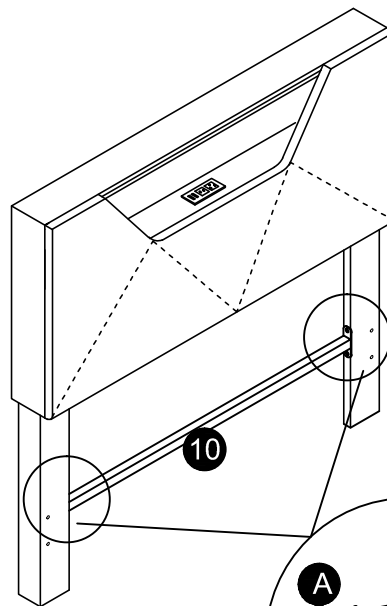
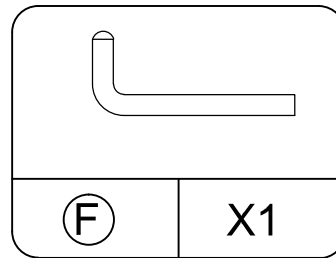
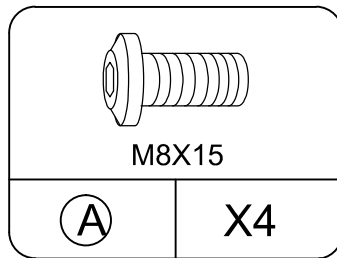

**Take the
plug out of
the plug
hole here**

Turn to the back

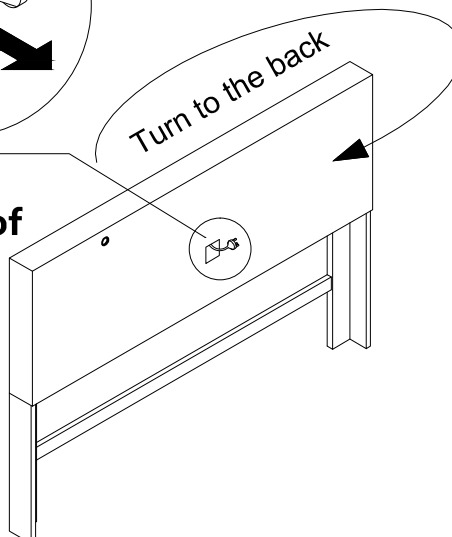

STEP4

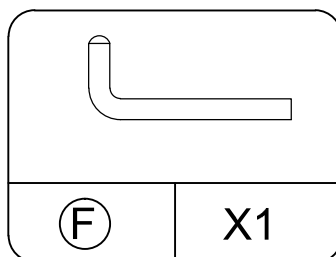
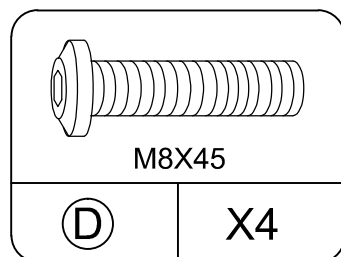

Four bed sides (3)
need to be installed, 2 sets in total

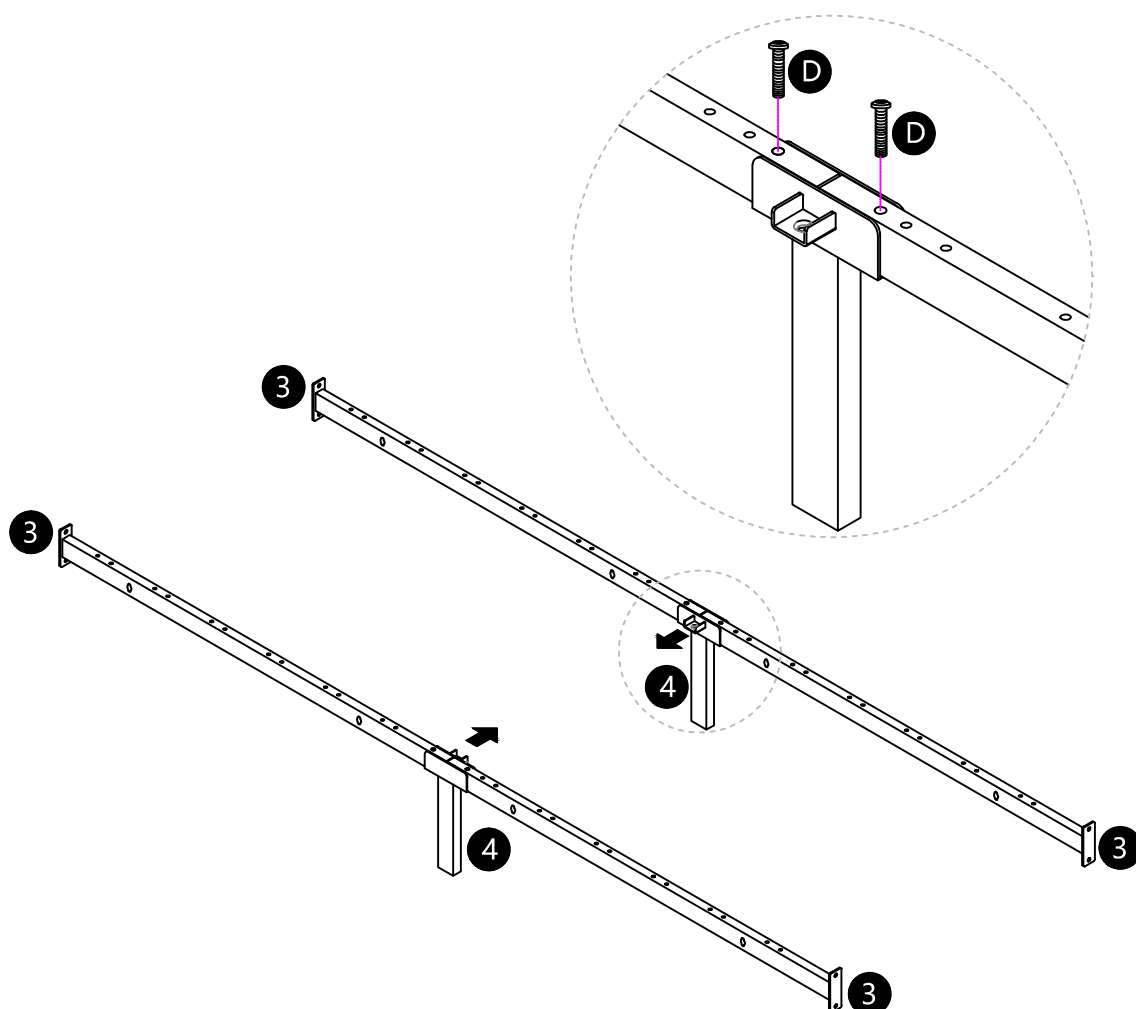

STEP5

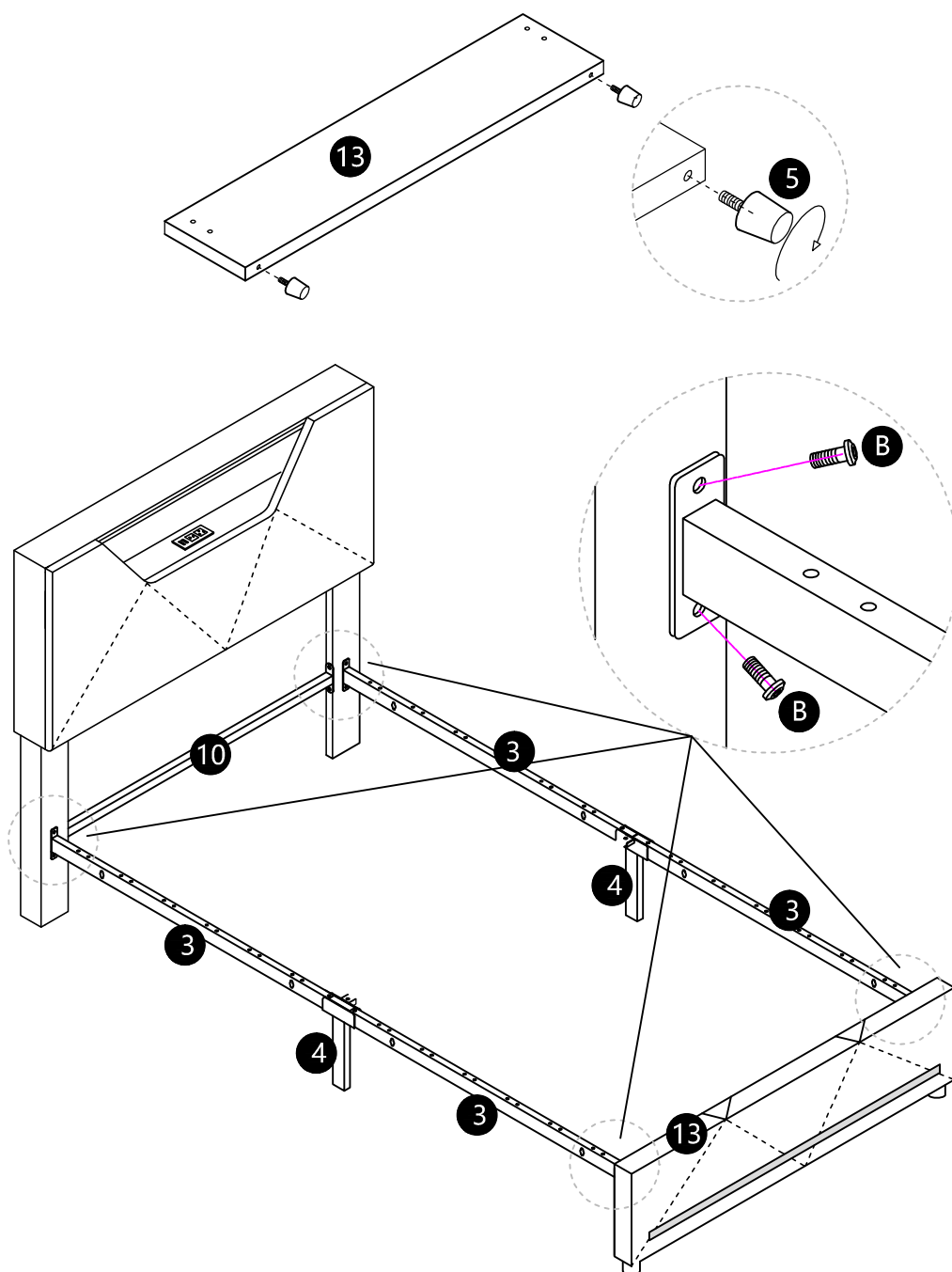
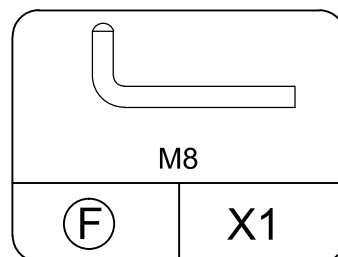
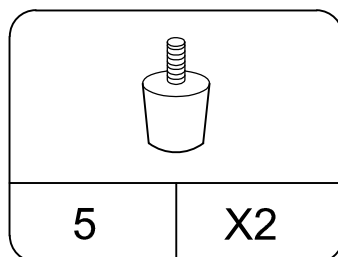
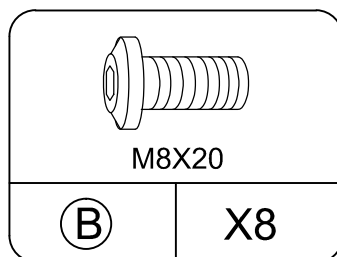

STEP6

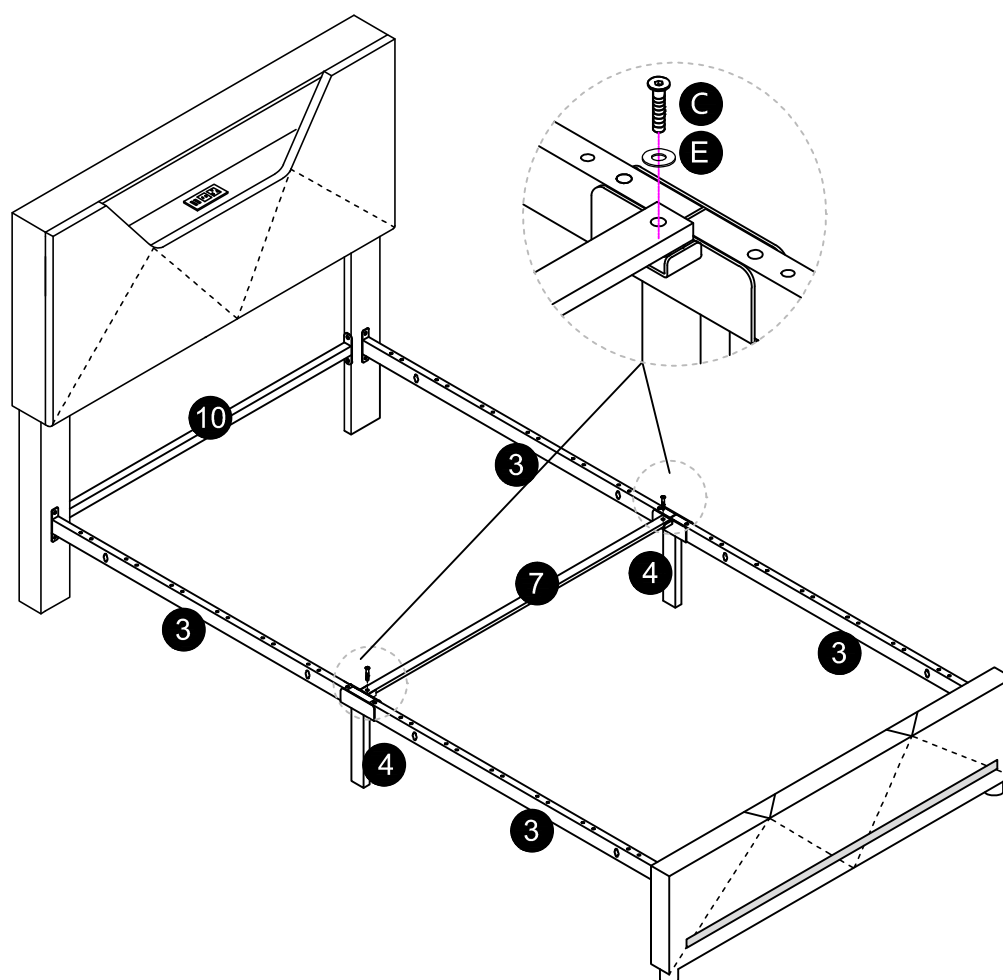
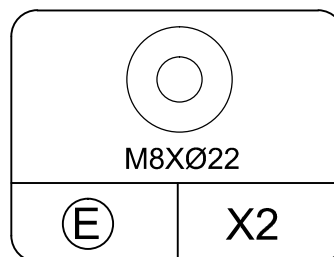
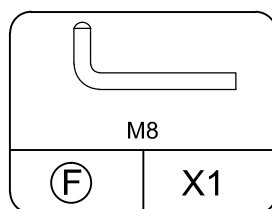
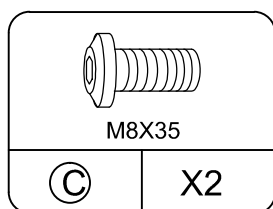

STEP7

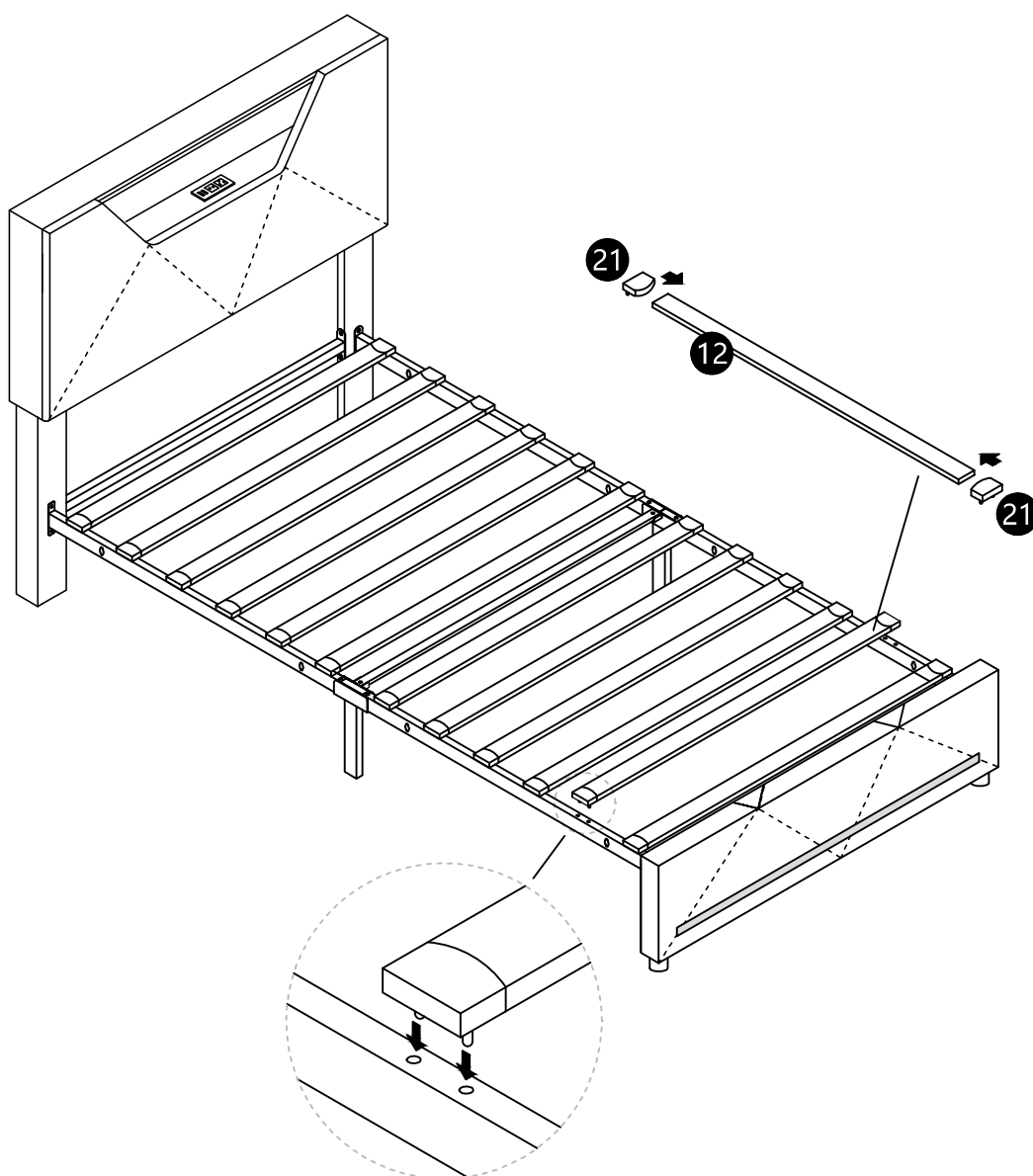
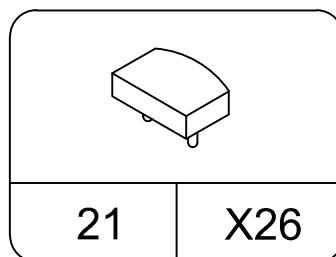

STEP8

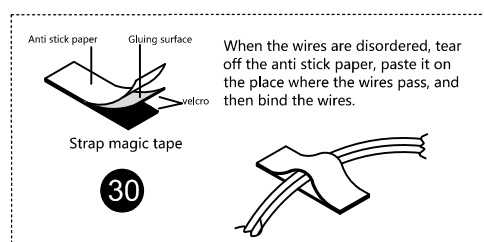
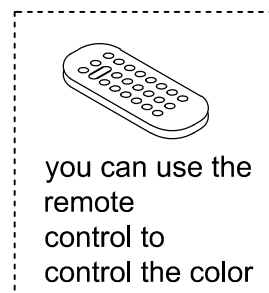
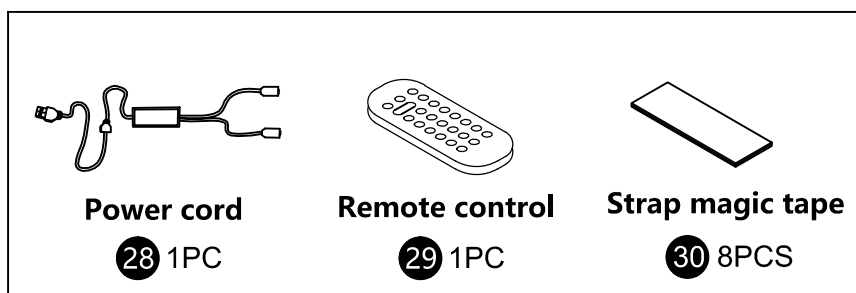

The LED lamp can only be used when it is powered on

There is glue on the back of the Strap magic tape, tear off the anti-stick strip, you can paste

Put the four meter long wire along the wire buckle and fix it

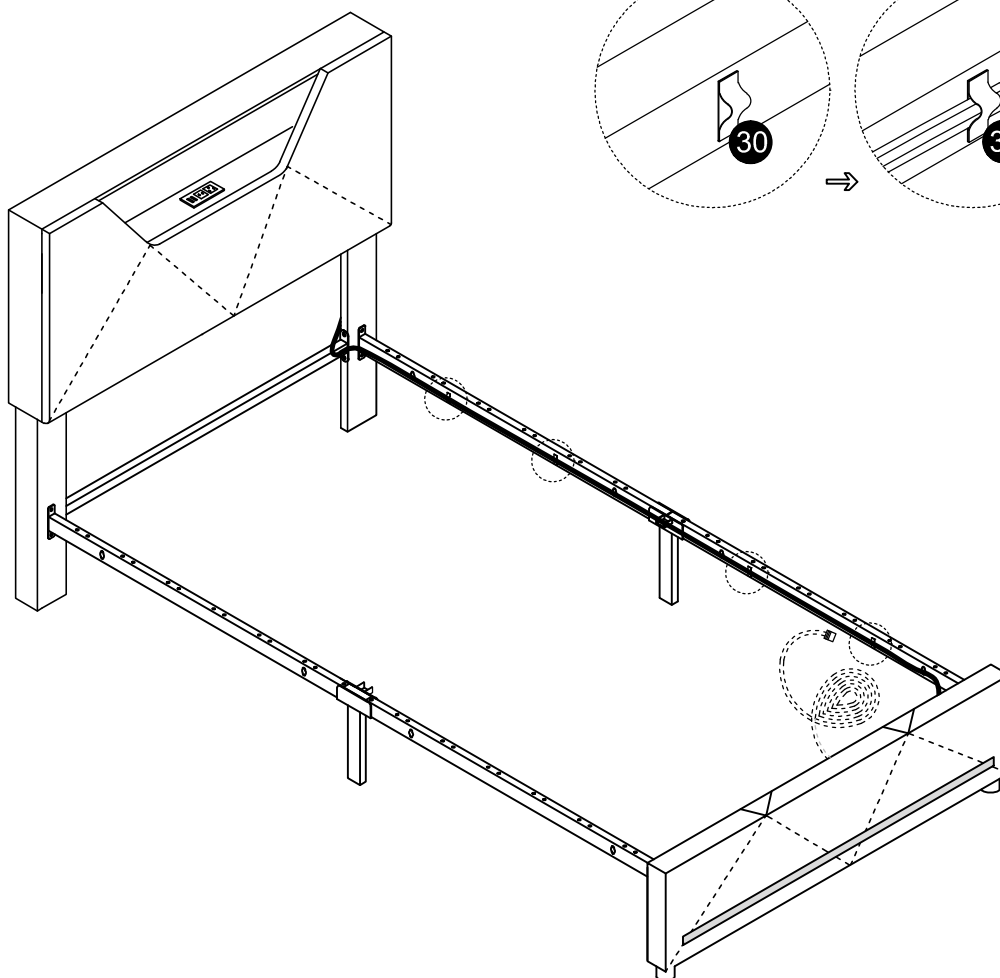
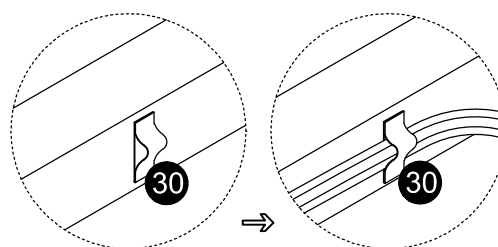

STEP9

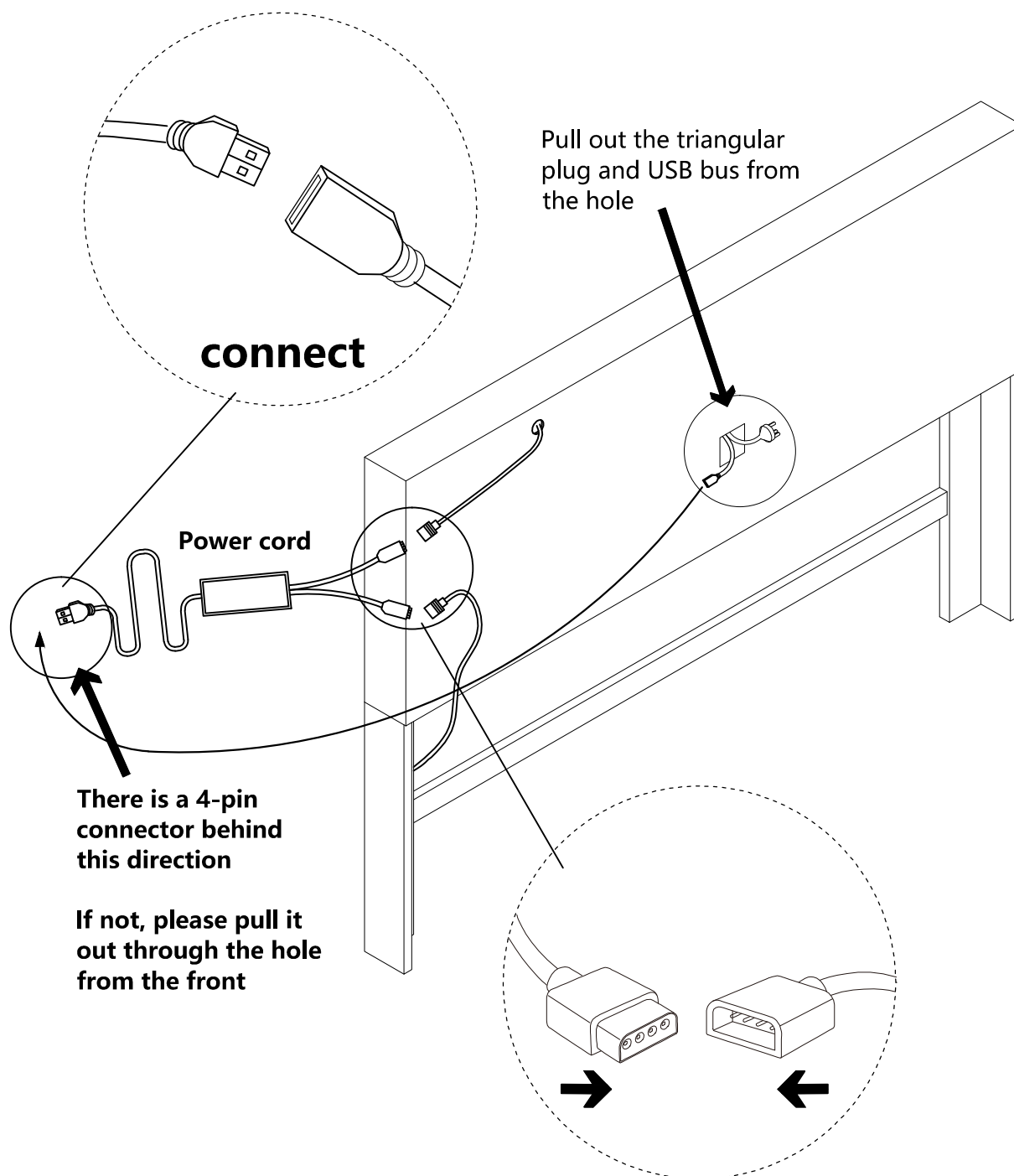

STEP10

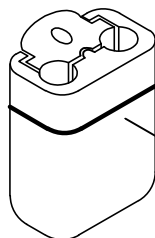
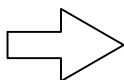
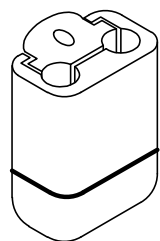

Remember this
convex coil

Reverse direction

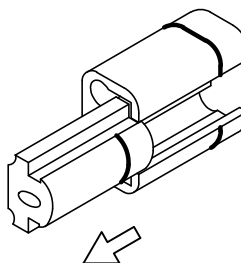
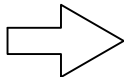
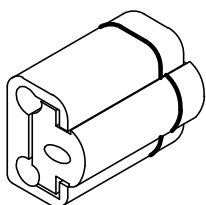

You can pull the buckle out by following
the direction indicated by the arrow

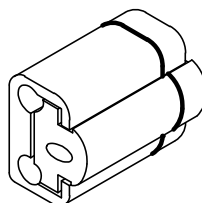
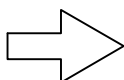
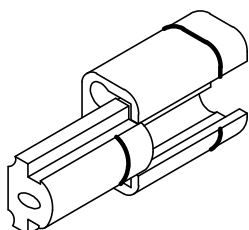

So This is the only direction that can be locked

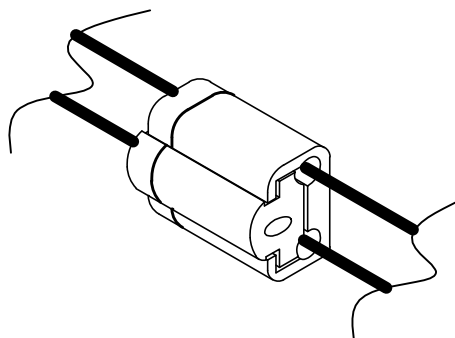
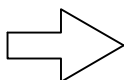
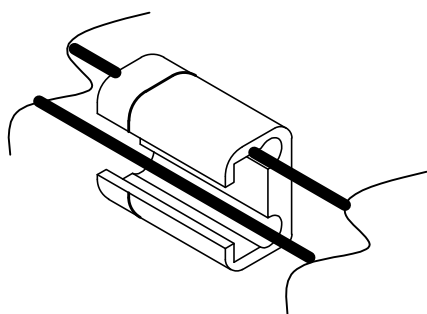

Place round iron tube as shown for better drawer assembly

STEP11

As shown in the figure Clip the pulley into position first

Then push the pulley to the side
At the same time, clamp the iron wire at the edge. It takes a little strength

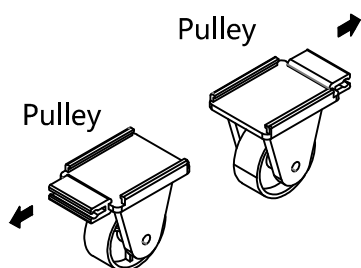
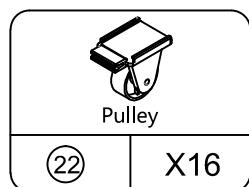
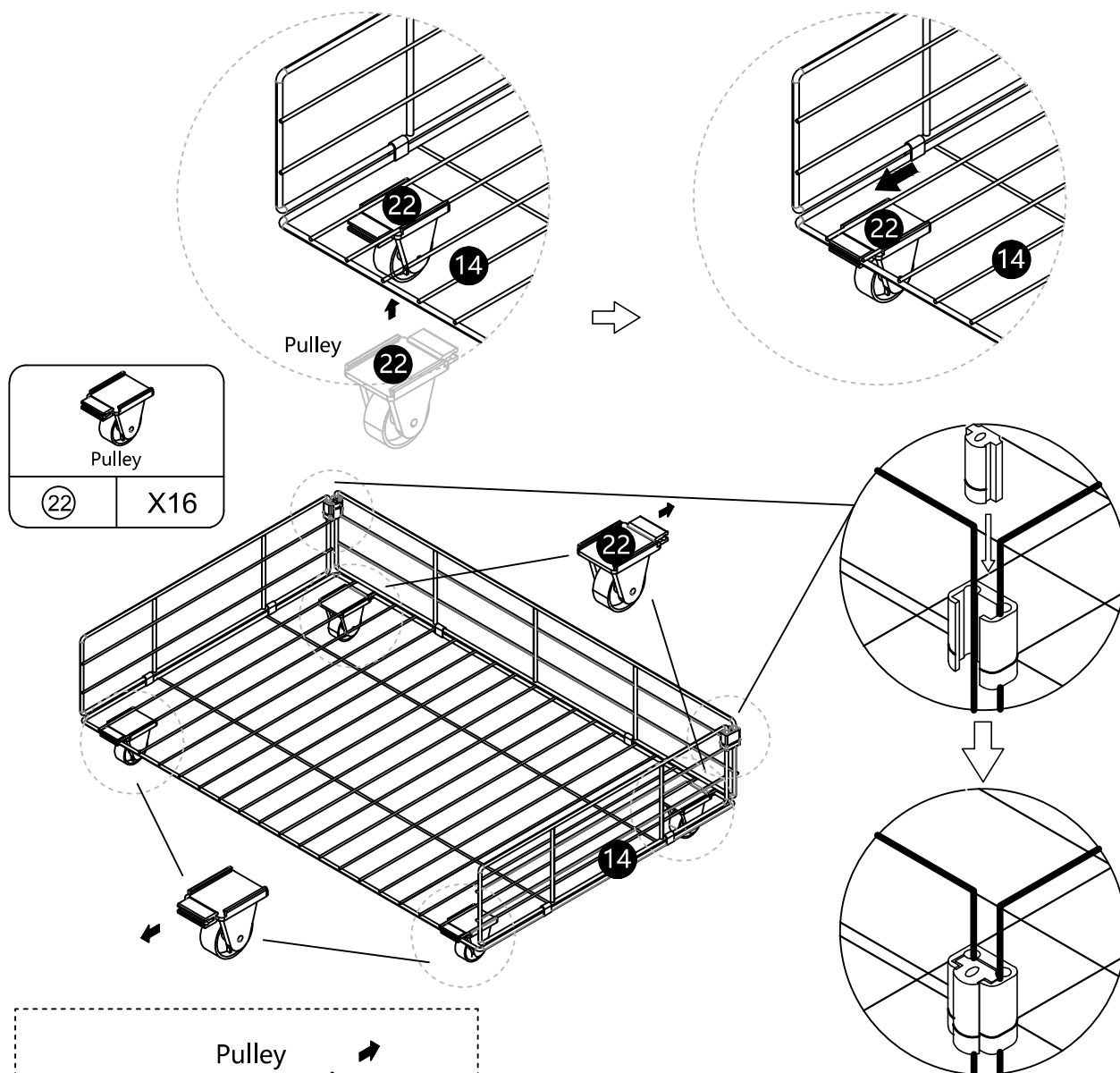

Pay attention to the orientation before clamping in

Please note that this drawer base (14) has front and back sides! Please see the instructions clearly before assembling!!!

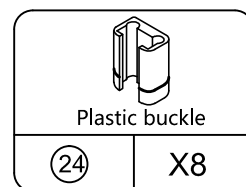
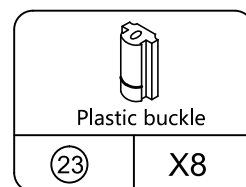

STEP12

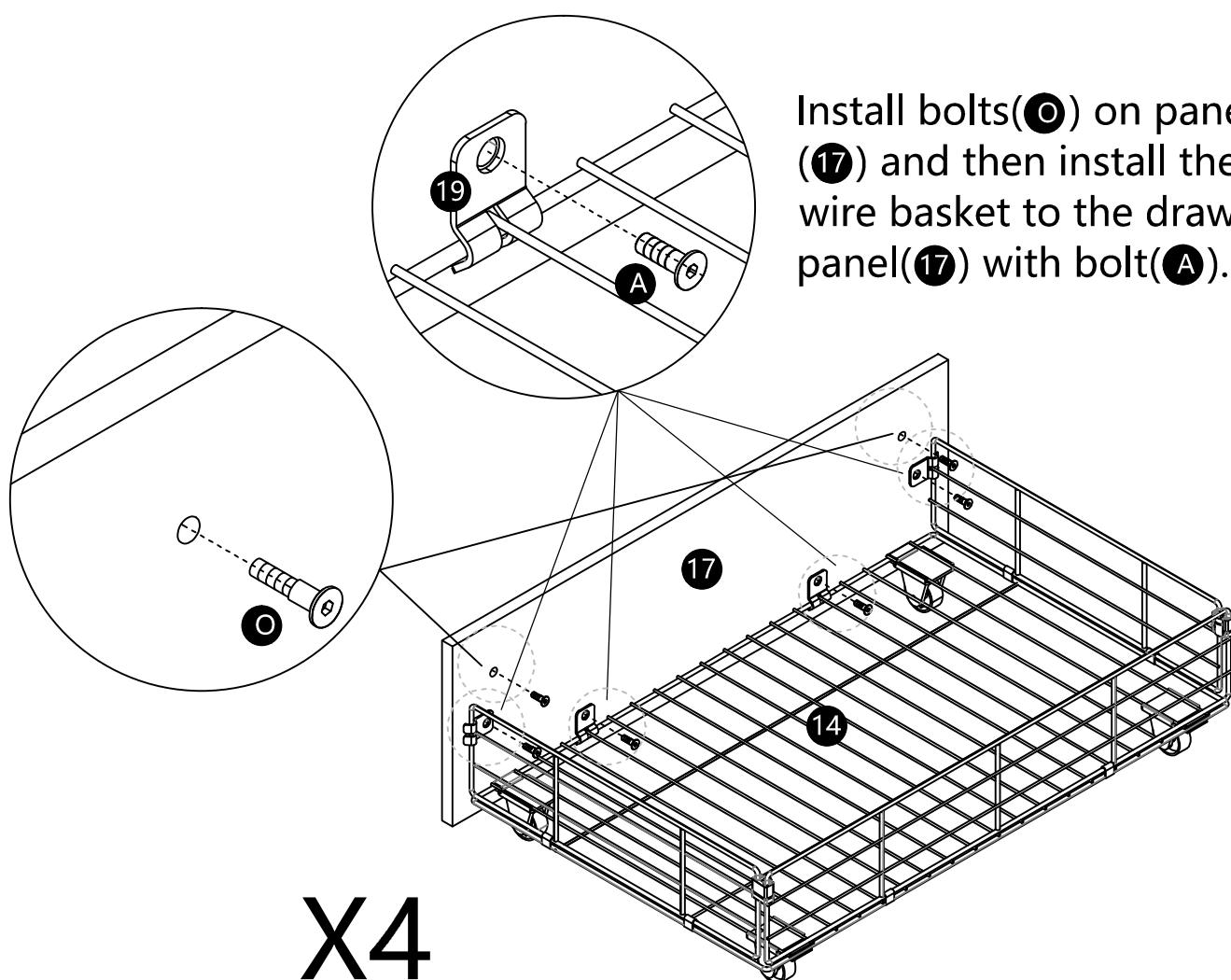
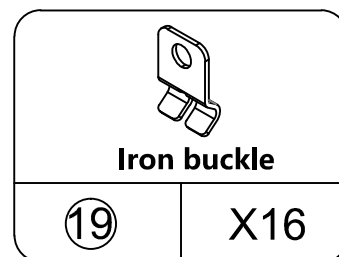
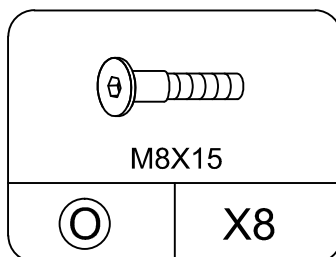
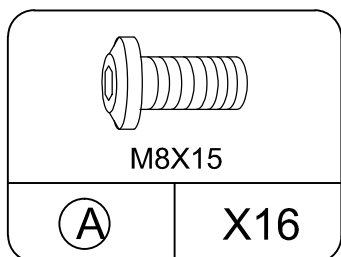

Install bolts (O) on panel (17) and then install the wire basket to the drawer panel (17) with bolt (A).

X4

Assemble the other three drawers in this way. 4 drawers in total.

STEP13

You must put the drawer pad (18) in the drawer

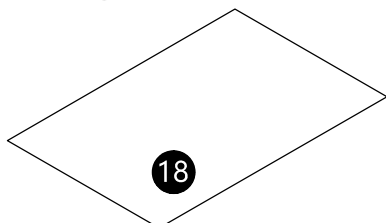

Put it in

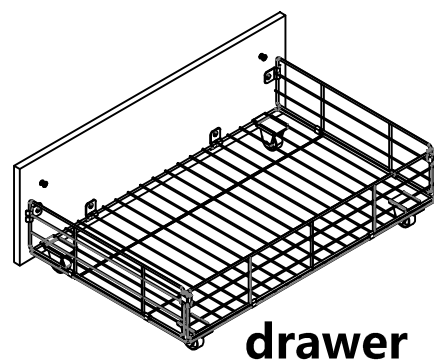

**When pushing into the drawer,
Lift the drawer gently,
Align the screw with the gourd
hole and push in
When pulling out the drawer, Lift
the drawer gently,
Align the screw with the gourd
hole, and then pull it out**

