

ASSEMBLY INSTRUCTION FOR SECTIONAL

Caution: Please read instructions thoroughly before unpacking assembly parts. Sharp, exposed staple tips can cause injury, therefore, for your protection, please remove any exposed staples used in packing.

1. We recommend that you should assemble this product with the assistance of another person; this will make assembly easier, and will help to eliminate damage the product or injury to person during assembly.
2. Be sure to check all packing materials carefully for small parts that may have come loose inside the carton during shipment.
3. Please do not over tighten screws or bolts.
4. Please put all parts on a non-abrasive floor before assembly, and follow the assembly steps to assemble your newly purchased product correctly and afficaently.

PART LIST CHAISE BOX (C)			
NO.	PART DESC	Q'TY	CODE
A	CHAISE BACKREST	1	
B	LOVESEAT BACKREST	1	
C	WOOD LEGS	4	PU-5140-LEG1

HARDWARE LIST CHAISE BOX			
NO.	HARDWARE DESC	Q'TY	HARDWARE CODE
1	SCREWS Ø4x50mm	8	PU-5140-147-HW
2			

PART LIST LOVESEAT BOX (L)			
NO.	PART DESC	Q'TY	CODE
E	CHAISE BACKREST CUSHION	1	
F	LOVESEAT BACKREST CUSHION	1	
G	LEFT ARM ADD POWER USB	1	
H	RIGHT ARM ADD POWER USB	1	
I	PILLOWS	2	PU-5140-4551-PIL PU-5140-4550-PIL

 Only tighten all bolts when all bolts aligned with bolt inserts.

ASSEMBLY INSTRUCTION FOR SECTIONAL

STEP 1
IN THE BOX CHAISE PULLOUT BED

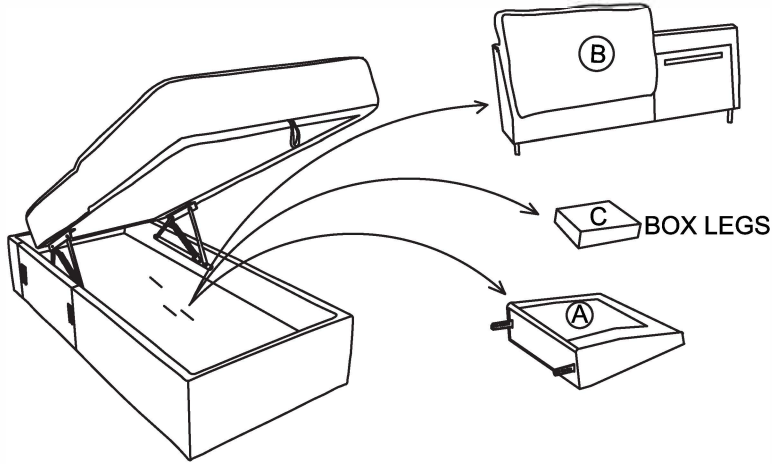

- STEP 2**
1. Turn the sofa and unzip the bottom remove the sofa legs carton
 - 2- Before opening the carton and taking out the sofa after the legs
 - 3- Remove the box, remove the legs of the sofa and put the inor bolts, spring washer in sequence

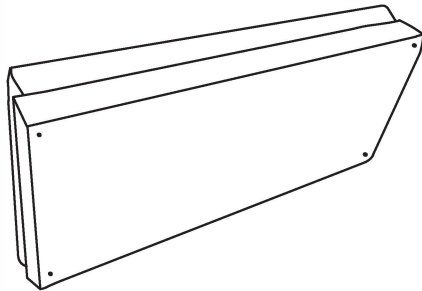

STEP 3

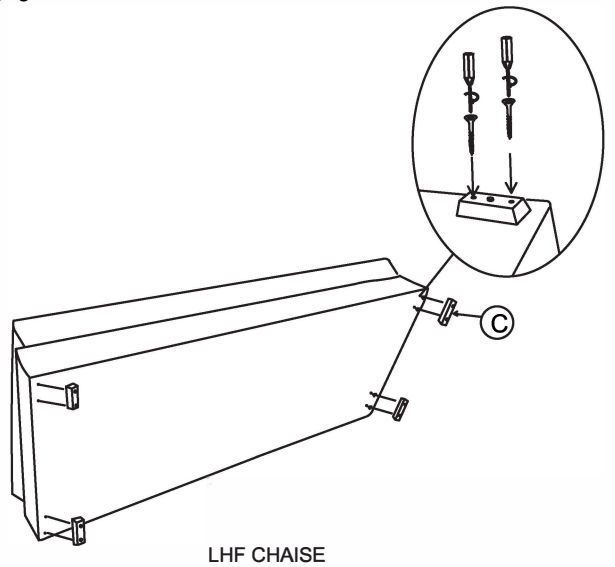

STEP 4

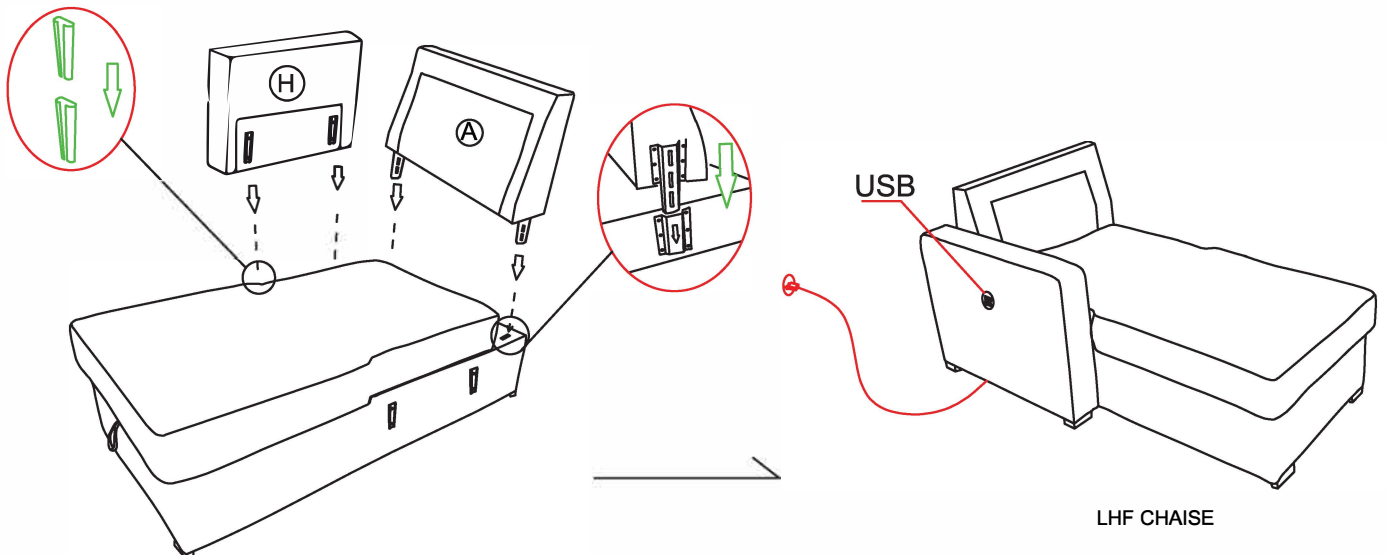

ASSEMBLY INSTRUCTION FOR SECTIONAL

STEP 5

IN THE BOX LOVESEAT PULLOUT BED

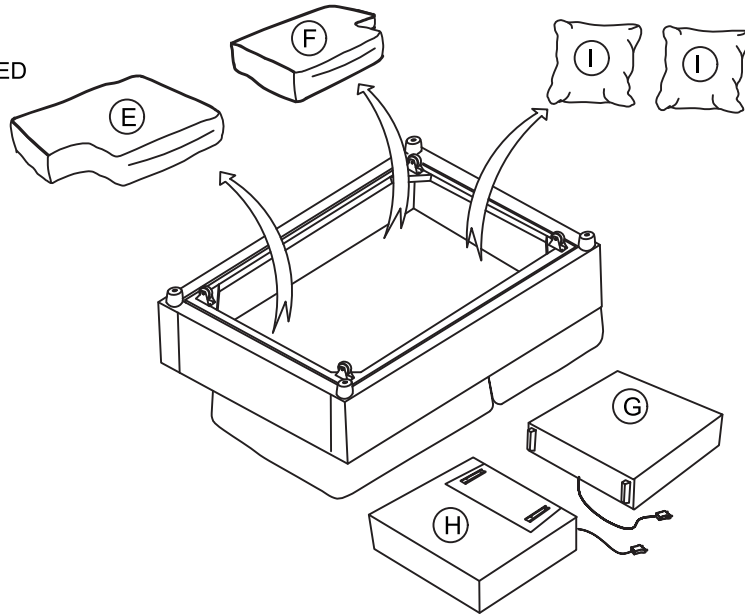

STEP 6

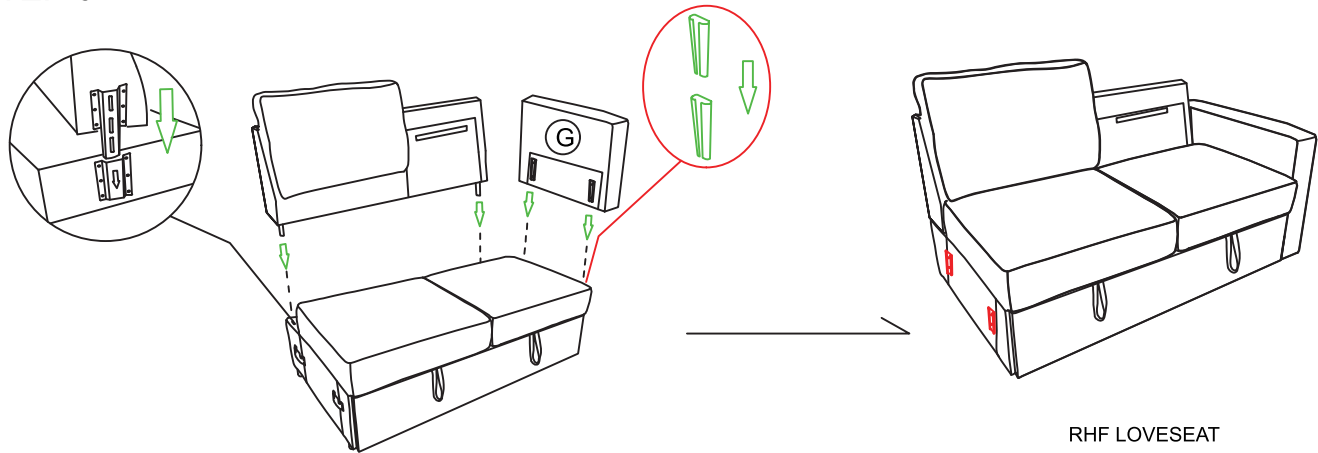

COMPLETED

