

APPROX WEIGHT: 11.77 lbs.
DOES NOT INCLUDE WEIGHT OF POWER OR PACKAGING!!!

ERGO-HANDLE WHEEL CHOCK - FAB-10-ERGO

*** ANY ADDITIONS, DELETIONS, OR OMISSIONS MUST BE CORRECTED ON THIS DRAWING AS THIS DRAWING WILL BE CONSIDERED ALL INCLUSIVE ***
ALL GRAPHICS PROVIDED ARE FOR REFERENCE ONLY. IF CERTAIN DIMENSIONS ARE CRITICAL PLEASE VERIFY THOSE DIMENSIONS WITH YOUR SALESPERSON

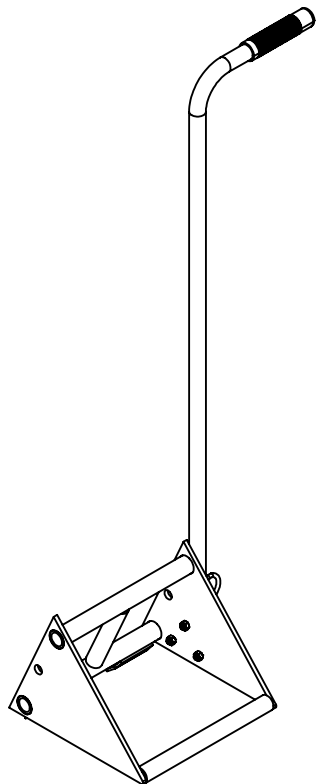
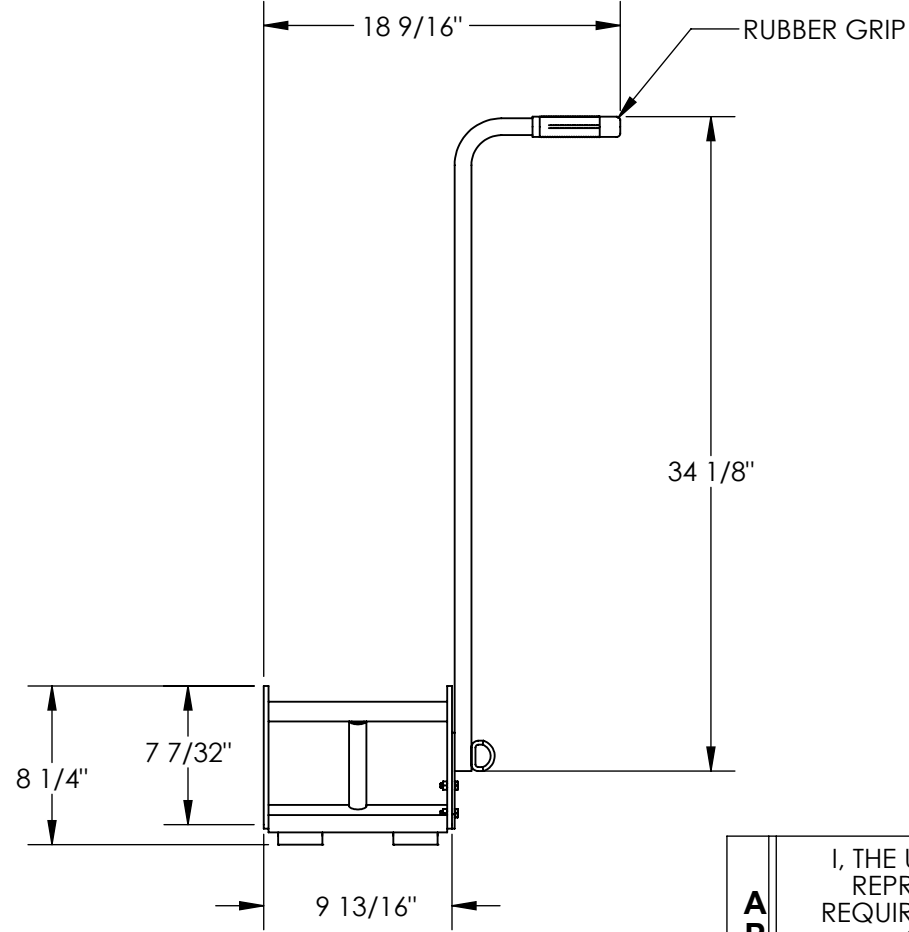
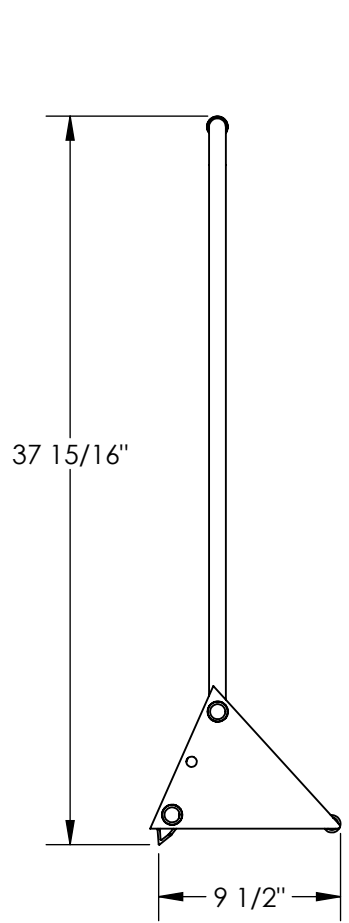

DIMENSION TOLERANCE ± 1/2"

STANDARD FEATURES

- MODEL NUMBER IS FAB-10-ERGO
- CHOCK WIDTH IS 9 13/16"
- OVERALL WIDTH IS 18 9/16"
- CHOCK LENGTH IS 9 1/2"
- OVERALL HEIGHT IS 37 15/16"
- CHOCK HEIGHT IS 7 7/32"
- HANDLE COMES WITH RUBBER GRIP
- SHIPS KNOCKED DOWN
- 10' CHAIN INCLUDED (NOT SHOWN)
- TOUGH BAKED IN POWDER COATED YELLOW FINISH

SPECIAL FEATURES

NONE

APPROVAL

I, THE UNDERSIGNED, AGREE THAT THE PRODUCT AS REPRESENTED SATISFIES DESIGN AND DIMENSION REQUIREMENTS. I ALSO ACKNOWLEDGE MY DUTY TO CONFIRM PRODUCT AND INSTALLATION COMPLIANCE WITH ALL APPLICABLE FEDERAL, STATE AND LOCAL REGULATIONS AND STANDARDS.
UNITS REQUIRING APPROVAL DRAWINGS OR MODIFIED ARE NON-RETURNABLE
☐ As drawn ☐ As marked

Signed: _____ Date: _____

Printed Name: _____

LEAD TIME WILL START UPON RECEIPT OF SIGNED APPROVAL DRAWING

| FOR INTERNAL USE ONLY PROJECT SIGN OFF | |
|---|--|
| SALES | |
| ENG. | |
| FAB. | |
| POWER | |

| | | |
|----------------------|--|------------|
| DISTRIBUTOR'S NAME: | | P.O.# |
| VESTIL MANUFACTURING | | X |
| DRAWN BY: R. STOY | | W.O.# |
| DATE: 09/07/2012 | | X |
| REFERENCE: X | | SALES: X |
| QUOTED LEAD TIME: X | | FILE NAME: |
| QUOTE # X | | 23-007-450 |
| SCALE: 1:10 | | |