

# Instruction Manual

## Hanging Ceiling Light



If you have any questions , please contact us directly for a faster and better solution .

## A LETTER TO MY PRECIOUS CUSTOMER

Dear Customer,

Thanks for choosing this lamp! To save your time and effort, please try to light up the lamp before installation to ensure the sockets are working correctly. Thank you for your support!

- Customer Support Team

## ATTENTION

1. Please check each part before installation.
2. Please turn off the power supply in your home before hard-wiring it.
3. Please use this product in a dry environment.

## QUESTION & ANSWER

Q: After powering on, my lamp doesn't work. What should I do?

A: First, make sure your bulbs are working well. If your bulbs work, you need to check if the wires are connected incorrectly. If you can't find the reason, please contact us and we will try our best to solve it for you.

## INFORMATION AND PACKAGE

Specification		Package List	
Voltage	110- 120V	Lamp base	1
Bulb Socket	E12 Base	Wood-like iron pipe	5
Wattage	Max 40W x 5	Mounting canopy	2
Bulb Type	LED/Halogen/Incandescent	Curved iron	3
Certification	Bulb Socket(s) is UL Listed	Ceiling mounted panel	1
Warranty	2 Years	Instructions and accessory kit	1

## Installation steps as a **ceiling light**

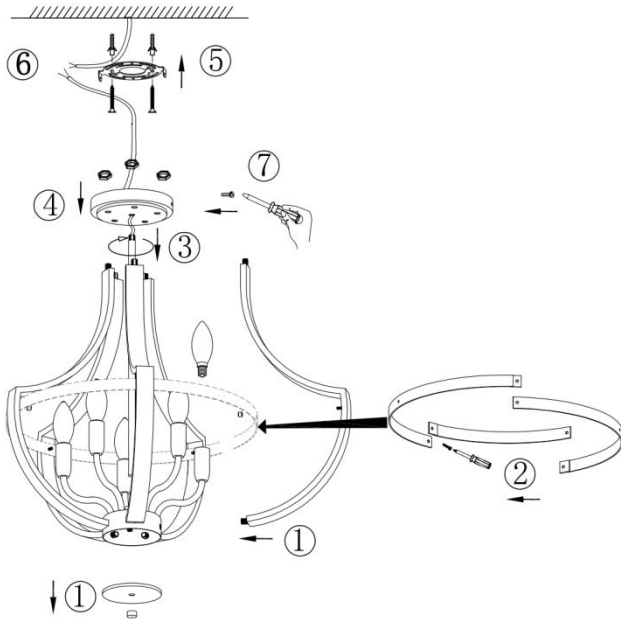

### Installation Steps:

1. First open the lid on the lamp base, then align the 5 wood-like iron pipes with the holes in the lamp base, lock them with nuts, and finally install the lid back in place.
2. 3 curved iron with screws installed in the inner side of the Wood-like iron pipe. (the first two flat iron installed at the interface will make the installation and simple)
- 3. Twist the round tube clockwise on the lamp base.**
4. Press down the iron pipes and round tube against the hole in the mounting canopy and torque it down with the nut.
5. Use the screws to mount the bracket on the junction box. (If you don't have a junction box, you can drill two holes in the wall and put in two expansion pellets, and finally fix the bracket with self-tapping screws)
6. Use the orange terminal cap to connect the "L" wire to the "Fire" wire and the "N" wire to the "Zero" wire. The "ground" wire can be connected to the home ground or wrapped around the green screw.
7. Align the mounting canopy with the holes on the side of the bracket and tighten with the matching screws.

## Installation steps as a **pendant light**

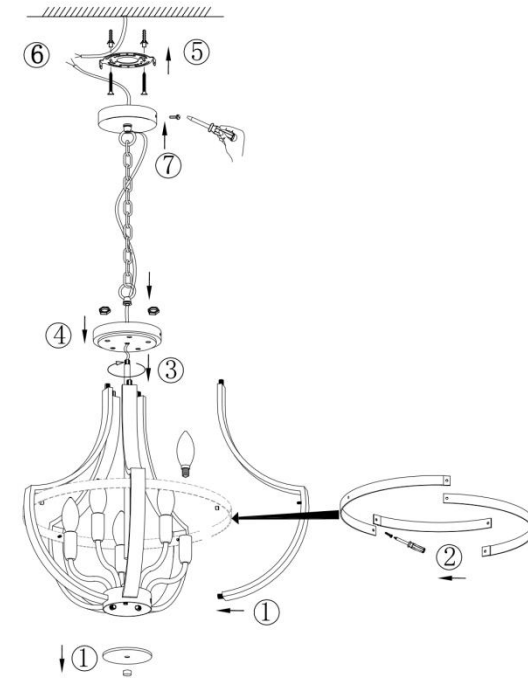

### Installation Steps:

1. First open the lid on the lamp base, then align the 5 wood-like iron pipes with the holes in the lamp base, lock them with nuts, and finally install the lid back in place.
2. 3 curved iron with screws installed in the inner side of the Wood-like iron pipe. (the first two flat iron installed at the interface will make the installation and simple)
- 3. Twist the round tube clockwise on the lamp base.**
4. Press down the iron pipes and round tube against the hole in the mounting canopy and torque it down with the nut, and the round tube is locked by the ring at one end of the chain.
5. Use the screws to mount the bracket on the junction box. (If you don't have a junction box, you can drill two holes in the wall and put in two expansion pellets, and finally fix the bracket with self-tapping screws)
6. Use the orange terminal cap to connect the "L" wire to the "Fire" wire and the "N" wire to the "Zero" wire. The "ground" wire can be connected to the home ground or wrapped around the green screw.
7. Align the mounting canopy with the holes on the side of the bracket and tighten with the matching screws.