

# Safety Information

Before starting installation of this fixture or removal of a previous fixture, please disconnect the power source to ensure safety.

Consult a qualified electrician if you have any electrical questions or need to replace the driver.

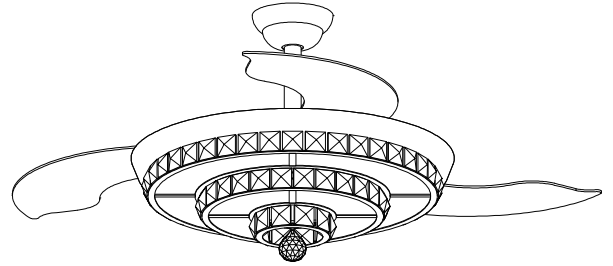

- ① Ceiling light is suitable for AC 110-120V(USA/CA) / 220V-240V(EU).
- ② Ceiling fan must be installed on a solid ceiling that can be able to withstand more than 30KG.
- ③ The crystal pendant is easily damaged and broken, please install carefully.

## Warranty

### WHAT IS COVERED

The manufacturer guarantees this fixture to be free from manufacture defects for a period of 1 Year from the date of purchase Warranty ONLY applies under normal use and to the original purchaser. The premise is that the product has not been damaged due to misuse, accident, modification, alteration, negligence or misoperation.

## Electrical Characteristics

Power	36W(Light)+58W(Motor)
Color	Satin Nickel
Input voltage	110-120V(USA/CA) / 220V-240V(EU)
Direction	One direction
Fan speed	3 speeds
Remote control	Yes

# Remote control instruction

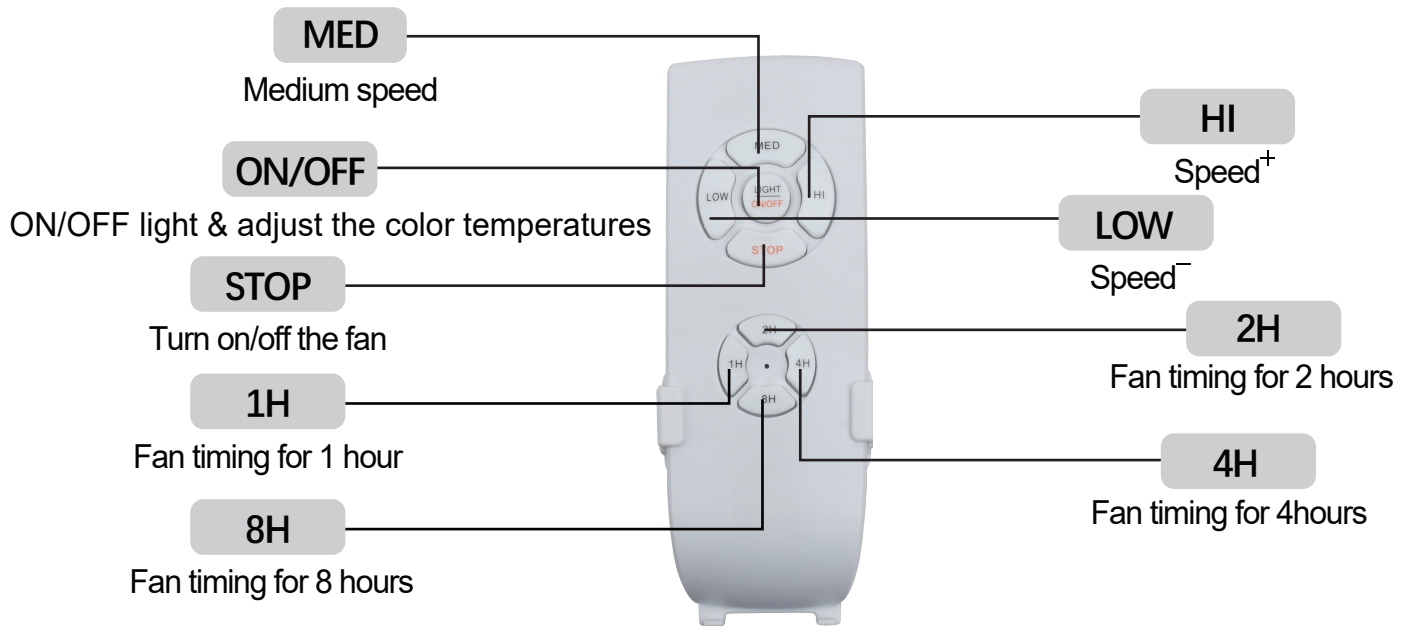

## Installation Steps

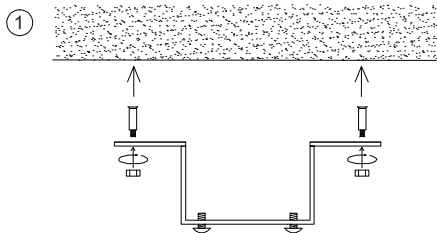

① Take out the ceiling box and fixing bracket, fix the hanger on the ceiling, and tighten the screws to ensure safety and firmness.

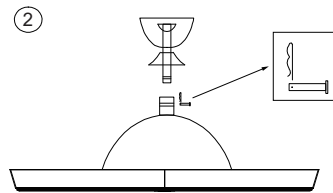

② First, Loosen the bolts on the head of the main engine. And then Put the bottom box and ceiling box into the boom. Finally, Pass the power cord through the boom, then connect the boom to the main engine, by inserting the fixing bolt, and finally tighten the fixing screws of the boom.

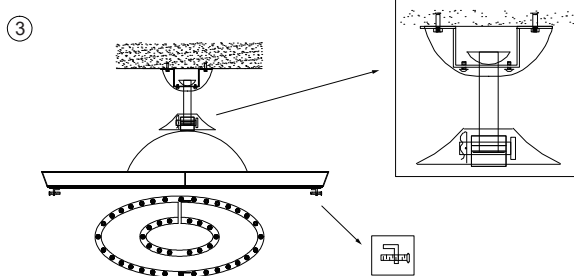

③ Hang the ball head at the top of the lamp body boom into the fixing bracket, connect the power cord, adjust the balance of the lamp body, and then clip the ceiling box to the fixing screw at the bottom of the fixing bracket, and tighten the screw of the sucker.

Take out the fixed screws, install the light source driver to the bottom of the fan, and connect the power supply.

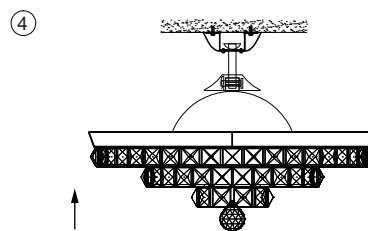

④ Put the crystal lampshade on the bottom panel of the fan and lock it with screws ,The installation is complete.

If you have any questions about the installation, please contact us