

FREESTANDING BATHTUB

Installation, Use and Care Manual

Product category	Freestanding soaking bathtub
Recommended installation	Qualified installer or licensed plumber where required
Application	Indoor residential bathroom use, unless product specifications state otherwise
Before first use	Complete leveling, drainage test, perimeter sealing and curing inspection

Use with product-specific data

This manual provides a complete generic workflow. Add the actual specification sheet, dimensions, finish, included accessory list, seller support details and marketplace terms for the exact product before publication.

1 Manual Structure & Safety Basics

No.	Section	Page
1	Manual Structure & Safety Basics	2
2	Tools, Materials & Parts Check	3
3	Site Preparation and Measurement Record	4
4	Pre-installation Inspection	5
5	Installation Procedure	6-7
6	Final Test, Use and Care	8
7	Troubleshooting and Service Record	9

Read before beginning

- Read the full manual and product specification sheet before unpacking, drilling, plumbing or sealing the bathtub.
- Use at least two people to move the bathtub. Do not lift or support the product by the rim, side wall, drain trim or overflow trim.
- Wear suitable eye protection, gloves and protective footwear. Keep the finished surface protected throughout installation.
- Installation must comply with local plumbing, building and waterproofing requirements. Use licensed trades where required.
- Complete leak testing before sealing the bathtub to the floor and before the bathroom is returned to normal use.

Professional recommendation

Incorrect rough-in work, unstable support or unsealed drainage connections can cause leakage, property damage or product movement. Have the installation reviewed by a qualified professional when the site condition is uncertain.

Topic	Action
Safe handling	Two-person lift; keep the product supported from the body, not the trim.
Surface protection	Use clean cardboard, foam sheet, blanket or other soft protective material.
Water test	Test drain and overflow before final setting and again after installation.
Curing time	Allow sealant to cure fully before filling the bathtub for normal use.

2 Tools, Materials & Parts Check



Suggested materials

Protective floor covering	Soft blanket, foam pad, cardboard sheet or clean dust sheet.
Sealant	Neutral-cure silicone sealant compatible with tub material and flooring.
Plumbing supplies	Approved drain, trap, connector and adapter components for the site.
Joint compound / plumber putty	Use only when suitable for the drain material and local code.
Cleaning supplies	Mild soap, warm water, soft cloth or sponge.
Optional construction adhesive	Use only if specifically allowed by the product and site instructions.

Generic parts verification



Part / item	What to confirm
Bathtub body	Inspect the shell, rim, base and visible surface for cracks, chips, deformation or shipping damage.
Drain assembly	Pop-up drain, gasket and waste outlet components may be pre-installed or supplied separately.
Overflow assembly	Check the overflow opening, cover and connection if applicable to the model.
Flexible waste connector	Used to connect the bathtub drain to the floor drain or trap system when permitted.
Leveling feet / support points	Adjust and lock these so the tub weight is supported by the base, not the rim or skirt.
Documents	Keep order details, specification sheet, packing list and installation photos for support records.

Accessory note

Actual parts vary by model and supplier. Do not discard packaging until all parts have been checked and the product has passed inspection.

3 Site Preparation and Measurement Record

Prepare the bathroom area before final installation. Confirm that the drain location, floor condition and faucet clearance match the specific product dimensions.

Finished floor	Flat, clean, dry and fully cured. Repair loose tiles, uneven substrate or moisture issues before setting the tub.
Drain rough-in	Drain center should match the product waste outlet location and must allow a secure, serviceable connection.
Waterproofing	Complete required subfloor and surrounding waterproofing before the bathtub is placed permanently.
Faucet clearance	Confirm spout reach, handle movement and user clearance before drilling or fixing any faucet.
Load support	Verify the floor can support the combined load of product, water and user.
Access planning	Plan enough room for positioning, plumbing inspection and future maintenance where possible.

Measurement record

Field	Value
Overall length	_____
Overall width	_____
Overall height	_____
Drain center from side wall	_____
Drain center from rear wall	_____
Faucet reach confirmed	Yes / No
Floor level checked	Yes / No
Waterproofing completed	Yes / No

Dry-fit checkpoint

Place the bathtub in the intended location without sealant. Lightly mark the outline and drain center, then move the tub away to complete plumbing access.

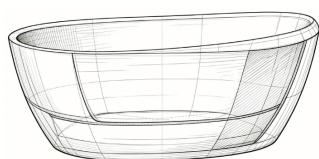

Reference product image for positioning

4 Pre-installation Inspection

Complete these checks before permanent connection or sealant application. Record photos of the product, packaging and accessory set when possible.

Check item	Acceptance condition
Surface condition	No visible cracks, chips, sharp deformation, heavy scratches or stress marks.
Accessory completeness	All required fittings, drain components, supports and documents are present.
Drain and overflow	Pre-installed components are seated and not visibly loose. Gaskets are correctly positioned.
Support system	Feet or support frame can be adjusted and locked. Each support point can contact the floor.
Dry fit stability	The bathtub stands level and stable at the planned location before sealant is applied.
Installer readiness	The installer has reviewed the sequence, local code requirements and rough-in measurements.

Do not proceed if damaged

If shipping damage, missing parts or unsafe installation conditions are found, stop installation and contact the seller or marketplace support channel. Do not drill, seal, modify or use the product until the issue is resolved.

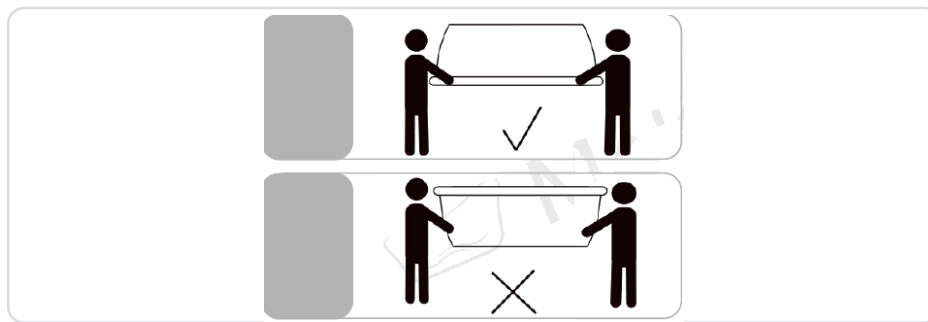

Keep the product upside down only on a clean, soft and stable protective surface. Never place the finished surface directly on abrasive flooring.

5 Installation Procedure

The sequence below is written for a common freestanding bathtub with drain, overflow and flexible waste connector. Adapt details to the actual product specification and local plumbing code.

01 Protect the surface and pre-test drainage

Place the bathtub on protected supports so the underside can be accessed safely. Close the pop-up drain, fill water above the overflow level, and check the drain, overflow and waste outlet for leakage before permanent placement.

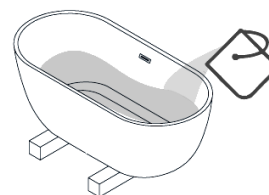

02 Mark the footprint and drain center

Set the bathtub at the intended location. Trace the outside outline with removable tape or pencil and mark the drain center so the plumbing connection can be completed accurately.

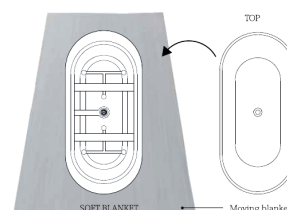

03 Adjust the base support points

Turn the bathtub upside down on a soft sheet. Use a level to adjust the base feet or support frame until each support point is even and can carry the load securely.

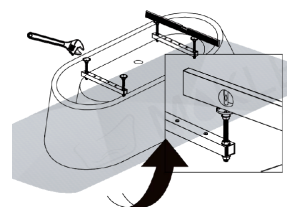

04 Confirm level after setting upright

Place the bathtub upright in the final area and check level along the top rim. Re-adjust support feet if needed and lock the adjustments before connection.

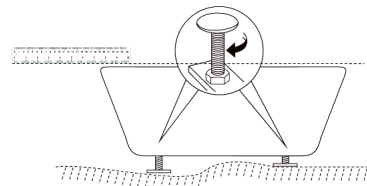

Support rule

The bathtub weight must be supported by the designed base or support points. The rim, side wall and decorative skirt should not carry the load.

5 Installation Procedure - Continued

05 Connect the drain system

Connect the flexible waste connector or approved drain adapter to the floor drain or trap assembly. Keep the connector fully seated, properly sealed and free from kinks or sharp bends.

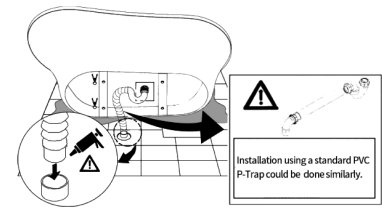

06 Run the final leak test and seal the base

After connection, run water through the drain and inspect all visible joints. Once no leakage is found, apply a neat bead of compatible silicone along the underside edge of the bathtub.

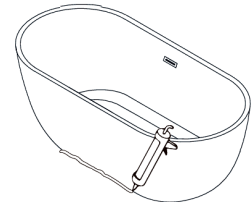

07 Allow sealant to cure

Keep the bathtub dry and undisturbed until the sealant is fully cured. A minimum 24-hour wait is commonly required, but follow the sealant label for the exact curing time.

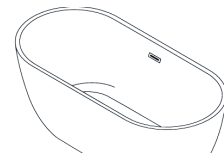

Completion criteria

Installation is complete only after the bathtub is level, stable, drains freely, shows no leaks, and the sealant has cured.

6 Final Test, Use and Care

Before first use

- Allow all sealants and adhesives to cure fully before filling the bathtub for normal use.
- Fill the bathtub and check drain, overflow and floor connections for leaks.
- Open and close the drain several times to confirm smooth operation.
- Clean the surface with mild soap, warm water and a soft cloth to remove installation dust.

Routine cleaning	Use mild soap, warm water and a soft cloth or sponge. Rinse and dry after cleaning.
Do not use	Abrasive pads, scouring powder, strong disinfectants, ammonia-based cleaner, aerosol solvent or harsh chemical drain cleaner on the bathtub surface.
Gloss maintenance	Use only a non-abrasive polish compatible with the tub material. Test in a hidden area first.
Stain prevention	Rinse away bath oil, colored soap, hair dye, mineral residue and metal marks promptly.
Periodic check	Inspect sealant, leveling stability, drain movement and signs of moisture every few months.
Repair guidance	For deep scratches, cracks, loose fittings or repeated leakage, stop use and consult a qualified technician.

User safety

Use caution when entering or leaving the bathtub. Keep the floor dry and do not use the product as a step, storage platform or lifting support.

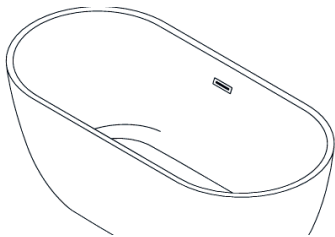

Allow curing time before normal use



24h

7 Troubleshooting and Service Record

Issue	General corrective action
Water near base	Stop use, dry the area, then inspect drain, overflow, connector and sealant line. Reconnect or reseal as required.
Slow drainage	Check for construction debris, clogged trap, kinked connector or misaligned drain connection.
Tub rocks or shifts	Confirm floor flatness and that each support point touches the floor and is locked.
Surface becomes dull	Clean with mild soap and use only non-abrasive material-compatible polish if needed.
Pop-up drain will not seal	Remove debris, check gasket seating and verify the pop-up mechanism moves freely.
Sealant separates	Remove failed sealant completely, clean and dry both surfaces, apply compatible silicone and allow full cure.

Service record

Order number	_____
Purchase date	_____
Marketplace / seller	_____
Product size / SKU	_____
Installer / company	_____
Installation date	_____
Photos retained	Before / During / After installation
Notes	_____

Support preparation

For support requests, provide order details, clear photos of the product, packaging, installation area, drain connection and the issue. Keep packaging until inspection and installation are complete.

This manual is a neutral installation and care document. It does not include brand-specific warranty promises, proprietary service procedures or restricted contact information. Seller terms and legal obligations should be provided separately when required.