

Parts

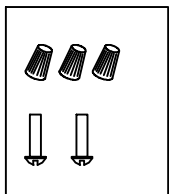

Steps 1

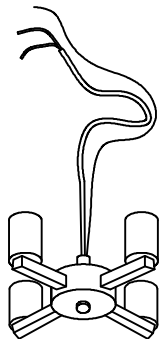
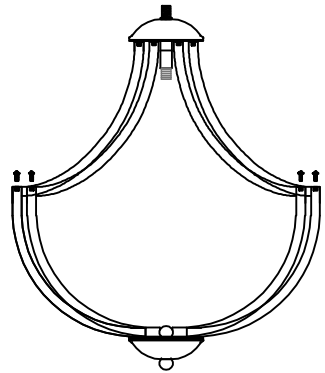
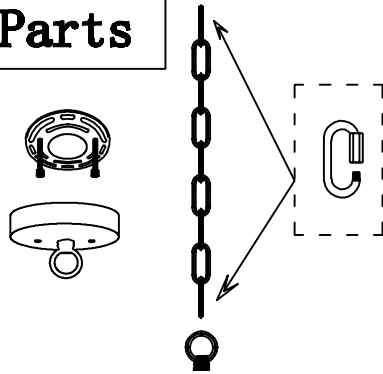
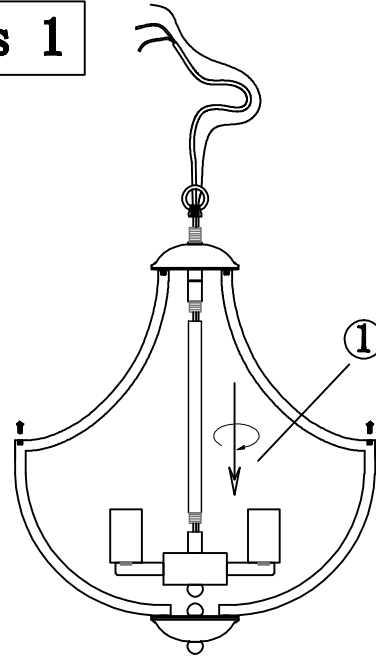

1. As shown in the picture, pass the main wire through the tube, lamp body and top loop respectively, and assemble them together.

Steps 2

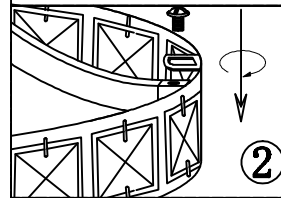
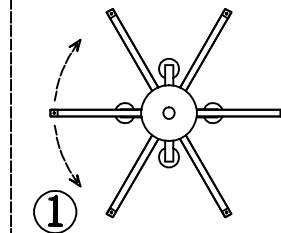
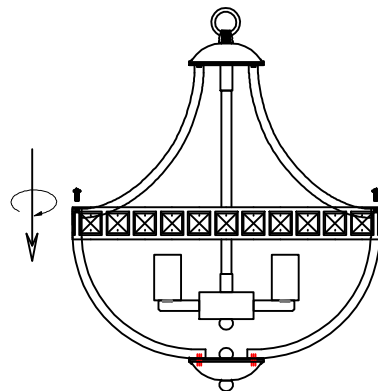

1. Adjust the positions of the 6 lamp arms as shown in the picture.
 2. As shown in the picture, first remove the screws of the frame, and then assemble it with the crystal ring.

Steps 3

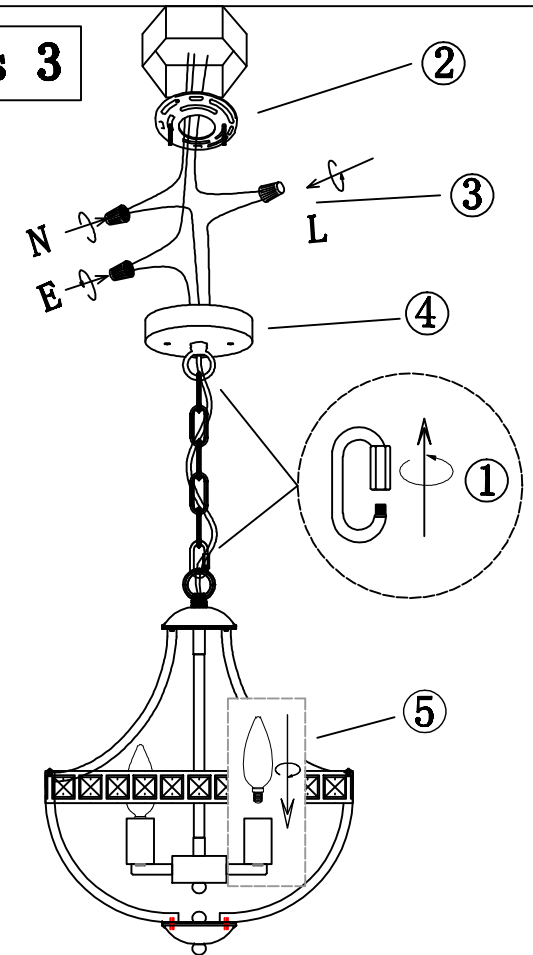

1. Pass the main line through the chain and ceiling junction box, loosen the safety buckle as shown in the figure, link the chain with the lamp body and tighten the safety buckle.
 2. Assembled the mounting bracket to the ceiling junction box with the screw.
 3. Connect the power cord out from the ceiling junction box to lamp wires with the lead wire and wire nut, according to the color to connect. (U.S. - black for "L", white for "N", copper wire for "Ground E")
 4. Assemble the canopy to the mounting bracket with the screw.
 5. Install the bulb. Bulbs need to be purchased separately.