



Pine Wood Barn Door without Frame

All-in-1 Installation Manual



SAFETY PRECAUTIONS

!CAUTION!

- Power tools can cause serious damage if not professionally used. Safety gear must be worn before installation to prevent unexpected injuries.
- Pick an area free of hazardous condition before you start on the project. Please use tools and power tools responsibly any loss of control and accident deaths may occur due to abuse of tools.
- Big objects required in this project are needed to be carefully and responsibly moved. Be sure to wear safety gloves and shoes to prevent any serious injury.
- Be extremely careful to not put any parts of your body against a moving part of the hardware. This may cause bruising, punctures, and other results of injuries when for example when fingers are caught in the closing area of the doors.
- Precautions should be taken when opening or closing the door(s). Handles should be used when attempting to slide the door(s). Always keep you and children aware and safe from any unexpected situations.
- Any extreme uncontrolled pressure opening or closing the door(s) can damage the hardware gradually. Use handle(s) to open and close the door(s) with care at all times.

HARDWARE INCLUDED

Please check your quantity of hardware before installation.
Different size of door comes with different quantity of hardware.

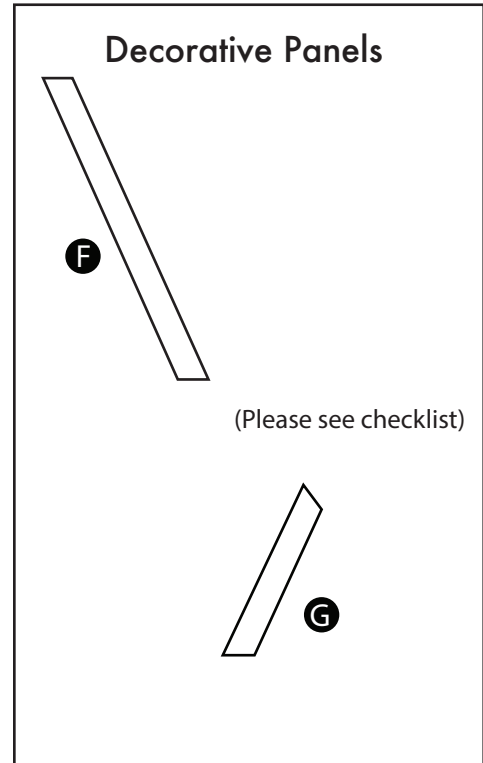
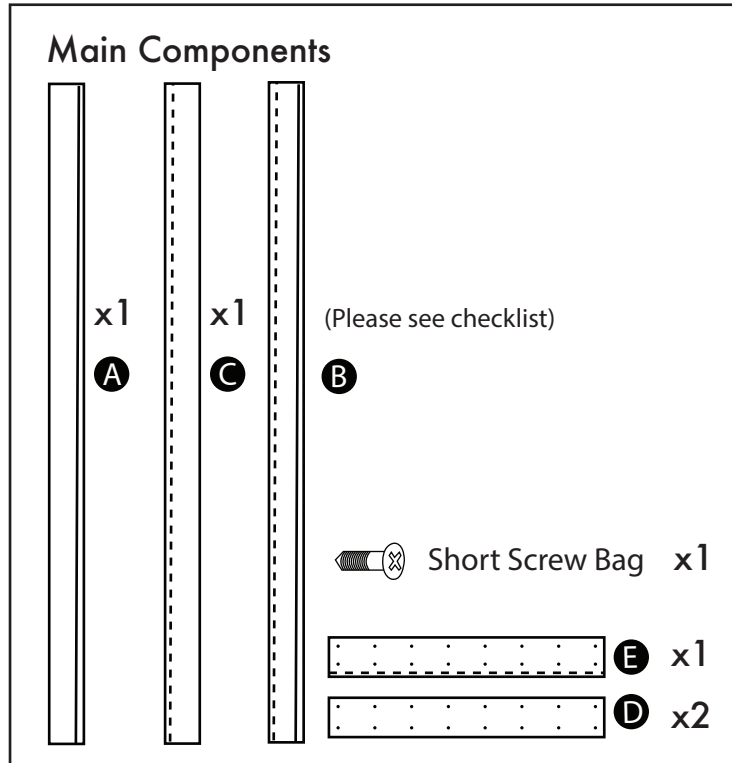

Panels and Hardware you need for different design doors.

Door Design	B	F	G
30" Classic	3	0	0
36" Classic	4	0	0
42" Classic	5	0	0
30" Single X	3	1	2
36" Single X	4	1	2
42" Single X	5	1	2
30" Double X	3	2	4
36" Double X	4	2	4
42" Double X	5	2	4
30" Right Arrow	3	2	0
36" Right Arrow	4	2	0
42" Right Arrow	5	2	0
30" Left Arrow	3	2	0
36" Left Arrow	4	2	0
42" Left Arrow	5	2	0

The parts inside this box are prepared for double x design. If you are building doors other than this design you may receive extra parts that you may not need. Do not worry.

INSTRUCTION

STEP 1

Components Needed

Panel B quantity varies from the size of doors you have, please go to page 2 for the checklist.

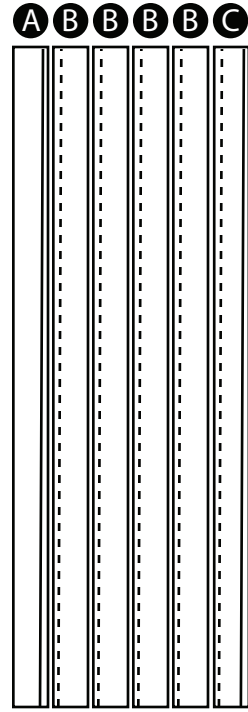

Bottom View

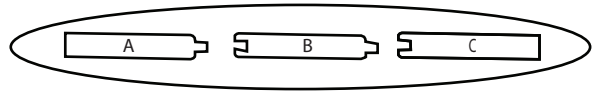

STEP 2

Components Needed

Short Screw

Short screw quantity varies from the size of doors you have, please follow the checklist below for this step.

Door Width	# of screws needed
30"	20
36"	24
42"	28

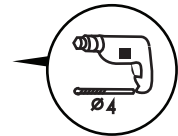
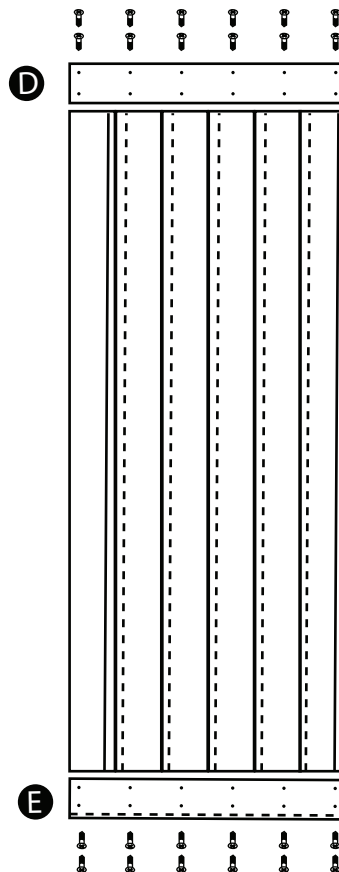

Install the screws following the predrilled holes on panel D & E.

Side View

Groove at bottom

STEP 3

Components Needed

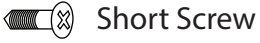
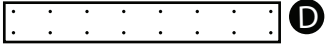

Short screw quantity varies from the size of doors you have, please follow the checklist below for this step.

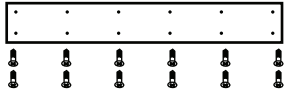

Install the screws following the predrilled holes on 2nd panel D. Making sure the top and the bottom spacing between each horizontal panels is equal before installing.

Door Width	# of screws needed
30"	10
36"	12
42"	14

NOTICE

If you are installing other than Classic Design please head to the next page to continue installation of panel **F** & **G** before you install STEP 3. Please find the correct design that you prefer before installation.

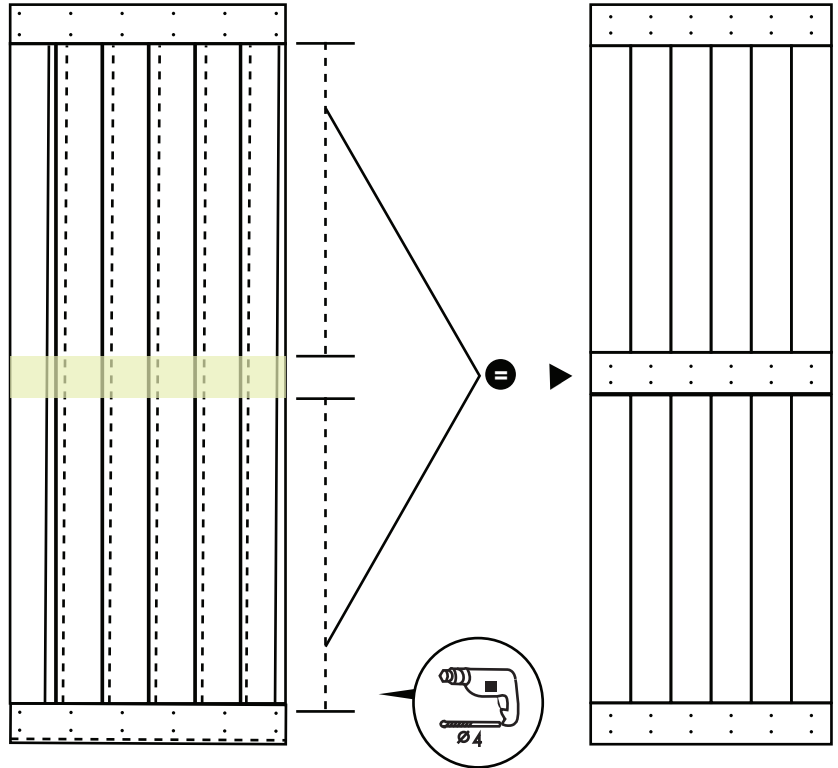

If you want a classic design your installation is complete!

NOTICE

But if you want to build other design besides classic please skip to the next page and finish up with STEP 3.

Single X Door Design

Install following the predrilled holes on panel F & G with the screws we offer.

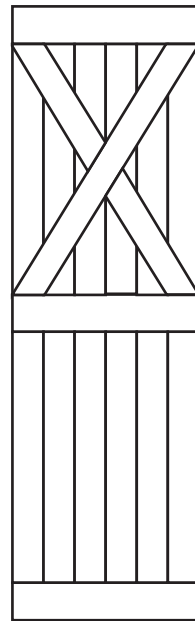
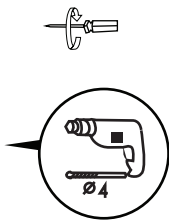
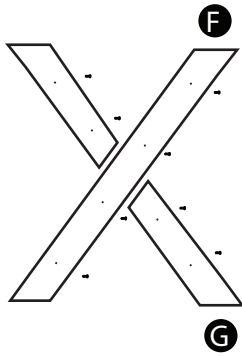
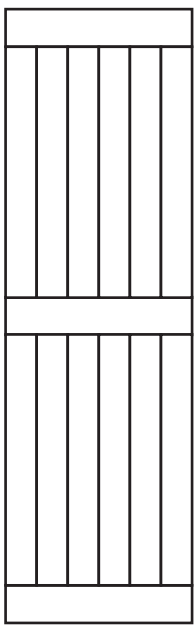

TOP

OR

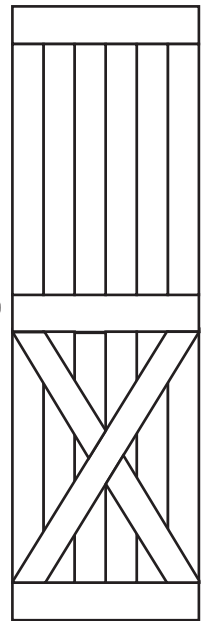

BOTTOM

Double X Door Design

Install following the predrilled holes on panel F & G with the screws we offer.

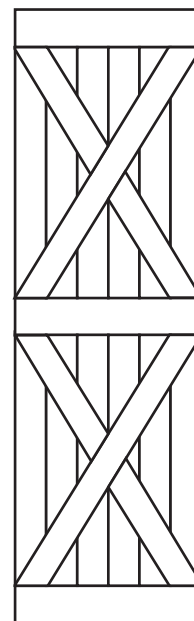
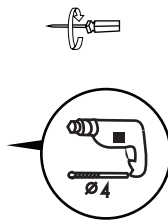
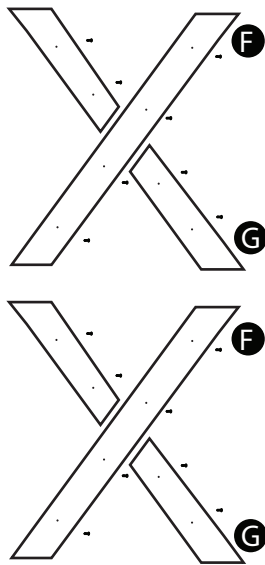
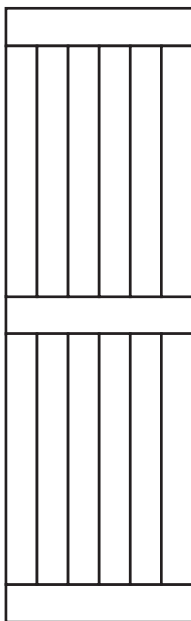

Left Arrow Door Design

Install following the predrilled holes on panel F & G with the screws we offer.

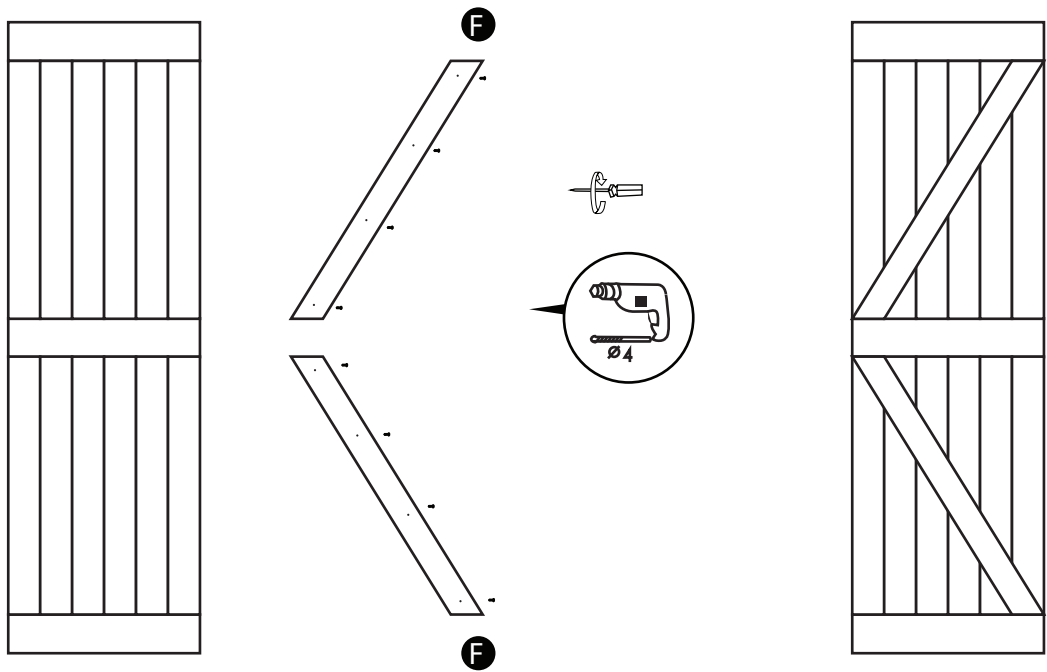

Right Arrow Door Design

Install following the predrilled holes on panel F & G with the screws we offer.

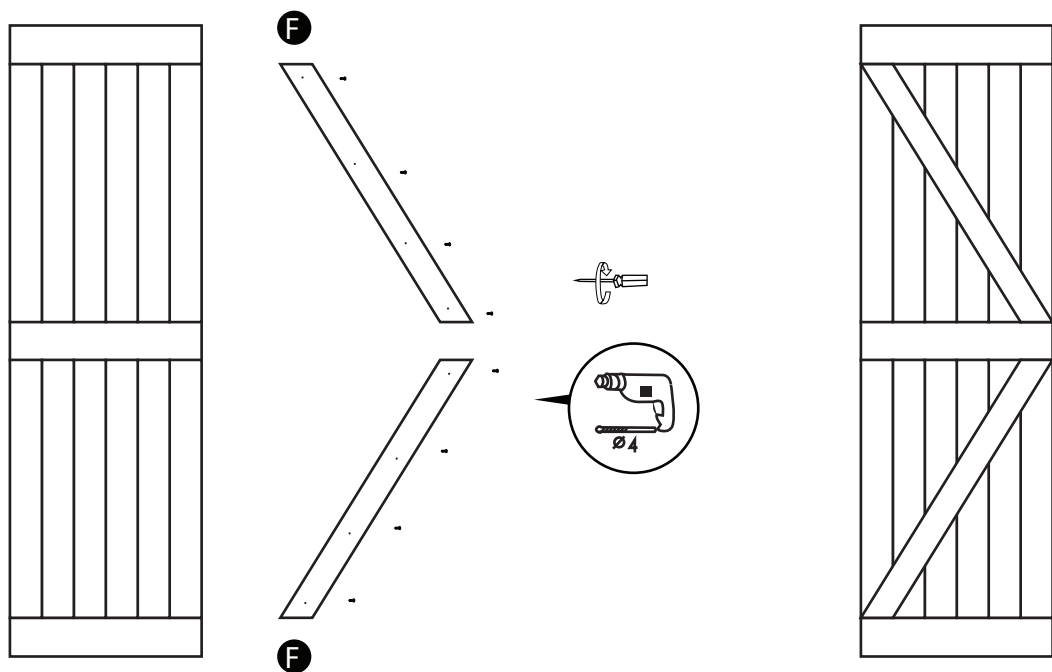

YOUR INSTALLATION IS COMPLETE!



SLIDING HARDWARE / BARN DOORS

High Quality • Exquisite Design • Outstanding Services

ABOUT US

At Homacer, our goal is to provide the finest sliding barn door hardware products and services for our valued customers. We keep polishing our products to make their quality better, prices lower and installation easier. We make it possible for you to get everything you need from us when you think about installing sliding barn doors.

CONTACT US

Office #: 1(770) 864-5437

Website: www.homacer.com

Email us: info@homacer.com

LOCATION

1885 Beaver Ridge Cir, Ste A
Norcross, GA 30071