

# Installation Instruction

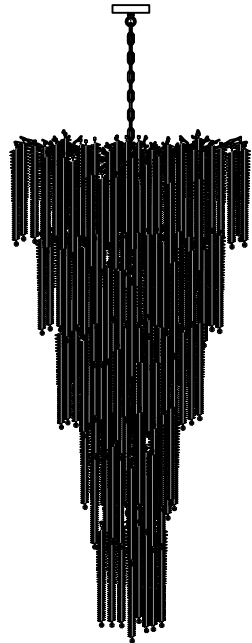

packaging diagram.

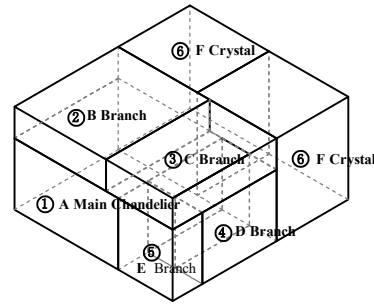

## Before Installation

- ★ Please carefully read all the
- ★ Keep the manual for future reference.
- ★ Separate and list all parts and hardware
- ★ Read each step carefully and follow the correct installation sequence.
- ★ To avoid losing accessories during assembly, we recommend that you do not move the fixture until you have completed the assembly work and always place the product on a flat, firm, stable surface.
- ★ Keep all small parts and packaging materials of this product away from infants and children as they can cause serious injury.

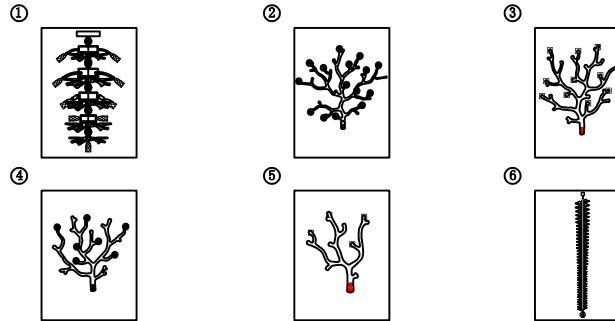

Packing List:

- |               |              |
|---------------|--------------|
| 1 A Main Body | 4 D Branch   |
| 2 B Branch    | 5 E Branch   |
| 3 C Branch    | 6 F Crystals |

## Chandelier Installation and Safety Standards

The installation of a chandelier is a crucial step in ensuring its safety. chandelier safety standards dictate the process of installation, including the tools and equipment that can be used, the methods of securing the chandelier, and the location of the chandelier

Securing the chandelier is a crucial step in the installation process. Chandelier safety standards dictate that the chandelier must be securely attached to a suitable support, such as a ceiling joist, to prevent it from falling. This includes ensuring that the support is strong enough to bear the weight of the chandelier, and that the chandelier is properly balanced to prevent it from tipping or swaying

Furthermore, the chandelier must be secured using suitable hardware, such as screws or bolts, that are strong enough to bear its weight. The hardware must be properly installed and tightened to ensure that the chandelier is securely attached. Regular inspections of the hardware are also necessary to detect and repair any damage or wear promptly.

## Accessory List

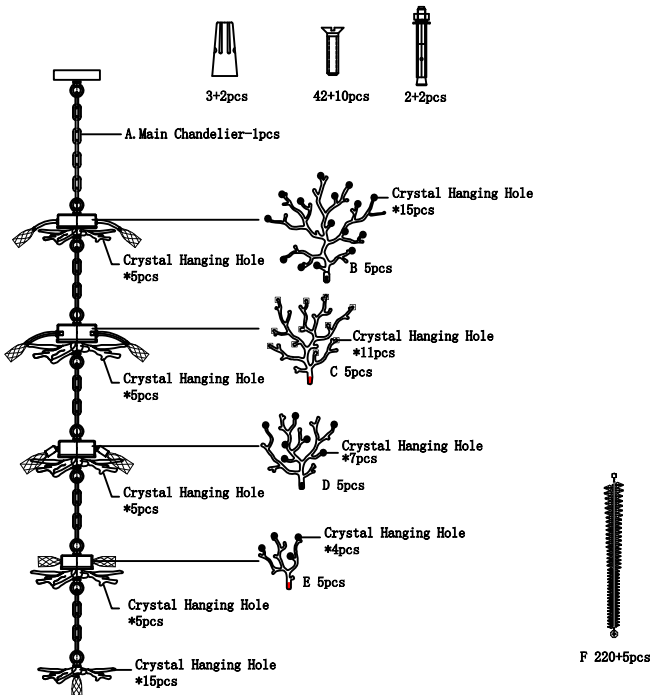

## ①Step:

- (1) Locate fixture body A from the list.
  - (2) Assemble fixture body A with branches (B, C, D, E) according to the diagram, aligning the holes and tightening the screws.
- (As shown in the diagram below)

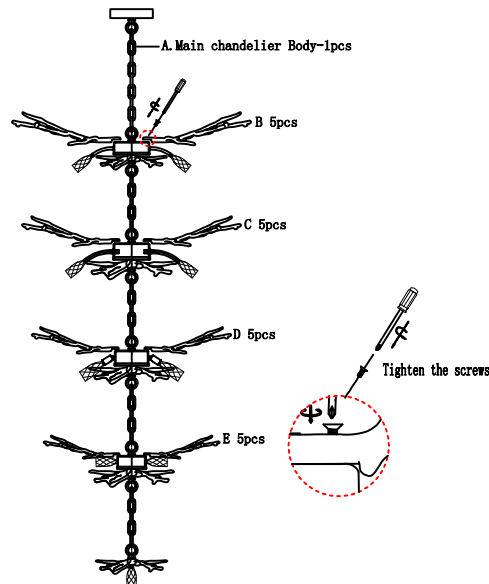

## ②Step:

- (1) Take out the mounting plate and attach it to the wall.
- (2) Connect the main power line to the fixtures main line, and secure the ceiling plate.
- (3) Properly connect the driver power wires.
- (4) Insert 28 G9 light sources into the lamp holder (not included in the product).
- (5) Hang the crystals (a total of 220 strings, of which 5 strings are spares and do not need to be hung). Installation completed.

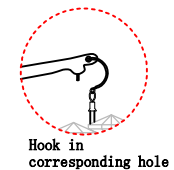
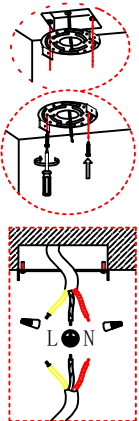
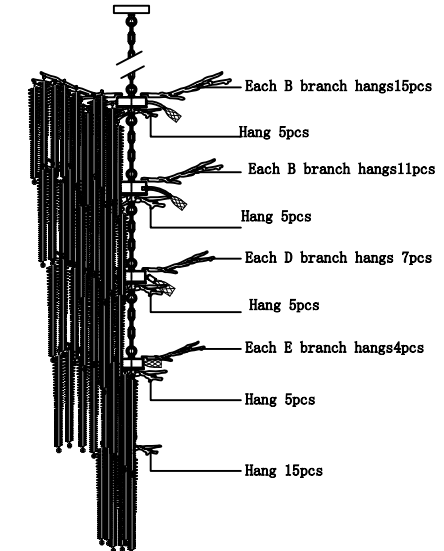

Hook in corresponding hole