

ASSEMBLY INSTRUCTIONS

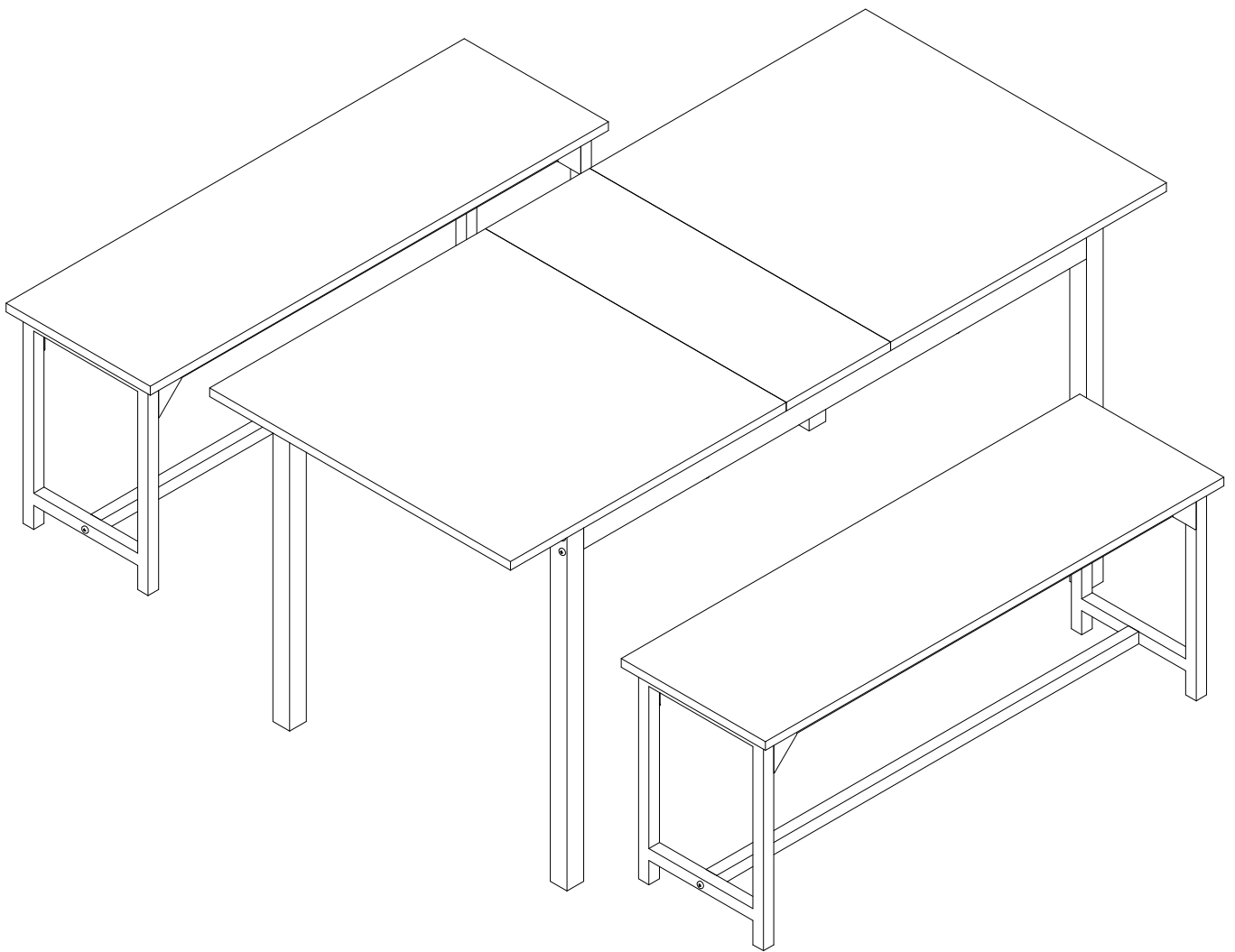

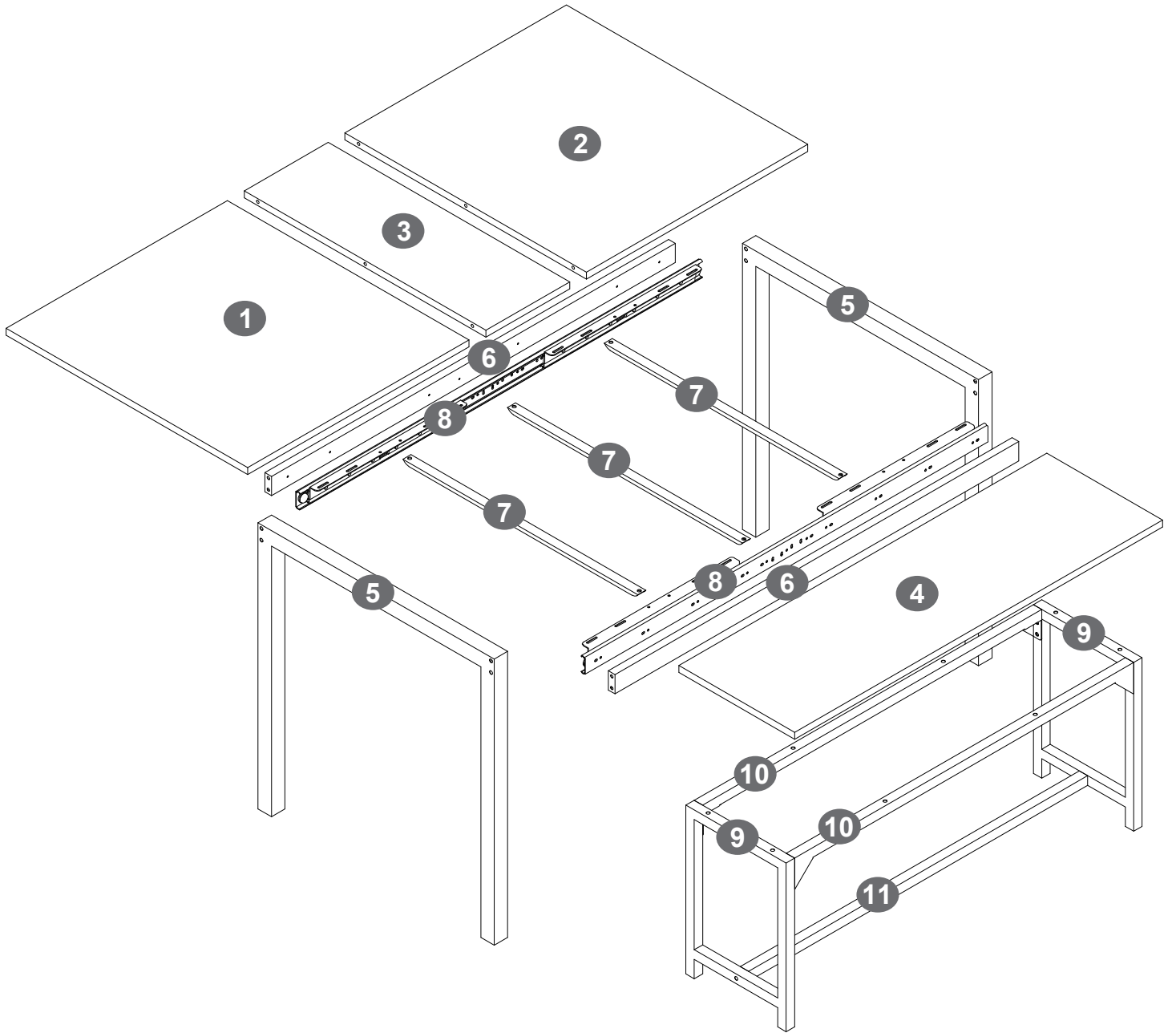

1

×1

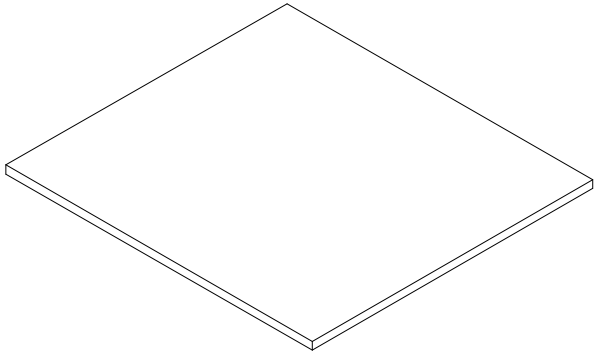

2

×1

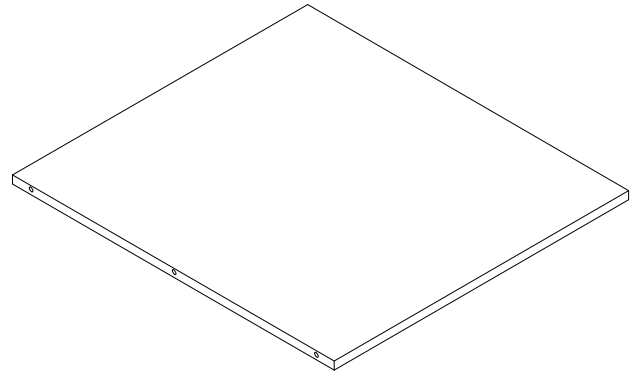

3

×1

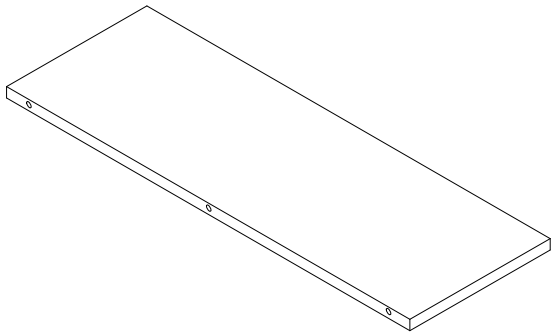

4

×2

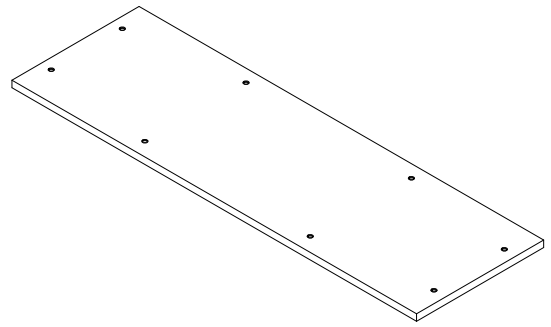

5

×2

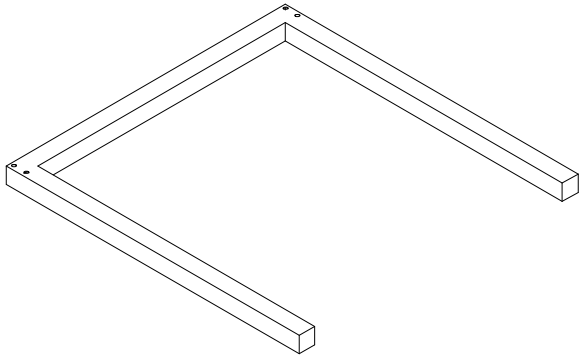

6

×2

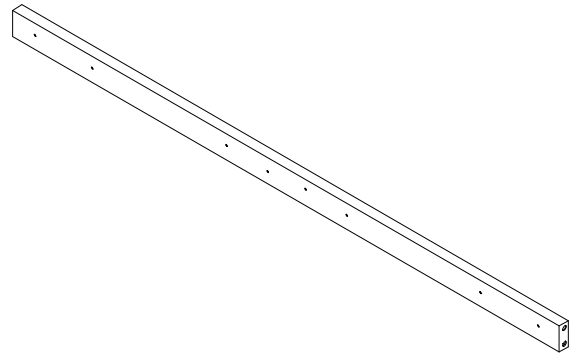

7

×3

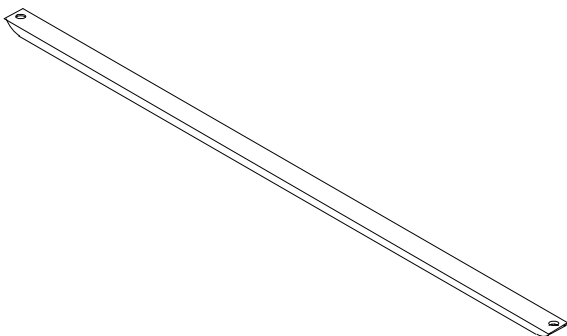

8

×2

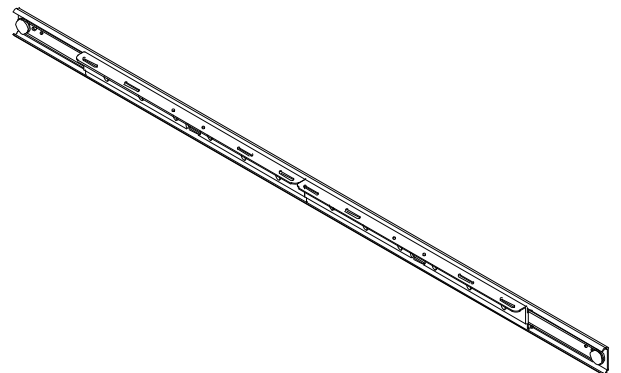

9

x 4

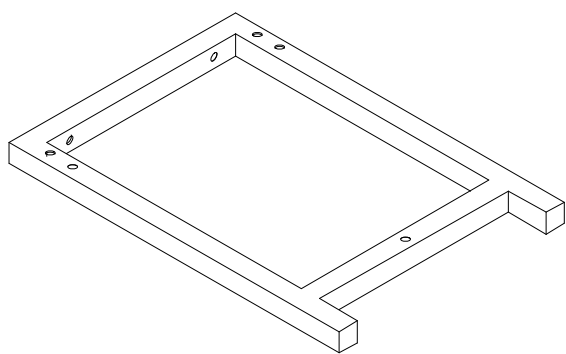

10

x 4

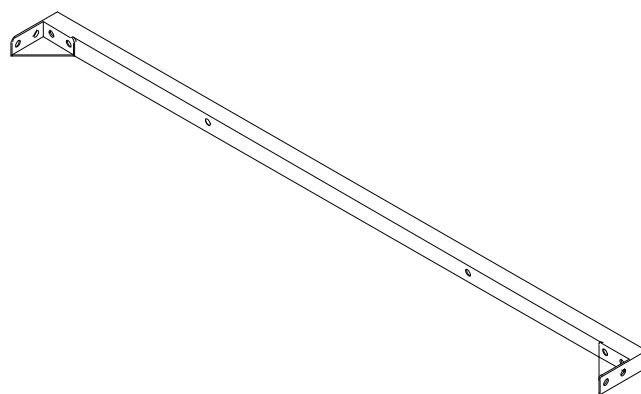

11

x 2

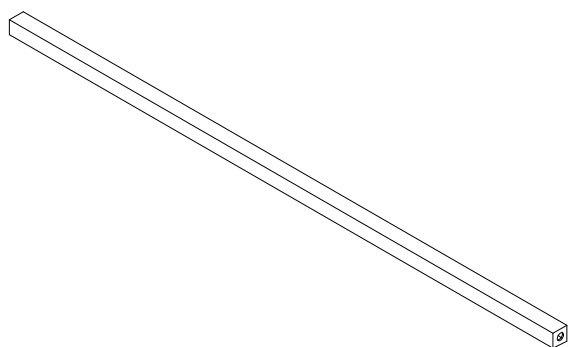

Hardware List

A

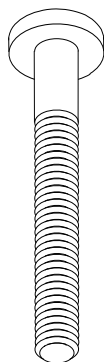

8+1
1/4x50mm

B

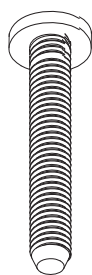

20+2
1/4x40mm

C

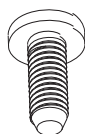

22+2
1/4x18mm

D

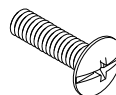

36+2
M5x18mm

E

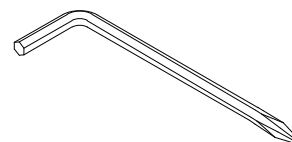

x1
M4

STEP 1

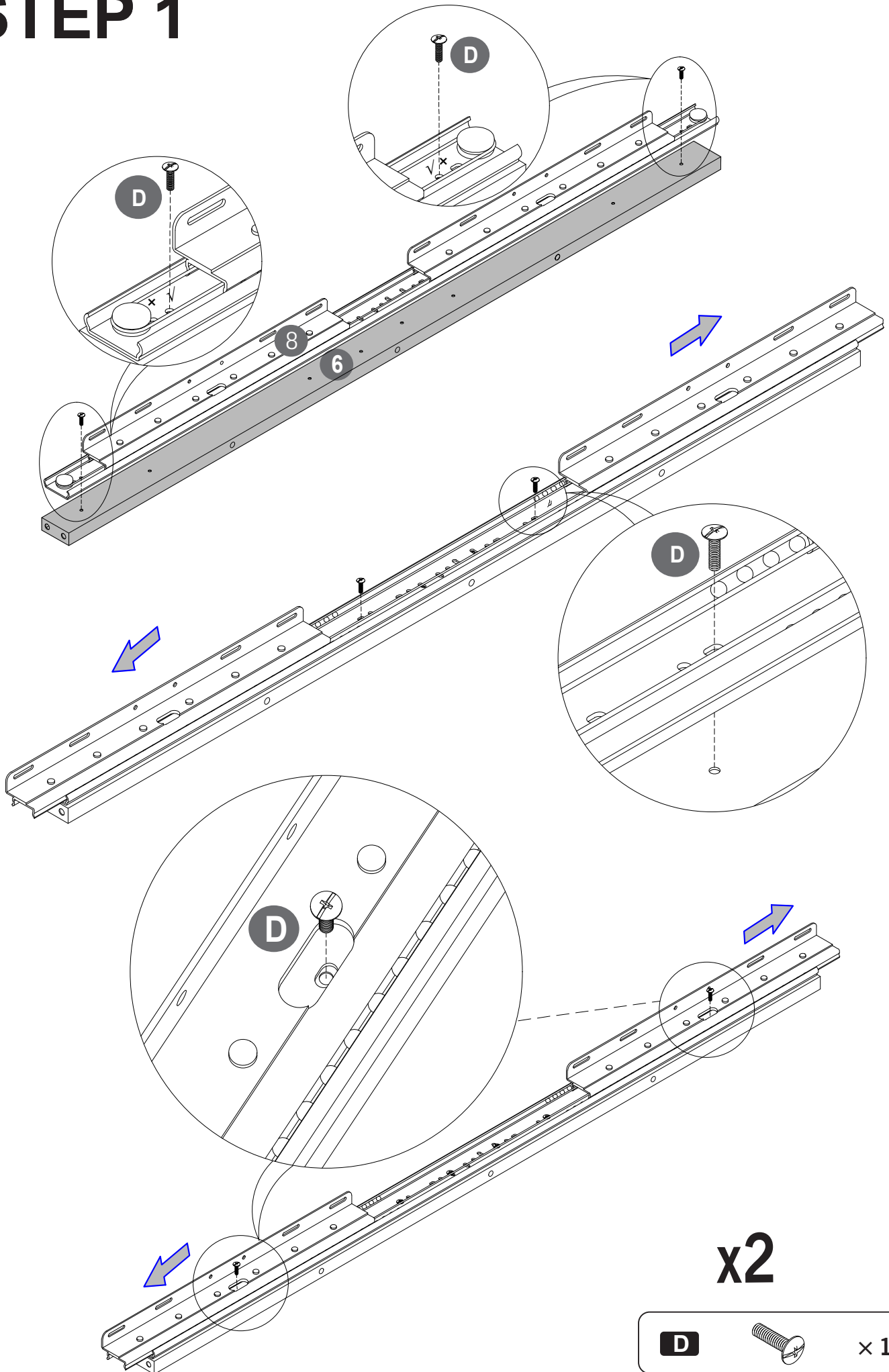

STEP 2

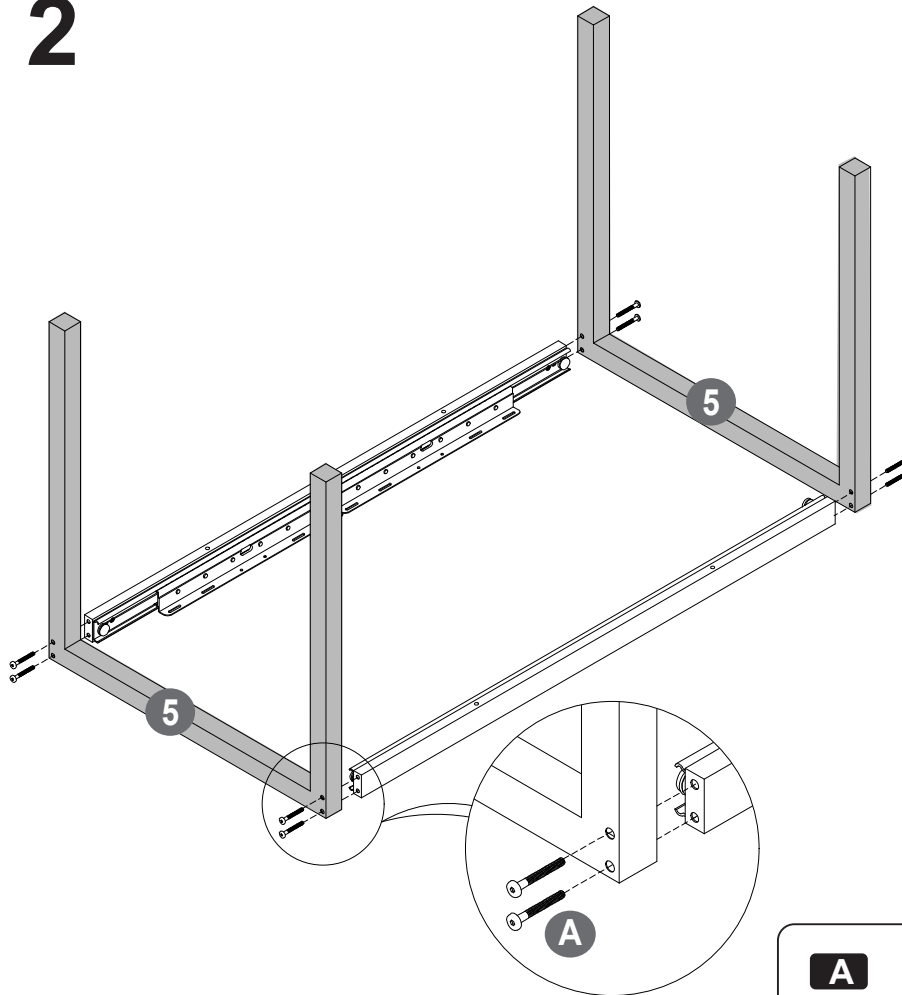

STEP 3

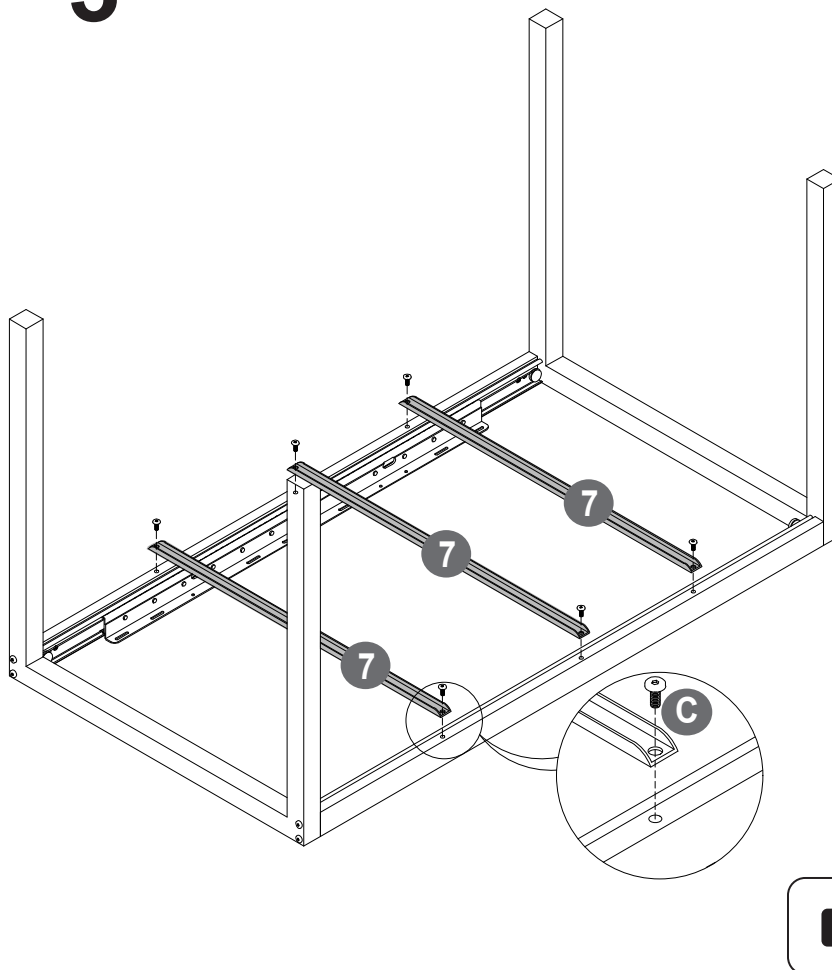

STEP 4

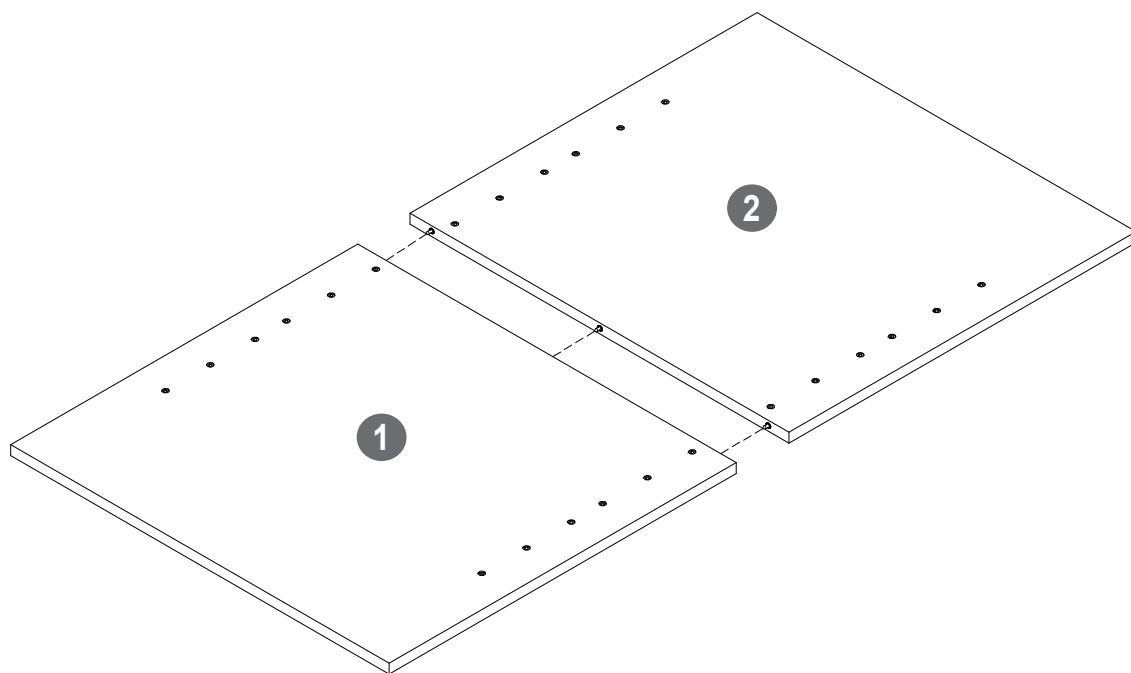

STEP 5

PATCH ALL THE SCREWS INTO POSITION THEN TIGHTEN THE SCREWS AGAIN

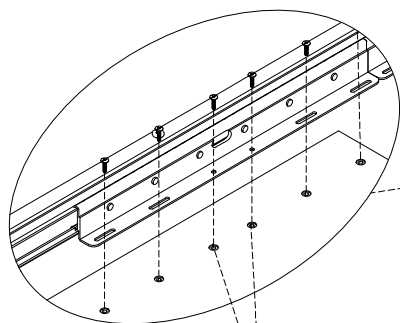

Tighten the locating screw first

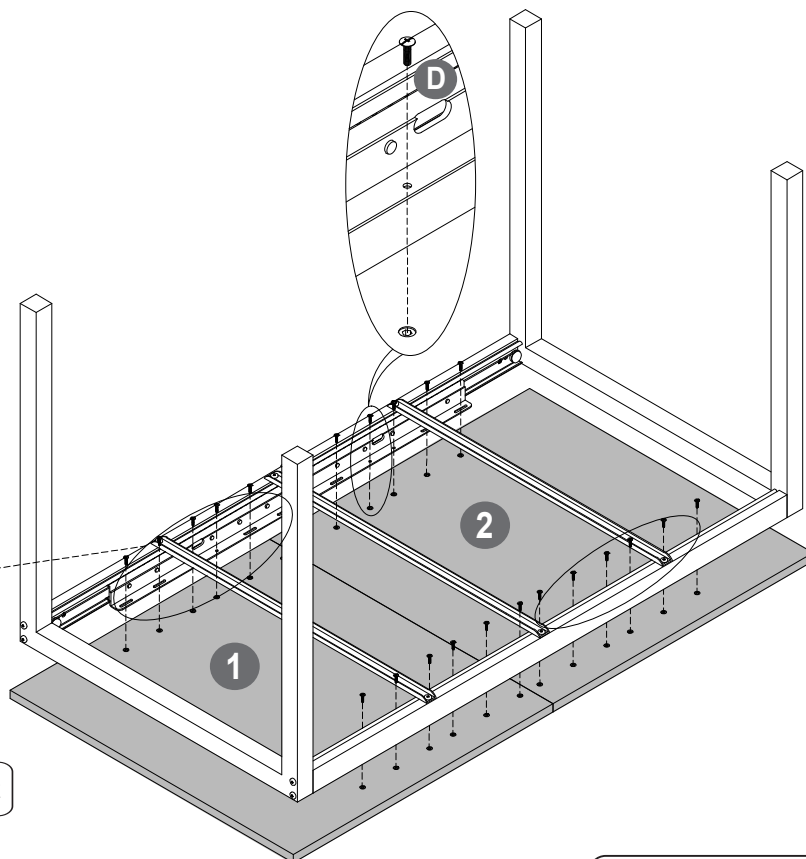

D



× 24

STEP 6

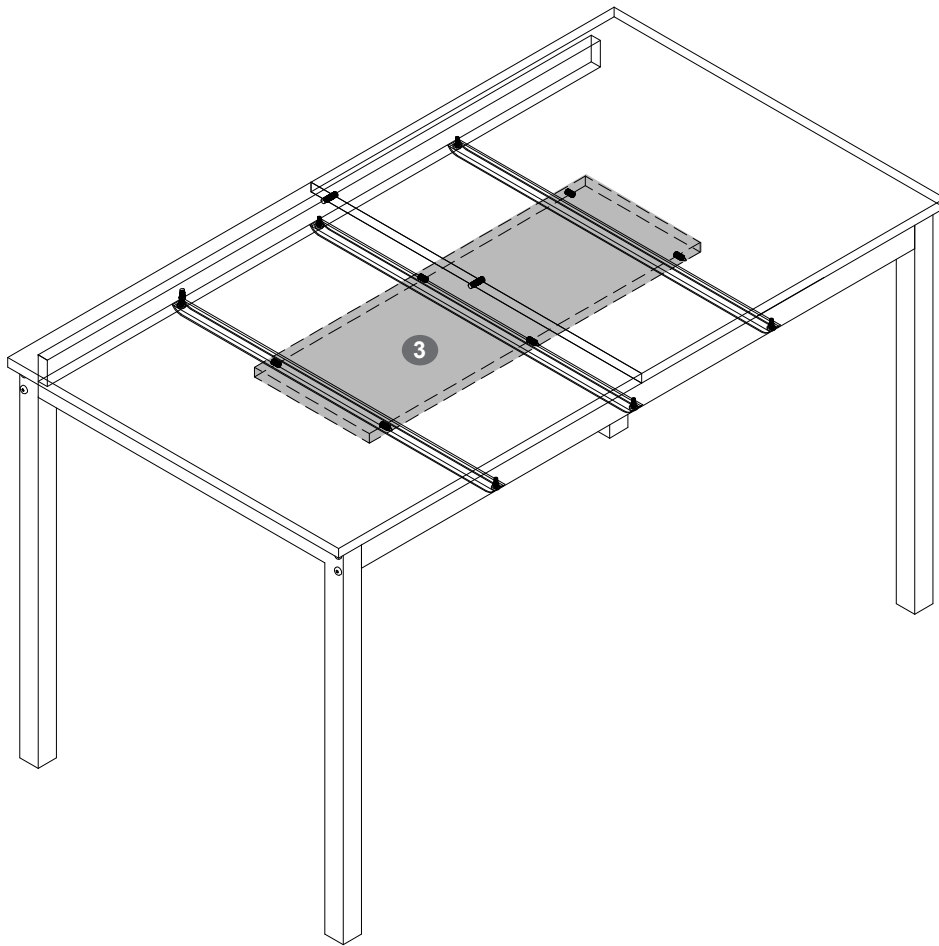

STEP 7

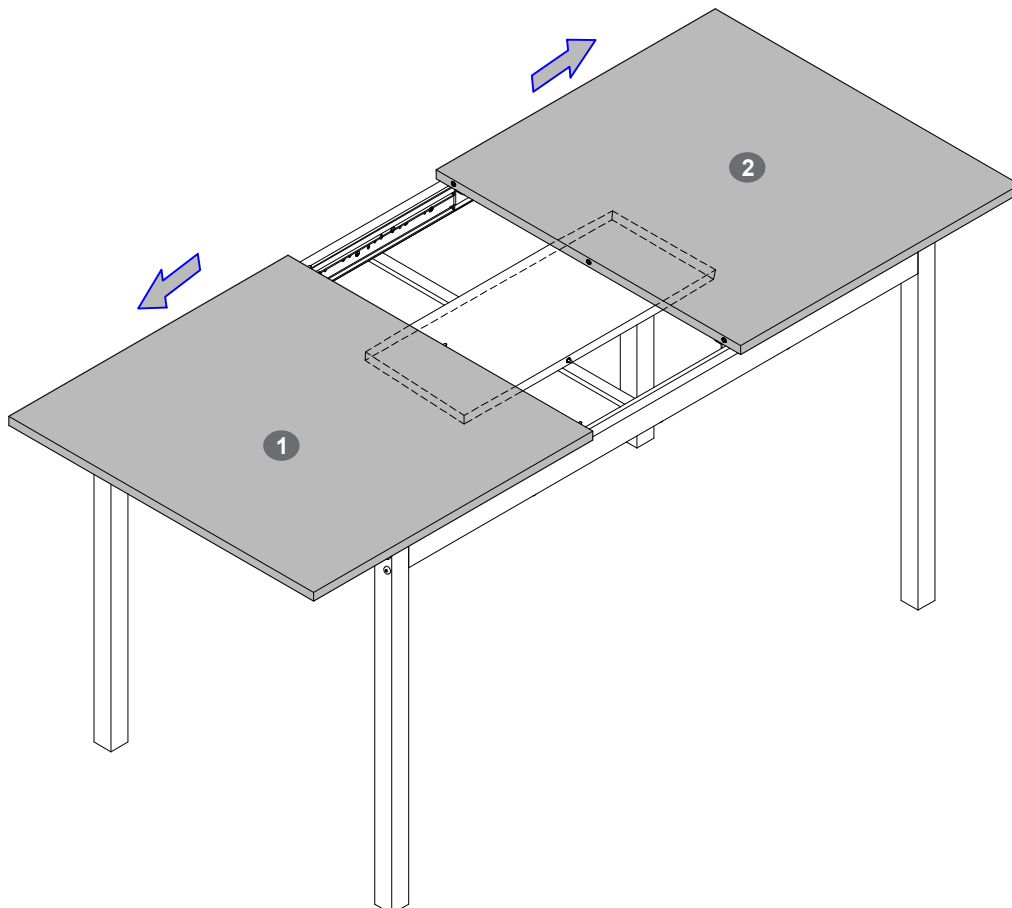

STEP 9

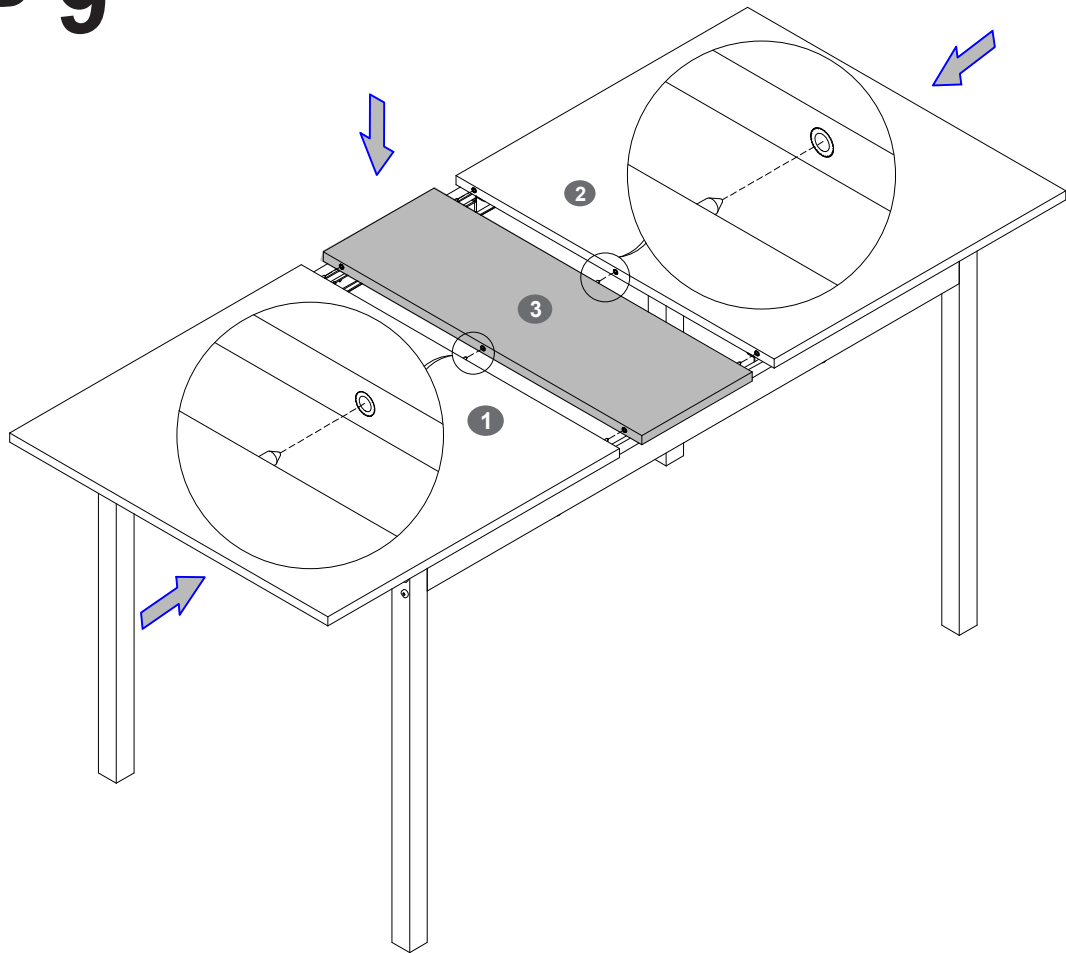

STEP 10

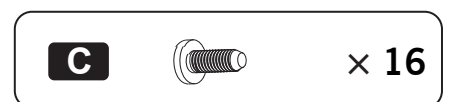
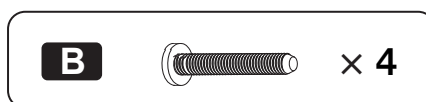
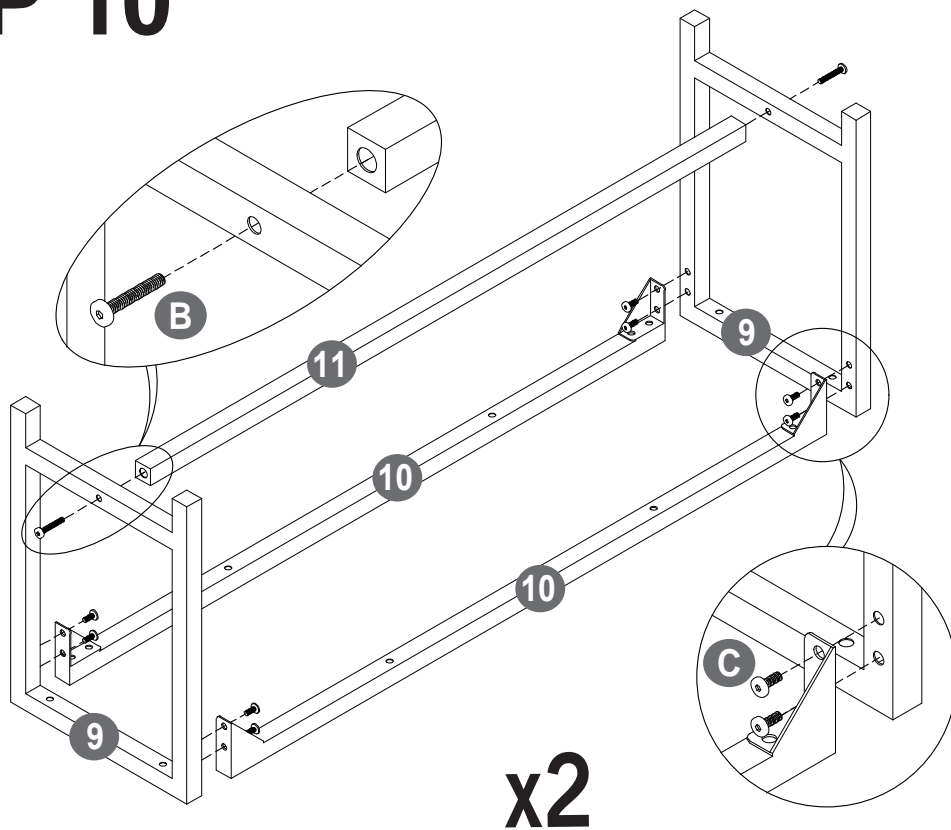

STEP 11

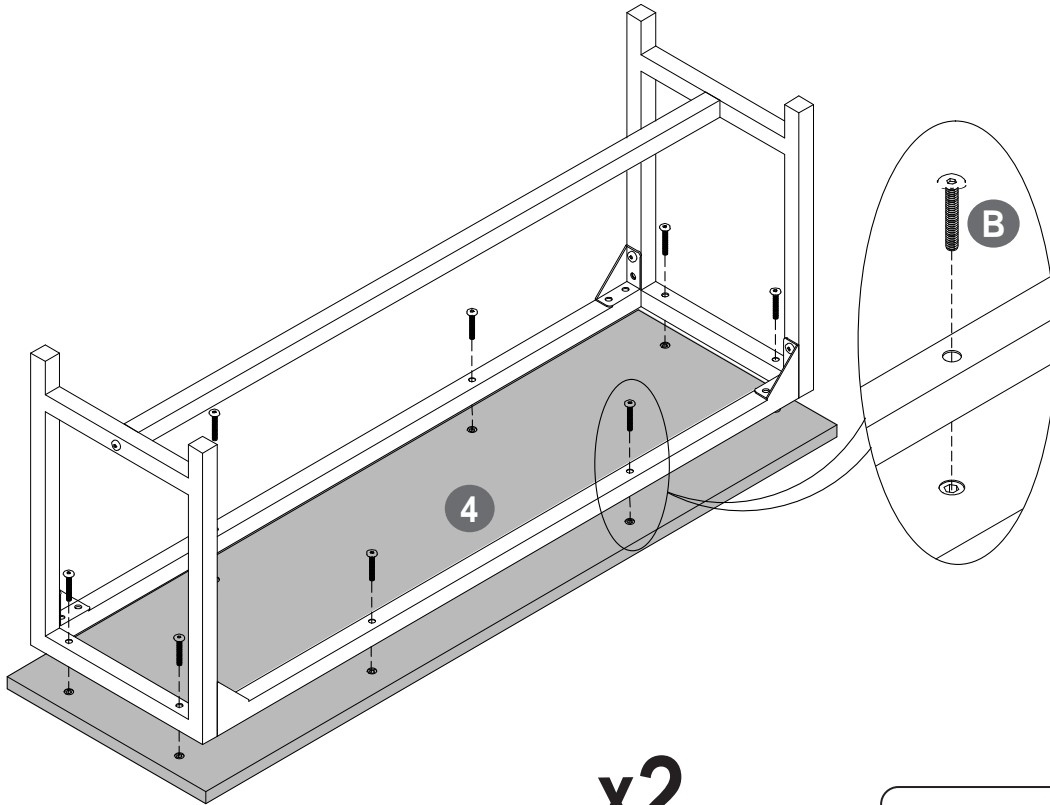

x2

