



**UBDT98**

## **Instruction Manual**

Thanks a lot your support and purchasing.

Please feel free to contact us if you have any questions with assembly or need replacement parts.

# Assembly Instruction

Decorate your home, Brighten wonderful life

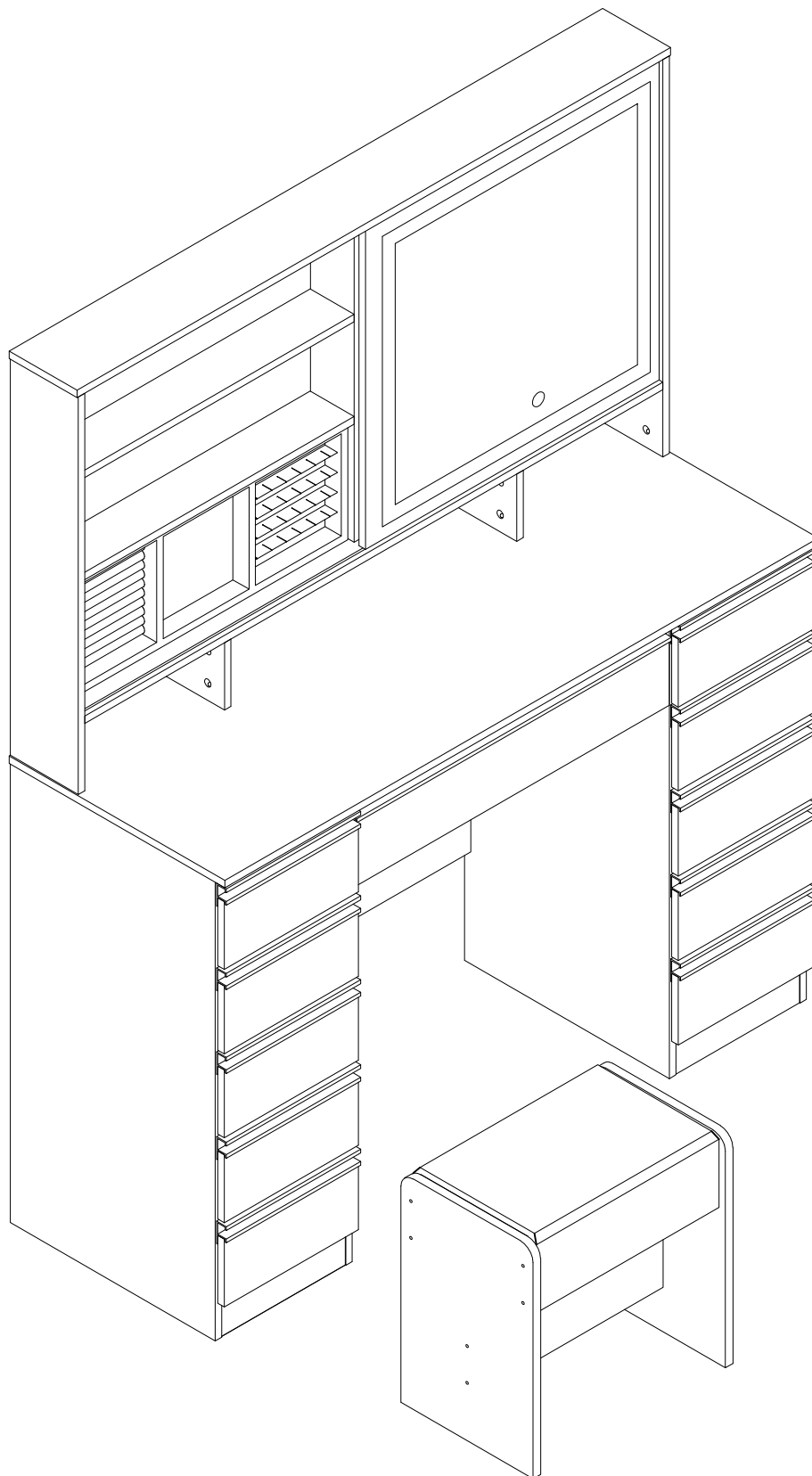

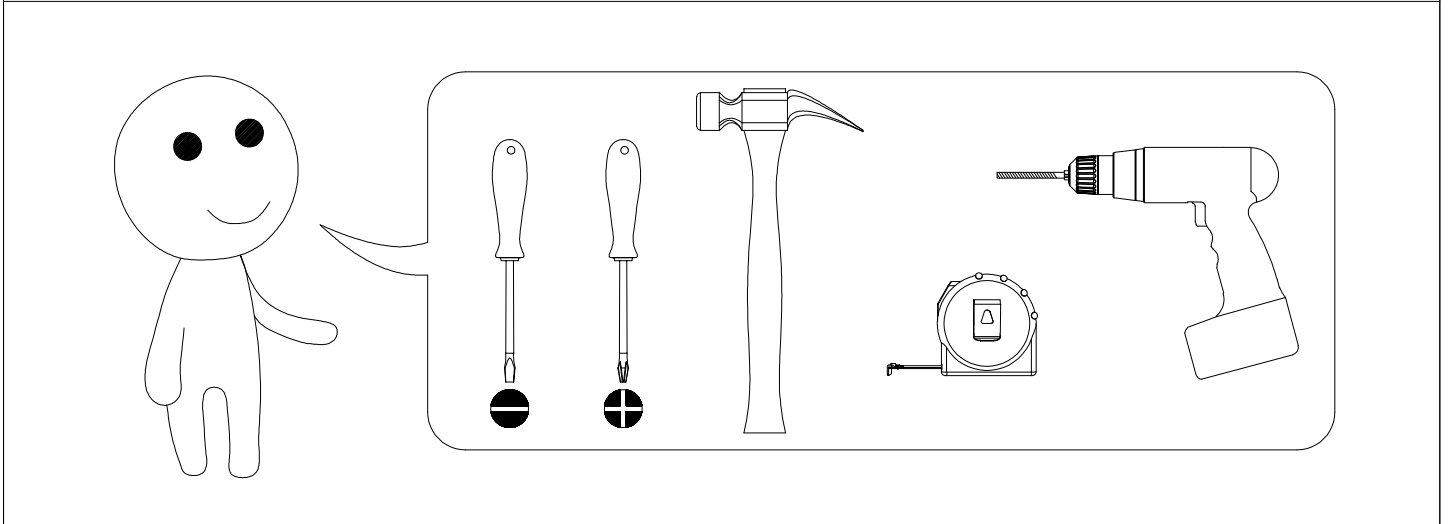
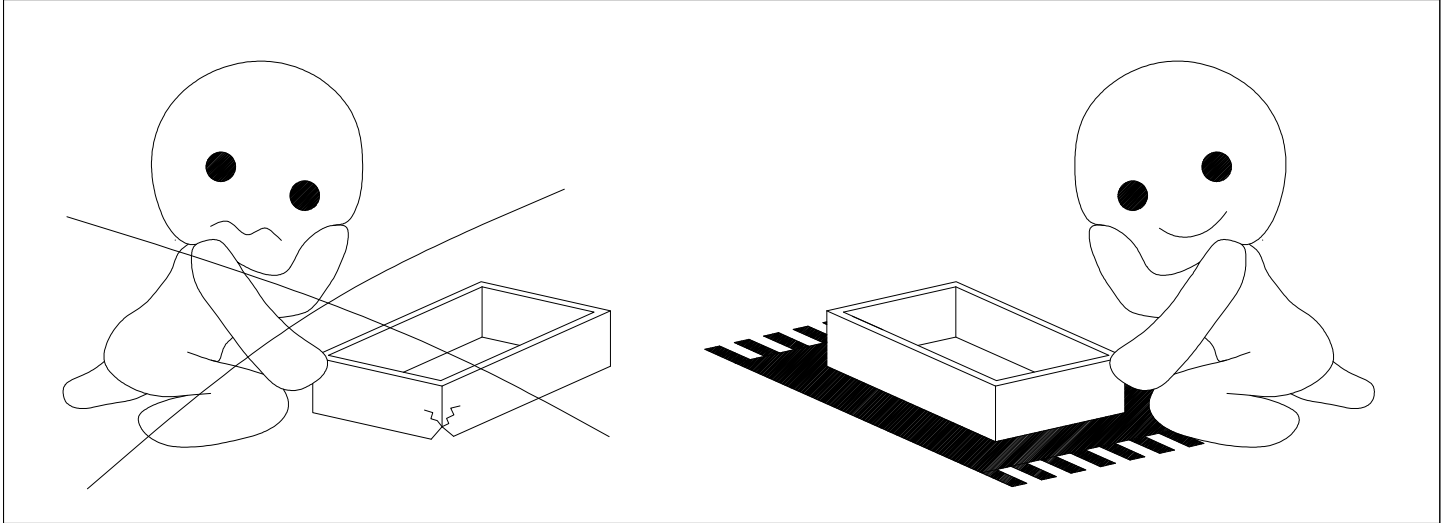
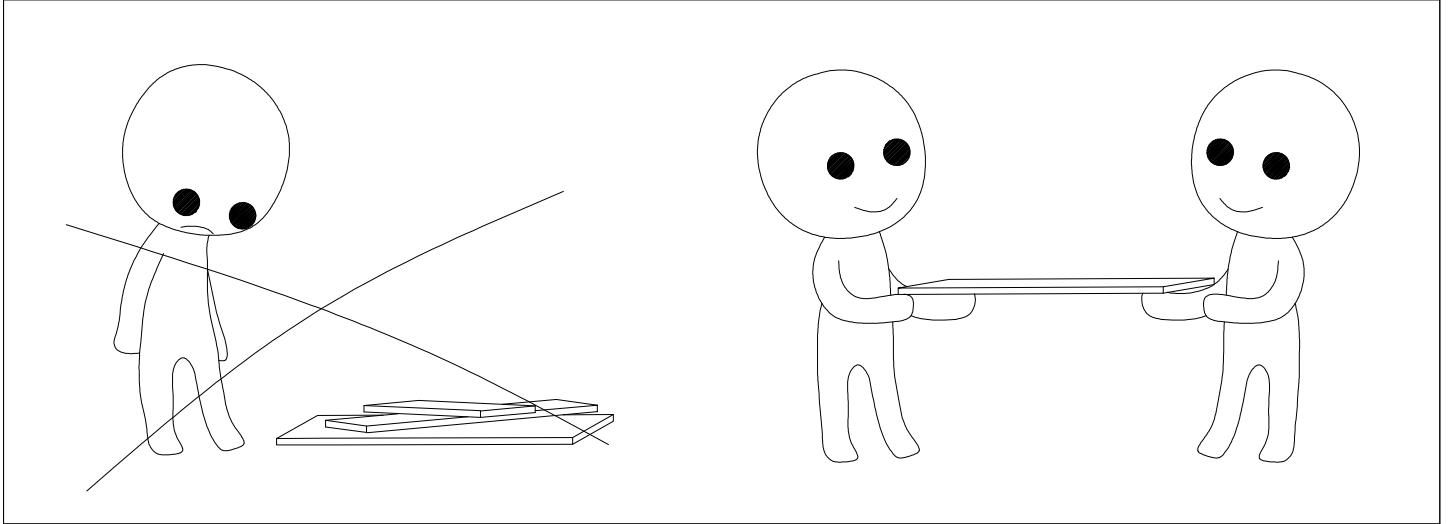
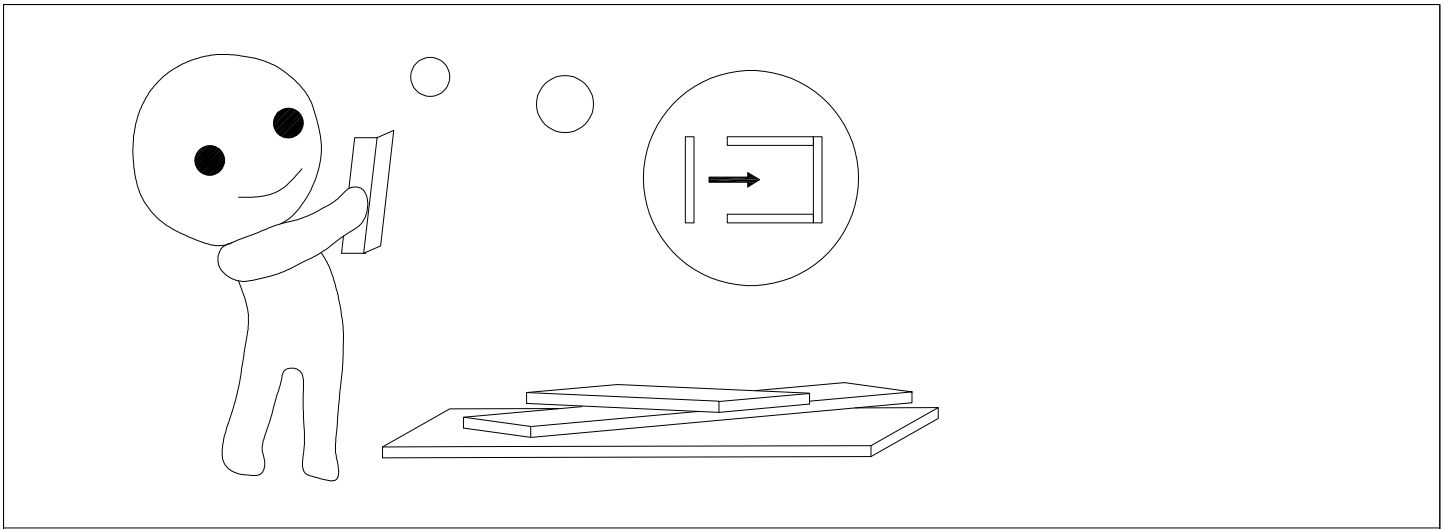

# PLATE NUMBER

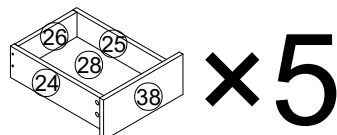
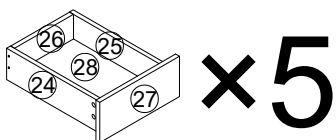
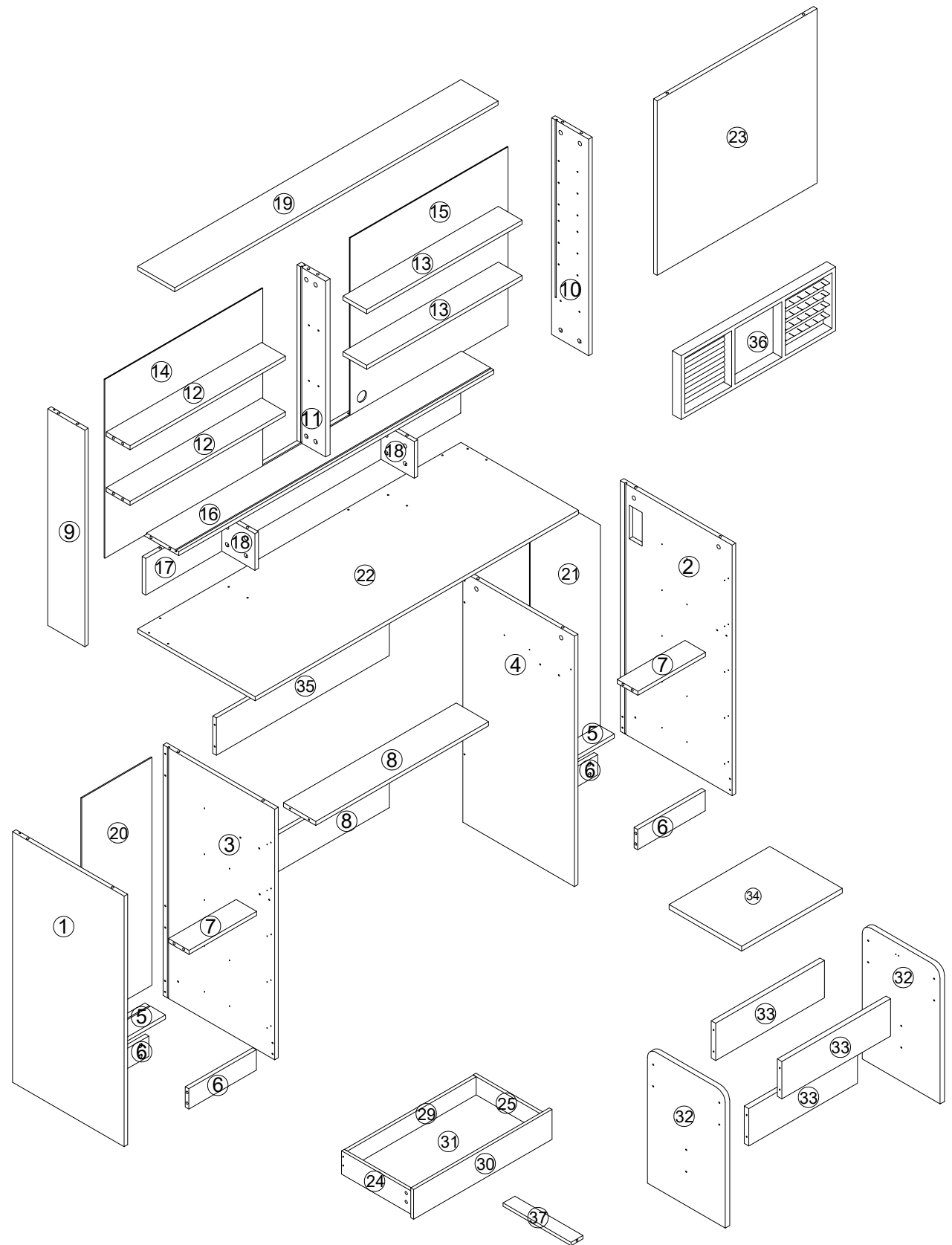

# ACCESSORIES LIST

A ×119

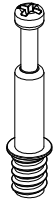

M6×35

B ×119

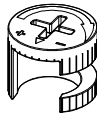

12×10

C ×73



M5×40

D ×222

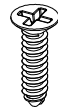

M3×12

E ×11

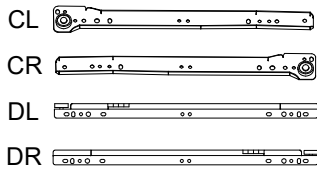

M300

F ×10

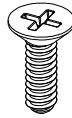

M3.5×12

G ×1

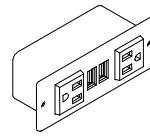

H ×14

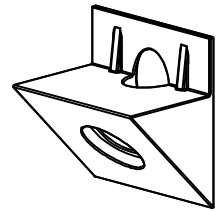

J ×14

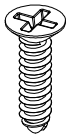

M3.5×14

K ×8

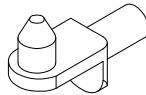

L ×1

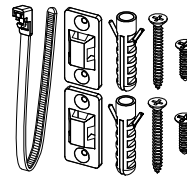

M ×1

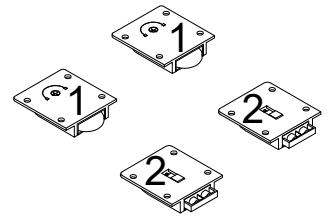

N ×4

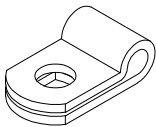

P ×1

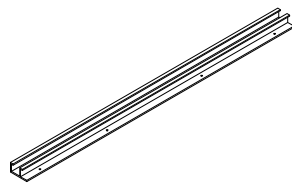

M583

Q ×10

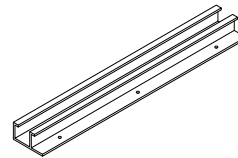

M249

R ×2

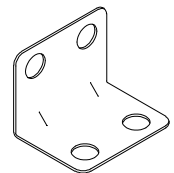

S ×1

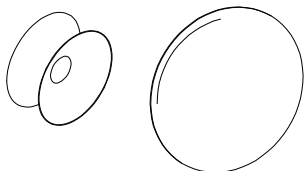

T ×6

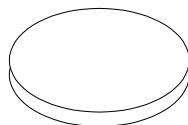

×1

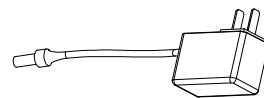

# STEP1

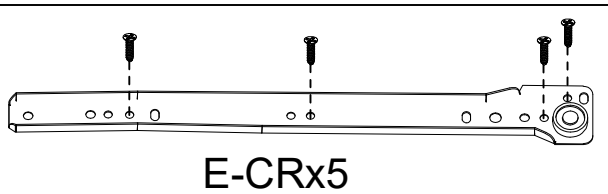
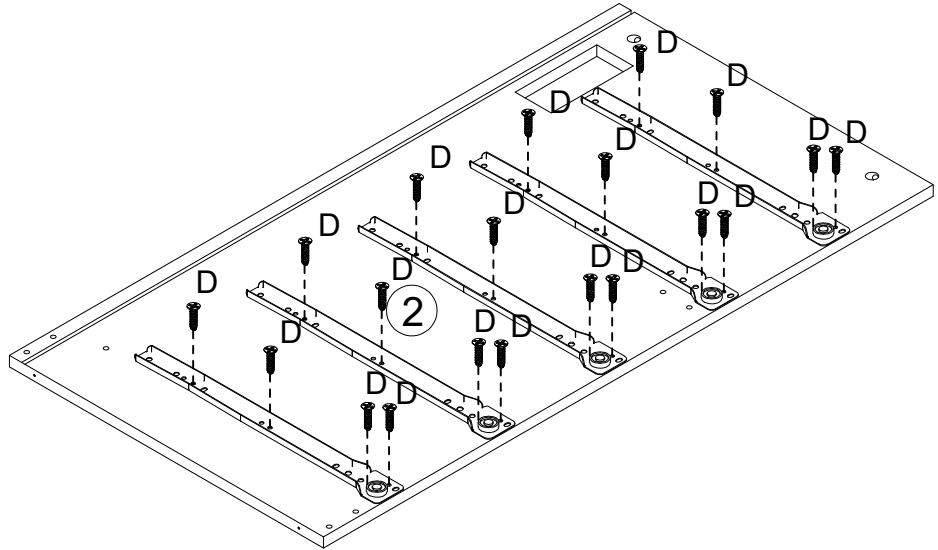
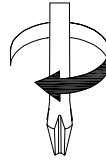

Dx20

# STEP2

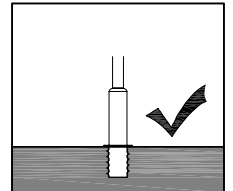
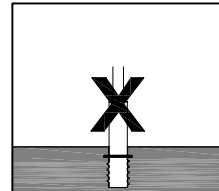
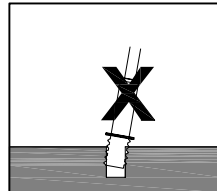
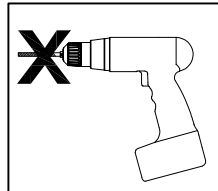

Iron Rod A is prohibited from using an electric drill.

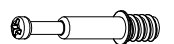
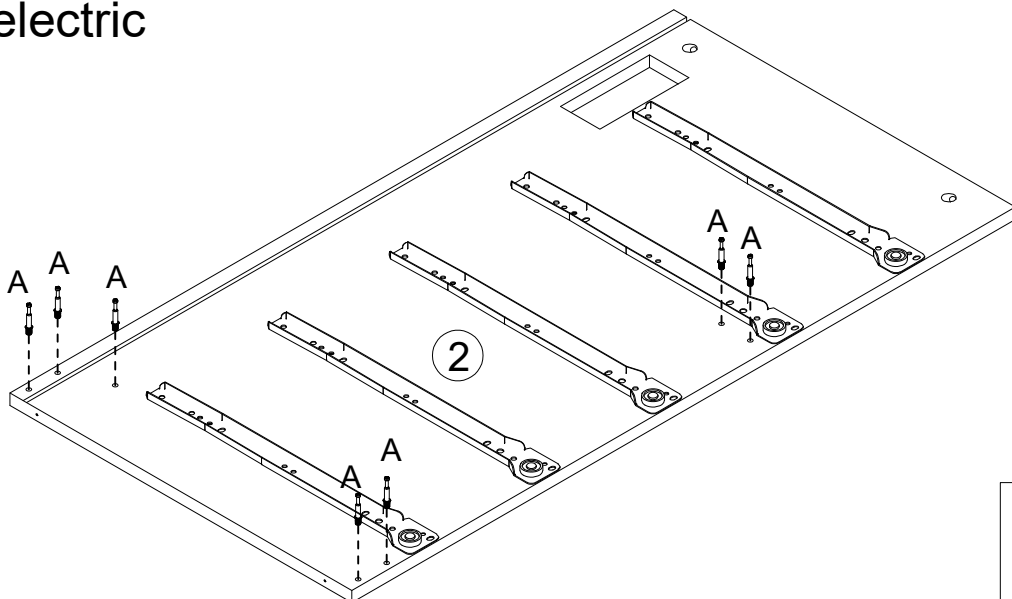
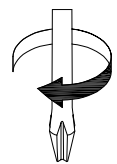

Ax7

# STEP3

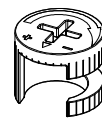
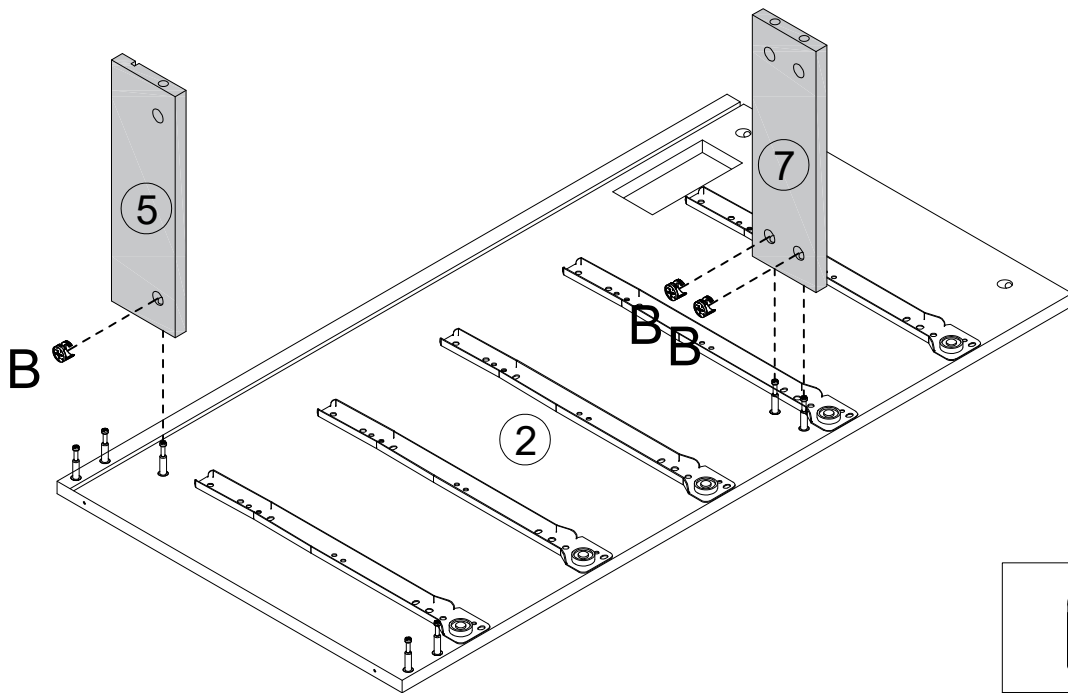
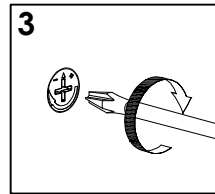
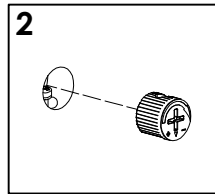
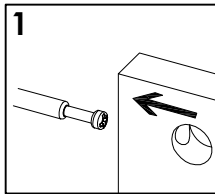
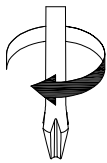

Bx3

# STEP4

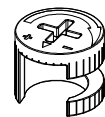
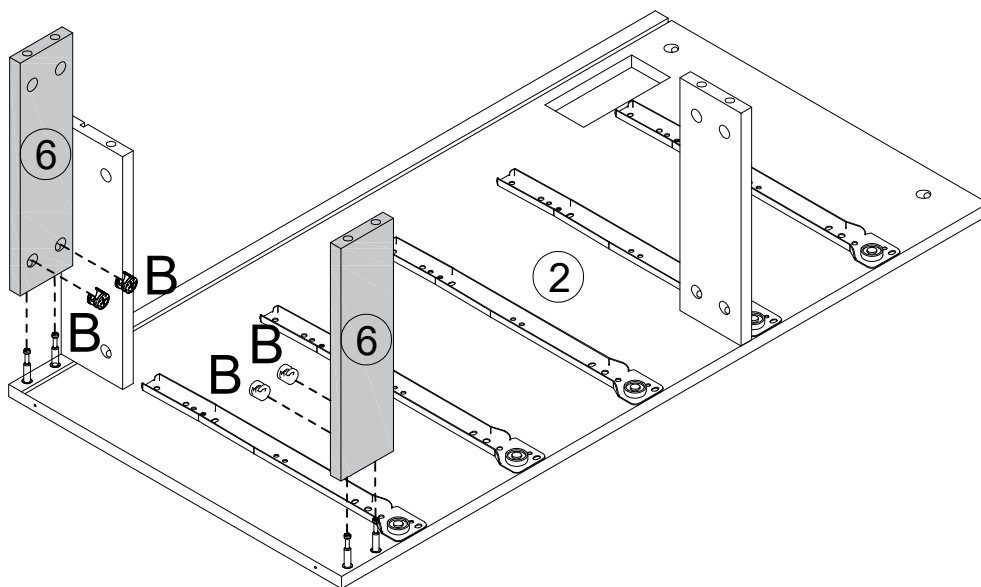
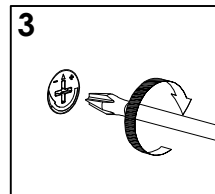
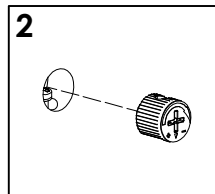
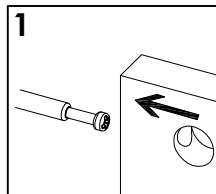
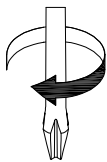

Bx4

# STEP 5

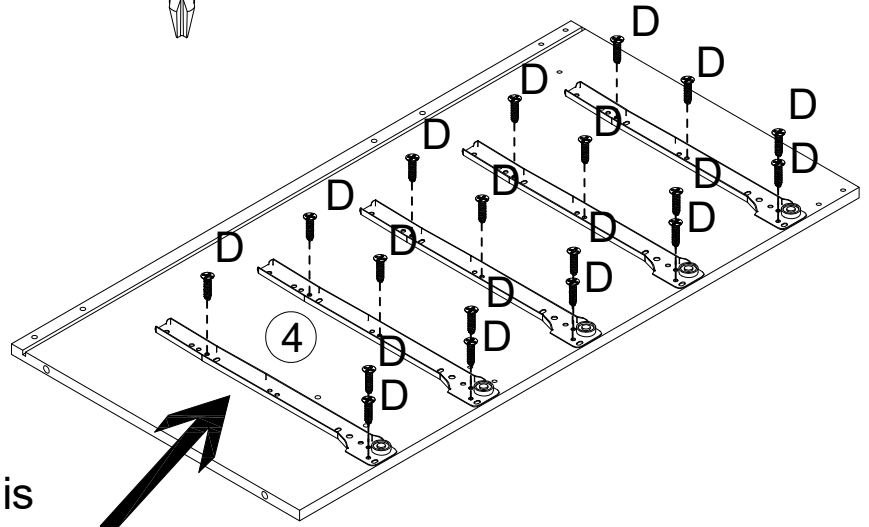
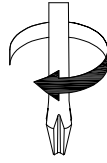

The rail indicated by this arrow is only installed with three screws D.

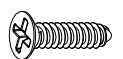
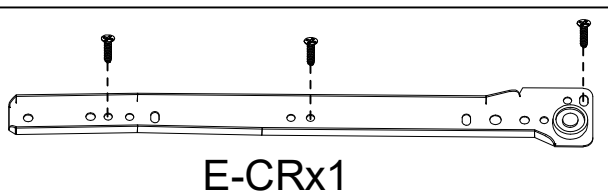
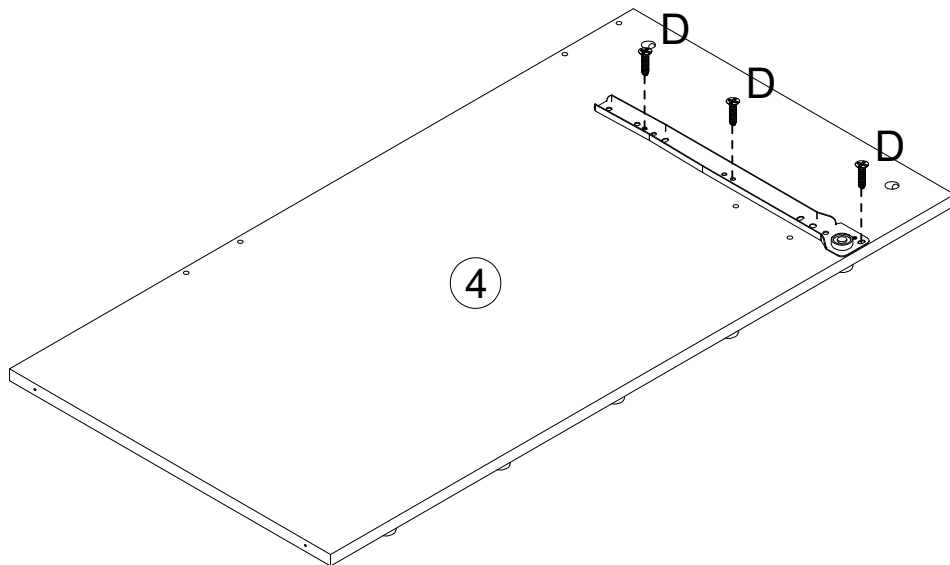
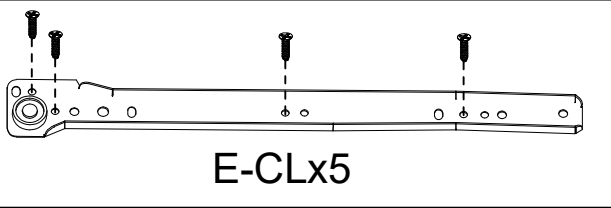

Dx22

# STEP6

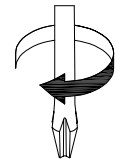
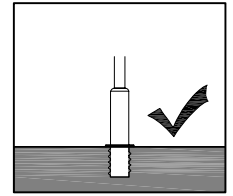
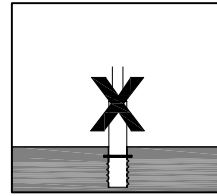
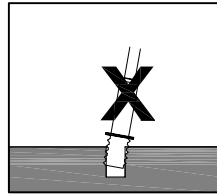
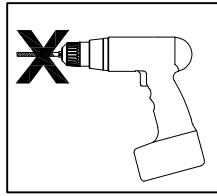

Iron Rod A is prohibited from using an electric drill.

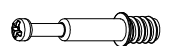
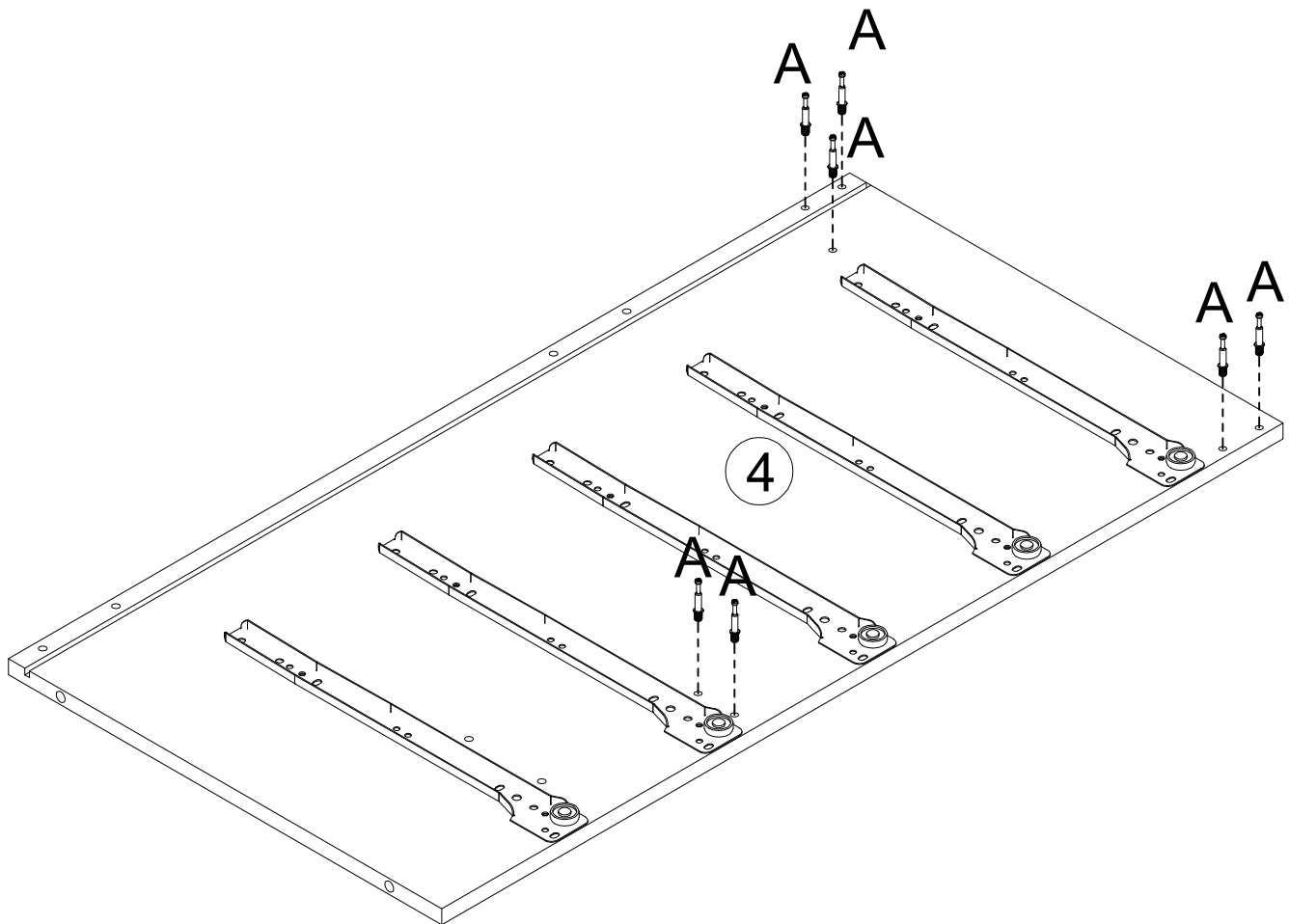

Ax7

# STEP 7

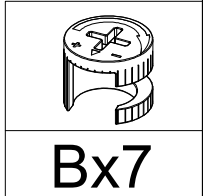
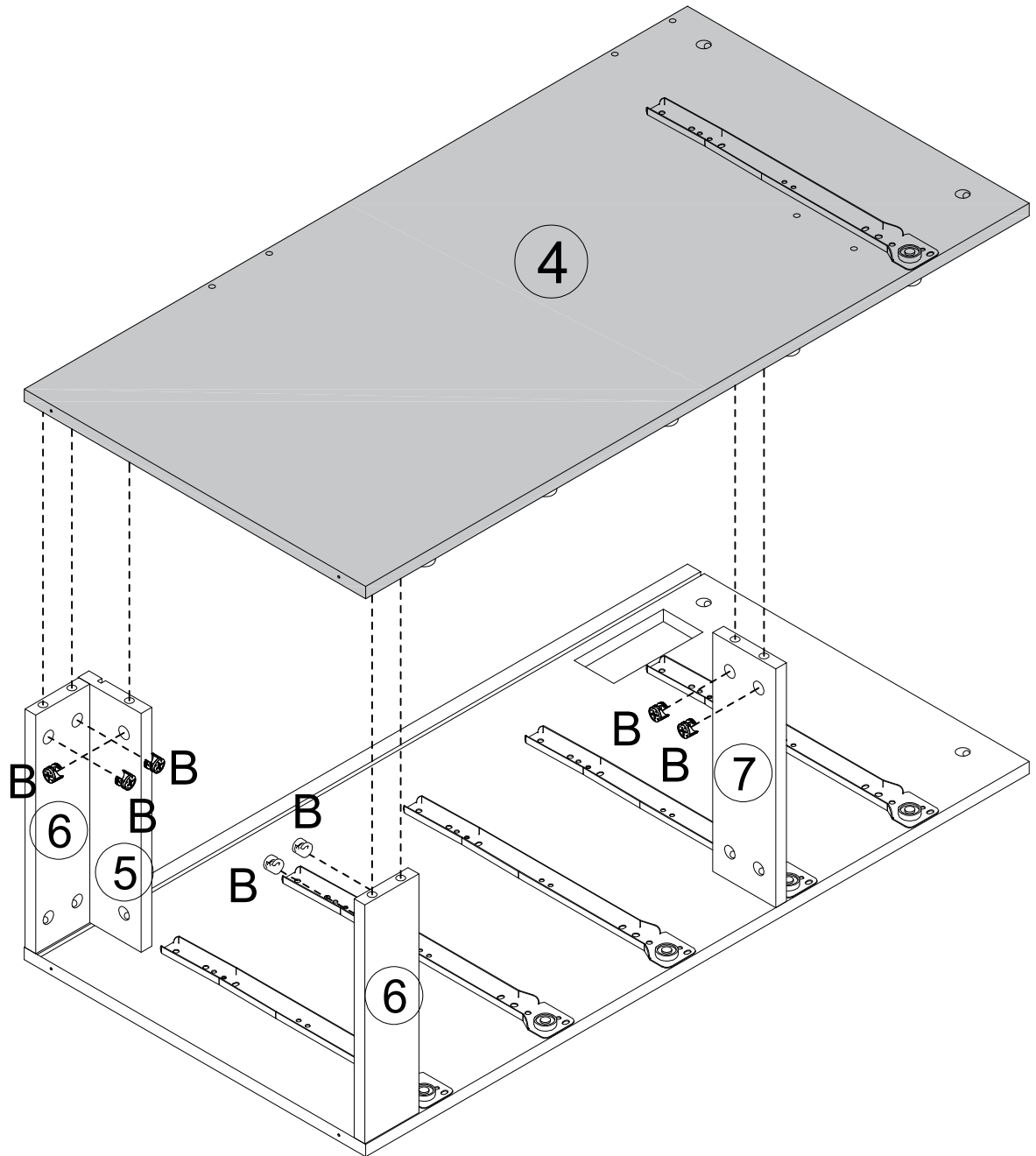
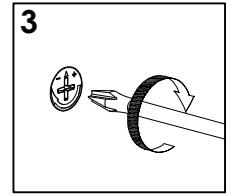
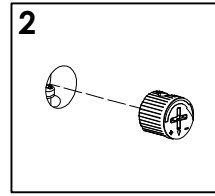
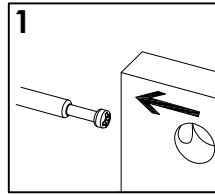
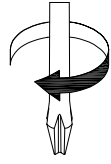

# STEP8

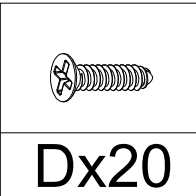
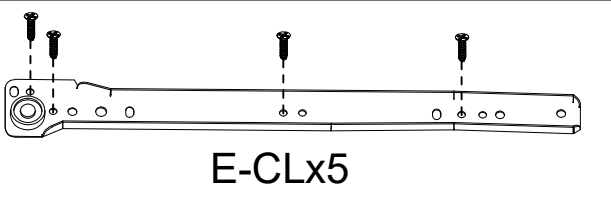
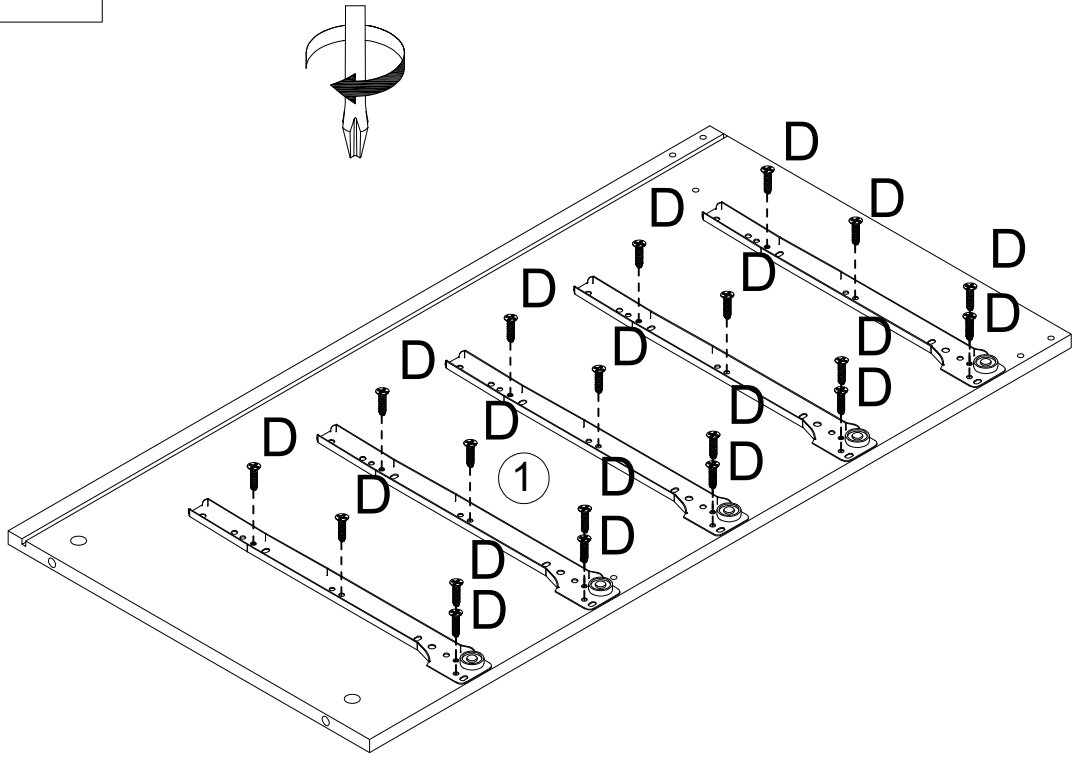

# STEP9

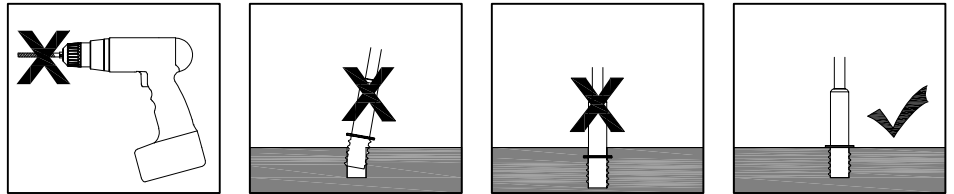

Iron Rod A is prohibited from using an electric drill.

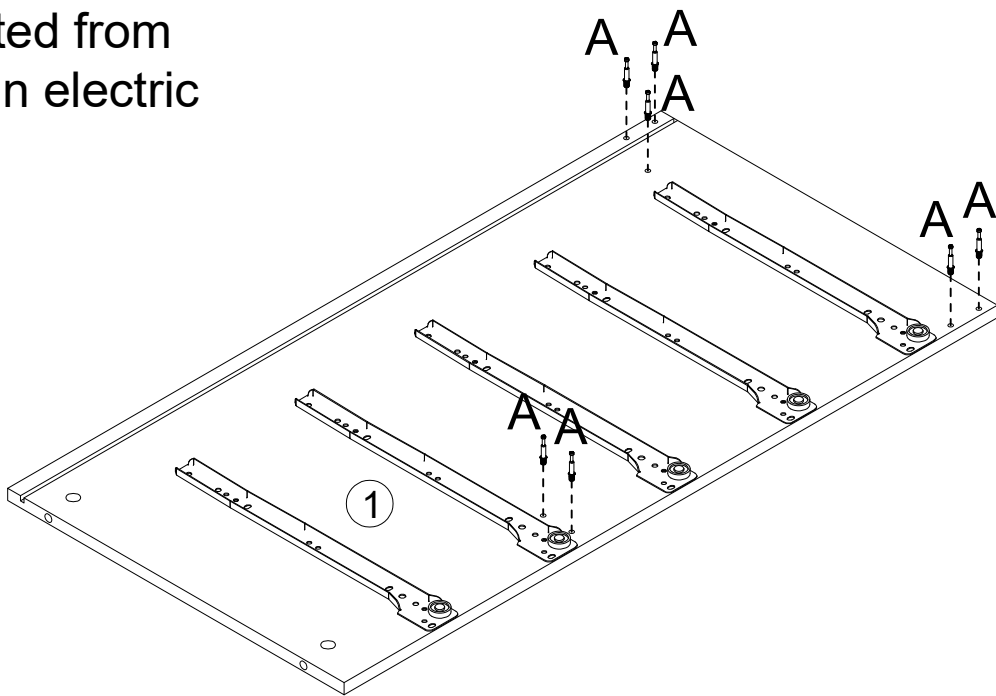

# STEP10

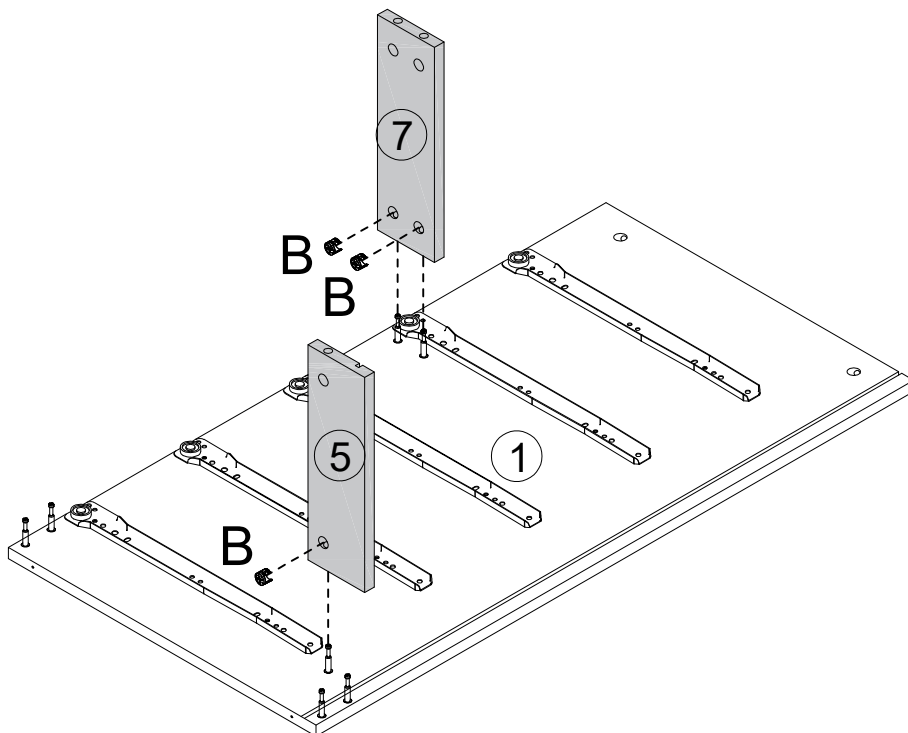
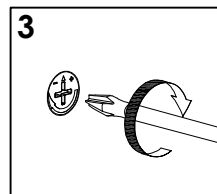
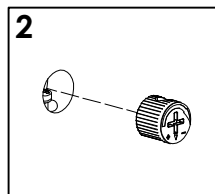
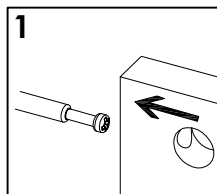
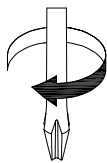

# STEP11

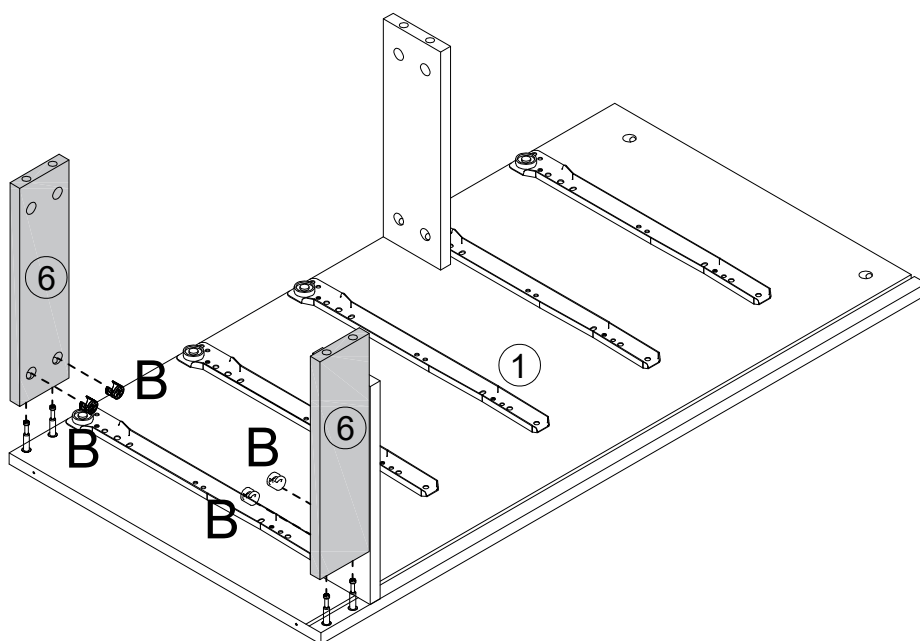
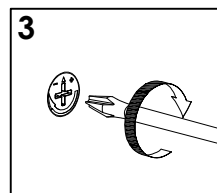
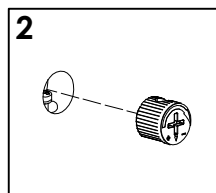
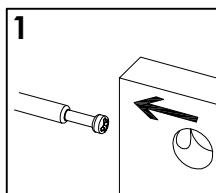
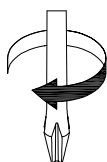

# STEP12

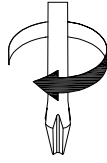

The rail indicated by this arrow is only installed with three screws D.

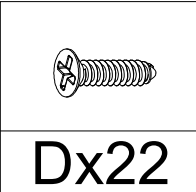
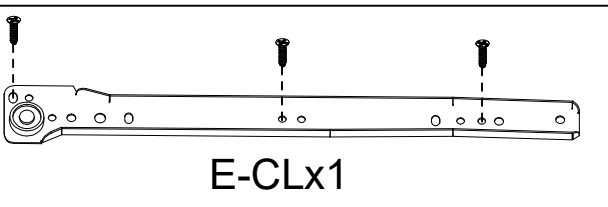
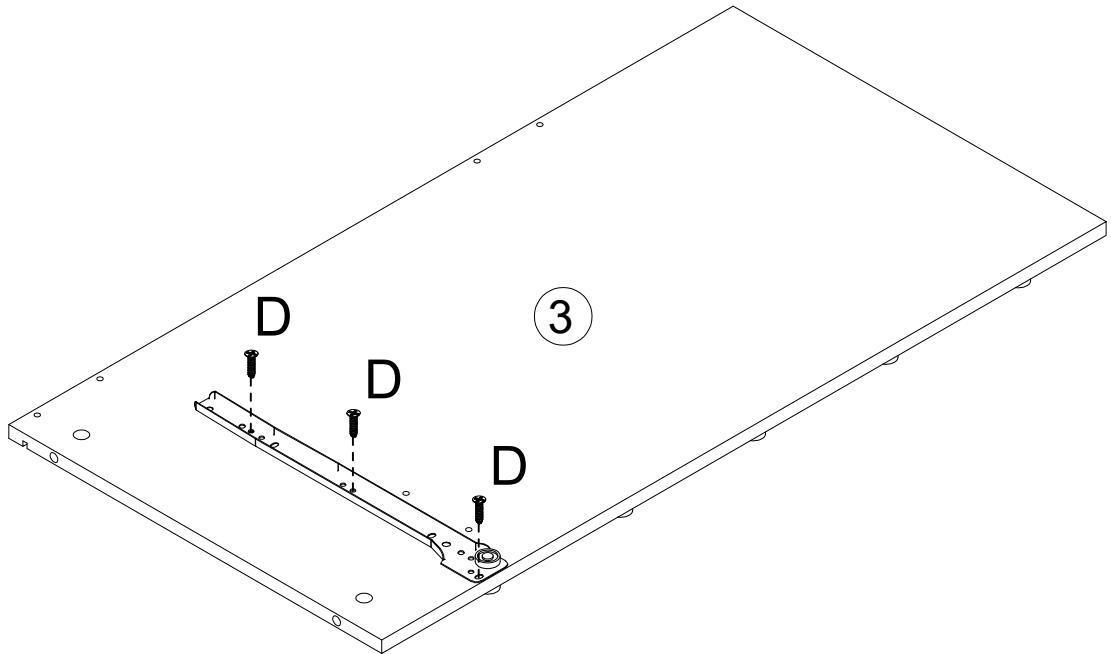
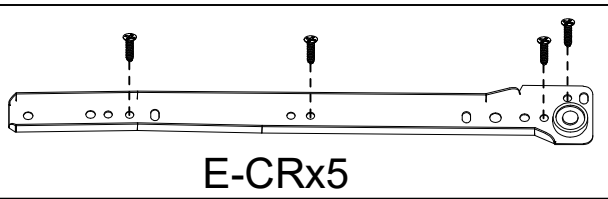
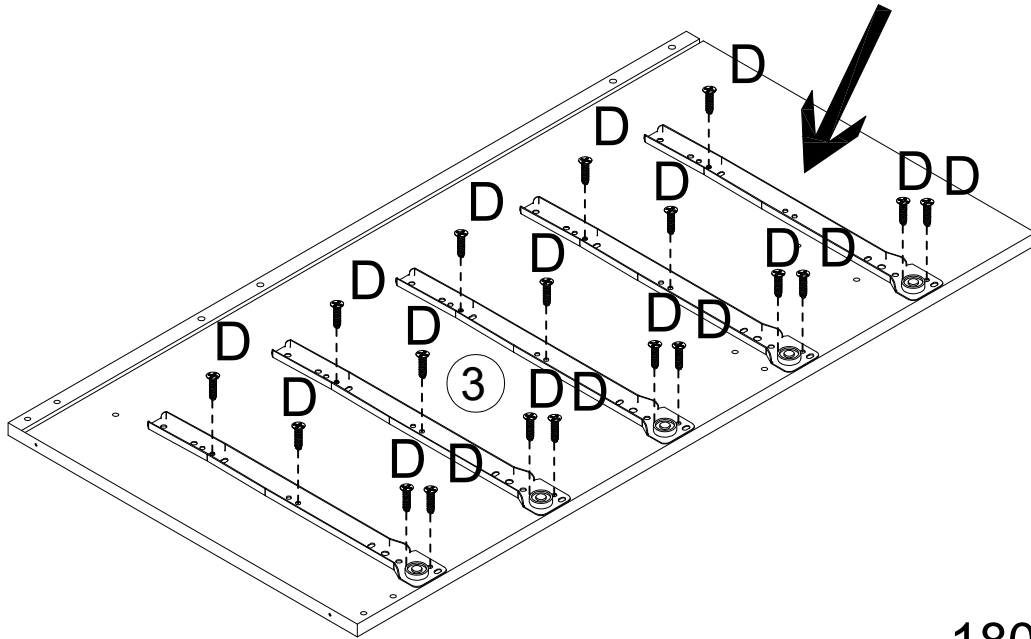

# STEP13

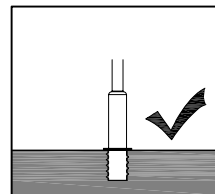
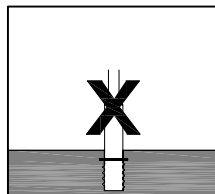
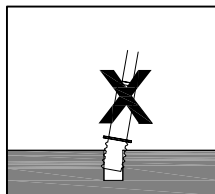
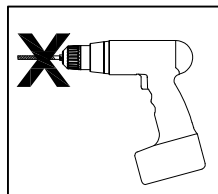

Iron Rod A is prohibited from using an electric drill.

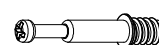
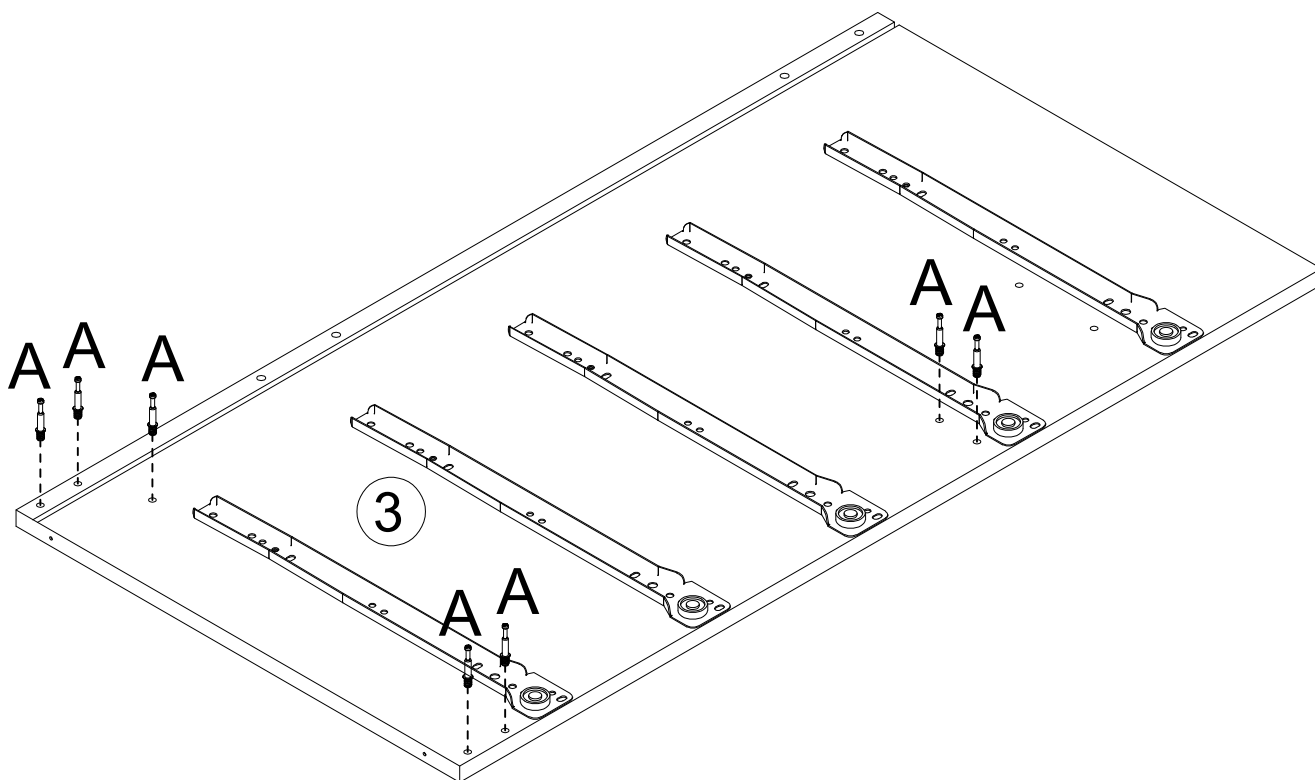
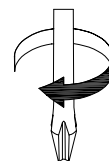

Ax7

# STEP 14

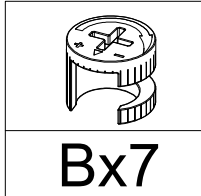
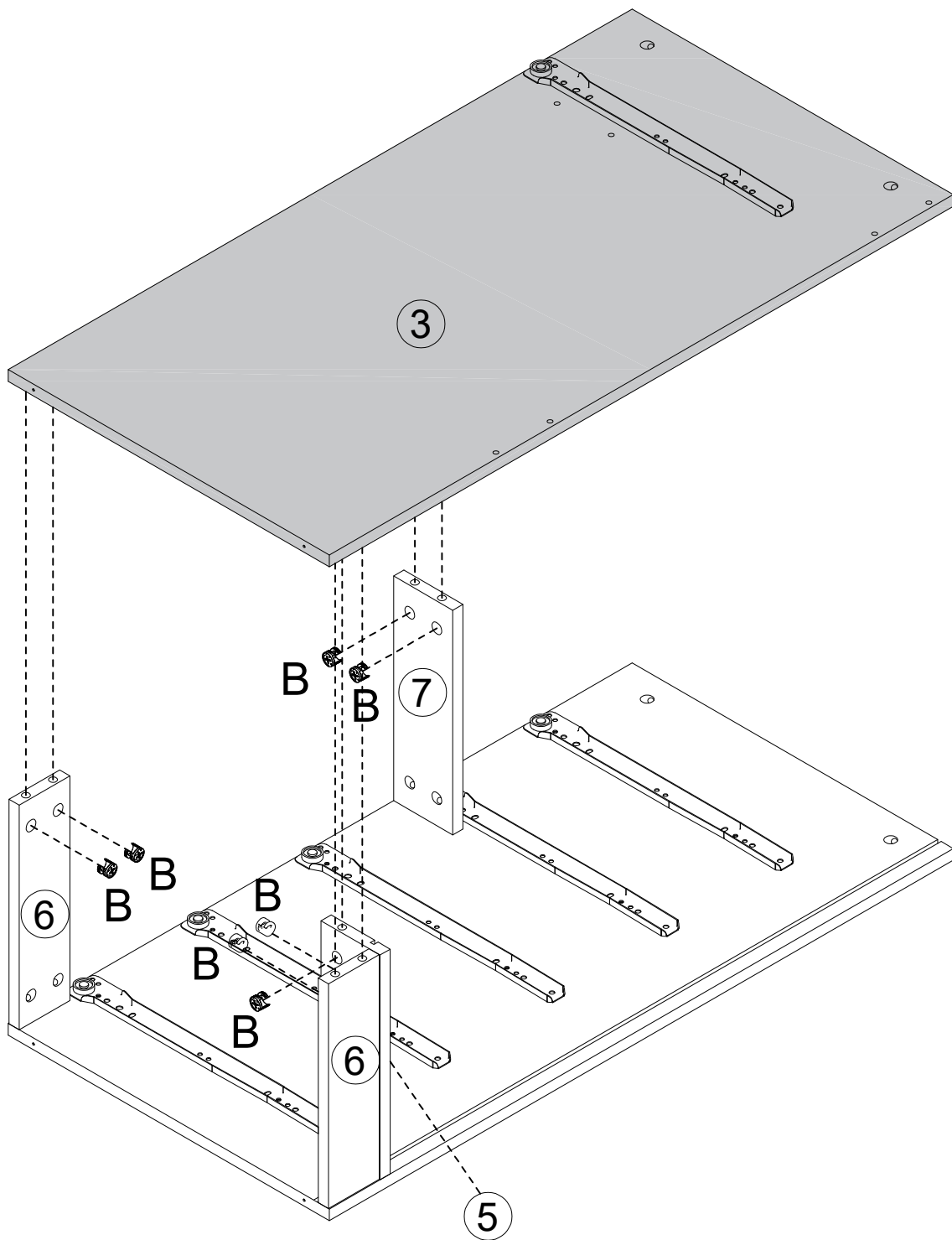
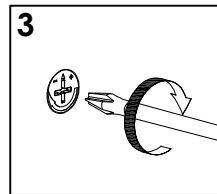
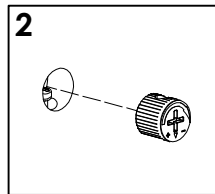
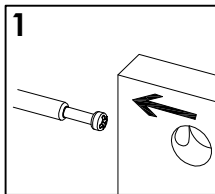
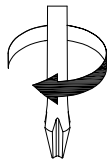

# STEP15

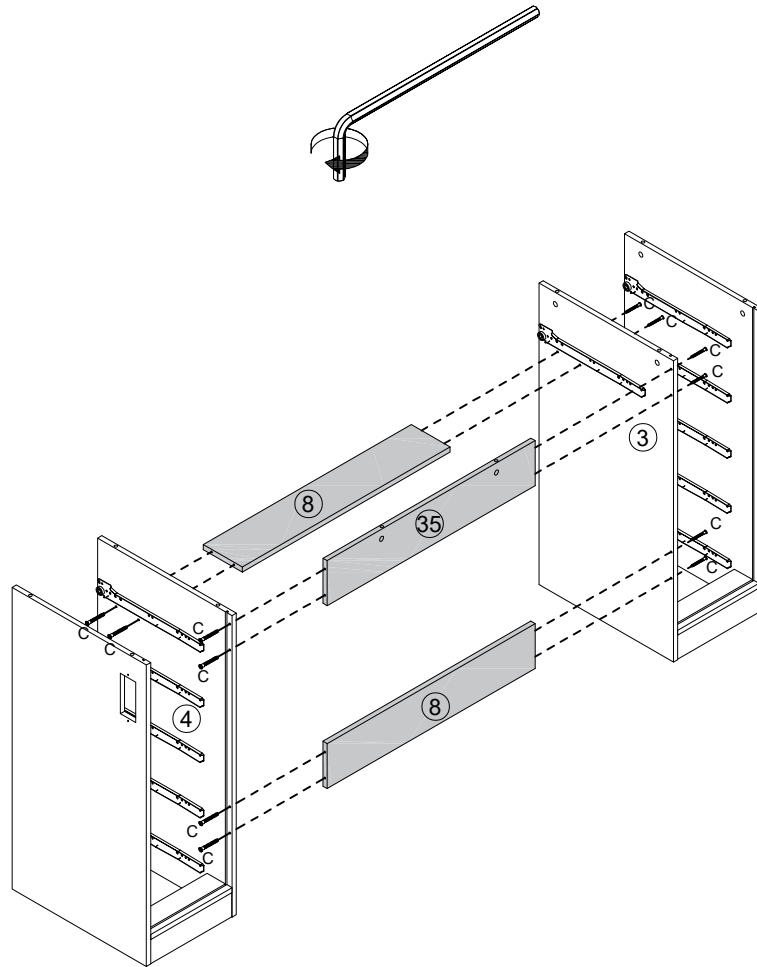

Cx12

# STEP16

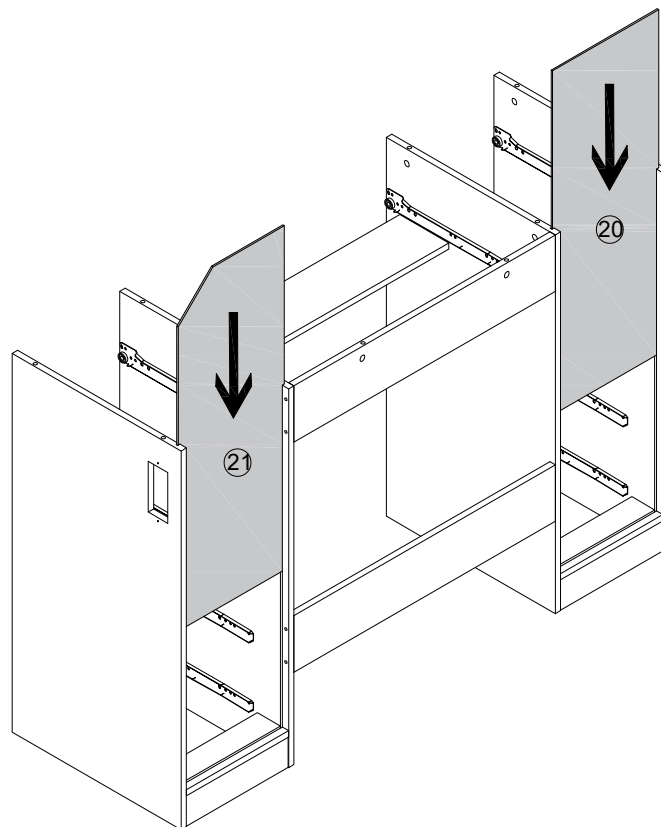

# STEP 17

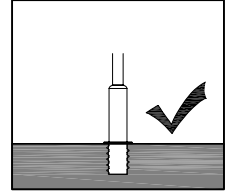
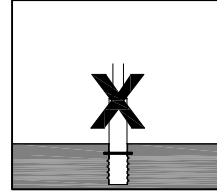
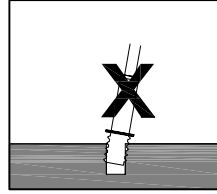
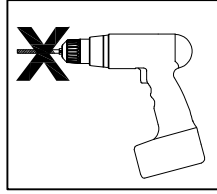

Iron Rod A is prohibited from using an electric drill.

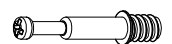
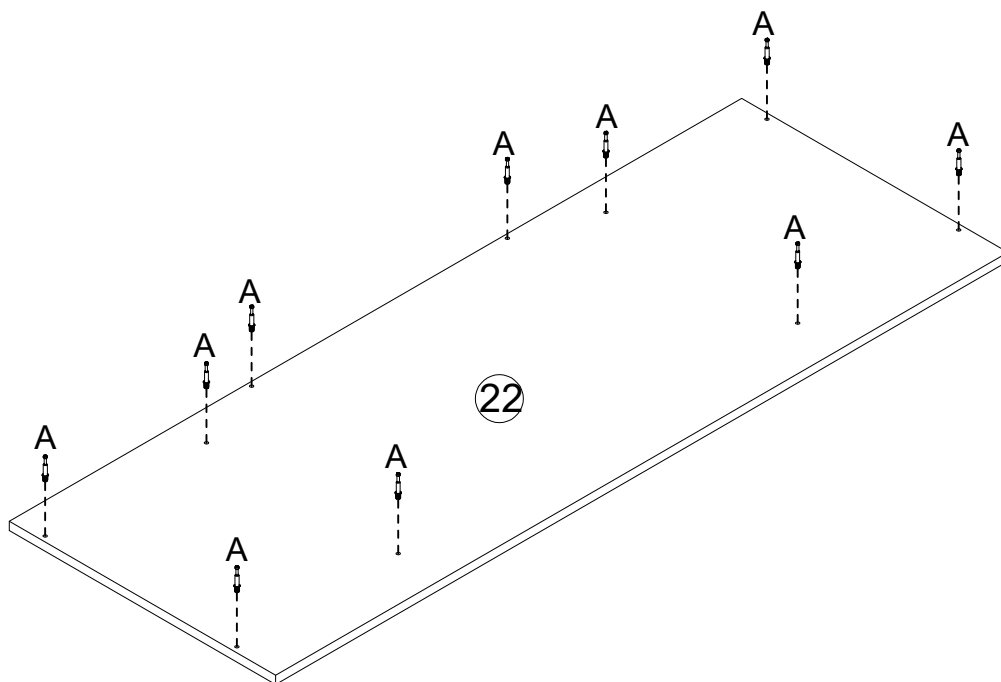
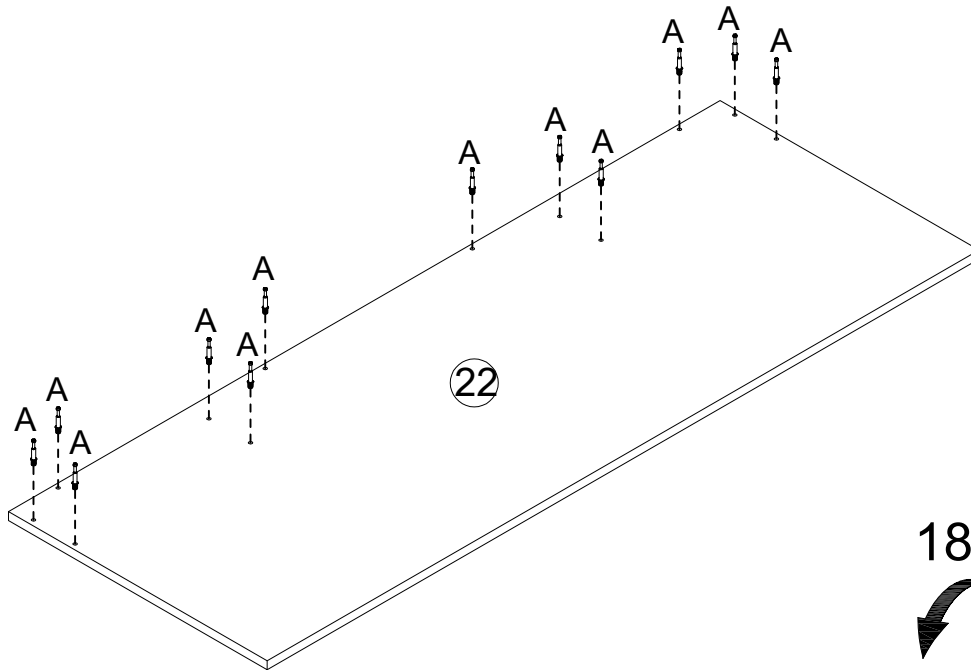
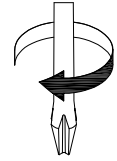

Ax22

# STEP 18

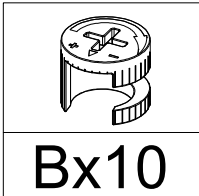
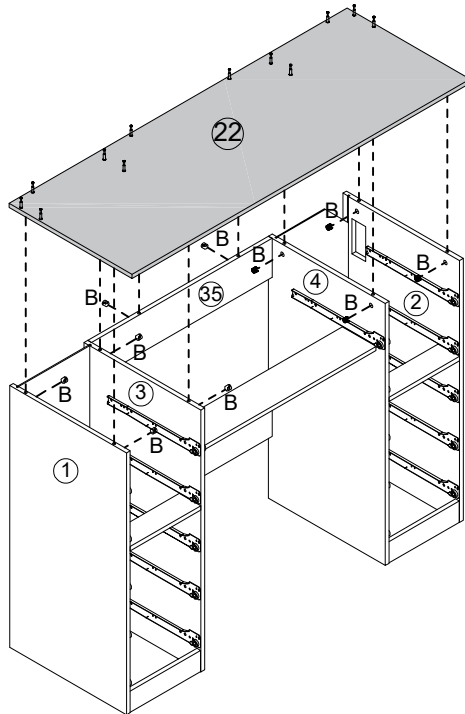
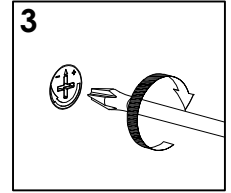
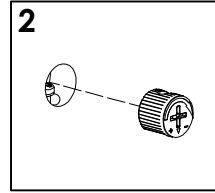
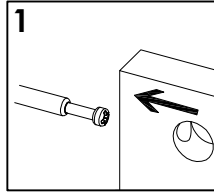
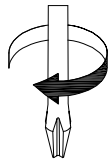

# STEP 19

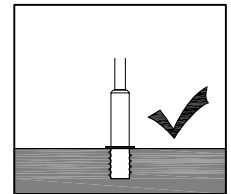
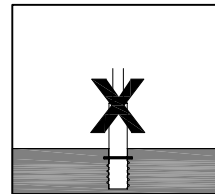
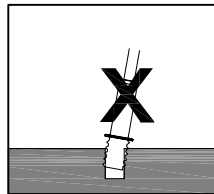
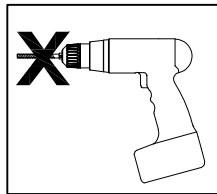

Iron Rod A is prohibited from using an electric drill.

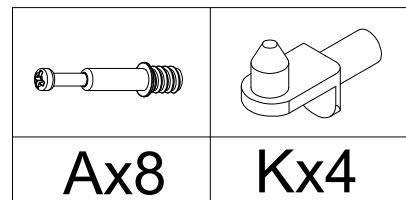
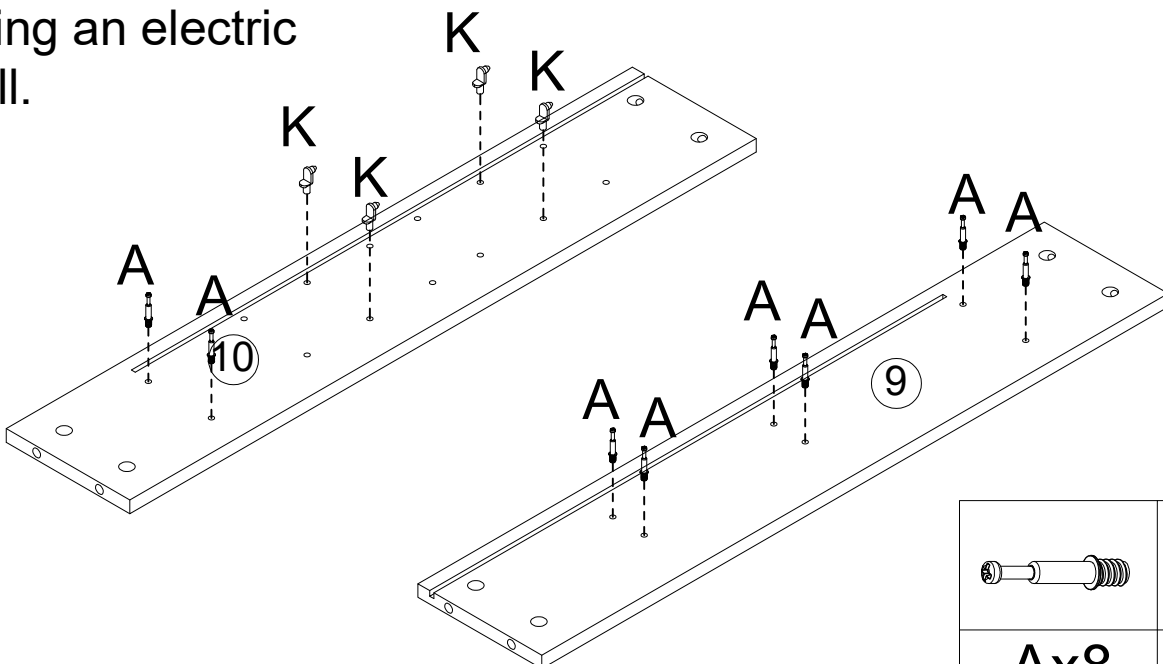
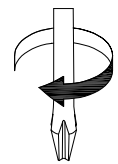

# STEP20

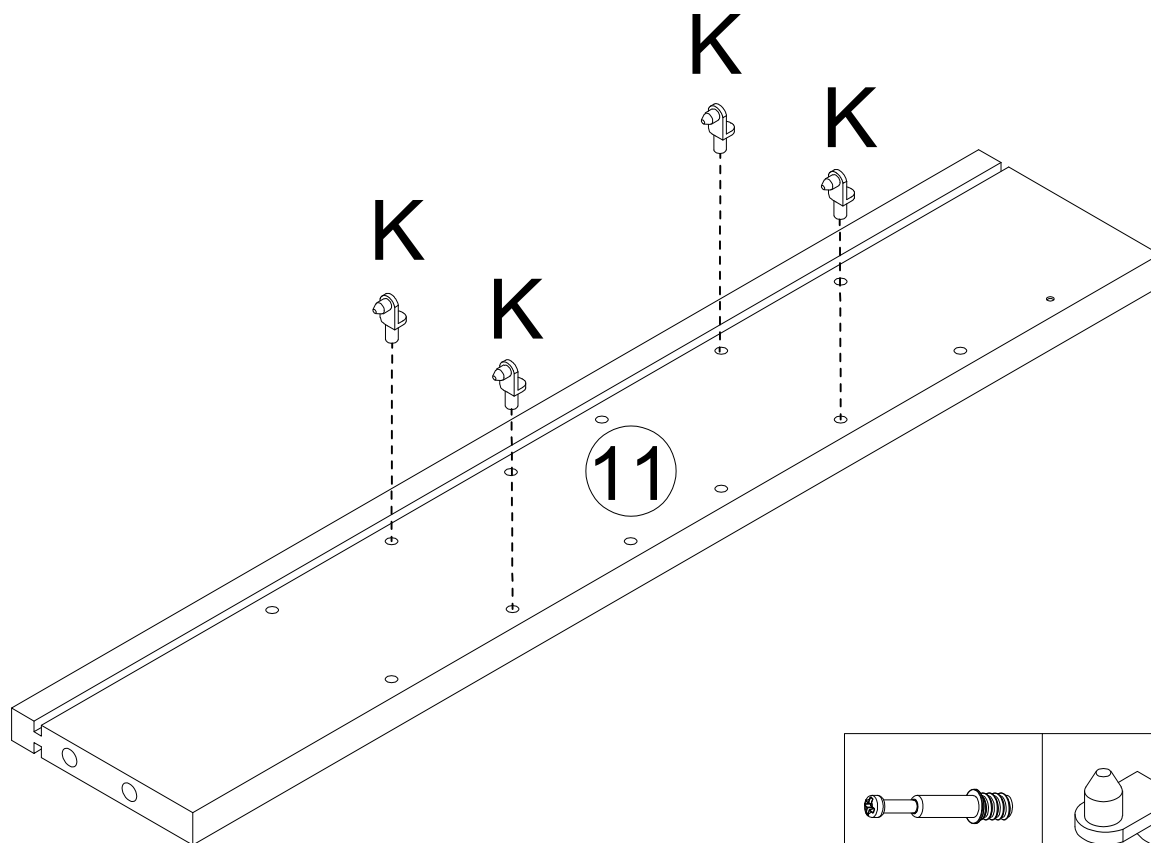
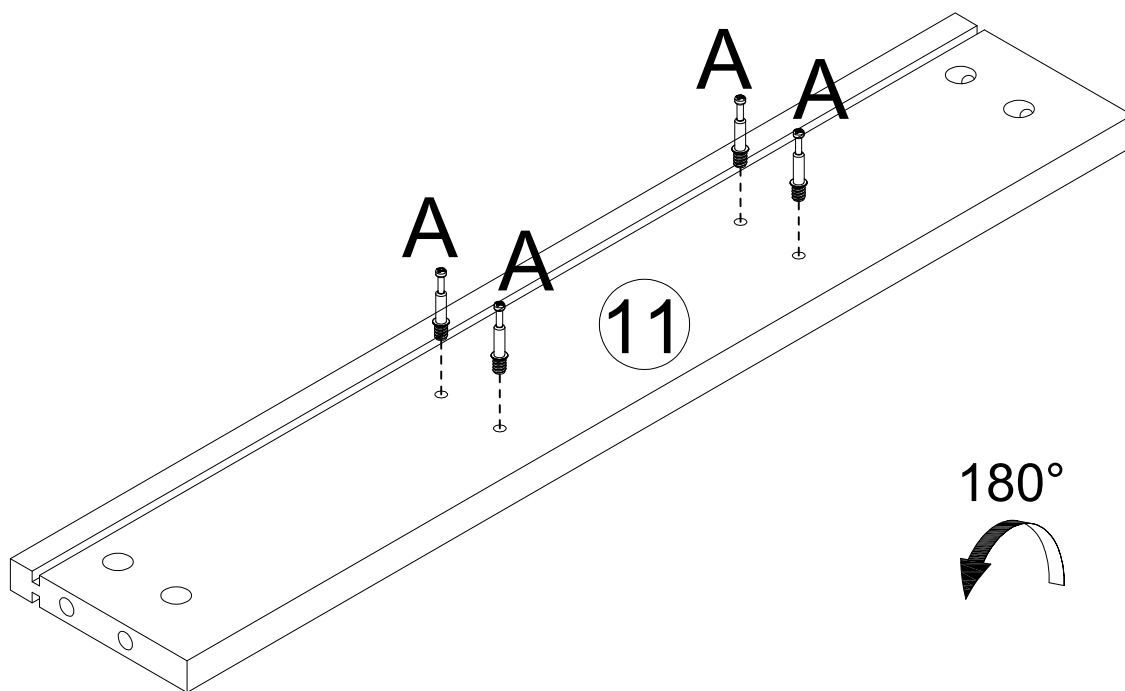
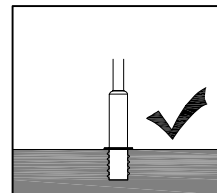
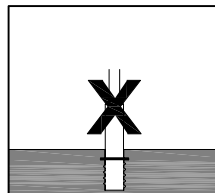
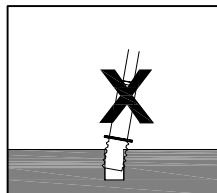
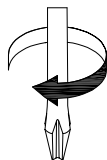

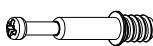
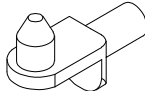
	
<b>Ax4</b>	<b>Kx4</b>

# STEP21

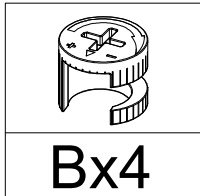
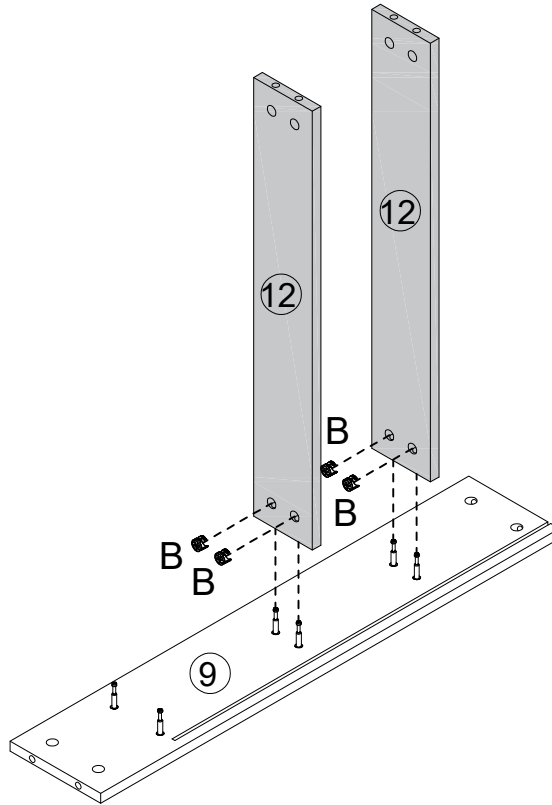
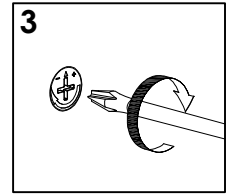
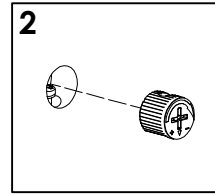
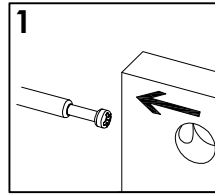
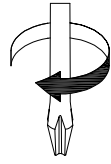

# STEP22

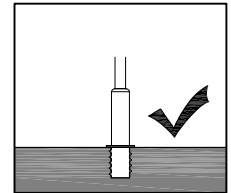
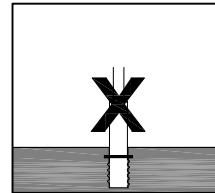
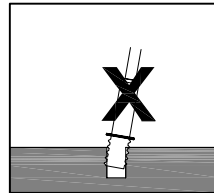
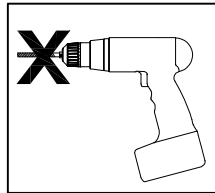

Iron Rod A is prohibited from using an electric drill.

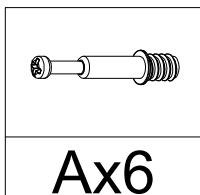
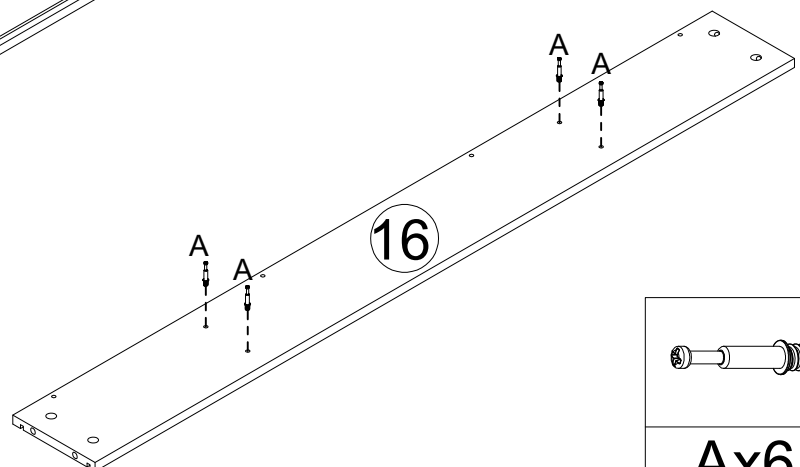
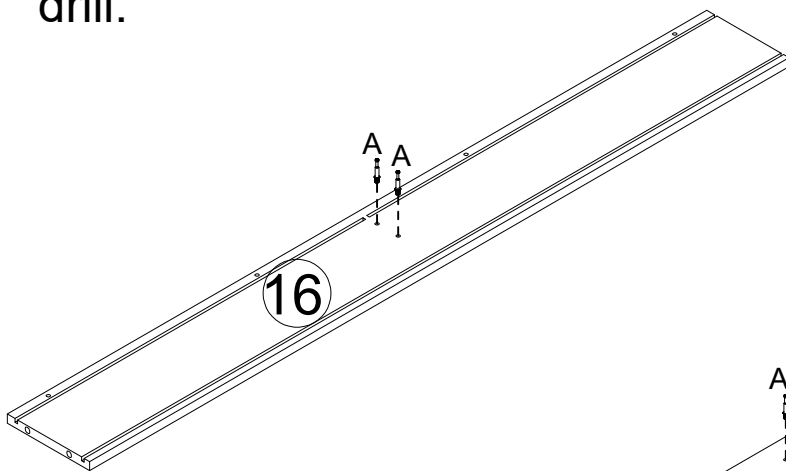
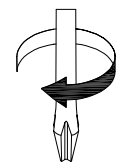

# STEP23

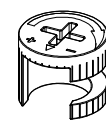
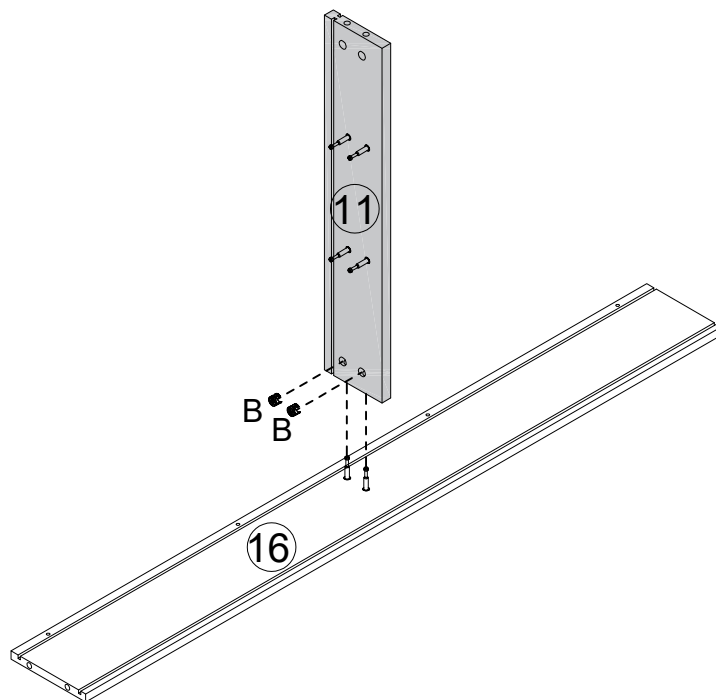
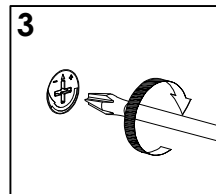
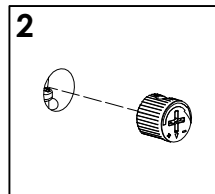
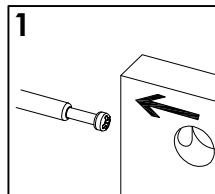
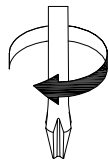

Bx2

# STEP24

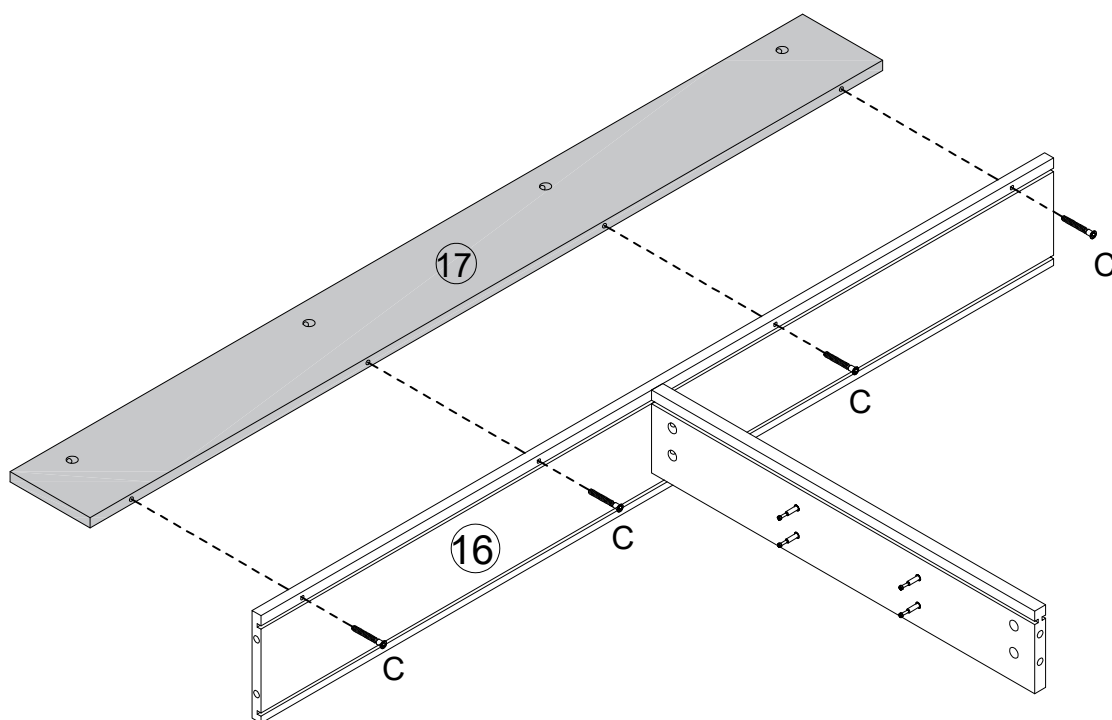
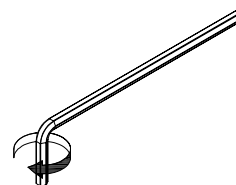

Cx4

# STEP25

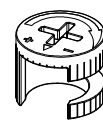
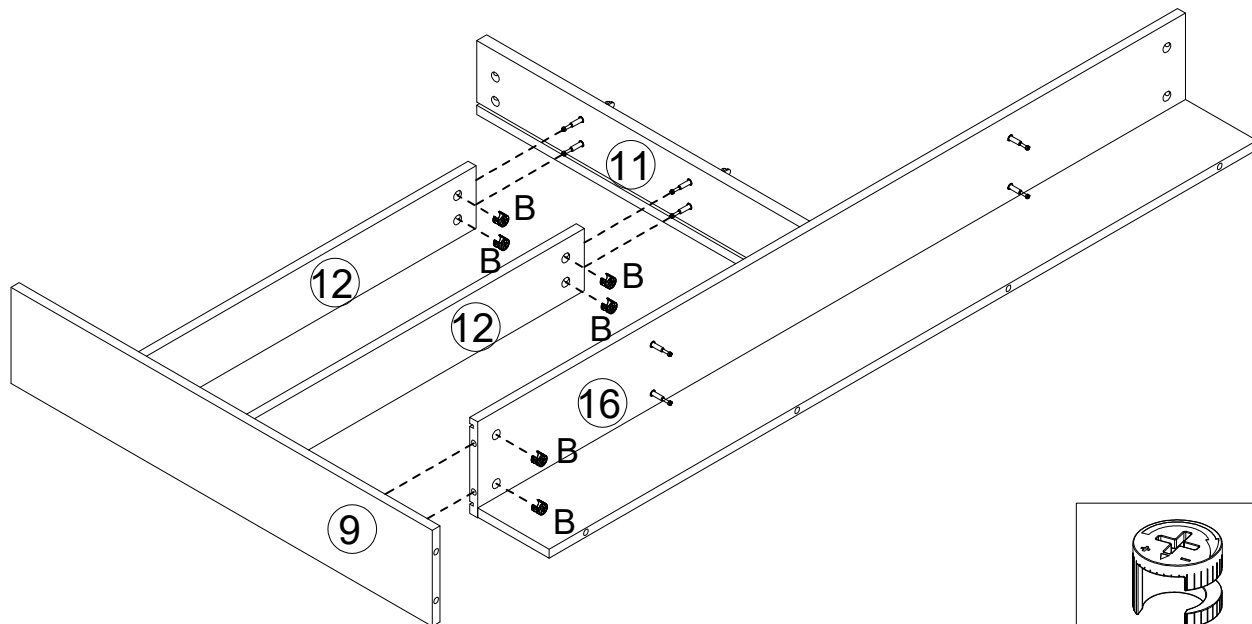
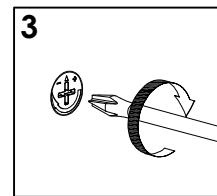
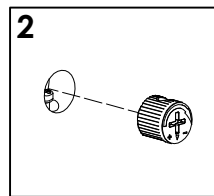
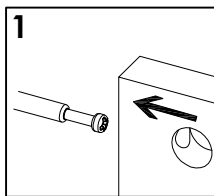
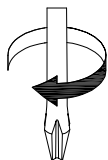

Bx6

# STEP26

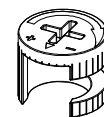
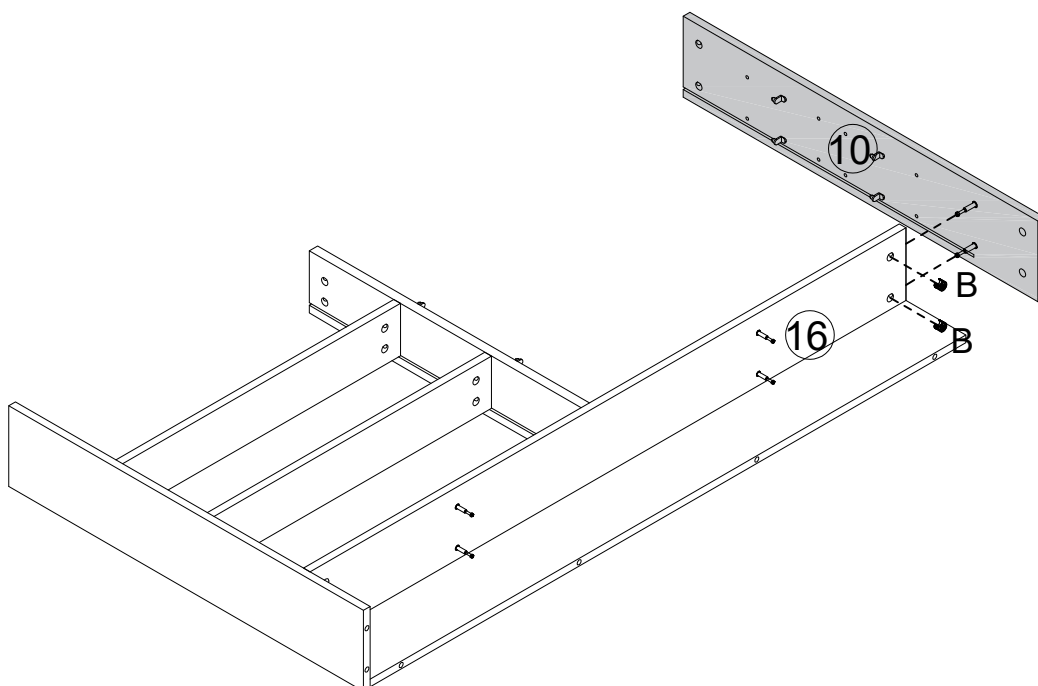
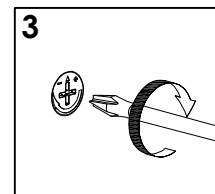
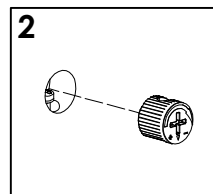
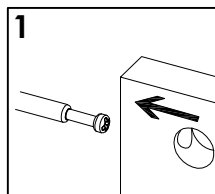
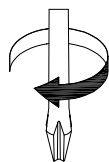

Bx2

# STEP27

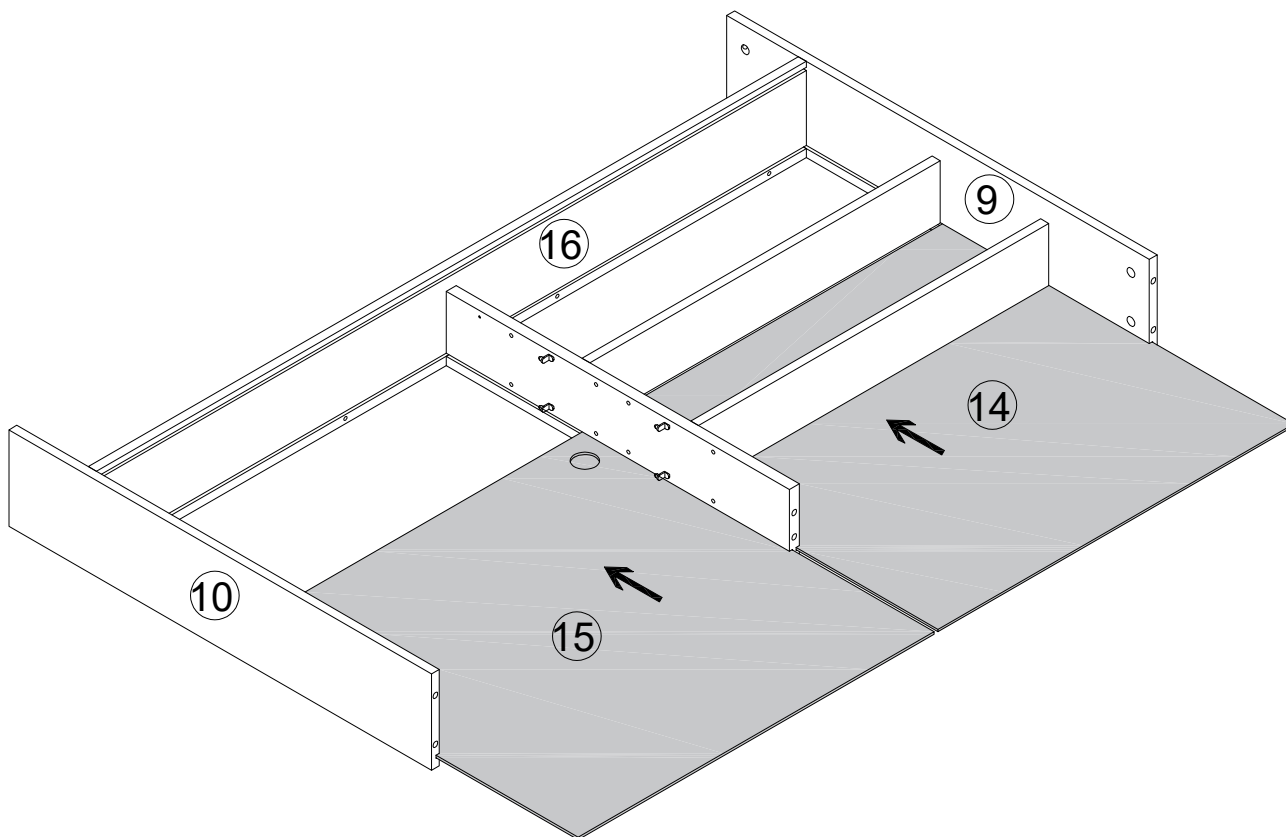

# STEP28

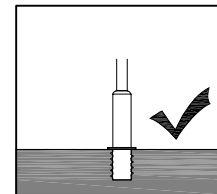
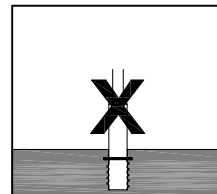
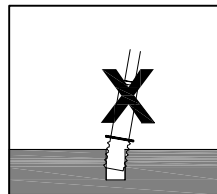
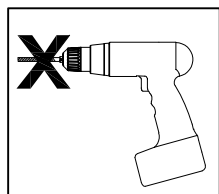

Iron Rod A is prohibited from using an electric drill.

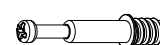
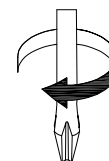
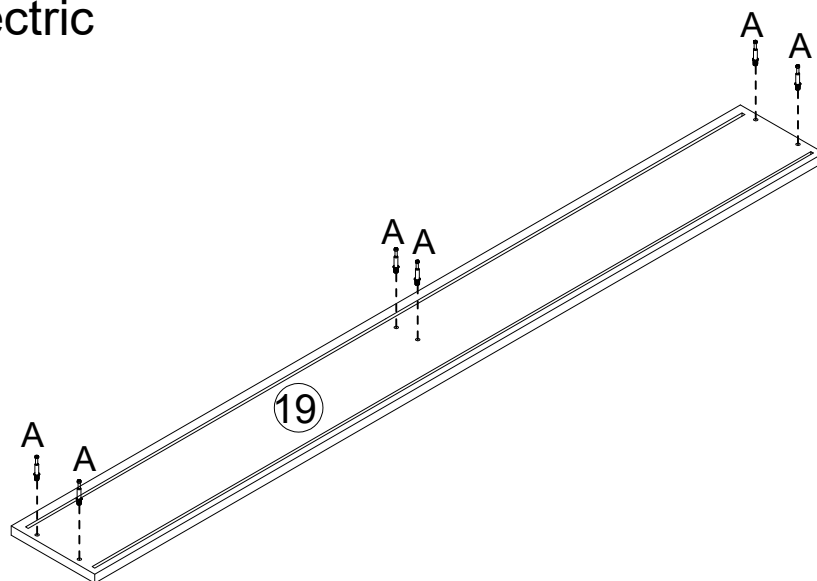

Ax6

# STEP29

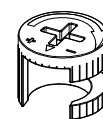
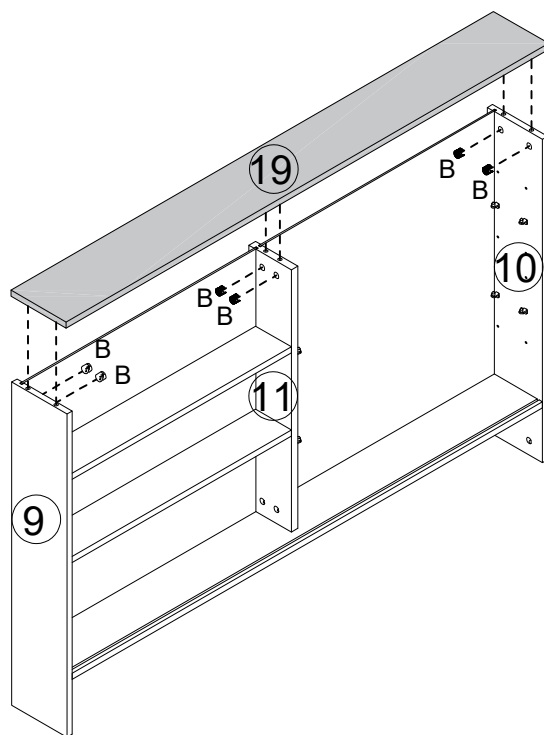
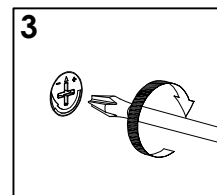
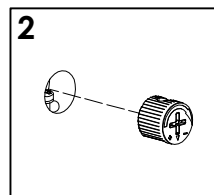
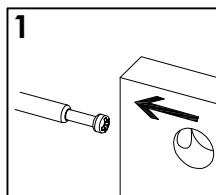
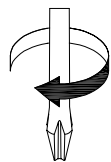

Bx6

# STEP30

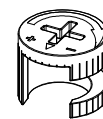
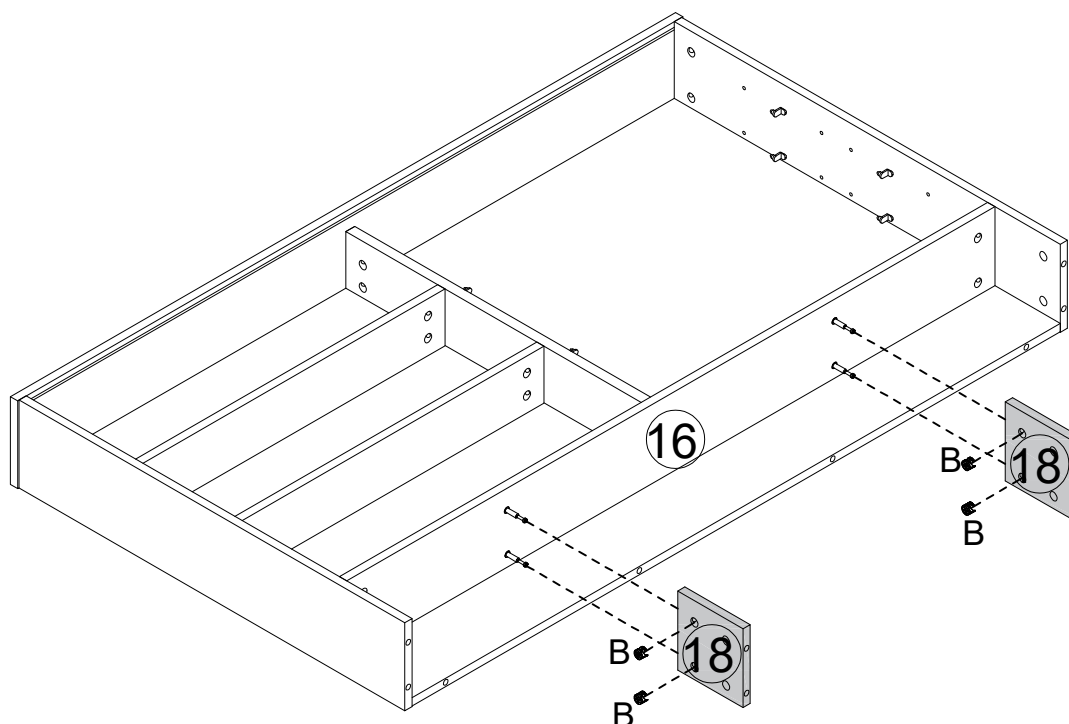
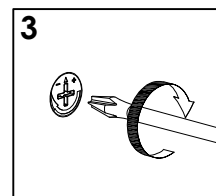
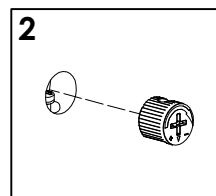
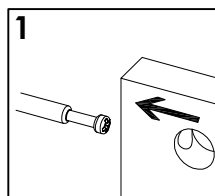
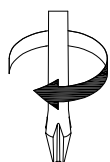

Bx4

# STEP31

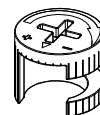
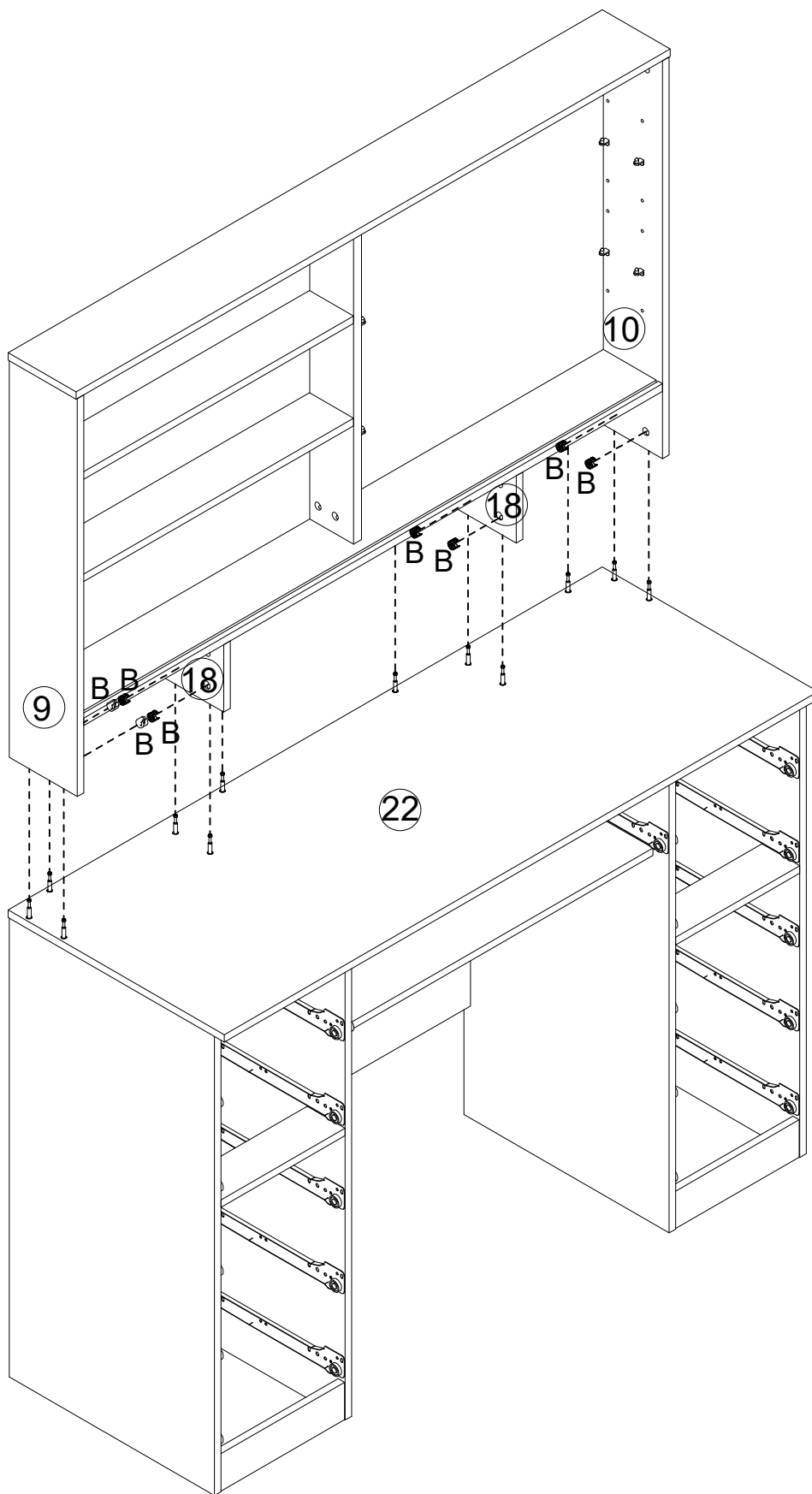
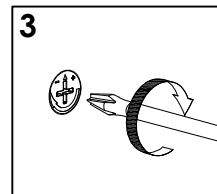
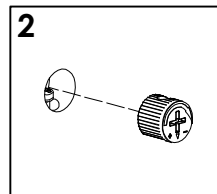
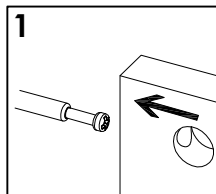
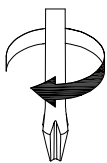

Bx8

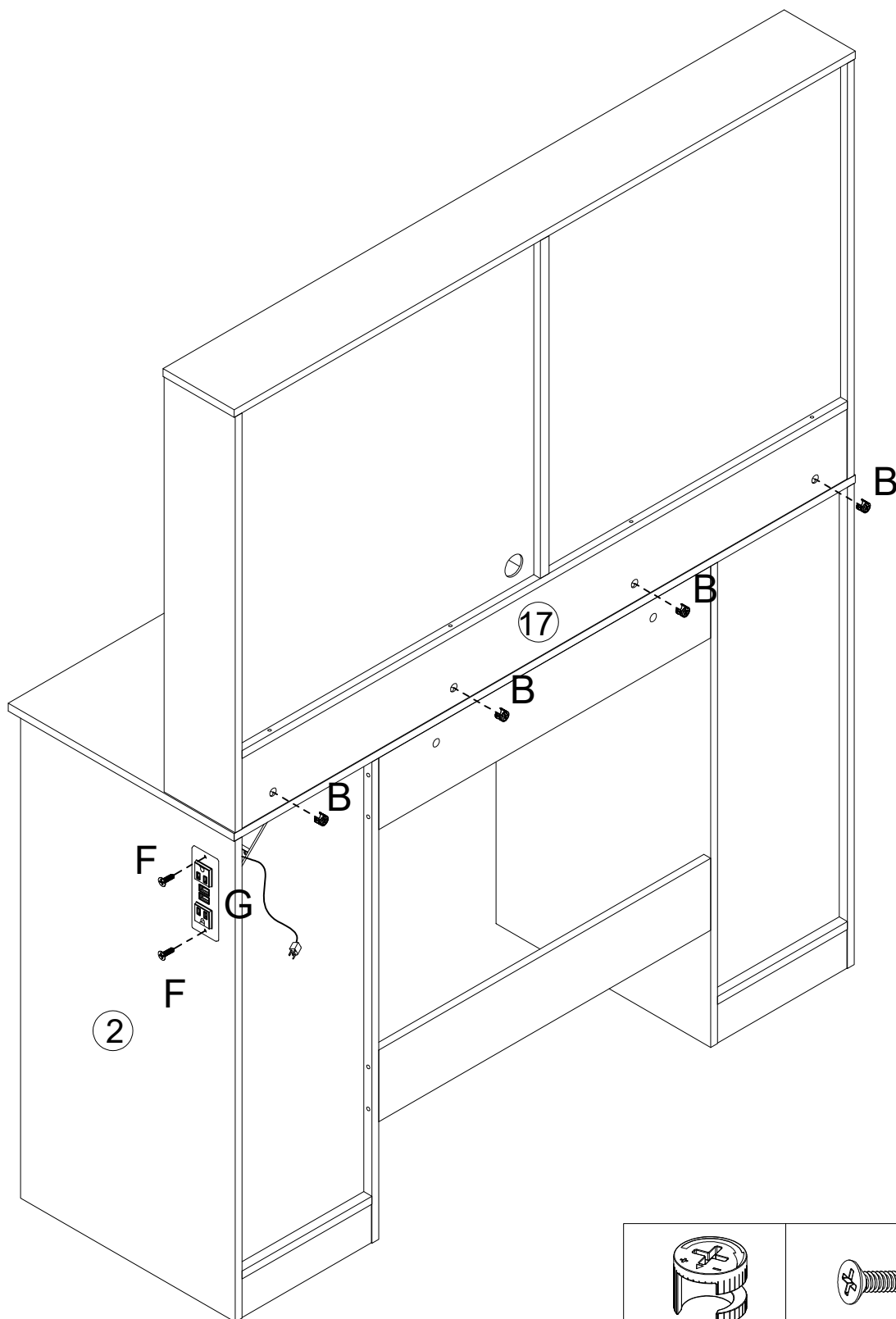
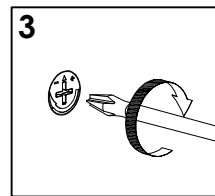
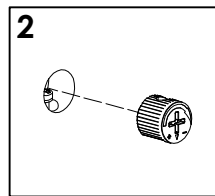
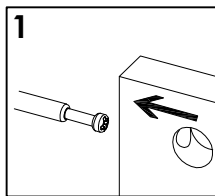
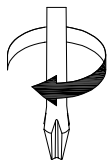

# STEP32

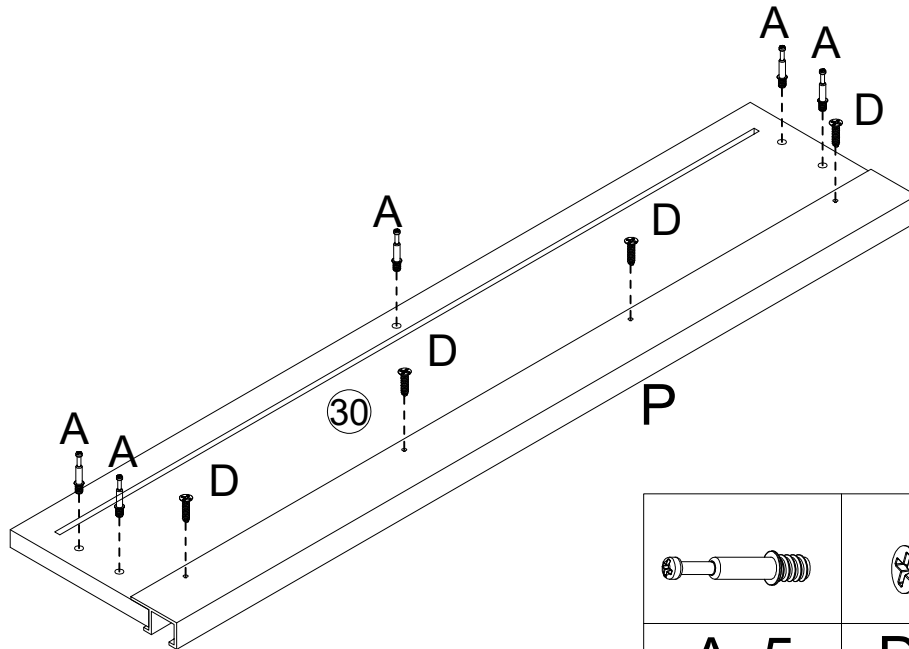
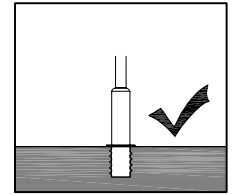
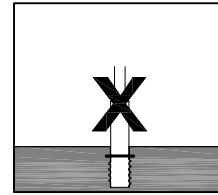
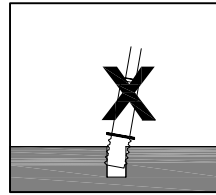
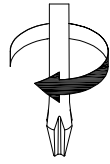

Bx4	Fx2	Gx1

# STEP33

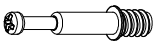

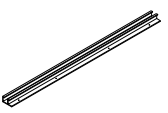
		
Ax5	Dx4	Px1

# STEP34

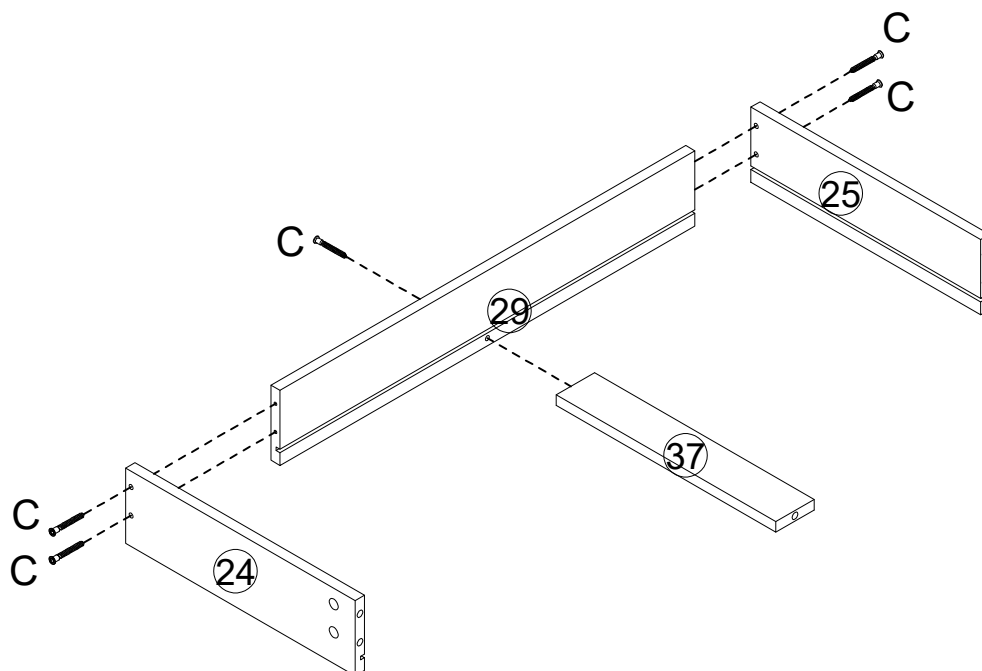
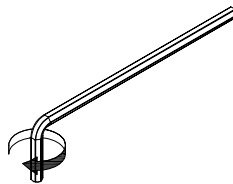

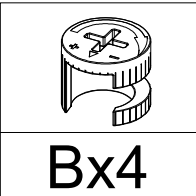
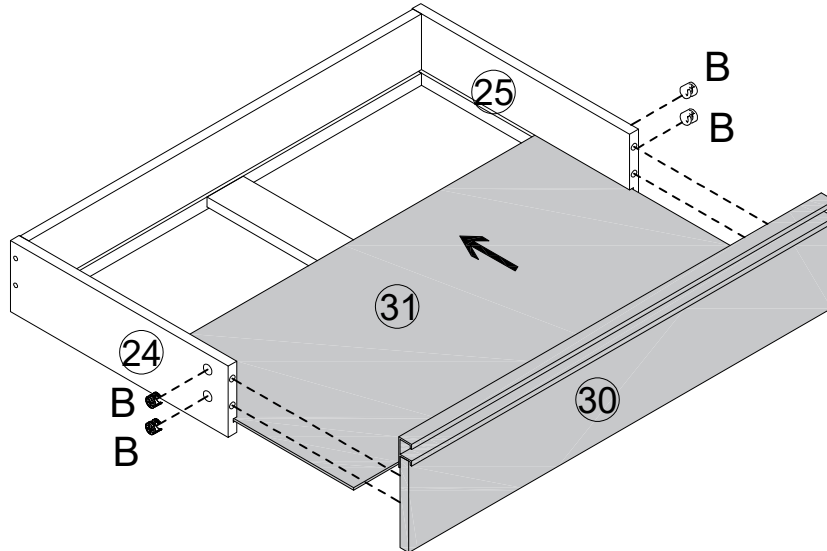
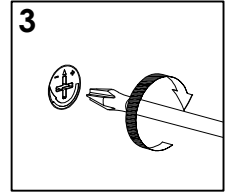
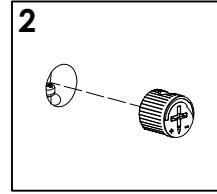
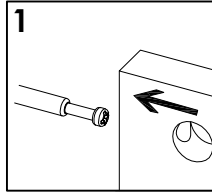
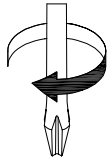

Cx5

# STEP35

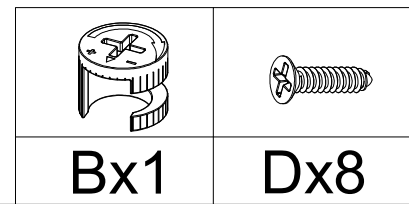
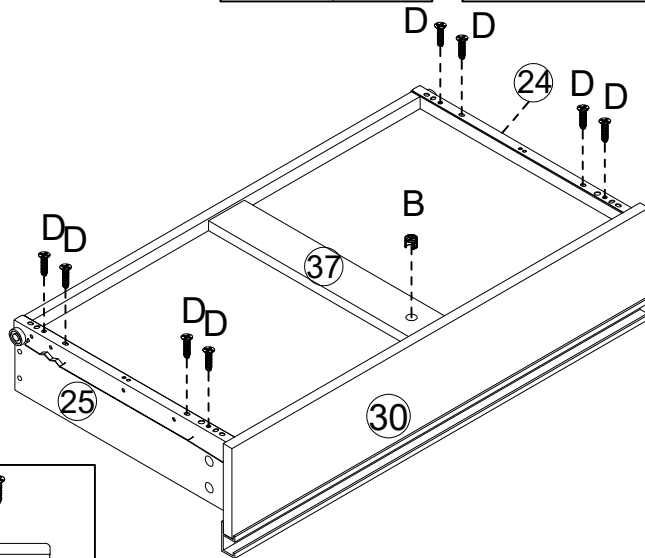
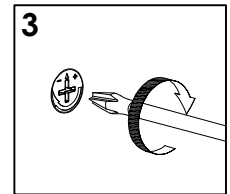
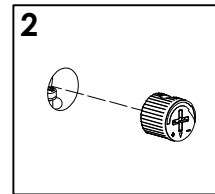
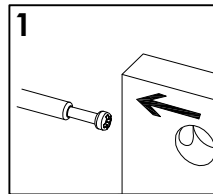
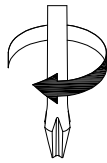

# STEP36



# STEP37x5

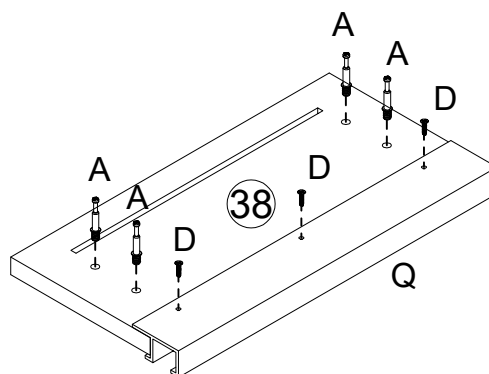
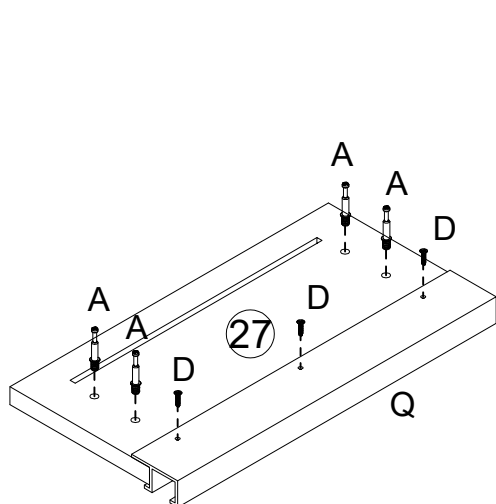
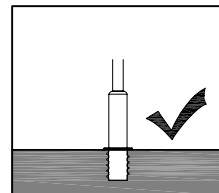
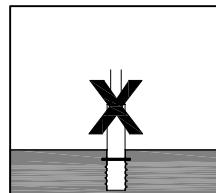
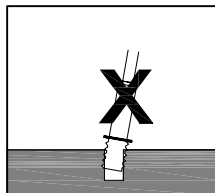
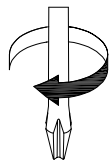

Ax40	Dx30	Qx10

# STEP38x10

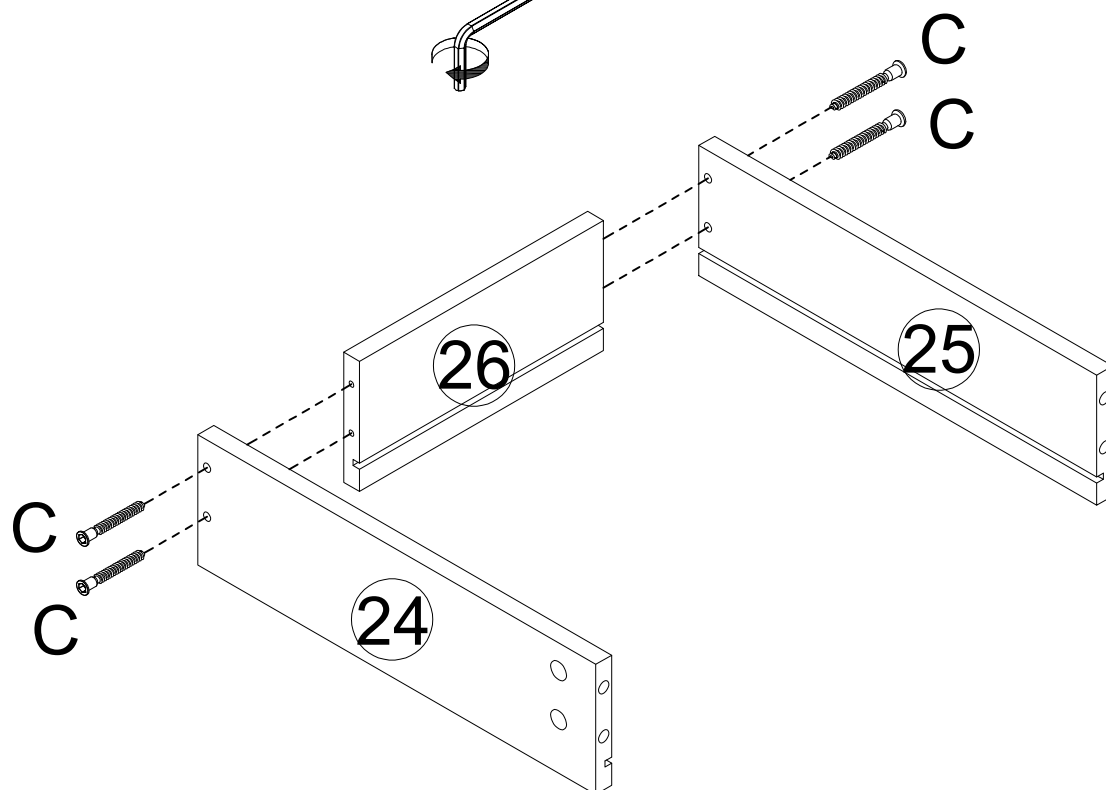
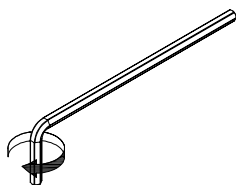

Cx40

# STEP39x5

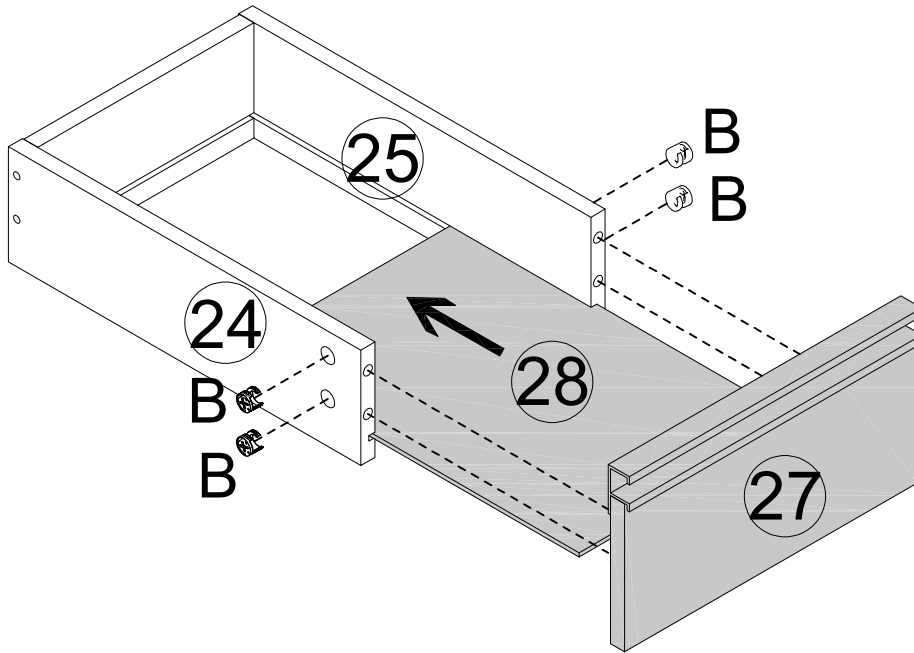
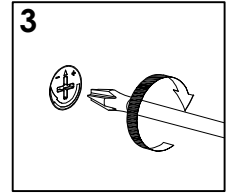
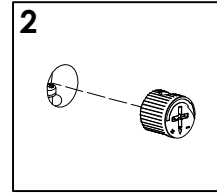
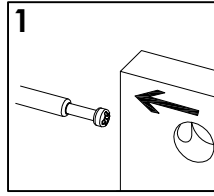
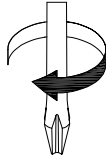

Bx20

# STEP40x5

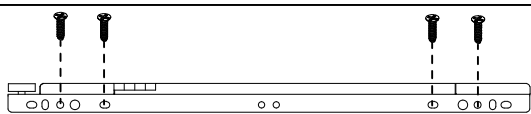
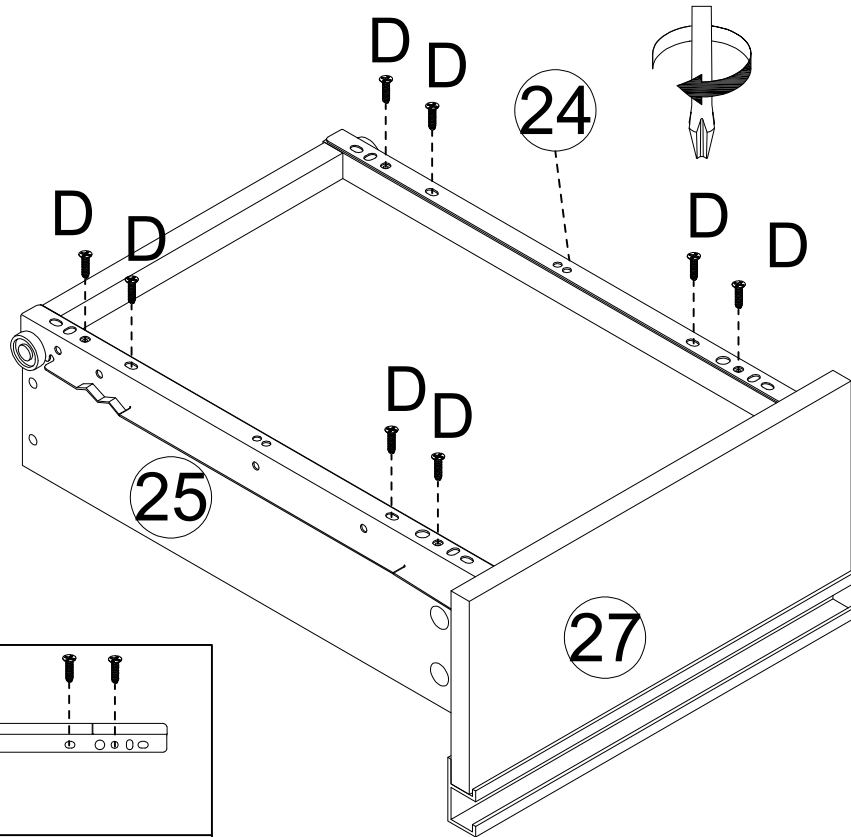

E-DLx5

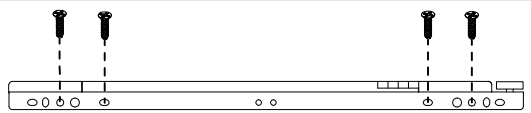

E-DRx5

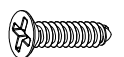

Dx40

# STEP41x5

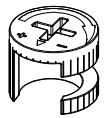
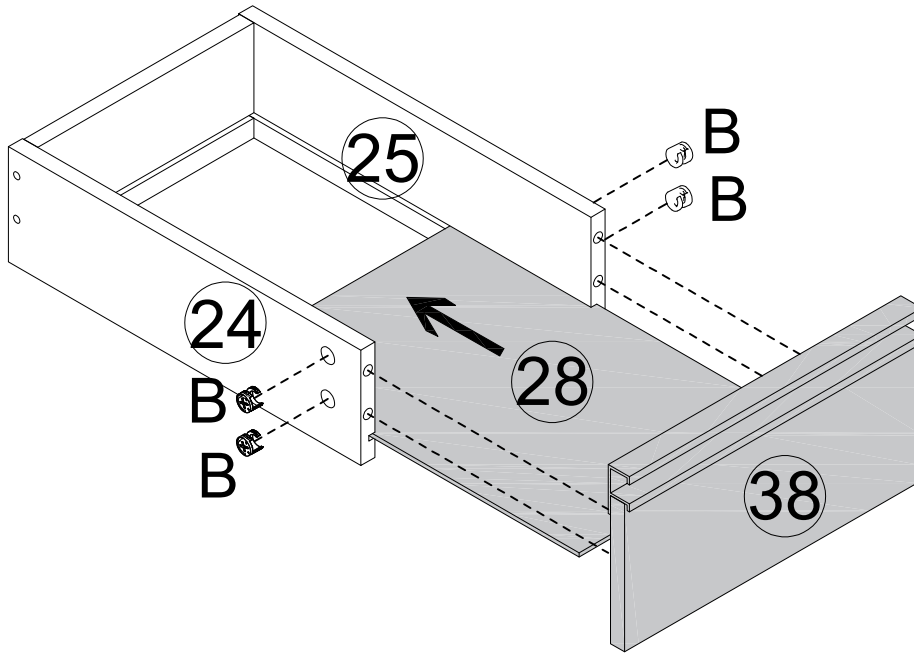
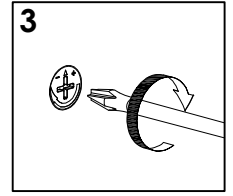
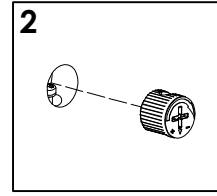
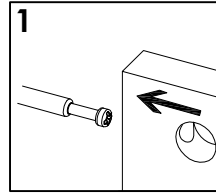
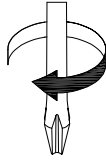

Bx20

# STEP42x5

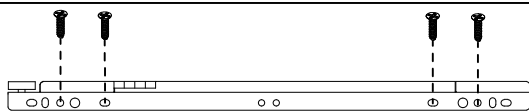
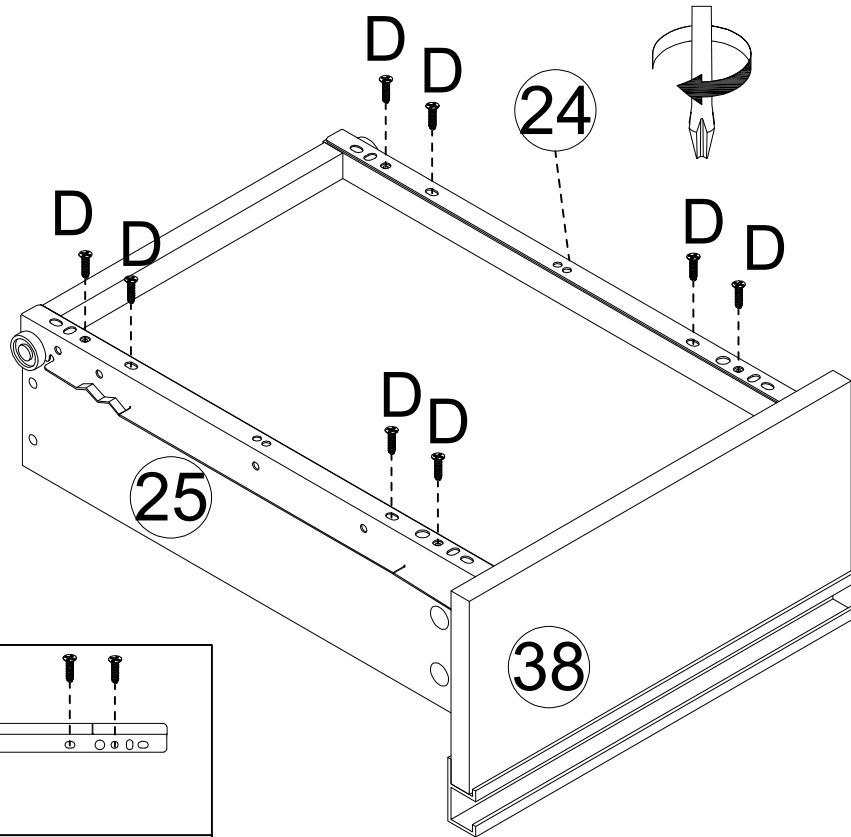

E-DLx5

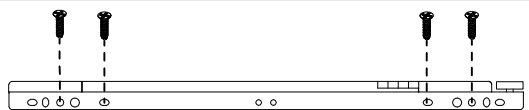

E-DRx5



Dx40

# STEP43

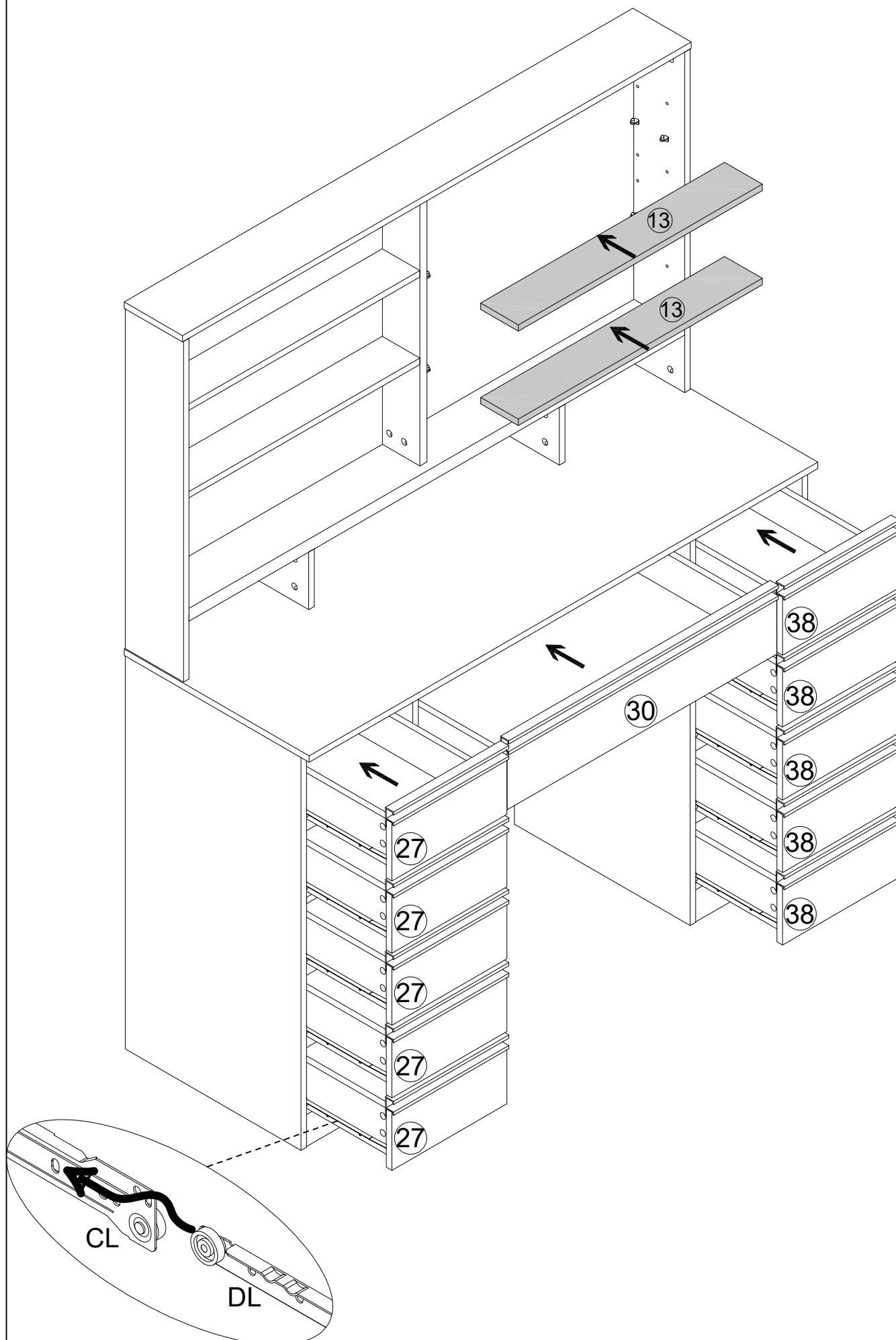

# STEP44

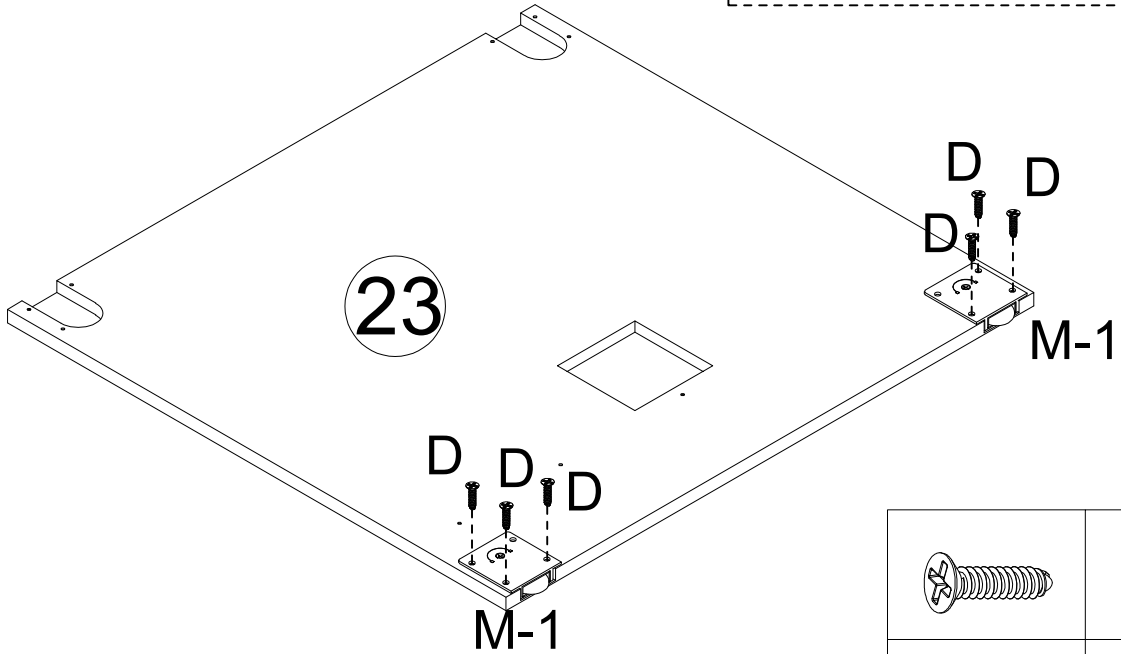
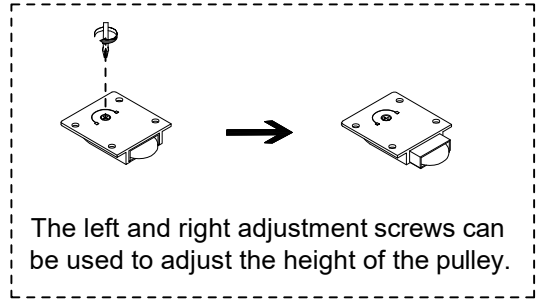
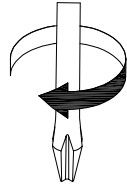

Dx6	M-1x2

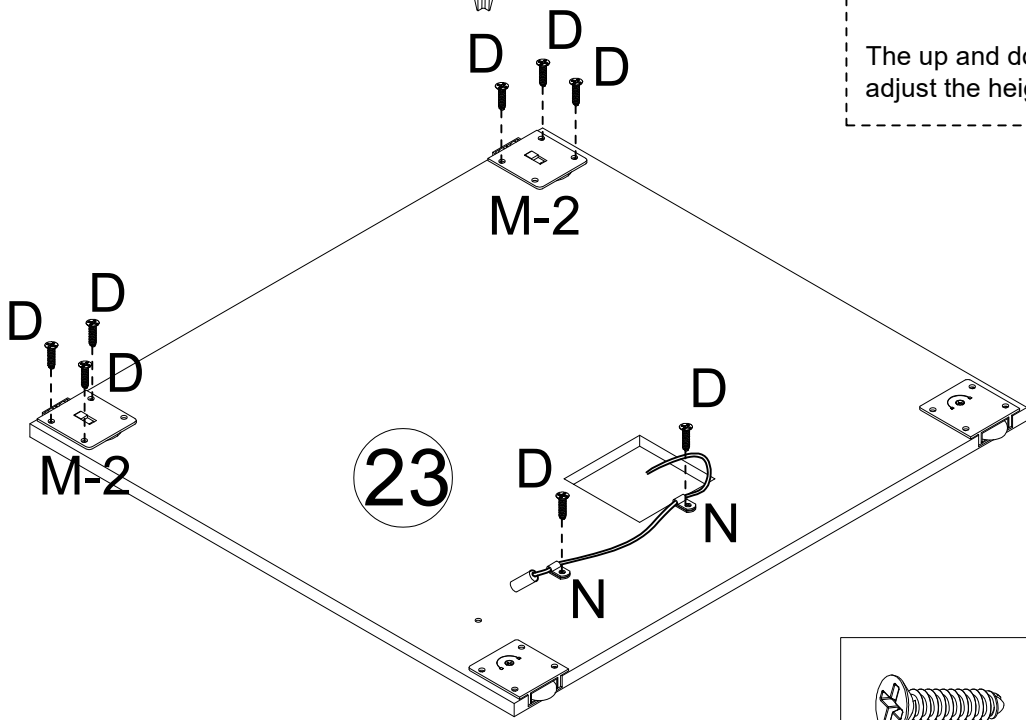
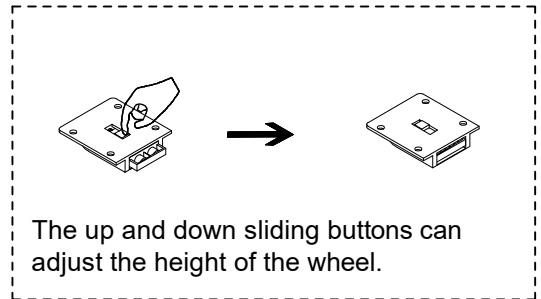
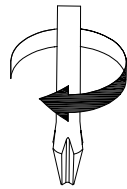

# STEP45

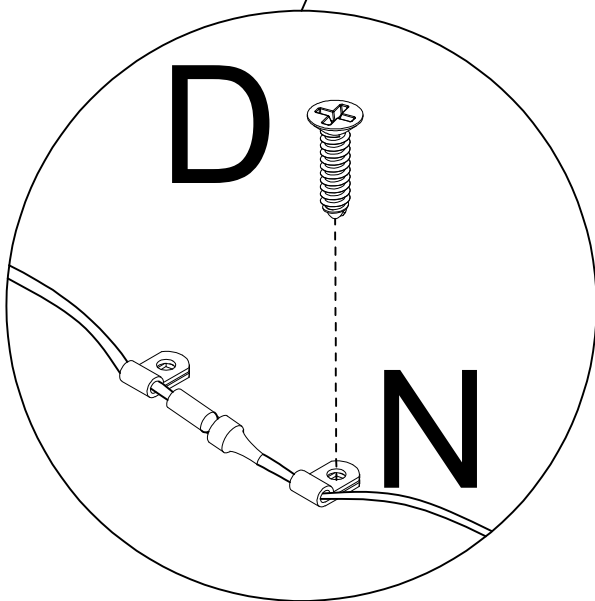
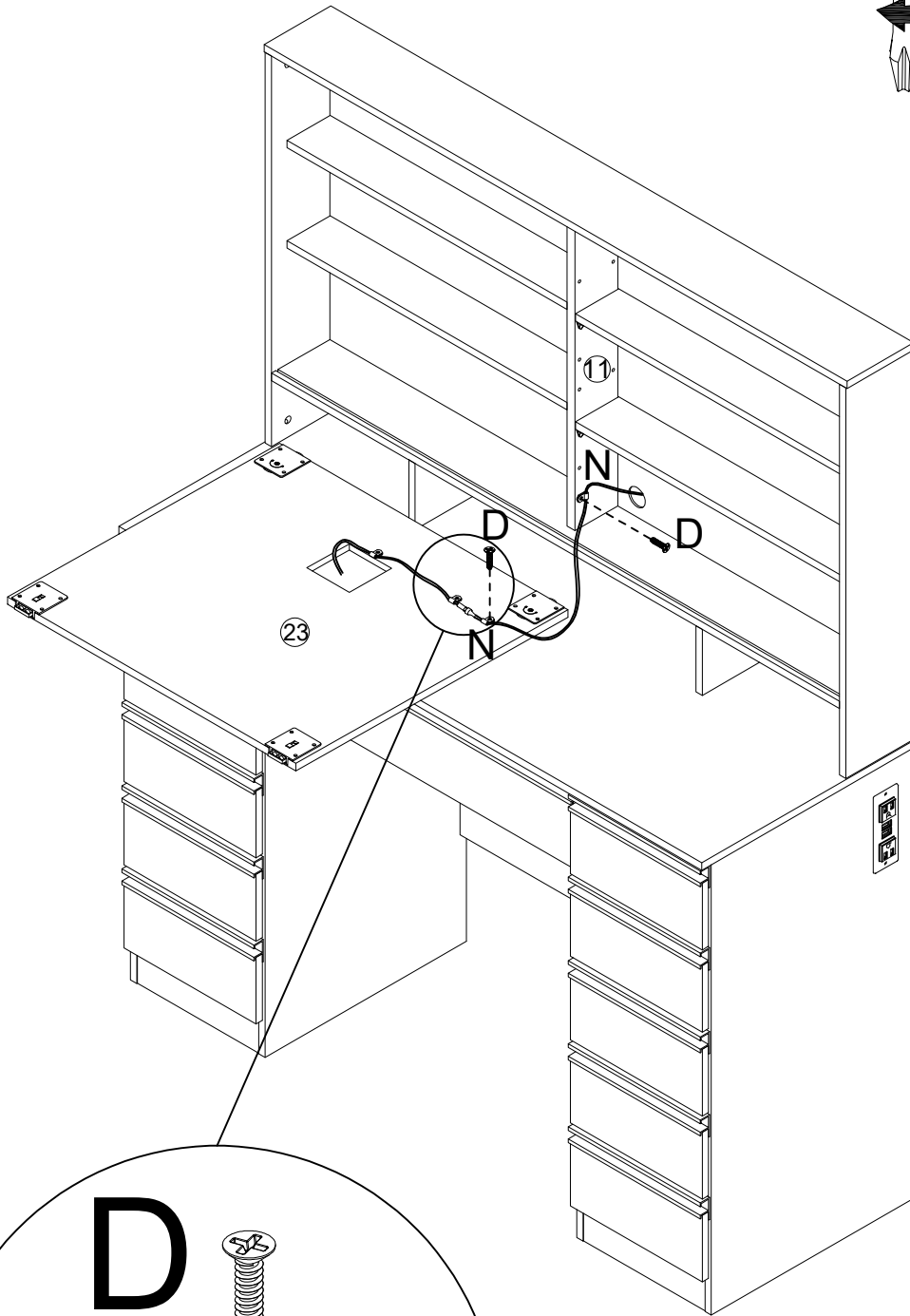
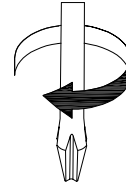

Dx8	M-2x2	Nx2

# STEP46

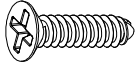

		
Dx2	Nx2	x1

## STEP47

First connect the power supply to the mirror panel light strip, then slot the mirror panel pulley into the groove.

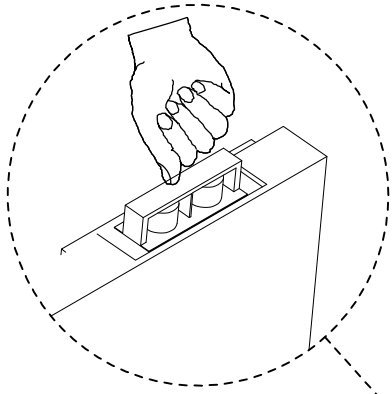

Press down the pulley when installing the mirror panel.

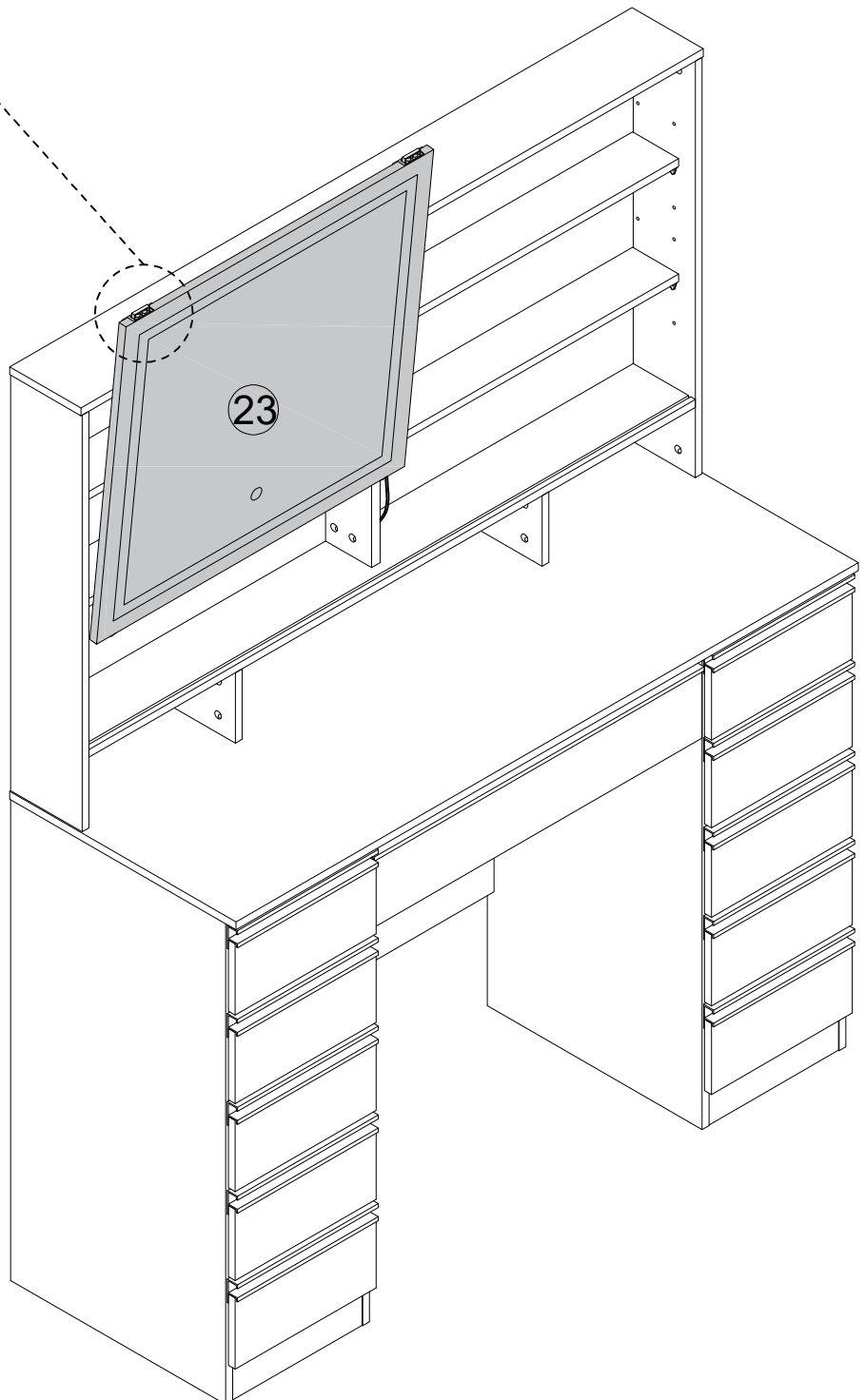

# STEP48

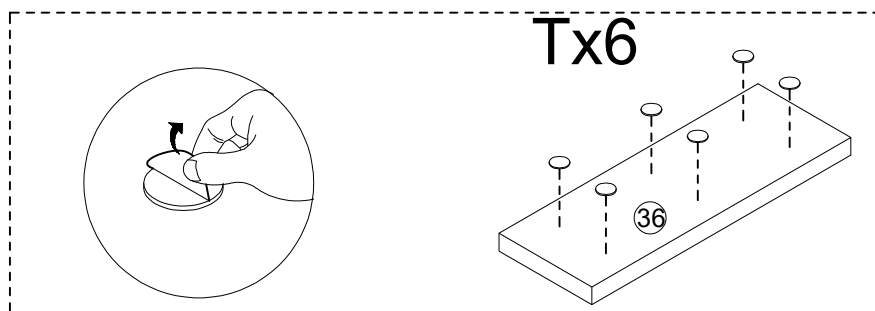

Peel off one side of the double-sided tape and stick it to the back of the jewelry box, then peel off the other side of the tape and stick the jewelry box onto the cabinet.

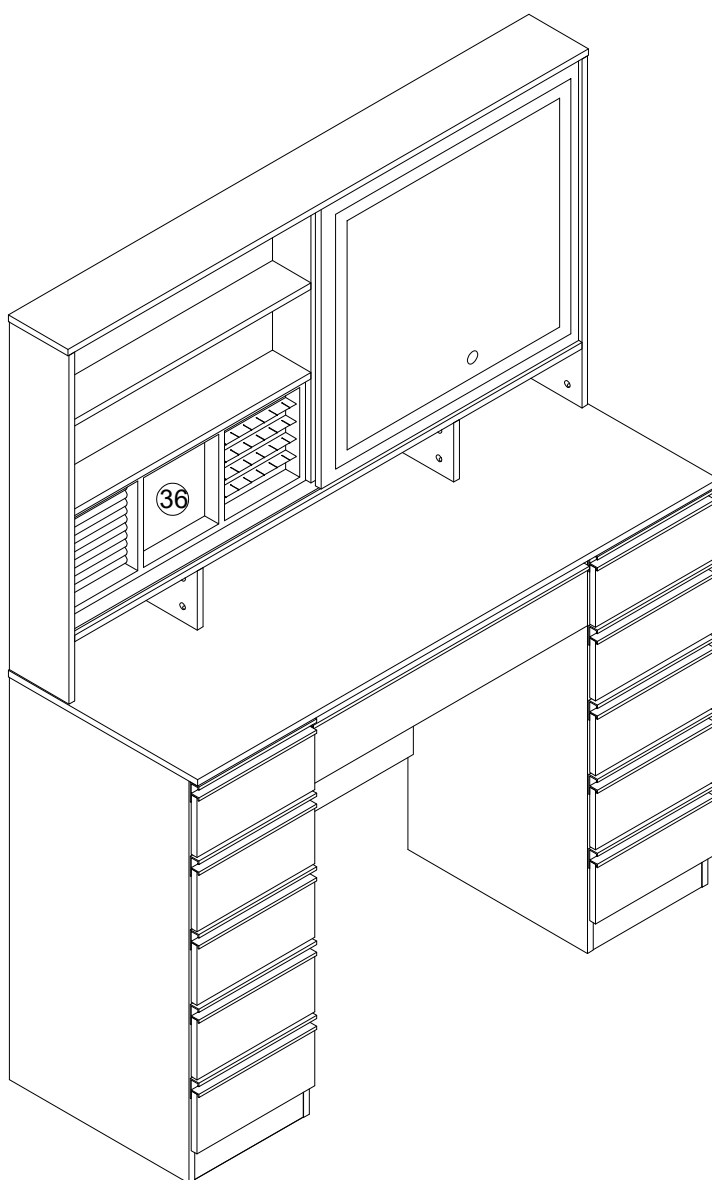

Tx6

# STEP49

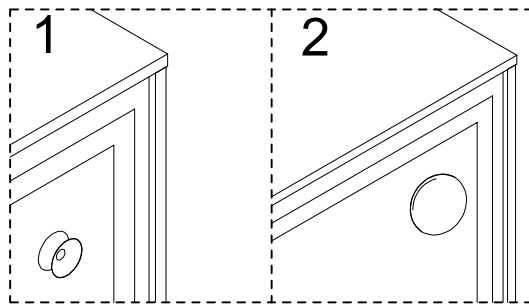

Place the suction cup on the mirror, then place the magnifying glass onto the suction cup.

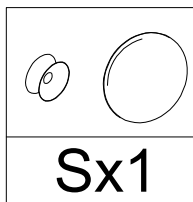
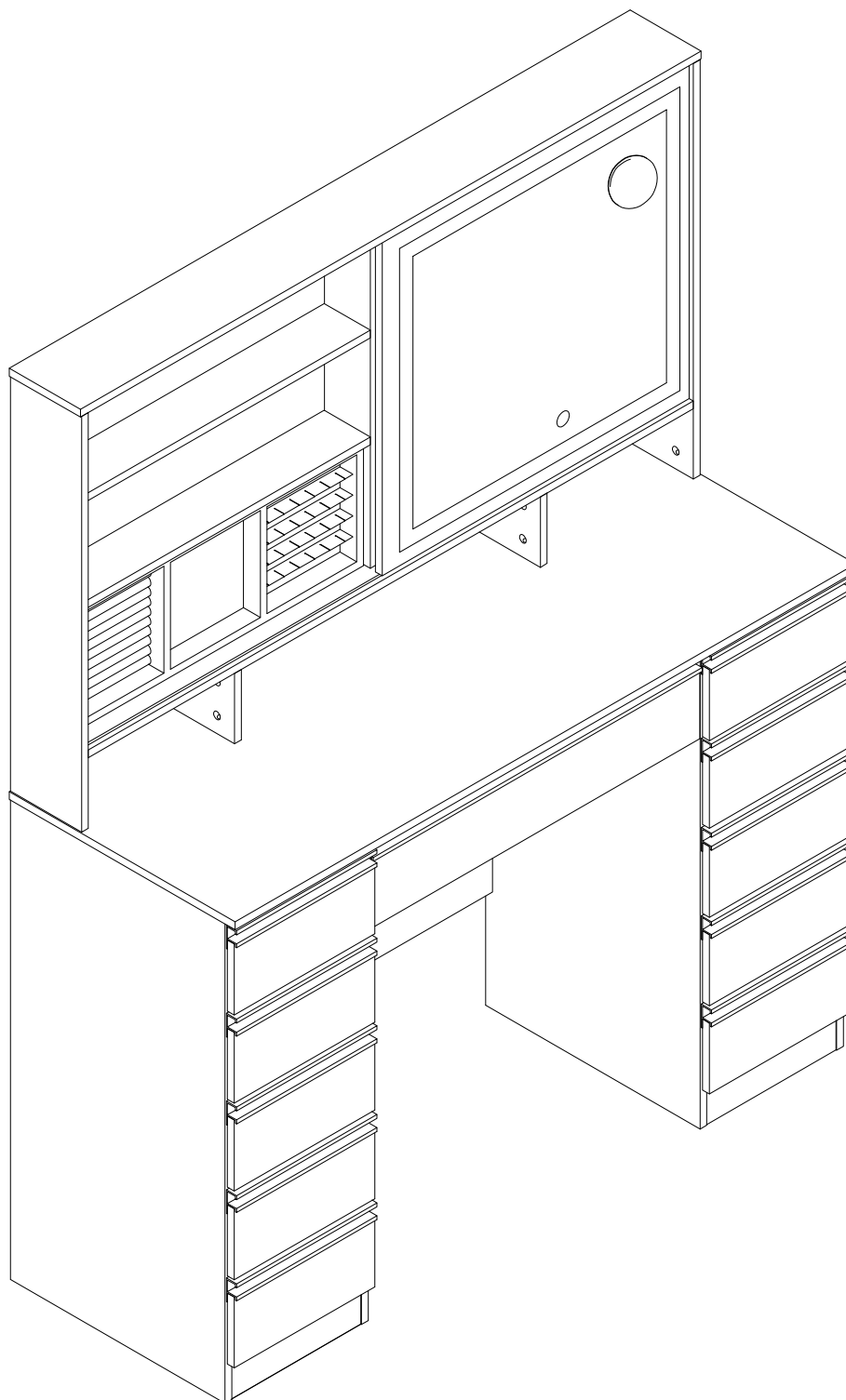

# STEP50

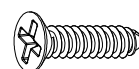
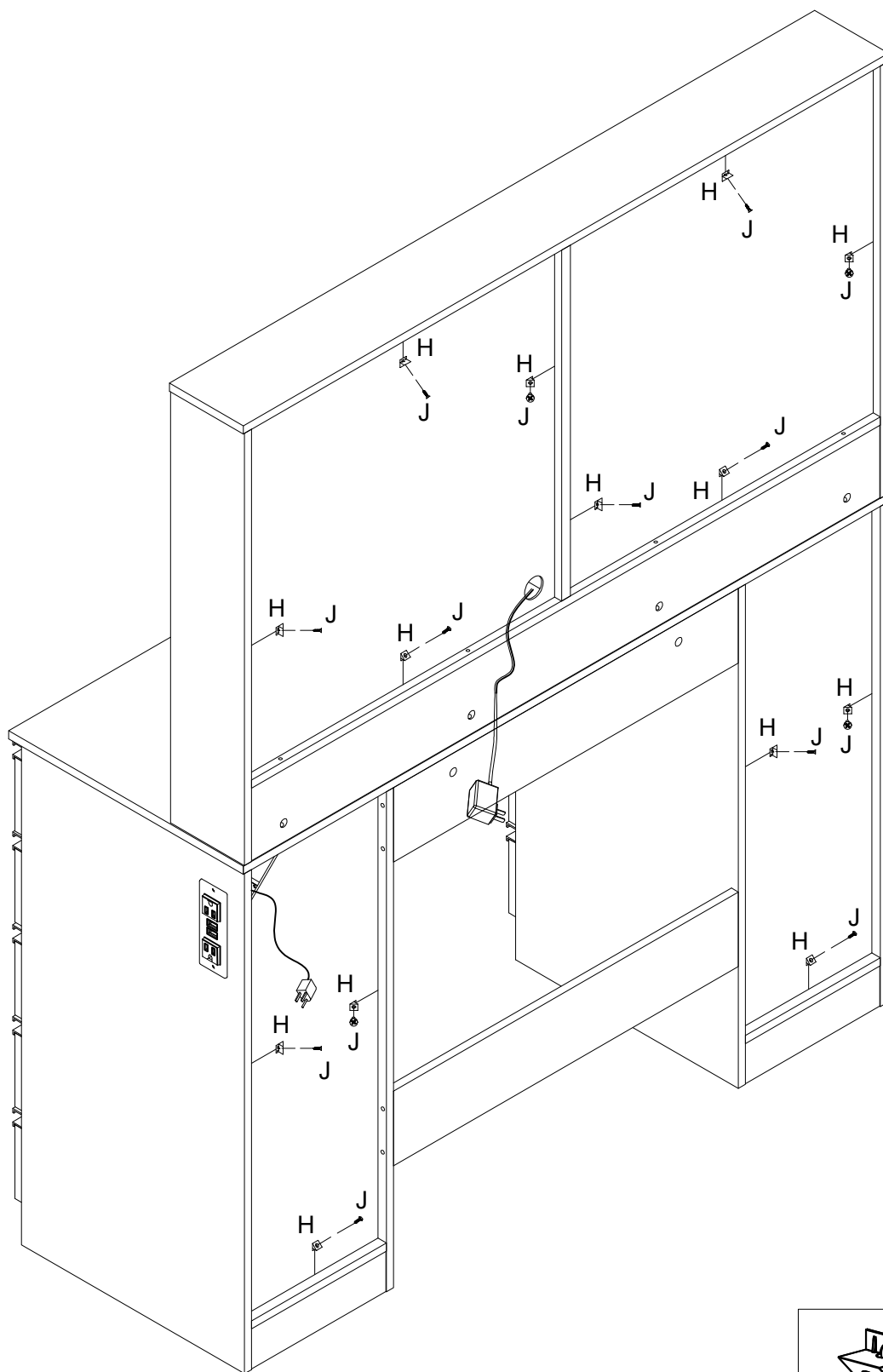
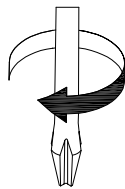

Hx14

Jx14

# STEP 51

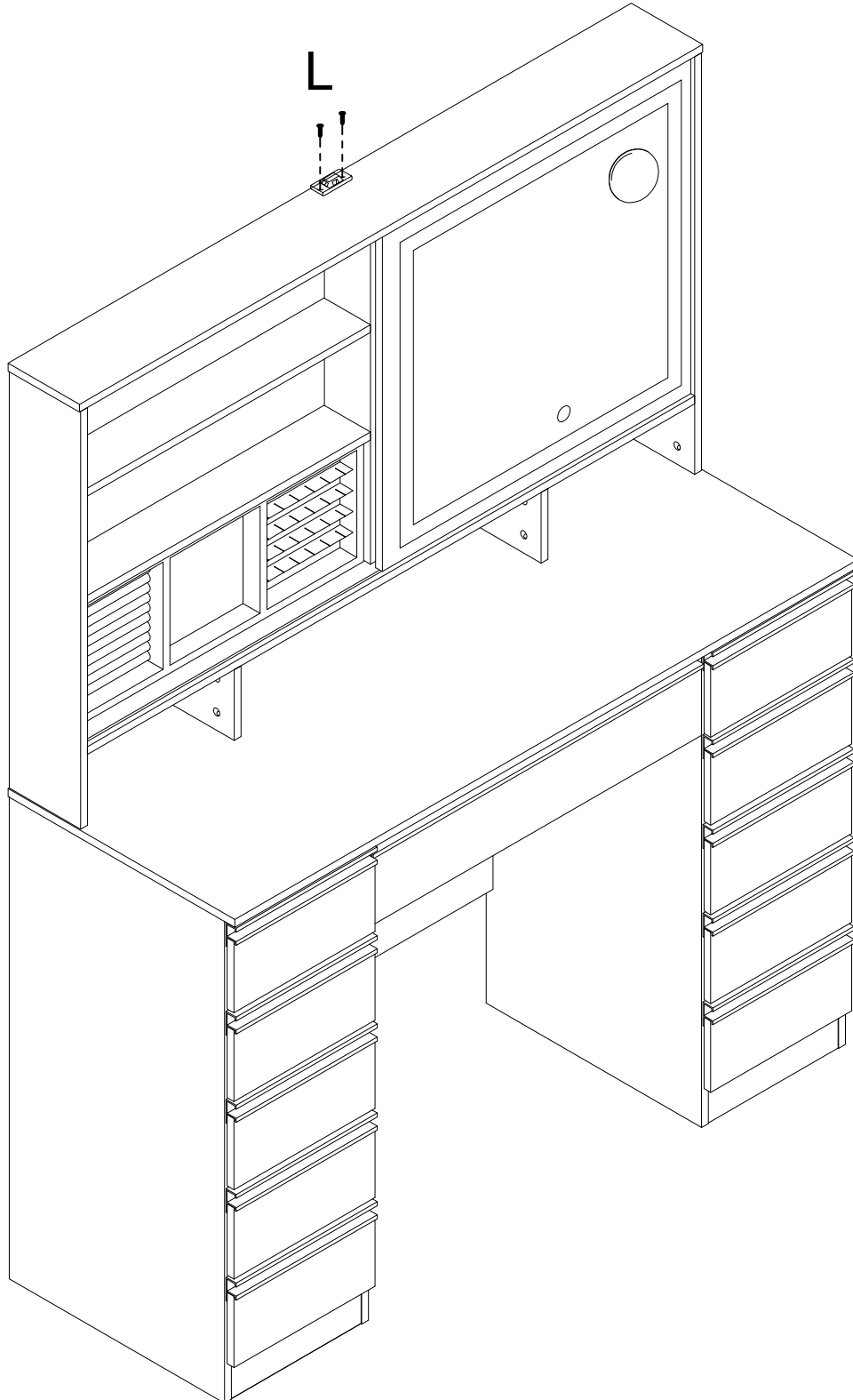
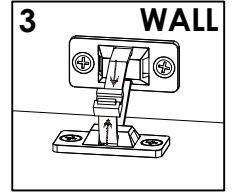
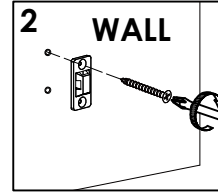
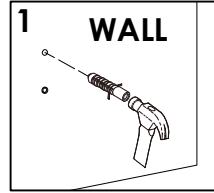
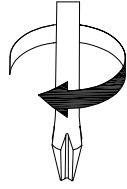

Lx1

# STEP52

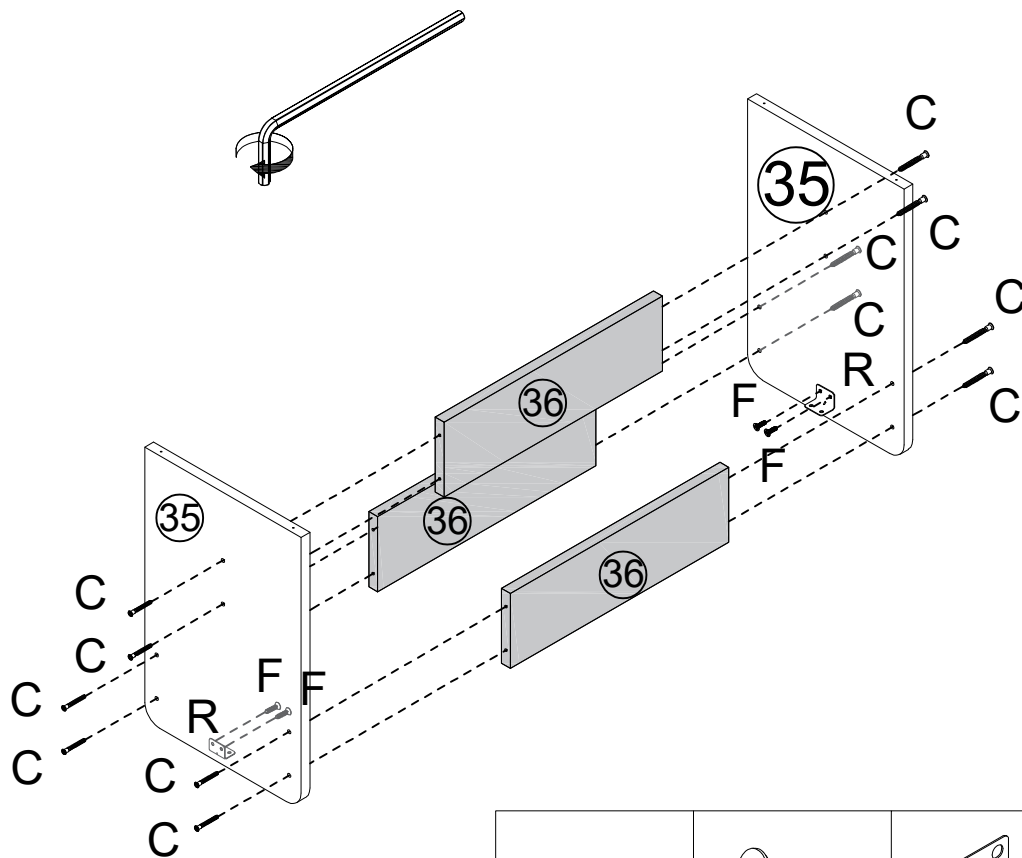
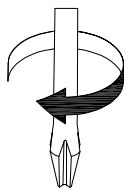

<b>Cx12</b>	<b>Fx4</b>	<b>Rx2</b>

# STEP53

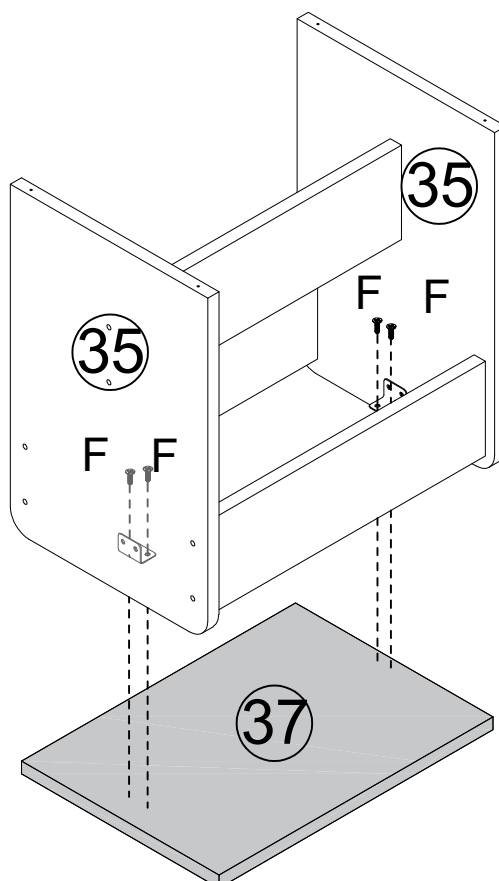
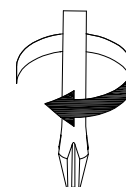

<b>Fx4</b>