

# Box List

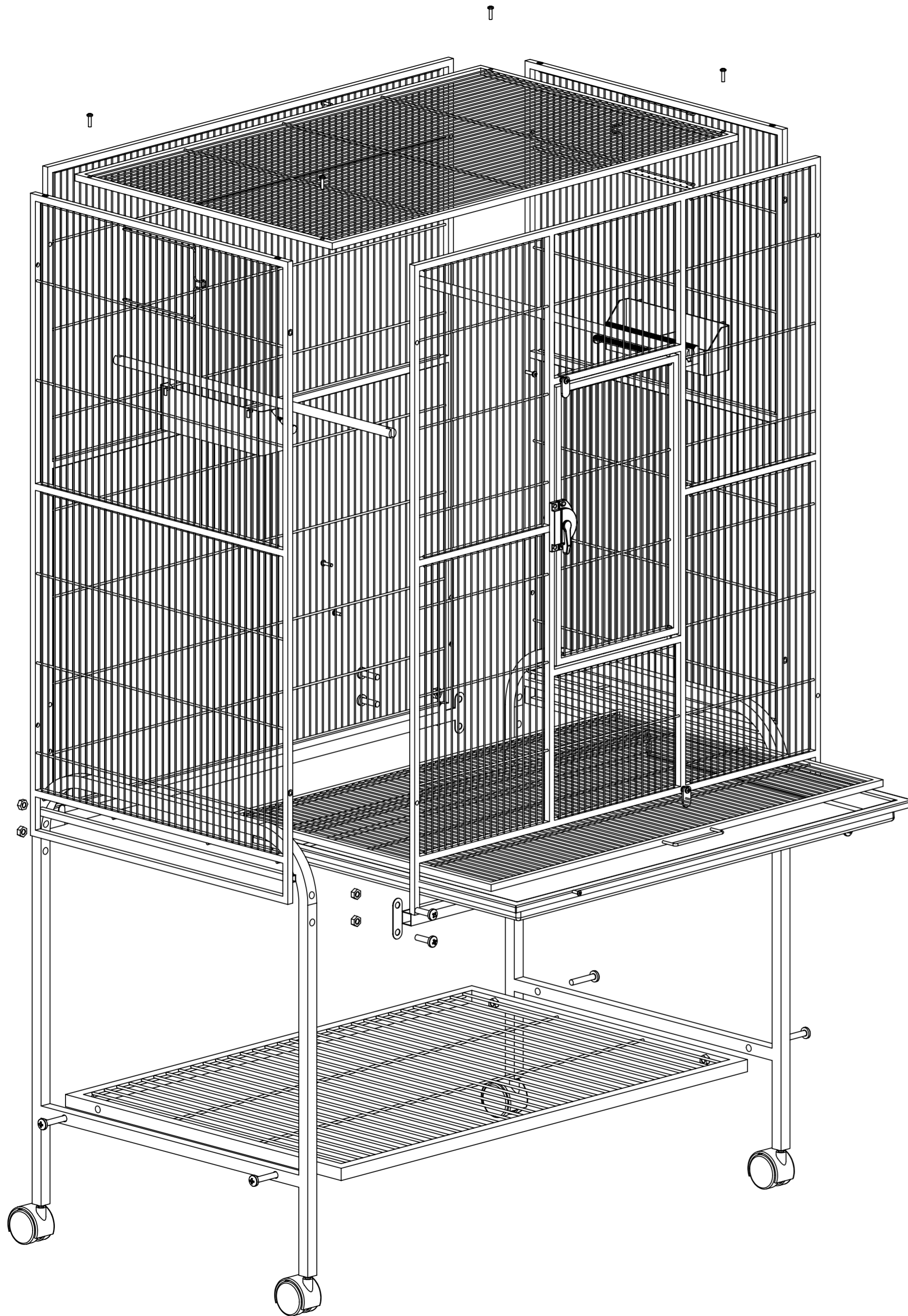

Box		Worker	Q C	ganger
Part name	Quantity			
Front wire(前网)	1pcs			
Back wire(后网)	1pcs			
Left wire(左网)	1pcs			
Right wire(右网)	1pcs			
Legs(脚框)	2pcs			
Horizontal tube(横管)	2pcs			
Grill(密网)	1pcs			
Top panel(wire)(盖网)	1pcs			
Bottom wire(脚网)	1pcs			
Plastic bottom(胶盆)	1pcs			
Plastic cup(胶杯)	2pcs			
Perch(木棍)	2pcs			
Wheels(2寸8厘脚轮)	4pcs			
Assembly Instructions(包装图)	1pcs			
Screw bag(螺丝包)	1pcs			

1. Screw wheels onto bottom of left & right legs ;
2. Attach the bottom wire to the left & right legs together with screws;
3. Attach tube to left & right legs with screws to form a stand;
4. Assembly front wire、back wire、left wire and right wire together with screws to form a cage body;
5. Assembly top wire on top of the cage body with screws;
6. Put the cage body on the stand ;
7. Slide the grill & tray into the bottom of the cage body;
8. Put the plastic feeder cup and perch in the appropriate position of the cage body.