

ASSEMBLY INSTRUCTIONS

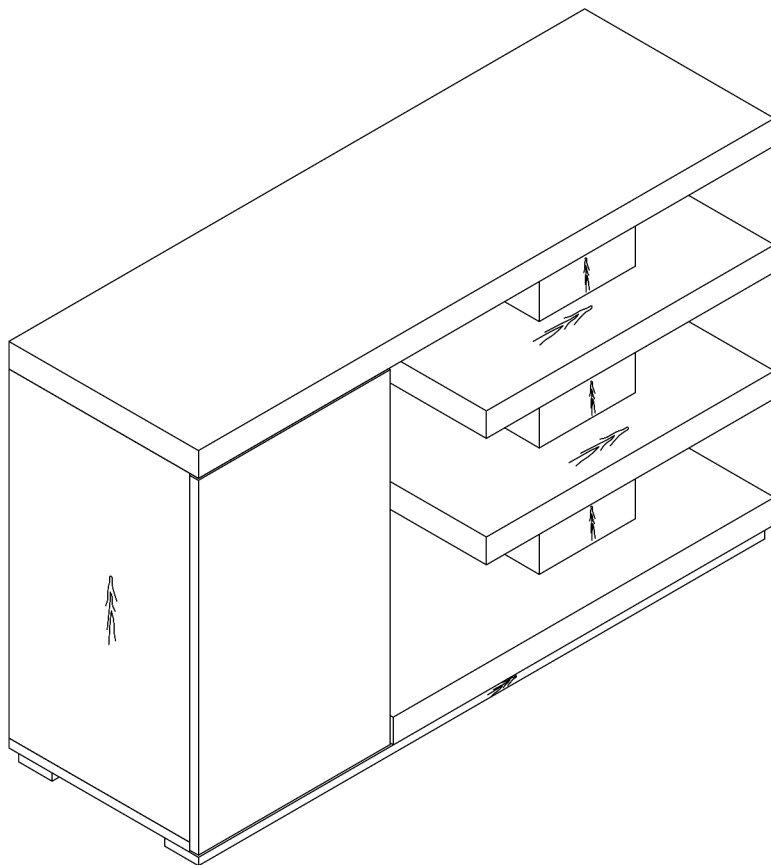

TOOLS REQUIRED

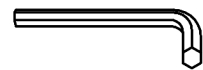

Allen Wrench

(Included)

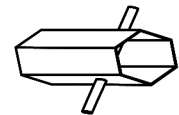

Socket Wrench

(Included)



**2 - Persons
Recommended**

ASSEMBLY RATING



EASY ————— DIFFICULT

The Assembly Rating is a 5-point system showing the level of effort needed to assemble a specific product.



CHECK BEFORE STARTING

☐

Are you missing anything?

Double-check all parts, hardware and accessories listed on Page 6 are accounted for.

☐

Check out our Quick Tips!

We recommend reviewing the pre-assembly handouts. Even experts need a refresher now and then!

☐

Should we send any replacements?

Are there any irregularities or flaws in the parts? We can send replacements!

☐

Prep Time!

Please review the assembly instructions and all diagrams prior to assembling. Arrange parts as recommended on Page 7 and group identical hardware together to make assembling easier.

PRE ASSEMBLY INTRODUCTION

We understand building ready-to-assemble furniture can be a challenging experience for some. To help avoid confusion, we have provided some helpful tips that may speed up the process.



Teamwork

ALWAYS have at least two people to help with transporting and assembling the product to avoid potential injury and/or damage.



Suitable Location

Assembling near the area of the intended location is highly recommended.



Sufficient Space

Make sure you have enough space to move around during the assembly.

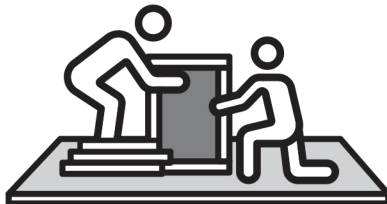

Avoid Scratches

Use cardboard, blankets or a carpeted area while assembling furniture to prevent scratches.

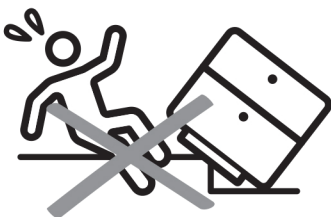

Flat Surface

Make sure the furniture rests on a flat and level surface with each leg evenly touching the floor.

ASSEMBLY AND CARE ADVICE



**FAILURE TO FOLLOW THE GUIDELINES BELOW MAY
RESULT IN INJURY AND/OR PROPERTY DAMAGE.**



Position each part correctly
and insert screws or bolts into
their respective holes.

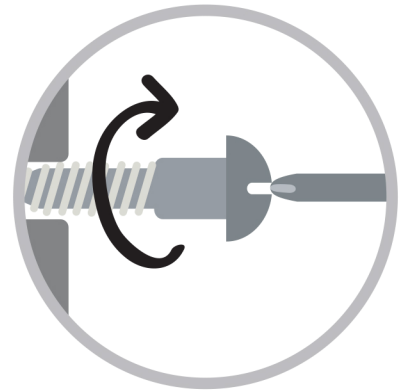

Turn clockwise to tighten and
only tighten when step is
completed or when instructed
to do so.



Use the appropriate hand tools
or power tools for assembly.
Select steps, such as tightening
screws and/or bolts, may require
hand tools to avoid causing
damage during assembly.



Save the instructions and store
any supplied tools for later
maintenance.

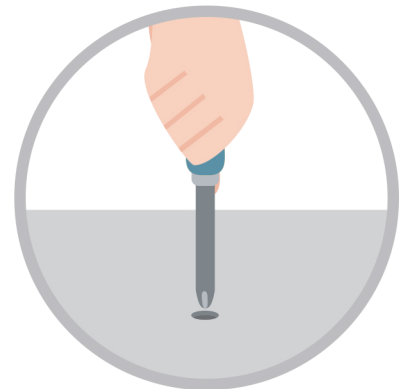

After two weeks, check and
tighten any loose hardware and
repeat again every six months
thereafter.

IT IS THE USER'S RESPONSIBILITY TO MAINTAIN THE FURNITURE. THE HARDWARE MAY LOOSEN OVER TIME AND MAY CAUSE THE FURNITURE TO BE WOBBLY AND UNABLE TO SUPPORT ITS INTENDED WEIGHT CAPACITY. THIS MAY LEAD TO COLLAPSE AND MAY CAUSE SERIOUS INJURY.

CAM LOCK FASTENER ASSEMBLY INSTRUCTIONS

Note :

Every cam lock bolt must have a cam lock connector in order to fasten the parts together.

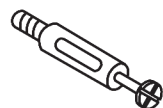

cam bolt



cam lock

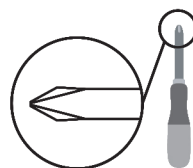

screwdriver

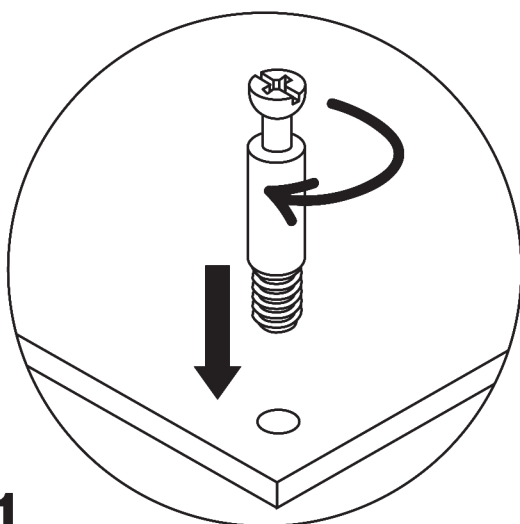

1

Screw the cam bolt into panel.

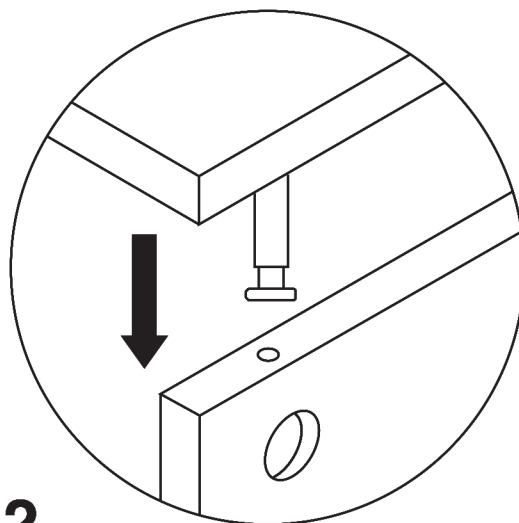

2

Insert the cam bolt into the bolt hole of joint panel.

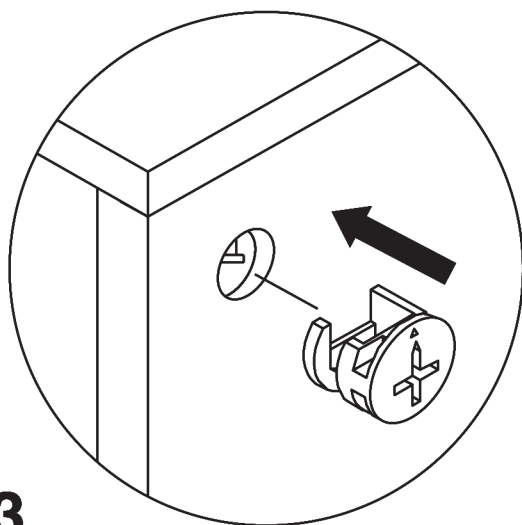

3

Align the cam lock with its side opening (or arrow) pointing to cam bolt.

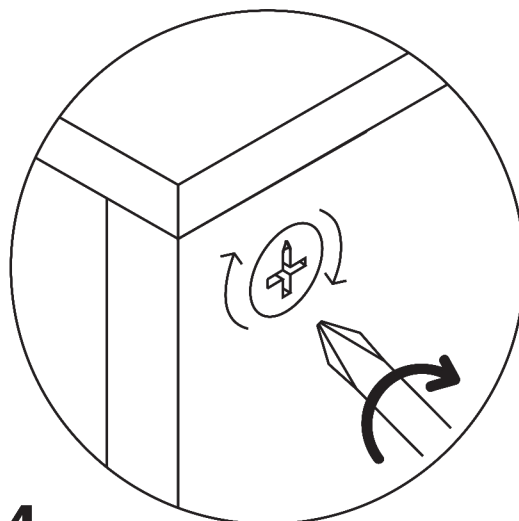

4

Turn the cam lock clockwise gently until it will not turn any more.

SOFA TABLE



- Please keep instructions for future reference.
- Check the quantity and irregularity of parts and hardware before you start.

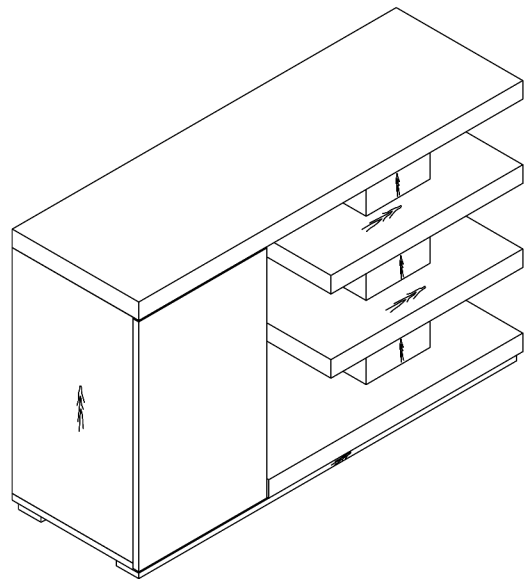

PARTS

#1 1pc

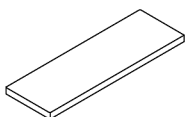

Wooden top

#2 1pc



Cabinet door

#3 1pc



Left board

#4 1pc



Mid board

#5 1pc

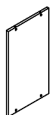

Back board

#6 2pcs



Left-layer board

#7 1pc

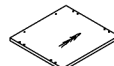

Left-bottom board

#8 3pcs



Post

#9 2pcs



Right-layer board

#10 1pc

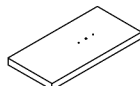

Right-bottom board

#11 1pc

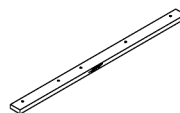

Supporting
batten-back

#12 1pc

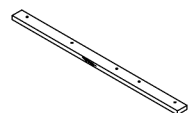

Supporting
batten-front

SOFA TABLE



- Please keep instructions for future reference.
- Check the quantity and irregularity of parts and hardware before you start.

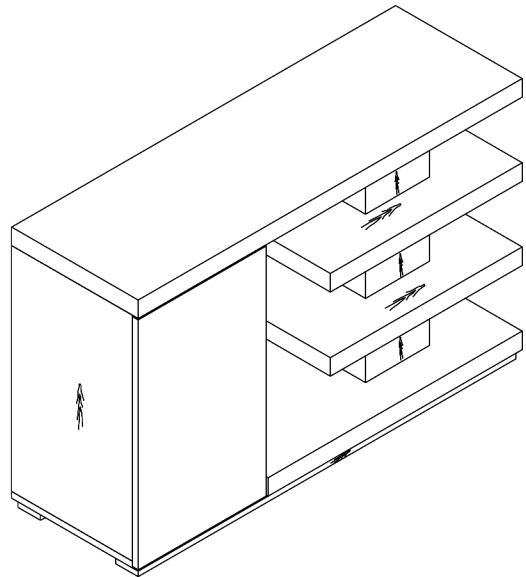

HARDWARE

#A 10pcs



Bolt 1/4" X 1-5/8"

#B 1pc

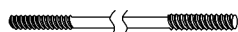

Rod 1/4"x28"

#C 1pc



Washer

#D 1pc



Nut M6

#E 28pcs



Ø6x30

#F 16pcs

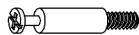

Cam Bolt M6x40

#G 16pcs



Cam Lock Ø14.5x11

#H 4pcs

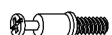

Cam Bolt M6x24

#I 4pcs



Cam Lock Ø12x10.5

#J 6pcs



Adjustable Foot
M6 x 16

#K 1pc

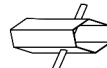

Socket Wrench
M6

#L 1pc

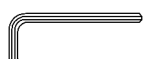

Allen Wrench M4

#M 18pcs



Screw M4

#N 3pcs



Pipe hinges

ASSEMBLY INSTRUCTIONS

Exploded View

1

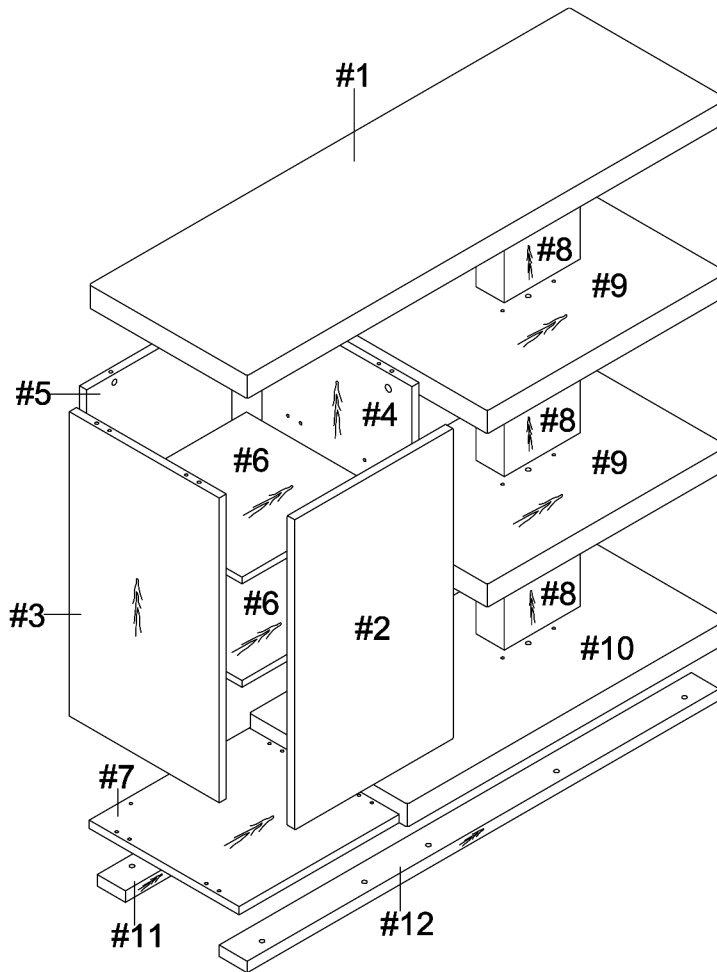

2

- Part #3 x 1pc
- Part #4 x 1pc
- Part #6 x 2pcs
- Hardware #E x 12pcs
- Hardware #F x 8pcs
- Hardware #G x 8pcs

1) Secure and attach cam bolts (#F) and dowels (#E) to left and mid boards (#3,4).

2-3

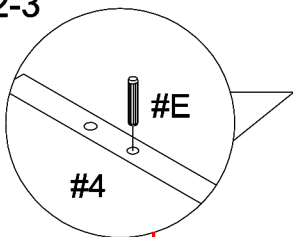

3) Insert dowels (#E) to left and mid boards (#3,4).

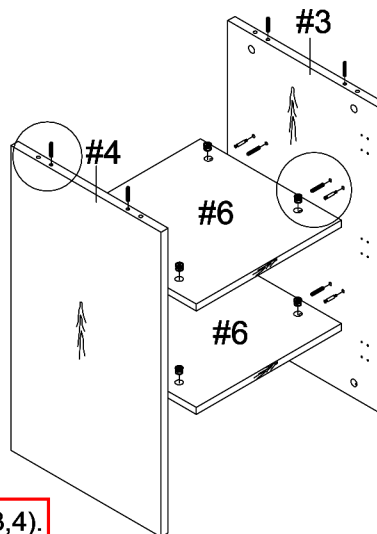

2-1

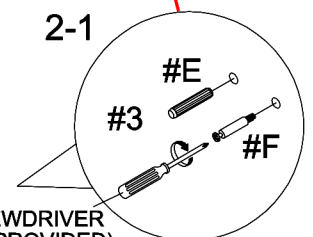

SCREWDRIVER
(NOT PROVIDED)

2-2

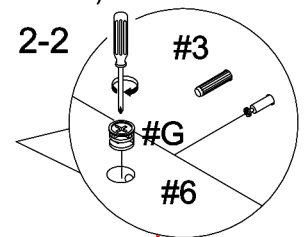

2) Align layer boards (#6) to the left and mid boards (#3,4), then secure by using cam locks (#G).

ASSEMBLY INSTRUCTIONS

3

Part **#1** x 1pc
 Part **#7** x 1pc
 Hardware **#E** x 4pcs
 Hardware **#F** x 8pcs
 Hardware **#H** x 4pcs

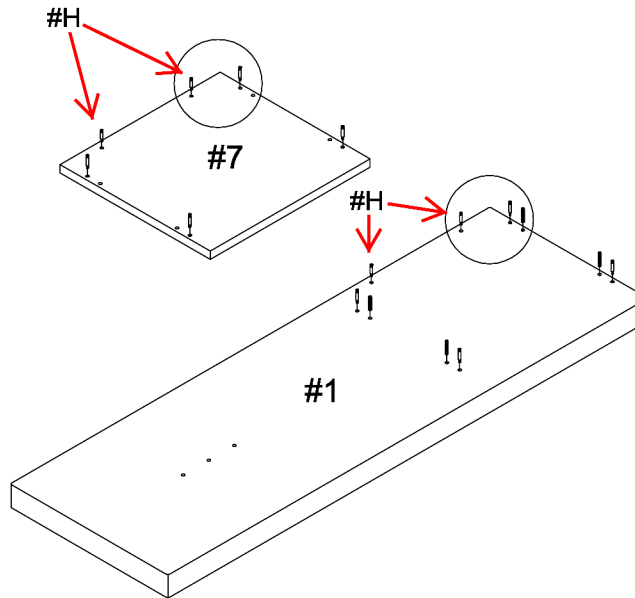

1) Secure cam bolts (#F,H) onto bottom board (#7).

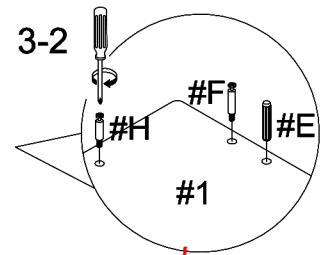
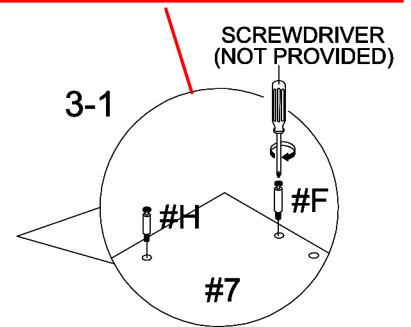

2) Secure cam bolts (#F,H) and dowels (#E) onto top (#1).

4

Part **#3** x 1pc
 Part **#4** x 1pc
 Part **#5** x 1pc
 Part **#7** x 1pc
 Hardware **#G** x 4pcs
 Hardware **#I** x 2pcs

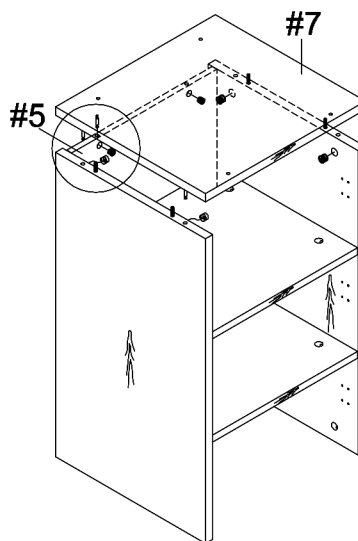

Align bottom board (#7) to built product, then secure cam bolts (#H) by using smaller cam locks (#I) and cam bolts (#F) by using larger cam locks (#G).

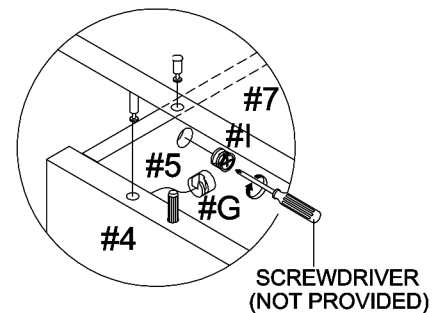

ASSEMBLY INSTRUCTIONS

5

- Part **#1** x 1pc
- Part **#3** x 1pc
- Part **#4** x 1pc
- Part **#5** x 1pc
- Hardware **#G** x 4pcs
- Hardware **#I** x 2pcs

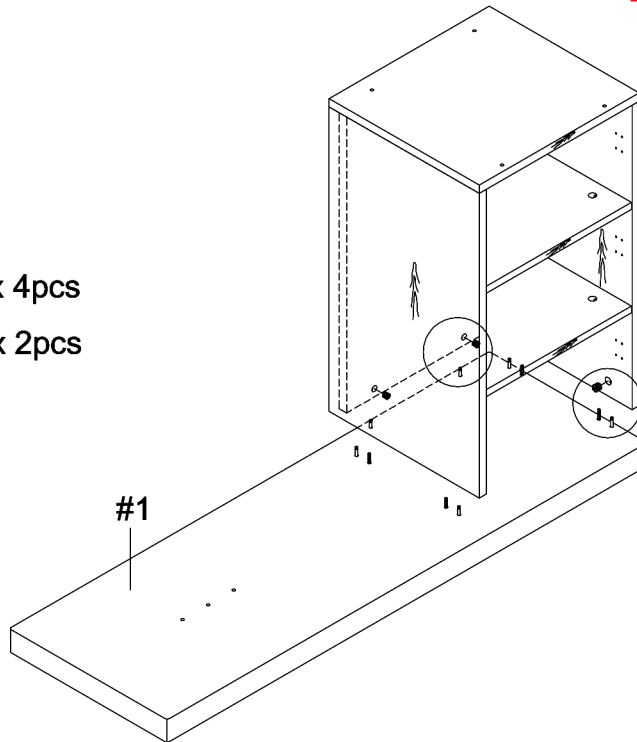

Align built product to top (#1), then secure cam bolts (#H) by using smaller cam locks (#I) and cam bolts (#F) by using larger cam locks (#G).

5-1

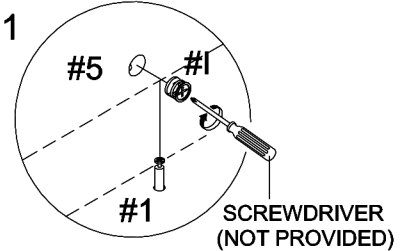

5-2

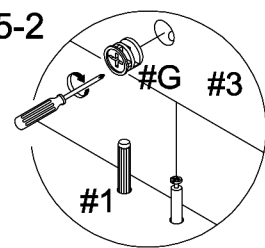

6

- Part **#2** x 1pc
- Part **#3** x 1pc
- Hardware **#M** x 18pcs
- Hardware **#N** x 3pcs

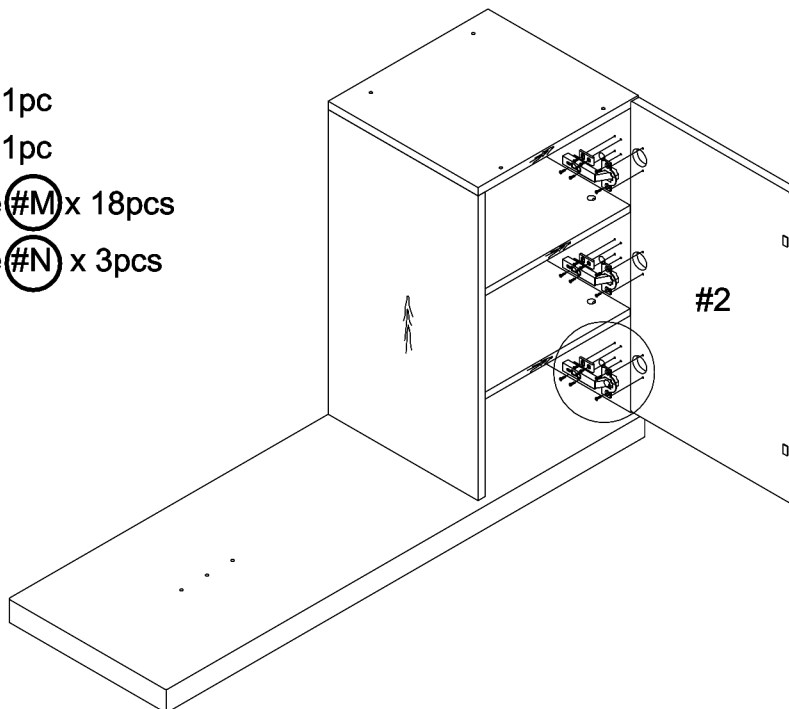

Align hinges (#N) to the built product and door (#2), then secure by using screws (#M).

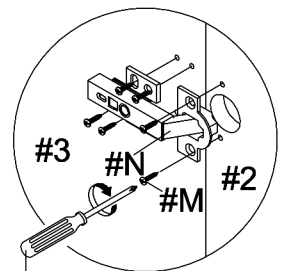

SCREWDRIVER
(NOT PROVIDED)

ASSEMBLY INSTRUCTIONS

7

- Part #1 x 1pc
- Part #8 x 3pcs
- Part #9 x 2pcs
- Hardware #B x 1pc
- Hardware #E x 12pcs

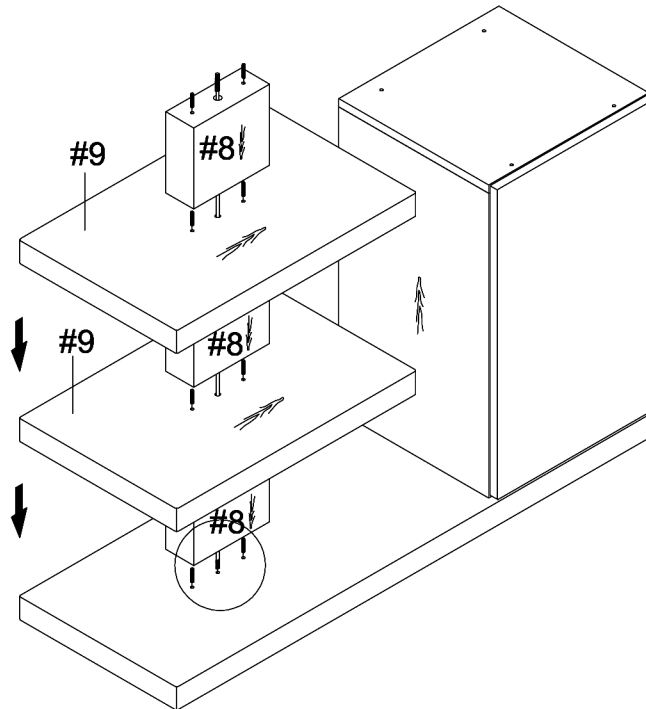

Secure rod (#B) to built product, then insert dowels (#E) to posts (#8) as you stack it with the layer boards (#9).

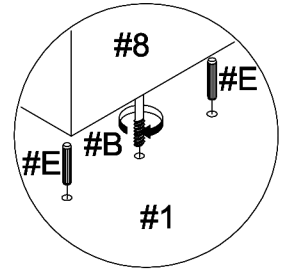

8

- Part #8 x 1pc
- Part #10 x 1pc
- Hardware #C x 1pc
- Hardware #D x 1pc

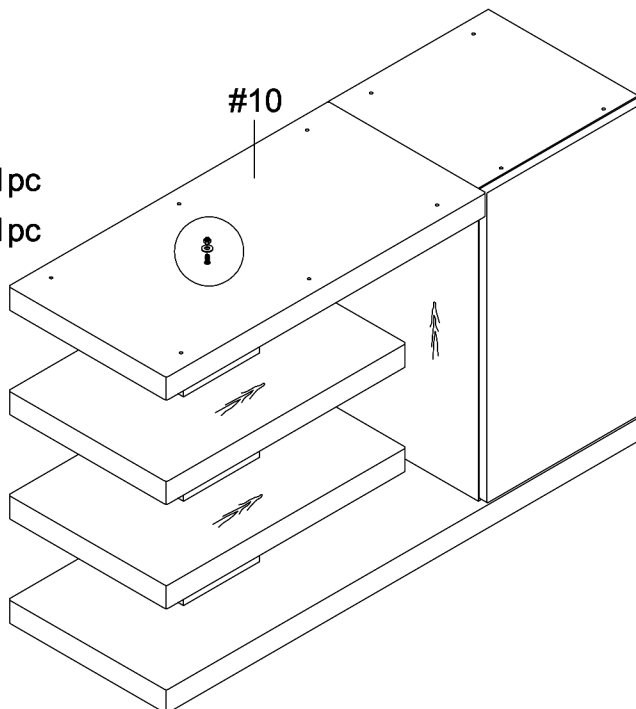

Align bottom board (#10) to the built product, then secure by using hex nut (#D) with washer (#C) onto rod.

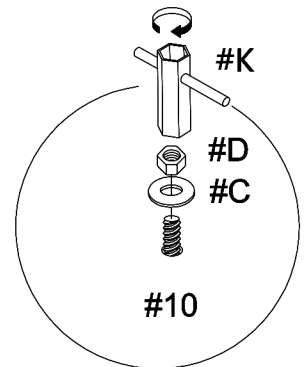

ASSEMBLY INSTRUCTIONS

9

- Part #7 x 1pc
- Part #10 x 1pc
- Part #11 x 1pc
- Part #12 x 1pc
- Hardware #A x 10pcs
- Hardware #J x 6pcs

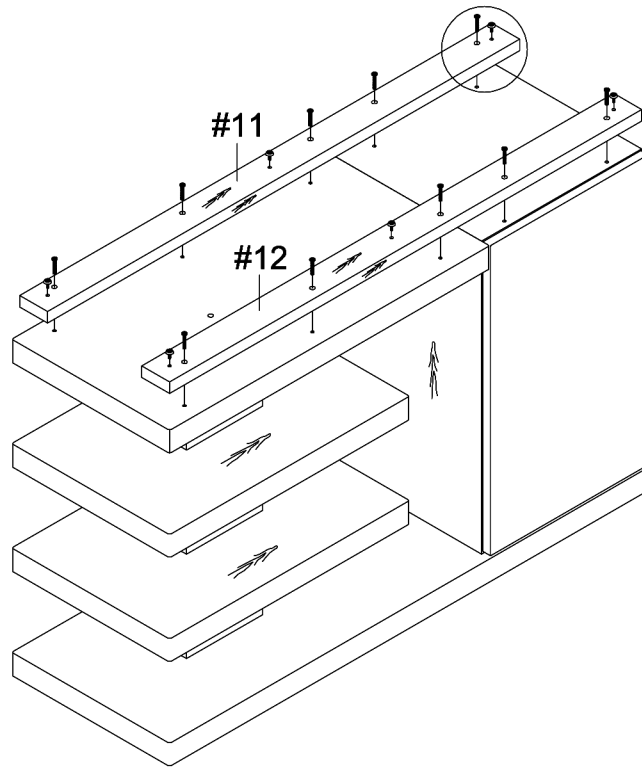

Align supports (#11,12) to built product, then secure by using bolts (#A). Attach adjustable feet (#J) to supports (#11,12), then adjust feet according to ground level.

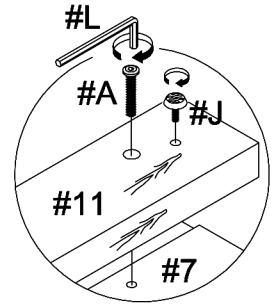

10

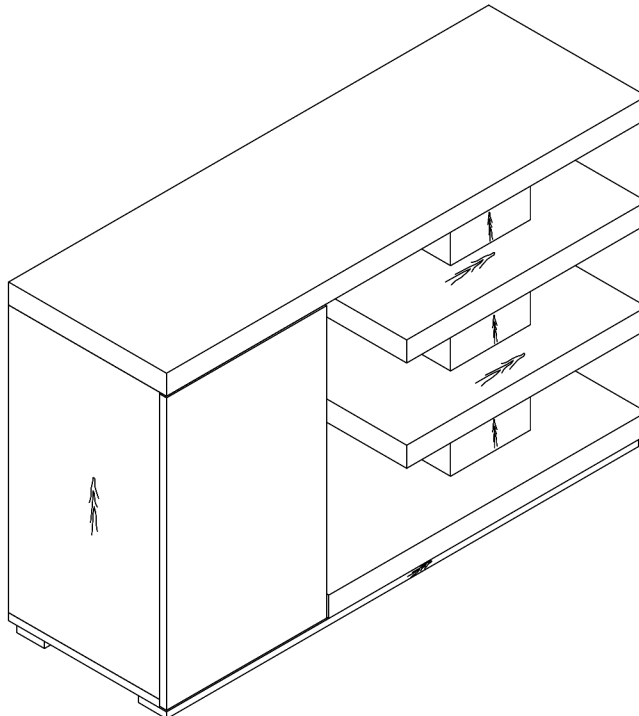

ASSEMBLY COMPLETED



Please ensure the furniture rests on an even and flat surface. If the product wobbles or feels loose, double-check all bolts and/or screws are properly tightened and secured.



Keep this handy!

Please retain this instruction manual and any order-related information for future reference.