

ASSEMBLY INSTRUCTIONS

# COFFEE TABLE

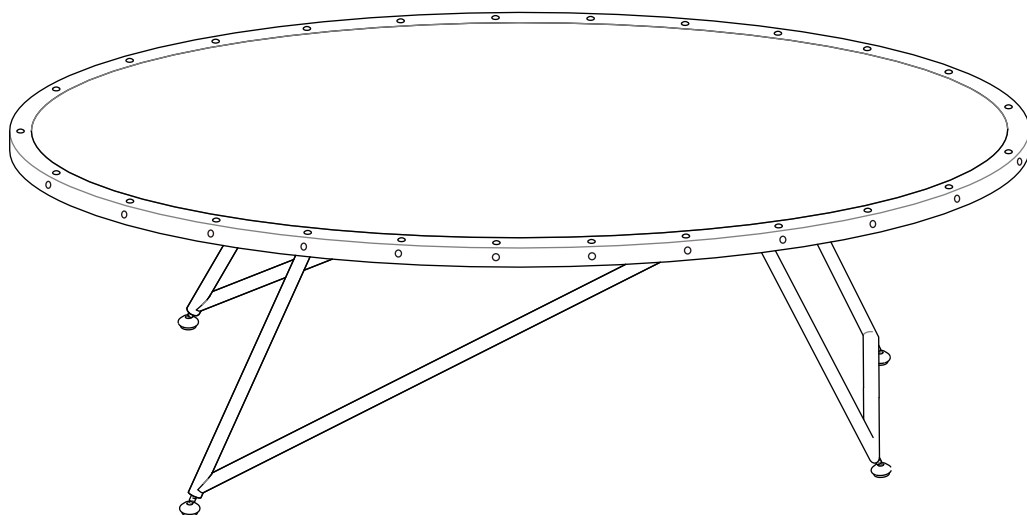

# COFFEE TABLE

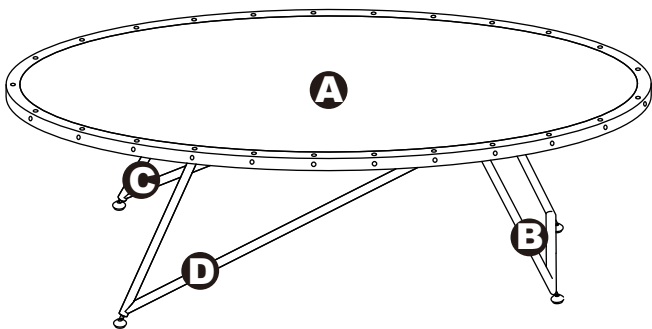

## DIMENSIONS

Width - 46.2"

Depth - 22.6"

Height - 14.8"

## PARTS LIST

**A** X1

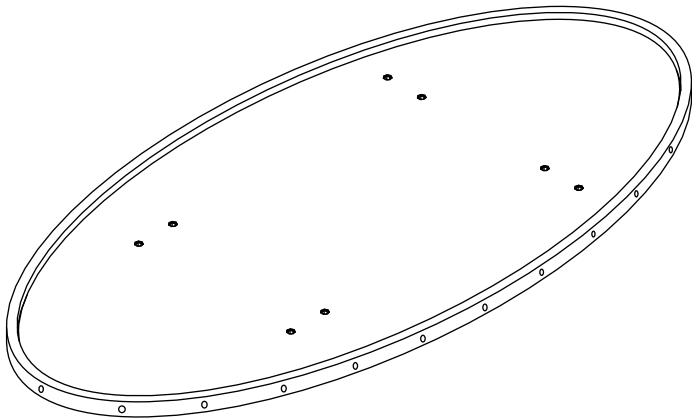

**B** X1

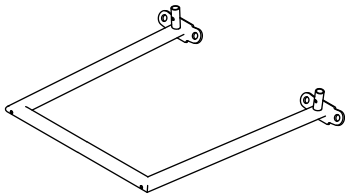

**C** X1

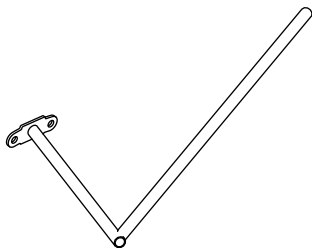

**D** X1

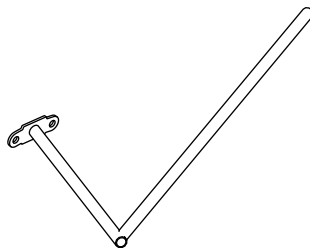

## HARDWARE LIST

**①** X10



**②** X4

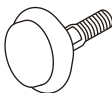

# ASSEMBLY INSTRUCTIONS

## Step 1.

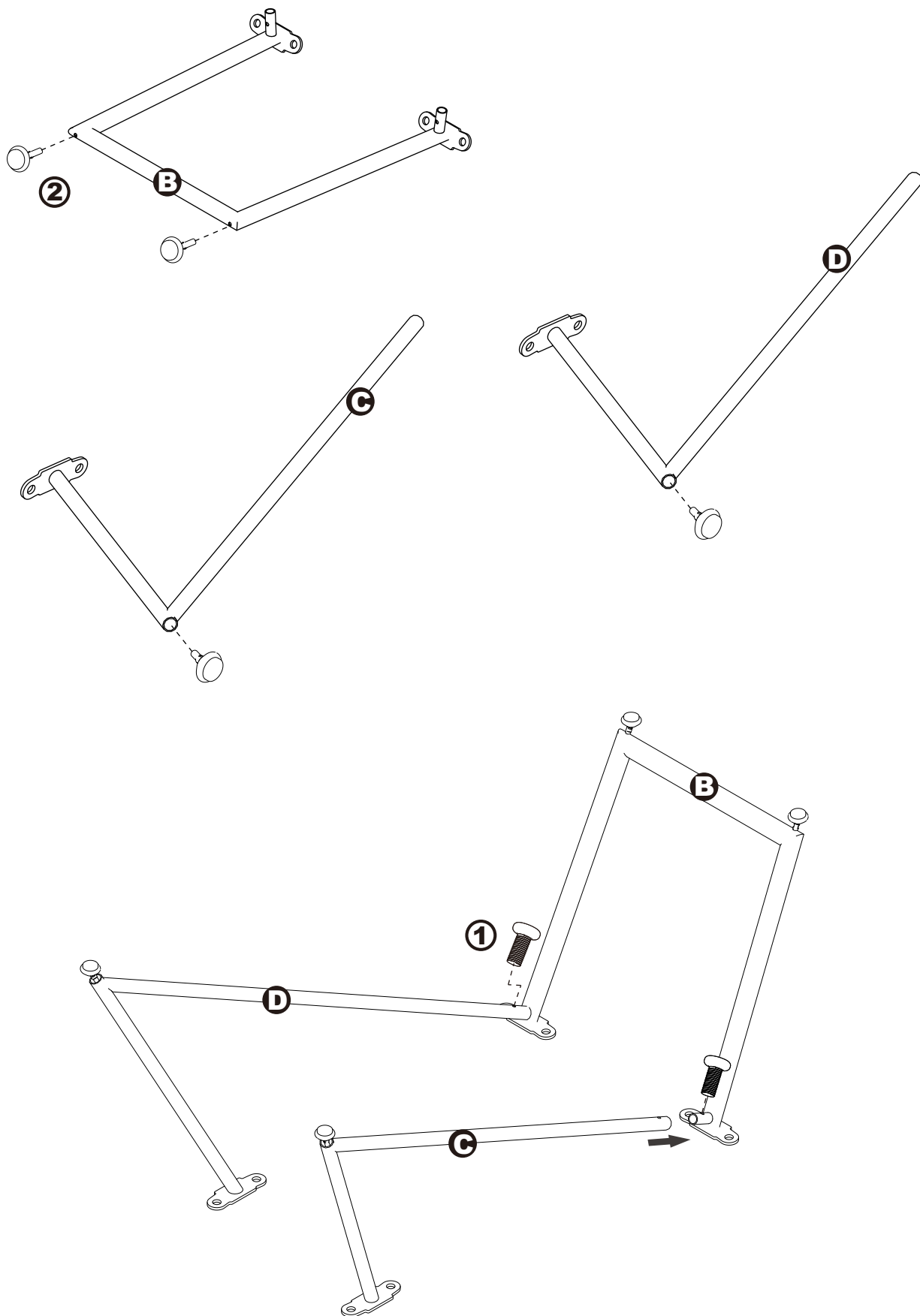

# ASSEMBLY INSTRUCTIONS

## Step 2.

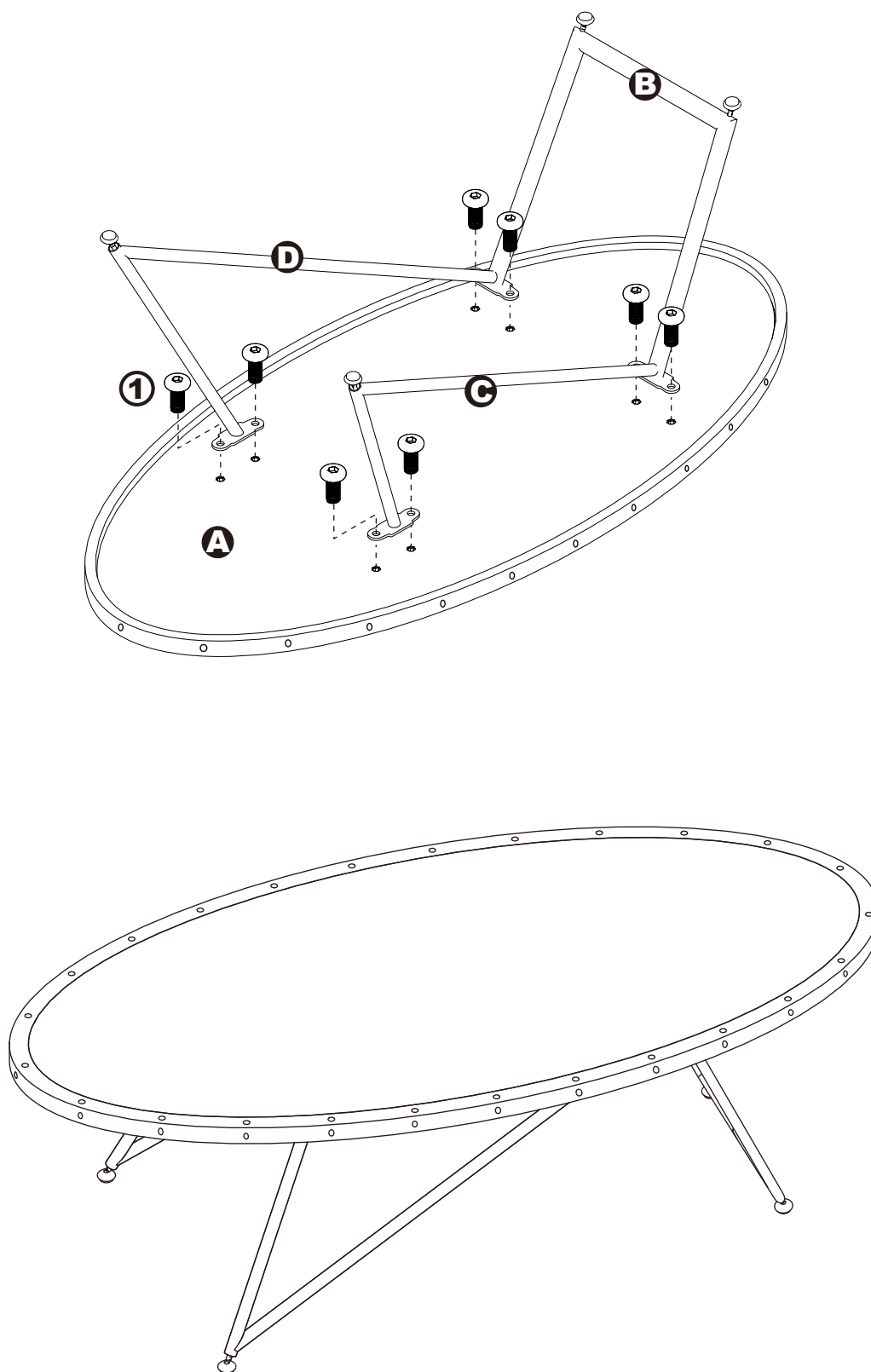

## ASSEMBLY IS COMPLETED

Make sure the product is rested on a flat surface and does not feel loose or wobbly. If it does, double check that the bolts/screws are secured and properly tightened.