

# Installation Instructions / Parts Diagram

Note: Item Fully Assembled

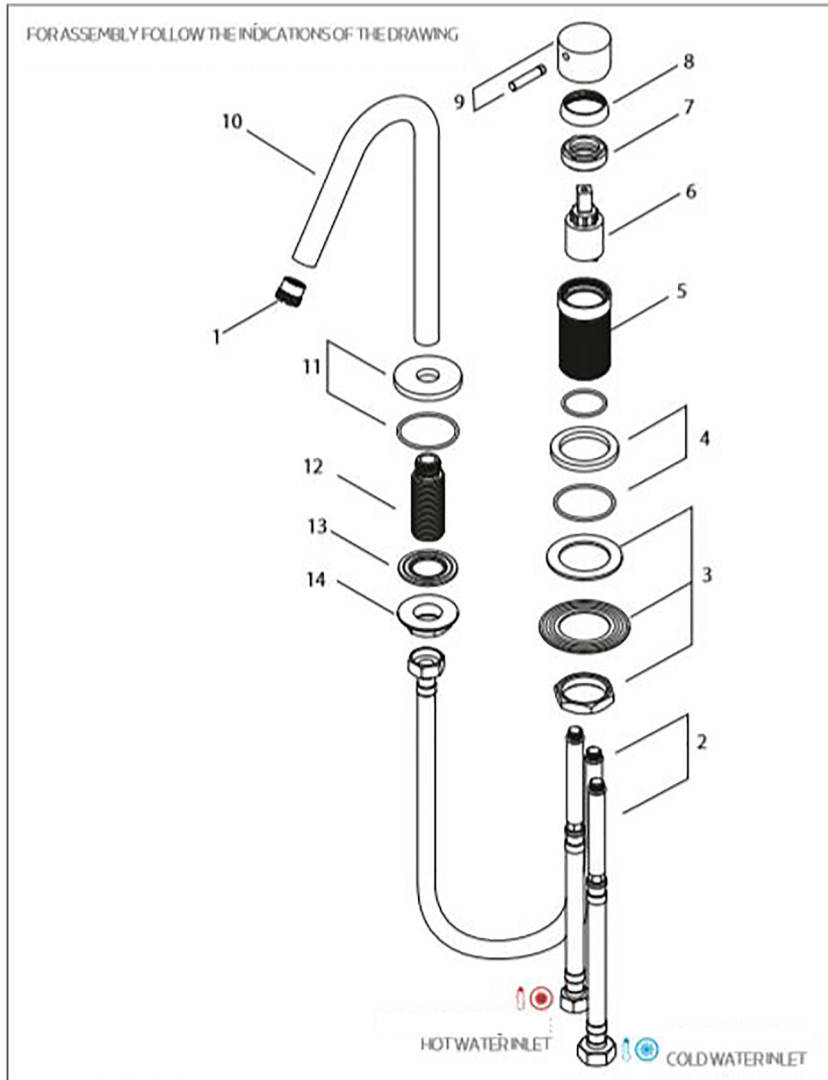

## TECHNICAL DATA

Nº	REFERENCE	DESCRIPTION
01	AR1.16	AERATOR
02	—	CONNECTION FLEXIBLE
03	—	FIXING KIT
04	ES1.45B	PLATE
05	—	TAP BODY
06	CR1.25	CARTRIDGE
07	—	LOCKNUT
08	—	CARTRIDGES CONCEALER
09	MA1.35	HANDLE
10	—	V SPOUT
11	—	SPOUT PLATE
12	—	CANNON
13	—	WASHER
14	—	STOP NUT

## INSTALLATION RECOMENDATIONS

Before installing a tap, it is good to rinse the supply pipes to remove all residues. We also recommend installing the taps with a filter. The installation of the tap must be done with the surface clean and dry. To perform the water pressure test, the taps must be open.

## CLEANING AND MAINTENANCE

Cleaning must be done with liquid soap and water. Do not use liquid detergents containing abrasive or acidic substances, abrasive sponges or disinfectants. Incorrect cleaning may permanently ruin the surface of taps.

On color finishings, do not use products containing alcohol, acetone and other solvents.

Collection  
Flow

Model |  
Flow T1.12V

Dimensions Metric

1 inch = 2.54 cm  
1 inch = 25.4 mm

**WS**<sup>®</sup>  
BATH  
COLLECTIONS

1051 Lea Drive - Collegeville, PA 19426  
Tel. 215 513 9400 - Fax 610 831 0215

[www.ws bathcollections.com](http://www.ws bathcollections.com) - [info@ws bathcollectins.com](mailto:info@ws bathcollectins.com)