

Installation Instruction

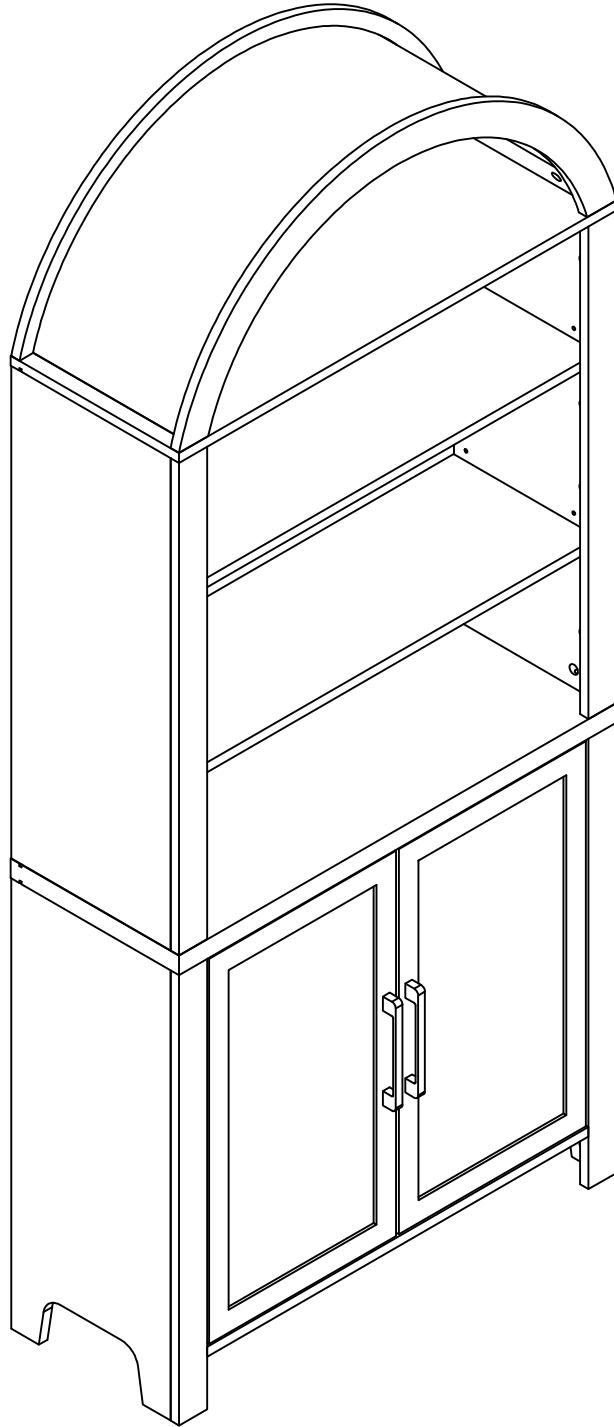

Assembling

Estimated time for assembly



45 : 00

What you need

- Use the packaging carton as a working surface to prevent product damage during assembly
- Phillips head screwdriver

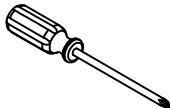

Weight Limitation



100

lbs table top

35

lbs per

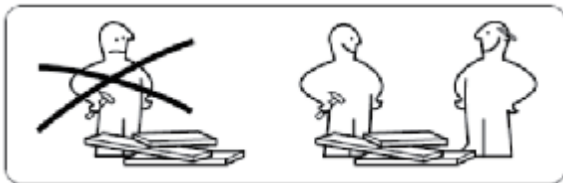

What' included

Code	Description	Qty
A	Cam Bolt M6X35MM	54
B	Cam Lock 15X12MM	54
C	Wooden Dowel M8X30MM	18
D	Screw M4X40MM	2
E	Screw M3.5X14MM	2
F	Metal shake handhandle	2
G	Nylon Strap	2
H	Screw M3.0X14MM	46
I	Cam Bolt M4X18MM	4
J	The back button	30
K	Anchor	2
L	The bolt	4
M	Ron absorption	4
N	Metal handle	4
O	Shelf Holder	12
P	Screw M4X25MM	7
Q	Foot nail	4

The Hardwares

A

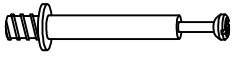

B

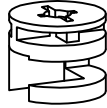

C

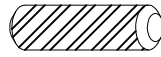

D

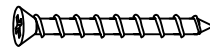

E



F

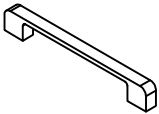

G



H



I



J

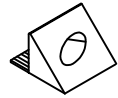

K



L



M

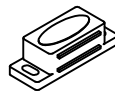

N



O



P

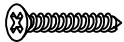

Q



IMPORTANT:

1. Do not tighten bolts / screws completely until all bolts / screws are lined up and inserted into holes.
2. Do not over tighten screws and bolts to avoid stripping
3. Please use hand tools to assemble this product. Do not use power tools.

Included Accessories

Code	Description	Qty
1	Cabinet Top	1
2	Bottom Panel	1
3	Superior left side plate	1
4	Superior right side plate	1
5	Inferior left side plate	1
6	Inferior right side plate	1
7	Movable laminated plate	3
8	Intermediate laminate	1
9	Back brace	3
10	Metal Door	2
11	Top baffle	2
12	Lower baffle	2
13	Front apron	1
14	Epigonotum	1
15	Reinforcing plate	5
16	Top plate	1
17	Intermediate backplane	3
18	Hypotergite	2

The Accessoriess

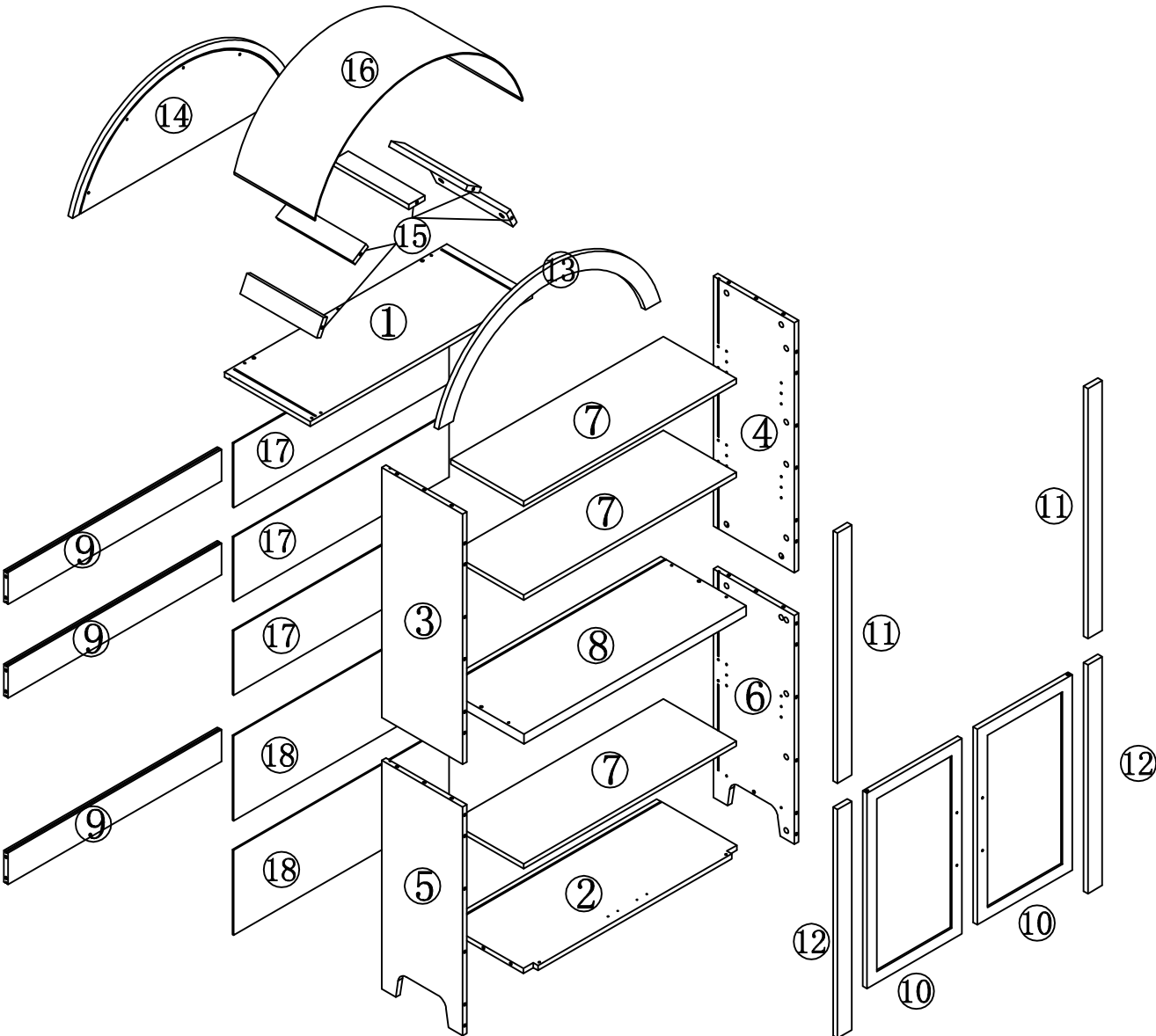

Step 1

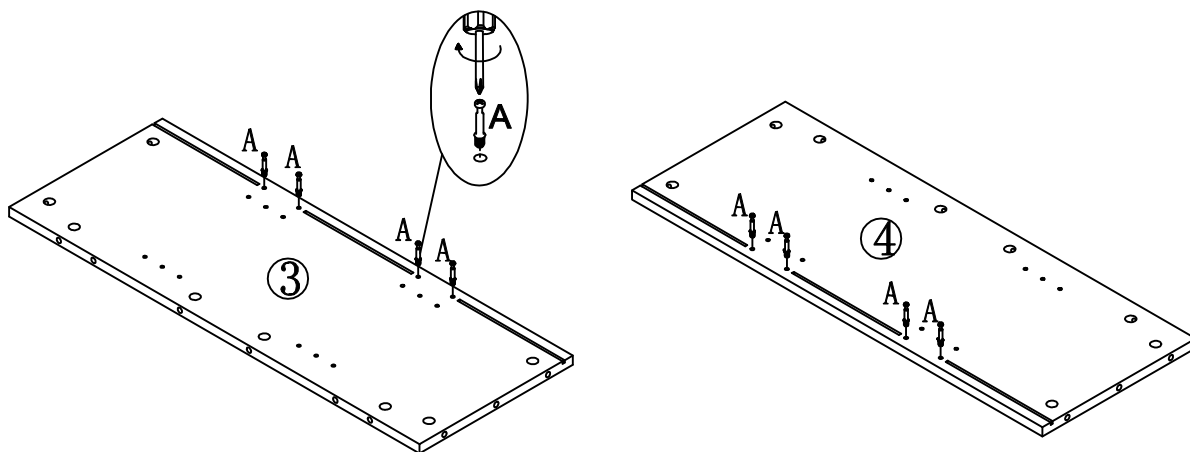
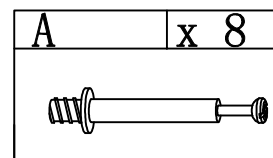

Step 2

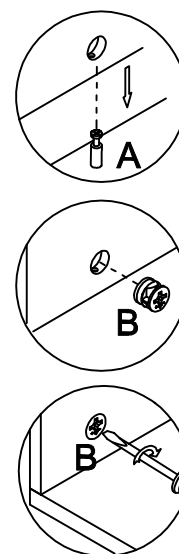
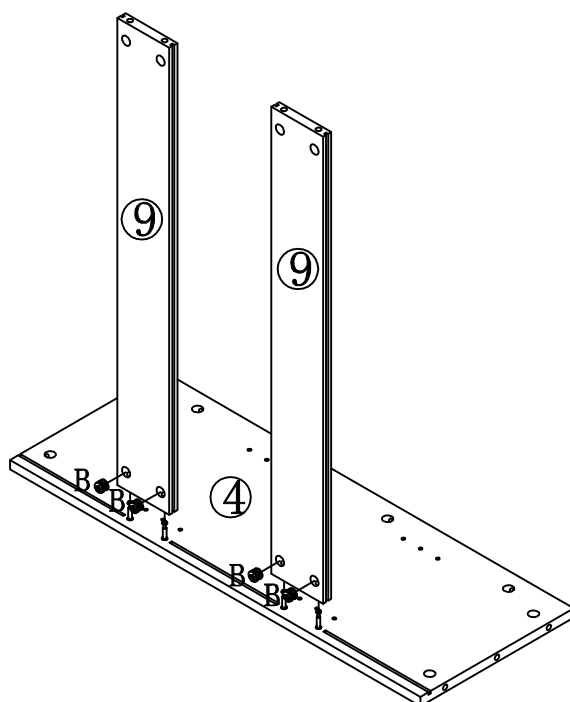
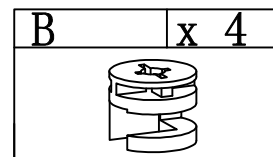

Step 3

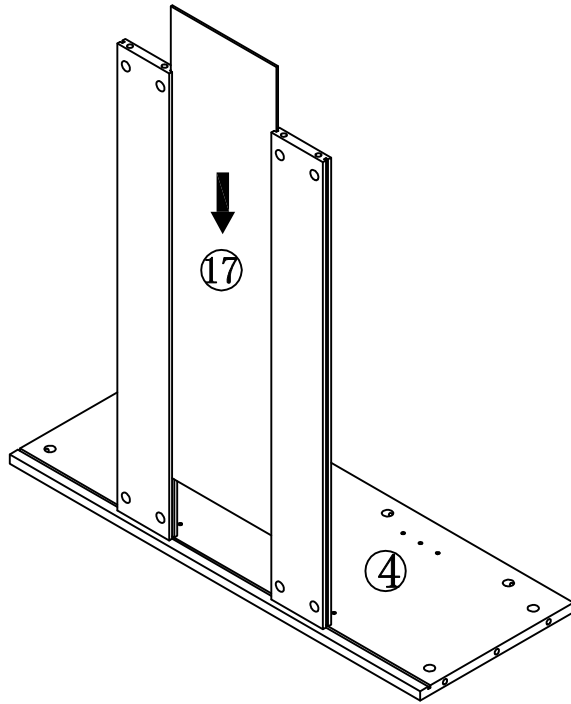

Step 4

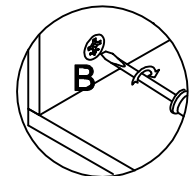
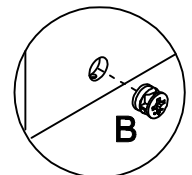
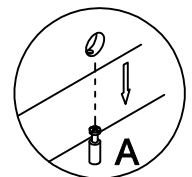
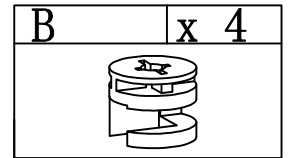
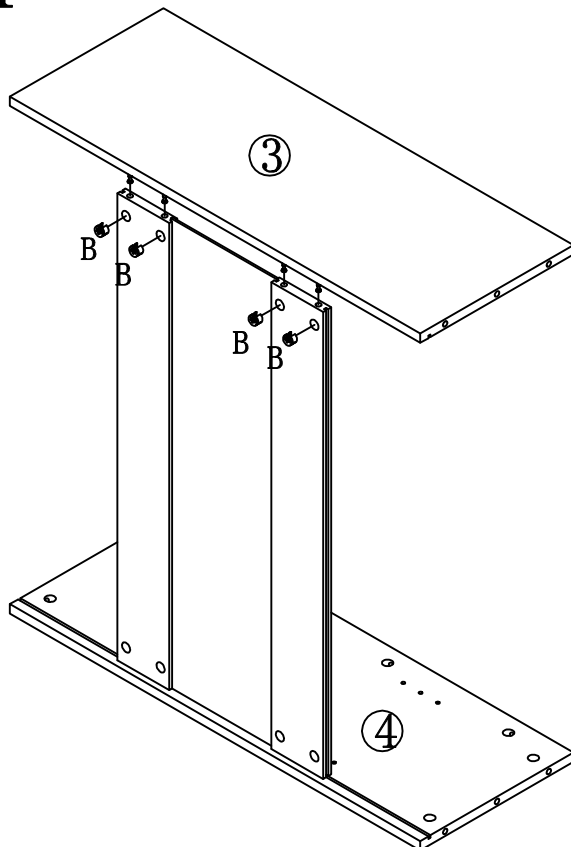

Step 5

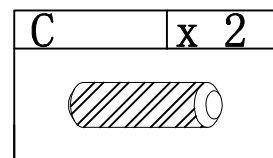
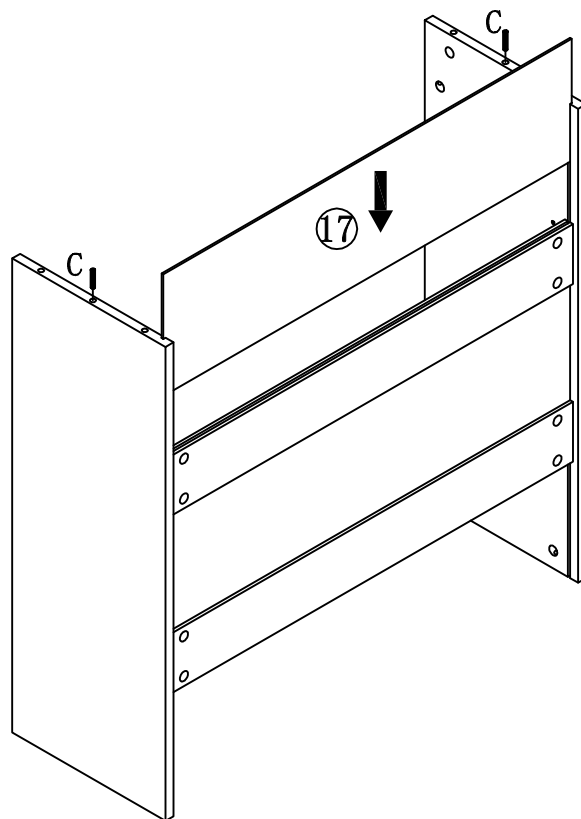

Step 6

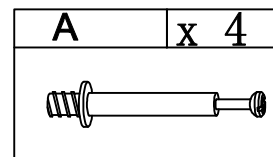
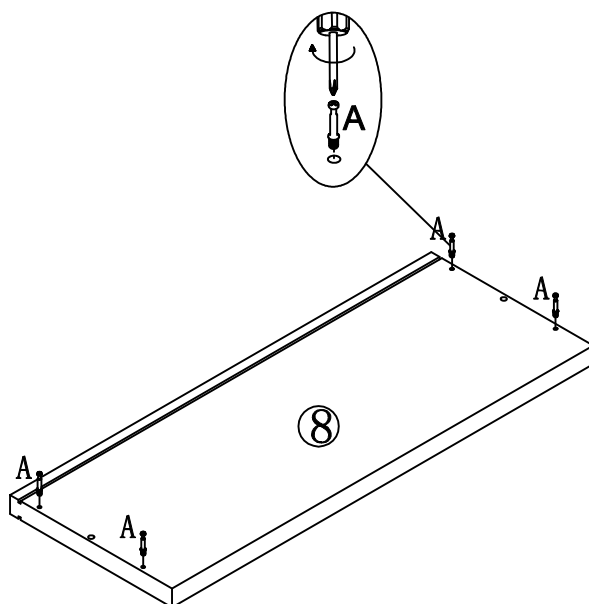

Step 7

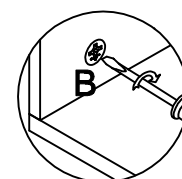
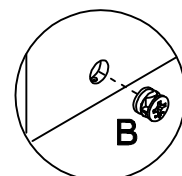
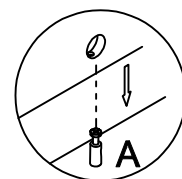
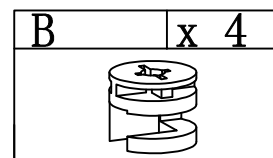
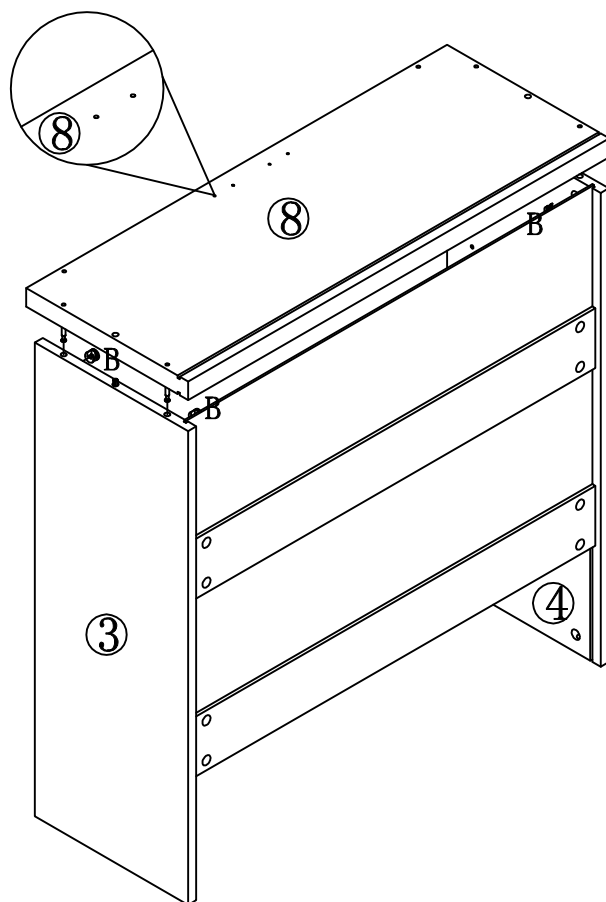

Step 8

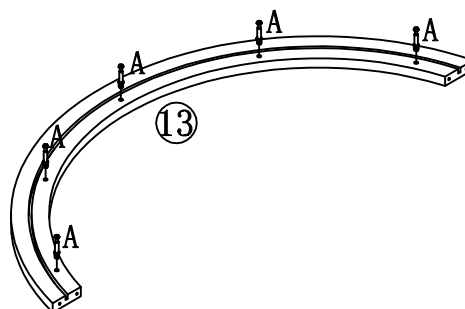
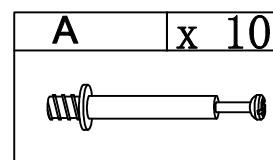
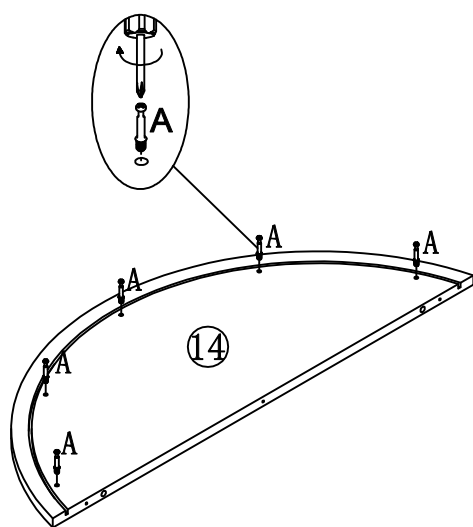

Step 9

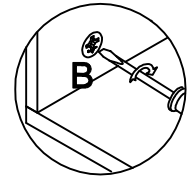
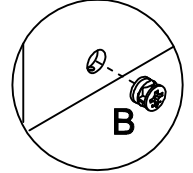
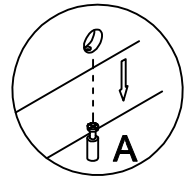
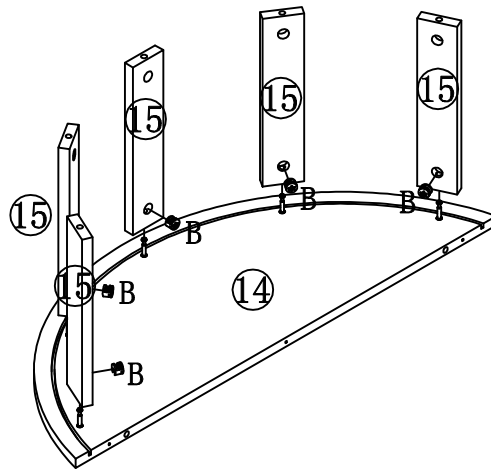
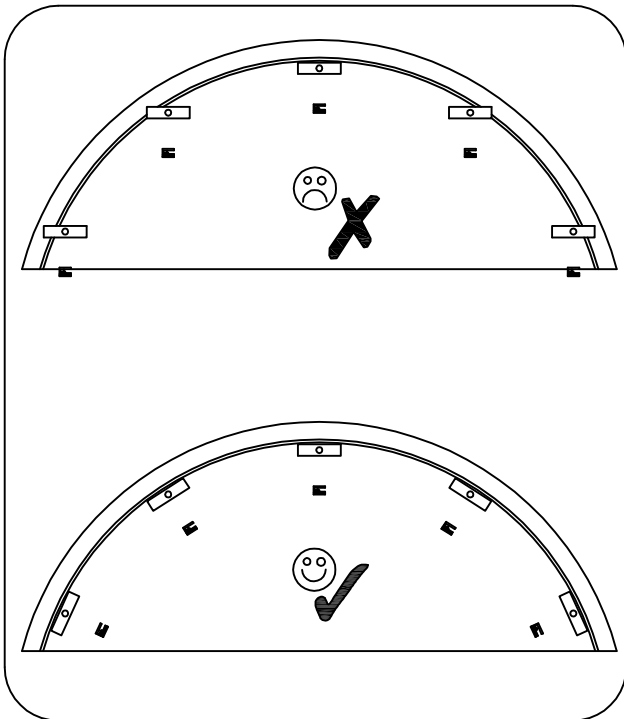
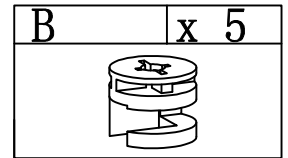

Step 10

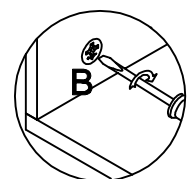
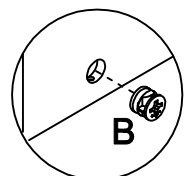
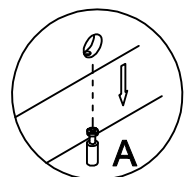
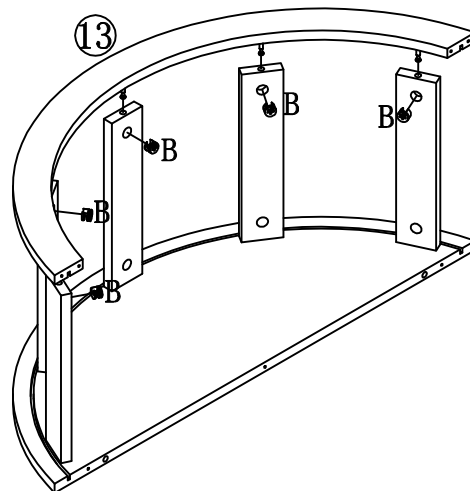
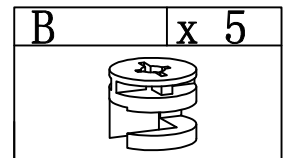

Step 11

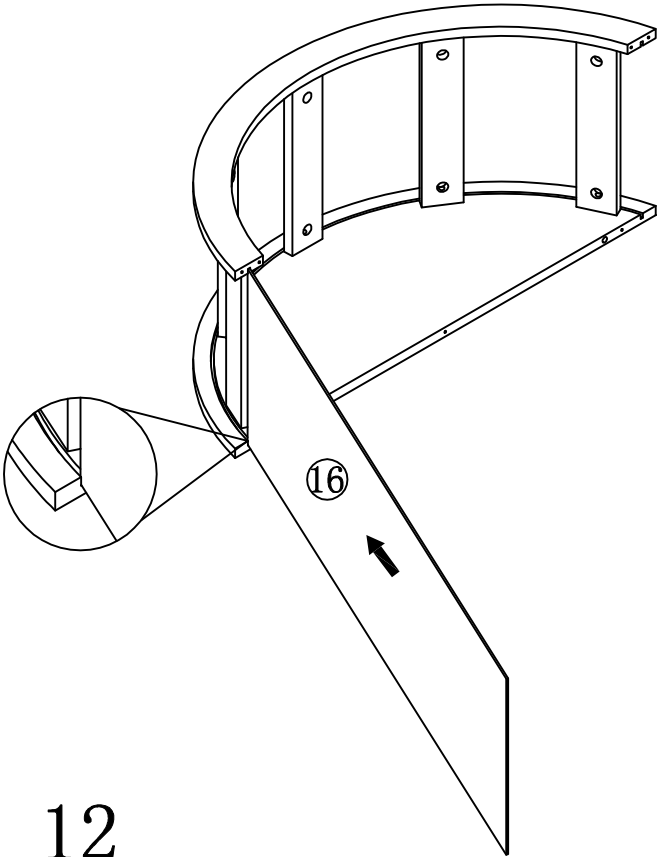

Step 12

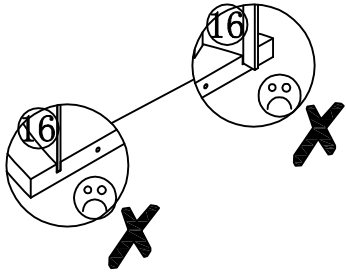
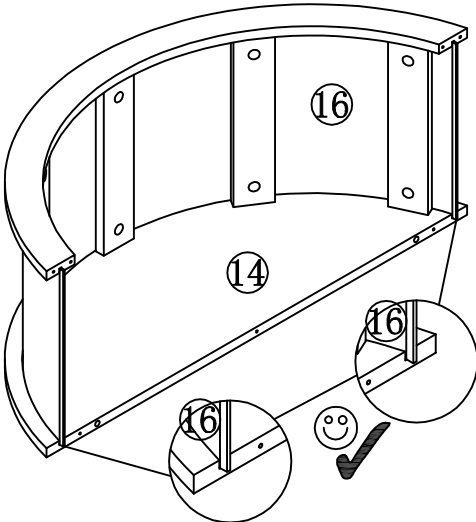

Step 13

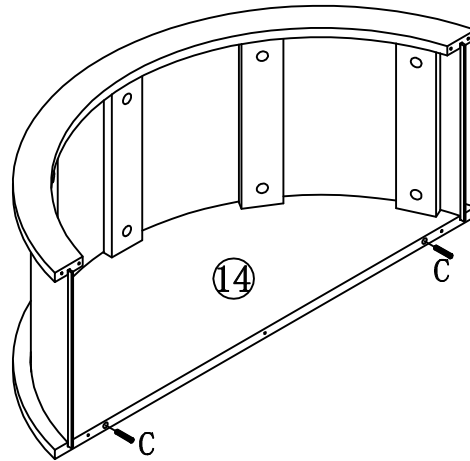
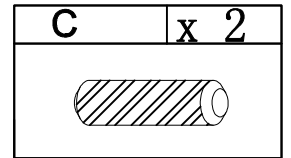

Step 14

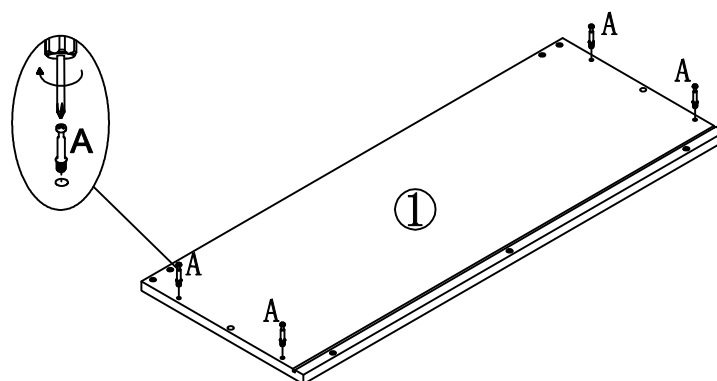
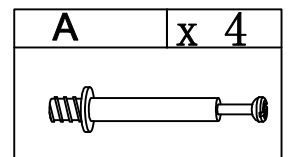

Step 15

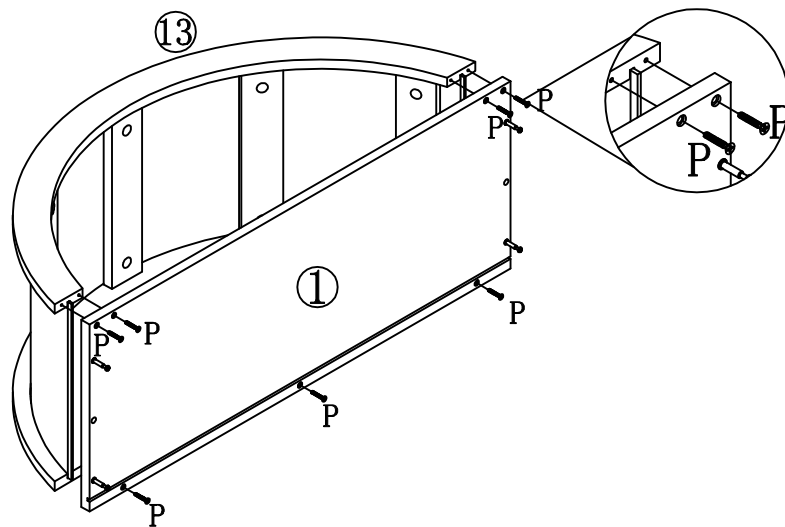
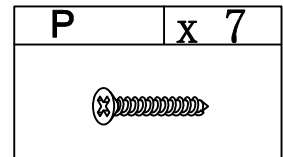

Step 16

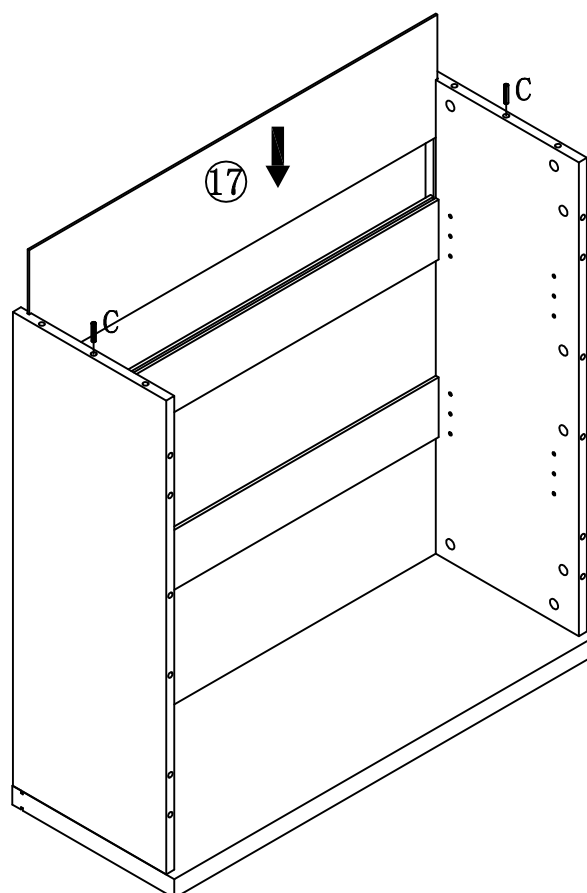
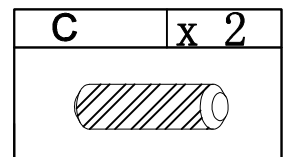

Step 17

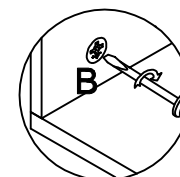
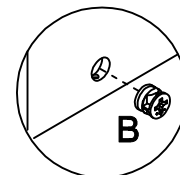
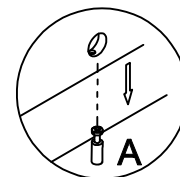
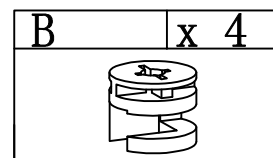
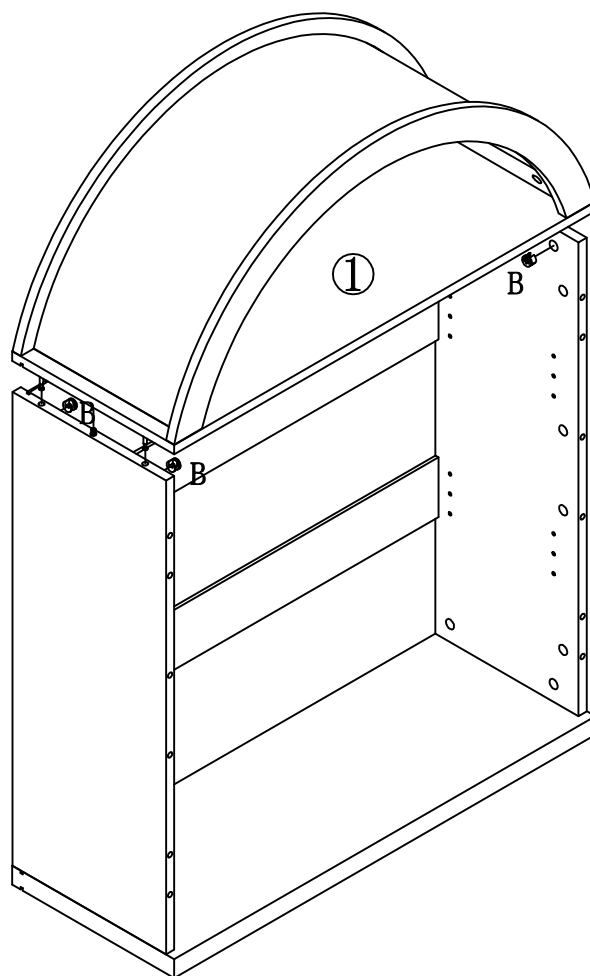

Step 18

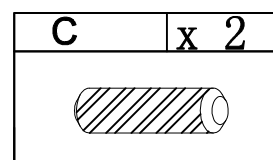
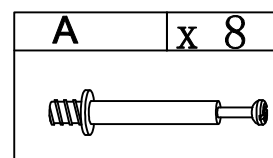
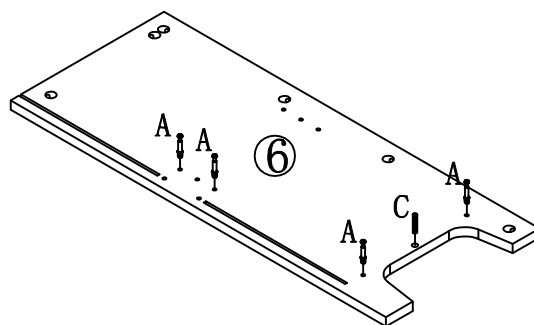
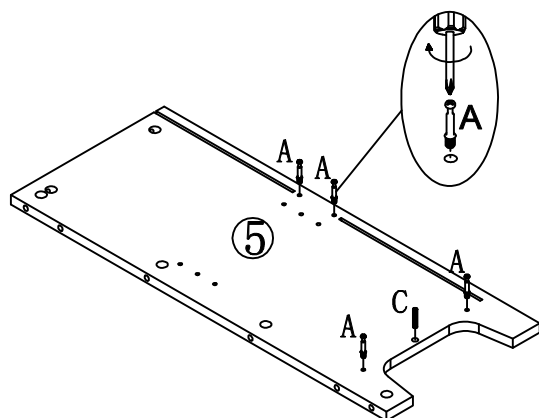

Step 19

H	x 4
	

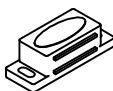
M	x 2
	

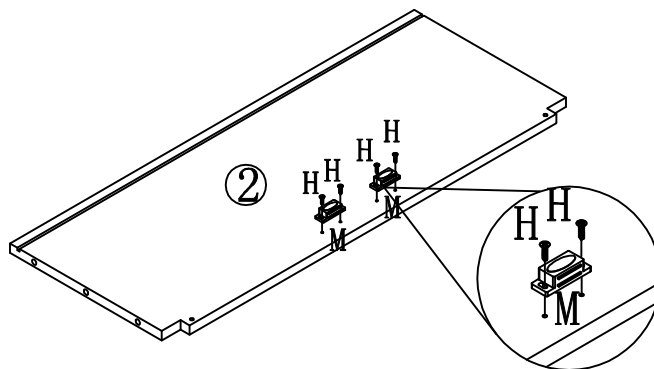

Step 20

B	x 4
	

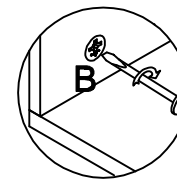
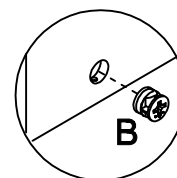
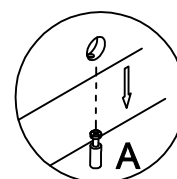
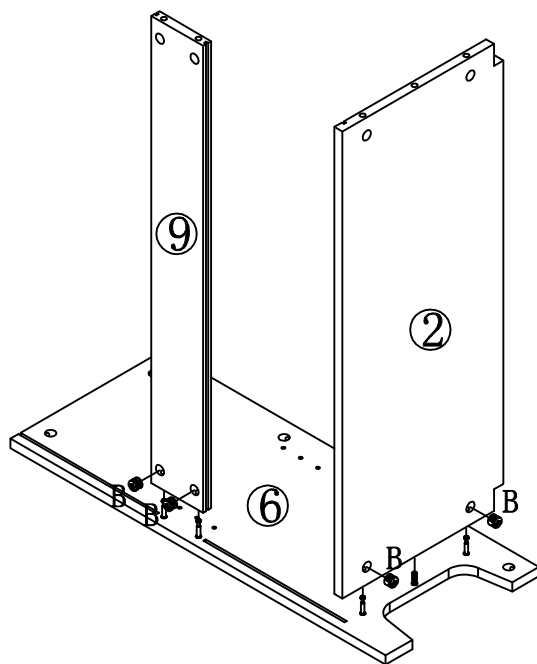

Step 21

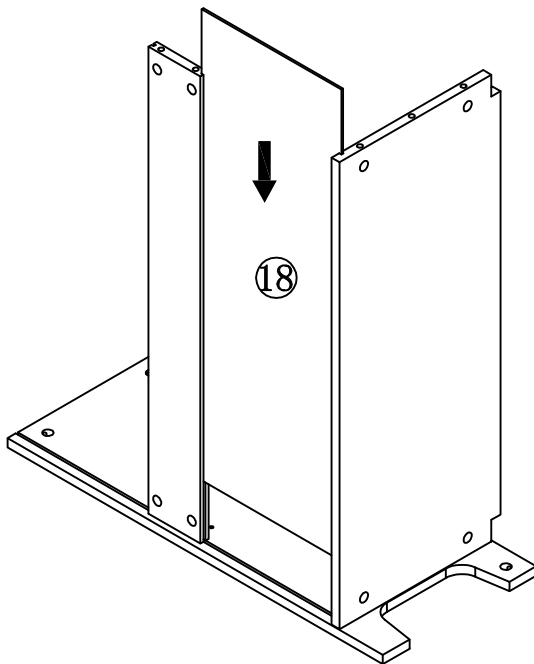

Step 22

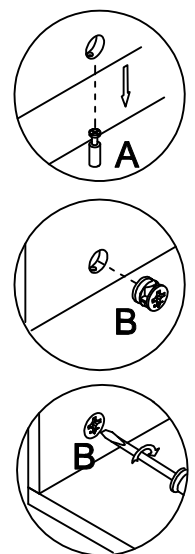
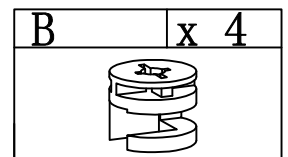
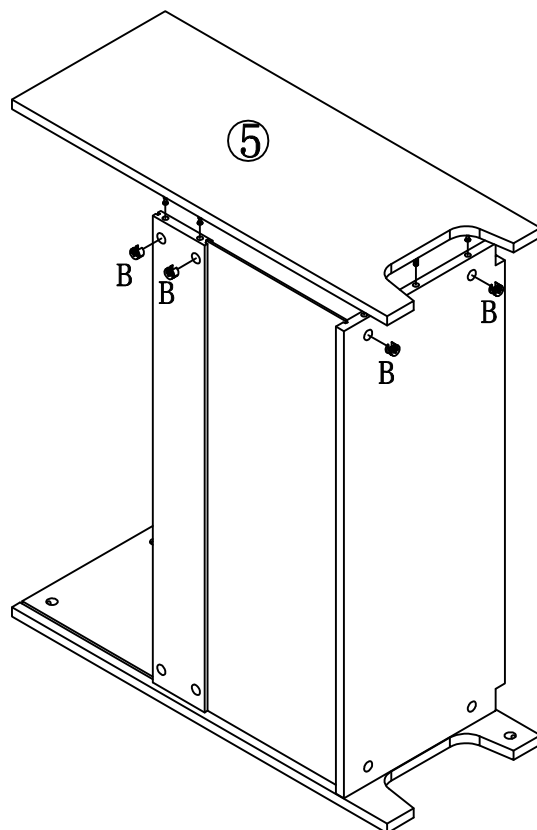

Step 23

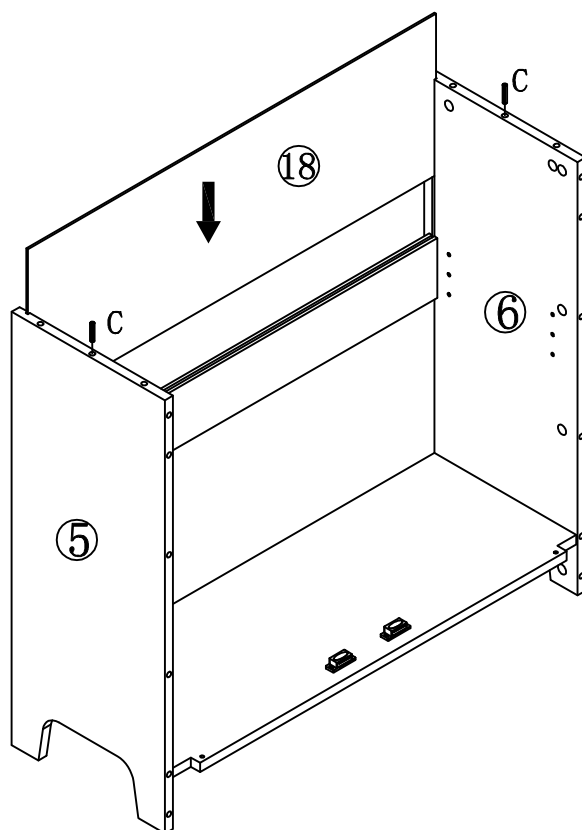
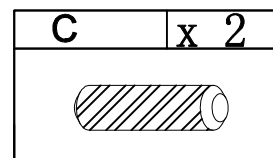

Step 24

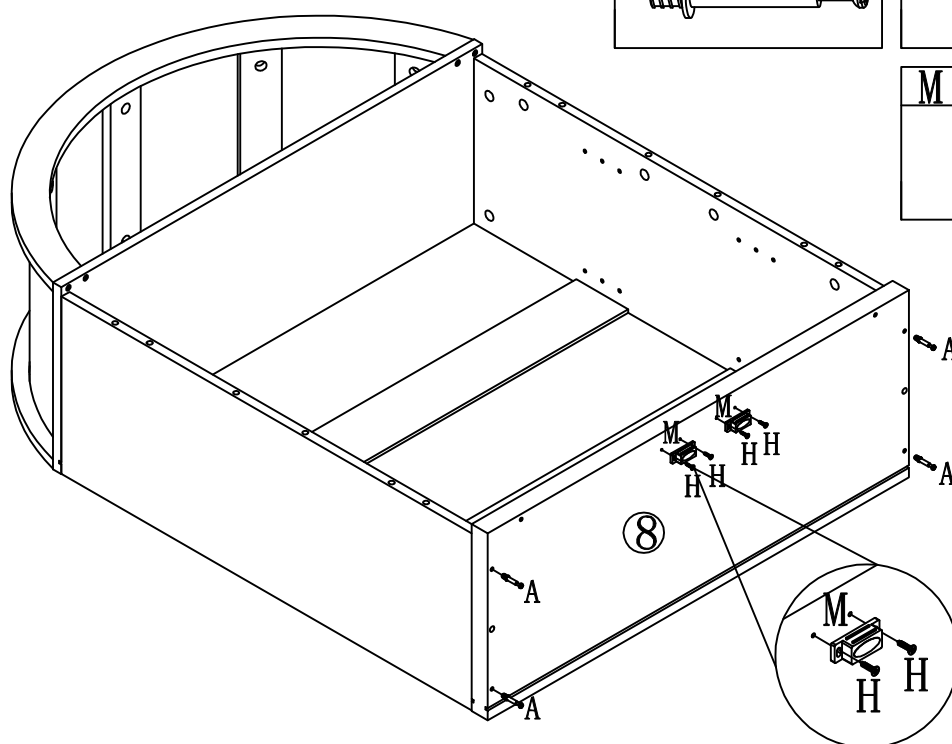
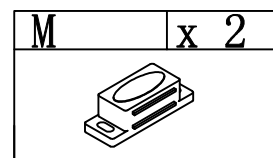
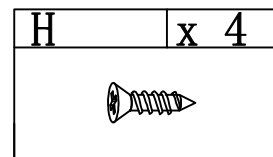
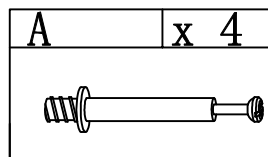

Step 25

B	x 4

Q	x 4

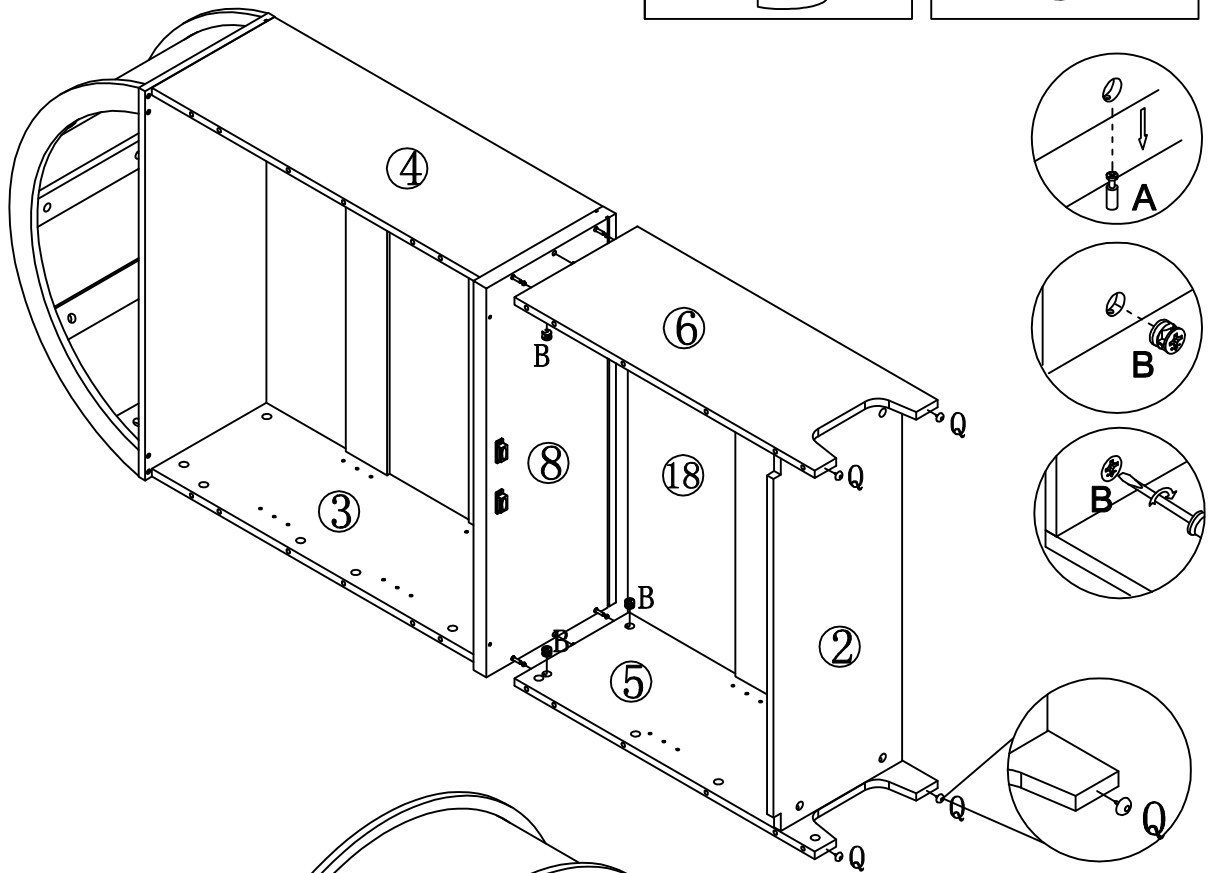

Step 26

H	x 30

J	x 30

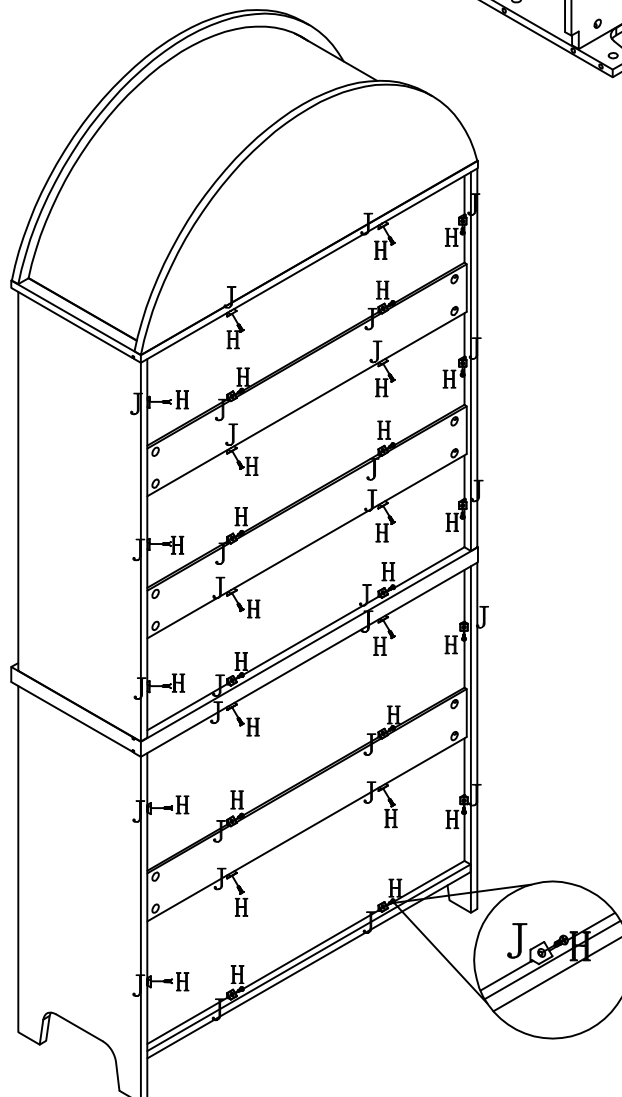

Step 27

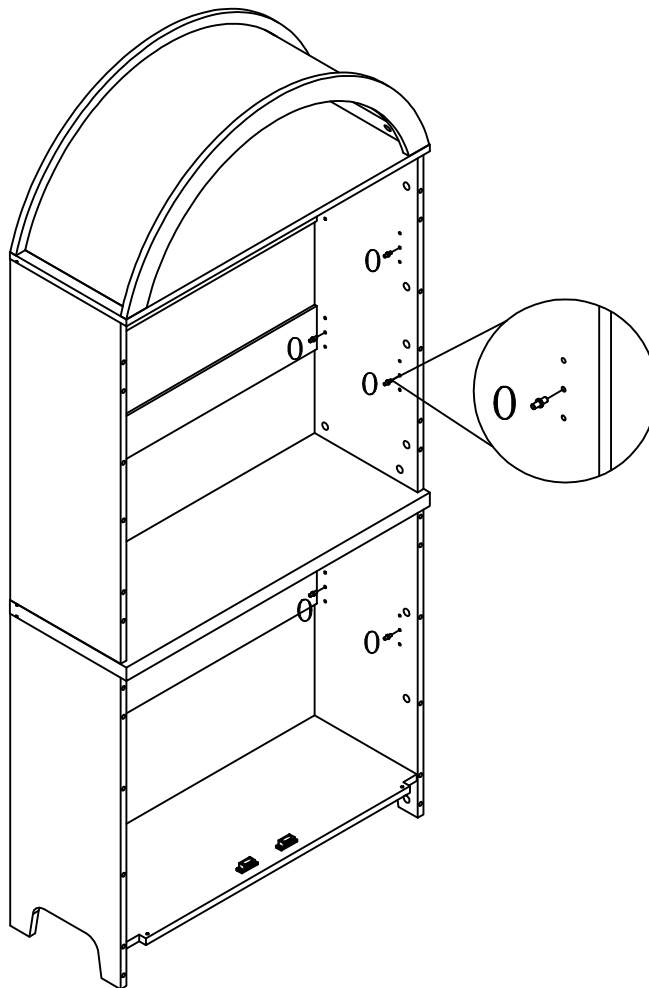

0	x 12
	

Step 28

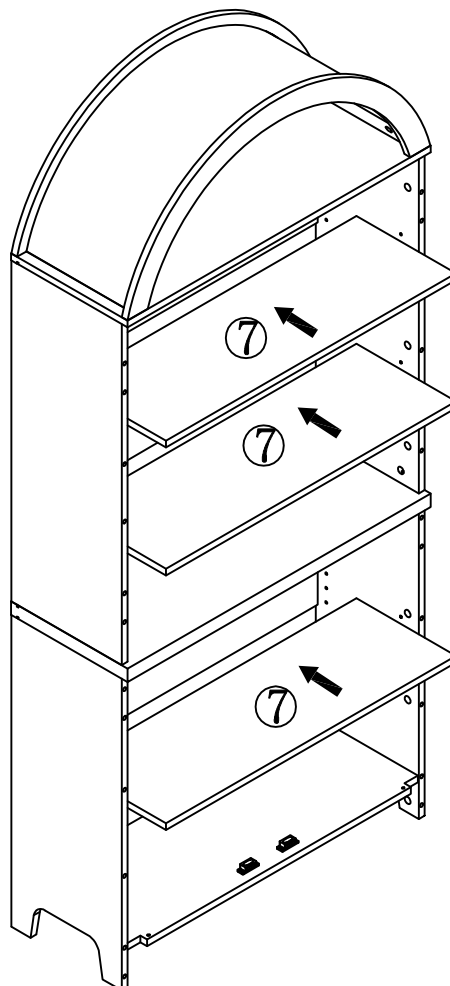

Step 29

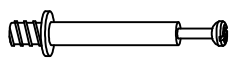
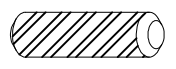
A	x 16
	
C	x 8
	

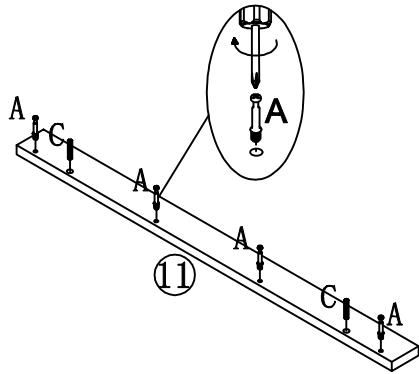

11

X 2

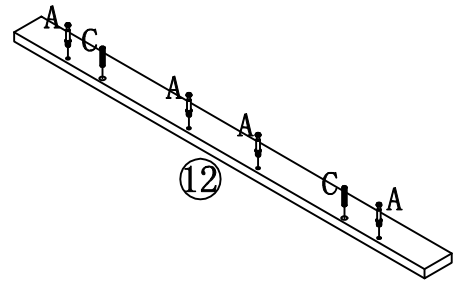

12

X 2

Step 30

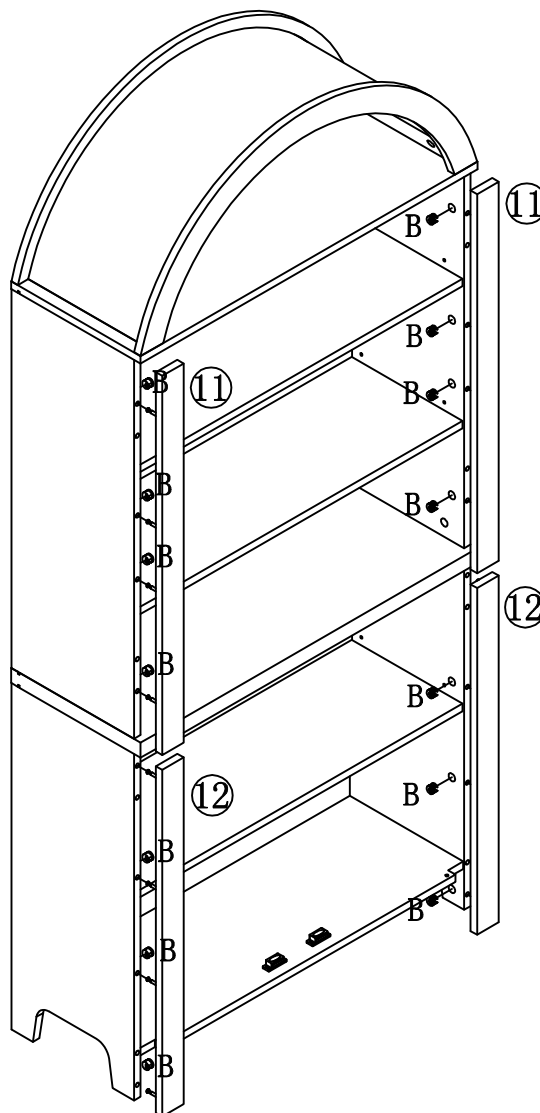

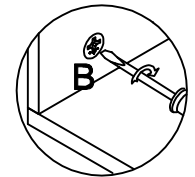
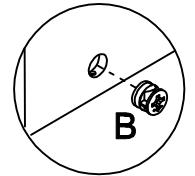
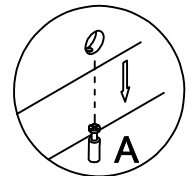

B	x 16
	



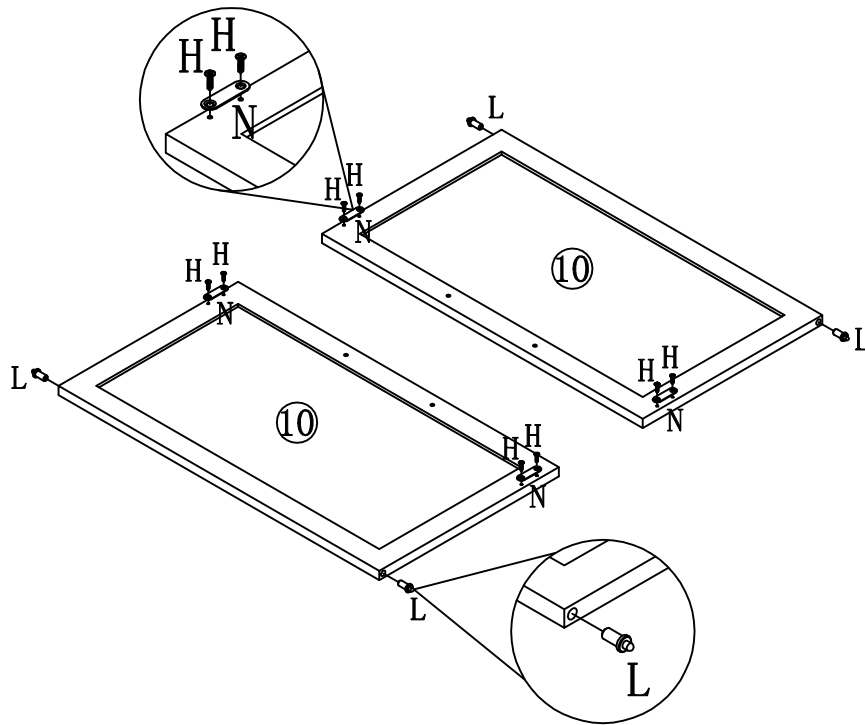



Step 31

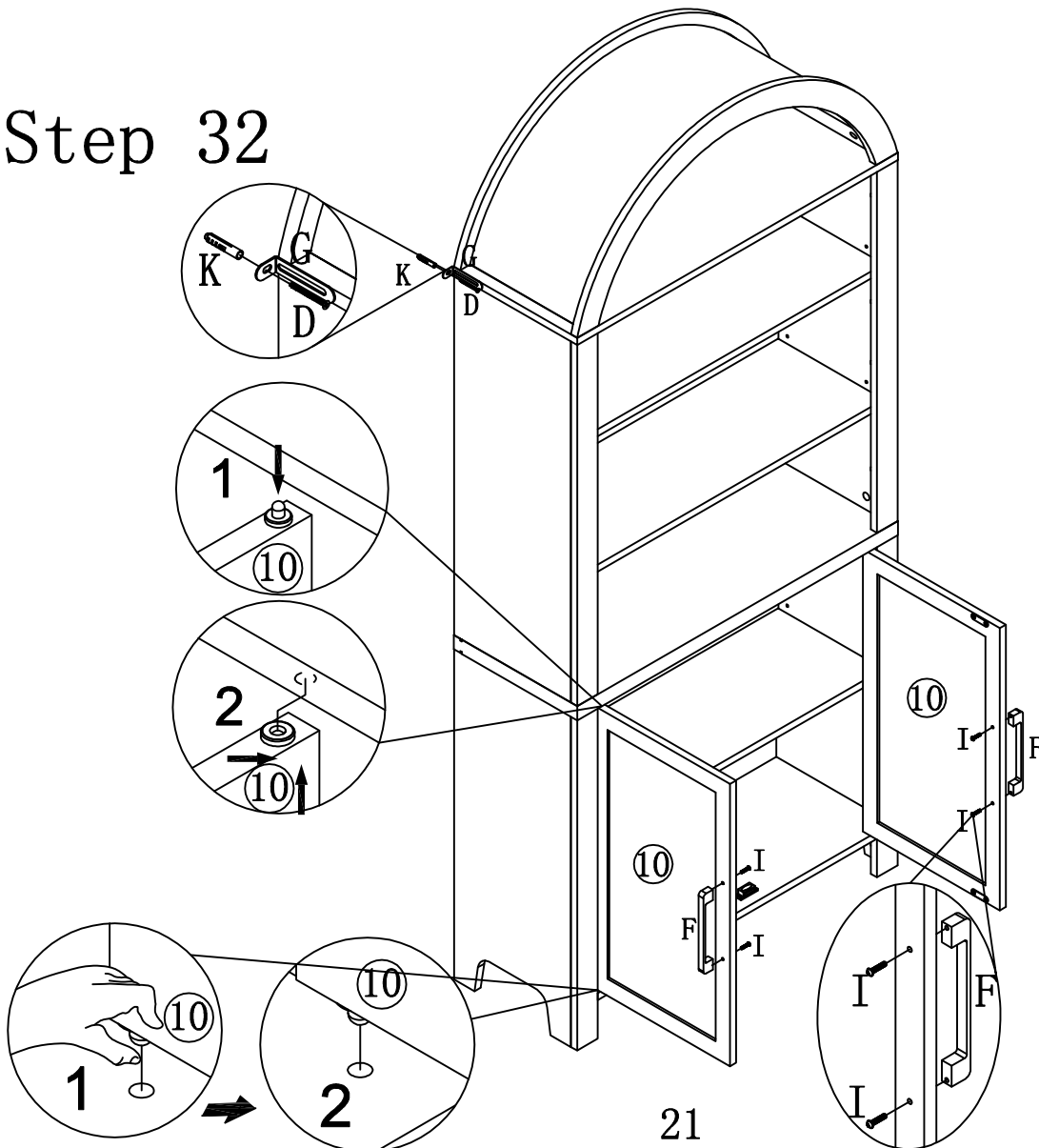

H	x 8
	
L	x 4
	
N	x 4
	

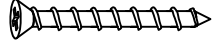
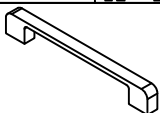
Step 32



D	x 2
	
F	x 2
	
G	x 2
	
I	x 4
	
K	x 2
	

Step 33

E	x 2
