

# ESPRESSO MACHINE

# INSTRUCTION MANUAL

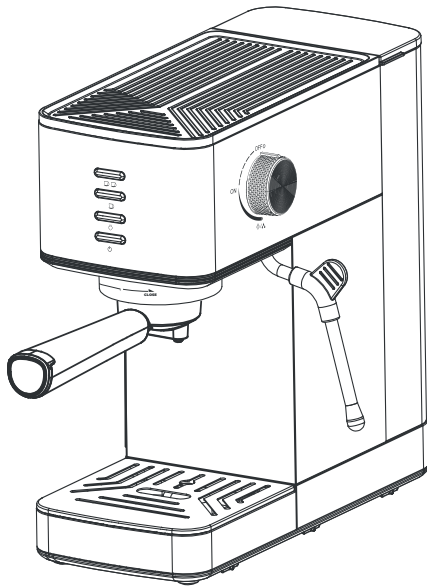

MODEL NO.: CM5432B-UL

ITEM NO.: CM8032SH

120V AC 60Hz 1350W

**Thank you for purchasing this product! Please read this manual thoroughly before using and save it for future reference. If you have any question about the product, please contact us via our customer service number:**

**661-435-8826**



# IMPORTANT SAFEGUARDS

Before using the electrical appliance, the following basic precautions should always be followed including the following:

1. Read all instructions.
2. Before using check that the voltage of wall outlet corresponds to rated voltage marked on the rating plate.
3. To protect against fire, electric shock and injury to persons do not immerse cord, plug, in water or other liquid.
4. Remove plug from wall outlet before cleaning and when not in use. Allow appliance cool down completely before taking off, attaching components or before cleaning.
5. Do not operate any appliance with a damaged cord or plug or after the appliance malfunctions, or is dropped or damaged in any manner. Return appliance to the nearest authorized service facility for examination, repair or electrical or mechanical adjustment.
6. The use of accessory attachments not recommended by the appliance manufacturer may result in fire, electric shock or injury to persons.
7. Place appliance on flat surface or table, do not hang power cord over the edge of table or counter.
8. Ensure the power cord do not touch hot surface of appliance.
9. Do not place the coffee maker on hot surface or beside fire in order to avoid to be damaged.
10. To disconnect, remove plug from wall outlet. Always hold the plug. But never pull the cord.
11. Do not use appliance for other than intended use and place it in a dry environment.
12. Close supervision is necessary when your appliance is being used by or near children.
13. Be careful not to get burned by the steam.
14. Do not touch the hot surface of appliance (such as steam wand, and the brewing filter just boiling). Use handle or knobs.
15. Do not let the coffee maker operate without water.
16. Scalding may occur if the water tank is removed during the brewing cycles.
17. Do not remove the metal funnel when appliance is brewing coffee or when steam and hot water escape from metal funnel and ensure to release the pressure in funnel before removing metal funnel.
18. Connect plug to wall outlet before using and turn any switch off before plug is removed from wall outlet.
19. Relief pressure through steam wand before removing tank cover or metal funnel.
20. This appliance is not intended for used by persons (including children) with reduced physical, sensory or mental capabilities, or lack of experience and knowledge, unless they have been given supervision or instruction concerning use of the appliances by a person responsible for their safety.
21. Children should be supervised to ensure that they do not play with the appliance.
22. This appliance is intended to be used in household and similar applications such as:
  - staff kitchen areas in shops, offices and other working environments;
  - farm houses;
  - by clients in hotels, motels and other residential type environments;
  - bed and breakfast type environments.
23. Do not use outdoors.

24. Do not place on or near a hot gas or electric burner, or in a heated oven.
25. If the supply cord is damaged, it must be replaced by the manufacturer, its service agent or similarly qualified persons in order to avoid a hazard.
26. **WARNING:** The filling aperture must not be opened during use.
27. The appliance must not be immersed.
28. The heating element surface is subject to residual heat after use.
29. **WARNING:** Potential injury from misuse.
30. The coffee-maker shall not be placed in a cabinet when in use.
31. Cleaning and user maintenance shall not be operated by children without supervision.
32. **WARNING:** Do not touch the metal surface of steam wand when using the unit to avoid scalding.

# HOUSEHOLD USE ONLY

# SAVE THESE INSTRUCTIONS

## KNOW YOUR COFFEE MAKER

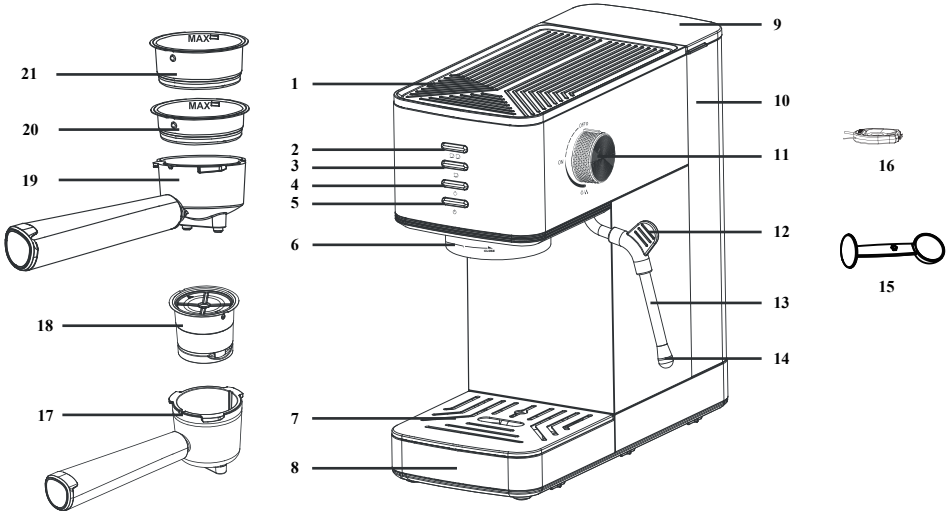

1.Top tray	2.Double cup button
3.Single cup button	4.Steam button
5.Power button	6.Funnel bracket
7.Drip plate	8.Drip tray
9.Water tank cover	10.Water tank
11.Steam/Hot water knob	12.Steam wand handle
13.Steam wand	14.Steam wand nozzle
15.Spoon (with the tamper at the other end)	16.Cleaning pin
17.Capsule funnel	18.Capsule filter
19.Ground coffee funnel	20.Single-cup filter
21. Double-cup filter	

## BEFORE THE FIRST USE

To ensure the first cup of coffee tastes excellent, you should rinse the coffee maker with warm water as follows:

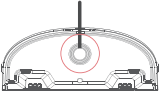

1. Remove the plug at the bottom of the tank.



2. Pour water into water tank, the water level should not exceed the “MAX” mark. Then close the tank cover.

**NOTE:** The appliance is supplied with a detachable water tank for easy cleaning, you can fill the water tank with water firstly, and then put the water tank back into the appliance.

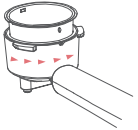

3. Set brewing filter into metal funnel (no coffee in the filter) by aligning the raised dot on the filter with the groove on the edge of the funnel, then rotate the filter to fix it.

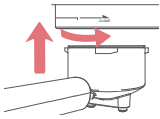

4. According to the corresponding grooves of the funnel bracket, insert the funnel into it at the “LOCK” position, then fix it firmly through turn it anticlockwise until it is at the “CLOSE” position.



5. Place an espresso cup on drip plate. Make sure the knob is at “OFF” position.

**NOTE:** The appliance is not equipped with jug or cup, please use your jug or coffee cup.

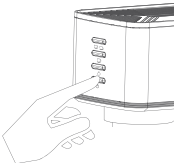

6. Connect to power source, press the power button to turn on. The four indicators illuminate together and then flash like breathing light. The machine enters preheat mode.

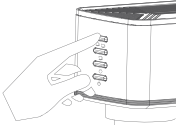

7. When the power, single and double-cup indicators become solid, the preheating is finished. Press the double-cup button, the single-cup indicator lights off and the double-cup indicator starts flashing. Wait for a moment, the water will flow out.

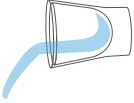

8. When the appliance stops pumping water automatically, the single and double-cup indicators return to steady light. You can pour the water in container out then clean them thoroughly, now you can start brewing.

**NOTE:** There may be noise when pumping the water on the first time, it is normal, the appliance is releasing the air in the appliance. After about 20s, the noise will disappear.

## MAKE COFFEE INSTRUCTIONS

### ● Preparation



1. Remove the water tank and open the tank cover to fill it with desired amount of the water, the water level should not exceed the “MAX” mark in the water tank.



2. Set brewing filter into metal funnel (no coffee contained)

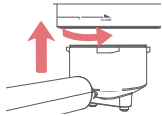

3. Then insert the funnel into the appliance and rotate to fix it.

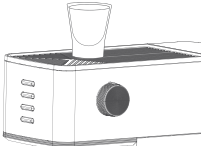

4. Place an espresso cup on top tray.

## ● Preheating

To make a cup of good hot Espresso coffee, we recommend you to preheat the appliance before making coffee, including the funnel, filter and cup, so that the coffee flavour can not be influenced by the cold parts.

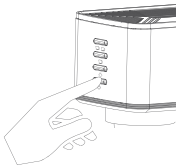

5. Make sure the knob is at the “OFF” position. Connect the appliance to power source, press the power button, the four indicators illuminate together and then flash like breathing light. The machine enters preheat mode.

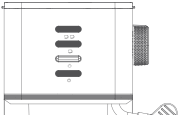

6. When the power / single / double-cup indicators become solid, the preheating is finished.

## ● Espresso Extraction

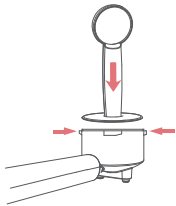

7. Remove the funnel out by turning it clockwise, add ground coffee to the filter with the spoon, a spoon of coffee powder can make about a cup of top-grade coffee, then press the ground coffee powder tightly with the tamper at the other end of the spoon.

**NOTE:** The coffee capsule of your choice could be directly put into the capsule filter, then put the filter into the capsule funnel, then continue the following steps.

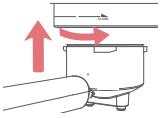

8. Insert the funnel into the appliance and fix it firmly.

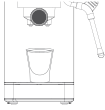

9. Place the warmed cup on the drip plate.



10. Press the single or double-cup button according to your demand. After waiting for a moment, there will be coffee flowing out. You can press corresponding single or double-cup button to stop the brewing any time.  
**NOTE:** If the coffee outflows too slow or there's no coffee flowing out during the brewing process, the probable cause is the excessive pressure. You can coarsen the coffee powder or reduce the added amount of the coffee powder or tamp the coffee powder more lightly to quicken the outflow rate.

**WARNING:** If you turn the knob on during the brewing process, the four indicators will flash to warn!

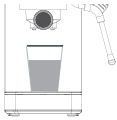

11. The appliance will stop working when the coffee-brewing is finished, and then your coffee is ready now.

**NOTE:** The default working time of single cup is 15 seconds, and that of double cup is 27 seconds.

**WARNING:** Do not leave the coffee maker unattended during making the coffee, as you need operate manually sometimes!

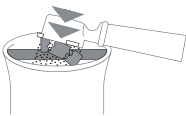

12. After finishing making the coffee, you can take the funnel out, then pour the coffee residue out.

**WARNING:** If the coffee funnel is removed immediately after the extraction is completed, the coffee liquid may erupt or overflow. So please wait 30 seconds after the extraction is completed until the pressure is released before removing the funnel to avoid erupt or overflow.

## MAKE HOT WATER

After finish preheating, put a cup under the steam wand and slowly turn the knob to “ON” position, the single and double-cup indicators light off and the steam indicator flashes. The hot water will dispense from steam wand. As you continue to rotate to “☉/☼” position, the pressure will gradually increase. When desired amount of hot water is got, turn the knob off.

**NOTE:** The maximum working time of hot water is 60 seconds.

## FROTHING MILK / MAKE CAPPUCCINO

The steam wand can be singly used to froth milk or make hot beverages like drinking chocolate and water. To make a cup of cappuccino, you will need to top up a cup of espresso with frothing milk. Firstly prepare the espresso, according to “**MAKE COFFEE INSTRUCTIONS**” section, with the cup big enough. Then prepare the jug with about 100 grams of milk for each cappuccino to be prepared. You are recommended to use whole milk at refrigerator temperature (not hot!). The diameter of the milk jug is not less than  $70\pm 5\text{mm}$ , and bear in mind that the milk increases in volume by 2 times, so please make sure the height of jug is enough.

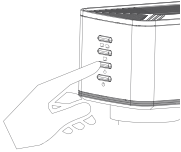

1. Press the steam button to preheat, the steam indicator will flash like breathing light and the single and double-cup indicators will light off. When steam indicator becomes solid, the preheating is finished.

**NOTE:** Make sure to complete the preheating of the steam before operating the knob.

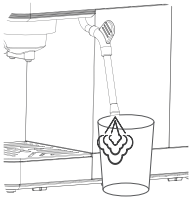

2. Before frothing milk, slowly turn the knob to “ON” position to release steam for 10s until the steam becomes steady, then turn off the knob.

**NOTE:** The knob only controls the steam wand to produce steam. When turning the knob, be careful to rotate slowly, as the greater the rotation angle, the greater the pressure.

**WARNING:** Be sure to operate carefully as the steam may result in scald to person.

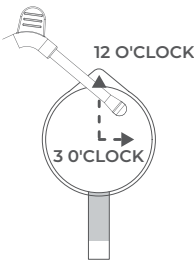

3. Insert the steam wand into the milk about 20mm deep. The steam wand arm is at 12 o'clock, the steam wand outlet is at 3 o'clock.

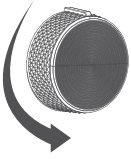

4. Then slowly turn the knob to “ON” position, steam will come out from the steam outlet and the steam indicator keeps on. As you continue to rotate to “☼/☼” position, the pressure will gradually increase. Froth milk in the way moving the jug round from up to down.

**NOTE:** During making steam, the metal funnel must be assembled in position.

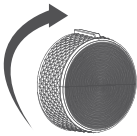

5. The maximum working time of steam is 180 seconds. When the required volume foam is reached, you can turn the knob off.



6. After steam wand stops generating, clean steam outlet with a thick and wet sponge immediately and turn the knob again to “ON” position for a few seconds to discharge the residual foam inside the wand. Be care not to hurt!



7. Pour the frothed milk into the espresso prepared, now the cappuccino is ready. Sweeten to taste and sprinkle the froth with a little cocoa powder if desired.

**NOTE:** After steaming, it is not recommended to brew coffee again immediately. If you do so, the taste of coffee will be affected.

## **DISPENSING AMOUNT SETTINGS**

- **Set the Dispensing Amount of Single Cup**

Hold and press the single-cup button for 3 seconds to enter into the mode of setting the dispensing amount, the single-cup indicator flashes. Press the single-cup button once, the coffee starts to dispense and the single-cup indicator keeps flashing. When the machine dispensing your desired amount of water (in about 10-25 seconds), press the single-cup button again, the coffee stops dispensing, the single-cup indicator keeps on, the setting for the dispensing amount of single cup is finished and it will be saved for next operation. Operating within 10 seconds is ineffective.

- **Set the Dispensing Amount of Double-Cup**

Hold and press the double-cup button for 3 seconds to enter into the mode of setting the dispensing amount, the double-cup indicator flashes. Then operate the same for the corresponding button, as above. The adjustable dispensing amount of double-cup ranges between 20-50 seconds. Operating within 20 seconds is ineffective.

- **Restore Factory Setting of the Dispensing Amount**

Simultaneously hold and press the single-cup and double-cup buttons for 3 seconds, the two indicators flashes 3 times and the machine recovers the factory setting of dispensing amount.

## **AUTOMATICALLY POWER-OFF FUNCTION**

After pressing the power button, if there is no any operation within 29 minutes, the unit will power off automatically.

## **CLEAN AND MAINTENANCE**

1. Cut off power source and let the coffee maker cool down completely before cleaning.
2. Clean housing of coffee maker with moisture-proof sponge often and clean water tank, drip tray and drip plate regularly then dry them.

**NOTE:** Do not clean with alcohol or solvent cleanser. Never immerse the housing in water.

3. Detach the metal funnel by turning it clockwise, get rid of coffee residue inside, then you can clean it with cleanser and rinse with clear water.
4. Clean all the attachments in the water and dry thoroughly.

## **DESCALING - CLEANING MINERAL DEPOSITS**

1. To make sure your coffee maker operating efficiently, internal piping is clean and the peak flavor of coffee, the coffee machine needs to be descaled, cleaned and maintained periodically. Descaling warning will be shown when the appliance has cumulatively worked for 500 cycles, at that time, all indicators will flash for 5 times after preheating, then the appliance will go back into normal condition.
2. To conduct the descaling, fill the water tank with water and detergent to the MAX level (the scale of water and detergent is 4:1. Please use household detergent or the citric acid (obtainable from chemist's or drug stores) and scale of the water and citric acid is 100:3.
3. Please prepare two containers with different volumes (500ml and 1L respectively recommended), place the 500ml container under the brew head and the 1L container under the steam wand nozzle.
4. Press and hold the steam button for 5 seconds, the single cup and double cup indicators begin to flash, and the coffee machine automatically performs descaling. After about 11 minutes, the single cup and double cup indicators flash faster. Now immediately turn the knob to "ON" position to dispensing water from the steam outlet, then reset the knob in 1 minute. The descaling completed.
5. It is recommended to add the water tank with clean water to the MAX level and repeat Step 4 twice to remove residual detergent.

**NOTE:** If you do not need to descaling, you can press and hold the single cup, double cup and steam buttons for 3 second, the indicators quickly flash 5 times and the descaling warning canceled.

## TROUBLE SHOOTING

Symptom	Cause	Corrections
Water leaks from the bottom of coffee maker.	There is much water in the drip tray.	Please clean the drip tray.
	The coffee maker is malfunction.	Contact with the authorized service facility for repairing.
Water leaks out of outer side of filter.	There is coffee powder on filter edge.	Get rid of them.
Acid (vinegar) taste exists in Espresso coffee.	Clean incorrectly after cleaning mineral deposits.	Clean coffee maker per the content in “before the first use” for several times.
	The coffee powder is stored in a hot, wet place for a long time. The coffee powder turns bad.	Please use fresh coffee powder, or store unused coffee powder in a cool, dry place. After opening a package of coffee powder, reseal it tightly and store it in a refrigerator to maintain its freshness.
The coffee maker cannot work any more.	The power outlet is not plugged well.	Plug the power cord into a wall outlet correctly, if the appliance still does not work, please contact with the authorized service facility for repairing.
The steam cannot froth.	The white indicator is not illuminated.	Only after the white indicator is illuminated, the steam can be used to froth.
	The container is too big or the shape is not fit.	Use high and narrow cup.
	You have used skimmed milk	Use whole milk or half-skimmed milk.
All indicators blink simultaneously.	Make hot water over 60s and the knob is not reset. The knob is not reset after cooling down.	Reset knob to off position.
All indicators blink simultaneously.	Make steam for 180s and the knob is not reset.	Reset knob to off position.
All indicators blink simultaneously.	The knob is not reset to off position, but the machine turned on.	Reset knob to off position.
All indicators blink at the same time for 5 times.	Need to descale.	Descale.

***Do not take apart the appliance by yourself if the cause of failure is not found, you had better contact certified serving center.***

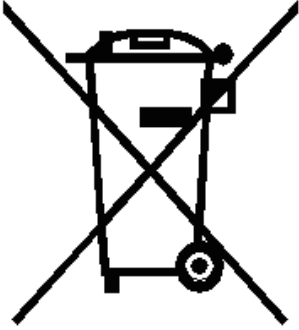

## Environment friendly disposal

You can help protect the environment!  
Please remember to respect the local regulations:  
hand in the non-working electrical equipment to an  
appropriate waste disposal center.

Thank you for purchasing this product! If you have any question about the product, such as missing parts, damaged products, product assembling, and operation, please contact us via customer service number: **661-435-8826**.

**IMPORTANT**

Please call our customer service department for any consulting:

**661-435-8826**

(8:30am - 5:30pm P.S.T.)

DATED PROOF OF PURCHASE IS REQUIRED FOR WARRANTY SERVICE.

**AVIS**

Veillez appeler le service à la clientèle pour toutes questions au:

**661-435-8826**

(8:30am - 5:30pm P.S.T.)

PREUVE D'ACHAT ORIGINALE REQUISE POUR SERVICE DE GARANTIE.

**IMPORTANTE**

Sólo hay que llamar nuestro departamento de servicio al cliente en caso de tener preguntas o inquietudes:

**661-435-8826**

(8:30am - 5:30pm P.S.T.)

SE REQUIERE PRUEBA DE COMPRA CON FECHA PARA SERVICIO BAJO GARANTÍA.

**ROWAN ELECTRIC APPLIANCE LLC**

**Phone: 661-435-8826**