

ASSEMBLY INSTRUCTION

DESCRIPTION : 4/6 BOOKCASE HEADBOARD - K/D

Thank you for purchasing this quality product. Be sure to check all packing material carefully for small parts, which may have come loose inside the carton during shipment. Identify and count all parts and compare with the parts list below.

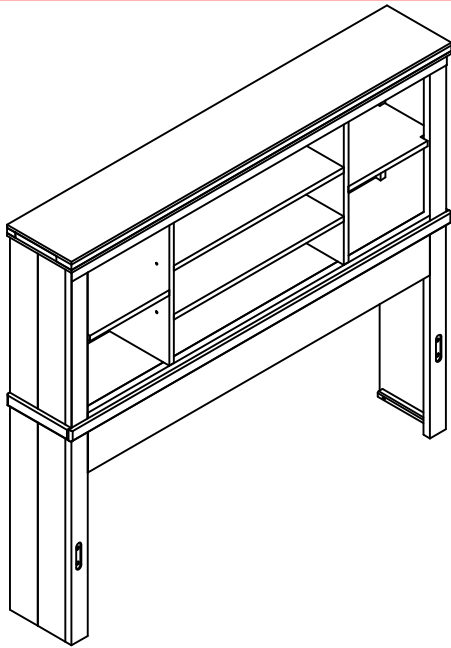

PARTS LIST

NO	SKETCH	DESCRIPTION	Q'TY
1		Upholstered Headboard	1 pc
2		Leg (Pack with HB)	2 pcs
3		Bottom Stretcher	1 pc

HARDWARE LIST

NO	SKETCH	DESCRIPTION	SIZE	Q'TY
A		JCBC Bolt	1/4"x38mm	14 pcs
B		Spring Washer	1/4"	14 pcs
C		Flat Washer	1/4"x19x2mm	14 pcs
D		Allen Key	M4	1 pc
E		Wood Dowel	M10x35mm	2 pcs

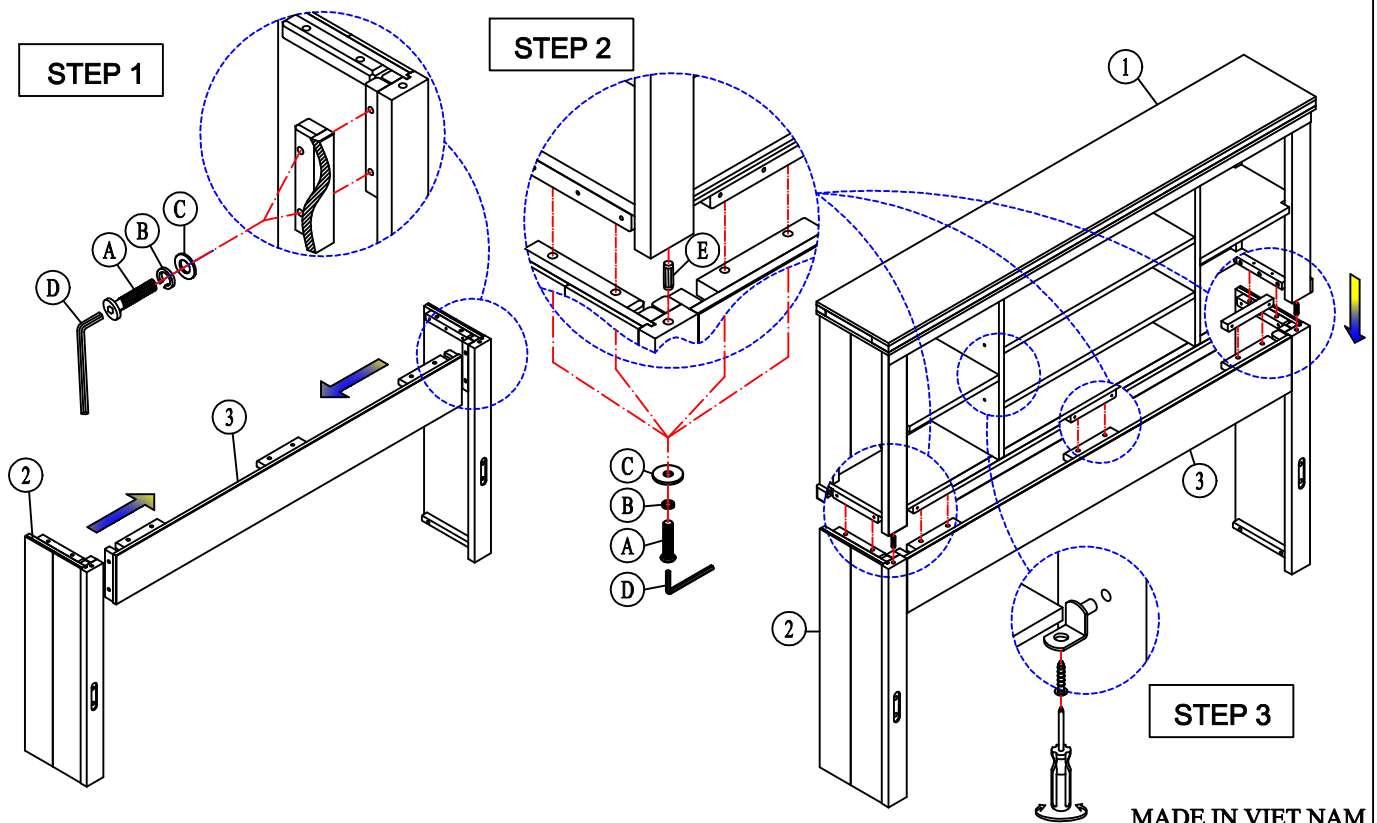

MADE IN VIET NAM