

### Features

- VibrAcoustic calms and soothes with sound vibration technology.
- Six concealed speakers send sound waves through the water to gently massage the body.
- Four original instrumental compositions offer different levels of relaxation.
- Plug in your smart phone, tablet, or MP3 player via auxiliary-in cable. Add your own receiver to stream wirelessly via Bluetooth®.
- Customize your experience with the high-resolution color touch screen.
- Fully adjustable volume above and below the water.
- Functions as a hydrotherapy bath when full of water and a stereo system when empty.
- Bask™ heated surface creates spa-like relaxation with soothing warmth on your back and neck.
- Three heat settings allow you to customize the surface temperature.
- Chromatherapy lighting allows you to select a preferred color scheme to suit your mood.
- Clearflo slotted overflow for deep soaking.
- \*The BLUETOOTH® word mark and logos are registered trademarks owned by Bluetooth SIG, Inc. and any use of such marks by Kohler Co. is under license. Other trademarks and trade names are those of their respective owners.
- 60 " (1524 mm) x 30 " (762 mm) x 19 " (483 mm)

### Material

- Acrylic

### Hydrotherapy

- VibrAcoustic
- Chromatherapy

### Installation

- Drop-in or under-mount.



ADA

### Codes/Standards











CSA B45.5/IAPMO Z124  
ASTM E162  
ASTM E662  
UL 1795  
CSA C22.2 No. 218.2  
ADA  
ICC/ANSI A117.1

### KOHLER® One-Year Limited Warranty KOHLER® Electronic Faucets, Valves, and Controls - Five-Year Limited Warranty

See website for detailed warranty information.

### Available Color/Finishes

*Color tiles intended for reference only.*

| Color  | Code | Description   |
|--|------|---------------|
|  | 0    | White         |
|  | 96   | Biscuit       |
|  | 47   | Almond        |
|  | NY   | Dune          |
|  | 95   | Ice™ Grey     |
|  | G9   | Sandbar       |
|  | 33   | Mexican Sand™ |
|  | K4   | Cashmere      |
|  | 58   | Thunder™ Grey |
|  | 7    | Black Black™  |

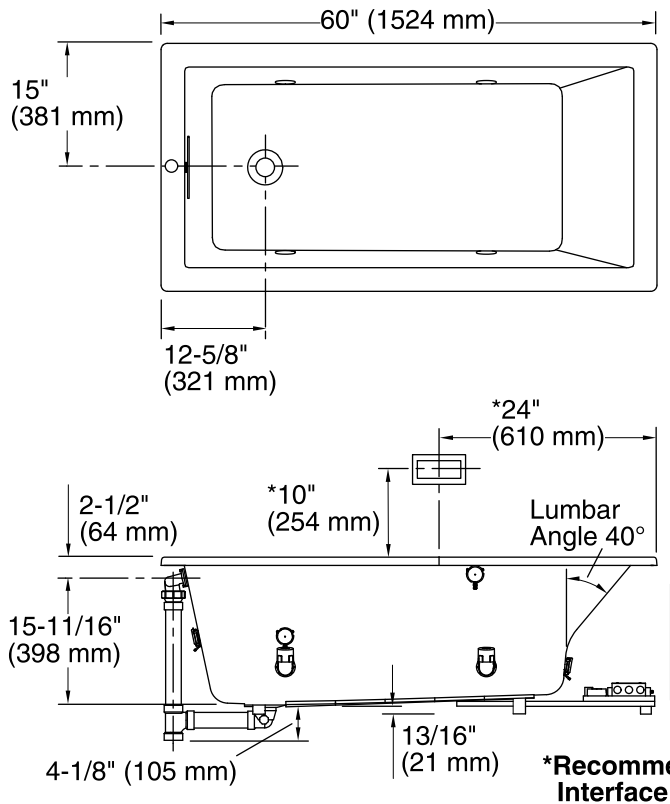

No change in measurement if connected with drain illustrated. (K-7272)

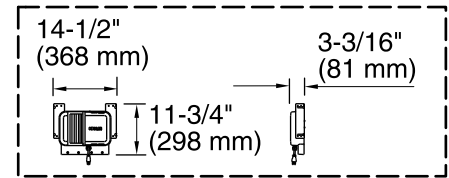
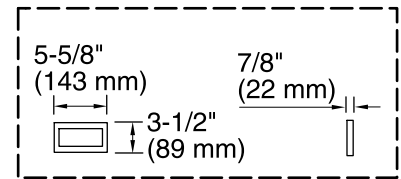

Control Access  
 30" (762 mm) W  
 x 15" (381 mm) H  
 Min

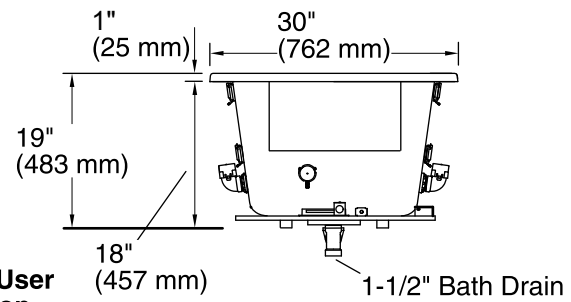

**\*Recommended User Interface Location**

### Required Electrical Service

One dedicated circuit required, protected with Class A Ground-Fault Circuit-Interrupter (GFCI) or Residual Current Device (RCD).

Amplifier, Heater: 120 V, 15 A, 50/60 Hz

### Technical Information

All product dimensions are nominal.

|                     |   |
|---------------------|---|
| Installation:       | Drop-in/Undermount  |
| Drain location:     | Reversible  |
| Basin area, bottom: | 42-3/8" x 20" (1076 mm x 508 mm)                                      |
| Basin area, top:    | 54-3/8" x 24-5/16" (1381 mm x 618 mm)                                 |
| Weight:             | 80 lbs (36.3 kg)  |
| Minimum floor load: | 50 lbs/ft <sup>2</sup> (244.1 kg/m <sup>2</sup> )                     |
| Water depth:        | 15-1/16" (383 mm)   |
| Water capacity:     | 59.8 gal (226.4 L)  |
| Cutout:             | Drop-in, 59-1/2" x 28-1/2" (1511 mm x 724 mm)                         |
| Under-mount kit:    | 531   |
| Electrical rating:  | Amplifier: 120 V, 50/60 Hz, 15 W<br>Heater: 120 V, 1.1 A, 60 Hz, 65 W |

### Notes

Install this product according to the installation guide. Ensure that the bath, user interface, amplifier, and transducers are functional before completing the installation.

Control amplifier fits 16" (406 mm) center studs. 25' (7.6 m) cables are included.

Locate the bath within 24" (610 mm) of a GFCI-protected 120 V, 15 A grounded electrical outlet. A second grounded outlet within the wall framing must be within 24" (610 mm) of the planned control amplifier. One electrical service may be used for the entire bath and related electrical components.

Hot water supply should be 70% of capacity or greater. Installations will vary.

ADA compliant when installed to the specific requirements of these regulations.