

# VEVOR

**Affordable. Reliable. Home Improvement.**

## **UNIVERSAL TV STAND**

**MODEL:PCT01-2**

Technical Support and E-Warranty Certificate

[www.vevor.com/support](http://www.vevor.com/support)

# VEVOR

Affordable. Reliable. Home Improvement.

## UNIVERSAL TV STAND

MODEL:PCT01-2

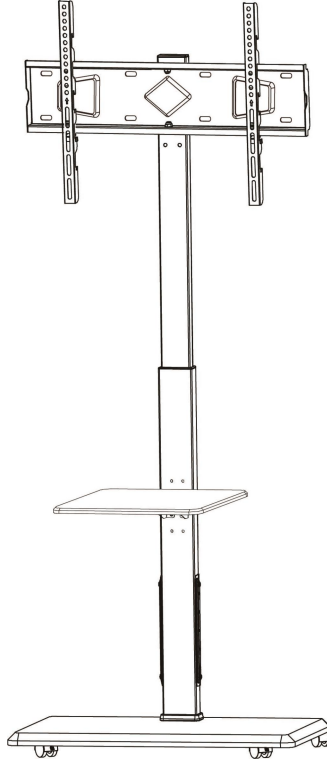

100x100 400x100  
200x100 400x200  
200x200 400x300  
300x200 400x400  
300x300 600x400



RATED LISTED WEIGHT. SERIOUS INJURY OR PROPERTY DAMAGE MAY OCCUR!

PCT01-2

This is the original instruction, please read all manual instructions carefully before operating. VEVOR reserves a clear interpretation of our user manual. The appearance of the product shall be subject to the product you received. Please forgive us that we won't inform you again if there are any technology or software updates on our product.

## SAFETY INSTRUCTIONS

### **WARNING:**

**Before installation, please ensure that your TV stand mounting holes, dimensions, and weight can meet the specifications and standards of the TV stand. If you have any questions or questions about the instructions and warnings, please contact us for help..**



### **Important:**

1. When installing the support, please use professional safety devices and tools in accordance with the requirements of the assembly instructions. Improper installation may cause the TV to fall or serious injury.
2. Before installation, ensure that the support surface can safely support the weight of the device and all accessories.
3. Please do not exceed the intended load capacity, otherwise it may cause serious injury or property damage.
4. This product contains small parts, swallowing them may cause choking hazards. Please keep out of reach of children.
5. This product is only suitable for indoor use, outdoor use may cause product damage and personal injury risk.

### **Maintenance:**

Please check the connection between the bracket and the TV periodically to ensure it remains stable, and verify that the screws have not loosened or fallen off due to long-term use (at least once every three months). If any security risks are identified, replace or reinforce the parts promptly.

### **WARNING FOR POWER STRIP:**

### **ELECTRICAL SHOCK AND FIRE HAZARD !**

The power strip is not to be connected to power prior to installation. Failure to comply with this instruction could result in an electrical failure, fire and

electrocution.

**IMPORTANT:** Installation of this power strip and related wiring must be done by a qualified electrician in compliance with all applicable electrical codes,

- If the supply cord is damaged, it must be replaced by the manufacturer, its service agent or similarly qualified persons in order to avoid a hazard.
- For indoor use only.
- Under no circumstances could the cover be opened. If the cover is damaged, the adapter may no longer be used.
- This appliance can be used by children aged 8 years and above and persons with reduced physical, sensory or mental capabilities or lack of experience and knowledge if they have been given supervision or instruction concerning use of the appliance in a safe way and understand the hazards involved.
- Children shall not play with the appliance.
- Cleaning and user maintenance shall not be made by children without supervision.

**SAVE THIS MANUAL**

# PARTS LIST

## PART LIST

	① X1		③ X1	Plastic Washer Steel Washer	
	② X1		④ X1		
	⑤ X1		⑥ X2		M6X50 G X4
	⑦ X1		⑧ X2		H X4
	⑨ X2		⑩ X2		M6X10 I X20
	⑪ X1		⑫ X2		M6X16X1.5 J X8
	⑬ X1		⑭ X2		M6X16 K X4
	⑮ X2		⑯ X2		M8X50 A X3
	⑰ X1		⑱ X2		M8X20X1 B X3
	⑲ X2		⑳ X2		M8X22X2 C X3
	㉑ X1		㉒ X2		M6X45 D X4
	㉓ X1		㉔ X2		E X2
	㉕ X1		㉖ X2		F X2
	㉗ X1		㉘ X2		L X1 4mm
	㉙ X1		㉚ X2		L X1 5mm
	㉛ X2		㉜ X2		L X1
	㉝ X1		㉞ X2		M X3
	㉟ X1		㊱ X2		N X2

## FOR TV INSTALLATION

M4X30 TV1 X4	M6X16 TV2 X4	M6X35 TV3 X4	M8X16 TV4 X4	M8X35 TV5 X4
M8X50 TV6 X4	SP1 TV7 X8	SP2 TV8 X4	SP3 TV9 X4	Washer TV10 X4

# ASSEMBLY STEP

1

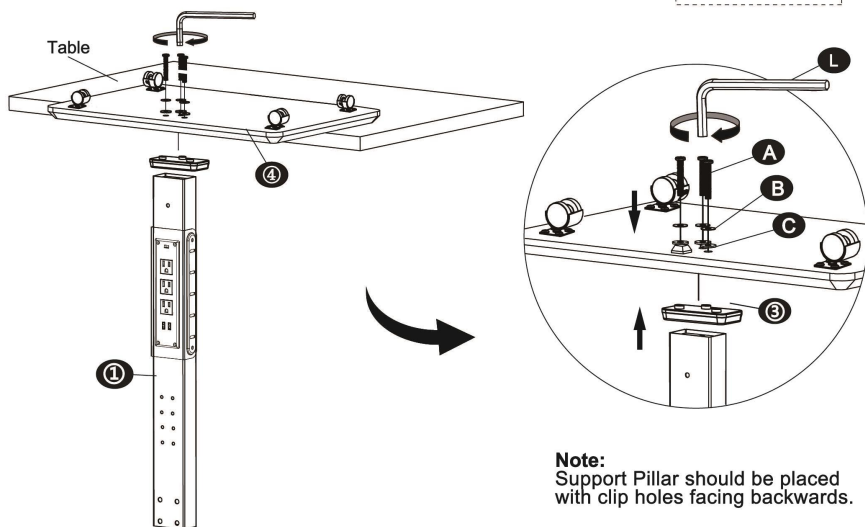
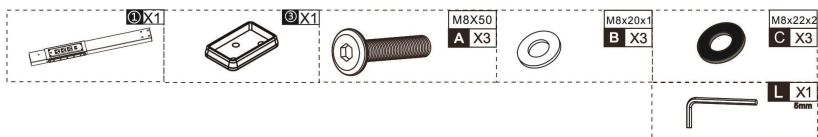
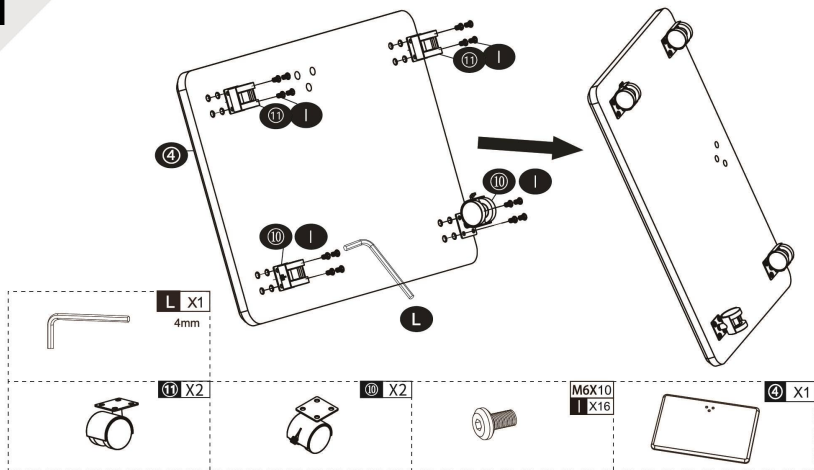

# 2

**Note:**  
Support Pillar should be assembled with clip holes in the same side.

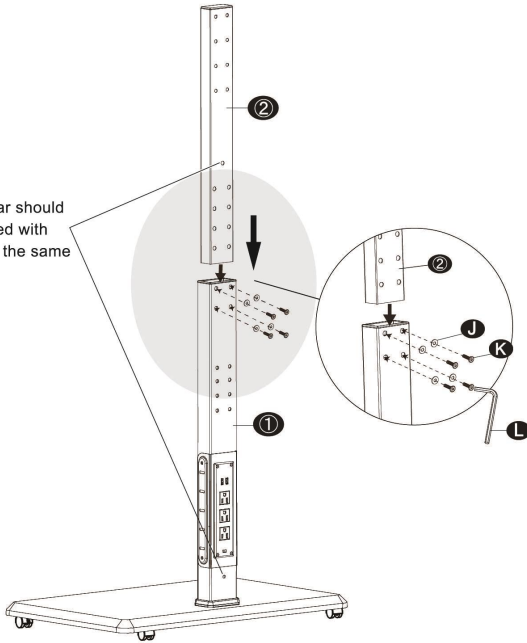

	<b>2</b> X1
	M6X16 <b>K</b> X4
	M6X16X1.5 <b>J</b> X4
	<b>L</b> X1 4mm

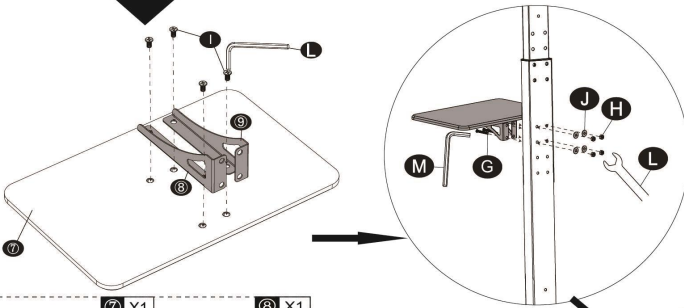

	<b>7</b> X1		<b>B</b> X1
	<b>H</b> X4		<b>C</b> X1
	<b>L</b> X1 4mm		M6X16X1.5 <b>J</b> X4
	M6X10 <b>I</b> X4		M6X50 <b>G</b> X4
			<b>L</b> X1

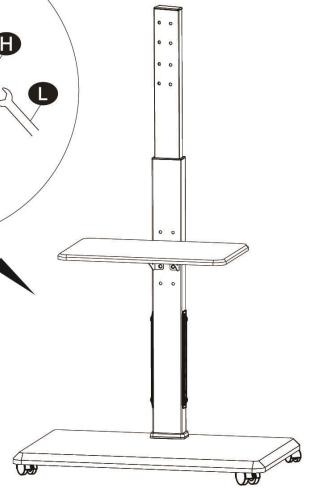

3

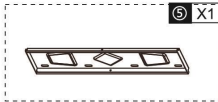

M6X45

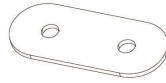

E X2

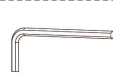

L X1  
4mm

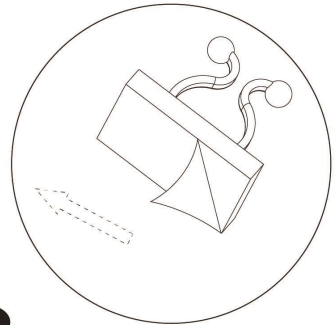
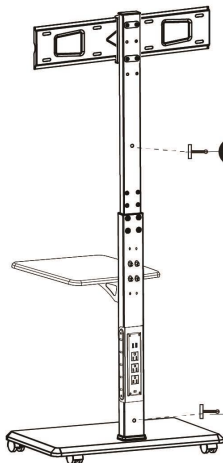
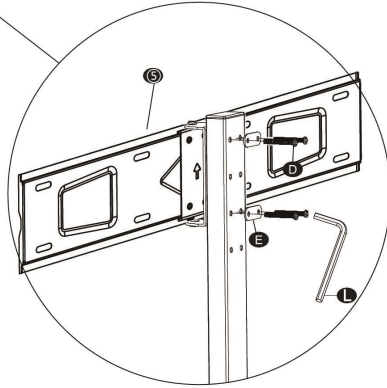
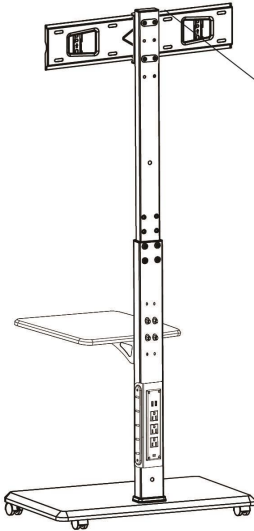

N X2

# 4

## Measure the TV fixing holes Width and Height

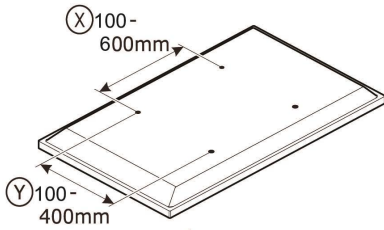

If width  $\textcircled{X}$  is greater than 600mm or height  $\textcircled{Y}$  greater than 400mm STOP installation now and contact the customer help line

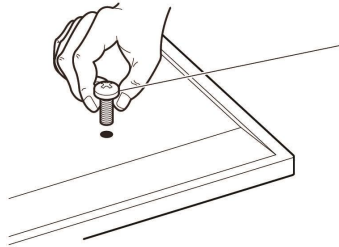

- TV1
- TV2-3
- TV4-6

You are provided with 4 diameters of TV fixing screws, **M4**, **M5** and **M8**. Determine the screw diameter that fits.

**Spacers**

**SP**

For TVs with irregular/obstructed back

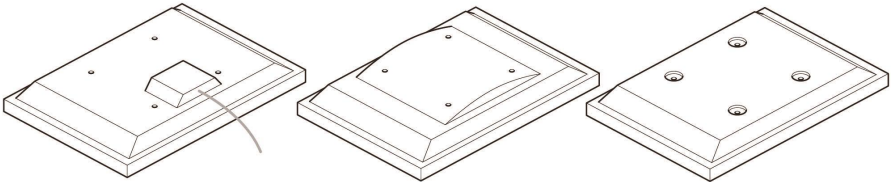

**No Spacers**

For TVs with flat/unobstructed back

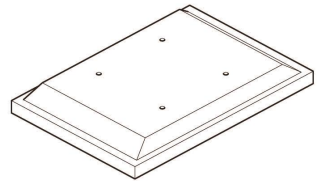

**WARNING**

please keep for future reference.

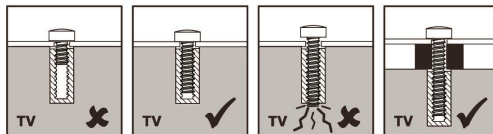

5

NOT INCLUDED

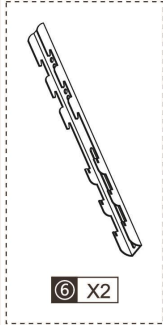
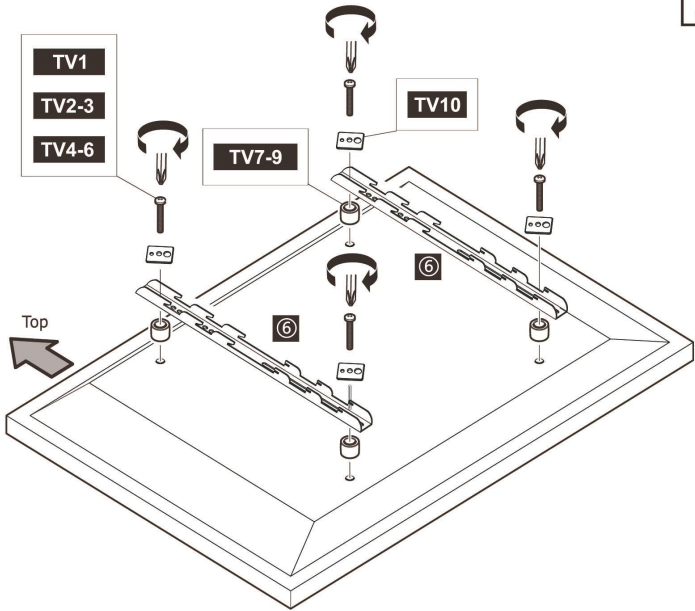

+



+

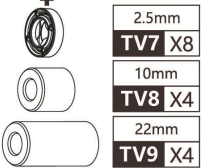

+



+

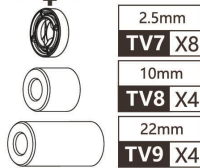

+



+

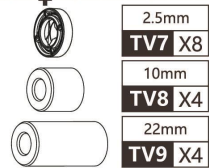

Attach the bracket to the back of your TV using suitable screw, reducer and spacer combinations.

6

NOT INCLUDED



M X3

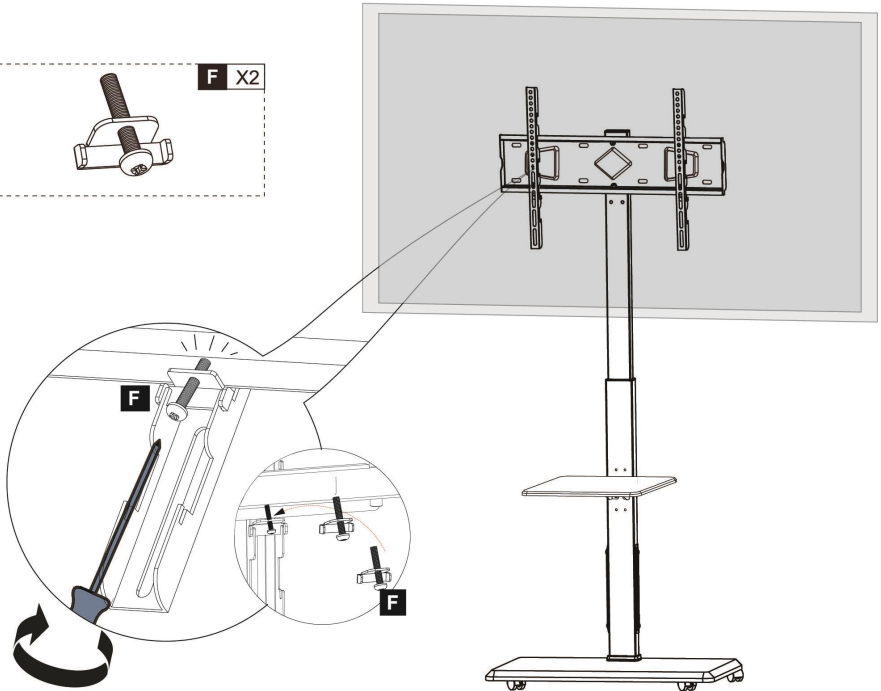
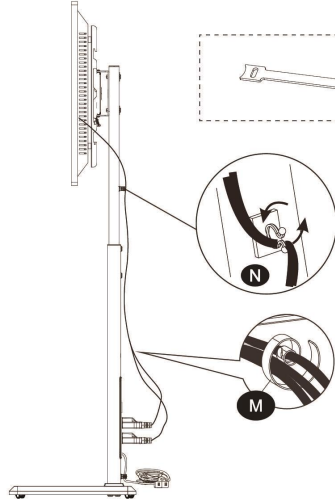
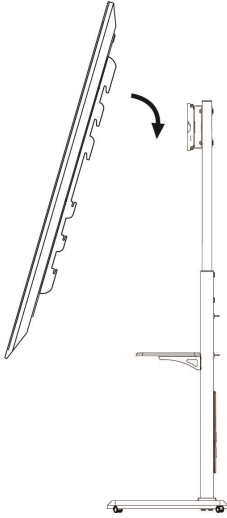

## PRODUCT PARAMETER

<b>Model</b>	PCT01-2
<b>Power</b>	AC125V 60Hz 12A (Via Power Strip)
<b>Safe Loading Weight</b>	88 LBS
<b>Product Size</b>	660*380*(1365-1620)mm

**Manufacturer:** Shanghaimuxinmuyeyouxiangongsi

**Address:** Shuangchenglu 803nong11hao1602A-1609shi, baoshanqu, shanghai 200000 CN.

**Imported to AUS:** SIHAO PTY LTD. 1 ROKEVA STREETEASTWOOD NSW 2122 Australia

**Imported to USA:** Sanven Technology Ltd. Suite 250, 9166 Anaheim Place, Rancho Cucamonga, CA 91730



YH CONSULTING LIMITED. C/O YH Consulting Limited Office 147, Centurion House, London Road, Staines-upon-Thames, Surrey, TW18 4AX



E-CrossStu GmbH  
Mainzer Landstr.69,  
60329 Frankfurt am Main.



**Technical Support and E-Warranty Certificate**  
[www.vevor.com/support](http://www.vevor.com/support)

# VEVOR

**Affordable. Reliable. Home Improvement.**

## SUPPORT TV UNIVERSEL

MODÈLE : PCT01-2

Assistance technique et certificat de garantie

électronique [www.vevor.com/support](http://www.vevor.com/support)

# VEVOR

Affordable. Reliable. Home Improvement.

## SUPPORT TV UNIVERSEL

MODÈLE : PCT01-2



100x100	400x100
200x100	400x200
200x200	400x300
300x200	400x400
300x300	600x400



RATED LISTED WEIGHT. SERIOUS INJURY OR PROPERTY DAMAGE MAY OCCUR!

PCT01-2

Il s'agit de la notice d'utilisation d'origine. Veuillez lire attentivement toutes les instructions du manuel avant de l'utiliser. VEVOR se réserve le droit d'interpréter clairement notre manuel d'utilisation. L'apparence du produit dépend du produit que vous avez reçu. Veuillez nous excuser, nous ne vous informerons plus si des mises à jour technologiques ou logicielles sont disponibles sur notre produit.

## CONSIGNES DE SÉCURITÉ

### AVERTISSEMENT:

Avant l'installation, assurez-vous que les trous de montage, les dimensions et le poids de votre support TV peuvent répondre aux spécifications et aux normes de meuble TV. Si vous avez des questions ou des questions sur le instructions et avertissements, veuillez nous contacter pour obtenir de l'aide.



### Important:

1. Lors de l'installation du support, veuillez utiliser des dispositifs de sécurité professionnels et des outils conformes aux exigences de l'assemblage instructions. Une installation incorrecte peut entraîner la chute du téléviseur ou de graves blessure.
2. Avant l'installation, assurez-vous que la surface de support peut supporter en toute sécurité le poids de l'appareil et de tous les accessoires.
3. Veuillez ne pas dépasser la capacité de charge prévue, sinon cela pourrait causer des blessures graves ou des dommages matériels.
4. Ce produit contient de petites pièces, leur ingestion peut provoquer Risque d'étouffement. Tenir hors de portée des enfants.
5. Ce produit est uniquement adapté à une utilisation en intérieur. Une utilisation en extérieur peut provoquer risque de dommages au produit et de blessures corporelles.

### Entretien:

Veuillez vérifier périodiquement la connexion entre le support et le téléviseur pour s'assurer qu'il reste stable et vérifier que les vis ne se sont pas desserrées ou tombé en raison d'une utilisation à long terme (au moins une fois tous les trois mois). Si les risques de sécurité sont identifiés, remplacez ou renforcez les pièces rapidement.

### AVERTISSEMENT POUR LA MULTIPLICATION D'ALIMENTATION :

### RISQUE DE CHOC ÉLECTRIQUE ET D'INCENDIE !

La multiprise ne doit pas être connectée à l'alimentation électrique avant l'installation. Le non-respect de cette instruction peut entraîner une panne électrique, un incendie et

électrocution.

**IMPORTANT** : L'installation de cette multiprise et du câblage associé doit être effectué par un électricien qualifié conformément à toutes les normes électriques en vigueur. codes, -

Si le cordon d'alimentation est endommagé, il doit être remplacé par le fabricant, son agent de service ou des personnes qualifiées de manière similaire afin d'éviter tout danger.

- Pour usage intérieur uniquement.

- Le couvercle ne doit en aucun cas être ouvert. Si le couvercle est endommagé, l'adaptateur ne peut plus être utilisé.

- Cet appareil peut être utilisé par des enfants âgés de 8 ans et plus et personnes ayant des capacités physiques, sensorielles ou mentales réduites ou dépourvues de expérience et connaissances s'ils ont reçu une supervision ou instructions concernant l'utilisation de l'appareil de manière sûre et comprendre les dangers encourus.

- Les enfants ne doivent pas jouer avec l'appareil.

- Le nettoyage et l'entretien de l'utilisateur ne doivent pas être effectués par des enfants sans surveillance.

**CONSERVER CE MANUEL**

LISTE DES PIÈCES

**PART LIST**

	① X1		③ X1	Plastic Washer Steel Washer		M6X50 G X4
	② X1		④ X1			H X4
	⑤ X1		⑥ X2		M6X10 I X20	
	⑦ X1		⑧ X2		M6X16X1.5 J X8	
	⑨ X1		⑩ X2		M6X16 K X4	
	⑪ X2		⑫ X2		M8X50 A X3	
	⑬ X2		⑭ X2		M8x20x1 B X3	
	⑮ X1		⑯ X2		M8x22x2 C X3	
	⑰ X1		⑰ X2		M6X45 D X4	
	⑱ X1		⑱ X2		E X2	
	⑲ X1		⑲ X2		F X2	
					L X1 4mm	
					L X1 5mm	
					M X3	
					N X2	

**FOR TV INSTALLATION**

M4X30 TV1 X4	M6X16 TV2 X4	M6X35 TV3 X4	M8X16 TV4 X4	M8X35 TV5 X4
M8X50 TV6 X4	SP1 TV7 X8	SP2 TV8 X4	SP3 TV9 X4	Washer TV10 X4

## ÉTAPE D'ASSEMBLAGE

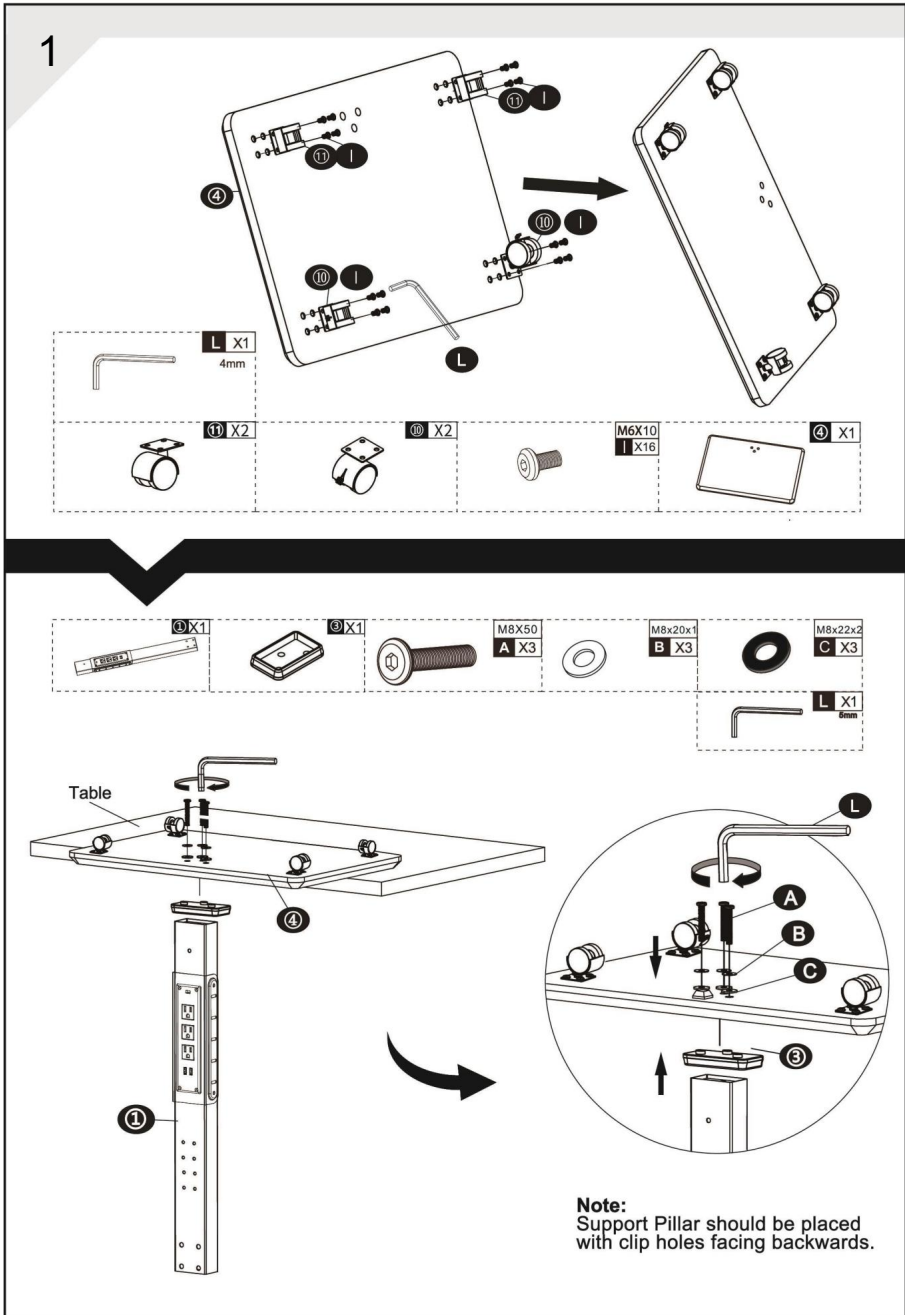

2

**Note:**  
Support Pillar should be assembled with clip holes in the same side.

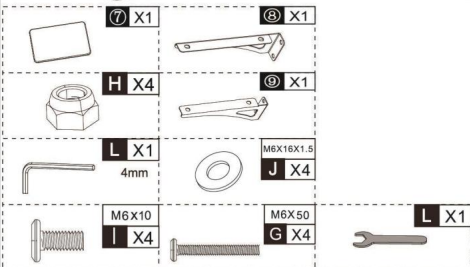
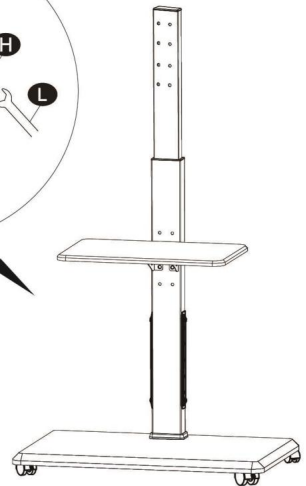
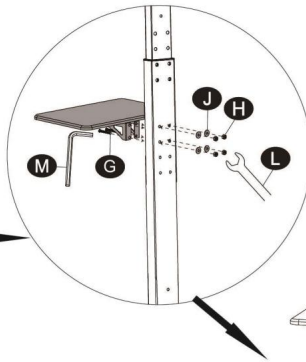
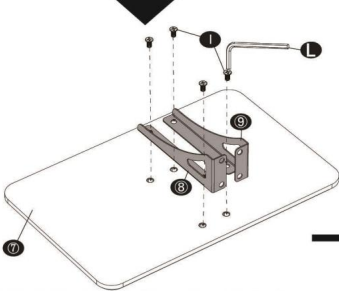
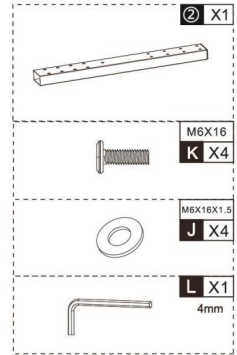
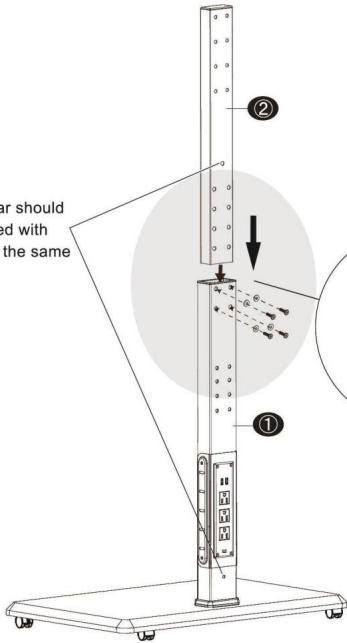

3

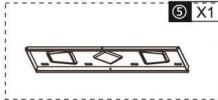

M6X45  
D X4

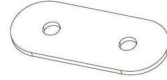

E X2

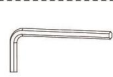

L X1  
4mm

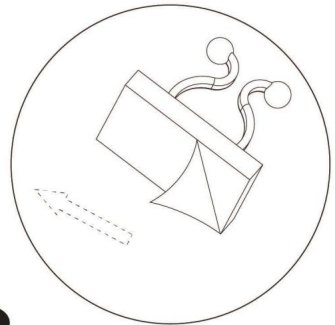
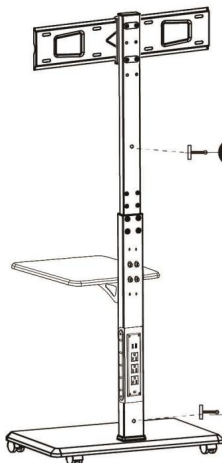
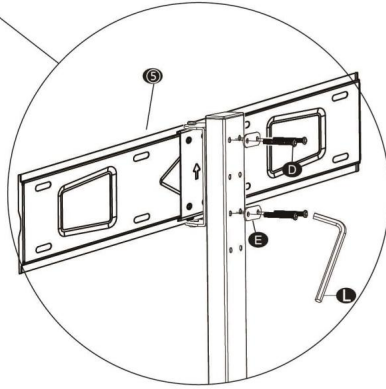

# 4

## Measure the TV fixing holes Width and Height

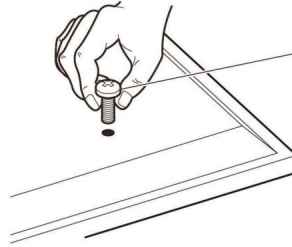
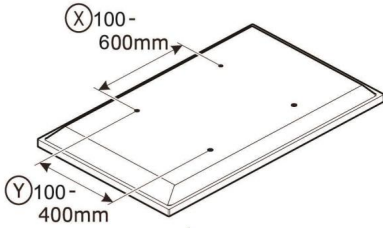

- TV1
- TV2-3
- TV4-6



If width  $\textcircled{X}$  is greater than 600mm or height  $\textcircled{Y}$  greater than 400mm STOP installation now and contact the customer help line

You are provided with 4 diameters of TV fixing screws, **M4**, **M5** and **M8**. Determine the screw diameter that fits.

Spacers

SP

For TVs with irregular/obstructed back

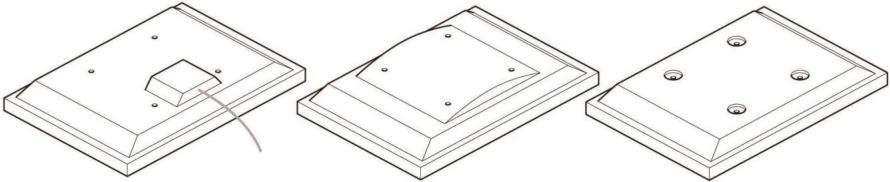

No Spacers

For TVs with flat/unobstructed back

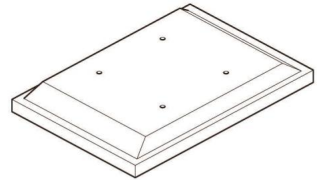

WARNING

please keep for future reference.

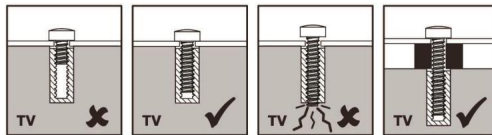

5

NOT INCLUDED

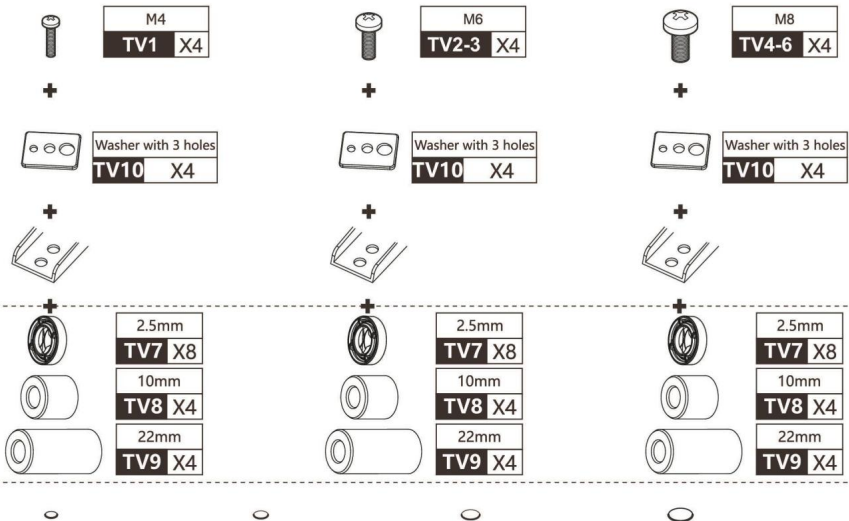
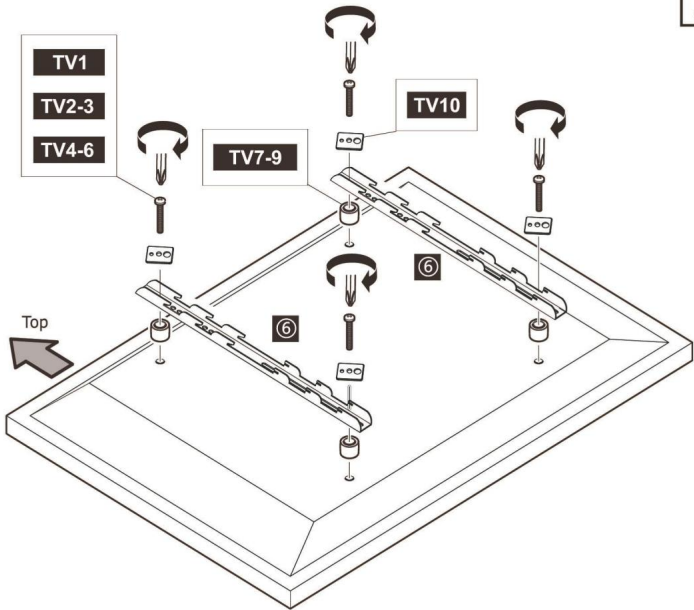
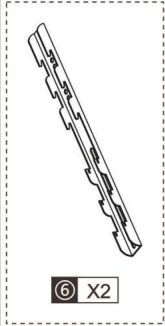

Attach the bracket to the back of your TV using suitable screw, reducer and spacer combinations.

6

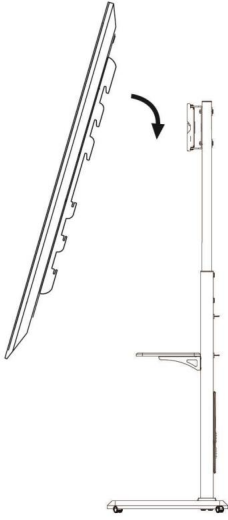

NOT INCLUDED 

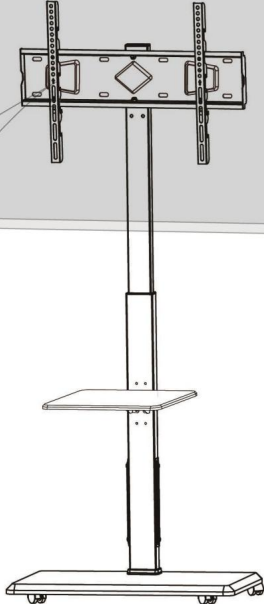
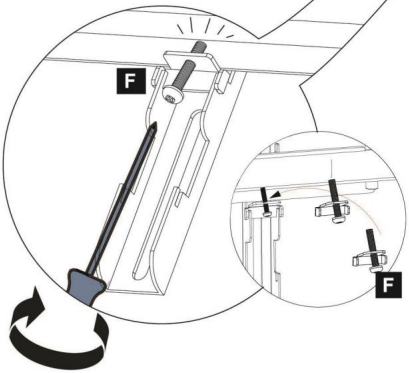
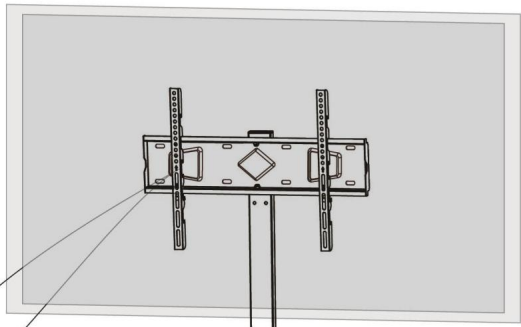
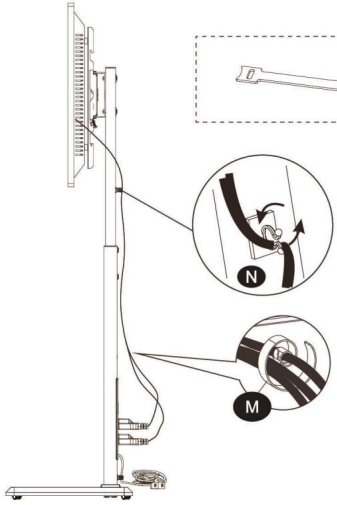

## PARAMÈTRE DU PRODUIT

Modèle	PCT01-2
Pouvoir	AC125V 60Hz 12A (via multiprise)
Poids de chargement sécuritaire	88 livres
Taille du produit	660*380*(1365-1620)mm

Fabricant : Shanghaimuxinmuyeyouxiangongsi

Adresse : Shuangchenglu 803nong11hao1602A-1609shi, Baoshanqu, Shanghai 200000 CN.

Importé en Australie : SIHAO PTY LTD. 1 ROKEVA STREETEASTWOOD NSW 2122 Australie

Importé aux États-Unis : Sanven Technology Ltd. Suite 250, 9166 Anaheim Lieu, Rancho Cucamonga, CA 91730



YH CONSULTING LIMITED. Avec l'aide de YH Consulting  
Bureau limité 147, Centurion House, Londres  
Route, Staines-upon-Thames, Surrey, TW18 4AX



E-CrossStu GmbH  
69, rue Mainzer Landstr.,  
60329 Francfort-sur-le-Main.



Assistance technique et certificat de garantie électronique  
[www.vevor.com/support](http://www.vevor.com/support)

# VEVOR

**Affordable. Reliable. Home Improvement.**

**UNIVERSAL-TV-STÄNDER**

**MODELL:PCT01-2**

Technischer Support und E-Garantie-Zertifikat

[www.vevor.com/support](http://www.vevor.com/support)

# VEVOR

Affordable. Reliable. Home Improvement.

## UNIVERSAL-TV-STÄNDER

MODELL:PCT01-2



100x100	400x100
200x100	400x200
200x200	400x300
300x200	400x400
300x300	600x400



RATED LISTED WEIGHT. SERIOUS INJURY OR PROPERTY DAMAGE MAY OCCUR!

PCT01-2

Dies ist die Originalanleitung. Bitte lesen Sie alle Anweisungen sorgfältig durch, bevor Sie das Gerät in Betrieb nehmen. VEVOR behält sich eine klare Auslegung unserer Bedienungsanleitung vor. Das Erscheinungsbild des Produkts richtet sich nach dem Produkt, das Sie erhalten haben. Bitte verzeihen Sie uns, dass wir Sie nicht erneut informieren, wenn es Technologie- oder Software-Updates für unser Produkt gibt.

## SICHERHEITSHINWEISE

### WARNUNG:

**Stellen Sie vor der Installation sicher, dass die Befestigungslöcher, Abmessungen und das Gewicht Ihres TV-Ständers den Spezifikationen und Standards entsprechen. der TV-Ständer. Wenn Sie Fragen oder Fragen zu den Anweisungen und Warnungen, bitte kontaktieren Sie uns für Hilfe.**



### Wichtig:

1. Verwenden Sie bei der Montage der Stütze professionelle Sicherheitsvorrichtungen und Werkzeuge entsprechend den Anforderungen der Montage Anweisungen. Eine unsachgemäße Installation kann zum Herunterfallen des Fernsehgeräts oder zu schweren Verletzungen.
2. Stellen Sie vor der Installation sicher, dass die Auflagefläche sicher tragen kann das Gewicht des Gerätes und sämtlichen Zubehörs.
3. Bitte überschreiten Sie nicht die vorgesehene Tragfähigkeit, sonst kann es schwere Verletzungen oder Sachschäden verursachen.
4. Dieses Produkt enthält Kleinteile, deren Verschlucken zu Erstickungsgefahr. Bitte außerhalb der Reichweite von Kindern aufbewahren.
5. Dieses Produkt ist nur für den Einsatz im Innenbereich geeignet. Bei Einsatz im Freien kann es zu Es besteht die Gefahr von Produktschäden und Verletzungen.

### Wartung:

Bitte überprüfen Sie regelmäßig die Verbindung zwischen der Halterung und dem Fernseher um sicherzustellen, dass es stabil bleibt, und überprüfen Sie, dass sich die Schrauben nicht gelöst haben oder durch langfristige Nutzung abgefallen (mindestens einmal alle drei Monate).

Werden Sicherheitsrisiken erkannt, sind die Teile zeitnah auszutauschen oder zu verstärken.

### WARNUNG ZUR STECKDOSENLEISTE:

#### STROMSCHLAG- UND BRANDGEFAHR!

Die Steckdosenleiste darf nicht an die Stromversorgung angeschlossen werden, bevor sie installiert wird.

Die Nichtbeachtung dieser Anweisung kann zu einem Stromausfall, einem Brand und

Stromschlag.

**WICHTIG:** Die Installation dieser Steckdosenleiste und der dazugehörigen Verkabelung muss von einem qualifizierten Elektriker unter Einhaltung aller geltenden elektrischen

- Wenn

das Netzkabel beschädigt ist, muss es vom Hersteller, seinem

Um Gefährdungen zu vermeiden, müssen Sie den Reparaturdienst oder eine ähnlich qualifizierte Person hinzuziehen.

- Nur für den Innenbereich.

- Unter keinen Umständen darf die Abdeckung geöffnet werden. Wenn die Abdeckung beschädigt ist, darf der Adapter nicht mehr verwendet werden.

- Dieses Gerät kann von Kindern ab 8 Jahren benutzt werden und

Personen mit eingeschränkten körperlichen, sensorischen oder geistigen Fähigkeiten oder Mangel an Erfahrung und Wissen, wenn sie beaufsichtigt werden oder

Anweisungen zur sicheren Verwendung des Geräts gelesen und verstanden haben.

die damit verbundenen Gefahren.

- Kinder dürfen nicht mit dem Gerät spielen.

- Reinigung und Benutzerwartung dürfen nicht von Kindern ohne Aufsicht.

**BEWAHREN SIE DIESES HANDBUCH AUF**

# TEILELISTE

## PART LIST

	① X1		③ X1			Plastic Washer
	② X1		④ X1			Steel Washer
	③ X1		⑤ X2		M8X50	<b>A</b> X3
	④ X1		⑥ X2		M8x20x1	<b>B</b> X3
	⑤ X1		⑦ X1		M8x22x2	<b>C</b> X3
	⑥ X2		⑧ X2		M6X45	<b>D</b> X4
	⑦ X1		⑨ X2		<b>E</b> X2	
	⑧ X2		⑩ X2		<b>F</b> X2	
	⑨ X2		⑪ X2		M6X50	<b>G</b> X4
	⑩ X2		⑫ X2		<b>H</b> X4	
	⑪ X2		⑬ X2		M6X10	<b>I</b> X20
	⑫ X2		⑭ X2		M6X16	<b>K</b> X4
	⑬ X2		⑮ X2		M6X16	<b>K</b> X4
	⑭ X2		⑯ X2		<b>L</b> X1	4mm
	⑮ X2		⑰ X2		<b>L</b> X1	5mm
	⑯ X2		⑱ X2		<b>L</b> X1	
	⑰ X2		⑲ X2		<b>M</b> X3	
	⑱ X2		⑳ X2		<b>N</b> X2	

## FOR TV INSTALLATION

M4X30 <b>TV1</b> X4	M6X16 <b>TV2</b> X4	M6X35 <b>TV3</b> X4	M8X16 <b>TV4</b> X4	M8X35 <b>TV5</b> X4
M8X50 <b>TV6</b> X4	SP1 <b>TV7</b> X8	SP2 <b>TV8</b> X4	SP3 <b>TV9</b> X4	Washer <b>TV10</b> X4

# MONTAGESTRITT

1

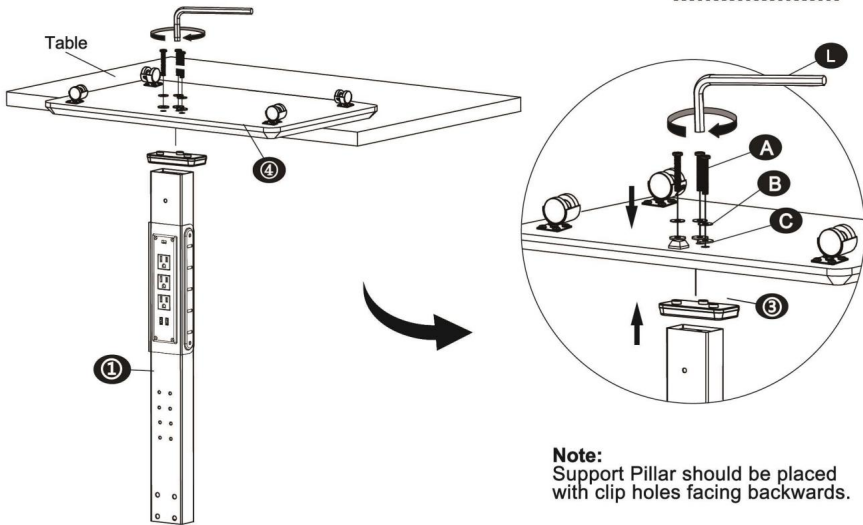
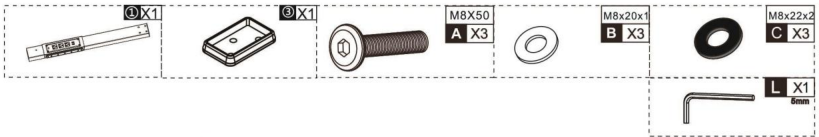
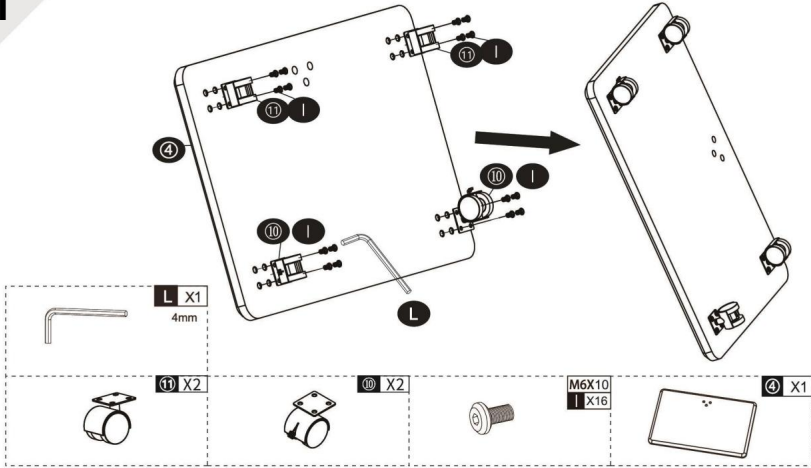

**Note:**  
Support Pillar should be placed with clip holes facing backwards.

# 2

**Note:**  
Support Pillar should be assembled with clip holes in the same side.

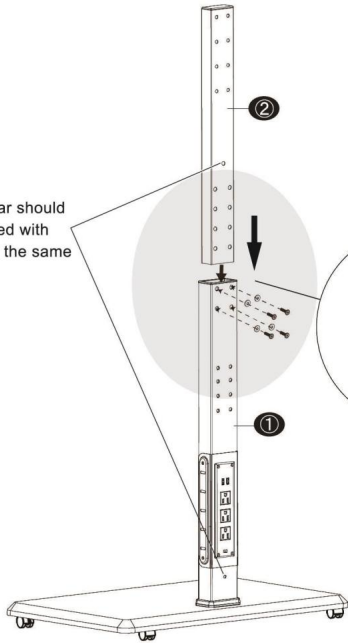

	<b>2</b> X1
	M6X16 <b>K</b> X4
	M6X16X1.5 <b>J</b> X4
	<b>L</b> X1 4mm

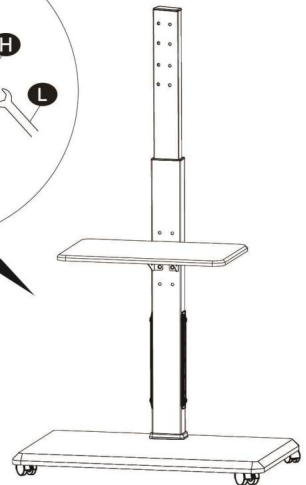
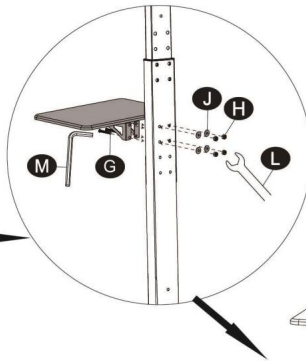
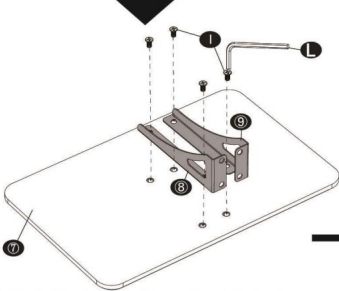

	<b>T</b> X1		<b>G</b> X1
	<b>H</b> X4		<b>G</b> X1
	<b>L</b> X1 4mm		M6X16X1.5 <b>J</b> X4
	M6X10 <b>I</b> X4		M6X50 <b>M</b> X4
	<b>L</b> X1		<b>L</b> X1

3

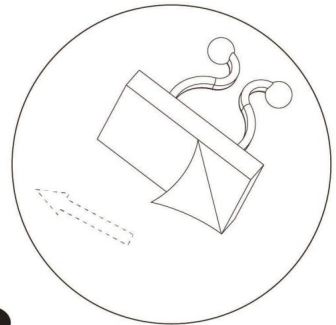
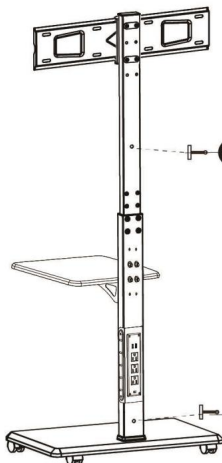
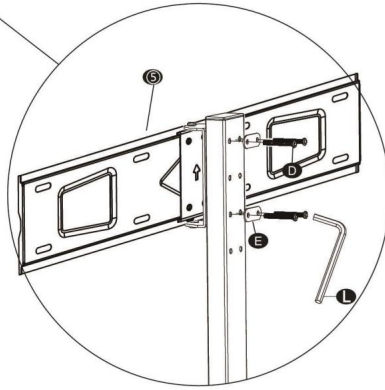
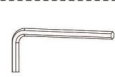
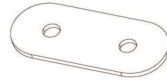
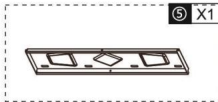

# 4

## Measure the TV fixing holes Width and Height

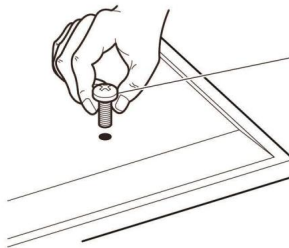
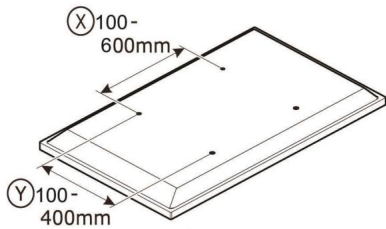

- TV1
- TV2-3
- TV4-6



If width  $\textcircled{X}$  is greater than 600mm or height  $\textcircled{Y}$  greater than 400mm STOP installation now and contact the customer help line

You are provided with 4 diameters of TV fixing screws, **M4**, **M5** and **M8**. Determine the screw diameter that fits.

Spacers

SP

For TVs with irregular/obstructed back

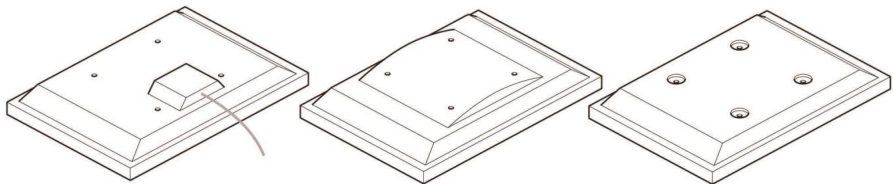

No Spacers

For TVs with flat/unobstructed back

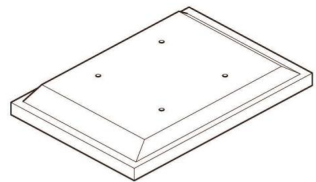

WARNING



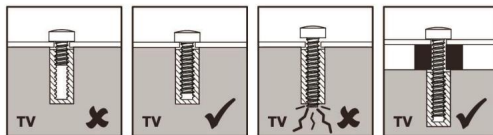



please keep for future reference.

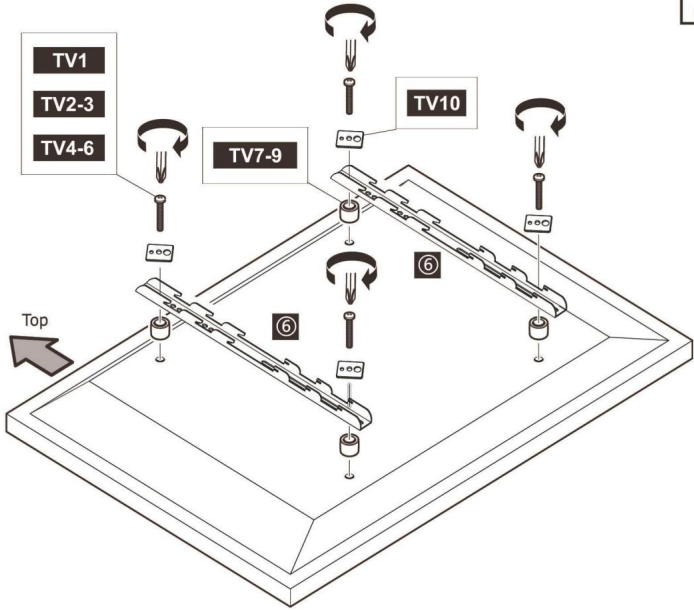
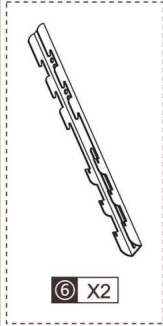



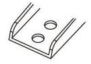









# 5

NOT INCLUDED



-  **M4**  
**TV1 X4**
- +
-  **Washer with 3 holes**  
**TV10 X4**
- +
- 
- +
-  **2.5mm**  
**TV7 X8**
-  **10mm**  
**TV8 X4**
-  **22mm**  
**TV9 X4**

-  **M6**  
**TV2-3 X4**
- +
-  **Washer with 3 holes**  
**TV10 X4**
- +
- 
- +
-  **2.5mm**  
**TV7 X8**
-  **10mm**  
**TV8 X4**
-  **22mm**  
**TV9 X4**

-  **M8**  
**TV4-6 X4**
- +
-  **Washer with 3 holes**  
**TV10 X4**
- +
- 
- +
-  **2.5mm**  
**TV7 X8**
-  **10mm**  
**TV8 X4**
-  **22mm**  
**TV9 X4**

Attach the bracket to the back of your TV using suitable screw, reducer and spacer combinations.

6

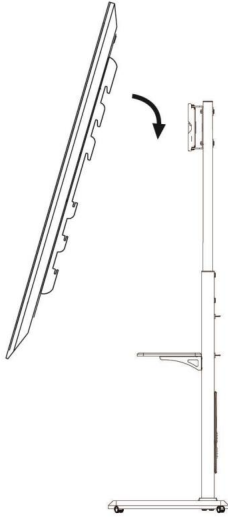

NOT INCLUDED



M X3

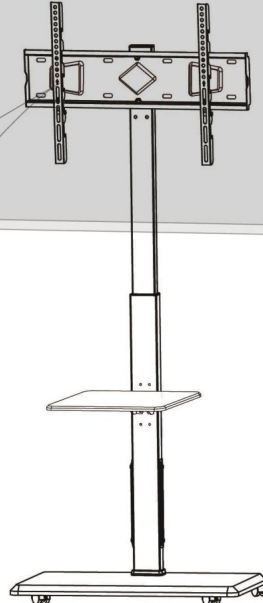
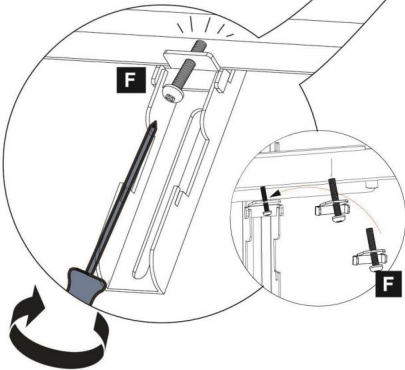
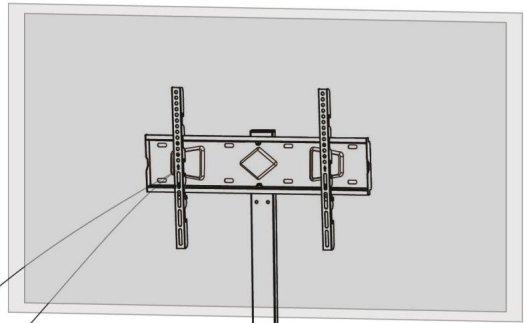
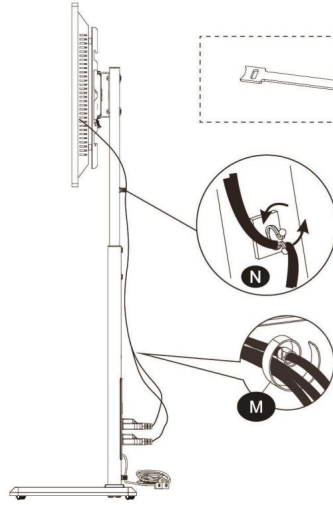

## PRODUKTPARAMETER

<b>Modell</b>	PCT01-2
<b>Leistung</b>	AC125 V, 60 Hz, 12 A (über Steckdosenleiste)
<b>Sicheres Ladegewicht</b>	88 Pfund
<b>Produktgröße</b>	660*380*(1365-1620)mm

**Hersteller:** Shanghaimuxinmuyeyouxiangongsi

**Adresse:** Shuangchenglu 803nong11hao1602A-1609shi, Baoshanqu, Shanghai 200000 CN.

**Nach AUS importiert:** SIHAO PTY LTD. 1 ROKEVA STREETEASTWOOD NSW 2122 Australien

**Importiert in die USA:** Sanven Technology Ltd. Suite 250, 9166 Anaheim Ort, Rancho Cucamonga, CA 91730



YH CONSULTING LIMITED. C/O YH Consulting  
Büro mit beschränkter Haftung 147, Centurion House, London  
Straße, Staines-upon-Thames, Surrey, TW18 4AX

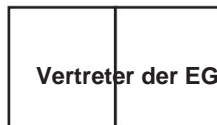

E-CrossStu GmbH  
Mainzer Landstr.69,  
60329 Frankfurt am Main.



**Technischer Support und E-Garantie-Zertifikat**  
[www.vevor.com/support](http://www.vevor.com/support)

# VEVOR

**Affordable. Reliable. Home Improvement.**

**SUPPORTO TV UNIVERSALE**

**MODELLO:PCT01-2**

Supporto tecnico e certificato di garanzia

elettronica [www.vevor.com/support](http://www.vevor.com/support)

# VEVOR

Affordable. Reliable. Home Improvement.

## SUPPORTO TV UNIVERSALE

MODELLO: PCT01-2



100x100 400x100  
200x100 400x200  
200x200 400x300  
300x200 400x400  
300x300 600x400



RATED LISTED WEIGHT. SERIOUS INJURY OR PROPERTY DAMAGE MAY OCCUR!

PCT01-2

Questa è l'istruzione originale, si prega di leggere attentamente tutte le istruzioni del manuale prima di utilizzare. VEVOR si riserva una chiara interpretazione del nostro manuale utente. L'aspetto del prodotto sarà soggetto al prodotto ricevuto. Vi preghiamo di perdonarci se non vi informeremo di nuovo se ci sono aggiornamenti tecnologici o software sul nostro prodotto.

## ISTRUZIONI DI SICUREZZA

### AVVERTIMENTO:

**Prima dell'installazione, assicurarsi che i fori di montaggio, le dimensioni e il peso del supporto TV siano conformi alle specifiche e agli standard di supporto TV. Se avete domande o dubbi sulle istruzioni e avvertenze, contattateci per assistenza.**



### **Importante:**

1. Durante l'installazione del supporto, utilizzare dispositivi di sicurezza professionali e utensili secondo le esigenze dell'assemblaggio istruzioni. Un'installazione non corretta può causare la caduta della TV o gravi infortunio.
2. Prima dell'installazione, assicurarsi che la superficie di supporto possa supportare in modo sicuro il peso del dispositivo e di tutti gli accessori.
3. Si prega di non superare la capacità di carico prevista, altrimenti potrebbe causare gravi lesioni o danni alla proprietà.
4. Questo prodotto contiene piccole parti, l'ingestione può causare rischi di soffocamento. Tenere fuori dalla portata dei bambini.
5. Questo prodotto è adatto solo per uso interno, l'uso esterno può causare danni al prodotto e rischio di lesioni personali.

### **Manutenzione:**

Si prega di controllare periodicamente la connessione tra la staffa e la TV per assicurarsi che rimanga stabile e verificare che le viti non si siano allentate o caduti a causa dell'uso prolungato (almeno una volta ogni tre mesi). Se presente vengono identificati i rischi per la sicurezza, sostituire o rinforzare tempestivamente le parti.

### **ATTENZIONE PER LA MULTISTRADA:**

### **RISCHIO DI SCOSSE ELETTRICHE E INCENDIO!**

La ciabatta non deve essere collegata alla presa di corrente prima dell'installazione. Fallimento il rispetto di queste istruzioni potrebbe causare guasti elettrici, incendi e

elettrocuzione.

**IMPORTANTE:** l'installazione di questa ciabatta e del relativo cablaggio deve essere eseguito da un elettricista qualificato in conformità a tutte le norme elettriche applicabili codici, -

Se il cavo di alimentazione è danneggiato, deve essere sostituito dal produttore, dal suo addetto all'assistenza o a persone con qualifica simile per evitare pericoli.

- Solo per uso interno.

- In nessun caso il coperchio potrebbe essere aperto. Se il coperchio è danneggiato, l'adattatore non può più essere utilizzato.

- Questo apparecchio può essere utilizzato da bambini di età pari o superiore a 8 anni e persone con ridotte capacità fisiche, sensoriali o mentali o prive di esperienza e conoscenza se hanno ricevuto supervisione o istruzioni riguardanti l'uso dell'apparecchio in modo sicuro e comprendere i pericoli connessi.

- I bambini non devono giocare con l'apparecchio.

- La pulizia e la manutenzione da parte dell'utente non devono essere eseguite da bambini senza supervisione.

**SALVA QUESTO MANUALE**

ELENCO DELLE PARTI

**PART LIST**

	① X1		③ X1	Plastic Washer Steel Washer		M6X50 G X4
	② X1		④ X1			H X4
	⑤ X1		⑥ X2		M6X10 I X20	
	⑦ X1		⑧ X2		M6X16X1.5 J X8	
	⑨ X1		⑩ X2		M6X16 K X4	
	⑪ X2		⑫ X2		M8X50 A X3	
	⑬ X2		⑭ X2		M8x20x1 B X3	
	⑮ X1		⑯ X2		M8x22x2 C X3	
	⑰ X1		⑱ X2		M6X45 D X4	
	⑲ X1		⑳ X2		E X2	
	㉑ X1		㉒ X2		F X2	
	㉓ X1		㉔ X2		L X1 4mm	
	㉕ X1		㉖ X2		L X1 5mm	
	㉗ X1		㉘ X2		L X1	
	㉙ X1		㉚ X2		M X3	
	㉛ X1		㉜ X2		N X2	

**FOR TV INSTALLATION**

M4X30 TV1 X4	M6X16 TV2 X4	M6X35 TV3 X4	M8X16 TV4 X4	M8X35 TV5 X4
M8X50 TV6 X4	SP1 TV7 X8	SP2 TV8 X4	SP3 TV9 X4	Washer TV10 X4



# 2

**Note:**  
Support Pillar should be assembled with clip holes in the same side.

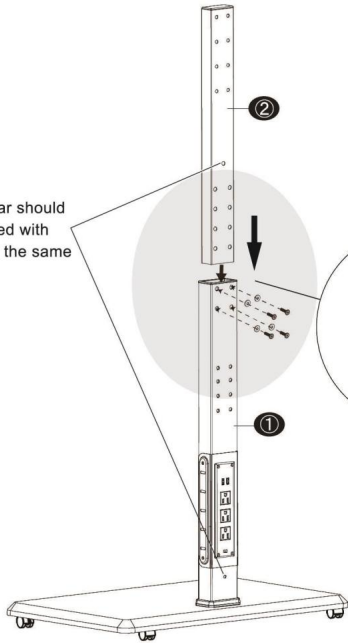

	<b>2</b> X1
	M6X16 <b>K</b> X4
	M6X16X1.5 <b>J</b> X4
	<b>L</b> X1 4mm

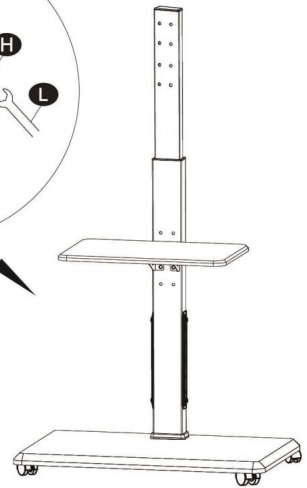
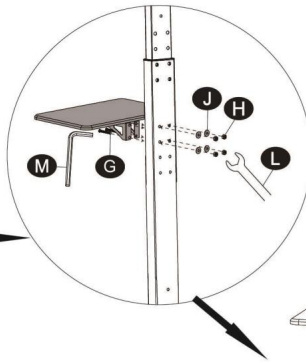
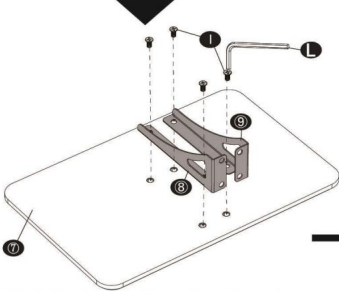

	<b>T</b> X1		<b>G</b> X1
	<b>H</b> X4		<b>G</b> X1
	<b>L</b> X1 4mm		M6X16X1.5 <b>J</b> X4
	M6X10 <b>I</b> X4		M6X50 <b>M</b> X4
	<b>L</b> X1		<b>L</b> X1

3

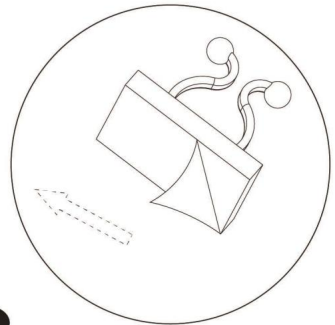
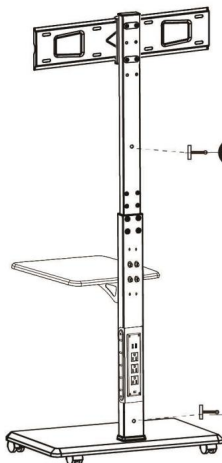
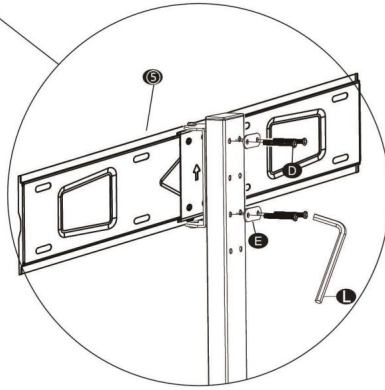
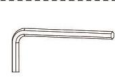
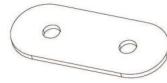
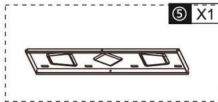

**N X2**

# 4

## Measure the TV fixing holes Width and Height

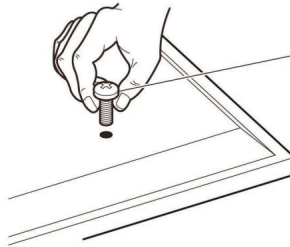
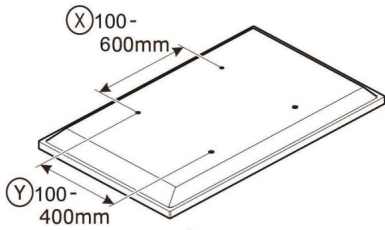

- TV1
- TV2-3
- TV4-6



If width  $\textcircled{X}$  is greater than 600mm or height  $\textcircled{Y}$  greater than 400mm STOP installation now and contact the customer help line

You are provided with 4 diameters of TV fixing screws, **M4**, **M5** and **M8**. Determine the screw diameter that fits.

Spacers

SP

For TVs with irregular/obstructed back

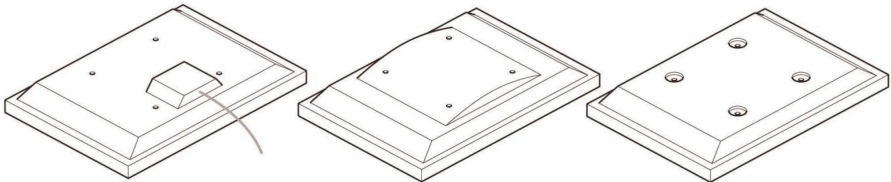

No Spacers

For TVs with flat/unobstructed back

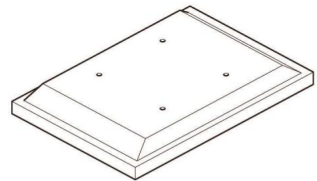

WARNING



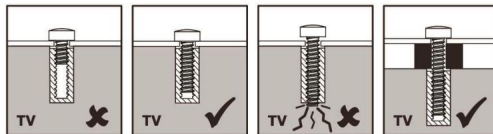





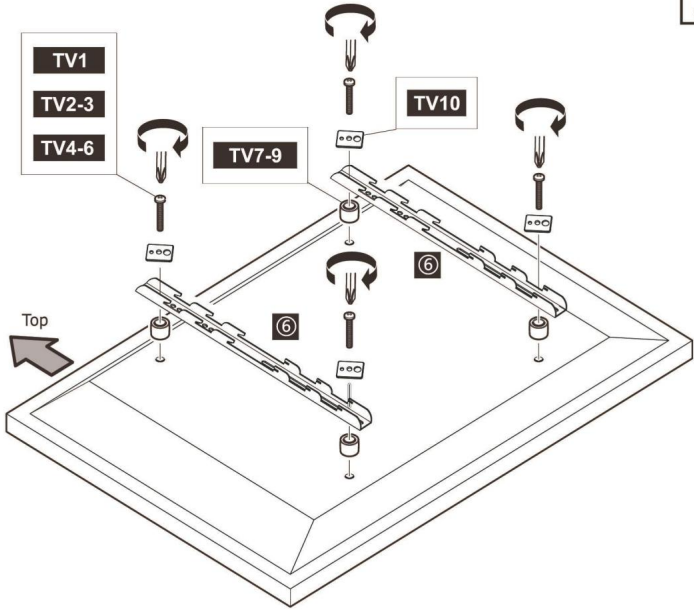
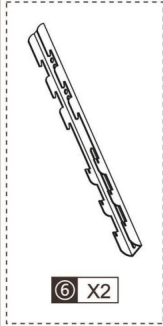





please keep for future reference.

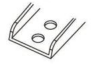
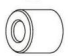

# 5

NOT INCLUDED



- |  |  |  |
|--|--|--|
| <br><b>M4</b><br><b>TV1 X4</b>  | <br><b>M6</b><br><b>TV2-3 X4</b>  | <br><b>M8</b><br><b>TV4-6 X4</b>  |
| +  | +  | +  |
| <br><b>Washer with 3 holes</b><br><b>TV10 X4</b>   | <br><b>Washer with 3 holes</b><br><b>TV10 X4</b>   | <br><b>Washer with 3 holes</b><br><b>TV10 X4</b>   |
| +  | +  | +  |
| <br><b>2.5mm</b><br><b>TV7 X8</b><br><br><b>10mm</b><br><b>TV8 X4</b><br><br><b>22mm</b><br><b>TV9 X4</b> | <br><b>2.5mm</b><br><b>TV7 X8</b><br><br><b>10mm</b><br><b>TV8 X4</b><br><br><b>22mm</b><br><b>TV9 X4</b> | <br><b>2.5mm</b><br><b>TV7 X8</b><br><br><b>10mm</b><br><b>TV8 X4</b><br><br><b>22mm</b><br><b>TV9 X4</b> |

Attach the bracket to the back of your TV using suitable screw, reducer and spacer combinations.

6

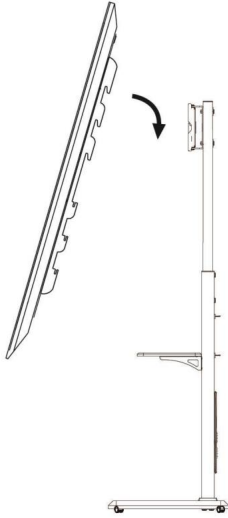

NOT INCLUDED



M X3

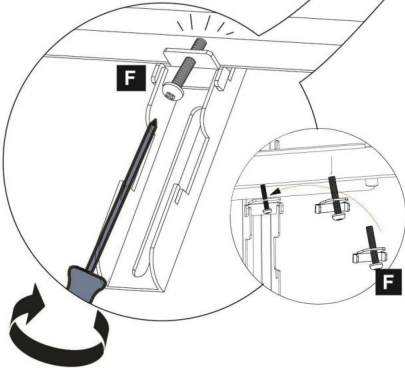
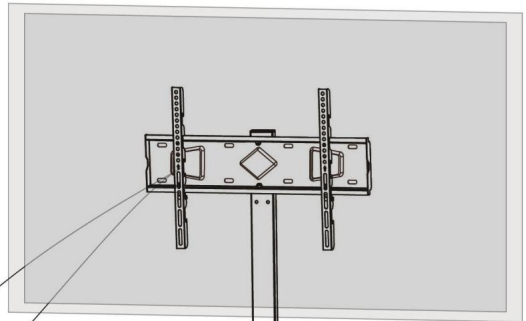
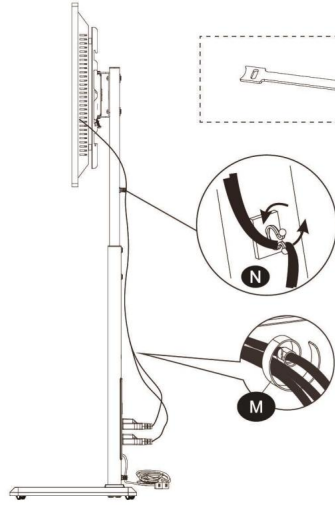

## PARAMETRO PRODOTTO

<b>Modello</b>	PCT01-2
<b>Energia</b>	AC125V 60Hz 12A (tramite multipresa)
<b>Peso di carico sicuro</b>	88 libbre
<b>Dimensioni del prodotto</b>	660*380*(1365-1620)mm

**Produttore:** Shanghaimuxinmuyeyouxiangongsi

**Indirizzo:** Shuangchenglu 803nong11hao1602A-1609shi, Baoshanqu, Shanghai 200000 CN.

**Importato in AUS:** SIHAO PTY LTD. 1 ROKEVA STREETEASTWOOD

Nuovo Galles del Sud 2122 Australia

**Importato negli USA:** Sanven Technology Ltd. Suite 250, 9166 Anaheim Luogo, Rancho Cucamonga, CA 91730



YH CONSULTING LIMITED. Per conto di YH Consulting  
Ufficio limitato 147, Centurion House, Londra  
Strada, Staines-upon-Thames, Surrey, TW18 4AX

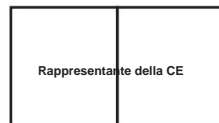

E-CrossStu GmbH  
Via Magonza 69,  
60329 Francoforte sul Meno.



**Supporto tecnico e certificato di garanzia elettronica**  
[www.vevor.com/support](http://www.vevor.com/support)

# VEVOR

**Affordable. Reliable. Home Improvement.**

SOPORTE UNIVERSAL PARA TV

MODELO:PCT01-2

Soporte técnico y certificado de garantía

electrónica [www.vevor.com/support](http://www.vevor.com/support)

# VEVOR

Affordable. Reliable. Home Improvement.

SOPORTE UNIVERSAL PARA TV

MODELO:PCT01-2



100x100 400x100  
200x100 400x200  
200x200 400x300  
300x200 400x400  
300x300 600x400



RATED LISTED WEIGHT. SERIOUS INJURY OR PROPERTY DAMAGE MAY OCCUR!

PCT01-2

Estas son las instrucciones originales, lea atentamente todas las instrucciones del manual antes de utilizar el producto. VEVOR se reserva una interpretación clara de nuestro manual de usuario. La apariencia del producto estará sujeta al producto que recibió. Perdónenos por no informarle nuevamente si hay actualizaciones de tecnología o software en nuestro producto.

## INSTRUCCIONES DE SEGURIDAD

### ADVERTENCIA:

Antes de la instalación, asegúrese de que los orificios de montaje, las dimensiones y el peso del soporte de su TV puedan cumplir con las especificaciones y estándares de el soporte del televisor. Si tienes alguna duda o pregunta sobre el instrucciones y advertencias, por favor contáctenos para obtener ayuda.



### Importante:

1. Al instalar el soporte, utilice dispositivos de seguridad profesionales. y herramientas de acuerdo con los requisitos del conjunto. instrucciones. Una instalación incorrecta puede provocar la caída del televisor o daños graves. lesión.
2. Antes de la instalación, asegúrese de que la superficie de apoyo pueda soportar el peso de forma segura. el peso del dispositivo y todos los accesorios.
3. No exceda la capacidad de carga prevista, de lo contrario podría causar lesiones graves o daños a la propiedad.
4. Este producto contiene piezas pequeñas, ingerirlas puede causar Peligro de asfixia. Mantener fuera del alcance de los niños.
5. Este producto solo es adecuado para uso en interiores, el uso en exteriores puede causar Riesgo de daños al producto y lesiones personales.

### Mantenimiento:

Por favor, compruebe periódicamente la conexión entre el soporte y el televisor. para asegurarse de que permanezca estable y verificar que los tornillos no se hayan aflojado o caído debido al uso prolongado (al menos una vez cada tres meses). Si alguno Se identifican los riesgos de seguridad, sustituir o reforzar las piezas rápidamente.

### ADVERTENCIA PARA LA REGLA DE ENCHUFE:

¡PELIGRO DE DESCARGA ELÉCTRICA E INCENDIO!

La regleta no debe conectarse a la corriente antes de la instalación.

No cumplir con esta instrucción podría provocar una falla eléctrica, un incendio y

electrocución.

**IMPORTANTE:** La instalación de esta regleta y el cableado relacionado debe realizarse

Realizado por un electricista calificado de acuerdo con todas las normas eléctricas aplicables.

códigos,

- Si el cable de alimentación está dañado, debe ser reemplazado por el fabricante, su agente de servicio o personas igualmente calificadas para evitar un peligro.

- Sólo para uso en interiores.

- Bajo ninguna circunstancia se podrá abrir la tapa. Si la tapa está

Si está dañado, el adaptador ya no podrá utilizarse.

- Este aparato puede ser utilizado por niños mayores de 8 años y

personas con capacidades físicas, sensoriales o mentales reducidas o con falta de

Experiencia y conocimientos si se les ha dado supervisión o

instrucciones sobre el uso del aparato de forma segura y comprender

los peligros que conlleva.

- Los niños no deben jugar con el aparato.

- La limpieza y el mantenimiento por parte del usuario no deberán ser realizados por niños sin supervisión.

**GUARDE ESTE MANUAL**

LISTA DE PIEZAS

**PART LIST**

	① X1		② X1		③ X1		④ X1		⑤ X1		⑥ X2		⑦ X1		⑧ X1		⑩ X2		⑪ X2		Plastic Washer		Steel Washer		M6X50 G X4		H X4		M6X10 I X20		M6X16X1.5 J X8		M6X16 K X4		M8X50 A X3		M8x20x1 B X3		M8x22x2 C X3		M6X45 D X4		L X1 4mm		L X1 5mm		L X1		M X3		F X2		N X2
--	------	--	------	--	------	--	------	--	------	--	------	--	------	--	------	--	------	--	------	--	----------------	--	--------------	--	---------------	--	------	--	----------------	--	-------------------	--	---------------	--	---------------	--	-----------------	--	-----------------	--	---------------	--	-------------	--	-------------	--	------	--	------	--	------	--	------

**FOR TV INSTALLATION**

	M4X30 TV1 X4		M6X16 TV2 X4		M6X35 TV3 X4		M8X16 TV4 X4		M8X35 TV5 X4
	M8X50 TV6 X4		SP1 TV7 X8		SP2 TV8 X4		SP3 TV9 X4		Washer TV10 X4

## PASO DE MONTAJE

1

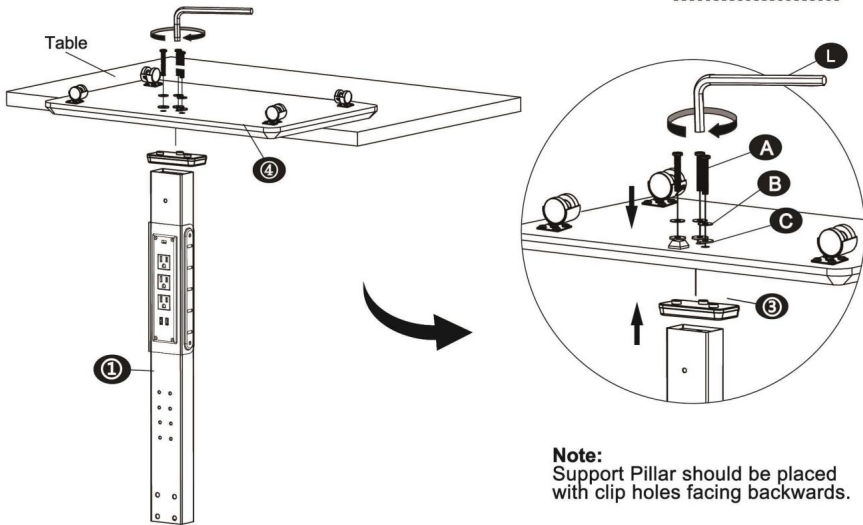
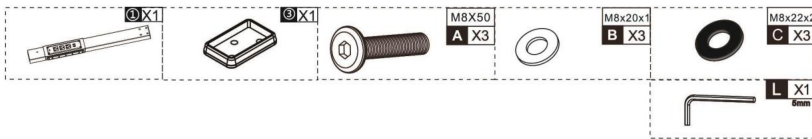
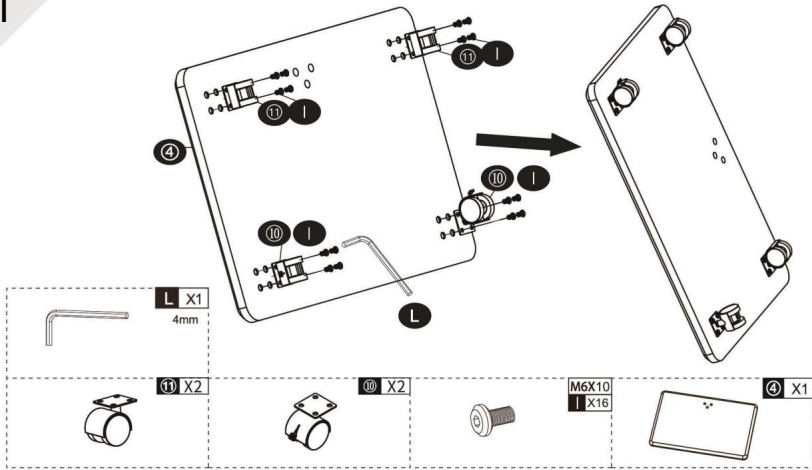

**Note:**  
Support Pillar should be placed  
with clip holes facing backwards.

2

**Note:**  
Support Pillar should be assembled with clip holes in the same side.

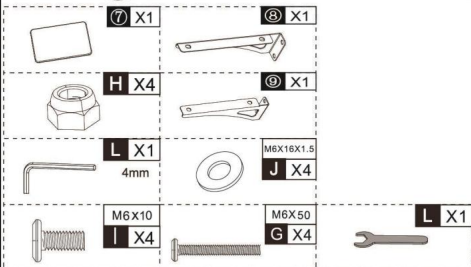
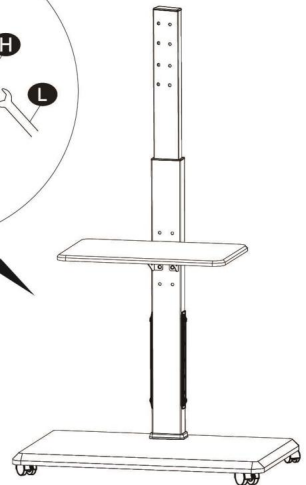
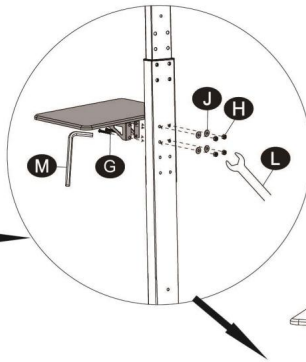
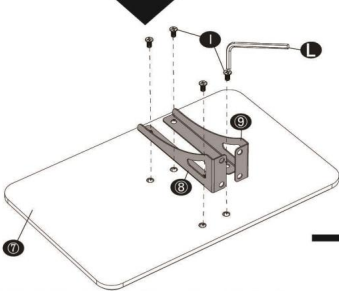
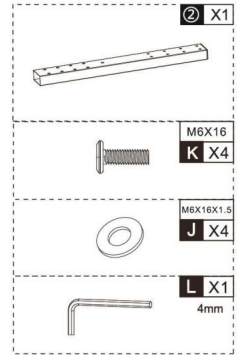
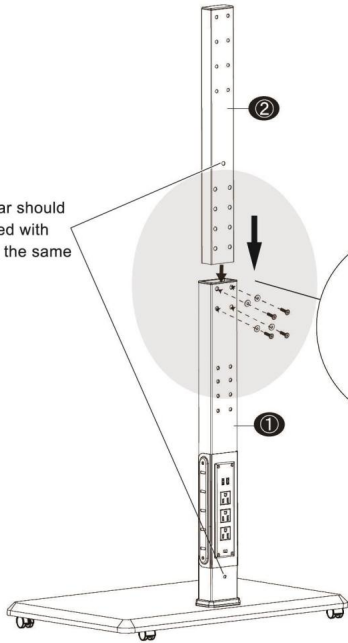

3

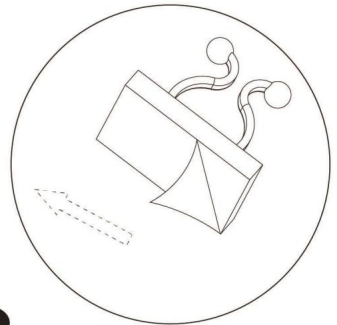
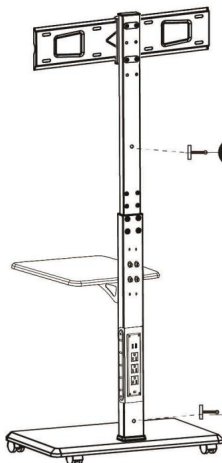
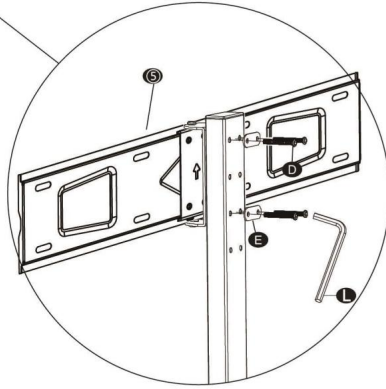
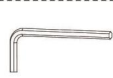
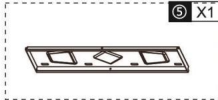

# 4

## Measure the TV fixing holes Width and Height

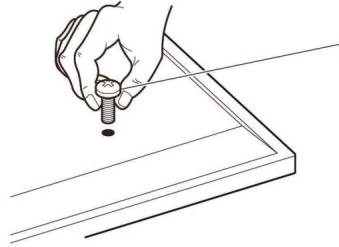
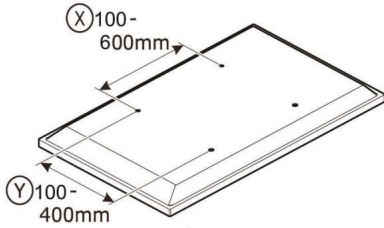

- TV1
- TV2-3
- TV4-6



If width  $\textcircled{X}$  is greater than 600mm or height  $\textcircled{Y}$  greater than 400mm STOP installation now and contact the customer help line

You are provided with 4 diameters of TV fixing screws, **M4**, **M5** and **M8**. Determine the screw diameter that fits.

Spacers

SP

For TVs with irregular/obstructed back

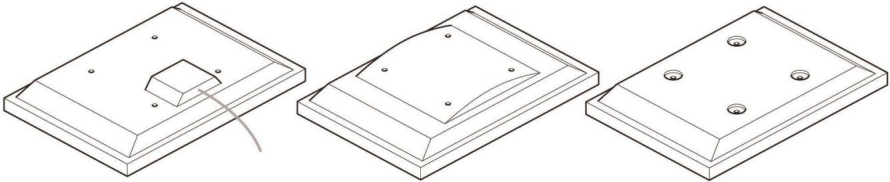

No Spacers

For TVs with flat/unobstructed back

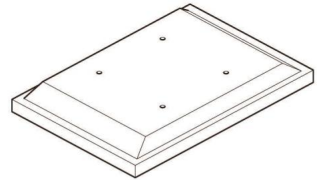

WARNING



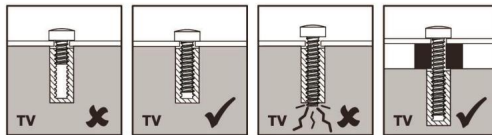



please keep for future reference.

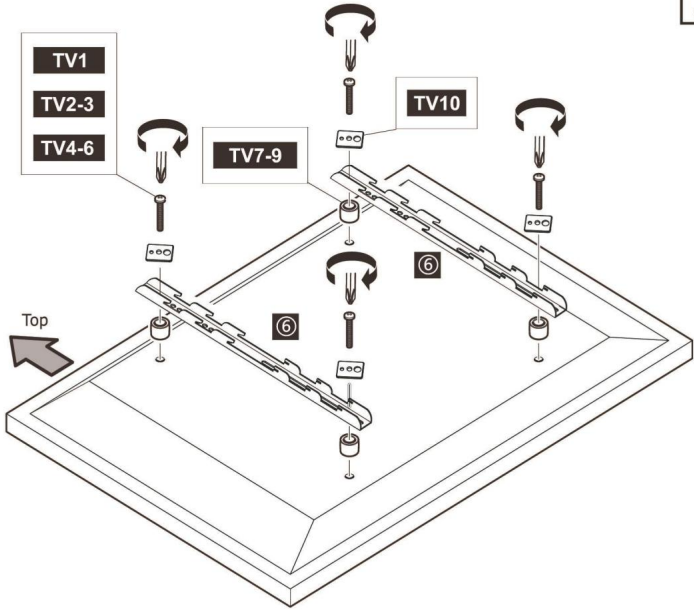
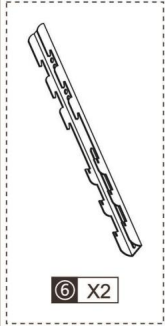



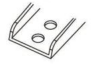









5

NOT INCLUDED



-  **M4**  
**TV1 X4**
- +
-  **Washer with 3 holes**  
**TV10 X4**
- +
- 
- +
-  **2.5mm**  
**TV7 X8**
-  **10mm**  
**TV8 X4**
-  **22mm**  
**TV9 X4**

-  **M6**  
**TV2-3 X4**
- +
-  **Washer with 3 holes**  
**TV10 X4**
- +
- 
- +
-  **2.5mm**  
**TV7 X8**
-  **10mm**  
**TV8 X4**
-  **22mm**  
**TV9 X4**

-  **M8**  
**TV4-6 X4**
- +
-  **Washer with 3 holes**  
**TV10 X4**
- +
- 
- +
-  **2.5mm**  
**TV7 X8**
-  **10mm**  
**TV8 X4**
-  **22mm**  
**TV9 X4**

Attach the bracket to the back of your TV using suitable screw, reducer and spacer combinations.

6

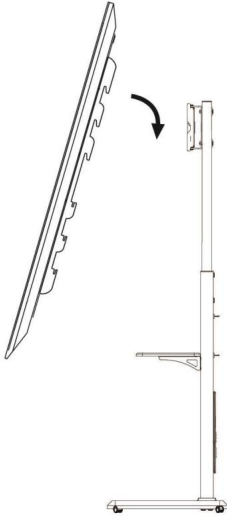

NOT INCLUDED 

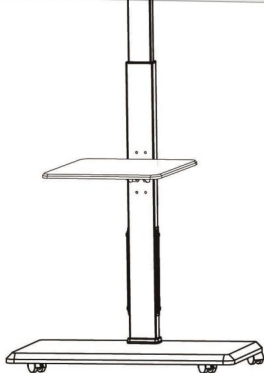
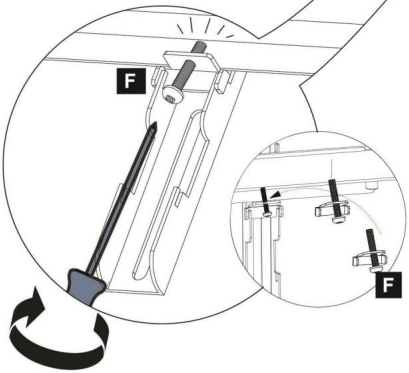
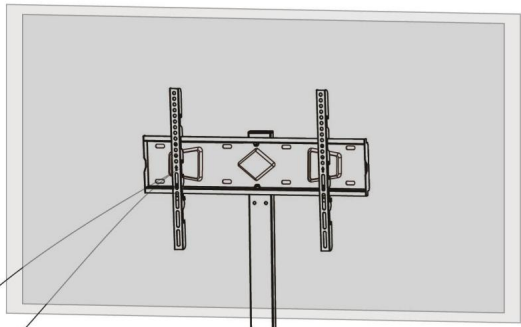
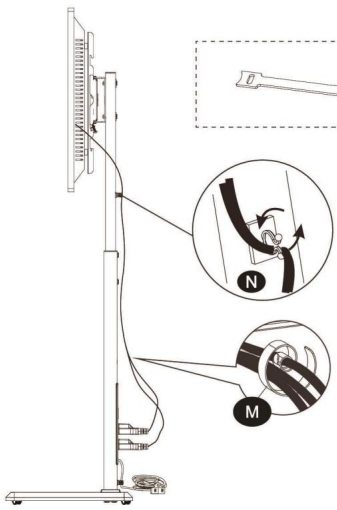
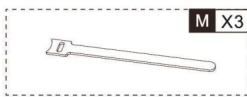

## PARÁMETRO DEL PRODUCTO

Modelo	PCT01-2
Fuerza	CA 125 V 60 Hz 12 A (mediante regleta de enchufes)
Peso de carga segura	88 LIBRAS
Tamaño del producto	660*380*(1365-1620)mm

**Fabricante:** Shanghaimuxinmuyeyouxiangongsi

**Dirección:** Shuangchenglu 803nong11hao1602A-1609shi, Baoshanqu, Shanghai 200000 CN.

**Importado a Australia:** SIHAO PTY LTD. 1 ROKEVA STREETEASTWOOD

Nueva Gales del Sur 2122 Australia

**Importado a EE. UU.:** Sanven Technology Ltd. Suite 250, 9166 Anaheim

Lugar, Rancho Cucamonga, CA 91730

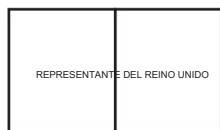

YH CONSULTING LIMITADA. A LA CARGO DE YH Consulting

Oficina limitada 147, Centurion House, Londres

Carretera, Staines-upon-Thames, Surrey, TW18 4AX

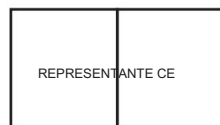

E-CrossStu GmbH

Calle Mainz Landstr.69,

60329 Fráncfort del Meno.



Soporte técnico y certificado de garantía electrónica

[www.vevor.com/support](http://www.vevor.com/support)

# VEVOR

**Affordable. Reliable. Home Improvement.**

UNIWERSALNY PODSTAWKA POD TV

MODEL:PCT01-2

Wsparcie techniczne i certyfikat gwarancji

elektronicznej [www.vevor.com/support](http://www.vevor.com/support)

# VEVOR

Affordable. Reliable. Home Improvement.

UNIWERSALNY PODSTAWKA POD TV

MODEL:PCT01-2



100x100	400x100
200x100	400x200
200x200	400x300
300x200	400x400
300x300	600x400



RATED LISTED WEIGHT. SERIOUS INJURY OR PROPERTY DAMAGE MAY OCCUR!

PCT01-2

To jest oryginalna instrukcja, przed użyciem należy uważnie przeczytać wszystkie instrukcje. VEVOR zastrzega sobie jasną interpretację naszej instrukcji obsługi. Wygląd produktu będzie zależał od produktu, który otrzymałeś. Prosimy o wybaczenie, że nie poinformujemy Cię ponownie, jeśli w naszym produkcie pojawią się jakiegokolwiek aktualizacje technologiczne lub oprogramowania.

## INSTRUKCJE BEZPIECZEŃSTWA

### OSTRZEŻENIE:

Przed montażem należy upewnić się, że otwory montażowe, wymiary i waga stojaka na telewizor spełniają wymagania i standardy.

stojak pod telewizor. Jeśli masz jakieś pytania lub wątpliwości dotyczące instrukcje i ostrzeżenia, prosimy o kontakt w celu uzyskania pomocy.



Ważny:

1. Podczas montażu podpórki należy stosować profesjonalne środki bezpieczeństwa i narzędzia zgodnie z wymaganiami montażu instrukcje. Nieprawidłowa instalacja może spowodować upadek telewizora lub poważne obrażenia.
2. Przed montażem należy upewnić się, że powierzchnia podparcia może bezpiecznie utrzymać wagę urządzenia i wszystkich akcesoriów.
3. Nie przekraczaj dopuszczalnego obciążenia, w przeciwnym razie może dojść do spowodować poważne obrażenia ciała lub uszkodzenie mienia.
4. Produkt zawiera małe części, których połknięcie może spowodować ryzyko zadławienia. Proszę trzymać poza zasięgiem dzieci.
5. Ten produkt nadaje się wyłącznie do użytku wewnątrz pomieszczeń, stosowanie na zewnątrz może powodować ryzyko uszkodzenia produktu i obrażeń ciała.

### Konserwacja:

Proszę okresowo sprawdzać połączenie między uchwytem a telewizorem.

aby upewnić się, że pozostanie stabilny, i sprawdź, czy śruby nie poluzowały się lub spadły z powodu długotrwałego użytkowania (przynajmniej raz na trzy miesiące). Jeśli jakieś zidentyfikowano zagrożenia bezpieczeństwa, niezwłocznie wymień lub wzmocnij części.

### OSTRZEŻENIE DOTYCZĄCE LISTWY ZASILAJĄCEJ:

#### RYZYKO PORAŻENIA PRĄDEM ELEKTRYCZNYM I POŻARU!

Listwa zasilająca nie powinna być podłączona do zasilania prąd do instalacji. Fallure nieprzestrzeżenie tej instrukcji może spowodować awarię elektryczną, pożar i

porażenie prądem.

**WAŻNE:** Montaż listwy zasilającej i związanego z nią okablowania musi być

wykonane przez wykwalifikowanego elektryka zgodnie ze wszystkimi obowiązującymi przepisami elektrycznymi kody, -

W przypadku uszkodzenia przewodu zasilającego należy go wymienić u producenta, agenta serwisowego lub podobnie wykwalifikowaną osobę w celu uniknięcia zagrożenia.

- Tylko do użytku wewnątrz pomieszczeń.

- W żadnym wypadku nie wolno otwierać pokrywy. Jeśli pokrywa jest

Jeśli adapter jest uszkodzony, nie nadaje się do dalszego użytku.

- Z urządzenia mogą korzystać dzieci w wieku od 8 lat i starsze.

osoby o ograniczonej sprawności fizycznej, sensorycznej lub umysłowej lub o braku

doświadczenie i wiedzę, jeżeli sprawowano nad nimi nadzór lub

instrukcję dotyczącą bezpiecznego korzystania z urządzenia i zrozumienia

związane z tym zagrożenia.

- Dzieci nie mogą bawić się urządzeniem.

- Dzieci nie mogą wykonywać czyszczenia i konserwacji bez nadzoru.

nadzór.

**ZAPISZ TĘ INSTRUKCJĘ**



## KROK MONTAŽU

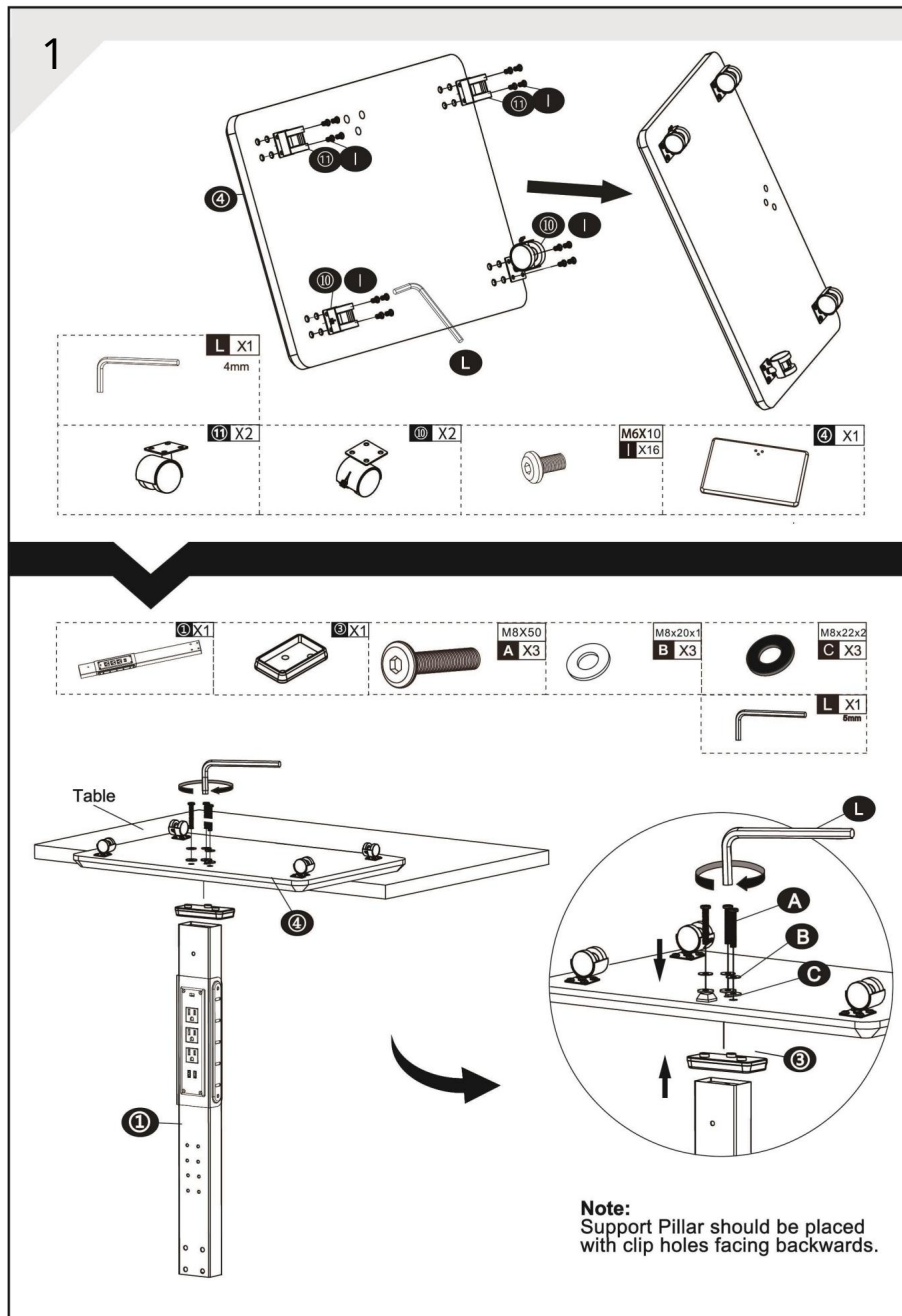

2

**Note:**  
Support Pillar should be assembled with clip holes in the same side.

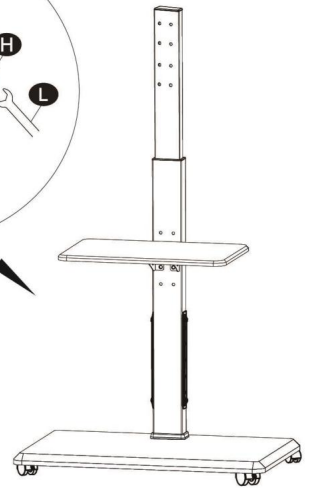
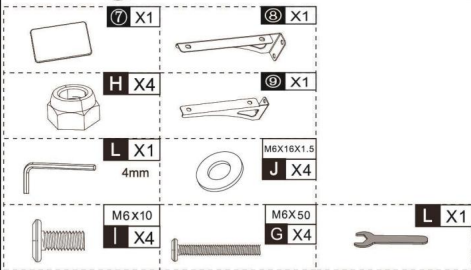
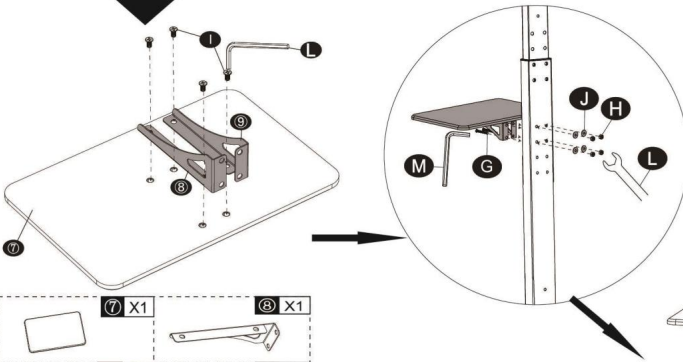
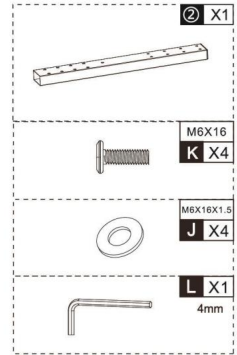
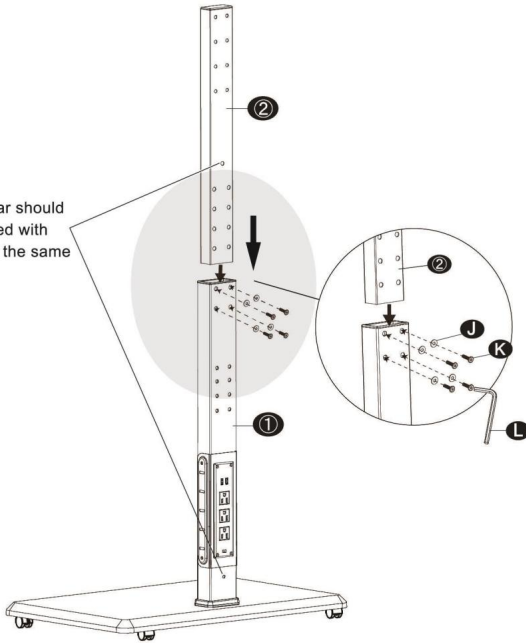

3

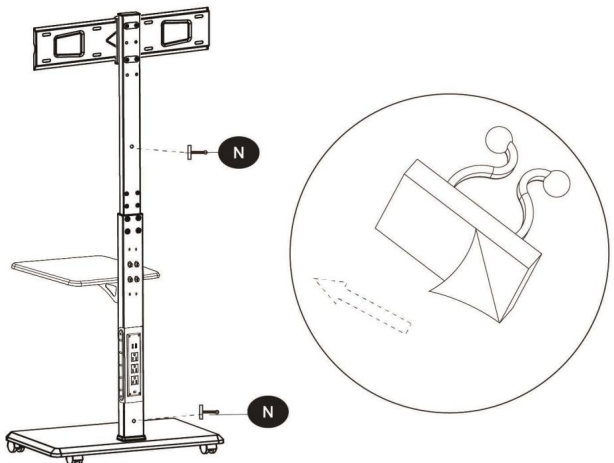
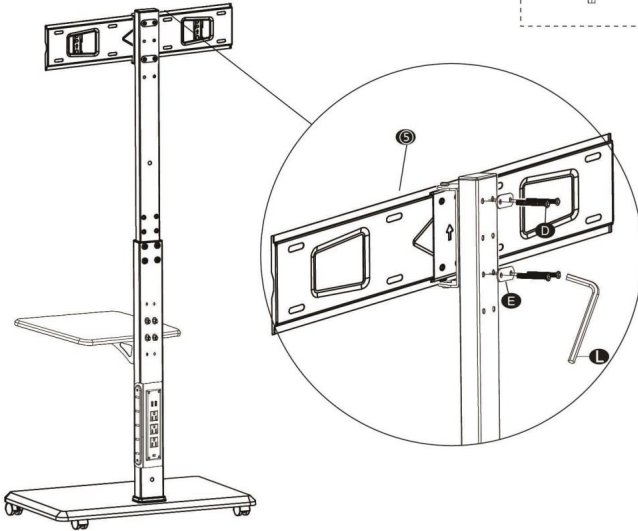
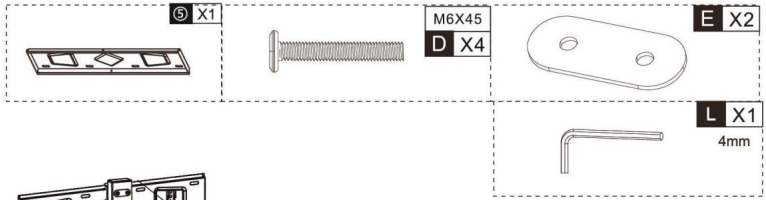

# 4

## Measure the TV fixing holes Width and Height

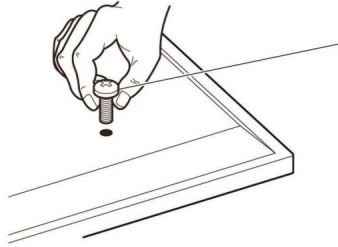
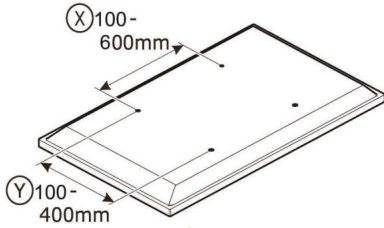

- TV1
- TV2-3
- TV4-6



If width  $\textcircled{X}$  is greater than 600mm or height  $\textcircled{Y}$  greater than 400mm STOP installation now and contact the customer help line

You are provided with 4 diameters of TV fixing screws, **M4**, **M5** and **M8**. Determine the screw diameter that fits.

Spacers

SP

For TVs with irregular/obstructed back

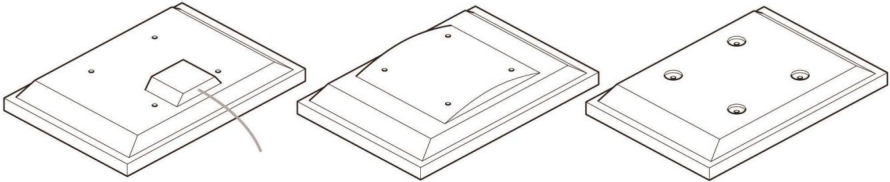

No Spacers

For TVs with flat/unobstructed back

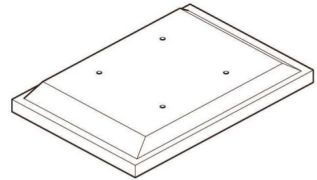

WARNING

please keep for future reference.

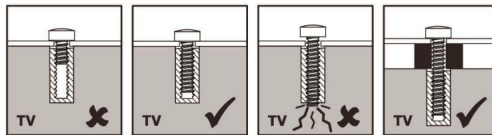

5

NOT INCLUDED

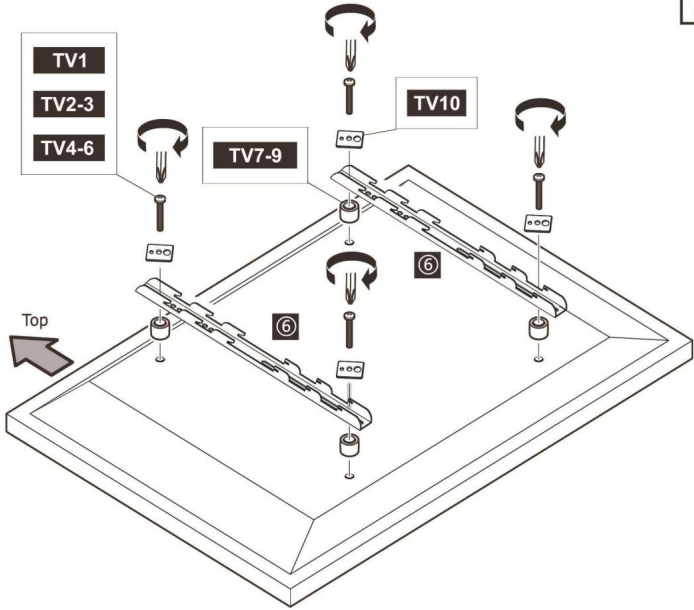
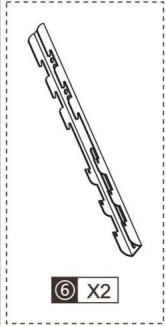

+



+

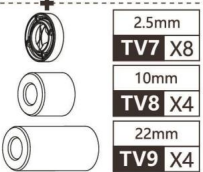

+



+

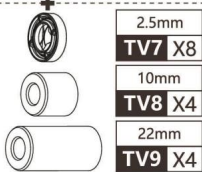

+



+

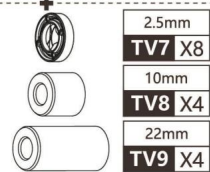

Attach the bracket to the back of your TV using suitable screw, reducer and spacer combinations.

6

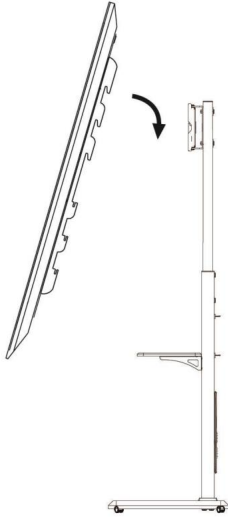

NOT INCLUDED 

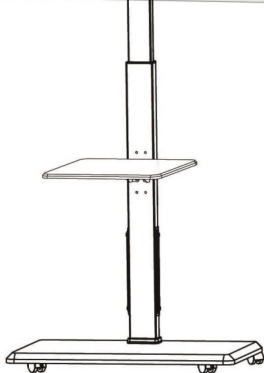
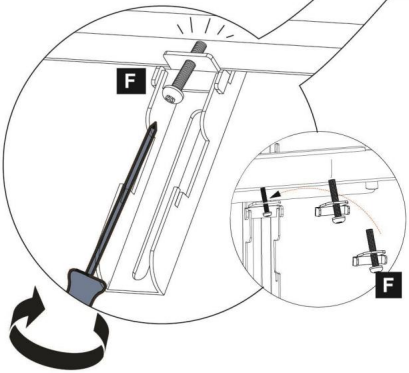
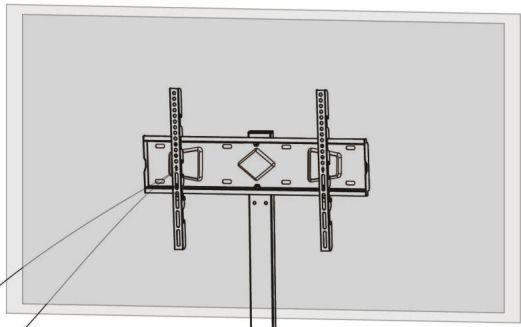
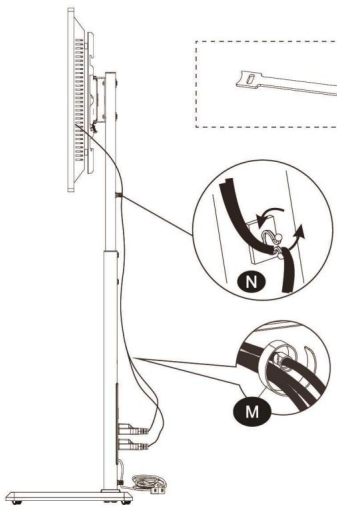
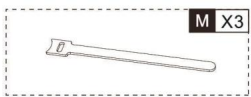

## PARAMETR PRODUKTU

Model	PCT01-2
Moc	AC125V 60Hz 12A (przez listwę zasilającą)
Bezpieczna waga załadunkowa	88 funtów
Rozmiar produktu	660*380*(1365-1620)mm

Producent: Shanghaimuxinmuyeyouxiangongsi

Adres: Shuangchenglu 803nong11hao1602A-1609shi, Baoshanqu, Szanghaj 200000 CN.

Importowane do AUS: SIHAO PTY LTD. 1 ROKEVA STREETEASTWOOD NSW 2122 Australia

Importowane do USA: Sanven Technology Ltd. Suite 250, 9166 Anaheim Miejsce, Rancho Cucamonga, CA 91730

REP WIELKIEJ BRYTANII
-----------------------

YH CONSULTING LIMITED. C/O YH Consulting  
Biuro Limited 147, Centurion House, Londyn  
Droga, Staines-upon-Thames, Surrey, TW18 4AX

Przedstawiciel UE
-------------------

E-CrossStu GmbH  
Mainzer Landstr.69,  
60329 Frankfurt nad Menem.



Wsparcie techniczne i certyfikat e-gwarancji  
[www.vevor.com/support](http://www.vevor.com/support)

# VEVOR

**Affordable. Reliable. Home Improvement.**

**UNIVERSELE TV-STANDAARD**

**MODEL:PCT01-2**

Technische ondersteuning en e-garantiecertificaat

[www.vevor.com/support](http://www.vevor.com/support)

# VEVOR

Affordable. Reliable. Home Improvement.

## UNIVERSELE TV-STANDAARD

MODEL:PCT01-2



100x100	400x100
200x100	400x200
200x200	400x300
300x200	400x400
300x300	600x400



RATED LISTED WEIGHT. SERIOUS INJURY OR PROPERTY DAMAGE MAY OCCUR!

PCT01-2

Dit is de originele instructie, lees alle handleidingen zorgvuldig door voordat u het product gebruikt. VEVOR behoudt zich een duidelijke interpretatie van onze gebruikershandleiding voor. Het uiterlijk van het product is afhankelijk van het product dat u hebt ontvangen. Vergeef ons dat we u niet opnieuw zullen informeren als er technologie- of software-updates voor ons product zijn.

## VEILIGHEIDSINSTRUCTIES

### WAARSCHUWING:

**Controleer vóór de installatie of de montagegaten, afmetingen en het gewicht van uw tv-standaard voldoen aan de specificaties en normen van de tv-standaard. Als u vragen of opmerkingen heeft over de instructies en waarschuwingen, neem dan contact met ons op voor hulp.**



### **Belangrijk:**

1. Gebruik bij het installeren van de ondersteuning professionele veiligheidsvoorzieningen en gereedschappen in overeenstemming met de eisen van de assemblage instructies. Onjuiste installatie kan ertoe leiden dat de tv valt of dat er ernstige schade ontstaat. blessure.
2. Controleer vóór de installatie of het steunoppervlak het apparaat veilig kan ondersteunen. het gewicht van het apparaat en alle accessoires.
3. Overschrijd de beoogde draagkracht niet, anders kan het ernstig letsel of materiële schade veroorzaken.
4. Dit product bevat kleine onderdelen. Als u deze inslikt, kan dit leiden tot: verstikkingsgevaar. Buiten bereik van kinderen houden.
5. Dit product is alleen geschikt voor gebruik binnenshuis, bij gebruik buitenshuis kan er schade ontstaan productschade en risico op persoonlijk letsel.

### **Onderhoud:**

Controleer regelmatig de verbinding tussen de beugel en de tv om ervoor te zorgen dat het stabiel blijft en controleer of de schroeven niet los zijn geraakt of afgevalen door langdurig gebruik (minimaal eens per drie maanden). Indien van toepassing Als er veiligheidsrisico's worden geïdentificeerd, moeten de onderdelen onmiddellijk worden vervangen of versterkt.

### WAARSCHUWING VOOR STROOMVERBINDINGSBLOK:

### **GEVAAR VOOR ELEKTRISCHE SCHOKKEN EN BRAND!**

De stekkerdoos mag niet worden aangesloten op het elektriciteitsnet vóór de installatie. het naleven van deze instructie kan leiden tot een elektrische storing, brand en

elektrocutie.

**BELANGRIJK:** De installatie van deze stekkerdoos en de bijbehorende bedrading moet uitgevoerd door een gekwalificeerde elektricien in overeenstemming met alle toepasselijke elektrische codes, -

Als het netsnoer beschadigd is, moet het door de fabrikant worden vervangen, serviceagent of personen met vergelijkbare kwalificaties om gevaar te voorkomen.

- Alleen voor gebruik binnenshuis.

- Onder geen beding mag de afdekking worden geopend. Als de afdekking

Indien beschadigd, mag de adapter niet meer gebruikt worden.

- Dit apparaat kan worden gebruikt door kinderen van 8 jaar en ouder en

personen met verminderde fysieke, sensorische of mentale vermogens of een gebrek aan ervaring en kennis als zij toezicht hebben gekregen of

instructies over het veilig gebruiken van het apparaat en het begrijpen

de gevaren die ermee gepaard gaan.

- Kinderen mogen niet met het apparaat spelen.

- Reiniging en gebruikersonderhoud mogen niet door kinderen worden uitgevoerd zonder toezicht. overzicht.

**BEWAAR DEZE HANDLEIDING**

ONDERDELENLIJST

PART LIST

	① X1		③ X1	Plastic Washer Steel Washer		M6X50 G X4
	② X1		④ X1			H X4
	③ X1		⑤ X1		M6X10 I X20	
	④ X1		⑥ X2		M6X16X1.5 J X8	
	⑤ X1		⑦ X1		M6X16 K X4	
	⑥ X2		⑧ X2		M8X50 A X3	
	⑦ X1		⑨ X2		M8x20x1 B X3	
	⑧ X2		⑩ X2		M8x22x2 C X3	
	⑨ X2		⑪ X2		M6X45 D X4	
	⑩ X2		⑫ X2		E X2	
	⑪ X2		⑬ X2		L X1 4mm	
	⑫ X2		⑭ X2		L X1 5mm	
	⑬ X2		⑮ X2		M X3	
	⑭ X2		⑯ X2		N X2	

FOR TV INSTALLATION

M4X30 TV1 X4	M6X16 TV2 X4	M6X35 TV3 X4	M8X16 TV4 X4	M8X35 TV5 X4
M8X50 TV6 X4	SP1 TV7 X8	SP2 TV8 X4	SP3 TV9 X4	Washer TV10 X4

# MONTAGESTAP

1

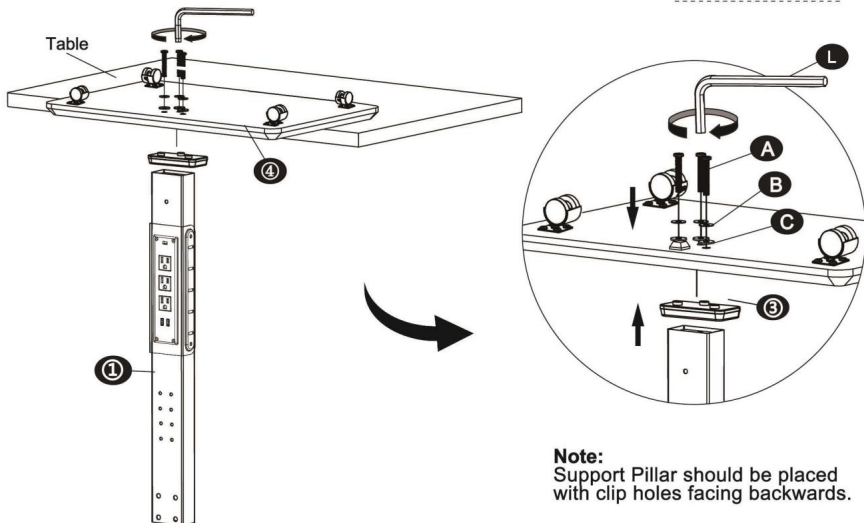
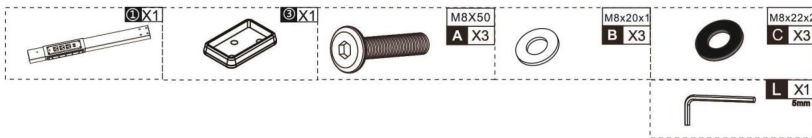
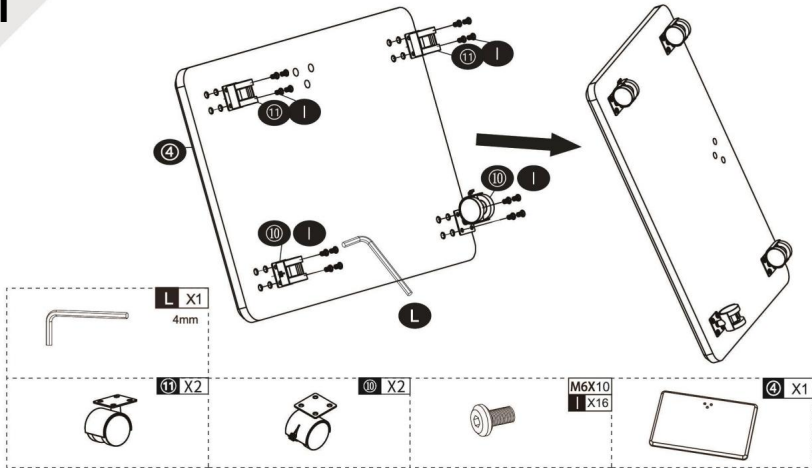

# 2

**Note:**  
Support Pillar should be assembled with clip holes in the same side.

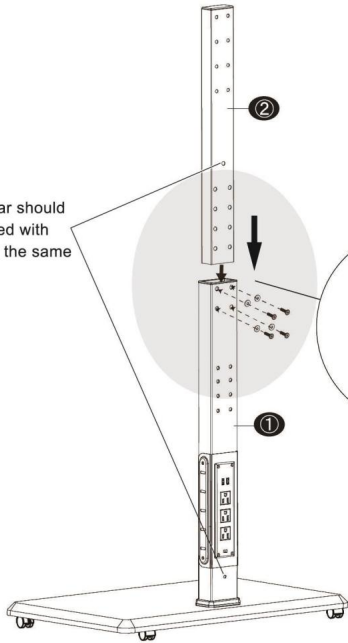

	<b>2</b> X1
	M6X16 <b>K</b> X4
	M6X16X1.5 <b>J</b> X4
	<b>L</b> X1 4mm

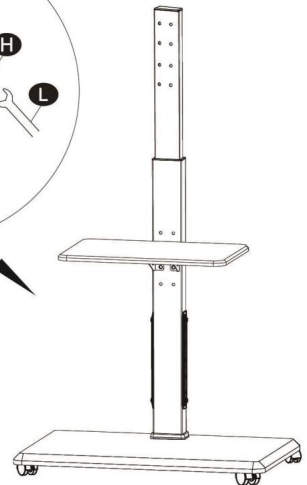
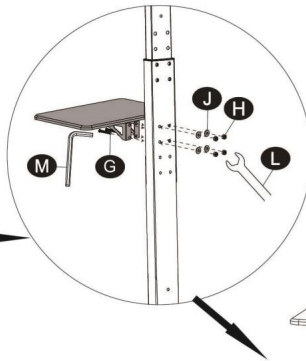
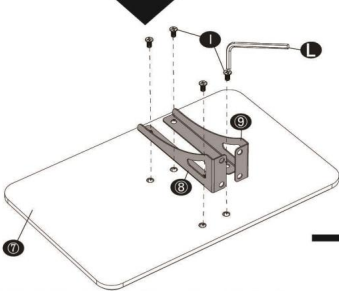

	<b>I</b> X1		<b>G</b> X1
	<b>H</b> X4		<b>G</b> X1
	<b>L</b> X1 4mm		M6X16X1.5 <b>J</b> X4
	M6X10 <b>I</b> X4		M6X50 <b>G</b> X4
			<b>L</b> X1

3

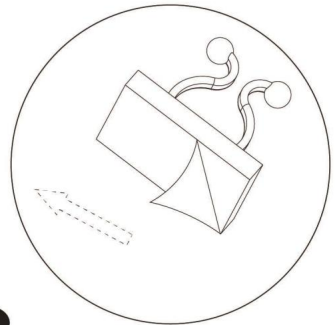
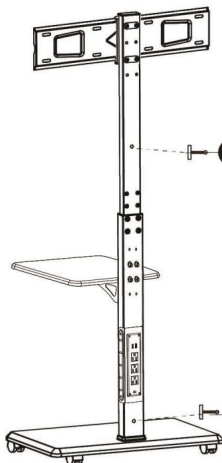
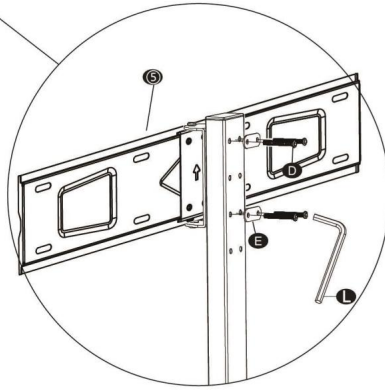
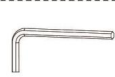
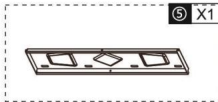

**N X2**

# 4

## Measure the TV fixing holes Width and Height

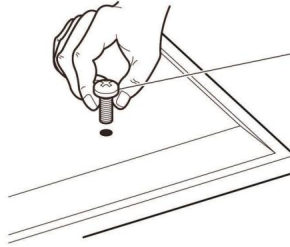
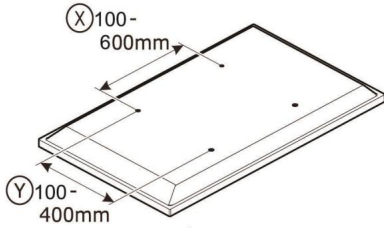

- TV1
- TV2-3
- TV4-6



If width  $\textcircled{X}$  is greater than 600mm or height  $\textcircled{Y}$  greater than 400mm STOP installation now and contact the customer help line

You are provided with 4 diameters of TV fixing screws, **M4**, **M5** and **M8**. Determine the screw diameter that fits.

Spacers

SP

For TVs with irregular/obstructed back

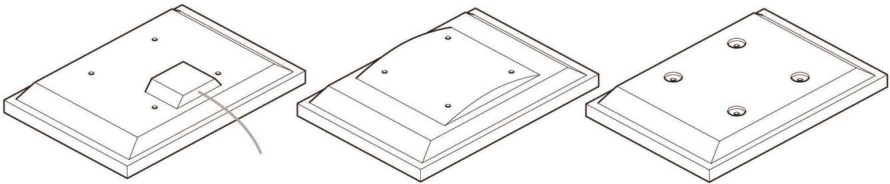

No Spacers

For TVs with flat/unobstructed back

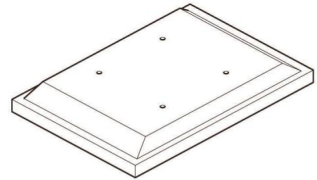

WARNING



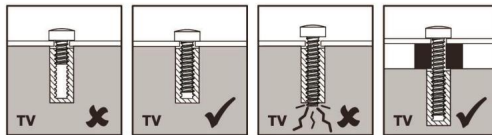



please keep for future reference.

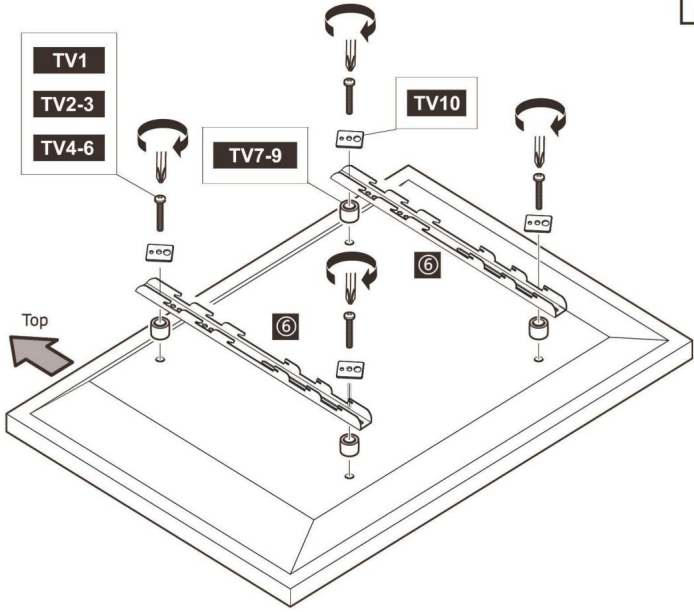
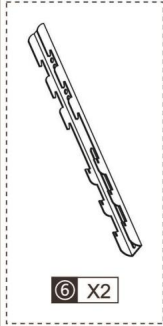



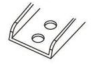









# 5

**NOT INCLUDED** 



-  **M4**  
**TV1 X4**
- +
-  **Washer with 3 holes**  
**TV10 X4**
- +
- 
- +
-  **2.5mm**  
**TV7 X8**
-  **10mm**  
**TV8 X4**
-  **22mm**  
**TV9 X4**

-  **M6**  
**TV2-3 X4**
- +
-  **Washer with 3 holes**  
**TV10 X4**
- +
- 
- +
-  **2.5mm**  
**TV7 X8**
-  **10mm**  
**TV8 X4**
-  **22mm**  
**TV9 X4**

-  **M8**  
**TV4-6 X4**
- +
-  **Washer with 3 holes**  
**TV10 X4**
- +
- 
- +
-  **2.5mm**  
**TV7 X8**
-  **10mm**  
**TV8 X4**
-  **22mm**  
**TV9 X4**

Attach the bracket to the back of your TV using suitable screw, reducer and spacer combinations.

6

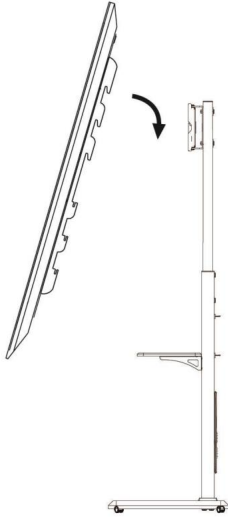

NOT INCLUDED



M X3

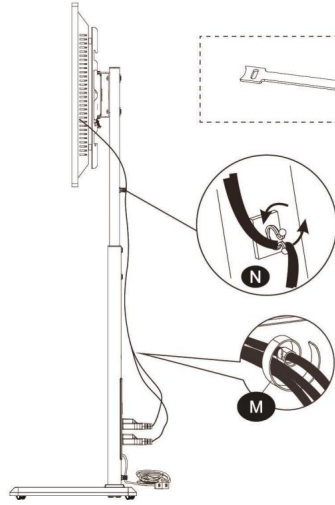

F X2

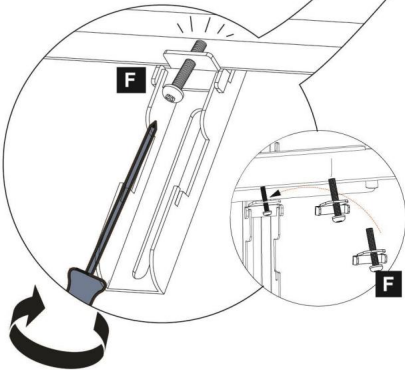
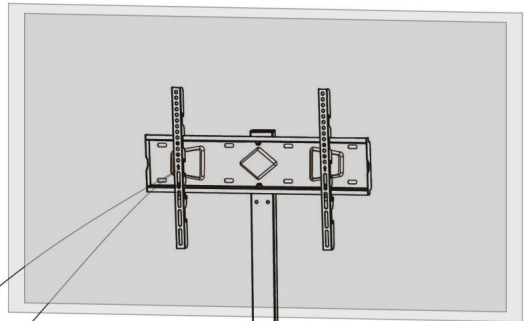

## PRODUCTPARAMETER

<b>Model</b>	PCT01-2
<b>Stroom</b>	AC125V 60Hz 12A (via stekkerdoos)
<b>Veilig laadgewicht</b>	88 pond
<b>Productgrootte</b>	660*380*(1365-1620)mm

**Fabrikant:** Shanghaimuxinmuyeyouxiangongsi

**Adres:** Shuangchenglu 803nong11hao1602A-1609shi, Baoshanqu, Shanghai 200000 CN.

**Geïmporteerd naar AUS:** SIHAO PTY LTD. 1 ROKEVA STREETEASTWOOD NSW 2122 Australië

**Geïmporteerd naar de VS:** Sanven Technology Ltd. Suite 250, 9166 Anaheim Plaats, Rancho Cucamonga, CA 91730



YH CONSULTING LIMITED. C/O YH Consulting  
Beperkt kantoor 147, Centurion House, Londen  
Weg, Staines-upon-Thames, Surrey, TW18 4AX



E-CrossStu GmbH  
Mainzer Landstr.69,  
60329 Frankfurt am Main.



**Technische ondersteuning en e-garantiecertificaat**  
[www.vevor.com/support](http://www.vevor.com/support)

# VEVOR

**Affordable. Reliable. Home Improvement.**

**UNIVERSELL TV-STÄLL**

**MODELL: PCT01-2**

Teknisk support och e-garanticertifikat

[www.vevor.com/support](http://www.vevor.com/support)

# VEVOR

Affordable. Reliable. Home Improvement.

## UNIVERSELL TV-STÄLL

MODELL: PCT01-2



100x100	400x100
200x100	400x200
200x200	400x300
300x200	400x400
300x300	600x400



RATED LISTED WEIGHT. SERIOUS INJURY OR PROPERTY DAMAGE MAY OCCUR!

PCT01-2

Detta är den ursprungliga instruktionen, läs alla instruktioner noggrant innan du använder den. VEVOR reserverar sig för en tydlig tolkning av vår användarmanual. Utseendet på produkten är beroende av den produkt du fått. Ursäkta oss att vi inte kommer att informera dig igen om det finns någon teknik eller mjukvaruuppdateringar på vår produkt.

## SÄKERHETSINSTRUKTIONER

### **VARNING:**

**Innan installationen, se till att monteringshålen, dimensionerna och vikten på ditt TV-ställ uppfyller specifikationerna och standarderna för tv-bänken. Om du har några frågor eller frågor om instruktioner och varningar, kontakta oss för hjälp..**



### **Viktig:**

1. Använd professionella säkerhetsanordningar när du installerar stödet och verktyg i enlighet med monteringskraven och instruktionerna. Felaktig installation kan göra att TV:n faller eller blir allvarligt skadad.
2. Före installation, se till att stödytan kan stödja säkerheten för enhetens vikt och alla tillbehör.
3. Vänligen överskrid inte den avsedda lastkapaciteten, annars kan det orsaka allvarlig personskada eller skada på egendom.
4. Denna produkt innehåller små delar, sväljning av dem kan orsaka kvävningsskada. Vänligen förvara utom räckhåll för barn.
5. Denna produkt är endast lämplig för inomhusbruk, utomhusbruk kan orsaka produktskador och risk för personskador.

### **Underhåll:**

Kontrollera med jämna mellanrum anslutningen mellan fästet och TV:n för att säkerställa att den förblir stabil och kontrollera att skruvarna inte har lossnat eller fallit av på grund av långvarig användning (minst en gång var tredje månad). Om någon säkerhetsrisk identifieras, byt ut eller förstärk delarna omgående.

### **VARNING FÖR GREDSLIPS:**

### **RISK FÖR ELEKTRISK STÖT OCH BRAND!**

Förgreningsdosan ska inte anslutas till strömförsörjningen till installationen. Fall att följa denna instruktion kan resultera i ett elektriskt fel, brand och

elstötning.

**VIKTIGT:** Installation av denna grenuttag och tillhörande ledningar måste vara utförd av behörig elektriker i enlighet med all tillämplig el

koder, -

Om nätsladden är skadad måste den bytas ut av tillverkaren, dess serviceombud eller liknande kvalificerade personer för att undvika fara.

- Endast för inomhusbruk.

- Under inga omständigheter kunde locket öppnas. Om locket är skadad får adaptern inte längre användas.

- Den här apparaten kan användas av barn från 8 år och uppåt personer med nedsatt fysisk, sensorisk eller mental förmåga eller brist på erfarenhet och kunskap om de har fått handledning eller instruktioner angående användning av apparaten på ett säkert sätt och förstå de inblandade farorna.

- Barn får inte leka med apparaten.

- Rengöring och användarunderhåll får inte utföras av barn utan tillsyn.

**SPARA DENNA MANUAL**

# DELLISTA

## PART LIST

	① X1		③ X1	Plastic Washer Steel Washer		M6X50 G X4
	② X1		④ X1			H X4
	③ X1		⑤ X2		M6X10 I X20	
	④ X1		⑥ X2		M6X16X1.5 J X8	
	⑤ X1		⑦ X1		M6X16 K X4	
	⑥ X2		M8X50 A X3		L X1 4mm	
	⑦ X1		M8x20x1 B X3		L X1 5mm	
	⑧ X2		M8x22x2 C X3		L X1	
	⑨ X2		M6X45 D X4		M X3	
	⑩ X2		E X2		N X2	
	⑪ X2		F X2			

## FOR TV INSTALLATION

	M4X30 TV1 X4		M6X16 TV2 X4		M6X35 TV3 X4		M8X16 TV4 X4		M8X35 TV5 X4
	M8X50 TV6 X4		SP1 TV7 X8		SP2 TV8 X4		SP3 TV9 X4		Washer TV10 X4

# MONTERINGSTEG

1

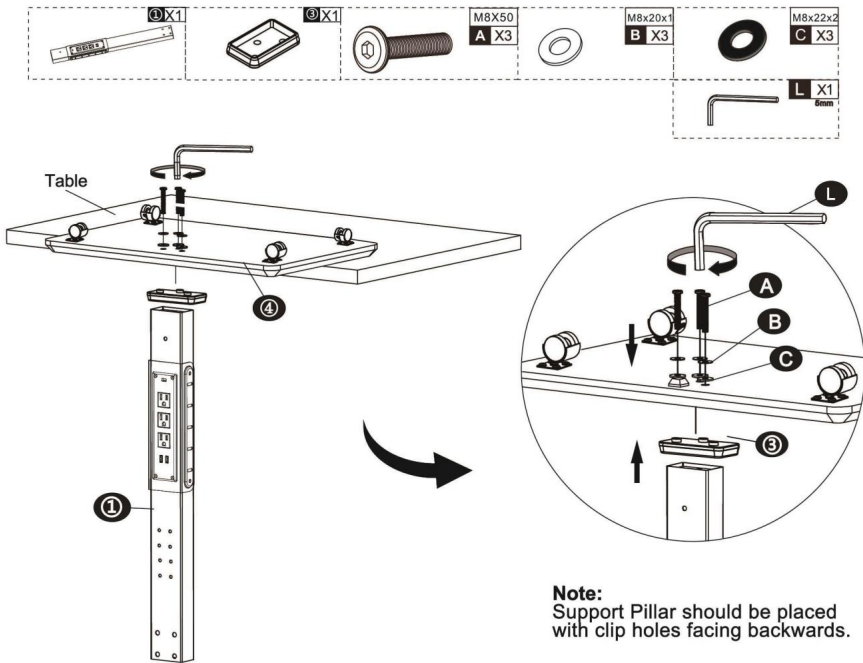
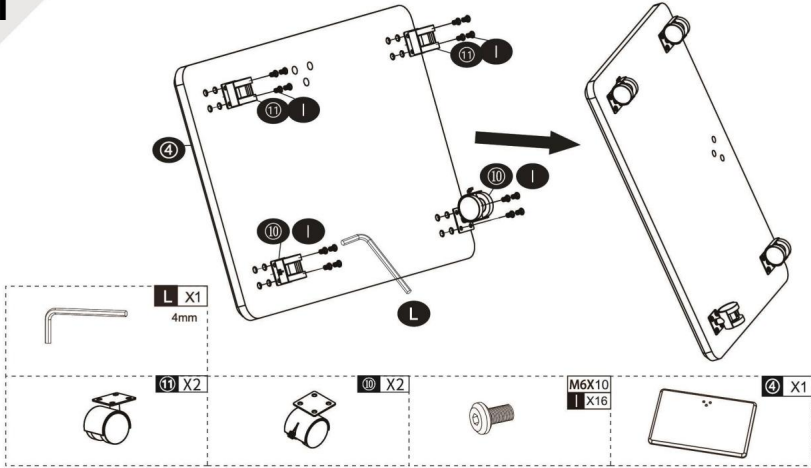

# 2

**Note:**  
Support Pillar should be assembled with clip holes in the same side.

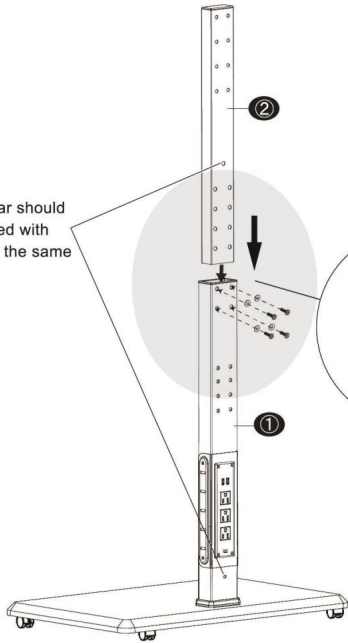

	<b>2</b> X1
	M6X16 <b>K</b> X4
	M6X16X1.5 <b>J</b> X4
	<b>L</b> X1 4mm

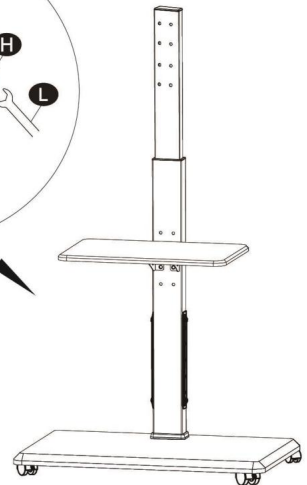
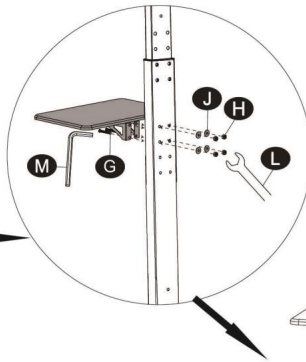
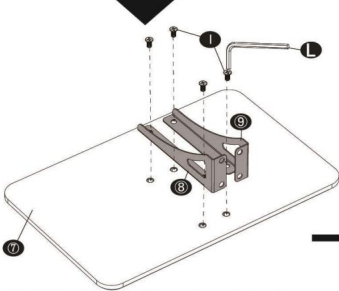

	<b>7</b> X1		<b>8</b> X1
	<b>H</b> X4		<b>9</b> X1
	<b>L</b> X1 4mm		M6X16X1.5 <b>J</b> X4
	M6X10 <b>I</b> X4		M6X50 <b>G</b> X4
			<b>L</b> X1

3

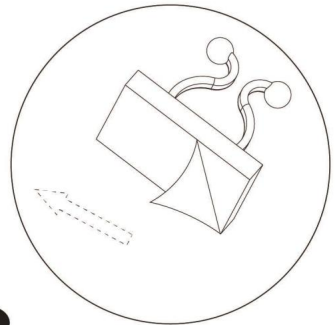
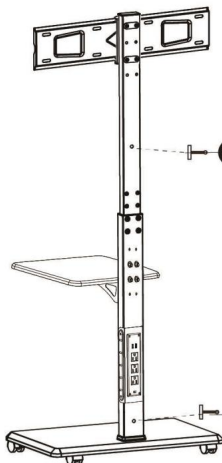
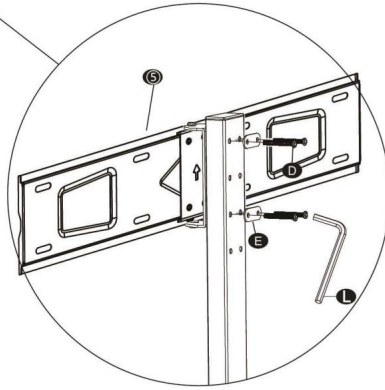
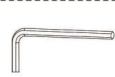
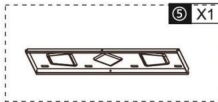

**N X2**

# 4

## Measure the TV fixing holes Width and Height

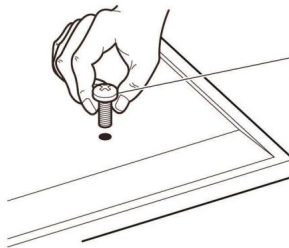
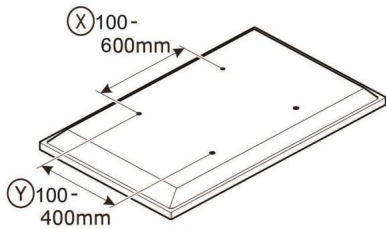

- TV1
- TV2-3
- TV4-6



If width  $\textcircled{X}$  is greater than 600mm or height  $\textcircled{Y}$  greater than 400mm STOP installation now and contact the customer help line

You are provided with 4 diameters of TV fixing screws, **M4**, **M5** and **M8**. Determine the screw diameter that fits.

Spacers

SP

For TVs with irregular/obstructed back

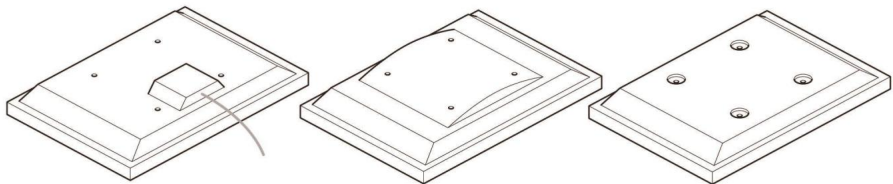

No Spacers

For TVs with flat/unobstructed back

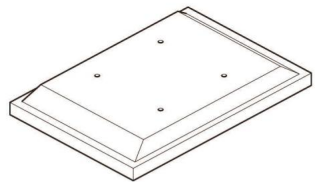

WARNING

please keep for future reference.

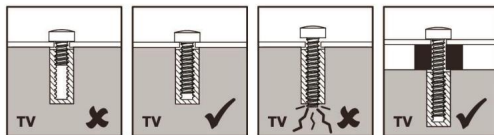

# 5

NOT INCLUDED

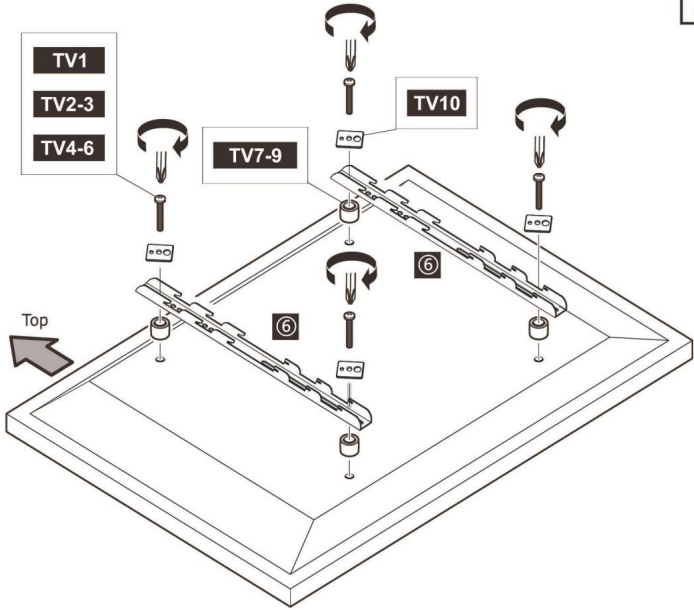
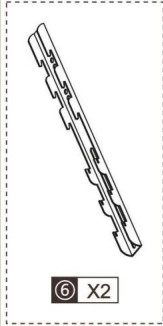

+



+



+



+



+



+

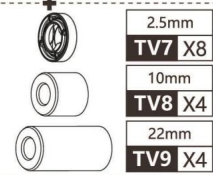
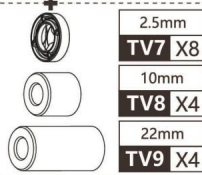
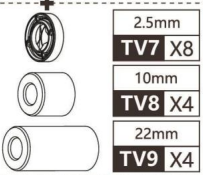

○ ○ ○ ○

Attach the bracket to the back of your TV using suitable screw, reducer and spacer combinations.

6

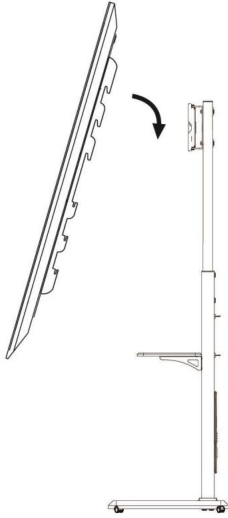

NOT INCLUDED



M X3

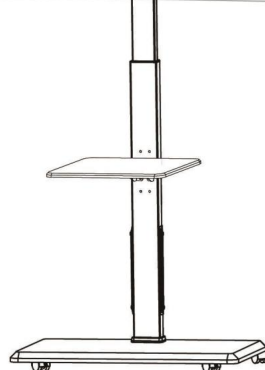
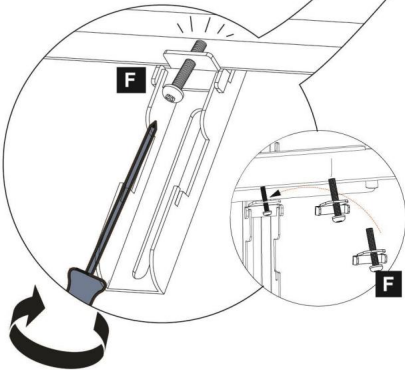
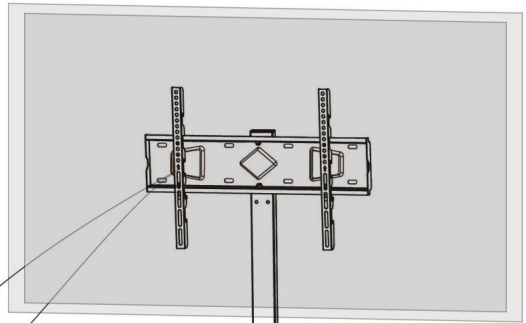
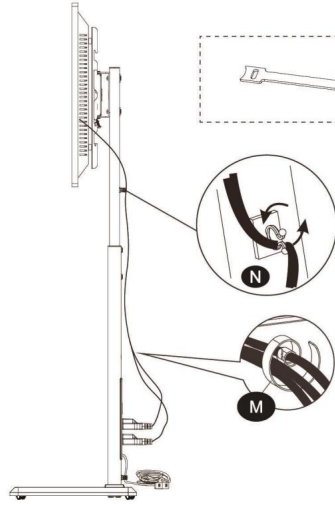

## PRODUKTPARAMETER

<b>Modell</b>	PCT01-2
<b>Driva</b>	AC125V 60Hz 12A (via Power Strip)
<b>Säker lastvikt</b>	88 LBS
<b>Produktstorlek</b>	660*380*(1365-1620) mm

**Tillverkare:** Shanghaimuxinmuyeyouxiangongsi

**Adress:** Shuangchenglu 803nong11hao1602A-1609shi, Baoshanqu, Shanghai 200000 CN.

**Importerad till AUS:** SIHAO PTY LTD. 1 ROKEVA STREETEASTWOOD NSW 2122 Australien

**Importerad till USA:** Sanven Technology Ltd. Suite 250, 9166 Anaheim Place, Rancho Cucamonga, CA 91730



YH CONSULTING LIMITED. C/O YH Consulting Limited Office 147, Centurion House, London Road, Staines-upon-Thames, Surrey, TW18 4AX



E-CrossStu GmbH  
Mainzer Landstr.69,  
60329 Frankfurt am Main.



**Teknisk support och e-garanticertifikat**  
[www.vevor.com/support](http://www.vevor.com/support)