

Assembly Instructions

This product only requires the lampshade to be installed.

How to fix the lampshade of a desk lamp

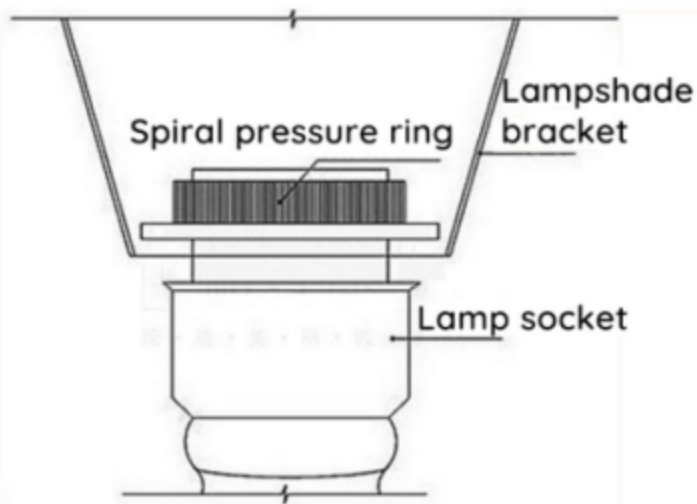

How to fix the lampshade

1. Remove the spiral pressure ring from the lamp holder
2. Put the lampshade on the lamp head
3. Press the lampshade bracket on the spiral pressure ring that has just been removed

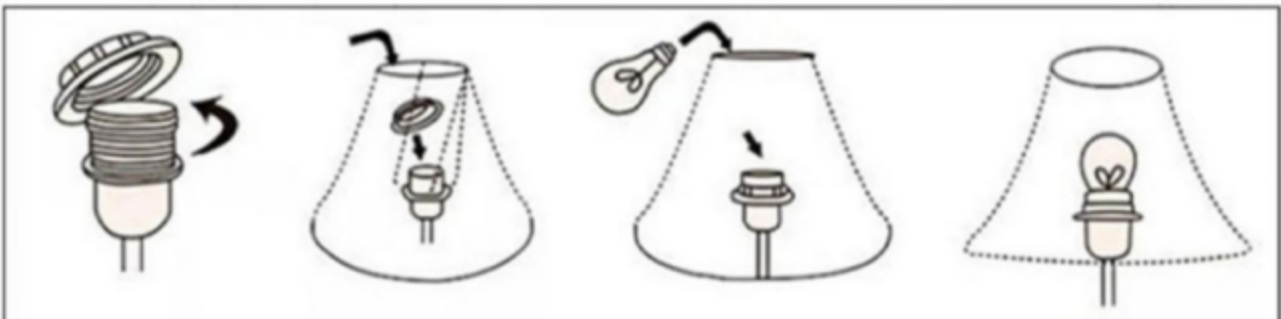

Your fixture is now assembled and ready to use.