

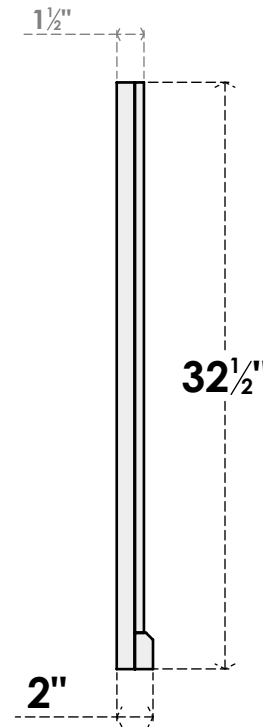

Technical drawing of a roof truss section. The drawing shows a cross-section of a roof with a pitch of 39.81 degrees. The main truss is a triangle with a base of 67" and a height of 32 1/2". The roof pitch is indicated by a line extending from the peak to the right, labeled 39.81 deg. The truss is composed of several horizontal members (chords) and vertical members (posts). The dimensions are as follows:

- Base: 67"
- Height: 32 1/2"
- Top chord length: 78"
- Right side vertical dimension: 27 7/8"
- Right side horizontal dimension: 2 5/8"
- Left side horizontal dimension: 5 1/2"
- Right side horizontal dimension: 5 1/2"
- Right side vertical dimension: 2"

# FRONT



## SIDE

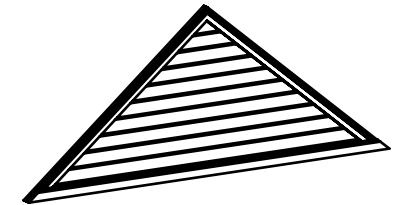

LOUVER HEIGHT: 2 3/4"  
LOUVER QTY: 10

1. INSTALLATION TO BE COMPLETED IN ACCORDANCE WITH MANUFACTURER'S SPECIFICATIONS.
2. DRAWING MAY NOT BE TO SCALE
3. THIS DRAWING IS INTENDED FOR DESIGN AND PLANNING PURPOSES ONLY.
4. ALL INFORMATION CONTAINED HEREIN WAS CURRENT AT THE TIME OF DEVELOPMENT BUT MU
- PRODUCT MANUFACTURER TO BE CONSIDERED ACCURATE.
5. ARCHITECTURAL GRADE PVC PRODUCTS ARE MADE FROM EXPANDED CELLULAR PVC AND CO

PAINTED

**EKENA MILLWORK**  
2300 WEST MAIN ST.  
CLARKSVILLE, TX 75426  
TOLL FREE: 866-607-0453  
[WWW.EKENAMILLWORK.COM](http://WWW.EKENAMILLWORK.COM)

Generated Date : 08/23/2022