

ASSEMBLY INSTRUCTIONS

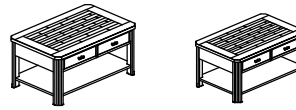

TOOLS REQUIRED:

Allen Wrench (supplied, Part # E)
Screw Driver (Not Supplied)

BEFORE YOU START:

1. Check the hardware against the hardware list to make sure all items are present.
2. Assemble your furniture on a soft, flat surface to avoid scratching the finish.
3. **CAUTION:** Do not over tighten screws, nuts or bolts during assembly.
4. Your furniture may require occasional tightening.

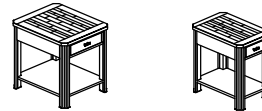
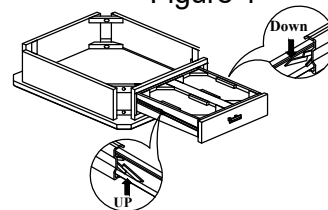

Figure 1



INSTRUCTIONS:

1. Remove the drawer by fully extending it to expose the lever in the track. Release by pushing on lever one up and one down. As shown in Figure 1
2. Turn the top upside down on a clean soft surface.
3. Attach the three legs to the drawer box top using Bolt (A), Lock Washer (C) and Flat Washer (D) and tighten with the Allen Wrench (E). As Shown in Figure 2.
4. Attach the shelf to the leg using Bolt (B), Lock Washer (C) and Flat Washer (D) and tighten with the Allen Wrench (E). As Shown in Figure 3.
5. Repeat steps 3, 4 for the fourth leg. As shown in Figure 4.
6. Tighten all bolts before setting table back upright.
7. Turn the table upright and replace the drawers by sliding them back into the track.

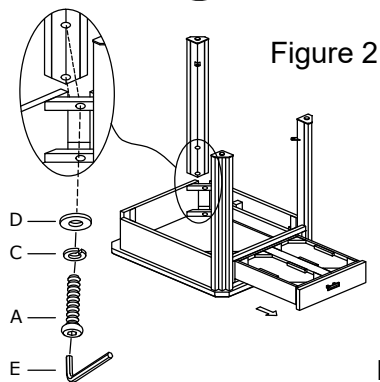

Figure 2

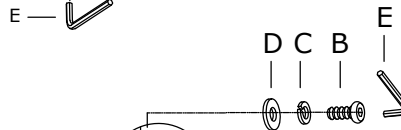
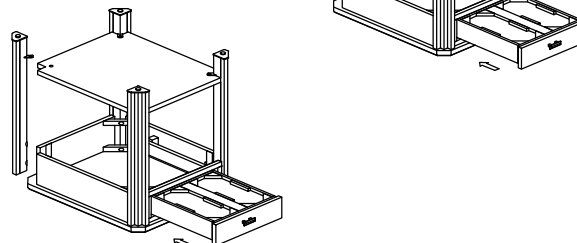

Figure 3

Figure 4



HARDWARE LIST			
NO.	Drawing	Description	Q'TY
A		Allen Bolt (ϕ 1/4 "x1-3/4 ")	8pcs
B		Allen Bolt (ϕ 1/4 "x5/8 ")	4pcs
C		1/4" Lock Washer	12pcs
D		1/4"*5/8 Flat Washer	12pcs
E		4mm Wrench	1pc

Thank you for purchasing furniture!