

MODEL : CF 9191 (4'6")

## ASSEMBLY INSTRUCTION

Step 1 : Tighten the leg (F) to arm (A).

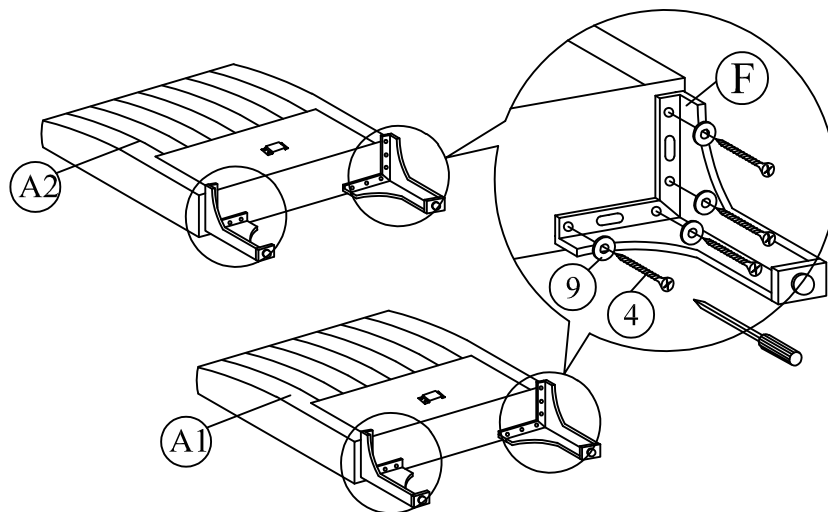

Step 2 : Attach side rail (D) &amp; (E) to arm (A) by pushing the bracket down to fit it.

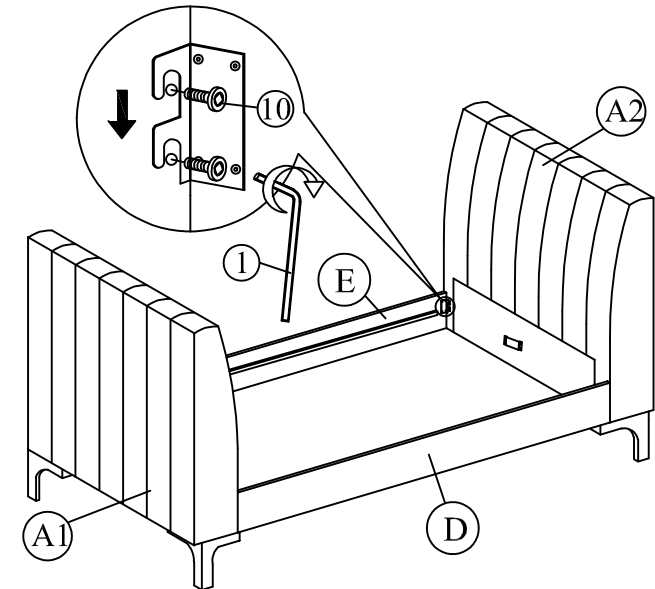

Step 3 : Attach the back panel (B) to arm (A). Attach side rail (D) to arm (A) by pushing the bracket down to fit it. Tighten with Allen Key (2).

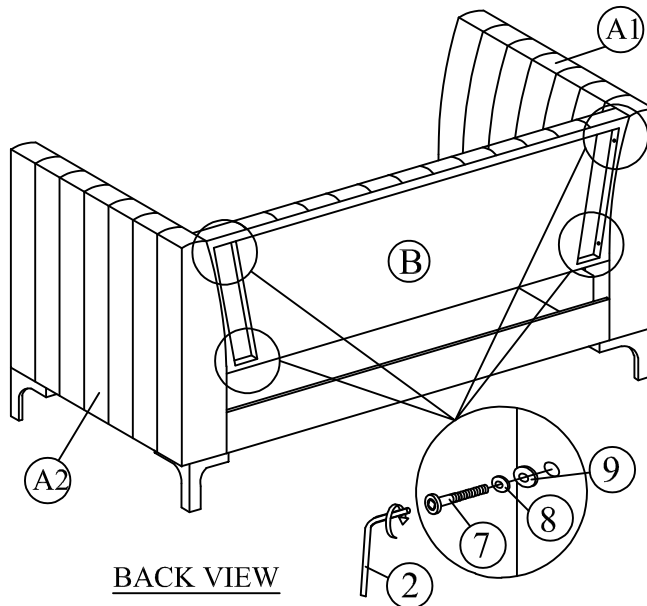

BACK VIEW

Step 4: Attach the support legs (H) to the center rail (G) of the bed as shown.

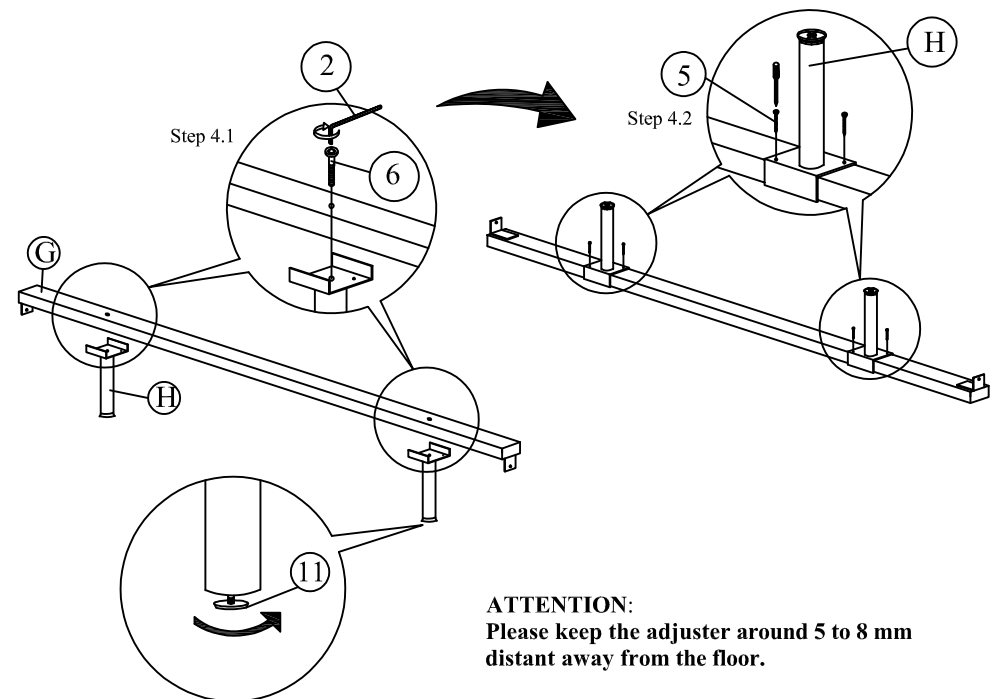

**ATTENTION:**  
Please keep the adjuster around 5 to 8 mm  
distant away from the floor.

Packing Hardware		
1	M5 x 70 mm	1 pc
2	M4 x 65 mm	1 pc
3	CSK M4 x 32mm	29 pcs
4	CSK M4 x 25mm	18 pcs
5	CSK M4 x 16mm	4 pcs
6	JCBC M6 X 40	2 pcs
7	JCBC M6 X 50	4 pcs
8	SPRING WASHER	4 pcs
9	FLAT WASHER	20 pcs
10	JCBB M8 X 20	8 pcs
11	BIG ADJUSTER	2 pcs

Step 5 : Slide the center rail (G) to the arm (A). Tighten screws (4) using screw driver (not included) to the arm (A).

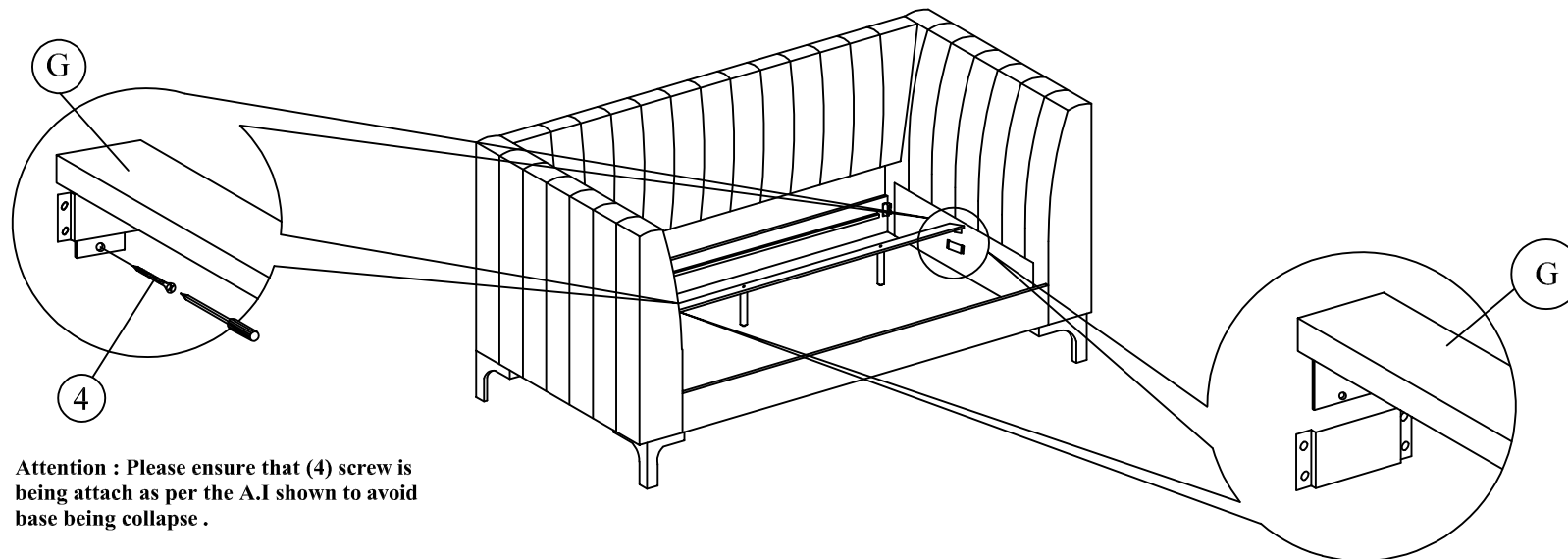

Step 6 : Tighten the slats with CSK screw (3). The distance of the slats should be sufficient to obtain desirable bed stability. Tighten all the 4 corner.

