

# ASSEMBLY INSTRUCTION

## DESCRIPTION: WRITING DESK

Thank you for purchasing this quality product. Be sure to check all packing material carefully for small parts which may have come loose inside the carton during shipment. Identify and count all parts and compare with the parts List Below.

### Finish Assembly

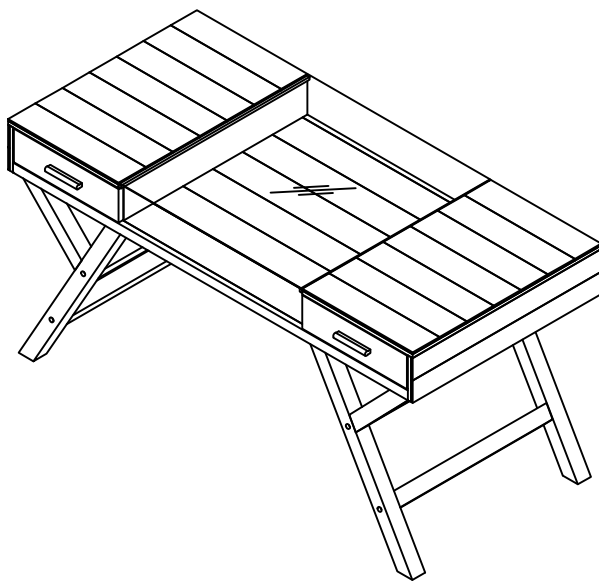

### PART LIST

NO.	DRAWING	DESCRIPTION	Q'TY
1		TOP	1pc
2		GLASS TOP	1pc
3		LEFT LEGS	2pcs
4		RIGHT LEGS	2pcs
5		STRETCHER	4pcs

### HARDWARE LIST

NO.	DRAWING	DESCRIPTION	Q'TY
A		BOLT 1/4" x 20 x 1-1/4"	8pcs
B		LOCK WASHER 1/4"	16pcs
C		FLAT WASHER 1/4"x16mm	16pcs
D		BOLT 1/4" x 20 x 2"	8pcs
E		ALLEN KEY 4mm	1pc
F		WOOD DOWEL Ø8x30mm	16pcs
G		PLASTIC CAP	8pcs

#### Step 1:

- Insert wood dowel locators (F) in the Left Leg (3), Right Leg (4), and the Stretcher(5) Assemble the Left leg (3), Right leg (4) and stretcher (5) with bolt (D), flat washer (C) lock washer (B) and Plastic Cap (G) using Allen Key (E). (See Page 2 of 2)

#### Step 2:

- Assemble the Left leg (3), Right leg (4) and stretcher (5) and the Top (1) with bolt (A) flat washer (C) lock washer (B) and using Allen Key (E). (See Page 2 of 2)

#### Step 3:

- Flip it over and assemble the Glass Top (2). (See Page 2 of 2)

#### Notes:

- Please follow the assembly diagram on locating all bolts and wood dowels. (See Page 2 of 2)

### CLEANING INSTRUCTION

Clean the surface with a furniture polish and a soft cloth.

# ASSEMBLY INSTRUCTION

## DESCRIPTION: WRITING DESK

Thank you for purchasing this quality product. Be sure to check all packing material carefully for small parts which may have come loose inside the carton during shipment. Identify and count all parts and compare with the parts List Below.

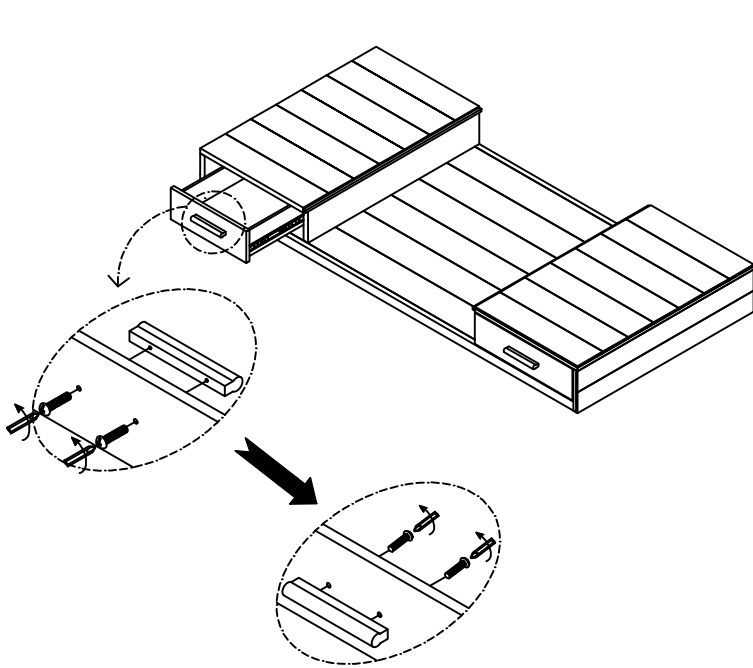

STEP 1

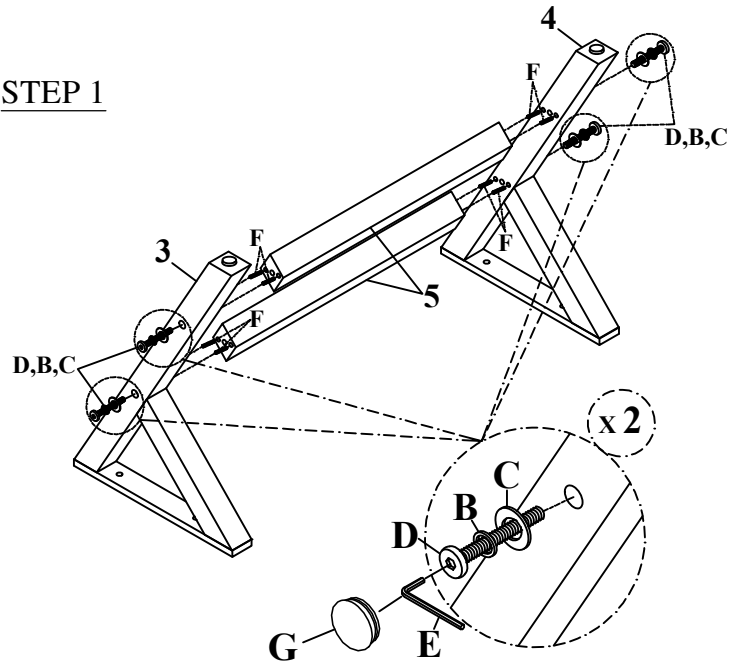

STEP 2

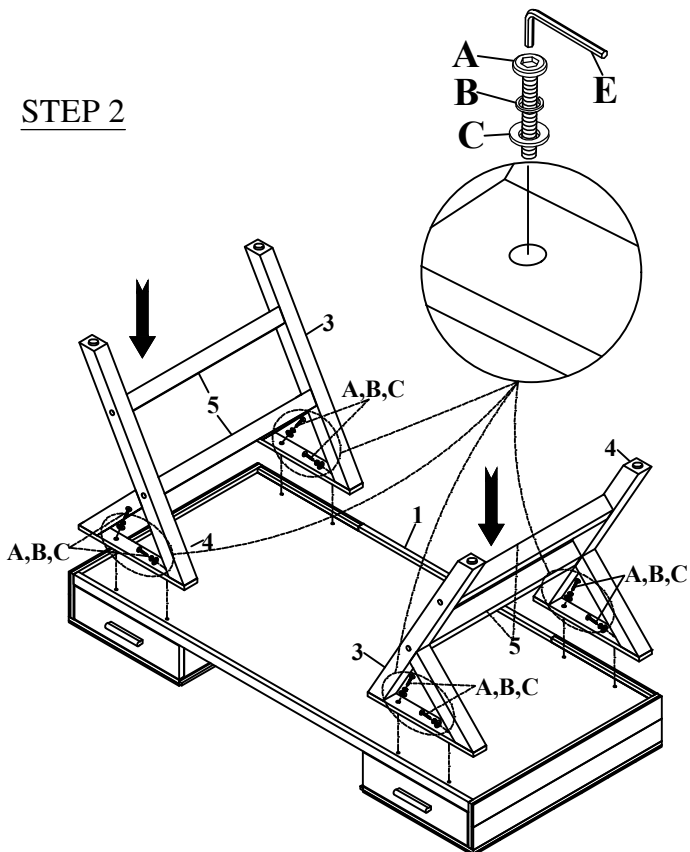

STEP 3

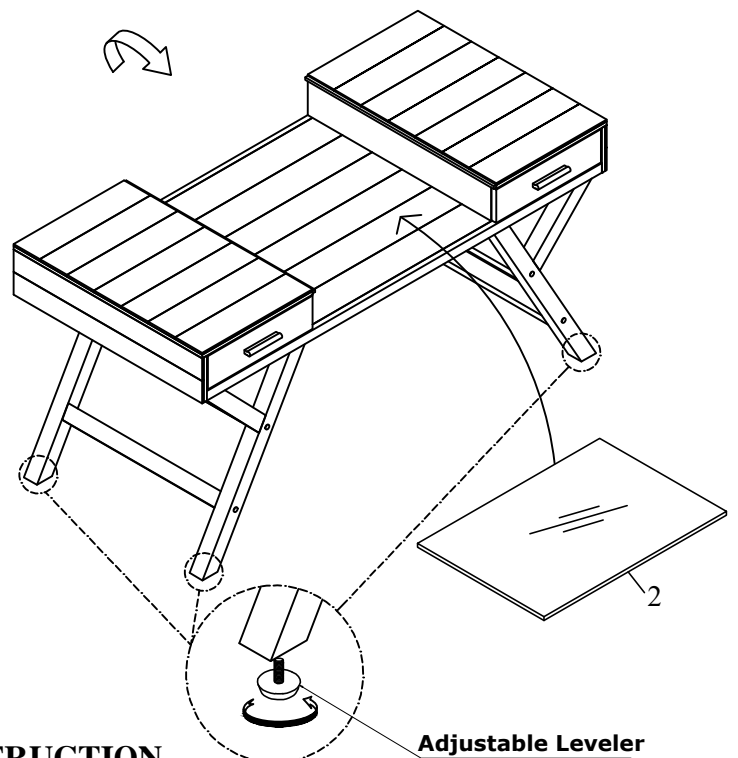

## CLEANING INSTRUCTION

Clean the surface with a furniture polish and a soft cloth.