

Coffee Table

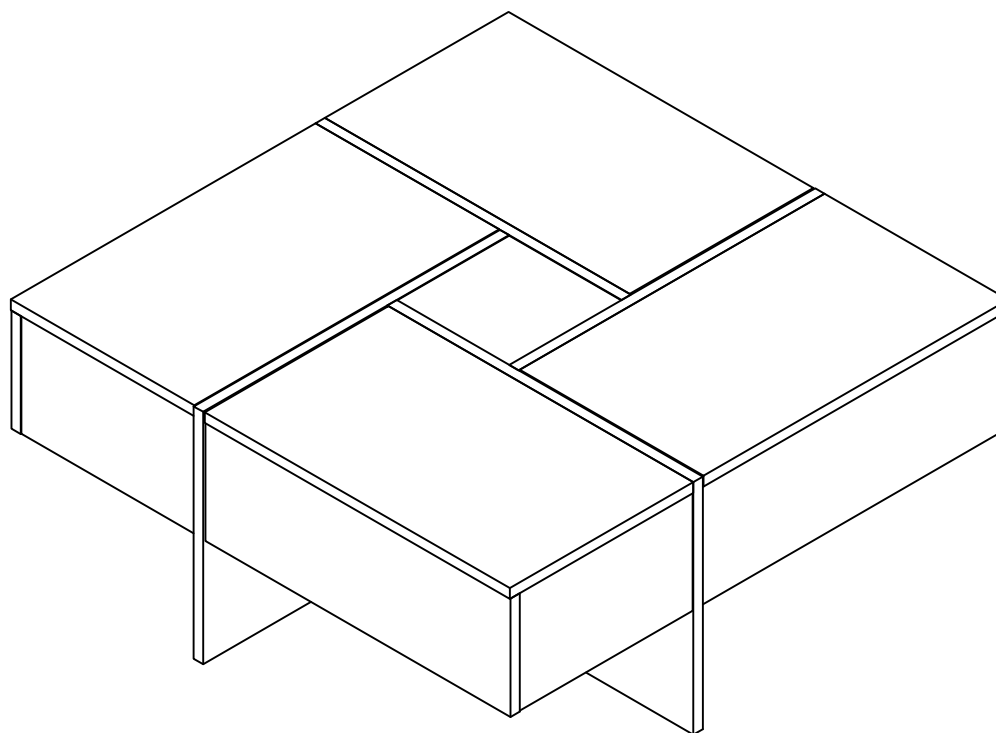

Width-31.5 inch
Depth-31.5inch
Height-13.78inch



Safety and Care Advice

Important – Please read these instructions fully before starting assembly

- Check you have all the components and tools listed on the following pages.
- Remove all fittings from the plastic bags and separate them into their groups.
- Keep children and animals away from the work area, small parts could choke if swallowed.
- Make sure you have enough space to layout the parts before starting.

- During assembly do not stand or put weight on the product, this could cause damage.
- Assemble the item as close to its final position (in the same room) as possible.
- Assemble on a soft level surface to avoid damaging the unit or your floor.
- Parts of the assembly will be easier with 2 people.



- To reduce the likelihood of damaging your product please ensure that your power drill is set on a low torque setting.

Care and maintenance

- Only clean using a damp cloth and mild detergent, do not use bleach or abrasive cleaners.
- From time to time check that there are no loose screws on this unit.
- This product should not be discarded with household waste. Take to your local authority waste disposal centre.

Handy Hints

- Assemble all parts and bolts loosely during assembly, only once the product is complete should you fully tighten the bolts
- Regularly check and ensure that all bolts and fittings are tightened properly.

WARNING
In order to help prevent overturning –
please follow these instructions

To help prevent product toppling over please follow the below steps:-

Use the anti tip strap or wall fixing method provided (if applicable)
Do not allow children to climb or hang on the furniture
Do not open more than one drawer at a time
Do not place heavy items in the top drawers
Do not place heavy items on top of the furniture, unless the furniture has been designed for this purpose

PLEASE NOTE: Part number **1**, Part number **5** , Part number **6**, Part number **8** are covered with a tight plastic protective film.
 If there are scratches on the product after disassembly, please don't worry, it's not product damage.
 Please slowly tear off the protective plastic film on the surface along the edge. After peeling off, the product becomes smooth and clean.

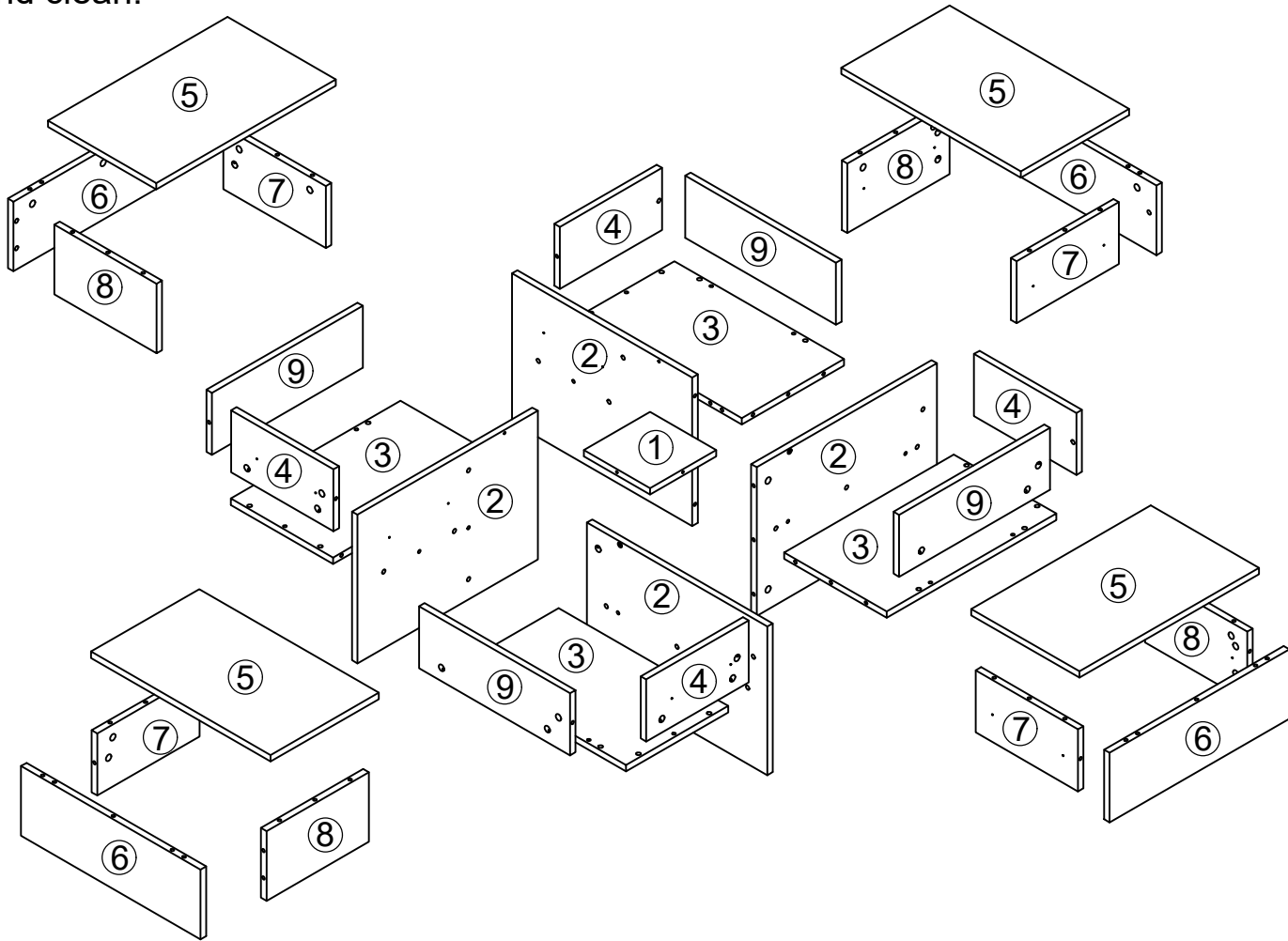

A	B	C	D	E	F	G	H	I
92+2PCS	92+2PCS	44+2PCS	4PCS	32+2PCS	8PCS	4PCS	4PCS	8PCS

"A" Hardware installation example

I

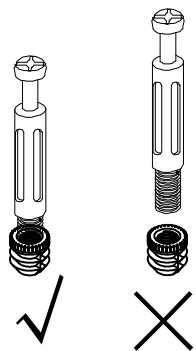

This part cannot be separated,
please install in strict
accordance with the assembly
requirements

II

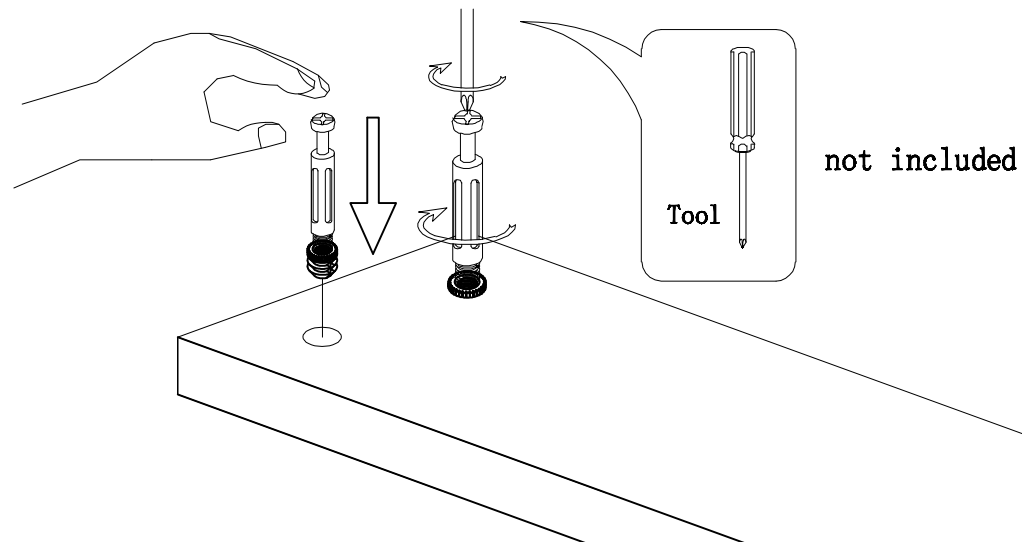

III

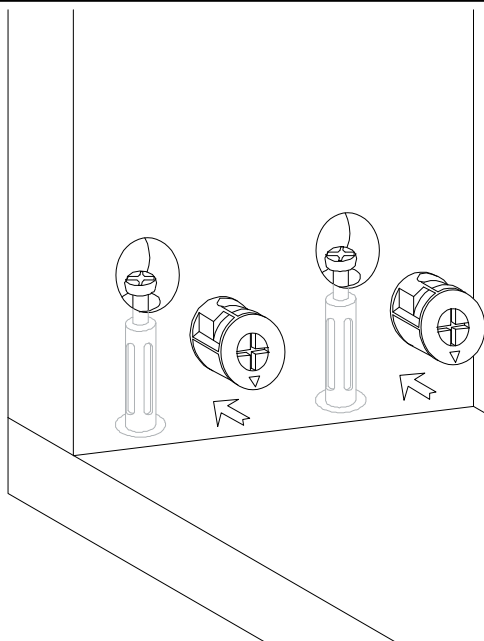

IV

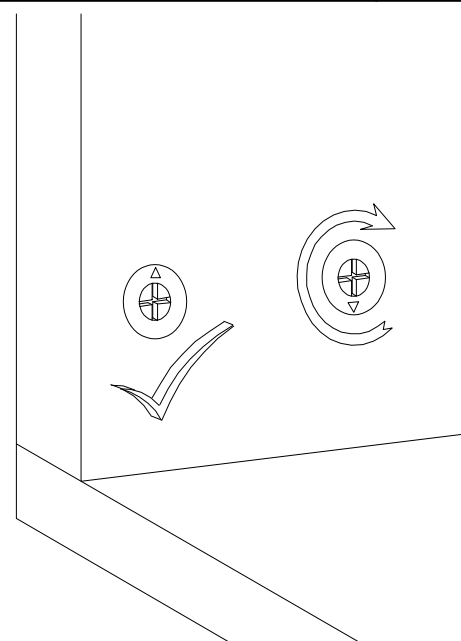

1

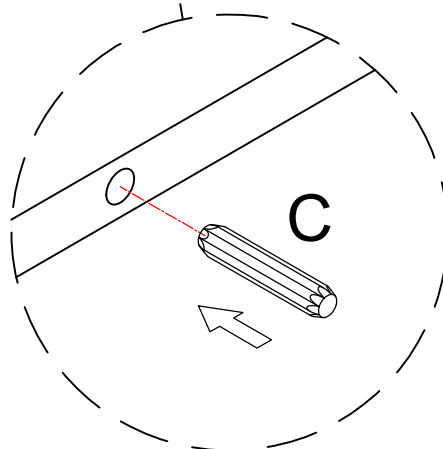
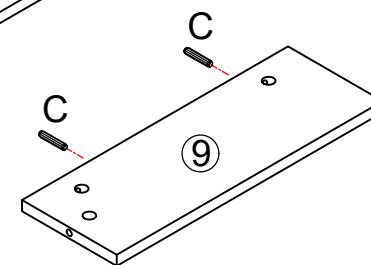
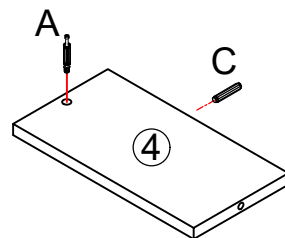
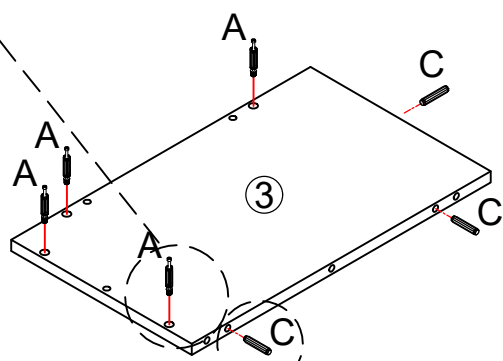
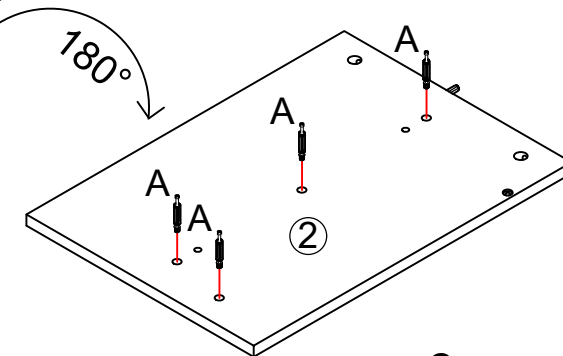
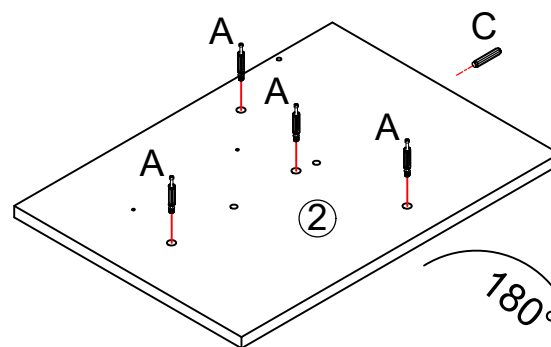
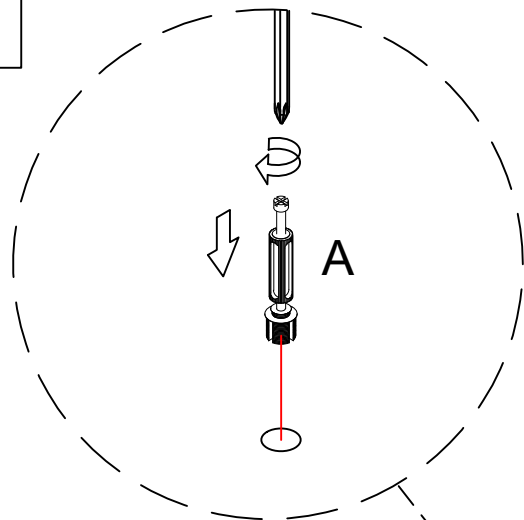

X4



A*52



C*28

2

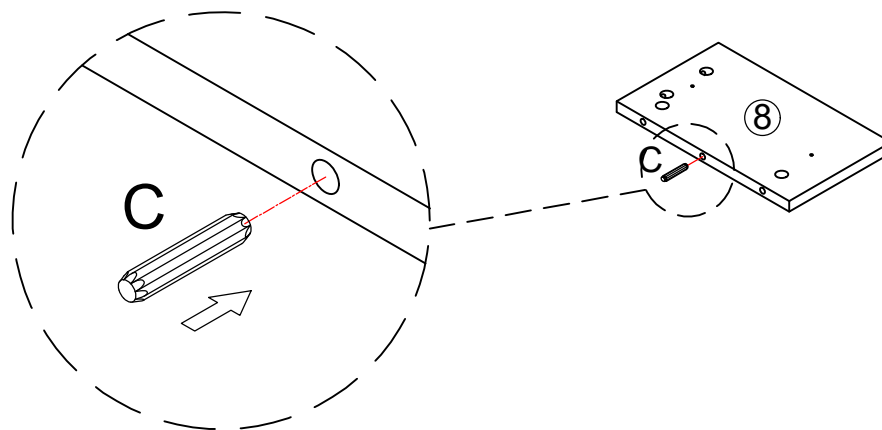
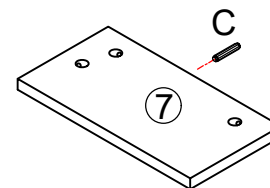
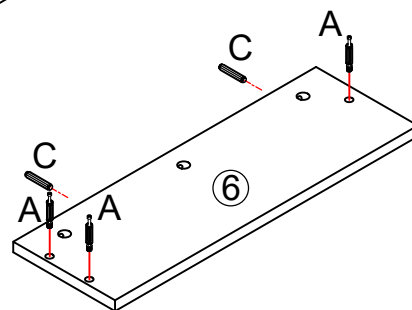
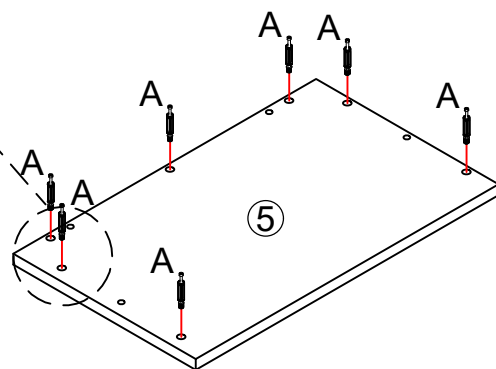
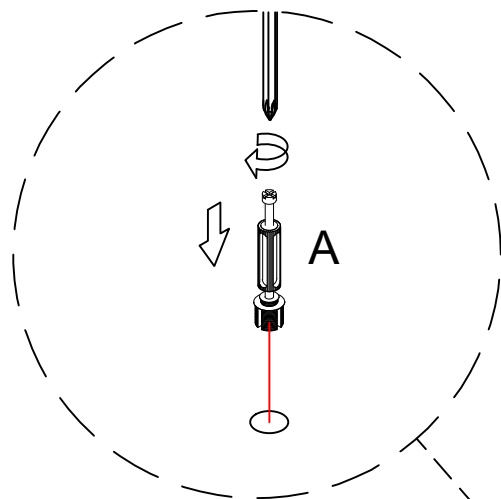

X4



A*40



C*16

3

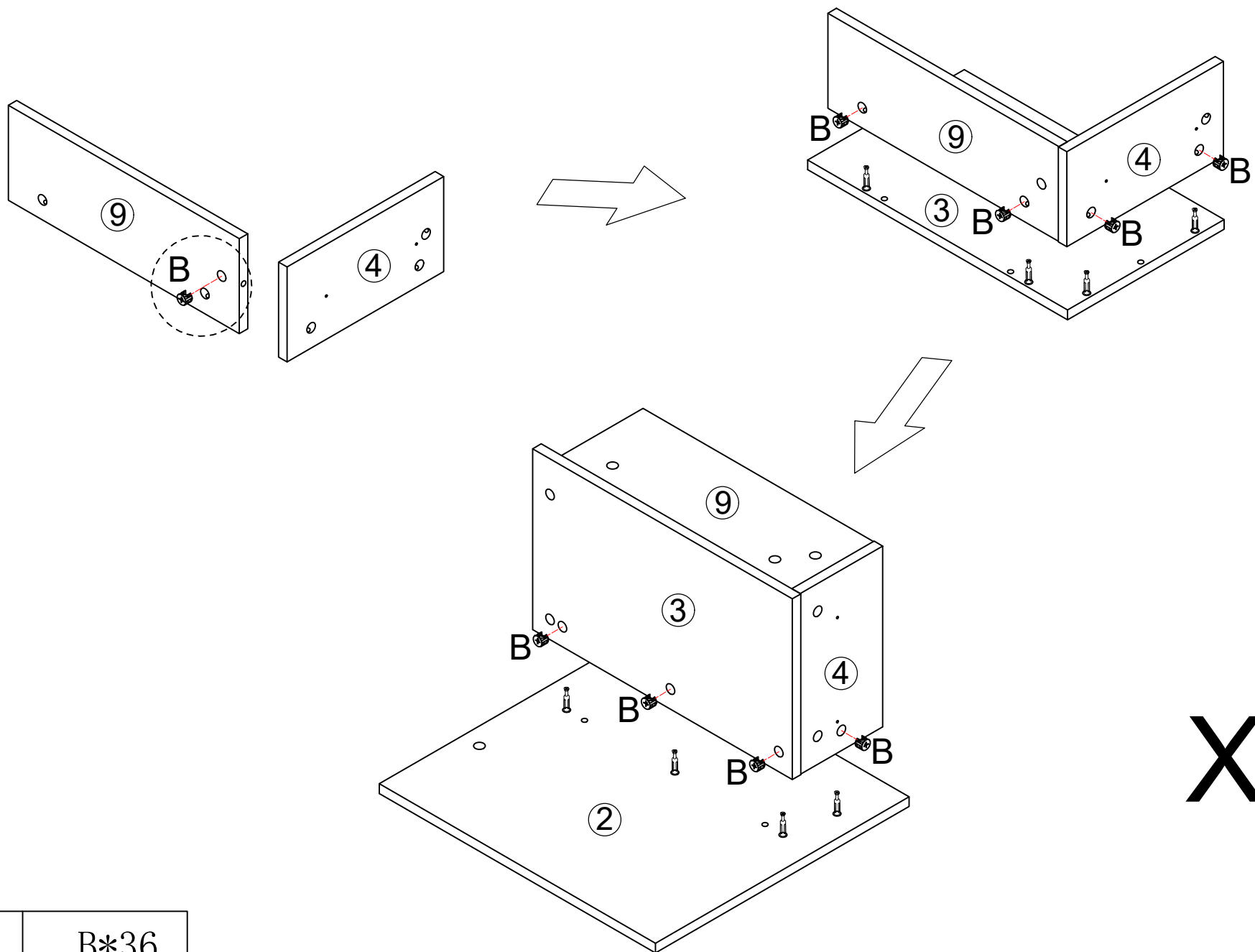

X4



B*36

4

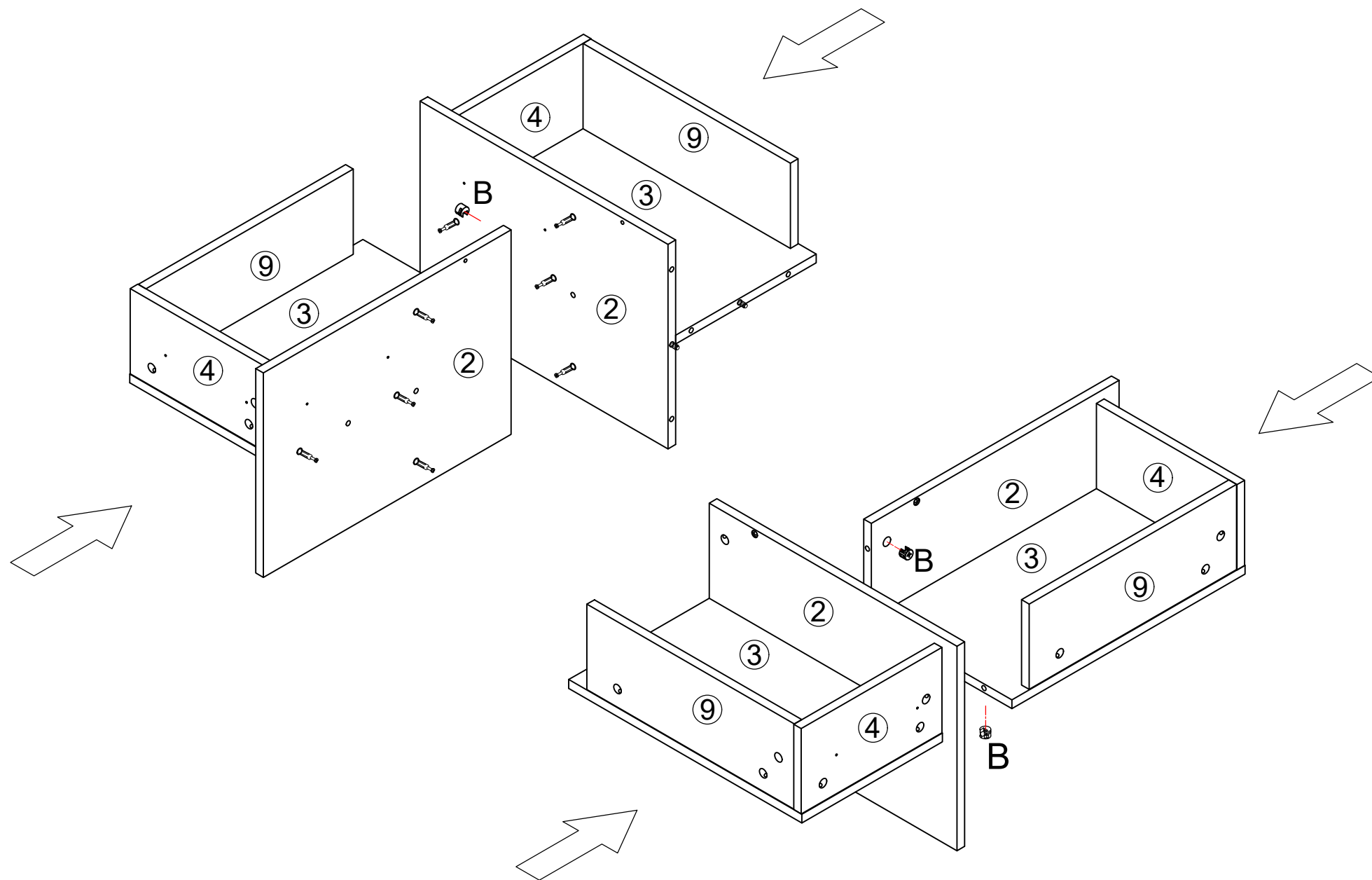

B*8

5

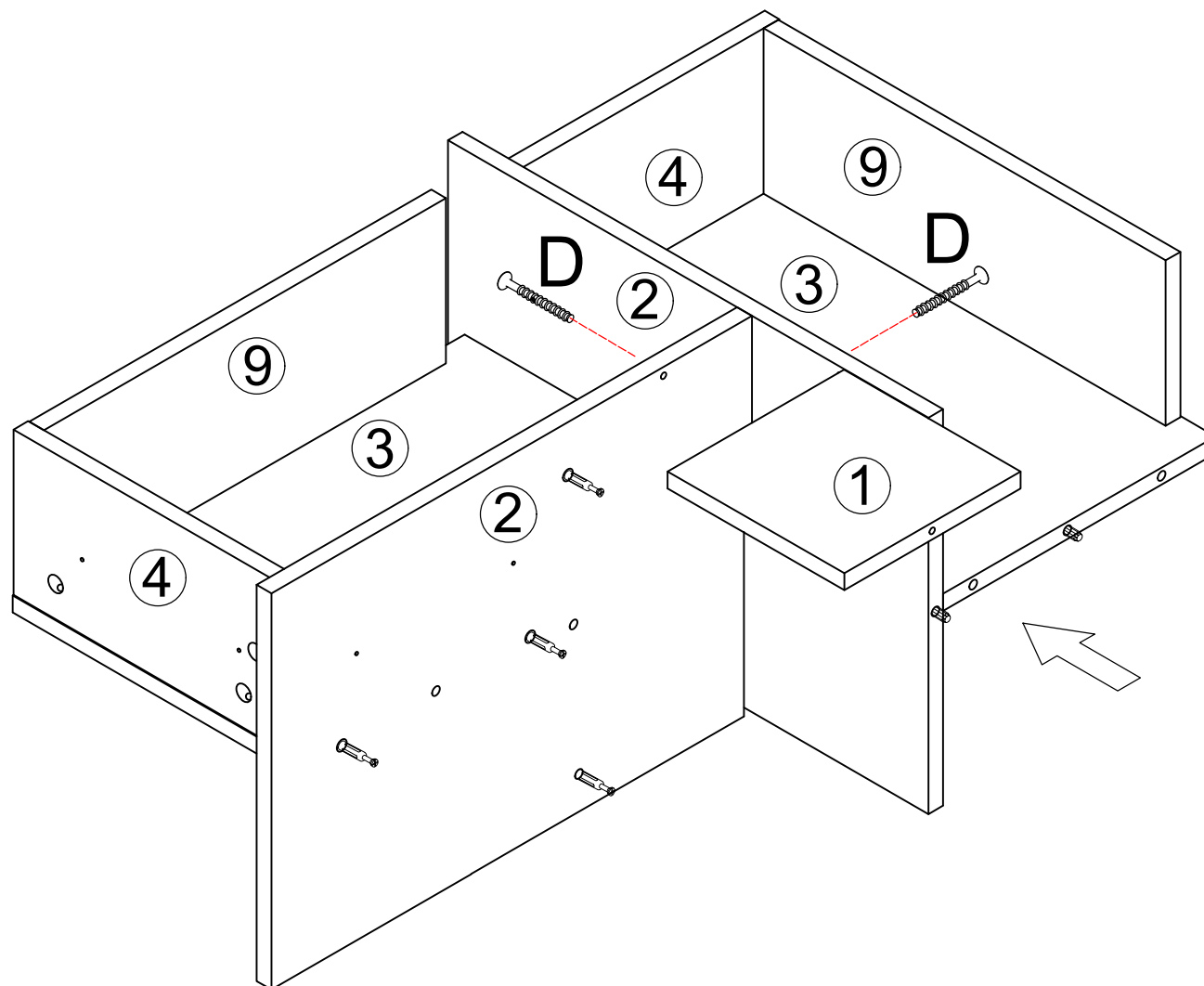

D*2

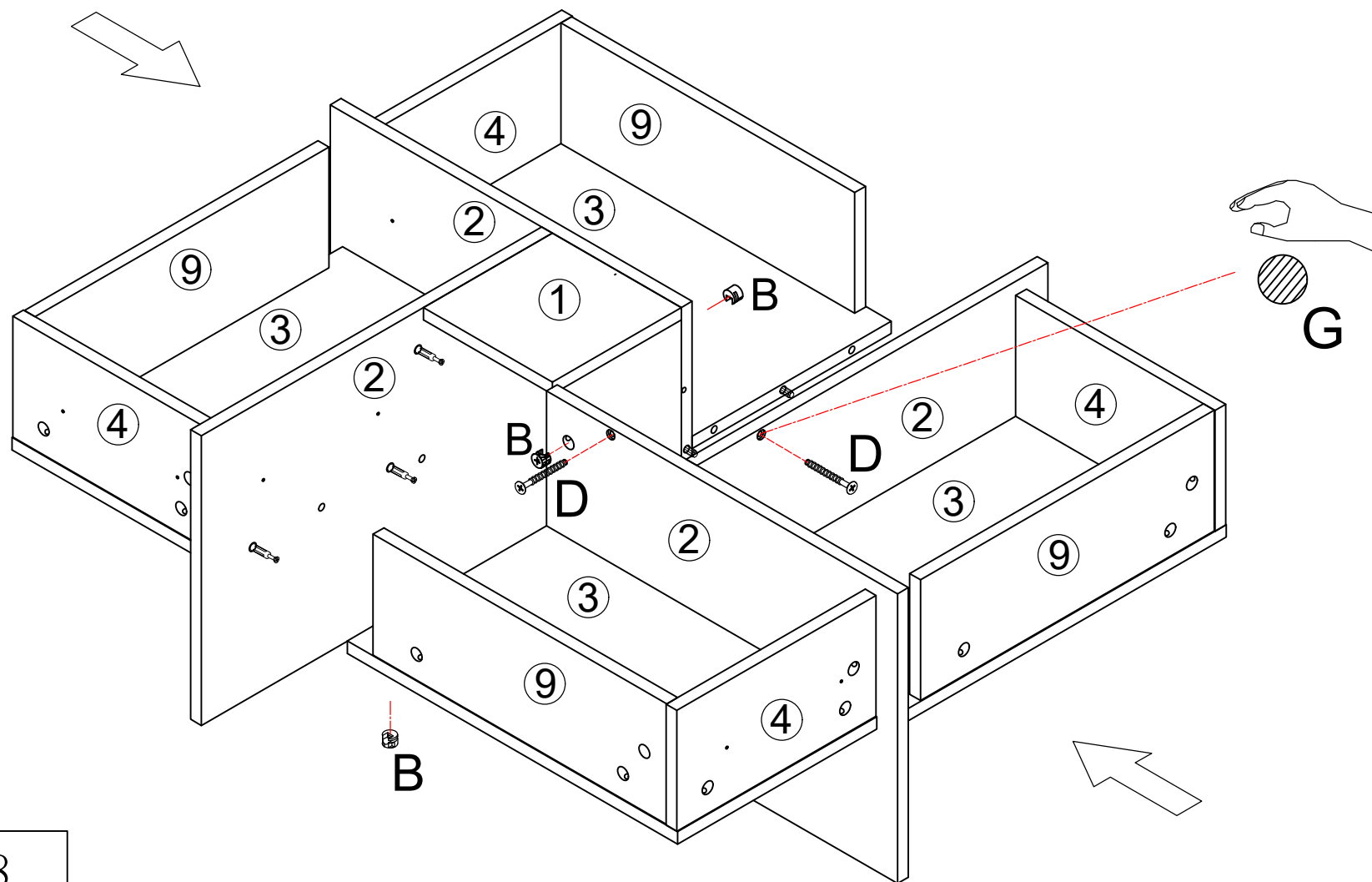

B*8



D*2



G*4

7

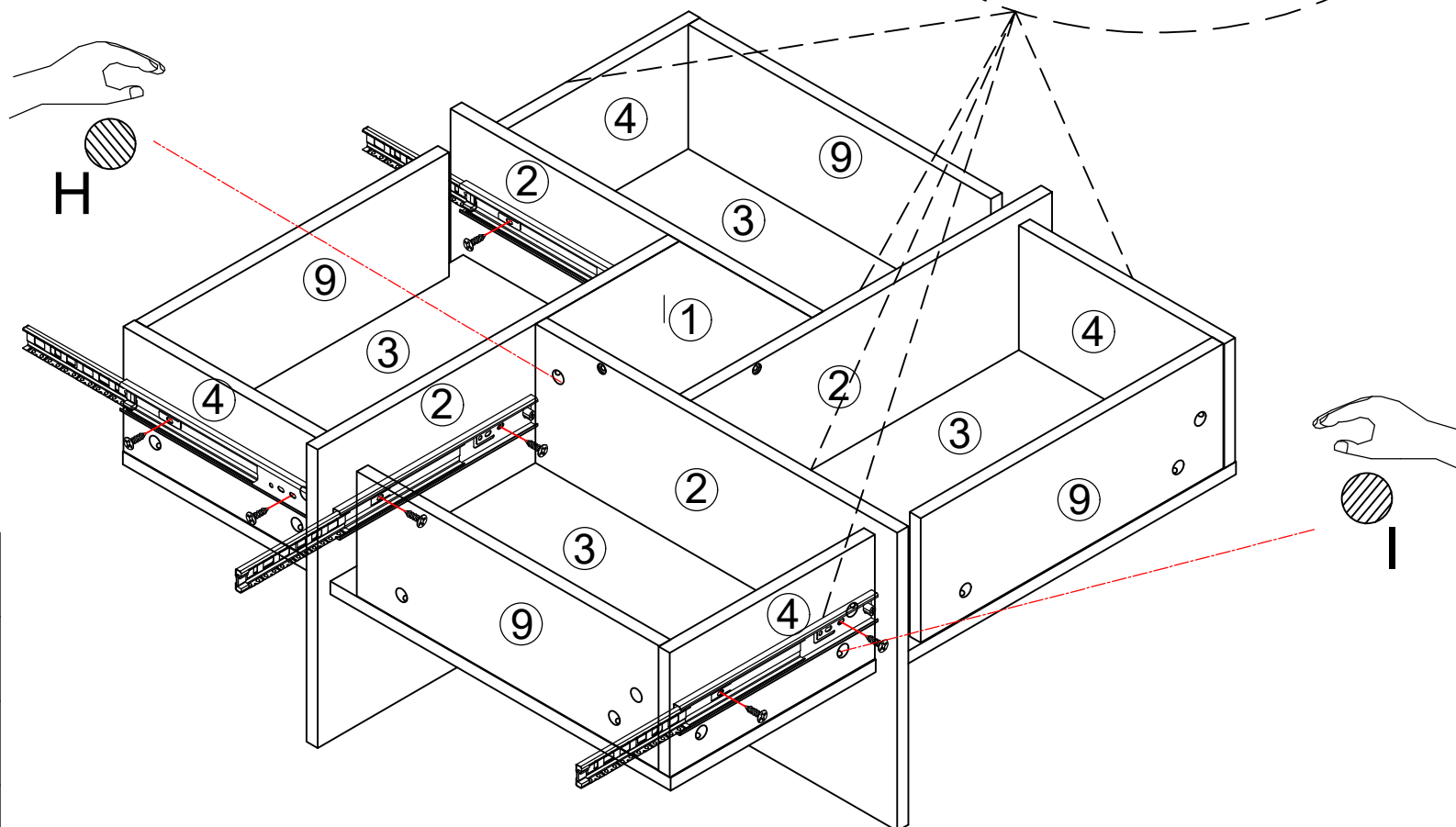
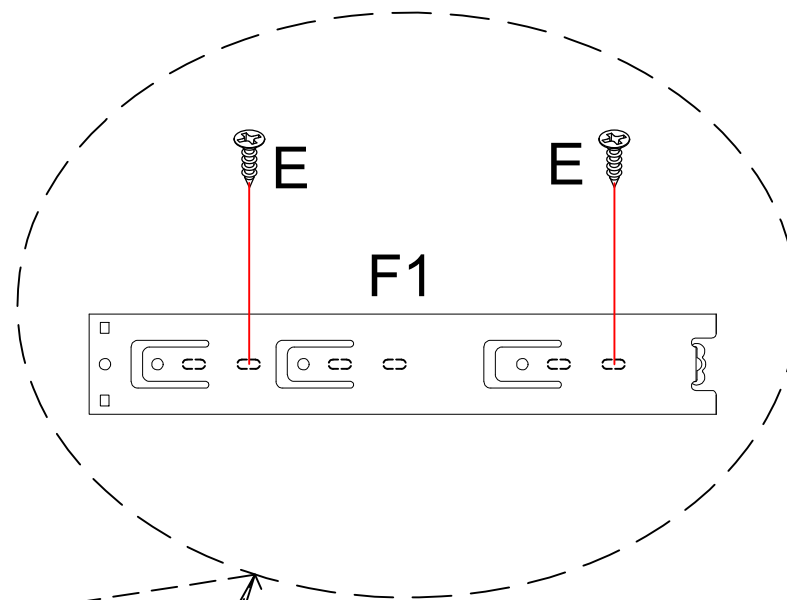
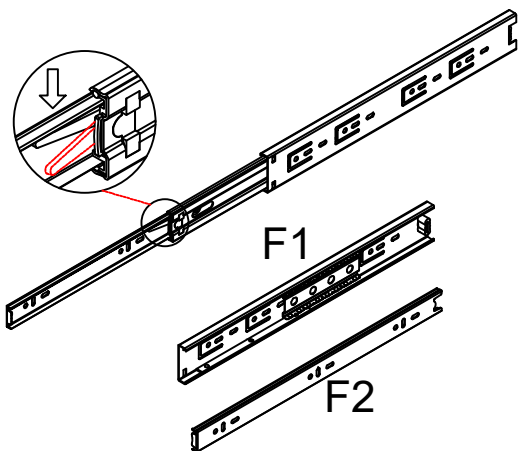

E*16



F1*8



H*4



I*8

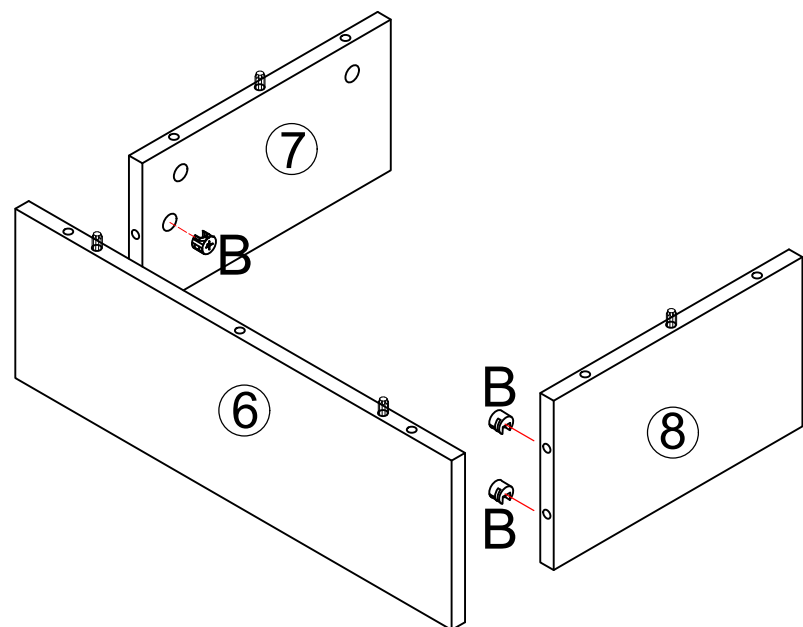

X4

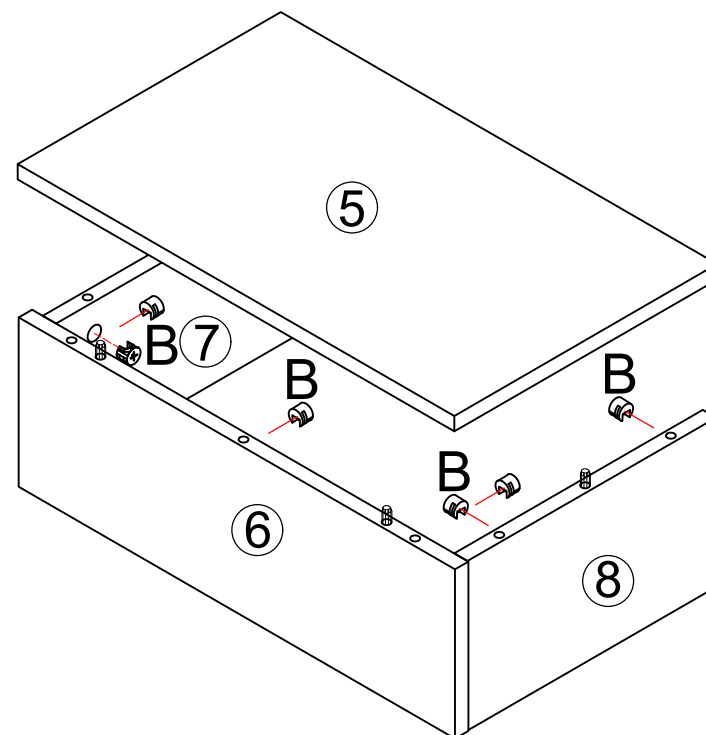

B*40

9

X4

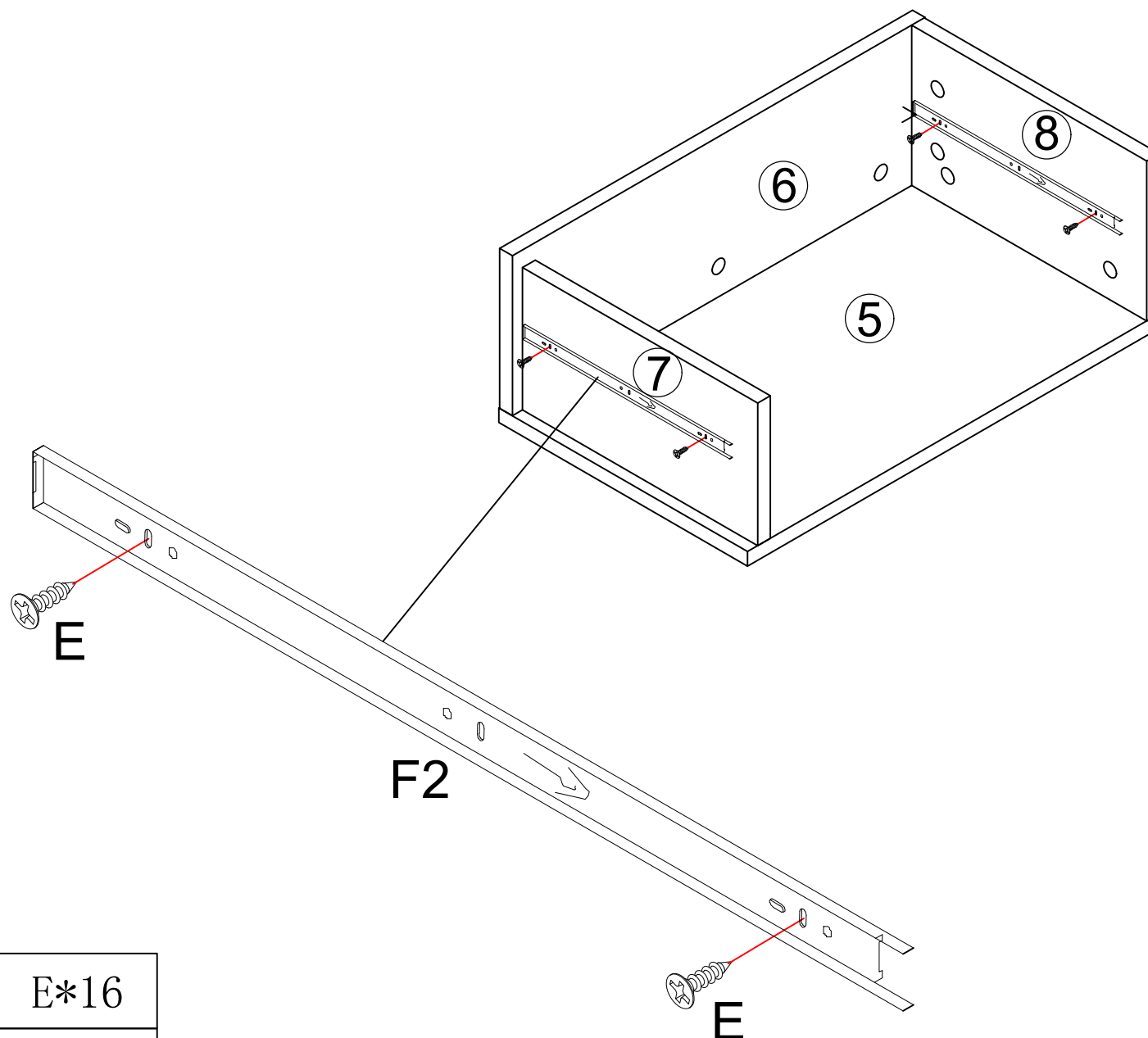

E*16



F2*8

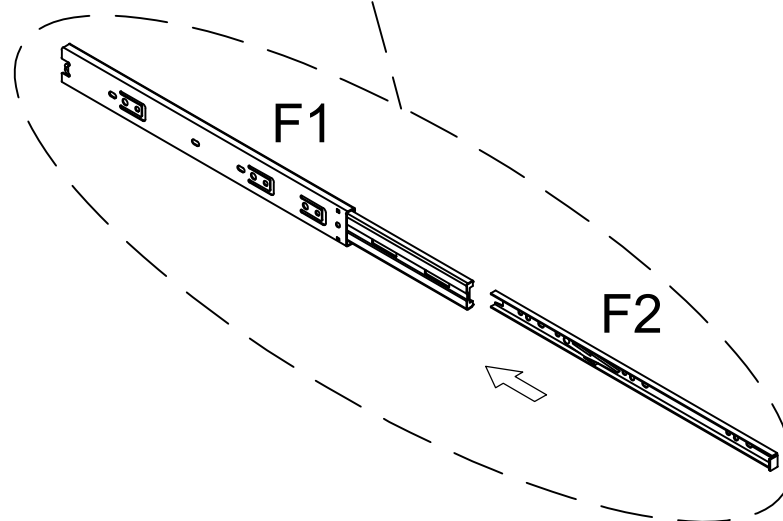
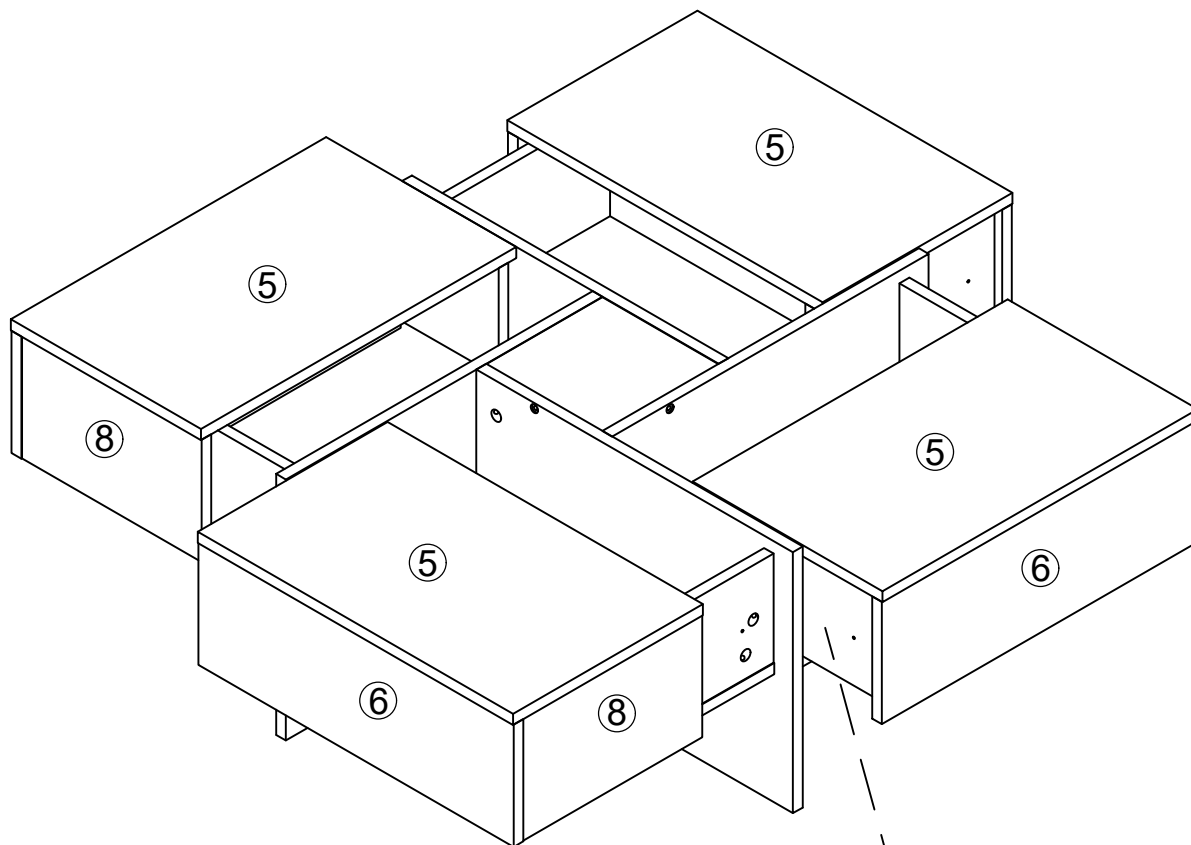

PLEASE NOTE: Part number **1**, Part number **5**, Part number **6**, Part number **8** are covered with a tight plastic protective film.

If there are scratches on the product after disassembly, please don't worry, it's not product damage. Please slowly tear off the protective plastic film on the surface along the edge. After peeling off, the product becomes smooth and clean.

