

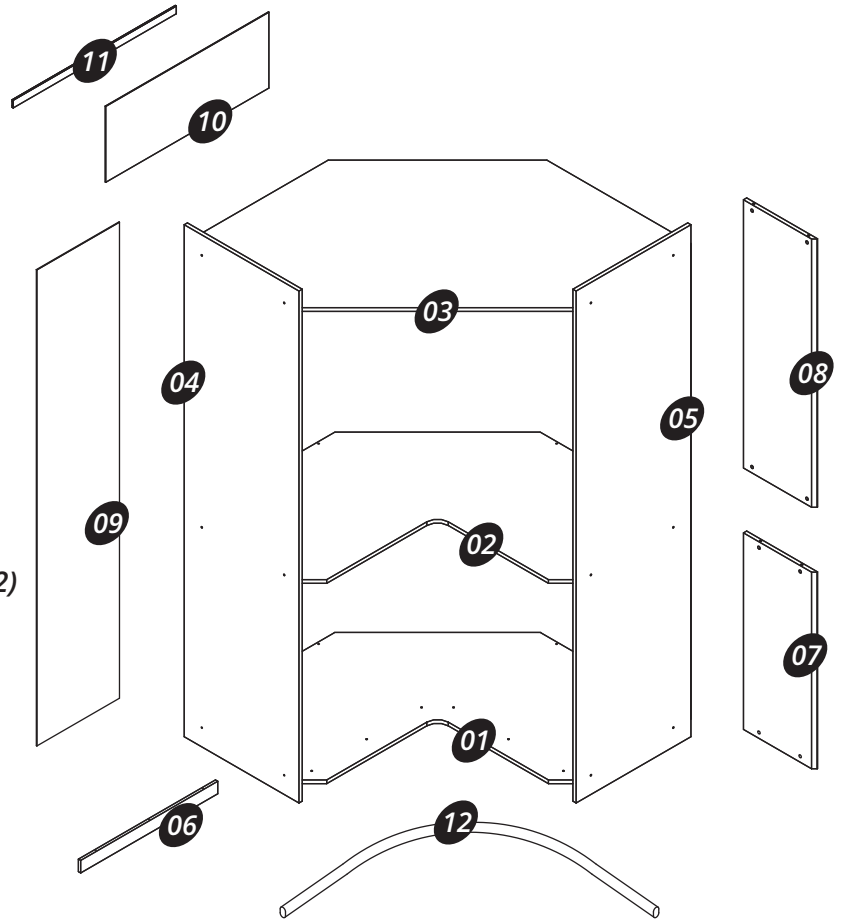

Corner Wardrobe

Included in the package

- 01 - Base Panel = 01 piece (box 1/2)
- 02 - Shelf Panel = 01 piece (box 1/2)
- 03 - Top Panel = 01 piece (box 1/2)
- 04 - Left Side Panel = 01 piece (box 2/2)
- 05 - Right Side Panel = 01 piece (box 2/2)
- 06 - Lower Bar = 04 pieces (box 2/2)
- 07 - Lower Lateral Panel = 02 pieces (box 2/2)
- 08 - Upper Lateral Panel = 02 pieces (box 1/2)
- 09 - Larger Rear Panel = 02 pieces (box 2/2)
- 10 - Smaller Rear Panel = 05 pieces (box 2/2)
- 11 - Union Plastic Profile = 04 pieces (box 1/2)
- 12 - Aluminum Hanger Bar = 02 pieces (box 1/2)



Hardware (box 1/2)



A = 04x

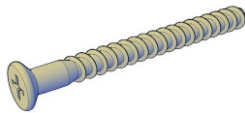

B = 24x



C = 32x



D = 12x

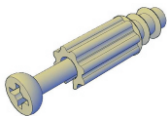

E = 16x



F = 16x

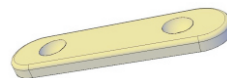

G = 12x

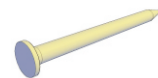

H = 160x



I = 04x

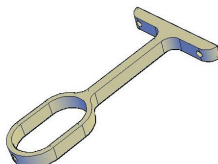

J = 02x



K = 16x



L = 04x



Tools needed
(not included)



Philips screw driver

Screw driver

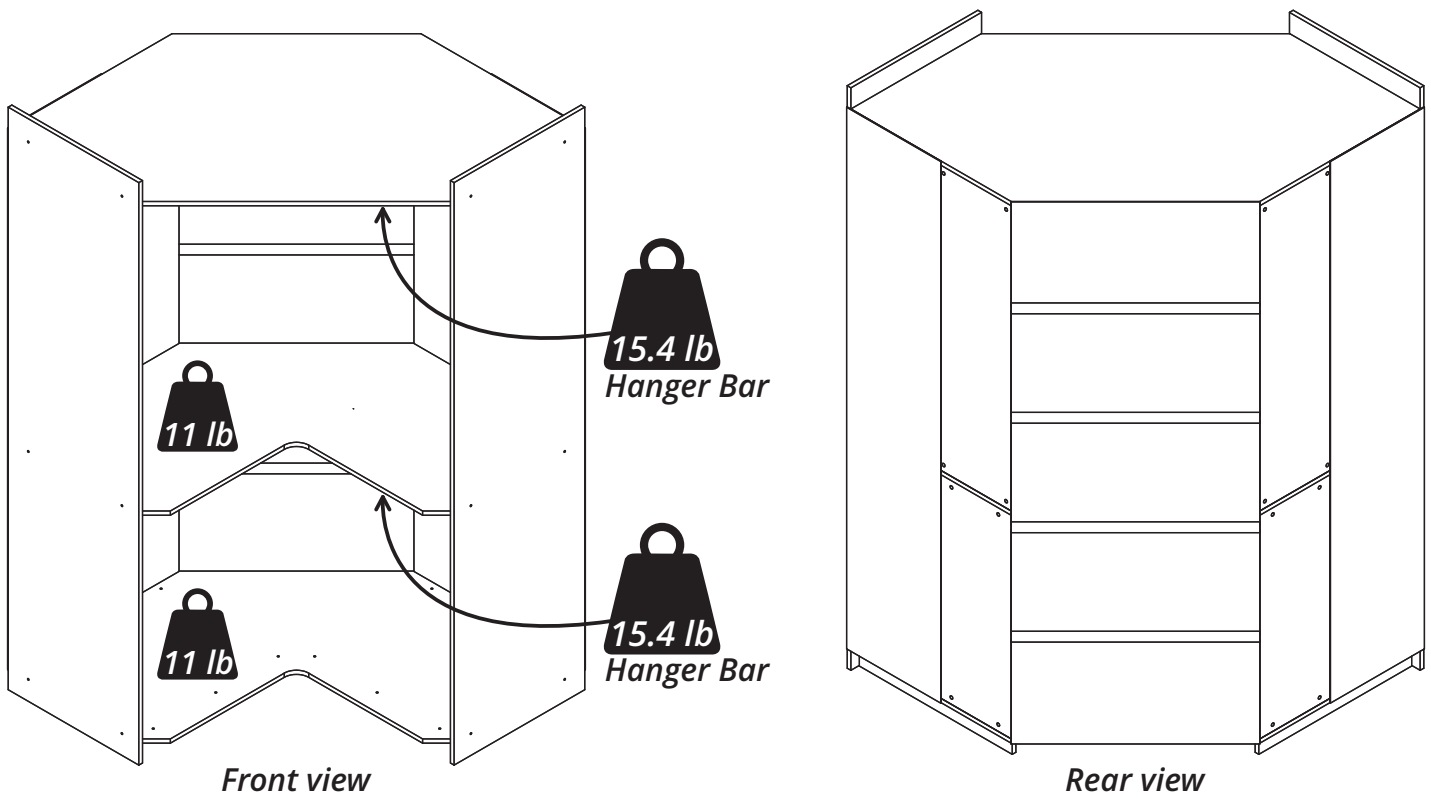

Step 01

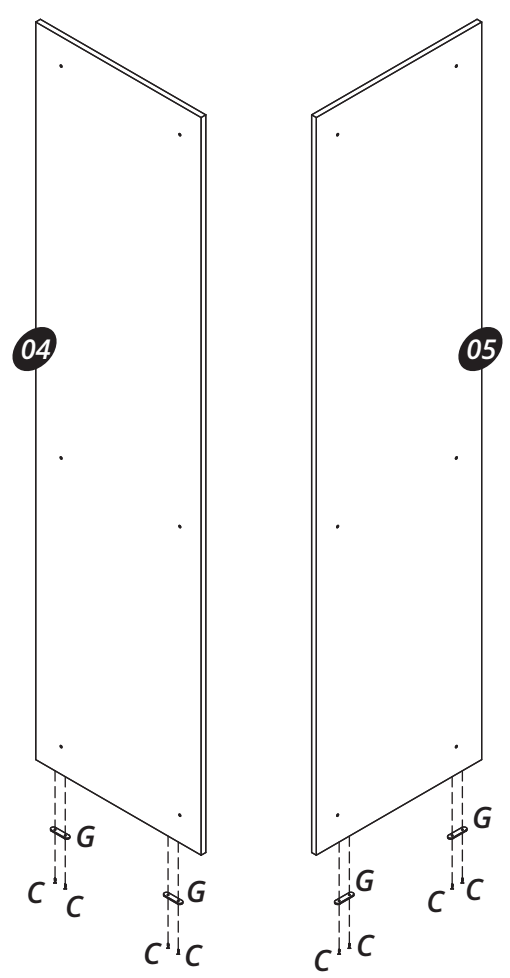

Fix the hardware (G) onto the part (04), onto the part (05) and the part (06) with the hardware (C).

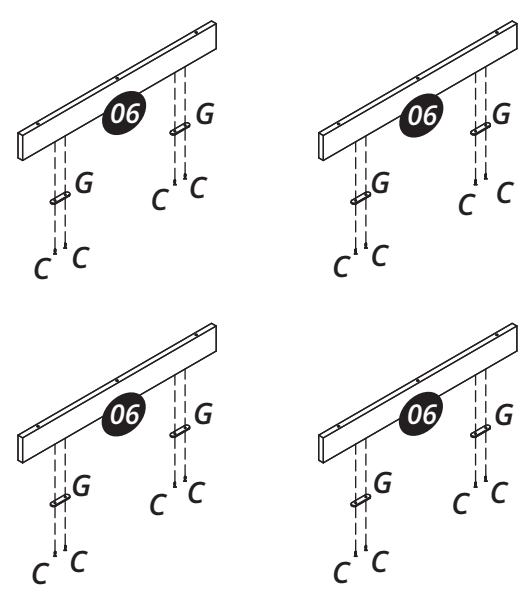

Step 02

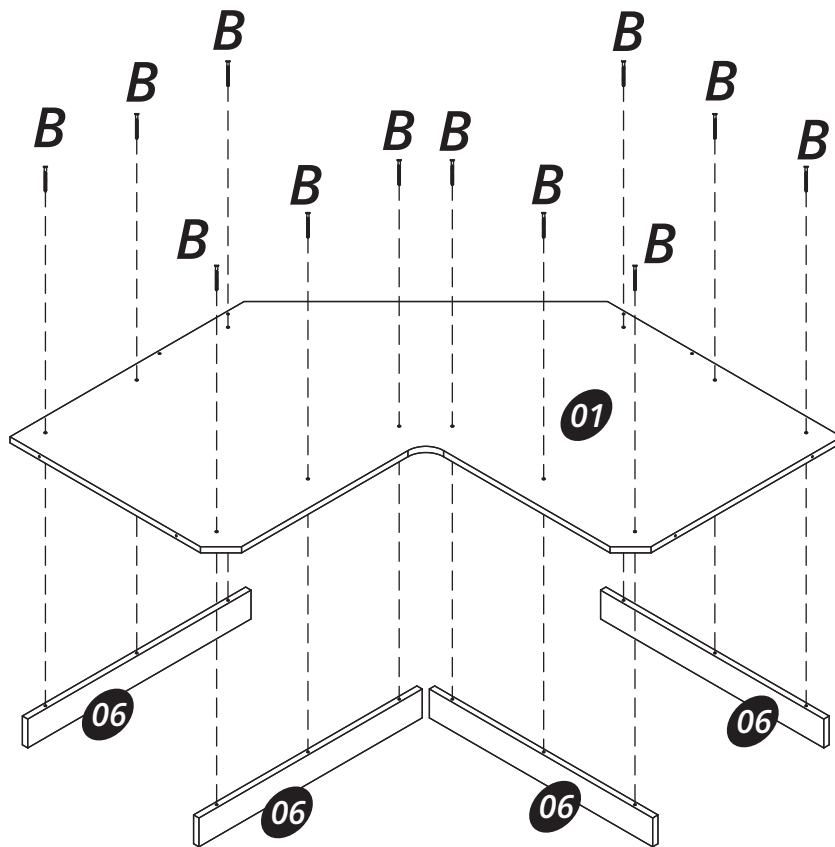

Connect the part (01)
onto the part (06) with
the hardware (B).

Step 03

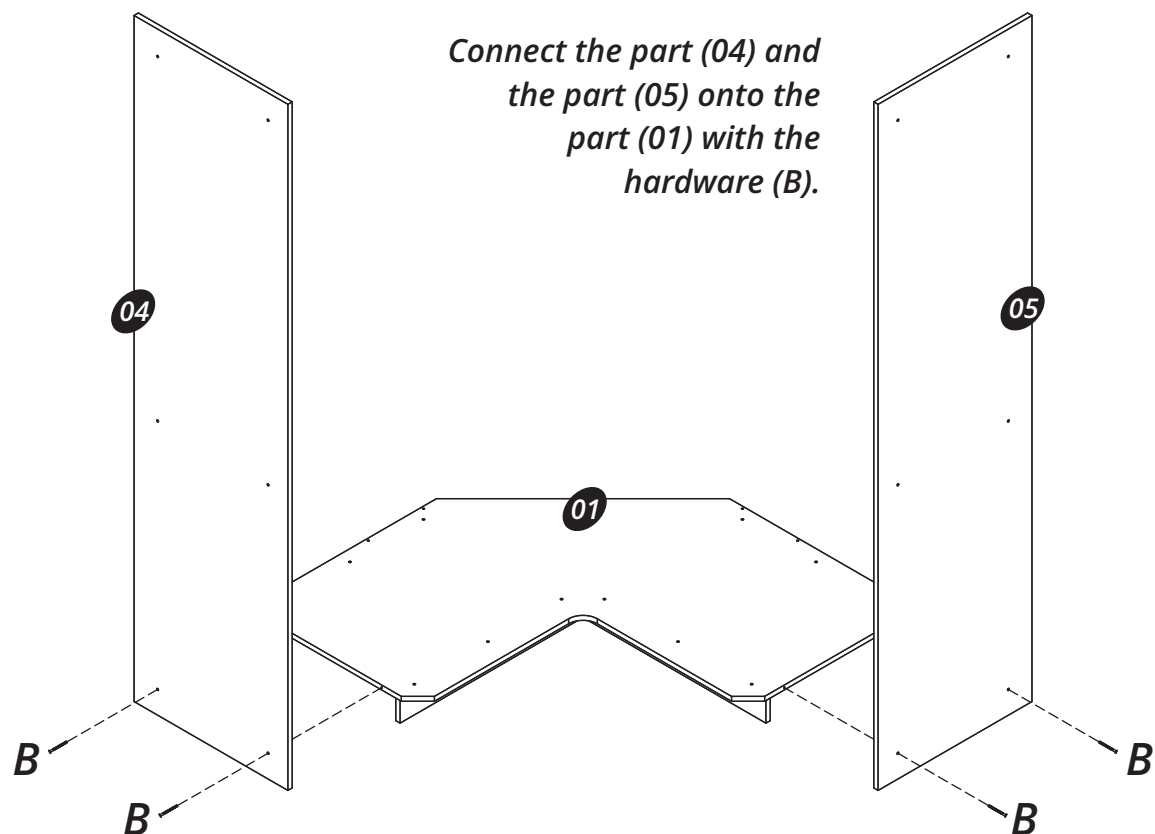

Connect the part (04) and
the part (05) onto the
part (01) with the
hardware (B).

Step 04

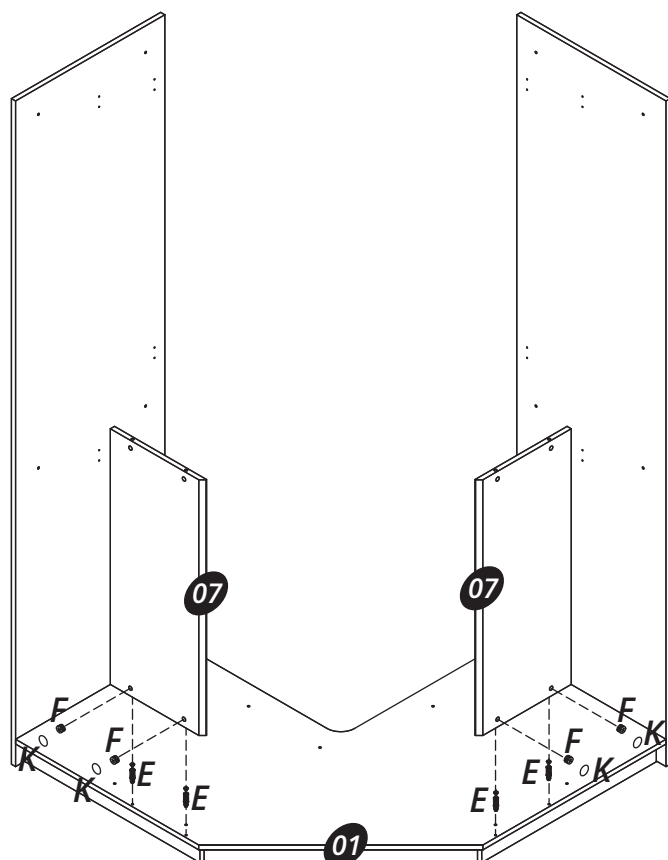

Connect the part (07)
onto the part (01) with
the hardware (E + F)
Apply the hardware (K) on
the hardware (F).

Pay attention to the correct
position of the edges
of the parts (07).

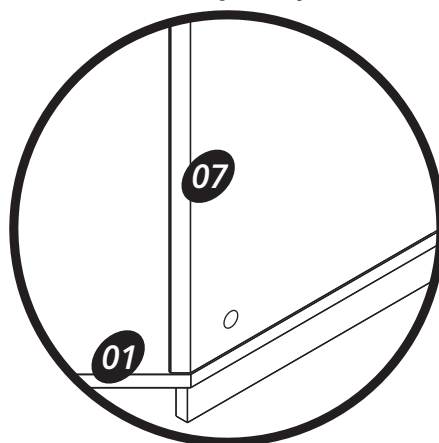

Step 05

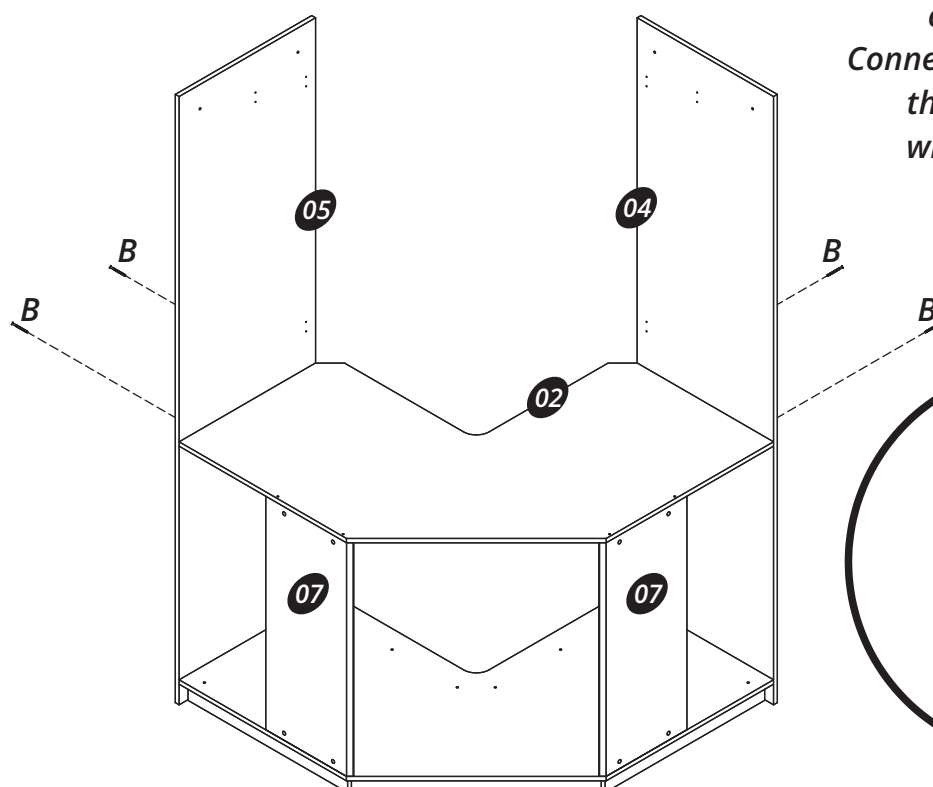

Connect the part (07) onto the part (02) with
the hardware (E + F). Apply the hardware (K)
on the hardware (F).
Connect the part (02) onto
the parts (04) and (05)
with the hardware (B).

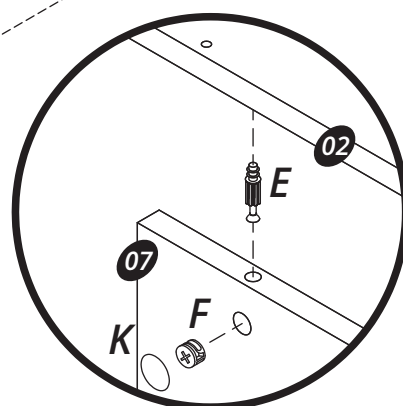

Step 06

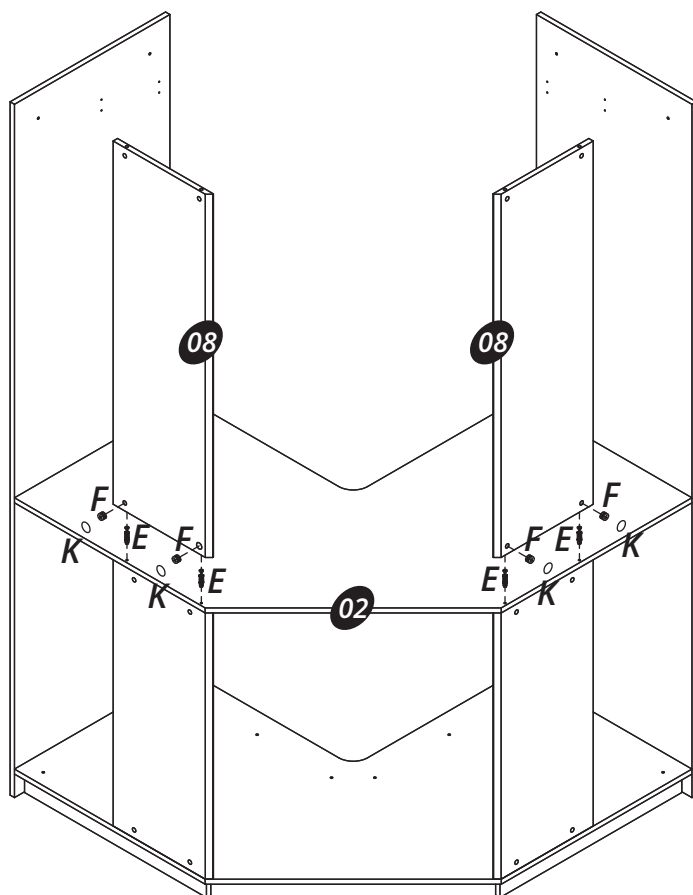

Connect the part (08) onto the part (02) with the hardware (E + F).
Apply the hardware (K) on the hardware (F).

Pay attention to the correct position of the edges of the parts (08).

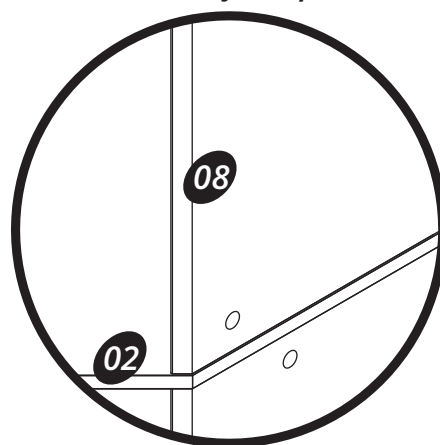

Step 07

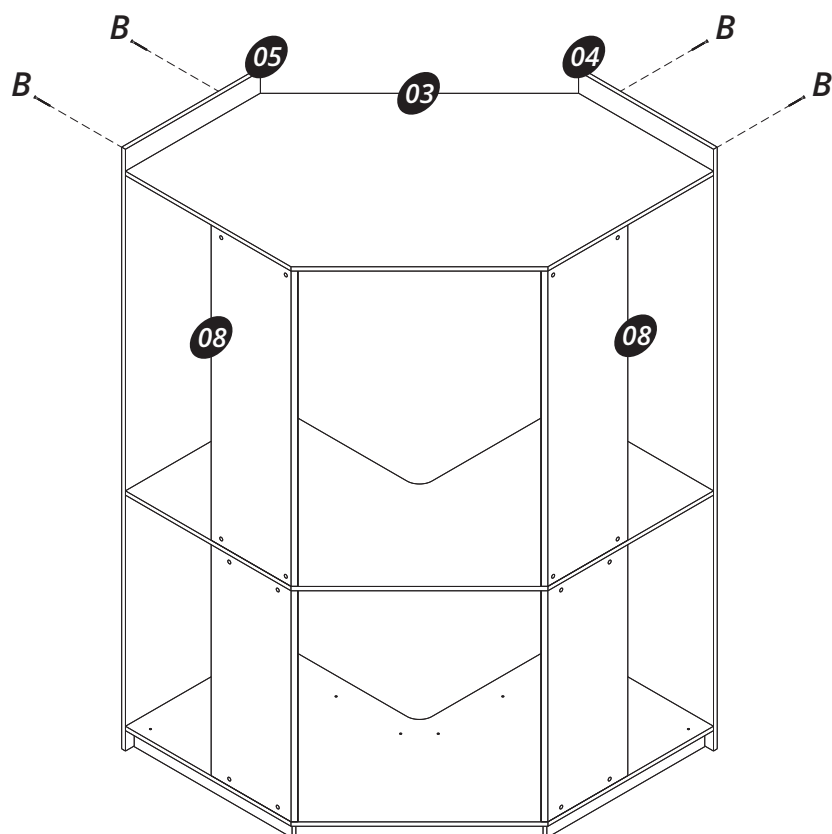

Connect the part (08) onto the part (03) with hardware (E + F). Apply the hardware (K) on the hardware (F).
Connect the part (03) onto the parts (04) and (05) with the hardware (B).

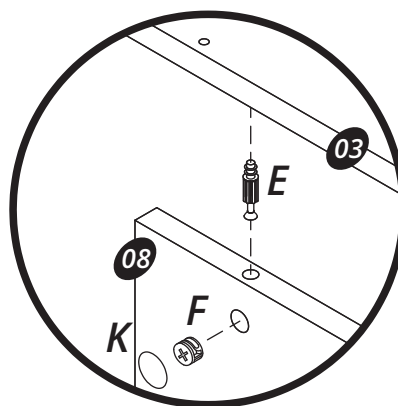

Step 08

Connect the part (09)
with the hardware (H).

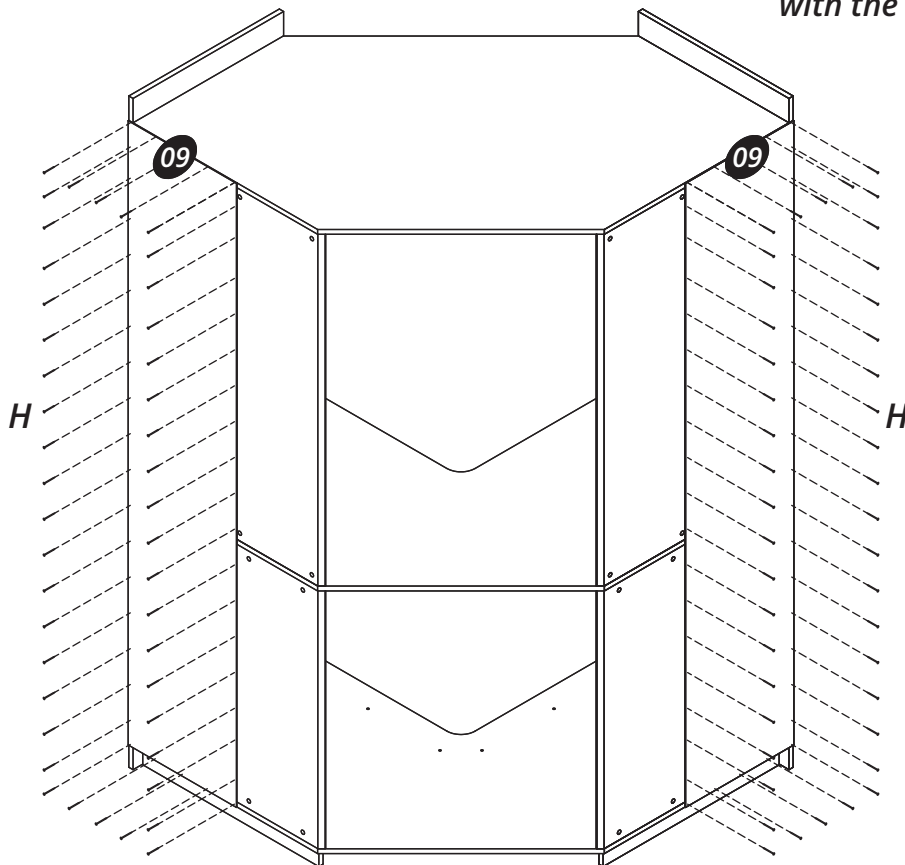

Step 09

Connect the part (10)
with the part (11)
and the hardware (H).

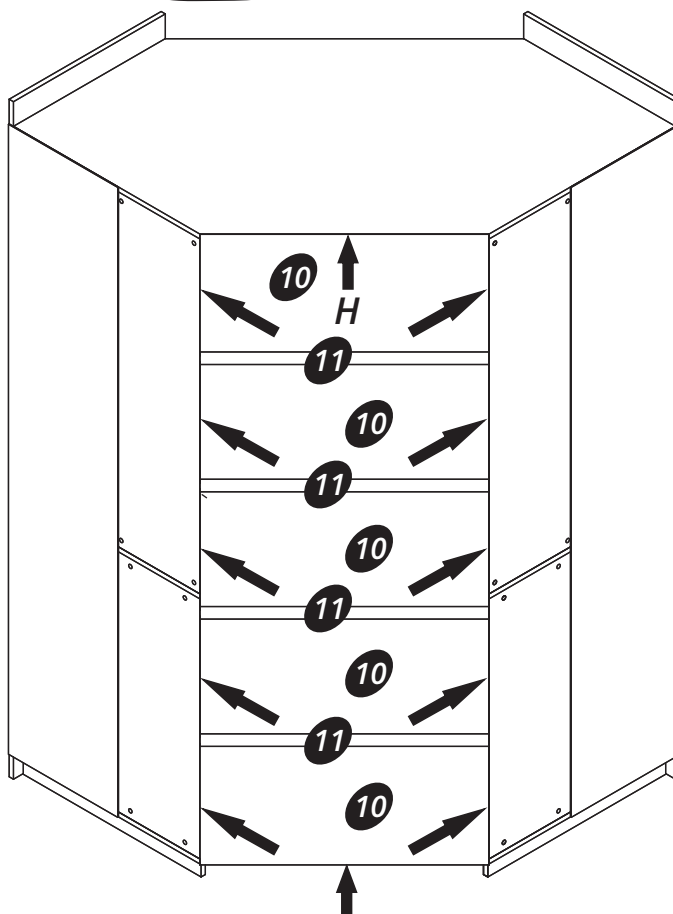

Step 10

Fix the hardware (I) onto the part (04) and the part (05) with the hardware (C).
Remember to fix the hardware (C) only in the hole like in the figure.

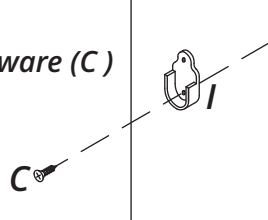

04

05

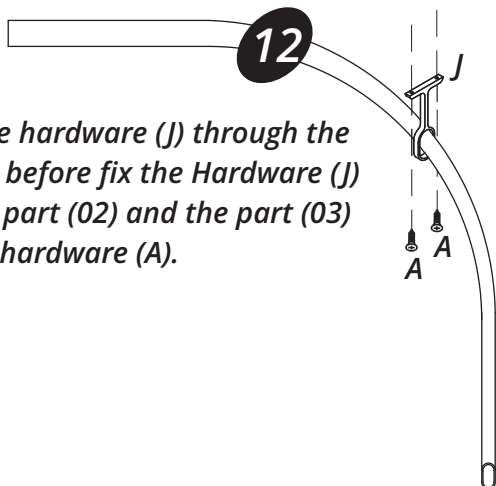

Insert the hardware (J) through the part (12) before fix the Hardware (J) onto the part (02) and the part (03) with the hardware (A).

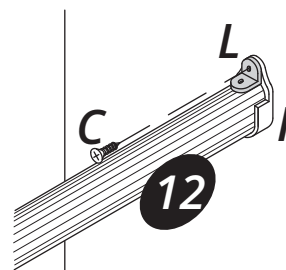

Fix the hardware (L) onto the hardware (I) with the hardware (C) after install the part (12).

Step 11

If you assembly the Mulberry Corner Wardrobe with the Mulberry Side Wardrobe you must have to fit them with screws (D).

