

ELECRTC SEWING MACHINE OPERATION MANUAL



Please read this operation manual carefully before using the sewing machine
This sewing machine is for Household Use only.



The address of operation video:
<https://youtu.be/MzFiayzqLLs>

⚠ WARNING

Safety Information

- ⊘ Never open the main motor case of the machine. The mechanism has been factory adjusted.
- ⊘ Do not pull on fabric as you sew Gently guide only. Pulling could break the needle and result in damage to the machine.
- ⊘ Do not sew clothing while it is on your body
- ⚠ Always check the threading of the lockstitch before beginning to sew a seam. Improper threading or placement of the bobbin in the case will result in damage to the machine.
- ⚠ Use only the power adapter recommended (Sold Separately) by the manufacturer, any other adaptor may cause injury or damage to the machine.
- ⊘ Always disconnect or remove power supply (including batteries) when changing needles or threading machines.
- ⊘ Never leave the sewing machine unattended while plugged in. Turn switch off and unplug the cord when not in use.
- ⊘ Remove batteries when the machine is not in use for long periods. This saves battery life and protects the machine. Keep extra batteries on hand so projects will not be interrupted when batteries need to be replaced.
- ⊘ Do not submerge the unit or any other parts in water.
- ⊘ Do not operate the sewing machine with wet hands, without shoes, or while standing in water or on a wet surface when using the adaptor.
- ⊘ Do not unplug by pulling or tugging on the cord. Grasp the plug with dry hands to remove the plug from the outlet.
- ⊘ Do not change needles or thread machine while unit is on. Do not touch needles before you turn off the power.
- ⊘ Children must be accompanied and directed by parents or adults to use this sewing machine.
- ⊘ Keep the power cord away from heated surfaces.
- ⚠ Do not close door on cord or pull around sharp edges, this could cause the cord to become punctured or damaged and could result in injury

CHECK: After the hook plate is locked, turn anticlockwise the hand wheel, when the tip of hook looks close to the needle eye, the tip of hook should be at the position of 1.5-2mm above the needle eye, if so, congratulations, you have successfully adjusted the hook line action to a standard situation. Finally, please check the distance between the needle eye and tip of hook again. If no other problem, the machine can draw up the bottom thread and work normally.

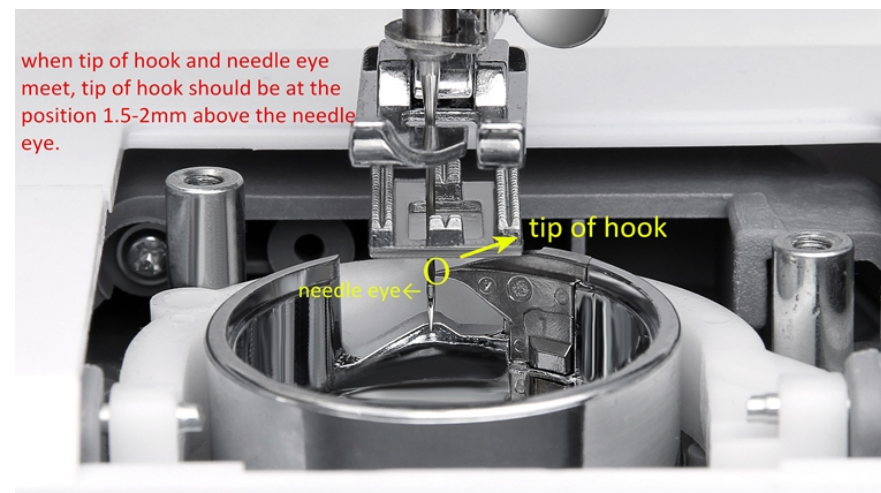

Step Four: After adjusting to the right position of the tip of hook and the needle eye, insert a screwdriver into the hexagon screw holder, hold the hook plate with your right hand, and turn the screwdriver clockwise to tighten.



Tighten the hexagon screw

Hold the hook plate

What can we do with this machine.



Product Feature	
Size	11*4.72*10.6inches
Weight	4.3 lb
Main material	ABS+metal
Stitch	12 kinds of stitches
Power	7.2W
Maximum sewing speed	330spm
Maximum speed thickness	2.5mm, 5 layers summer jeans
Input	100-240V~50/60Hz
Output	DC 6V 1200mA /4AA batteries



Step Three: Insert a screwdriver into the hexagon screw holder, turn the screwdriver counterclockwise about one round to loose the screw(the best tightness is the hook plate can be derived when turn the hand wheel). Hold the hook plate with your left hand, and then turn the hand wheel with your right hand to adjust the tip of hook at the position 1.5-2mm above the needle eye.



Poor bottom thread	Upper thread is seized up	Raise Bobbin Pressing(U) ,make it flexible and make thread smooth.
	Upper thread is too tight/bottom thread is too loose	Adjust the Upper Thread Tension Dial (B) (Bigger number, tighter of the upper thread, refer to Page.12).
	Needle is bent	Change new needle
Machine stop when using, and cannot turn the handwheel(K)	Bottom bobbin is seized up	Raise Presser Foot Lifter(R), take away fabric, open Transparent Cover(H), Cut the voluble thread, replace a new bobbin.

Repair Step

Step One: Please choose stitch 12, then loosen the screw on the purple cover plate and take out the cover plate

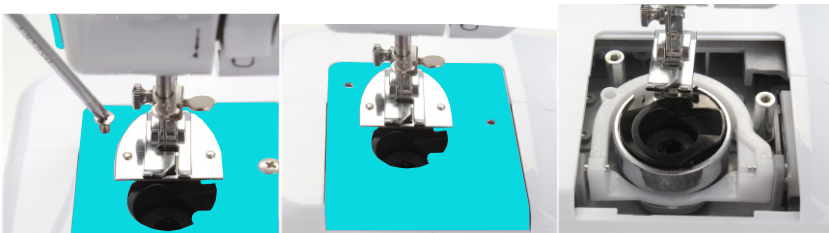

Step Two: Take out the hole plug on the back shell of the machine. Then turn the hand wheel to find the hexagon screw inside the hole

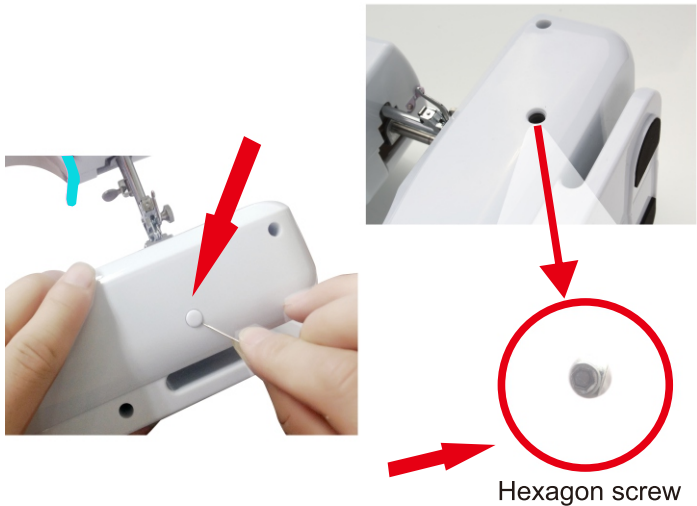

Parts & Accessories

MAIN UNIT

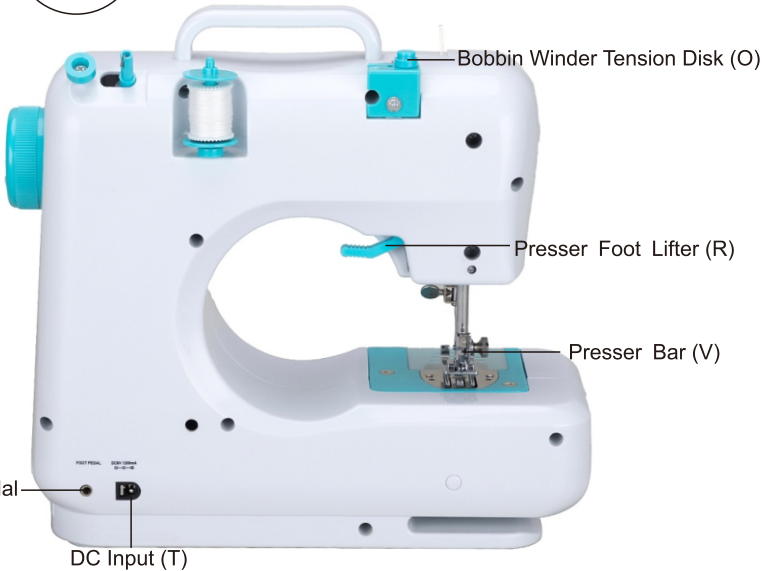

Additional Accessories

Needle(#14×2,#11×1,#9×1) × 4 Needle No. 14 applies to plain denim, plain cloth. Needle No. 11 applies relatively thin cloth. Needle No. 9 applies to satin cloth.	
Needle Threader × 1	
Metal Bobbin × 2	
Spool × 2	
Buttonhole Presser × 1	
Foot Pedal × 1	

Main Function

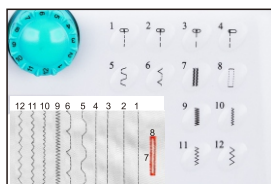

Built-in 12 stitches



Double Thread design, upper thread and bottom thread ensure solid seams

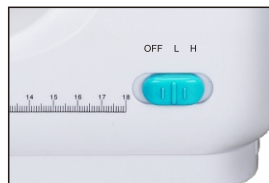

Two-speed modes: High & Low and mode OFF



Operated with either foot pedal or the ON/OFF mode

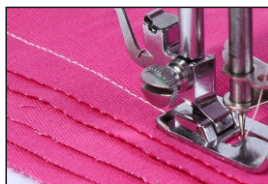

Can sew 5-layers summer jeans



Little drawer, easier storage

Trouble shooting guide

Problem	Cause	Amendment
No power/ runs slowly	Batteries are installed incorrectly	Reinstall the batteries in correct way
	Batteries had run out	Replace new batteries
	Old and new batteries mixed use	Replace new batteries
	Poor adaptor and socket contact	Re-plug the adaptor
Thread jumping	Fabric is uneven	Use even fabric
	The fabric is too slippery/thin	Add a newspaper or A4 paper above and under the cloth, tear off them after sewing
	Needle eye is not in the middle	Replace new needle
	The thread is too thick	Use the proper thread
	Misalignment between the needle and hook tip	Check the position between needle and hook tip, and adjust accordingly, refer to Page.15-18
	Needle is bent/installed incorrectly	Replace/Re-install new needle
	Presser Foot(G) is loose	tighten presser foot screw
Bottom thread cannot be drawn up	Needle/thread is in incorrect way	Thread in correct way, refer to Page.8
	Bottom bobbin runs out	Replace new bottom bobbin, refer to Page.7
	Misalignment between the needle and hook tip	Check the position between needle and hook tip, and adjust accordingly, refer to Page.15-18
Thread keeps breaking	Thread in incorrect way	Re-thread in correct way, refer to Page.8
	Thread of bottom bobbin is jammed	Re-thread in correct way, refer to Page.8
	Thread is uneven loaded	Wind the thread around the metal thread spool and use it as open-wire thread
	Needle is bent	Replace new needle, refer to Page.7
	Needle encounters hook tip	Replace needle, if still encounter, please refer to Page.15-18
	Burr around the needle eye	Replace new needle
	Needle is installed incorrectly, position of needle and chassis is incorrectly	Reinstall the needle
	Burr on the thread presser sheet, thread-guiding spring, thread pulling rod and transfer-interface points	Polish with fine sandpaper to make it smooth
	Needle and sewing thread are inappropriate for the fabric	Choose proper needle and thread
		• Thin fabric(Silk, linen, muslin, chiffon, organzine, taffeta, etc) No.9-11 needle, No. 60-80 cotton thread, silk thread.
		• Regular fabric(jeans, wollen, cotton cloth, velure, etc) No.14 needle, No.50-60 cotton thread.
		• Thick fabric(thick cloth, thick denim, corduroy, canvas, etc) No.16/18 needle, No.30-50 cotton thread.

Applicable fabric for sewing

Sewing Presentation Fabric Specification	Fabric			
	Cotton/Linen	Silk/Wool	Polyster	Elastic
Regular	✓	✗	✓	△
Thick	✓	✗	✓	△
Thin	✓	✗	✗	✗
Hard	✓	✓	✓	△
Soft	✗	✗	✗	✗

Sewing effective:

- ✓ : means easy to sew
- △ : means not smooth to sew
- ✗ : means difficult to sew

NOTE:

1. The definition of the fabric thickness:

Thin(fabric) : two layers of the fabric thickness<0.35mm,
Thick(fabric) : two layers of the fabric thickness>0.8mm;
Regular(fabric) : two layers of the fabric thickness≥0.35mm and ≤0.8mm.

2. The definition of elastic cloth :

If the cloth, which size is "100mm x 30mm", is extending to or over 106mm under 1.1 lbs' tension force, then the cloth is defined elastically, otherwise there is no elasticity.

3. Hard fabric : such as jeans,fine canvas,etc.

4. Soft fabric : such as towel,duster,etc.

5. When sew thin fabrics, please use No.9 or No.11 needles. If it can't sew well, you can use two papers to clamp the fabric or put a paper under the fabric to sew.

6. The maximum sewing thickness is about 2.5mm, not suitable for over-thick fabric.

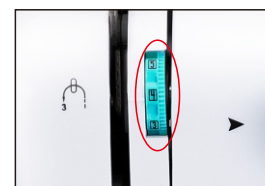

Upper thread tension dial can be used to adjust the tightness of the thread



Reverse stitching can be more convenient for sewing(can be only used with straight stitch #1, #2, #3 and #4)



Anti-Slip
Prevent the machine from falling down



Two power supply-Battery or Power Cord
(Not available at the same time!!!)

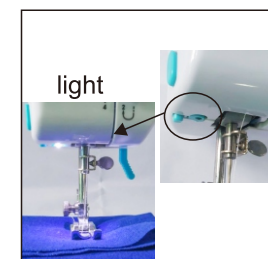

Built-in work light, can see it clear in bad light

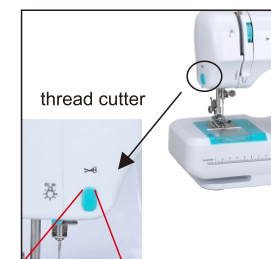

Built-in thread cutter, no need to find scissors



Automatic winding function, thread can be wound automatically on it that has run out



The sleeve sewing design can make it more convenient to sew the sleeves



Button holes can be sewn with our extra free buttonhole presser

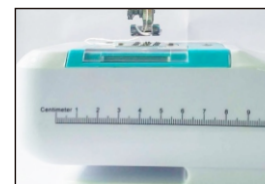

The machine with its own scale allows you to know the size more easily when sewing

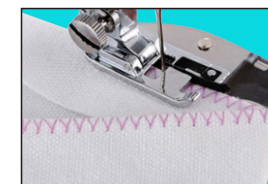

The #9, #10, #11 and #12 stitch can be used to the overlock

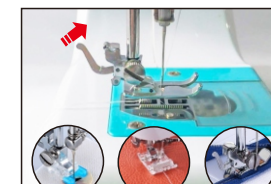

Changeable presser foot, reach your different sewing needs

Getting Start to Sew

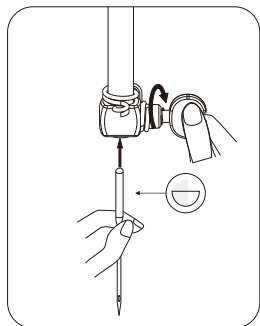

Install needle

The flat surface of needle shall be toward Presser Bar (V), and needle should be installed to the end.



Install top bobbin

Take out the Bobbin Pressing(U), then insert the top bobbin.

Install bottom bobbin

Open the Transparent Cover(H), put the bottom bobbin inside the bobbin holder.

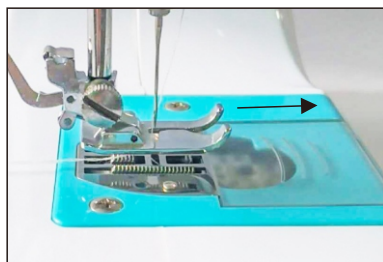

NOTE : The thread is already complete. Please check whether the thread is correct according to page 8 of the instruction. If there is any error, please re-thread according to the instruction.

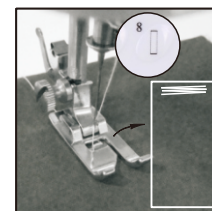

Fig.1

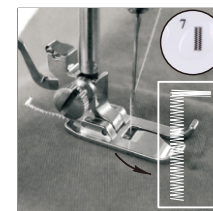

Fig.2

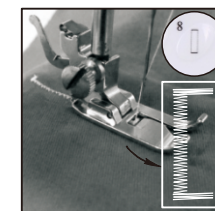

Fig.3

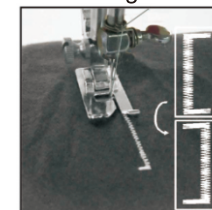

Fig.4

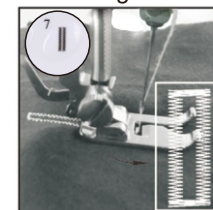

Fig.5

Adjusting stitching

1. As shown in the picture(Fig.A)normal stitching shall be neat with top and bottom threading neither too tight nor to loose.

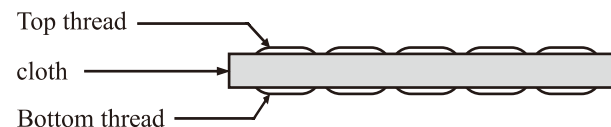

Fig.A

2. If the bottom threading looks like a straight line, which indicates the top thread is too loose, please turn too tight nor too loose clock wise to increase pressure until the stitching returns to normal.(Fig.B)



Fig.B

3. However, when the top thread looks like a straight line indicating an over-tight top thread, slowly turn the upper thread tension dial counterclockwise to reduce pressure until the stitching back to normal.(Fig.C)



Fig.C

Change presser foot

1. Turn Hand Wheel(J) anticlockwise to raise the needle to highest position.

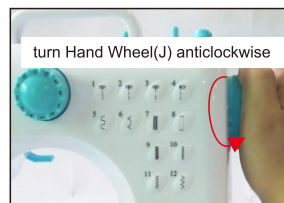

2. Raise the presser foot to press the tightening lever behind the pressure foot (1) to remove the pressure foot.

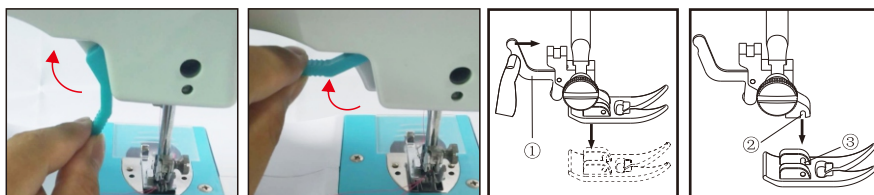

3. Put new presser foot under the presser foot rack, pay attention to the pin (3) on the presser foot to align the slot (2), and then loosen the tightening lever (1) to firmly lock the presser foot.

CAUTION:

1. Please always switch power off, disconnecting the machine from the power adaptor, and remove the foot pedal before replacing the presser foot
2. When replace the presser foot, please place the machine on a stable platform.
3. When you put down the presser, please keep your hand or fingers away from the bottom side of the presser foot to avoid injuring.

Manual Buttonhole

- (1) Put the cloth under the presser foot and lower the presser foot on the cloth where you need to sew buttonhole, then choose the stitch pattern #8.
- (2) Turn on the switch and sew 5-6 stitch in low speed, then turn off the switch (Fig.1)
- (3) Choose the stitch pattern #7, turn on switch and sew on the cloth in suitable length, then turn off switch. Note that try to keep sewed stitch in straight line (Fig.2)
- (4) Choose the stitch pattern #8, then turn on switch and sew 5-6 stitch in low speed. then turn off switch (Fig.3)
- (5) Raise the presser foot, rotating the cloth for 180° (Fig.4)
- (6) Choose the stitch pattern #7, then turn on switch and sew till buttonhole is fully sewed. (Fig.5)

Thread in correct way

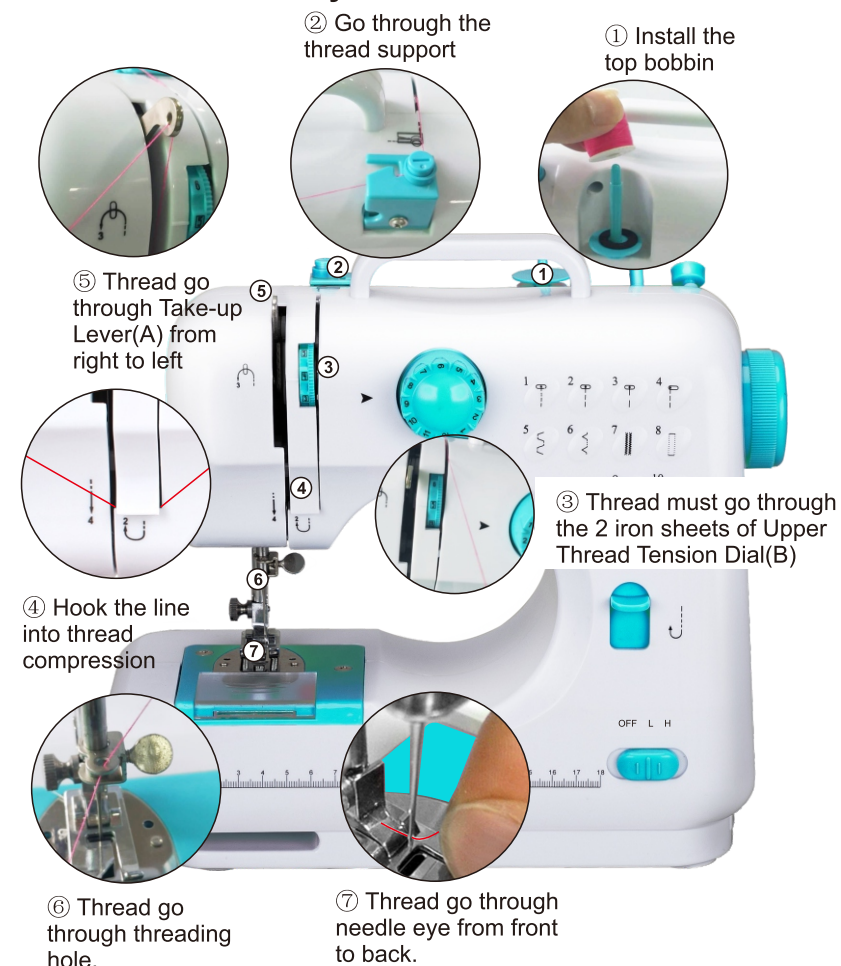

CAUTION:

It's very **IMPORTANT** to thread in a correct way. If not, it will lead to problems of thread seized up, thread in a group, bottom thread cannot be drawn up, etc.

How to sew

- 1.Take away Transparent Cover(H).
(Fig. a)

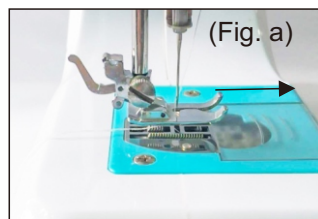

- 2.Pull the bottom thread out about 10cm,
hold the upper thread which go
through needle eye by hand (Fig. b).

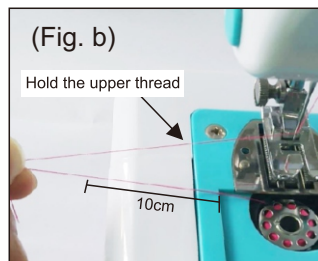

- 3.Turn Hand Wheel(J) anticlockwise
then draw up the bottom thread (Fig. c).

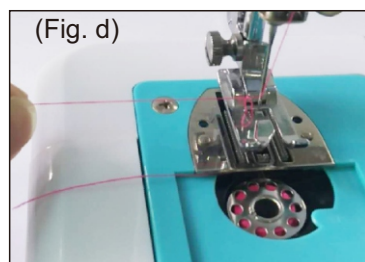

- 4.Raise Presser Foot Lifter(R)
top thread and bottom thread
should be under the presser foot,
pull both thread out of 10cm.
Install Transparent Cover(H) (Fig. e).

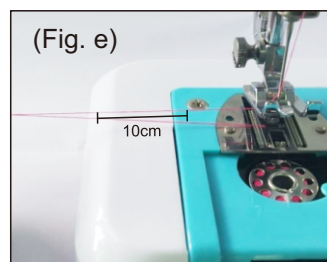

- 5.Put fabric under the presser foot, sew
several pins by turning Hand Wheel(J)
anticlockwise, if it can be turned smoothly,
then you can start to sew (Fig. f).

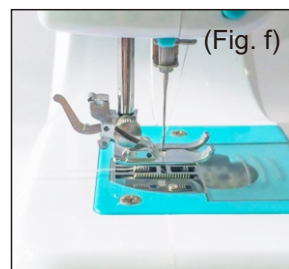

How to use foot pedal

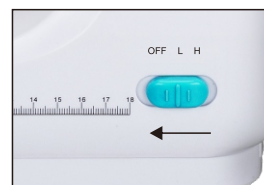

Stop sewing and turn the speed switch(M)
to OFF position.

Plug in the power cord of the pedal, control
the foot pedal by foot, so that you can release
your hands from sewing (Please kindly note
that you can't use foot pedal and the
automatic switch at the same time, you can
only choose one sewing way at a time!!!).



Bobbin Winding

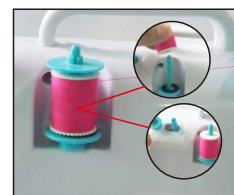

Fig.A

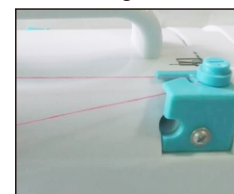

Fig.B

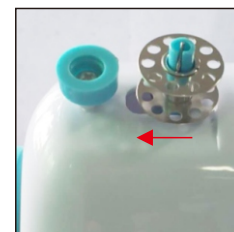

Fig.C

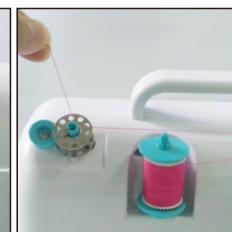

Fig.D

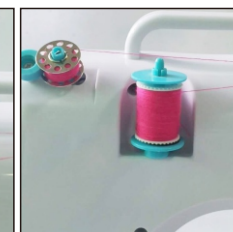

Fig.E

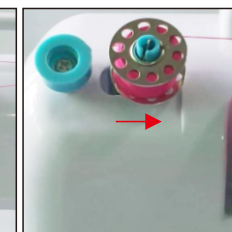

Fig.F

- 1.Put a spool on spool pin.(Fig.A)
- 2.Guide the thread through the bobbin winder
tension disk on the upper side of the machine.(Fig.B)
- 3.Put the bobbin on the bobbin winder pin, wind
thread clockwise around bobbin several times.(Fig.C)
- 4.Push bobbin to the left.(Fig.D)
- 5.Switch on the machine to start winding(Fig.E)
- 6.Turn off the machine after you get the thread you want.
- 7.Push bobbin away when bobbin winder stop, take
bobbin off the pin and cut the thread.(Fig.F)

NOTE : Please make sure you have removed the
bottom bobbin and thread in the needle before
winding the bobbin.