

Assembly Manual

Modular Sofa

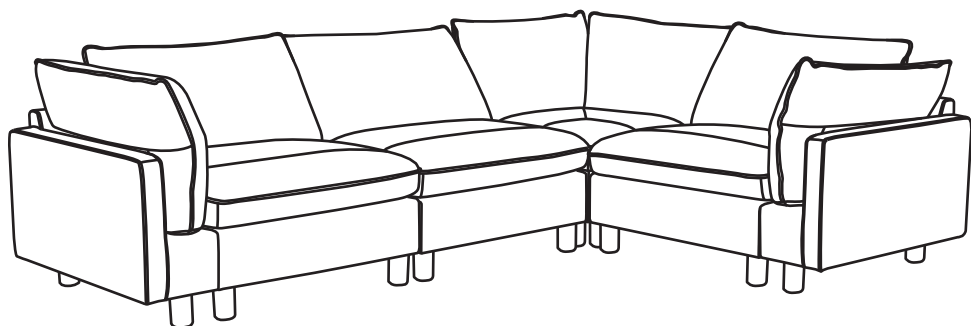

Thank you for purchasing. Please read this manual carefully before using and keep this manual for future reference.

The design and /or specification of this product is subject to change without notice.

If you are reading these instructions, the hard part is already out of the way. Surrounded by all these boxes, you may feel a little overwhelmed. No worries, we will walk you through and you will find the assembly process easy, intuitive and mostly, fun. Here are some tips before you get started.

- 1.**Count the boxes. Check if you have received all boxes using the diagram on next page. Do not start the assembly process until all boxes are present. If you have not received all boxes or received wrong boxes, please contact our customer service at info@brendon.com and we will get back to you. Do not discard any of the packaging until you are certain that you have all the necessary parts for the assembly.
- 2.**Do not open all boxes at once. Start with Arms Box and Left Chair Seat & Backrest Box to assemble the Left Armchair. Then, move on to open the Right Chair Seat & Backrest Box to assemble the Right Armchair. Next, assemble the Armless Chair, Corner, and finally, the Ottoman.
- 3.**After the assembly is complete, feel free to enjoy your Brendon Collection as much as you can. However, please ensure that the packaging is disposed of in a safe and environmentally responsible way.
- 4.**For your safety (as well as Brendon's), do not sit on the backrest during and after assembly and never use this sofa as a step ladder.

! Do not start the assembly process until all boxes are present.

2-piece Armless

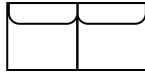

2-piece Sofa

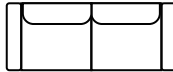

3-piece Sofa

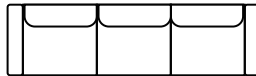

4-piece Modular

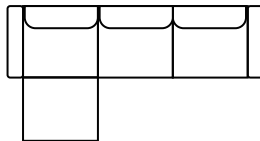

5-piece Corner Modular

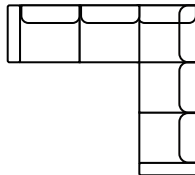

6-piece Modular

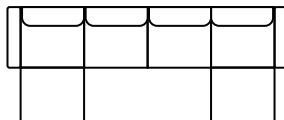

Assembly Manual

Left Armchair



Parts

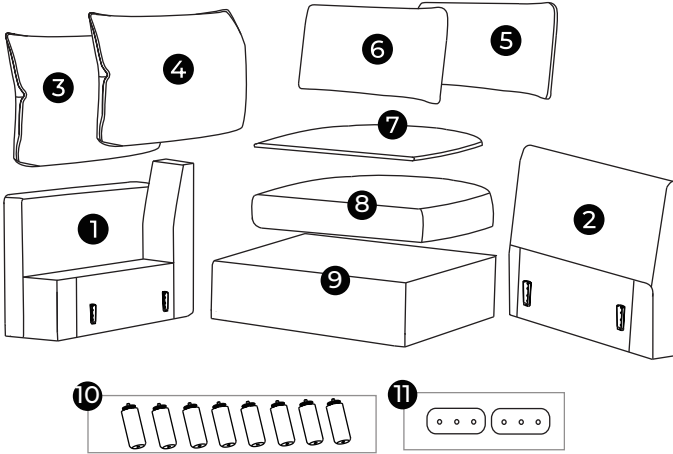

- ❶ Left Arm
- ❷ Left Backrest
- ❸ Left Arm Cushion Core
- ❹ Left Arm Cushion Case
- ❺ Back Cushion Core
- ❻ Back Cushion Case
- ❼ Seat Cushion Case
- ❽ Seat Cushion Core
- ❾ Left Seat Base
- ❿ Leg x 8
- ⓫ Connector x 2

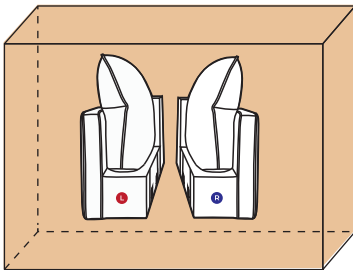

Note: Left & Right Arms are packed together in Arms Box.



Arms PIECES INCLUDED

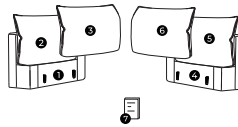

- ❶ Left Arm x 1
- ❷ Left Arm Cushion Core x 1
- ❸ Left Arm Cushion Case x 1
- ❹ Right Arm x 1
- ❺ Right Arm Cushion Core x 1
- ❻ Right Arm Cushion Case x 1
- ⓫ Assembly Manual x 1

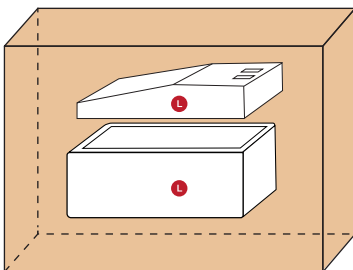

Left Chair Seat & Backrest PIECES INCLUDED

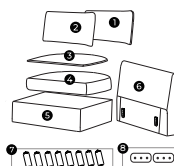

- ❺ Back Cushion Core x 1
- ❻ Back Cushion Case x 1
- ❼ Seat Cushion Case x 1
- ❽ Seat Cushion Core x 1
- ❾ Left Seat Base x 1
- ❷ Left Backrest x 1
- ❿ Leg x 8
- ⓫ Connector x 2

Left Armchair

Step 1

Take out the Left Arm, Left Arm Cushion Core from Arms Box.
Take out the Left Arm Cushion Case from the bottom of Left Arm.

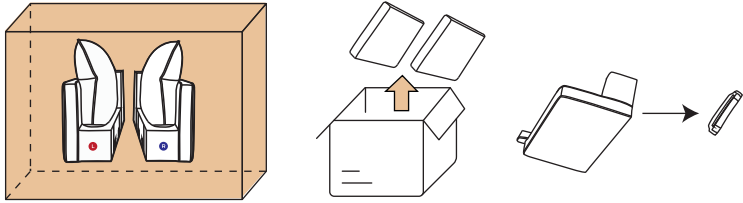

Step 2

Take out the Left Seat Base, Seat Cushion Case, Back Cushion Case and Backrest from Left Chair Seat & Backrest Box.

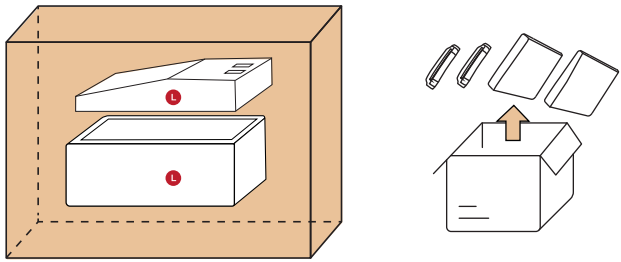

Step 3

Remove the three wood sticks at the base of the seat to take out the hardware pack, vacuum-packed Seat Cushion Core and Back Cushion Core, then open these bags.

⚠ Remove the sticks one by one. Push the stick down and rotate it towards the corner of the base and pull it out. Do NOT use sharp tools such as knives or scissors to open bags as it could potentially damage the cushions. Please use your hands to gently pull the bags apart. Please allow up to 48 hours for the cushions to return to the original thickness.

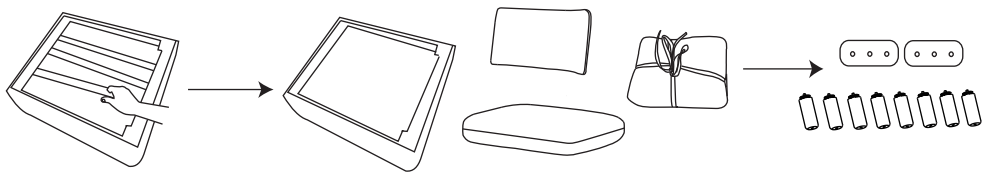

Left Armchair

Step 4

Rotate the Legs firmly.

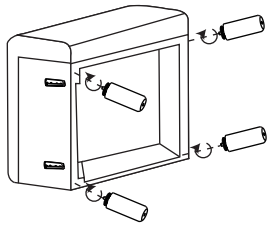

Left Seat

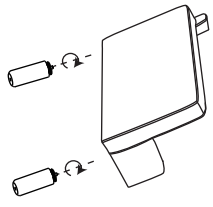

Left Arm

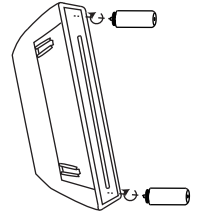

Left Backrest

Step 5

Slide the Left Backrest into the Left Seat.

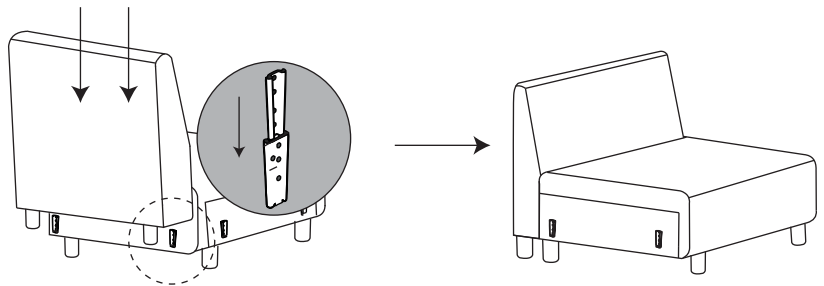

Step 6

Slide the Left Arm into the Left Seat and Backrest.

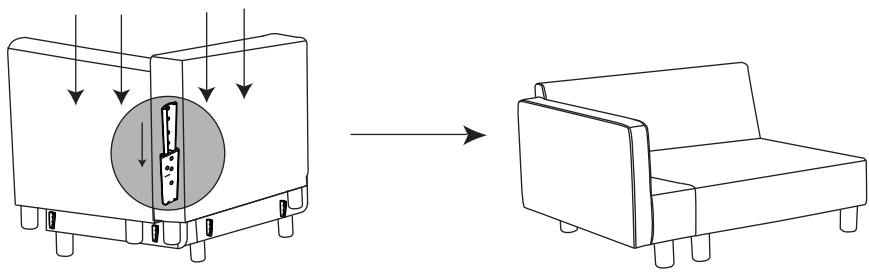

Left Armchair

Step 7

Insert the Left Arm Cushion Core into the Left Arm Cushion Case.
Insert the Seat Cushion Core into the Seat Cushion Case.
Insert the Back Cushion Core into the Back Cushion Case.
Fluff the Left Arm Cushion, Seat Cushion and Back Cushion, and put them on the Seat Base to complete the assembly of your Left Armchair.

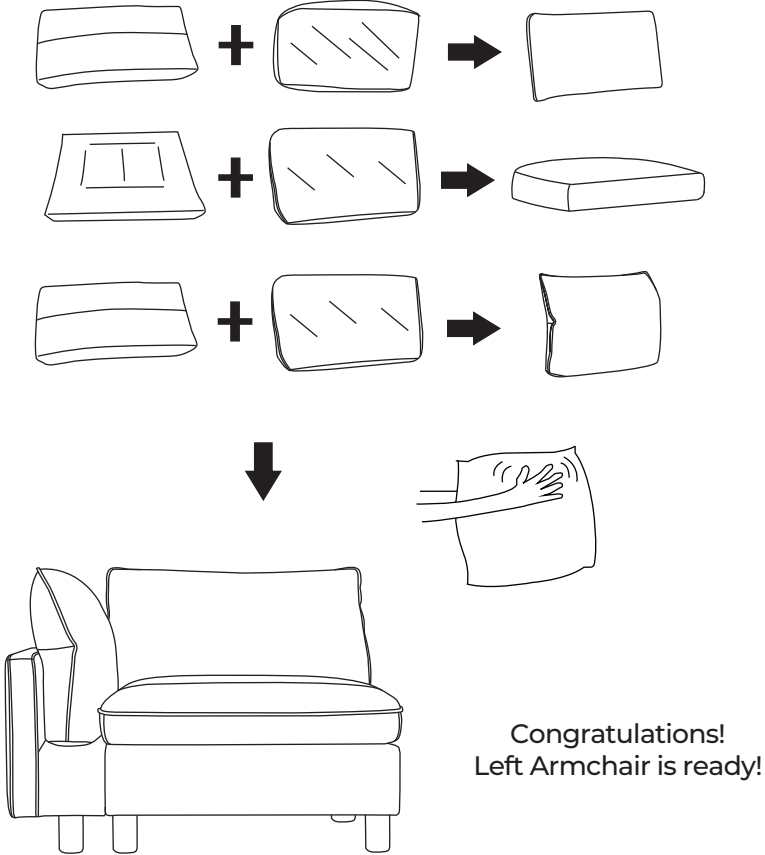

Tips

For now, please keep the Metal Connectors aside and you may need them after you have completed the assembly of all modules (See Page 21 for details).

Right Armchair



Parts

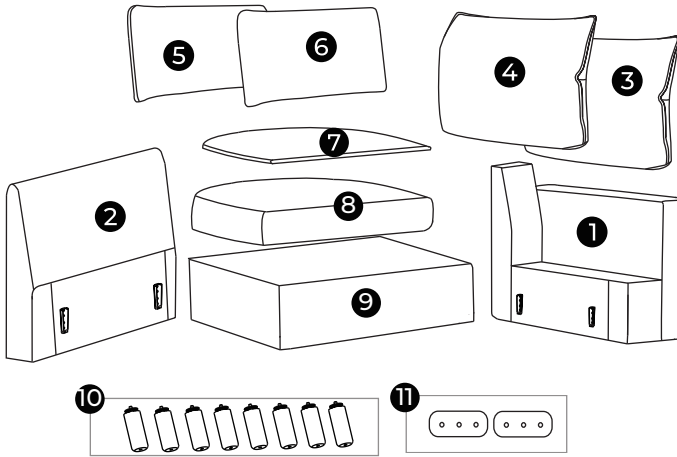

- ❶ Right Arm
- ❷ Right Backrest
- ❸ Right Arm Cushion Core
- ❹ Right Arm Cushion Case
- ❺ Back Cushion Core
- ❻ Back Cushion Case
- ❼ Seat Cushion Case
- ❽ Seat Cushion Core
- ❾ Left Seat Base
- ❿ Leg x 8
- ⓫ Connector x 2

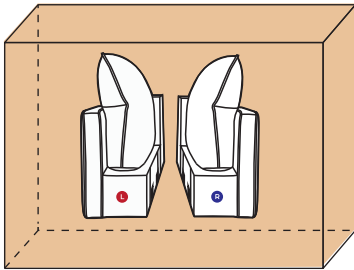

Note: Left & Right Arms are packed together in Arms Box.



Arms PIECES INCLUDED

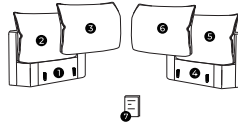

- ❶ Left Arm x 1
- ❷ Left Arm Cushion Core x 1
- ❸ Left Arm Cushion Case x 1
- ❹ Right Arm x 1
- ❺ Right Arm Cushion Core x 1
- ❻ Right Arm Cushion Case x 1
- ❼ Assembly Manual x 1

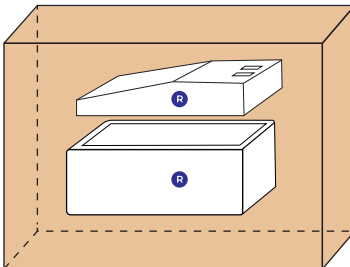

Right Chair Seat & Backrest PIECES INCLUDED

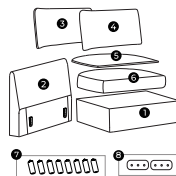

- ❶ Right Seat Base x 1
- ❷ Right Backrest x 1
- ❸ Back Cushion Core x 1
- ❹ Back Cushion Case x 1
- ❺ Seat Cushion Case x 1
- ❻ Seat Cushion Core x 1
- ❼ Leg x 8
- ⓫ Connector x 2

Right Armchair

Step 1

Take out the Right Arm, Right Arm Cushion Core from Arms Box. Take out the Right Arm Cushion Case from the bottom of Right Arm.

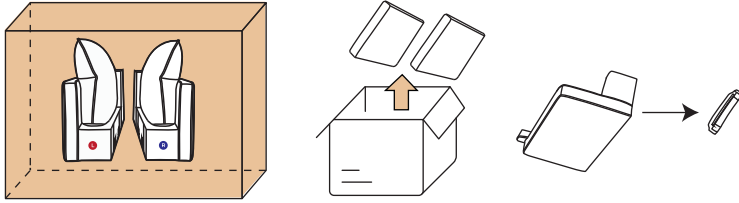

Step 2

Take out the Right Seat Base, Seat Cushion Case, Back Cushion Case and Backrest from Right Chair Seat & Backrest Box.

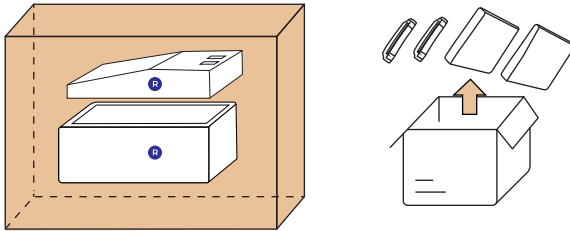

Step 3

Remove the three wood sticks at the base of the seat to take out the hardware pack, vacuum-packed Seat Cushion Core and Back Cushion Core, then open these bags.

⚠ Remove the sticks one by one. Push the stick down and rotate it towards the corner of the base and pull it out. Do NOT use sharp tools such as knives or scissors to open bags as it could potentially damage the cushions. Please use your hands to gently pull the bags apart. Please allow up to 48 hours for the cushions to return to the original thickness.

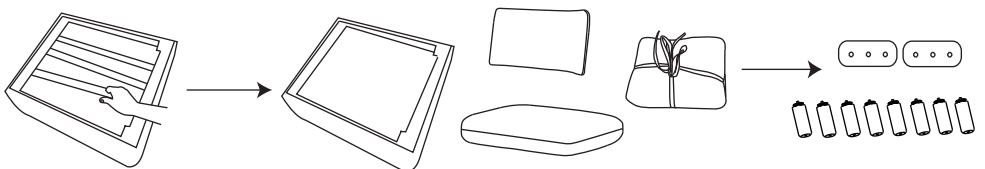

Right Armchair

Step 4

Rotate the Legs firmly.

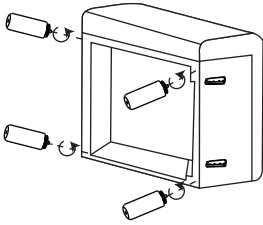

Right Seat

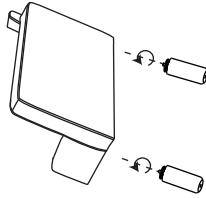

Right Arm

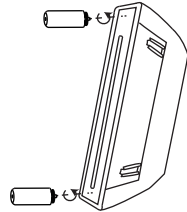

Right Backrest

Step 5

Slide the Right Backrest into Right Seat.

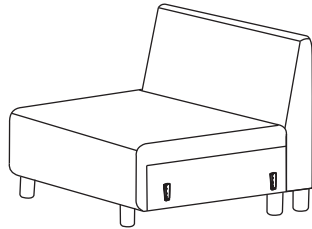
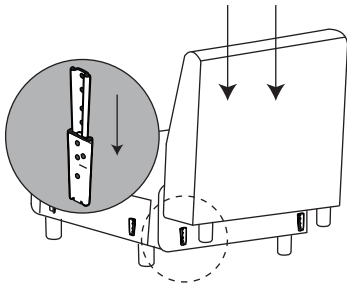

Step 6

Slide the Right Arm into Right Seat and Backrest.

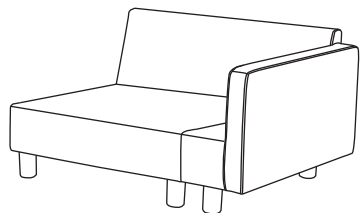
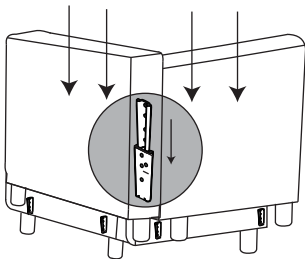

Right Armchair

Step 7

Insert the Right Arm Cushion Core into the Right Arm Cushion Case.

Insert the Seat Cushion Core into the Seat Cushion Case.

Insert the Back Cushion Core into the Back Cushion Case.

Fluff the Right Arm Cushion, Seat Cushion and Back Cushion, and put them on the Seat Base to complete the assembly of your Right Armchair.

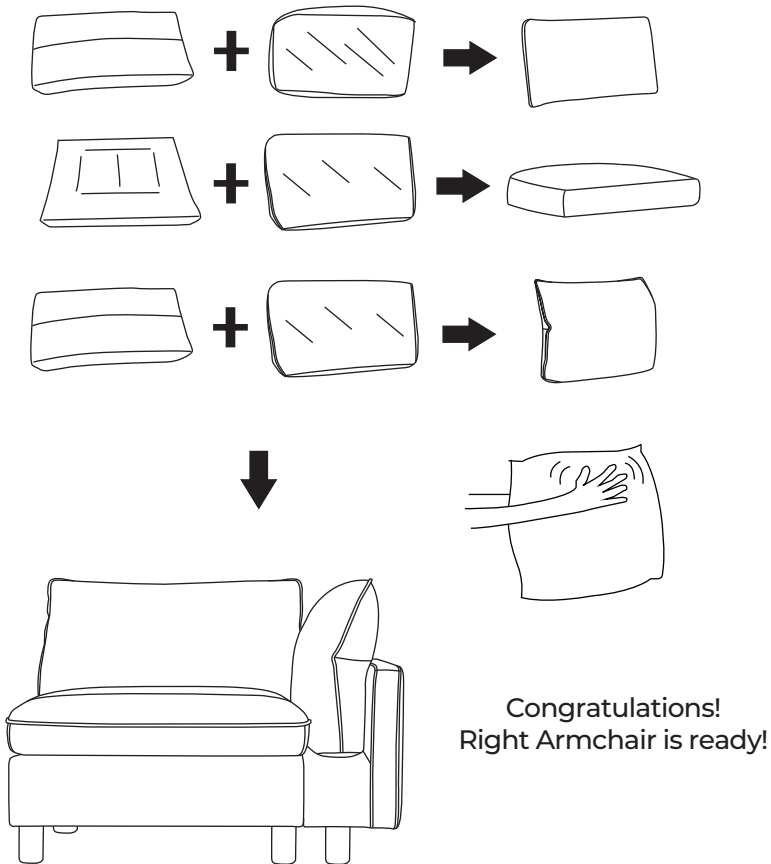

Tips

For now, please keep the Metal Connectors aside and you may need them after you have completed the assembly of all modules (See Page 21 to for details).

Armless Chair



Parts

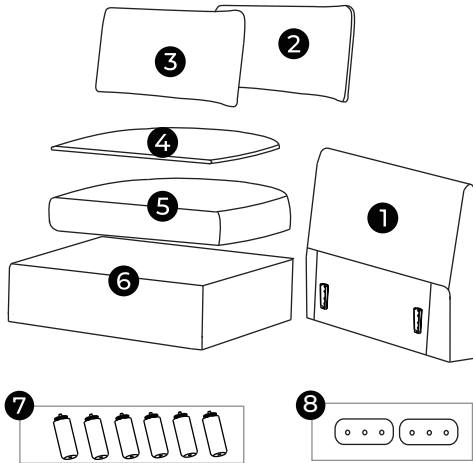

- ❶ Armless Backrest
- ❷ Back Cushion Core
- ❸ Back Cushion Case
- ❹ Seat Cushion Case
- ❺ Seat Cushion Core
- ❻ Armless Seat Base
- ❼ Leg x 6
- ❽ Connector x 2

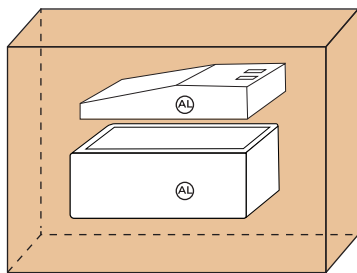

Armless Chair PIECES INCLUDED

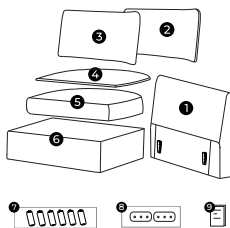

- ❶ Armless Backrest x 1
- ❷ Back Cushion Core x 1
- ❸ Back Cushion Case x 1
- ❹ Seat Cushion Case x 1
- ❺ Seat Cushion Core x 1
- ❻ Armless Seat Base x 1
- ❼ Leg x 6
- ❽ Connector x 2
- ❹ Assembly Manual

Step 1

Take out the Armless Seat Base, Seat Cushion Case, Back Cushion Case and Backrest from Armless Chair Box.

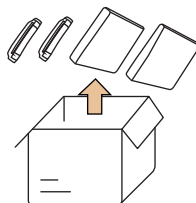
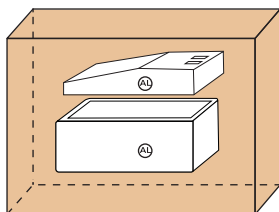

Armless Chair

Step 2

Remove the three wood sticks at the base of the seat to take out the hardware pack, vacuum-packed Seat Cushion Core and Back Cushion Core, then open these bags.

⚠ Remove the sticks one by one. Push the stick down and rotate it towards the corner of the base and pull it out. Do NOT use sharp tools such as knives or scissors to open bags as it could potentially damage the cushions. Please use your hands to gently pull the bags apart. Please allow up to 48 hours for the cushions to return to the original thickness.

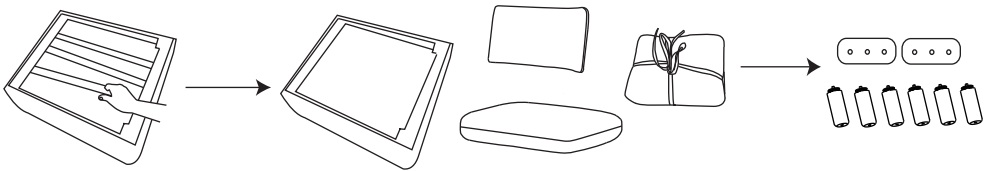

Step 3

Rotate the Legs firmly.

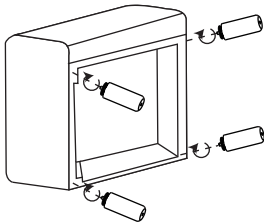

Armless Seat

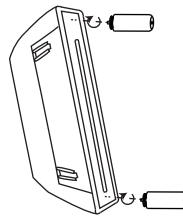

Armless Backrest

Step 4

Slide the Backrest into the Seat.

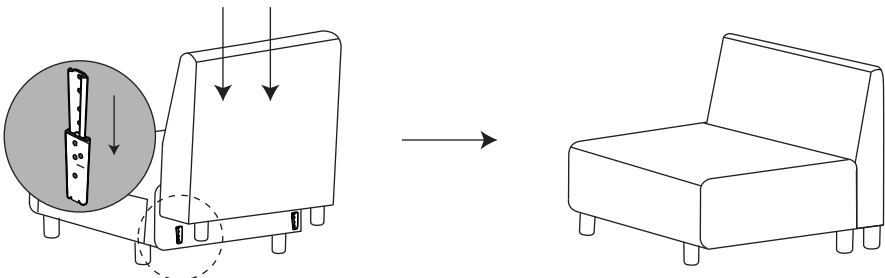

Armless Chair

Step 5

Insert the Seat Cushion Core into the Seat Cushion Case.
Insert the Back Cushion Core into the Back Cushion Case.
Fluff the Seat Cushion and Back Cushion, and put them on the Seat Base to complete the assembly of your Armless Chair.

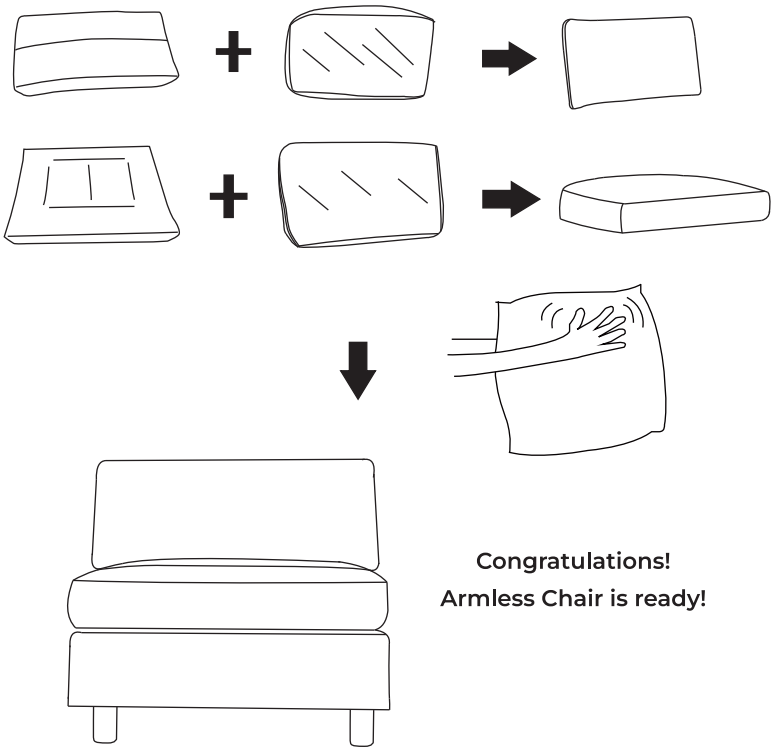

Tips

For now, please keep the Metal Connectors aside and you may need them after you have completed the assembly of all modules (See Page 21 for details).

Corner



Parts

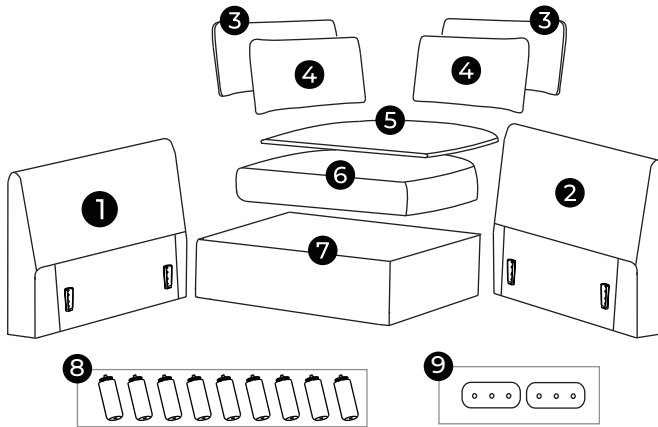

- ❶ Corner Left Back C1
- ❷ Corner Right Back C2
- ❸ Back Cushion Core x 2
- ❹ Back Cushion Case x 2
- ❺ Seat Cushion Case
- ❻ Seat Cushion Core
- ❼ Corner Seat Base
- ❽ Leg x 9
- ❾ Connector x 2

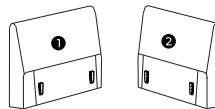
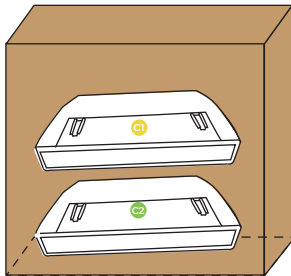

Corner Backs PIECES INCLUDED

- ❶ Corner Left Back C1 x 1
- ❷ Corner Right Back C2 x 1

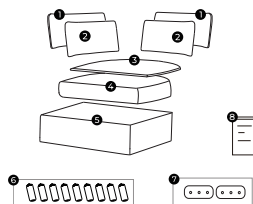
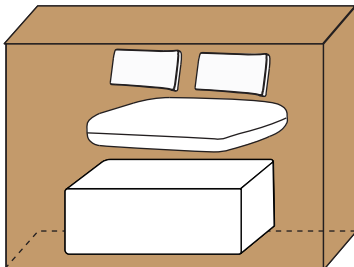

Corner Seat & Cushions PIECES INCLUDED

- ❶ Back Cushion Core x 2
- ❷ Back Cushion Case x 2
- ❸ Seat Cushion Case x 1
- ❹ Seat Cushion Core x 1
- ❺ Corner Seat Base x 1
- ❻ Leg x 9
- ❼ Connector x 2
- ❽ Assembly Manual

Corner

Step 1

Take out the Corner Left Back (C1) and Corner Right Back (C2) from Corner Backs Box.

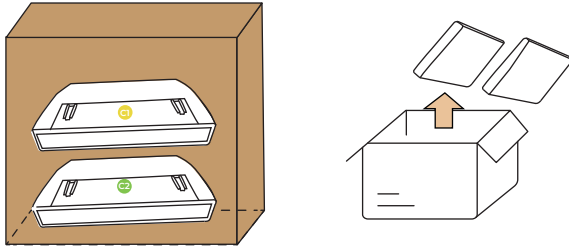

Step 2

Take out the Seat Base, Seat Cushion Case, Back Cushion Cases (2 pieces), and Back Cushion Cores (2 pieces) from the Corner Seat & Cushions Box, and open these bags.

⚠ Do NOT use sharp tools such as knives or scissors to open bags as it could potentially damage the cushions. Please use your hands to gently pull the bags apart. Please allow up to 48 hours for the cushions to return to the original thickness.

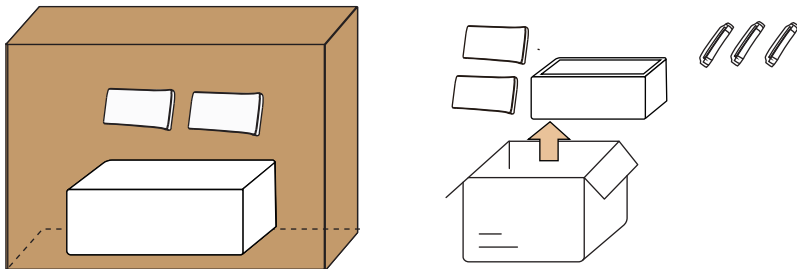

Corner

Step 3

Remove the three wood sticks at the base of the seat to take out the hardware pack and vacuum-packed Seat Cushion Core, then open these bags.

⚠ Remove the sticks one by one. Push the stick down and rotate it towards the corner of the base and pull it out. Do NOT use sharp tools such as knives or scissors to open bags as it could potentially damage the cushions. Please use your hands to gently pull the bags apart. Please allow up to 48 hours for the cushions to return to the original thickness.

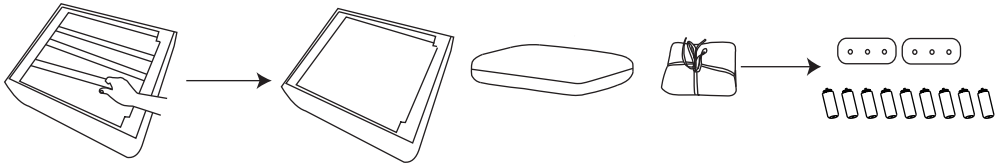

Step 4

Rotate the Legs firmly.

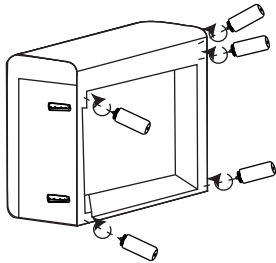

Corner Seat

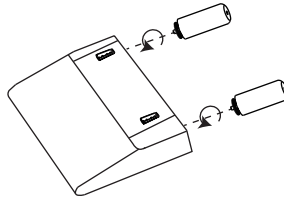

Corner Left Back

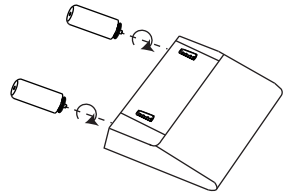

Corner Right Back

Step 5

Slide the Corner Right Back (C2) into the side of Seat Base marked with C2.

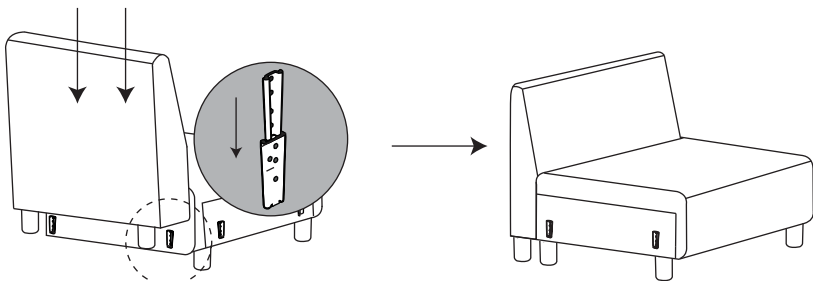

Corner

Step 7

Slide the Corner Left Back (C1) into the side of Seat Base marked with C1.

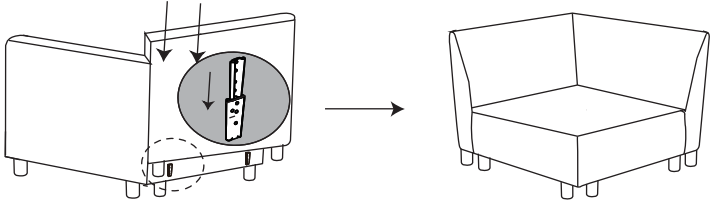

Step 8

Insert the Seat Cushion Core into the Seat Cushion Case. Insert the Back Cushion Cores into the Back Cushion Cases. Fluff the Seat Cushion and Back Cushions, and put them on the Seat Base to complete the assembly of your Corner.

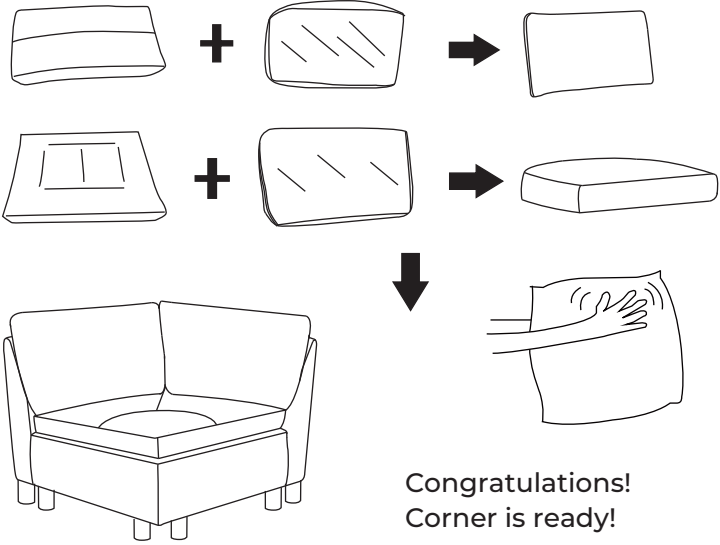

Tips

For now, please keep the Metal Connectors aside and you may need them after you have completed the assembly of all modules (See Page 21 for details).

Ottoman



Parts

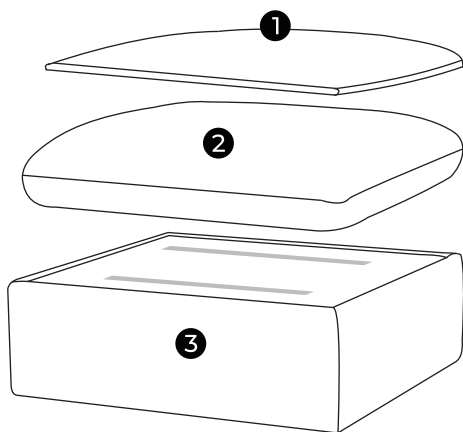

- 1 Seat Cushion Case
- 2 Seat Cushion Core
- 3 Ottoman Seat Base
- 4 Leg x 4

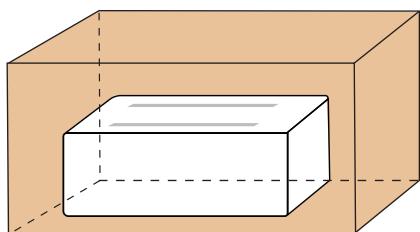

Ottoman PIECES INCLUDED

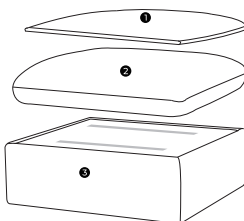

- 1 Seat Cushion Case x 1
- 2 Seat Cushion Core x 1
- 3 Ottoman Seat Base x 1
- 4 Leg x 4
- 5 Assembly Manual



Step 1

Take out the Seat Base and the Seat Cushion Case from Ottoman Box.

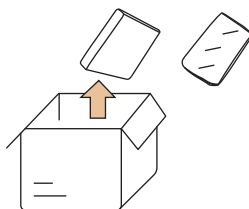
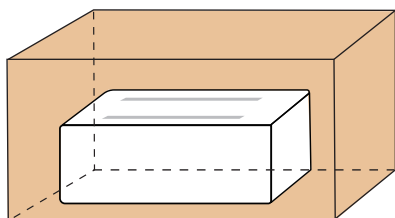

Ottoman

Step 2

Remove the three wood sticks at the base of the seat to take out the hardware pack and vacuum-packed Seat Cushion Core, then open these bags.

⚠ Remove the sticks one by one. Push the stick down and rotate it towards the corner of the base and pull it out. Do NOT use sharp tools such as knives or scissors to open bags as it could potentially damage the cushion. Please use your hands to gently pull the bags apart. Please allow up to 48 hours for the cushion to return to the original thickness.

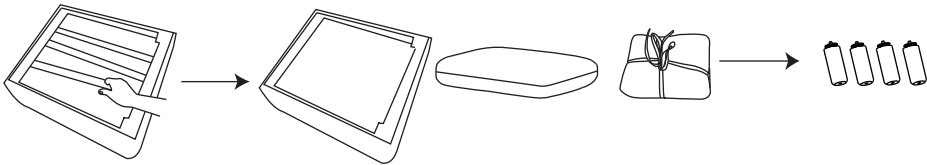

Step 3

Rotate the Legs firmly.

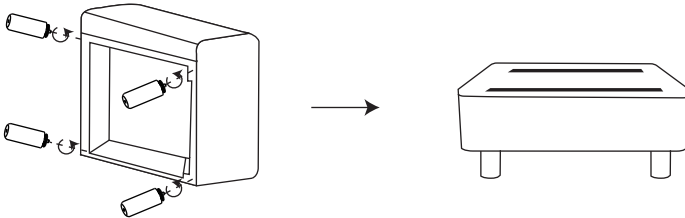

Step 4

Remove the velcro protectors on the top of the Seat.

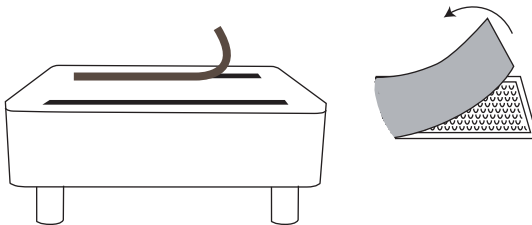

Ottoman

Step 5

Insert the Seat Cushion Core into the Seat Cushion Case. Fluff the Seat Cushion and put it on the Seat Base to complete the assembly of your Ottoman.

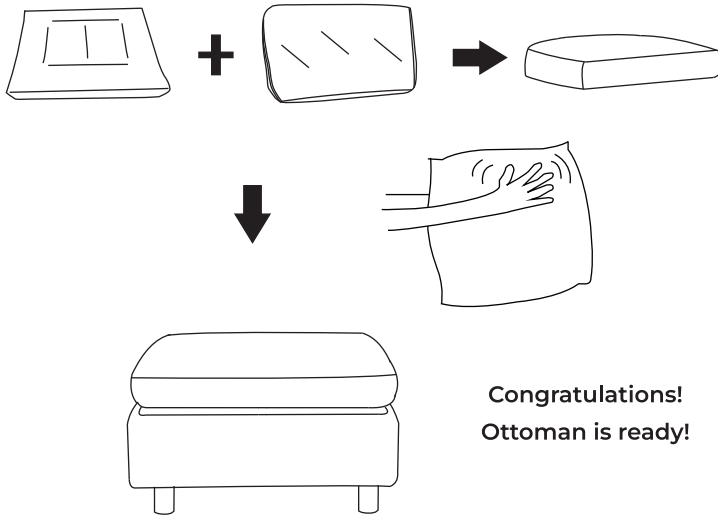

Care Instruction

- Avoid direct heat and sunlight.
- Periodically dust using a clean, dry and non-abrasive white cloth.
- If spills occur, immediately soak up any liquids with an absorbent cloth.

Note

Leather is a natural product. Both texture and color will vary slightly from hide to hide. Stretch marks, scars and insect bites will be visible and prove the high quality and naturalism of the leather.

Bonus Feature

You have now successfully assembled each module. Depending on the number of modules you purchased, you can reconfigure your Brendon set in various arrangements. Once you've selected your preferred configuration, use the provided metal connectors to secure the chairs together and help prevent them from sliding apart.

Step 1: Put the chairs side by side, with the base of the chair facing you.

Step 2: Attach the Metal Connectors by screwing on the legs firmly. You may have a few extra Metal Connectors left over. They are included in case you want to connect additional modules in the future. We recommend storing them in the little zip-top bag in case you decide to expand your Liam later.

Note: Ottoman is a standalone piece and cannot be attached to any chair with Metal Connectors.

