

# 3-Light Natural Wood Travertine LED Vanity Light

Hardwired wall light fixture | Built-in LED light sources | 360° rotatable travertine shades

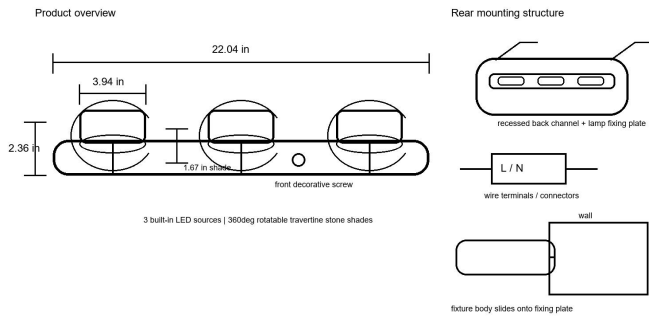

Specification	Value
Overall width	22.04 in
Shade diameter	3.94 in
Fixture height	2.36 in approx.
Shade height	1.67 in
Light source	3 built-in LED light sources
Installation	Hardwired wall mount; install to secure junction box or structure.

## Safety Warnings

**DANGER:** Turn OFF breaker and verify power is off before touching wires.

**WARNING:** Connect ground wire. Do not install if no grounding conductor is available.

**WARNING:** Install per NEC (ANSI/NFPA 70) and local codes. Qualified electrician recommended.

**CAUTION:** Travertine shades are natural stone and may be heavy/fragile. Handle with care.

## Parts, Tools, and Wiring

Parts: fixture body with 3 LED shades, lamp fixing plate with long slots, mounting screws, front decorative screw/nut, wire terminals or listed wire connectors.

Tools: Phillips screwdriver, voltage tester, level, pencil, wire stripper/cutter if needed, ladder, gloves, safety glasses. (Suggested but not included in the package.)

Fixture Wire	Supply Wire	Requirement
Black	Black/Hot (L)	Use listed terminal/connector.
White	White/Neutral (N)	Use listed terminal/connector.
Green/Bare	Ground	Connect to ground wire or ground screw.

## Package Contents / Before Installation

- Check all accessories before installation.
- Confirm the fixing plate matches the outlet box or wall anchors.
- Protect travertine shades on a soft surface.
- All wiring must remain inside the junction box or fixture back channel.
- Do not disassemble built-in LED modules.
- Rotate shades gently after the fixture is secure.

## Installation Steps

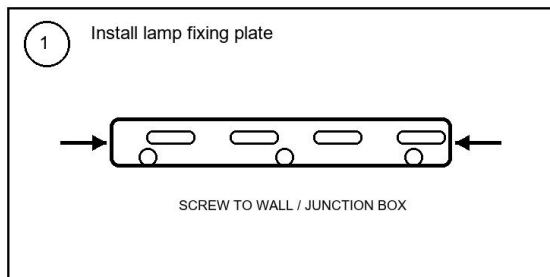

### 1. Install fixing plate

Level the lamp fixing plate. Fasten it to the junction box or solid wall structure.

NOTE: Due to the narrow profile of this fixture, the Round Cover Plate (included) could be installed to fully cover the standard Junction Box.

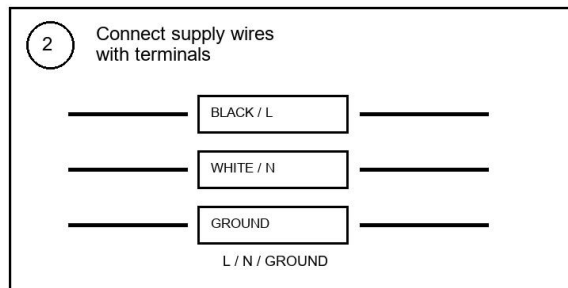

### 2. Connect wires

Connect black/hot, white/neutral, and ground using the supplied terminals or listed connectors.

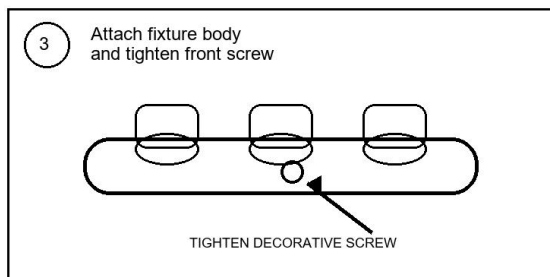

### 3. Secure fixture body

Place fixture body over the fixing plate and tighten the front decorative screw/nut.

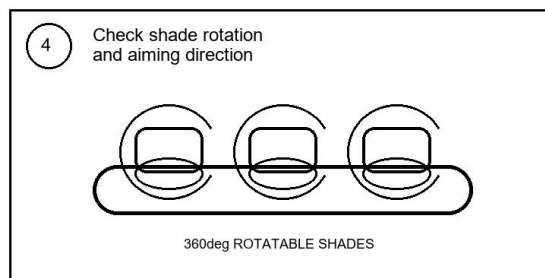

### 4. Adjust shades

Gently rotate each travertine shade to the desired direction after the fixture is secure.

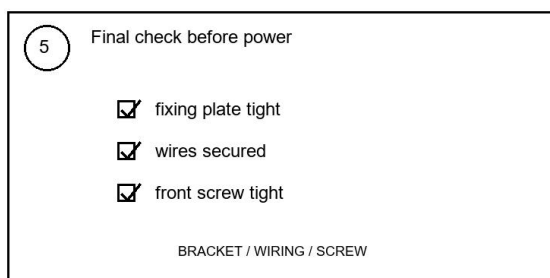

### 5. Final check

Confirm fixing plate, wiring, and front screw are secure before restoring power.

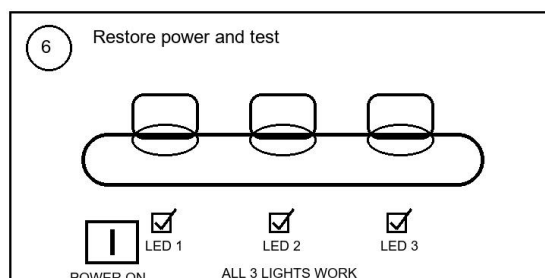

### 6. Test

Restore power and test that all three LED light sources work normally.

## Final Check / Care

- Fixing plate is tight and fixture does not move.
- Ground connection is complete.
- All connectors are inside the junction box or back channel.
- Front decorative screw/nut is secure.

- Clean wood/stone with soft dry cloth only.
- No alcohol, solvents, or abrasive cleaners.
- Do not modify or disassemble LED modules.
- If flicker, odor, overheating, or breaker trip occurs, turn off power.

Limited warranty: Covers defects in materials/workmanship for the seller-stated period. Excludes incorrect installation, misuse, modification, improper cleaning, third-party parts, and normal wear.