

VIVOSUN

6L ULTRASONIC HUMIDIFIER

INSTRUCTION MANUAL



Chat Support



Product Inquiry



Orders FAQ



Product Assembly



Notes

DESIGNED BY **VIVOSUN** IN CALIFORNIA
Made in P.R.C

VIVOSUN

6L ULTRASONIC HUMIDIFIER

ASSEMBLY INSTRUCTONS



HOW THE PRODUCT WORKS

The ultrasonic air humidifier generates 1.7 million ultrasonic vibrations per second to convert water into ultra-fine, 1~5 micron-wide particles that then disperse throughout the air for comfortable, evenly humidified air.

PRODUCT USAGE

- 1. Fill the water tank with clean tap water or distilled water to the "maximum water level" marked inside the water tank. (Must be unplugged when filling with water).
- 2. Return the water tank to its base, cover, and insert the power plug into the socket, making sure that the rated voltage is consistent with the machine's working voltage.
- 3. Press the Power key, and the machine will start working. Humidity levels can be adjusted at will.
- 4. When the machine's water level gets too low, the machine will automatically cut off the power and stop working. When this happens, first turn the machine off and stop working by pressing the Power key again and pull out the power plug before adding any water to the water tank.

PRODUCT PARAMETER TABLE

Product Name	6L Ultrasonic humidifier
Model No.	HD-2113
Rated Voltage	100-240V
Rated Frequency	50-60Hz
Rated Power	Heating Power: 90W Normal Power: 25W
Tank Capacity	6L
Maximum Atomization	300 mL/h
Implementation Standard	GB 4706. 1-2005/ GB 4706. 48-2009

PRODUCT PARTS

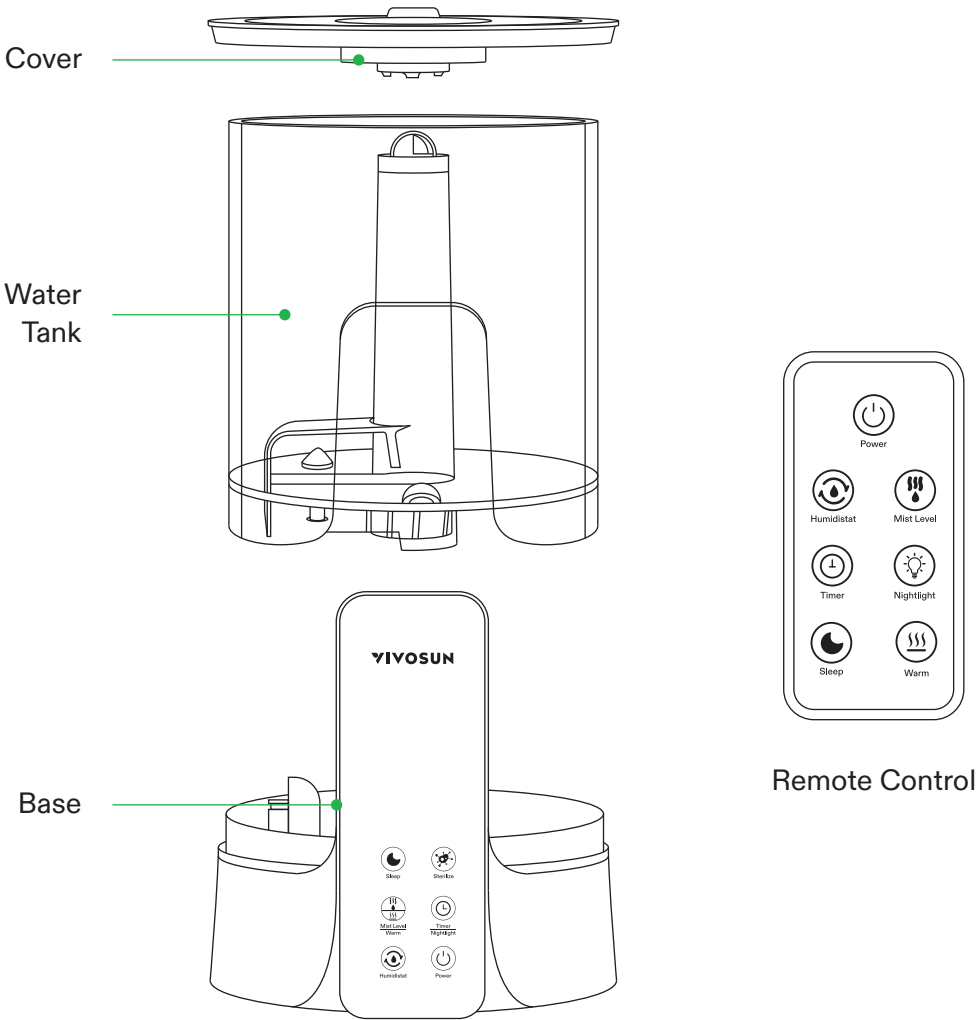

OPERATING PANEL

-Main Product Panel

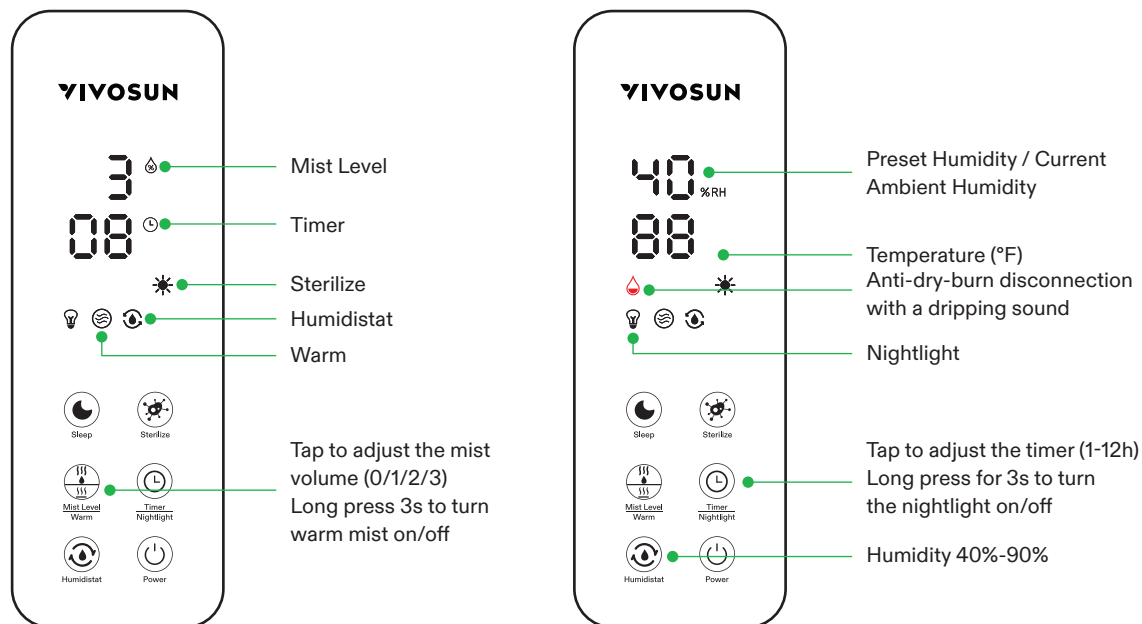

-Remote Control Panel

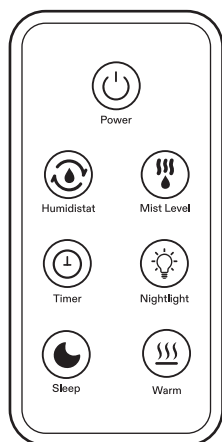
***Warm Tip.**

There is no UV Sterilize key on the remote control; this function must be operated via the machine's control panel.

OPERATING INSTRUCTIONS

Power Key:

After plugging in, touch the power button. The LCD display will light up and the machine will start working. Touch the power button again, and the humidifier will stop working and enter standby mode.



Mist Level Key:

Four mist levels can be chosen from: zero mist (0), low mist (1), medium mist (2), and high mist (3). After setting, the corresponding level number will be displayed (as shown in the Figure to the right). By default, the product is set to the maximum fog level.

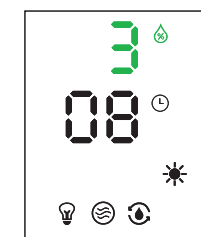

Constant Humidity Key:

Start the machine and the default mode is continuous humidification. To change the constant humidity, press the Humidistat key and the LCD "Ambient Humidity" will light up. The initial humidity is set at 40%. Every time you press the button, the value rises by 5% until it reaches 90%. After setting the humidity, the LCD will also display the current ambient humidity.

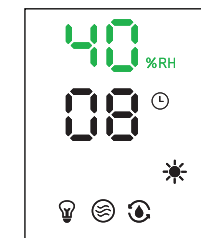

After reaching the preset humidity, the machine will stop humidifying. When the ambient humidity falls below the preset humidity, it will resume working again. After reaching 90%, press the Humidistat button again to exit constant humidity mode, and press it yet again to return to the initial humidity setting of 40%.

Night Light Function:

Press and hold the timer button for 3 seconds to turn the night light function on or off. When on, a nightlight icon will appear on the display (as shown in the Figure at the right).

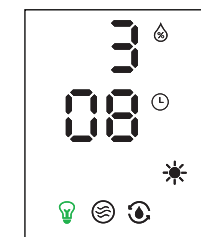

Timer Key:

This product has an preset timer function. It can be timed in increments of 1 hour from 1 to 12 hours. Press the key to set the switch-off time. Each time the key is pressed briefly, the corresponding time will be shown on the display.

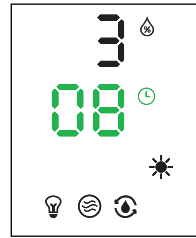

UV Sterilize Key:

This product has a UV sterilization function. Touch the Sterilize key to turn the function on or off. When turned on the display will show the sterilization icon (as shown in the Figure to the right).



Heating Function:

Press and hold the mist level button for 3 seconds to turn the heating function on or off. The heating icon will appear on the display when it is on (as shown in the Figure to the right).

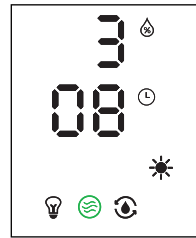

Sleep Key:

Touch the key on the product control panel to activate sleep mode. The display will automatically switch off (sterilization and nightlights are not affected by sleep mode) and the product will work according to its initial settings. Press any function key to exit sleep function and display the current working status.



SAFETY TIPS

1. Please do not touch the plug with wet hands to avoid electric shock.
2. Please do not disassemble, repair, or modify this product without authorization.
3. When starting up, please do not touch the atomizing sheet; doing so will cause great pain.
4. The power cord must not be scratched, damaged, knotted, or press upon by heavy objects or clamps or it may cause electric shock, short circuit, and possibly fire.
5. Please do not replace the power cord without authorization. If there are any abnormalities obvious on the plug, please unplug it immediately and contact the manufacturer or a after-sales customer service agent.
6. If the power cord is damaged, it must be repaired by professional personnel designated by the manufacturer.
7. Please do not separate the water tank and the base while the machine is working, and do not touch the water or parts inside the base.
8. This machine is for indoor use only.
9. Please unplug the machine's power plug when not in use for a long time or during thunderstorms.
10. To avoid burning out any internal components, please do not turn the machine over when it is powered on and there is water inside.
11. Please keep this product out of the reach of children. Do not let children use or operate this product.
12. Unplug the power plug when filling with water or cleaning.

WARNING SIGN

About the base water:

The humidifier uses ultrasonic atomizing vibrations to break liquid water up into water mist, and the water tank only serves as a transitional water storage tool. All humidifier bases will accumulate some water. Do not be alarmed if you see water in the base.

About fog adjustment:

If there is water around the machine during use, it indicates that the room humidity is too high; please adjust the fog settings to whatever is appropriate for the environment.

About the remote control battery:

For battery replacement instructions and battery model, please refer to the instructions on the back of the remote control.

TROUBLE SHOOTING METHODS

If your humidifier is not working properly, please check below before requesting service.

Problem	Potential Cause	Potential Solution
Nothing displays on the screen	The power is not connected or switch is not turned on	Connect the power and switch to "on"
Flashing red light on display screen and no spray	Low water level	Add the appropriate amount to the tank
The machine powers on but does not spray	1. The atomizer scales 2. The water is dirty or has been stored for a long time 3. The amount of fog is set at the minimum level	1. Clean atomization sheet 2. Add a small amount of hot water to the tank 3. Replace with clean water 4. Set to the fog level until desired amount is put forth
Abnormal noise	Water tank is resonating with the countertop	Fill the tank with water to the appropriate level and keep on a solid surface
The screen shows that there is water in the tank, but displays water shortage, and the status "Icon alarm"	The switch senses that the float is stuck	Move the float up and down smoothly

After the above treatment, if the machine still does not function normally, please contact the company's after-sales service center or local dealer. We will do everything we can to help you.

CLEANING MAINTENANCE

1. Clean the water tank and sink every week, and unplug the power plug before cleaning.
2. External cleaning: wipe the external surface with a clean soft cloth cooler than 40°C.
3. Do not use hard cleaning tools to avoid damaging parts.
4. Do not use chemical detergents to clean.
5. Always replace the water in the water tank to keep the inside of the humidifier clean.
6. When not in use for a long time, please keep the inside of the humidifier dry.

TRANSDUCER AND MACHINE BASE DESCALING

Before cleaning, make sure to turn off the power and unplug the power plug. Pour the disinfectant into the base, and then add warm (about 60°C) water to make the disinfectant dissolve. Let soak for 5-10 minutes. Use a cleaning brush to scrub the surface of the transducer until the scale is removed. At the same time, clean the base and the surface of the machine with clean water.

TABLE OF HARMFUL SUBSTANCES CONTENT OF PRODUCTS

Part Name	Name and content of harmful substances in products					
	Pb	Hg	Cd	Cr(VI)	PBB	PBDE
Plastic Housing	○	○	○	○	○	○
Blower Fan	X	○	○	○	X	X
Circuit Board	X	○	○	X	○	○
Fasteners	○	○	○	X	○	○
Silicone Piece	○	○	○	○	○	○
Internal Conductor	○	○	○	○	○	○
Power Cord	X	○	○	○	○	○

This table is prepared according to S/T 11364, which indicates that the content of the hazardous substance in all materials of the part is in the quantity specified in GB/T 26572.

The following x indicates that the main substance is at least contains in the homogeneous material of the part, which is beyond the quantity specified in GB/T 26572.

Note: in addition to the parts published in this table, there are gumax batteries which are not included in the quantity specified for replacement.



Under the normal use conditions described in this manual, the environmental protection service life of this product is 10 years. It can be used within the environmental protection service life. After the environmental protection service life, it should be put into the recycling system.

WARRANTY POLICY

1. The machine can be guaranteed for 1 year in normal use from the date of purchase. (Subject to the date of the purchase invoice)
2. The following conditions are not covered by the free warranty, but you can still enjoy the preferential maintenance service of material cost only as below:
 - a. Failure to follow the operating steps and precautions of the manual causes the product to malfunction.
 - b. Product failure due to accidental disasters, force majeure and other factors, such as excessive voltage, fire, flood, earthquake, etc.
 - c. The warranty period has expired.
 - d. The customer makes unauthorized changes, misuses, or accidental damages.
 - e. The use environment exceeds the product specifications.
3. Please keep the warranty card; it will not be reissued after it is lost.
4. If the product and the specification parameters are updated, no further notice will be given. The form and color may be slightly different from the actual product; please refer to the actual product.