

ASSEMBLY INSTRUCTIONS

Parts:

(2) Side Piece

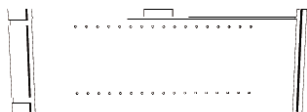

Top Piece



Bottom Piece

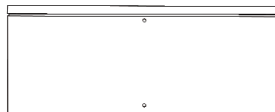

Back Piece

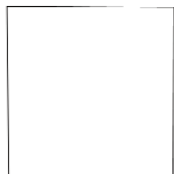

Back Brace ($3\frac{1}{4}'' \times 29\frac{1}{8}''$)

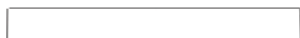

(2) Skirt ($2'' \times 29\frac{1}{8}''$)



(1) Shelf Piece



**Notice - KEEP BACK GROOVES ALIGNED
Do Not Drill!**



(4) Shelf Pins

Tools needed for assembly

(34) Hex Screws



Allen Wrench



Phillips Head Screwdriver
(Not Included)



Set of (4) Casters
with hardware

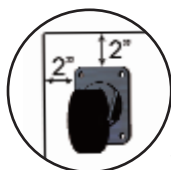

Step 1: Using phillips head screwdriver (not included) and hardware provided, attach casters to **bottom piece** as shown. See instructions included with caster set.



Step 2: Align **skirt** with pre-drilled holes on **bottom piece**. Insert hex screws into pre-drilled holes in **bottom piece**. Tighten down. Repeat for remaining skirt piece.

Step 3: Insert edge of **bottom piece** into mortise of **side piece**. Make sure back grooves are aligned. Insert hex screws into each of pre-drilled holes in **side piece** and each of the **skirt**. Tighten down halfway.

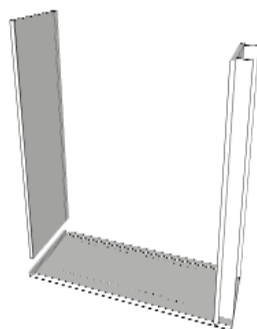
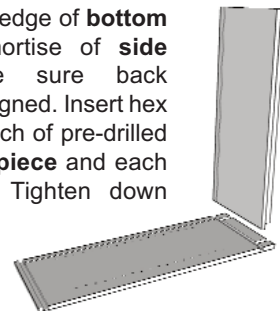

Step 4: Insert edge of **top piece** into mortise of **side piece**. Make sure back grooves are aligned. Insert hex screws into each of pre-drilled holes in **side piece** and tighten halfway.

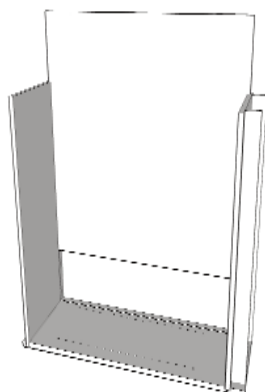

Step 5: Insert sides of **back piece** into back grooves of **top** and **bottom pieces**. Slide down until edge rests firmly in back groove of **side piece**.



Step 6: Fit edges of assembled pieces into mortises and back grooves of remaining **side piece**. Insert hex screws into each of pre-drilled holes in **side piece** and tighten down halfway.

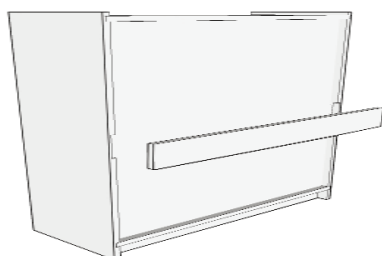
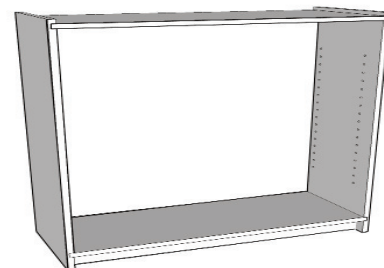

Step 7: Insert edge of **Back Brace** into mortises of **side pieces**. Make sure back grooves are aligned. Insert hex screws into each of pre-drilled holes in **side piece** and tighten halfway.

Step 7: Tighten all screws snugly. **DO NOT OVERTIGHTEN**. Rotate unit so that it rests on **bottom piece** and edges of **side pieces**. Insert shelf pins at desired height and place shelves on shelf pins. **Assembly is now complete.**