

# ASSEMBLY INSTRUCTIONS

## ASSEMBLY REQUIREMENTS

2-Person  
Assembly

1.5 Hours  
Assembly Time  
(Approximate)

Tools Required  
(Not Provided)

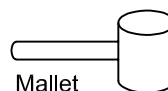

Mallet



Pozidriv

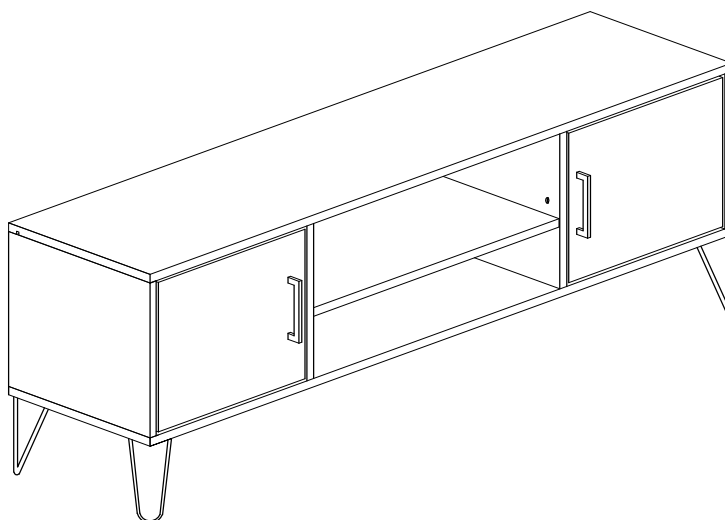

**NOTE : THE MAXIMUM WEIGHT THIS PRODUCT CAN HOLD UP TO 25 KGS.**

**Thank you for purchasing our product!**

Please refer and use this assembly instruction to assemble the product. Contact our customer service department in case there are any missing or damage parts or hardware. Replacement parts are normally shipped within 2 or 3 days

**We appreciate your business!**

## ASSEMBLY PREPARATION

1. Remove all packaging materials, staples and packing straps from the carton.
2. Refer to Parts List and Hardware List, and ensure parts and hardware are correct before assembly. Contact customer service for missing parts.
3. Place all wooden parts on a clean, flat and soft surface (e.g. carpet or rug) to prevent scratch and damage to parts

## SAFETY PRECAUTION

1. KEEP ALL HARDWARE PARTS OUT OF REACH OF CHILDREN.
2. DISPOSE PLASTIC PACKAGING MATERIAL IMMEDIATELY TO AVOID ANY RISK OF SUFFOCATION TO CHILDREN
3. AND ANIMALS.

## TIPS FOR ASSEMBLY

1. Allow ample room for assembly and in close proximity to where product will be placed.
2. Assemble the product on a surface that does not scratch or damage the exterior gloss and finish of the furniture.
3. Identify all of the parts, hardware and quantities required for each step.
4. During assembly, do not over-tighten any fittings as this may cause damage.
5. DO NOT USE POWER TOOLS TO ASSEMBLE THIS PRODUCT.
6. Always place the product on a flat, level surface.
7. Do not sit or stand on the partially assembled product; only use the product for which it is intended.

## CARE AND MAINTENANCE

- Use a slightly damp cloth to clean the product. Do not use bleach or abrasive cleaning material.
- Check all the fittings periodically and re-tighten as necessary. Do not use the product if any of the parts is damaged or broken.
- Never allow any kind of liquid to remain on your furniture. Absorption can cause wood to warp or delaminate.
- Do not place hot items (e.g. hot drinks) directly on to the wood surface.
- Do not drag and/or pull the furniture.

This product is for indoor and household use only - not for commercial use.

# ASSEMBLY INSTRUCTIONS

## PART LIST

PARTS	DESCRIPTION	QTY
(A)	RIGHT PANEL	1
(B)	LEFT PANEL	1
(C)	RIGHT CENTRE PANEL	1
(D)	LEFT CENTRE PANEL	1
(E)	TOP PANEL	1
(F)	BOTTOM PANEL	1
(G)	ADJUSTABLE PANEL	1
(H)	DOOR PANEL	2
(I)	BACK PANEL(A)	2
(J)	BACK PANEL(B)	1

## PARTS ASSEMBLY OVERVIEW

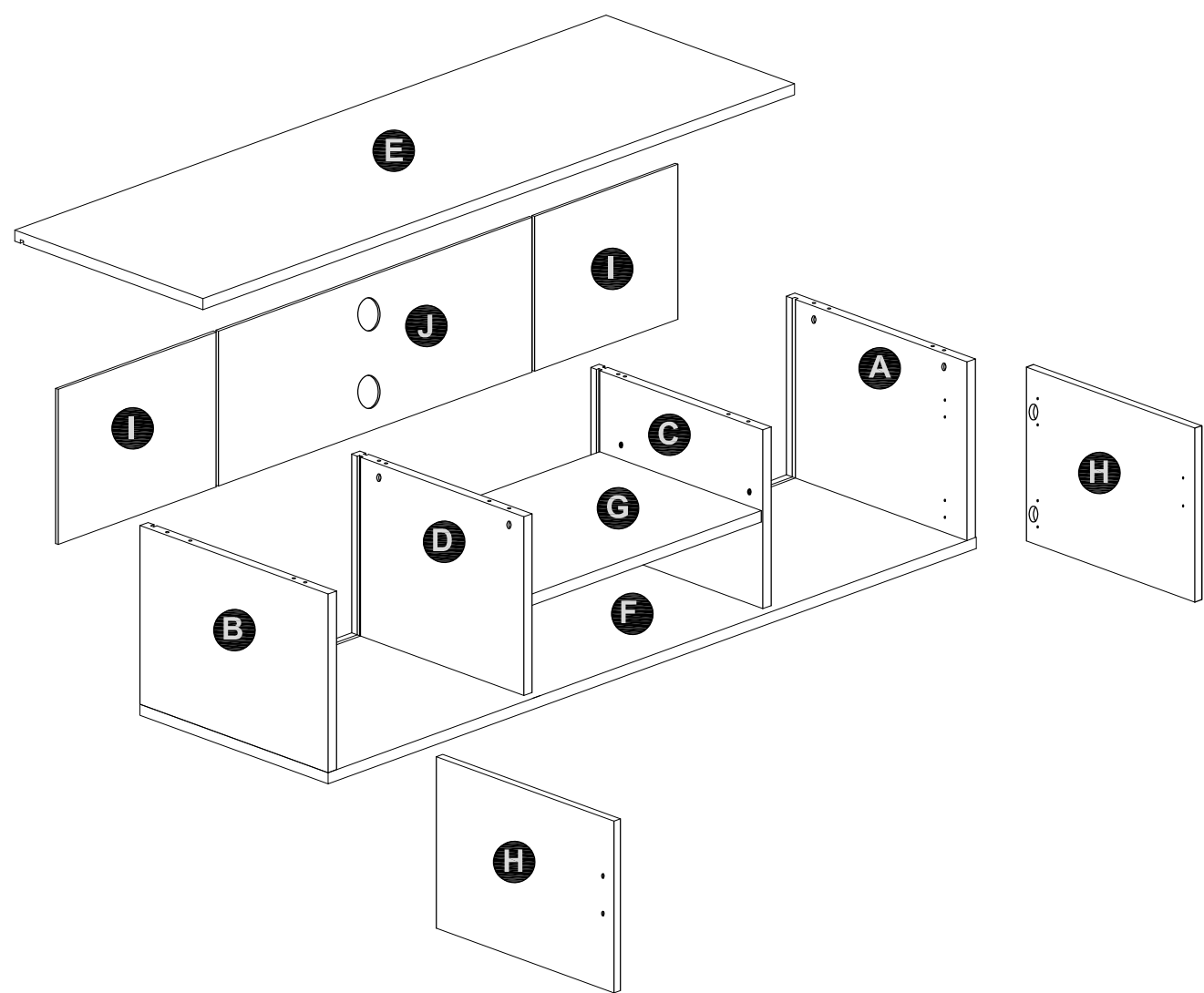

# ASSEMBLY INSTRUCTIONS

## HARDWARE LIST

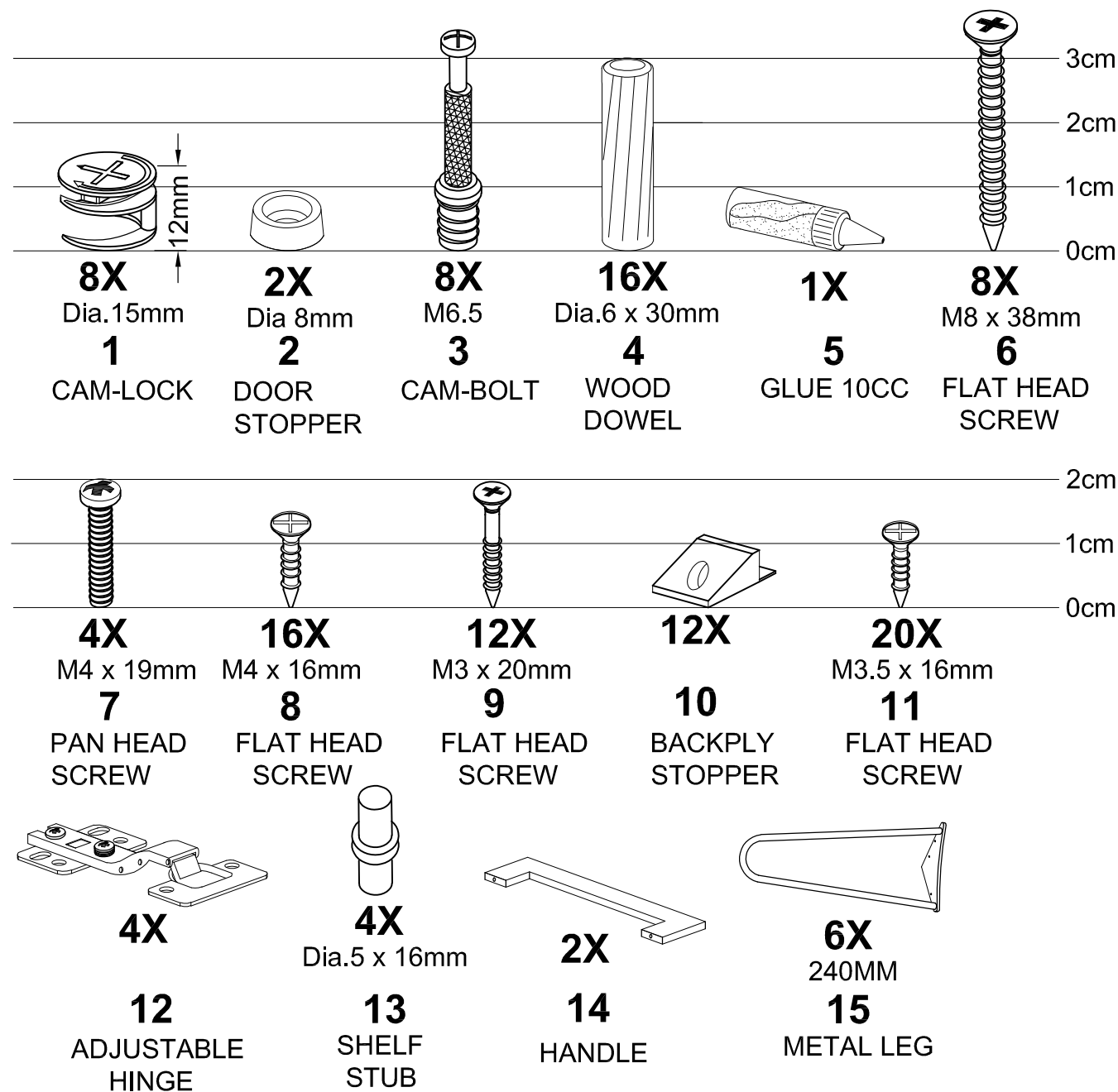

## EXTRA HARDWARE LIST

PART	DESCRIPTION	QTY
<b>1</b>	CAM-LOCK	x1
<b>3</b>	CAM-BOLT	x1
<b>4</b>	WOOD DOWEL (Dia. 6 x 30mm)	x2

PART	DESCRIPTION	QTY
<b>6</b>	M8 x 38mm	x1
<b>11</b>	M3.5 x 16mm	x2
<b>13</b>	SHELF STUB	x1

\* Extra Hardware for Spare Use

# Instructions For Fastening CAM-BOLT and CAM-LOCK

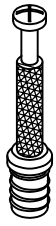

CAM-BOLT



CAM-LOCK

Tools Required

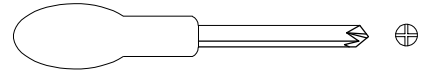

## INSERTING AND TIGHTENING CAM-BOLT

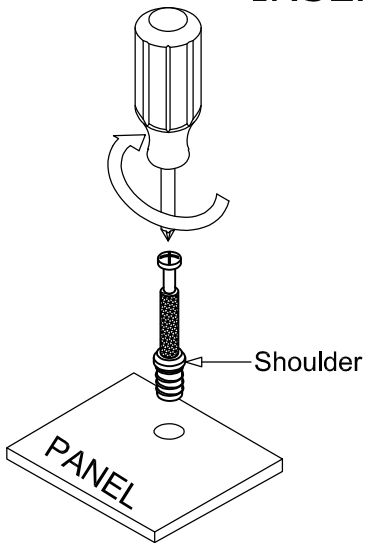

Place Cam-bolt on pre-drilled hole and screw in vertically

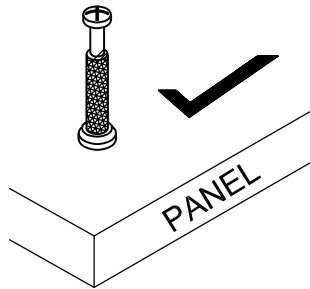

Shoulder is flushed  
(on the same level)  
with the panel

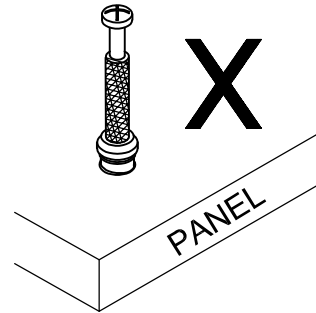

Shoulder is  
above the panel.

### INSERTING CAM-LOCK

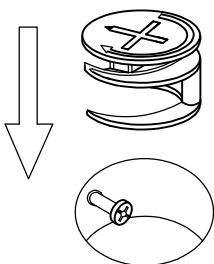

Insert Cam-lock  
with arrow align  
to Cam-bolt head

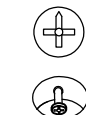

CORRECT

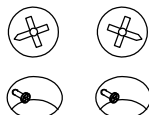

WRONG

Align the arrow on the Cam-lock to the  
Cam-bolt head and insert the Cam-lock.  
Ensure Cam-lock is fully inserted.

### TIGHTENING CAM-LOCK

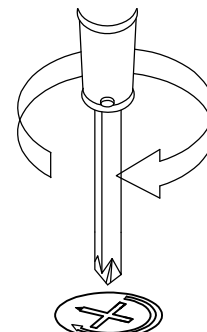

Use a pozidriv Screwdriver to turn Cam-lock  
clockwise to lock the head of the Cam-bolt.  
Turn until it is snug ( about 3 / 4 ths of a turn )  
- over-tightening could damage Cam-lock  
or / and Cam-bolt

# ASSEMBLY INSTRUCTIONS

## STEP 1

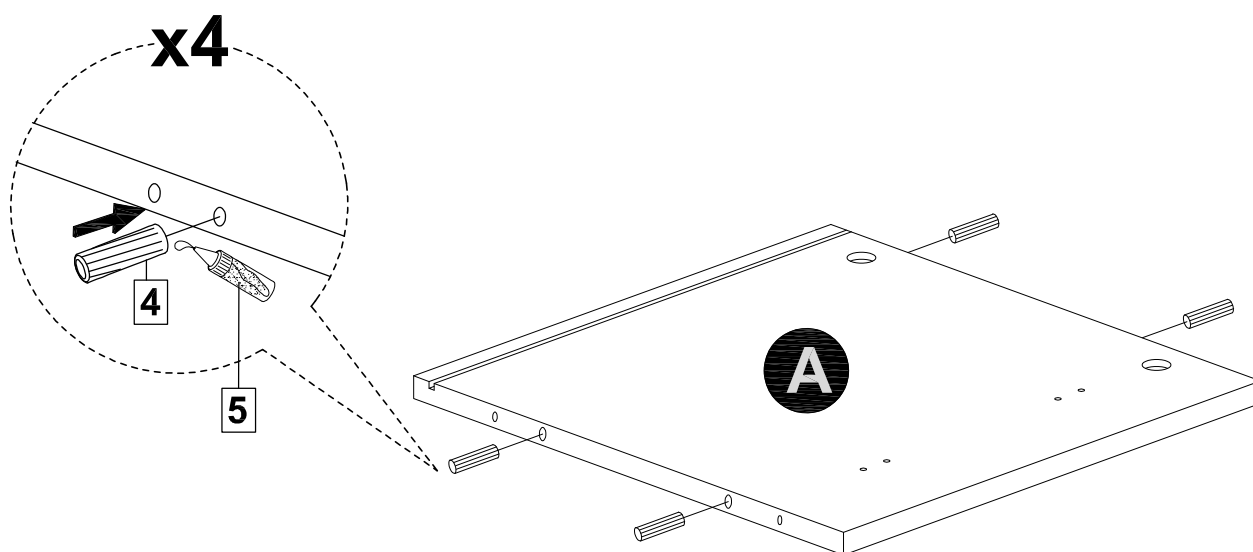

a) Lay Right Panel (A) on a material that does not scratch or damage the part.

b) Apply Glue (5) to Wood Dowel (4) and insert Wood Dowel into the designated (inner) holes as shown. Use a mallet or hammer to lightly tap Wood Dowel into the hole if necessary.

## STEP 2

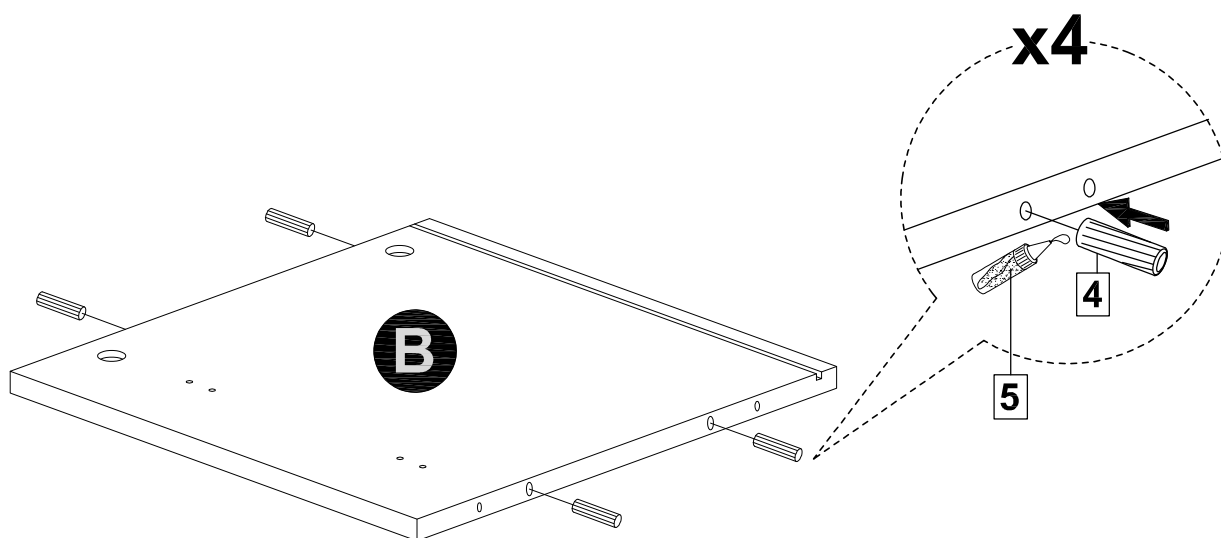

a) Lay Left Panel (B) on a material that does not scratch or damage the part.

b) Apply Glue (5) to Wood Dowel (4) and insert Wood Dowel into the designated (inner) holes as shown. Use a mallet or hammer to lightly tap Wood Dowel into the hole if necessary.

# ASSEMBLY INSTRUCTIONS

## STEP 3

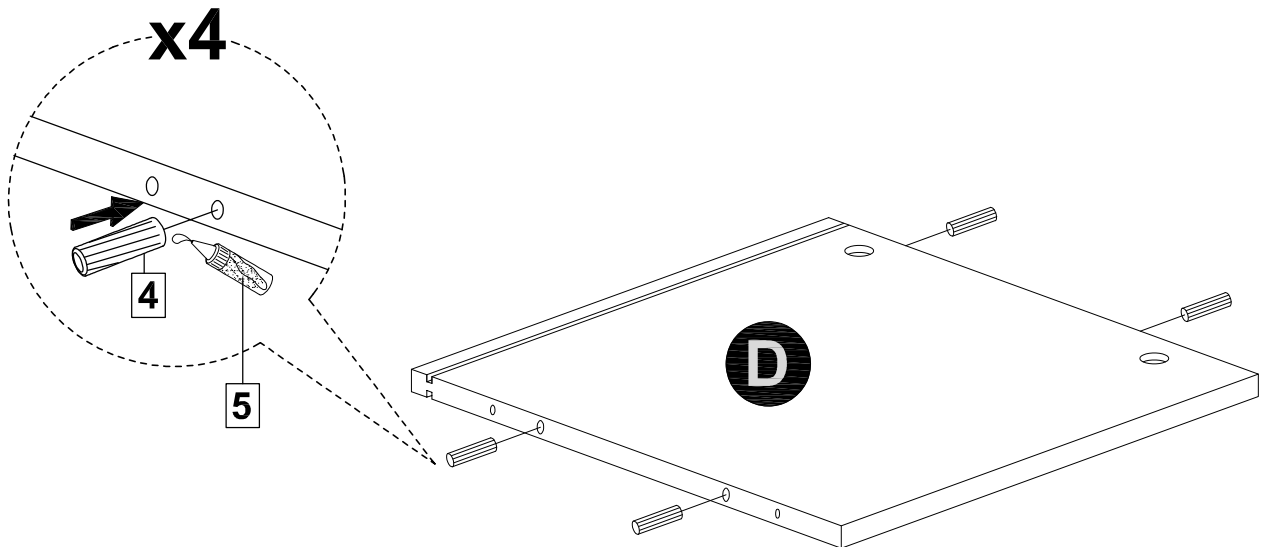

- a) Lay Left Center Panel (D) on a material that does not scratch or damage the part.
- b) Apply Glue (5) to Wood Dowel (4) and insert Wood Dowel into the designated (inner) holes as shown. Use a mallet or hammer to lightly tap Wood Dowel into the hole if necessary.

## STEP 4

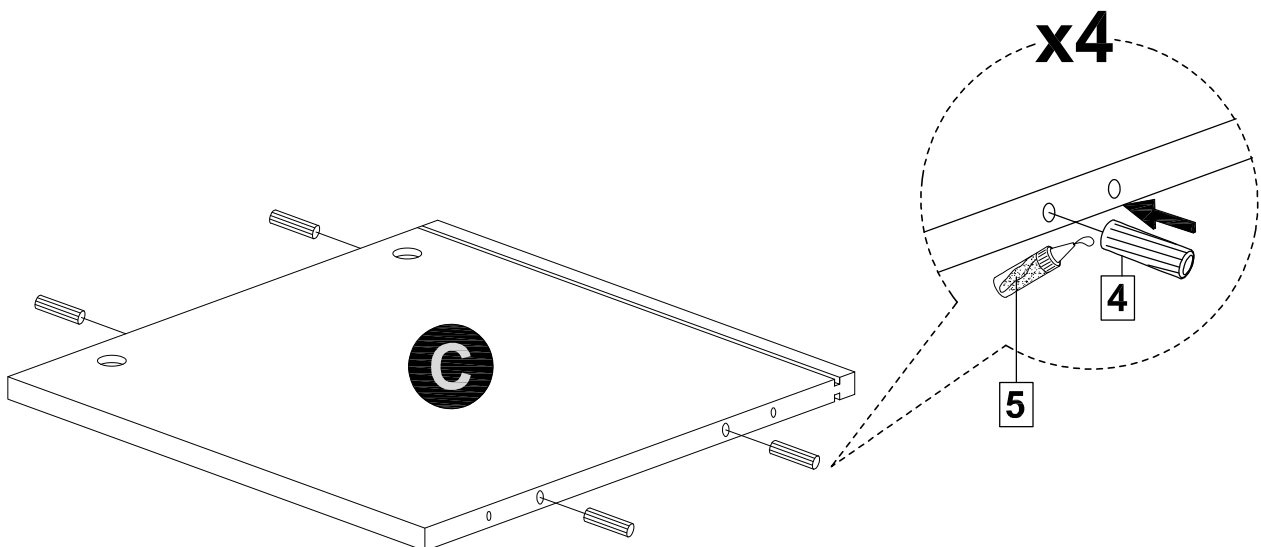

- a) Lay Right Center Panel (C) on a material that does not scratch or damage the part.
- b) Apply Glue (5) to Wood Dowel (4) and insert Wood Dowel into the designated (inner) holes as shown. Use a mallet or hammer to lightly tap Wood Dowel into the hole if necessary.

# ASSEMBLY INSTRUCTIONS

## STEP 5

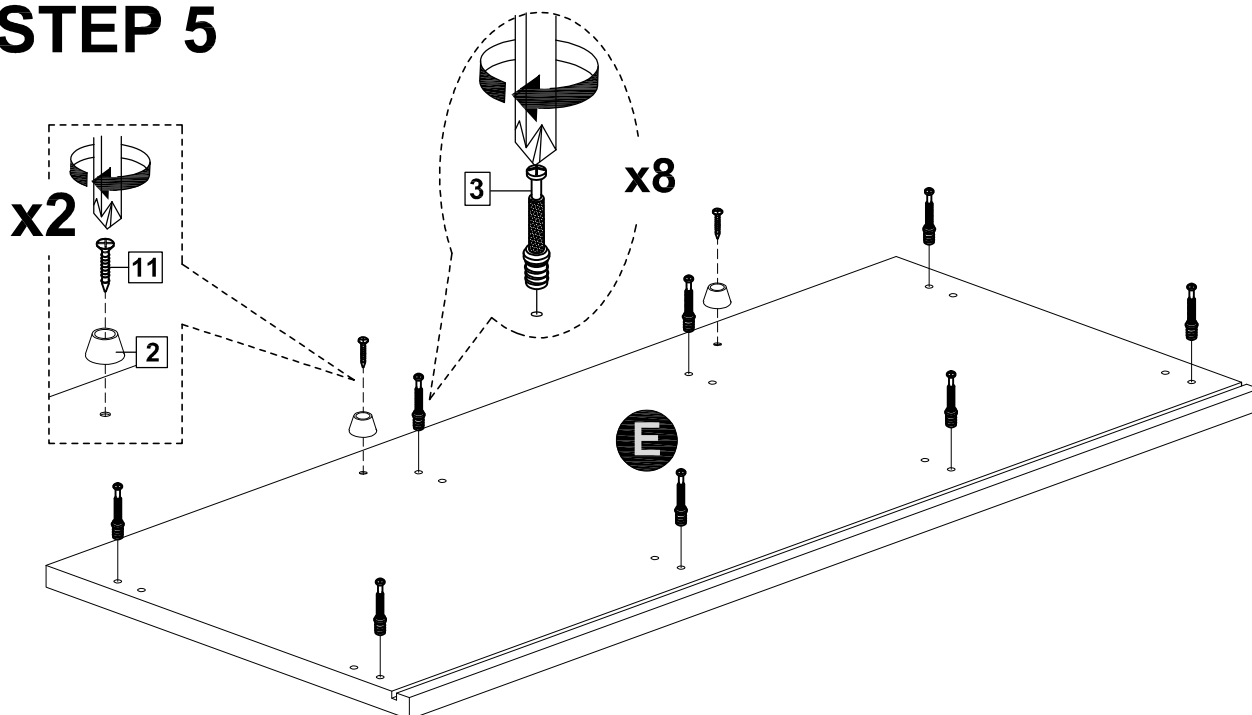

- Lay Top Panel (E) bottom-side up on a material that does not scratch or damage the part.
- Screw in Cam-bolt (3) into designated holes as shown. Refer to Page 4 for instructions to install Cam-bolts.
- Use Screw (11) to fasten Door Stopper (2) into the designated holes towards the front edge of (E) as shown.

## STEP 6

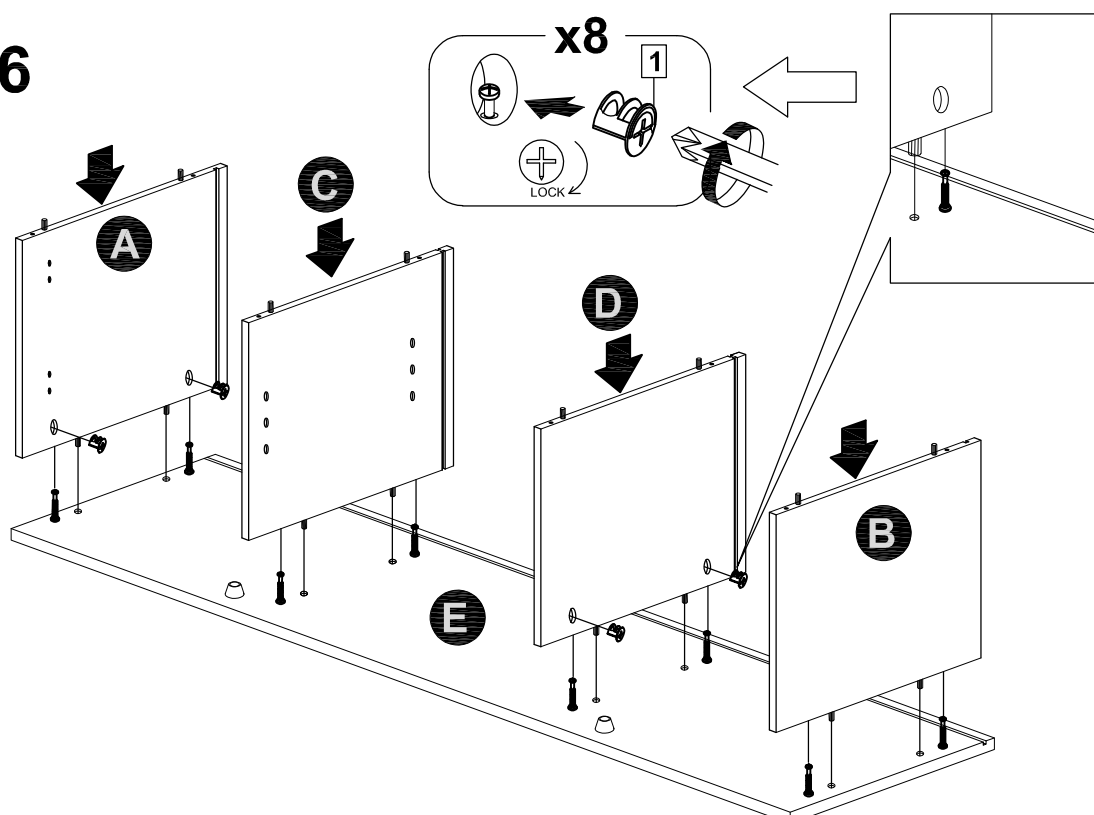

- Attach Right, Left, Center Right and Center Left Panel (A, B, C & D), from Step 1 to 4, to Top Panel (E) via Wood Dowels and Cam-bolts on the respective parts.  
Note the orientation of the parts: (the groove on (A, B, C & D) are perpendicular to the groove on (E); the holes for shelf stubs on (C & D) must mirror each other.
- Insert Cam-lock (1) into designated holes on (A, B, C & D) as shown and turn clockwise to lock onto cam-bolt. Refer to Page 4 for instructions to insert and tighten Cam-lock.

# ASSEMBLY INSTRUCTIONS

## STEP 7

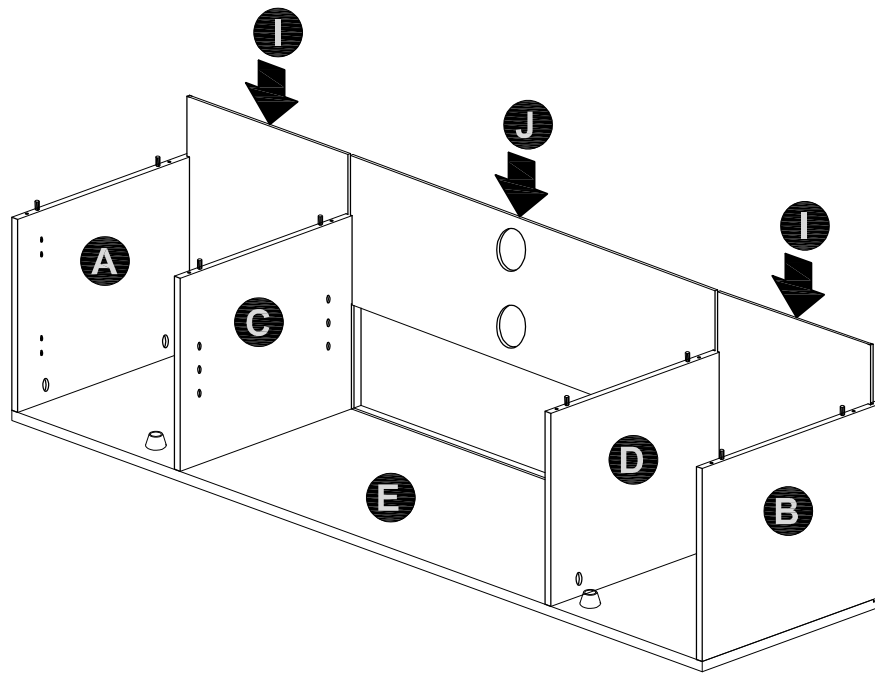

Fit Back Panel (I & J) by inserting the short edges of (I & J) into the groove on vertical side panels (A, B, C & D). Check that the bottom edge of (I & J) fits into the groove on Top Panel (E).

## STEP 8

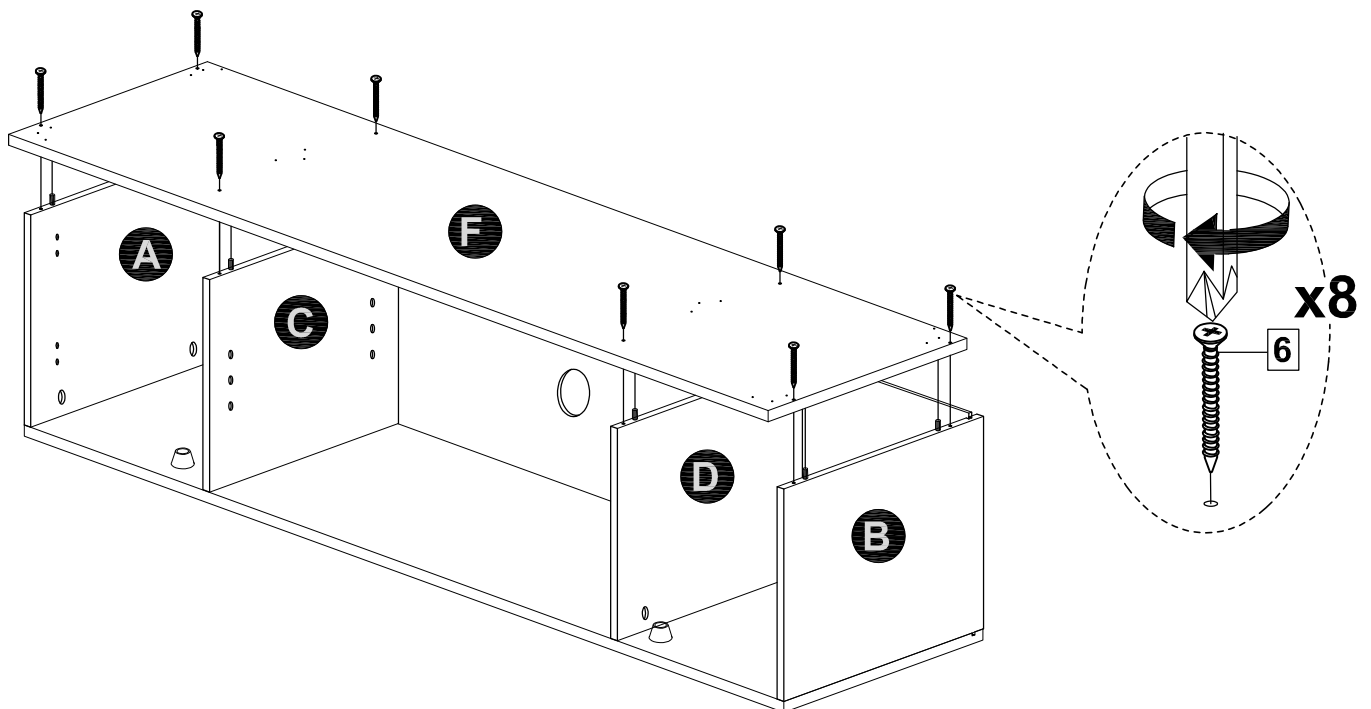

- a) With the bottom-side up, attach Bottom Panel (F) to Right, Left, Center Right and Center Left Panel (A, B, C & D), via Wood Dowels on (A,B,C&D). Check that the top edge of (I&J) fits into the groove on inside surface of (F).
- b) Use Screw (6) to fasten (F) to (A, B, C & D).



# ASSEMBLY INSTRUCTIONS

## STEP 9

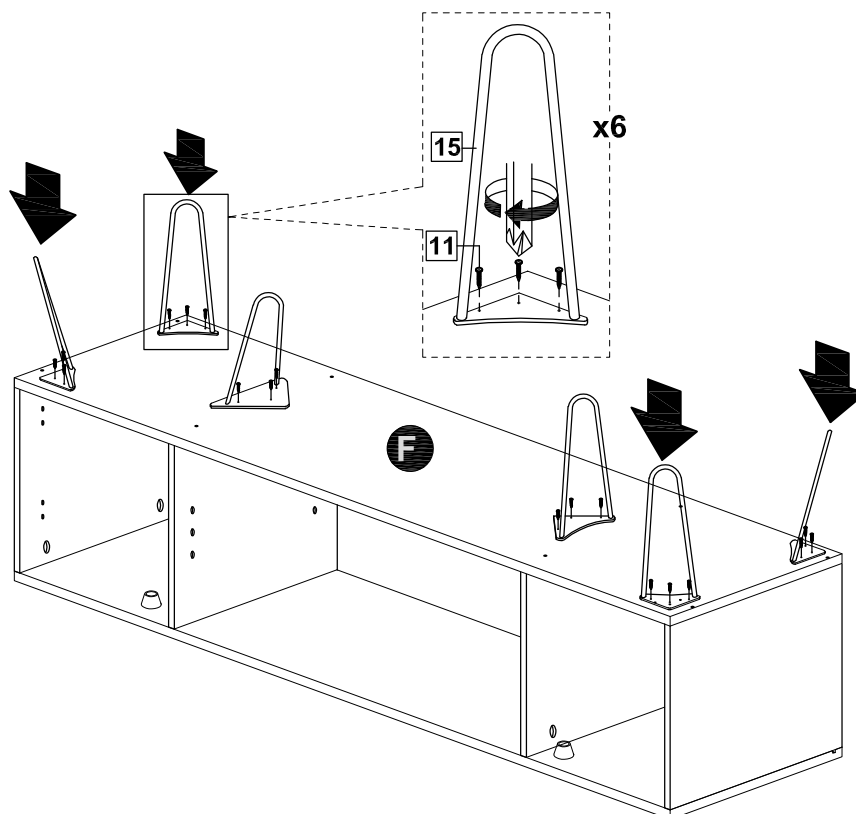

- Position Metal Leg (15) as shown and align the screw holes on base of metal leg to the screw holes on the bottom side of Bottom Panel(F).
- Use Screw (11) to fasten (15) to Bottom Panel (F). Do not tighten Screw (11) completely until all 3 screws are in place.

## STEP 10

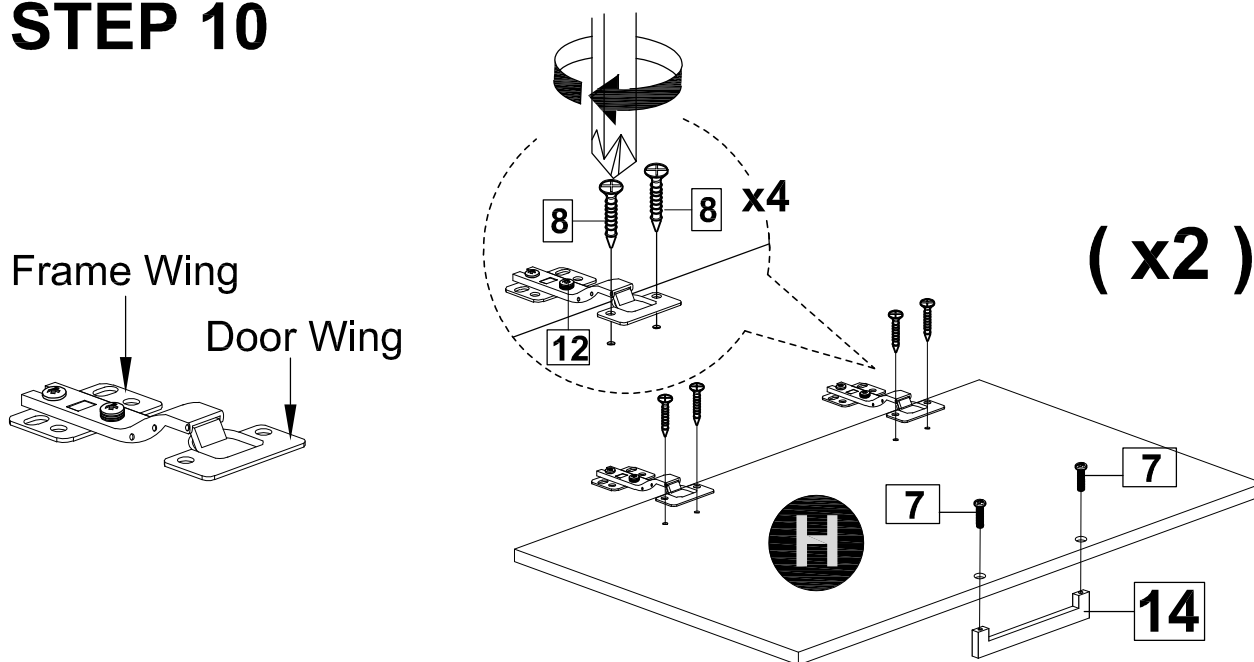

- Lay Door Panel (H) on a material that does not scratch or damage the part with the panel interior side facing up.
- Place door wing of Hinge (12) against the side of Door (H) and align the screw holes on door wing to pilot holes on door.
- Use Screw (8) to fasten door wing of hinge to door. Do not tighten the screw completely until both screws on each door wing are in place.
- Use Screw (7) to fasten Handle (14) as shown.

# ASSEMBLY INSTRUCTIONS

## STEP 11A

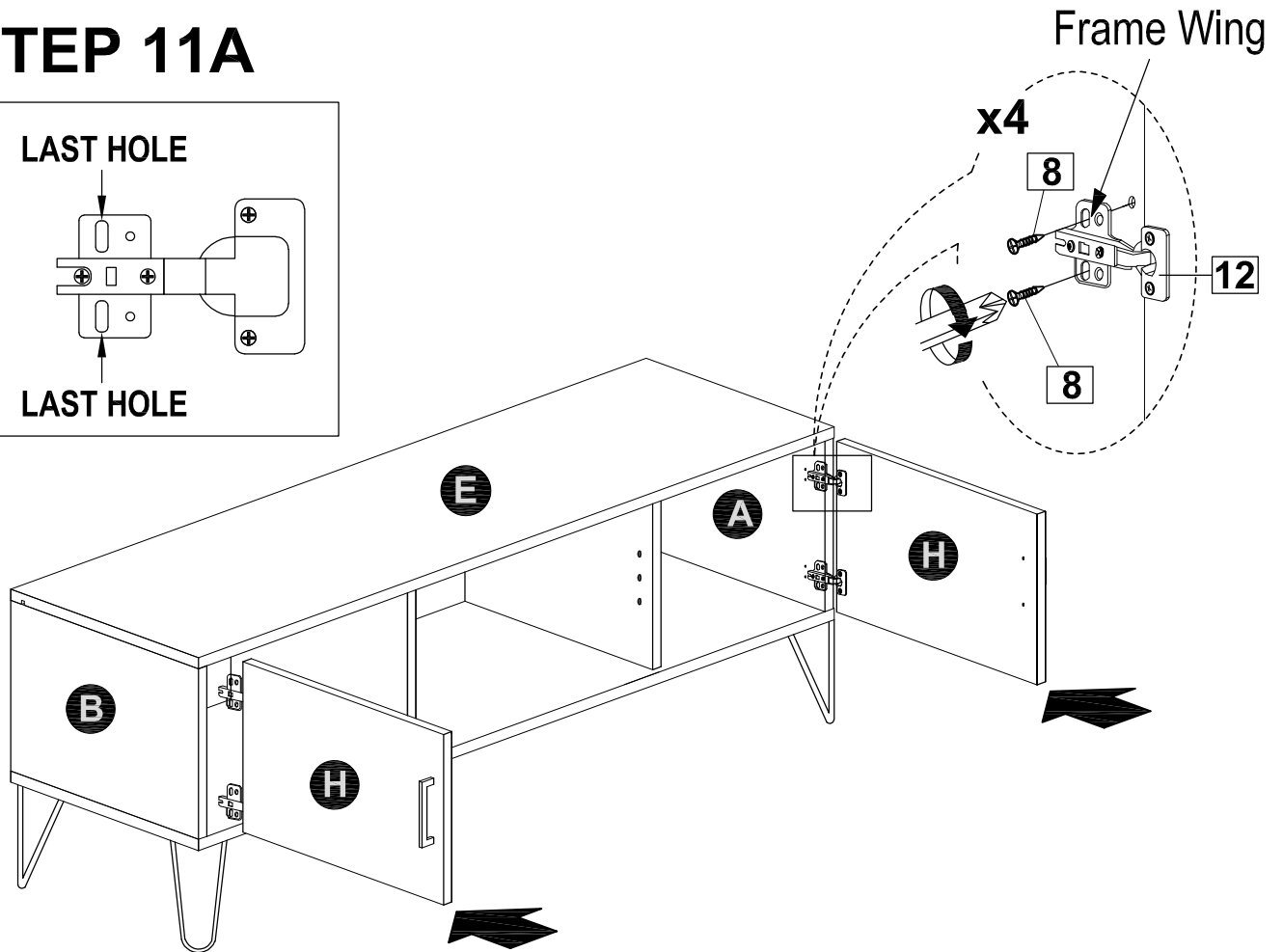
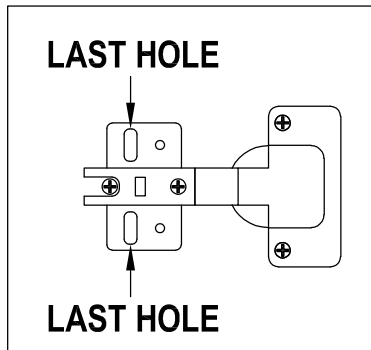

- a) Place frame wing of Hinge (12) against the frame on the Right & Left Panel (A&B) and align the screw holes on frame wing to pilot holes on Right & Left Panel (A&B).
- b) Use Screw (8) to fasten frame wing of hinge to Right & Left Panel (A&B). Do not tighten the screw completely until both screws are in place.

## STEP 11B

### Hinges Adjustment

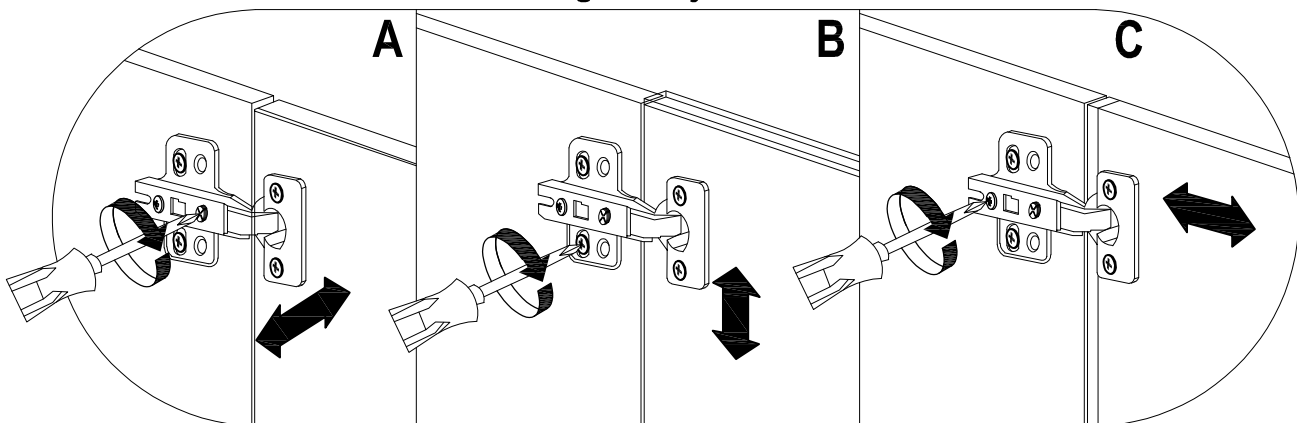

A. Turn front screw to adjust door overlay (sideway).

B. Rotate cam screw on mounting plate to adjust door height.

C. Turn rear screw for door depth adjustment.

# ASSEMBLY INSTRUCTIONS

## STEP 12

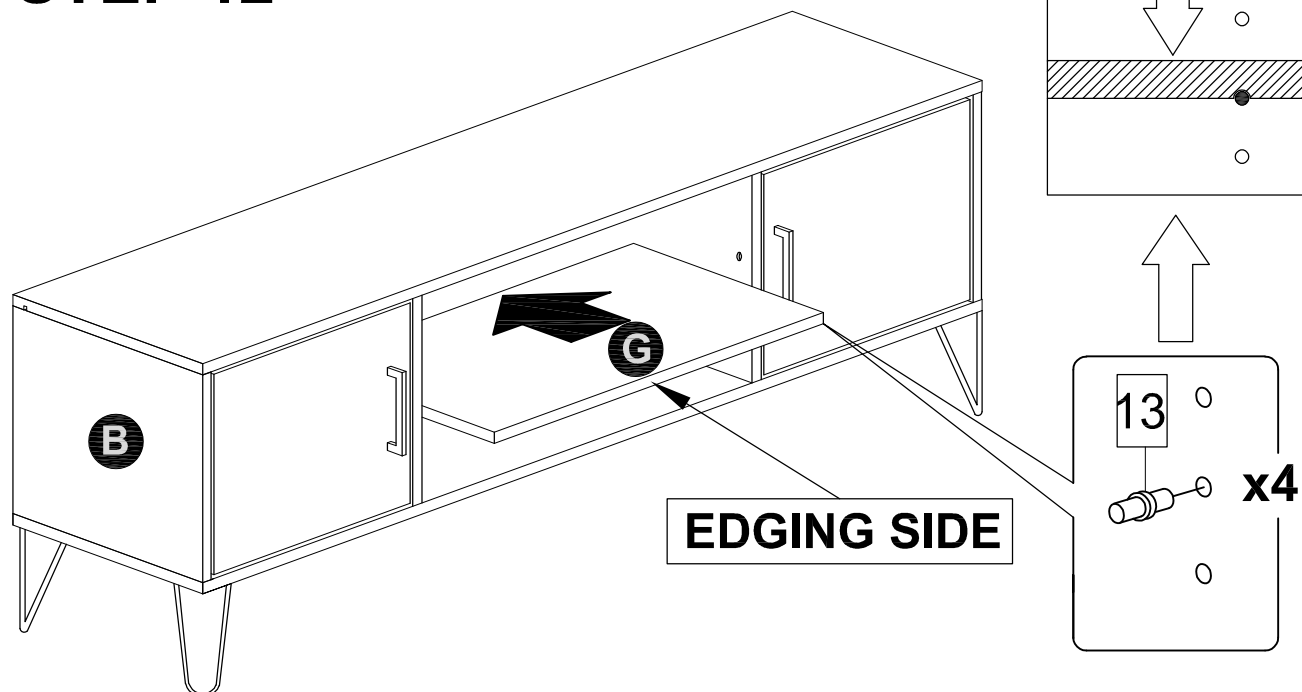

- a) Insert Shelf Stub (13) into the designated holes on the same level at the desired height on Center Panels.  
b) Place Shelf (G) - edging side facing out - by tilting it to fit between Center Panels and then level it to sit on Shelf Stubs.

## STEP 13

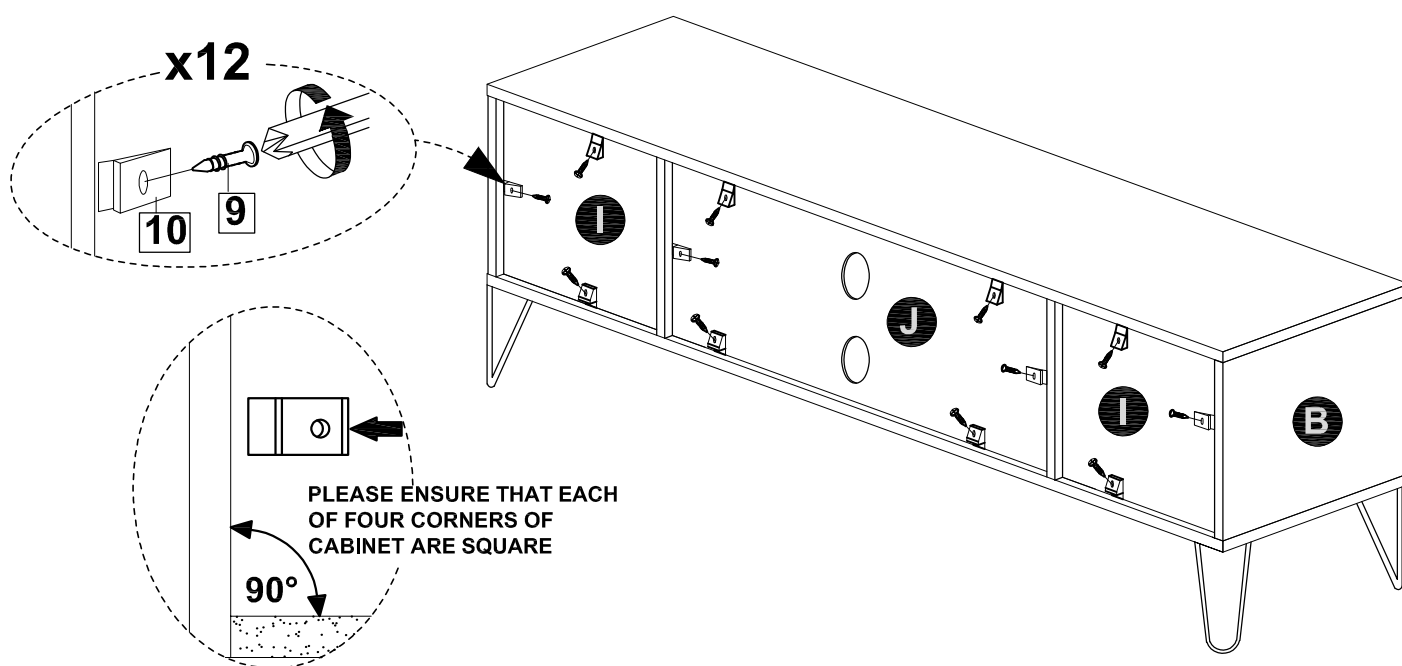

Insert Backply Stopper (10) at each location as shown to fit into the groove and against Back Panel (I & J). Use Screw (9) to fasten Backply Stopper.

## ASSEMBLY INSTRUCTIONS

### STEP 14

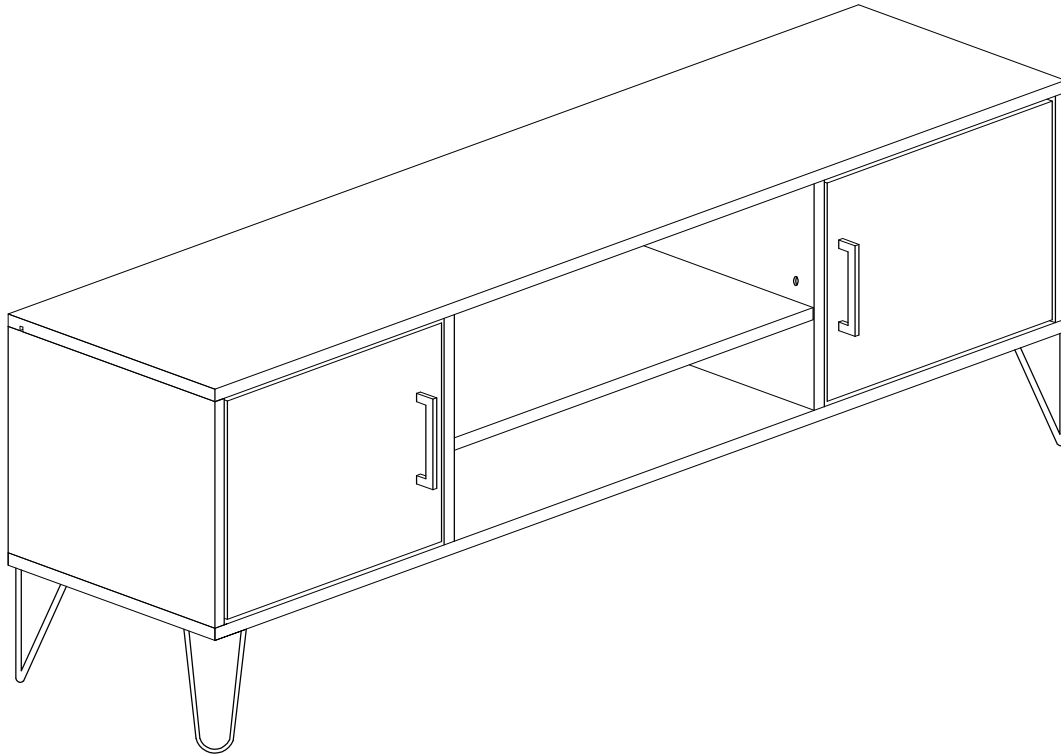

· The assembly of the 1 TV Stand is complete.