

Precautions:

- This product is intended for resin window screen use. Please avoid using it on metal window
- For setup of the frame, please secure it first with included parts.
- For old window screen, it is possible that the screen is wearing out. Please replace it for a one first.
- Please remove the attached dust carefully with the processes below.

Installation procedure

1 Secure the frame by the window screen.

Secure by referring to the vertical line and the bottom line of the frame. Push it against the window screen to allow the protruding parts to pierce through the window screen.

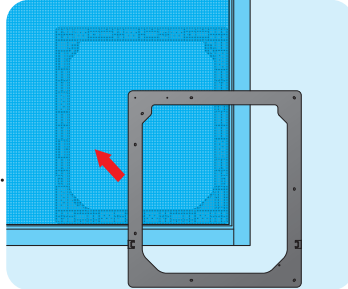

2 Secure the frame with included parts.

Make sure that the secured two frames are not tilted. Fasten the screws with a driver while securing it with your hands.

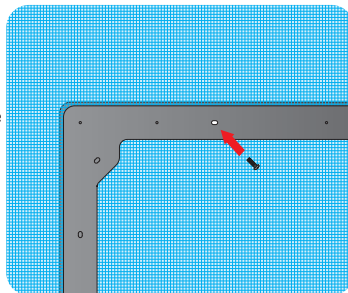

3 Cut out the wire within the frame.

Please cut out the wire within the frame by following the internal border of the frame. (Injuries can occur while handling a sharp object. Please exercise extreme precautions.)

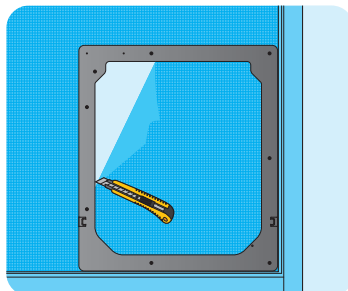

4 Attach the door to the frame.

Bent the door in a shape of a bow while inserting it into the opening at the frame.

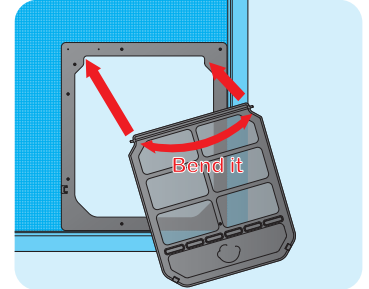

5 Adjust the opening/closing of the door.

If the opening and closing is not optimal, please adjust the metallic part by the lower part of the door so that the magnet can work properly.

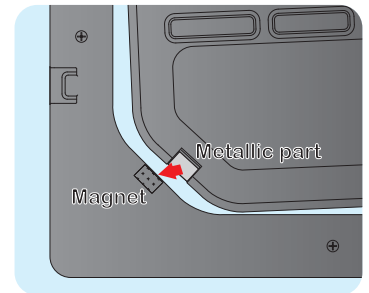

One Point

■ While securing.

If holding the position of the frame is difficult, you can insert pin or other small stick into the openings on the frame in order to secure it!

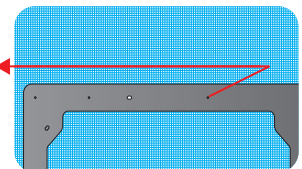

■ For first time use.

It is possible that pet will need some practice before getting used to it.

Specification : Frame 2 PCS / Made from AES Resin
Neodymium Magnet
Door w/Net / Made from AES Resin
Pet Defense
Clasp/Steel

Size : Outline (LxWxTick) 34x31x1.2

⚠ Cautions

1. Avoid placing it in direct contact with heat source or near medical supplies.
2. Do not exert strong force against it or apply medical solution on it.
3. Please avoid using thinner, alcohol, benzene, toilet cleaning solution or nylon brush as it may be damaged during the process.
4. Please take into consideration that door may damage it if it is not used for long period of time or when there is strong wind.
5. Please be careful while opening the sash as the it may come into contact with the door and be damaged during the process.
6. It is possible that scratch mark on the door will occur during usage. This will not affect the functionality.
7. External intrusion from the door opening is possible. Please exercise caution.
8. Our company cannot be held responsible for any accident, damage, or malfunction caused by improper usage of this product or attachment, modification of this product.

□ The maker



TAKARA INDUSTRY CO.,LTD.

タカラ産業株式会社

Address: 2-2-30 Nagata Eminence Bld. 2F,
Nagata Naka, Higashi Osaka-City, Osaka,
577-0013, Japan
TEL: 06-7711-3080
<http://www.takaranet.co.jp>

Distributor