

Assembly Instructions

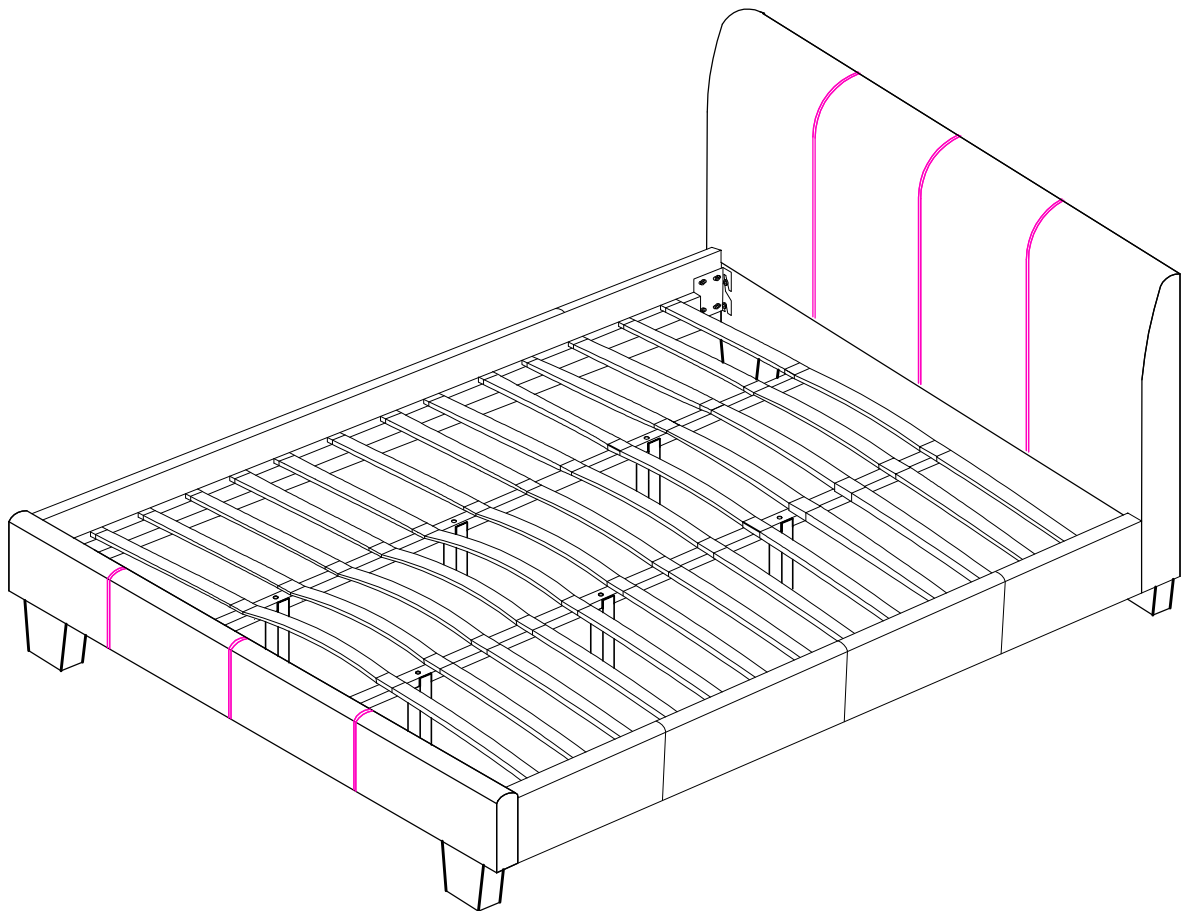

ASSEMBLY RATING

The Assembly Rating is a 5-point system that shows the degree of effort needed in assembling a specific product (with 1 being easy and 5 being difficult). For some products, two persons are recommended.

EASY



DIFFICULT

Tools Required For Assembly:

Allen Wrench

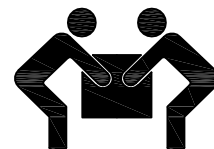
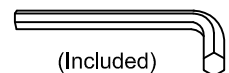

2 PERSONS RECOMMENDED

ASSEMBLY & CARE ADVICE

FOR YOUR FURNITURE TO LAST, CORRECT ASSEMBLY AND PROPER MAINTENANCE ARE NECESSARY. PLEASE FOLLOW THE INFORMATION PROVIDED BELOW TO FULLY ENJOY YOUR FURNITURE.

BASIC ASSEMBLY TECHNIQUES

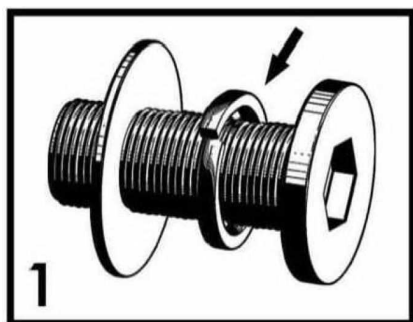

When lock or spring washer is used in an assembly, please make sure the lock or spring washer is placed between the larger flat washer and the head of the screw or bolt.

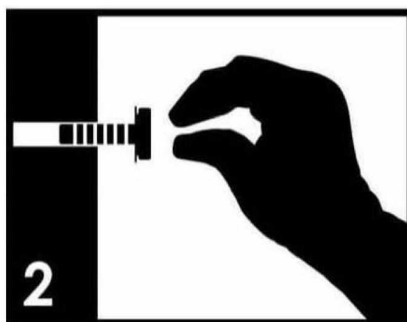

Position each part correctly and insert screws or bolts into their respective holes by hand tighten or using the proper hand tool. Only tighten when step is completed or when instructed to do so.

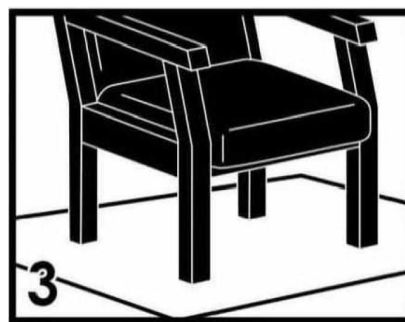

Use cardboard or carpet area when assembling furniture to prevent scratches. Make sure the furniture rests on a flat and level surface with each leg evenly touching the floor.

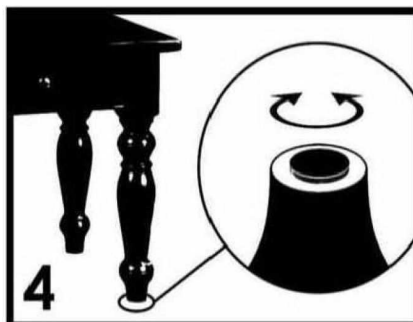

Some furniture comes with height adjustment knobs underneath each leg. To lower or to raise each leg, you need to turn clockwise or counterclockwise, respectively.

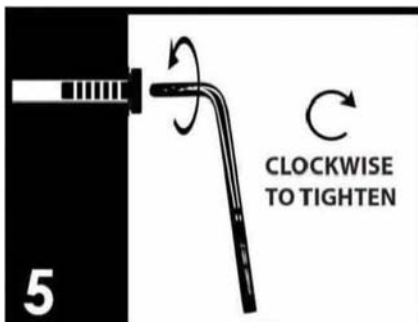

Make sure all parts are properly aligned, then use the appropriate hand tool to completely tighten the bolts or screws. Do not use power tools and do not overtighten.

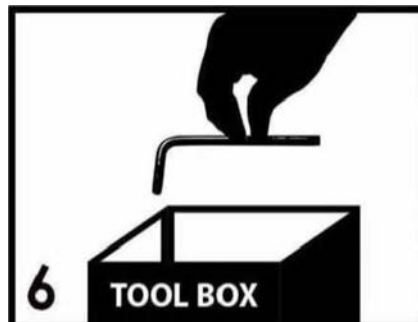

Save the instructions and store the Allen wrench or any supplied tool for later maintenance. After two weeks, check and tighten any loose hardware and repeat again every six months thereafter.

IT IS THE USER'S RESPONSIBILITY TO MAINTAIN THE FURNITURE. THE HARDWARE MAY LOOSEN OVER TIME AND MAY CAUSE THE FURNITURE TO BE WOBBLY AND UNABLE TO SUPPORT ITS INTENDED WEIGHT CAPACITY. THIS MAY LEAD TO COLLAPSE AND MAY CAUSE SERIOUS INJURY.

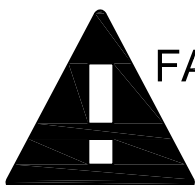

FAILURE TO FOLLOW THE GUIDELINES ABOVE MAY RESULT IN INJURY AND/OR PROPERTY DAMAGE.



Before you begin, please read Page 2 of "Assembly and Care Advice".

And remember, do not tighten until each step is completed or instructed.

Parts List

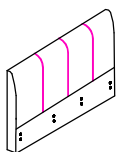

#1 x 1pc
Headboard

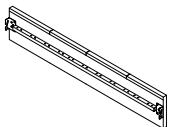

#2 x 2pcs
Side Rail

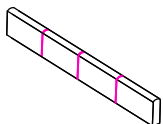

#3 x 1pc
Footboard

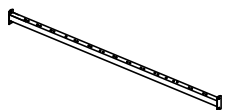

#4 x 2pcs
Central Support Rail

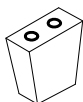

#5 x 4pcs
Legs



#6 x39pcs
Slat

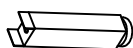

#7 x6pcs
Support Rail Leg

Hardware List



#A x 8pcs
Bolt 5/16"x1-3/8"

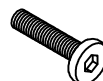

#B x 14pcs
Bolt 5/16"x1-1/2"

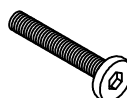

#C x 8pcs
Bolt 5/16"x4"



#D x 30pcs
Lock Washer



#E x 30pcs
Flat Washer



#F x 26pcs
Center Connector



#G x 26pcs
End Cap



#H x 1pc
Allen Wrench M5



#1

#Cx 8pcs
#Dx 8pcs
#Ex 8pcs

- I. Align the legs (#5) to the pre-drilled holes located on the bottom of the headboard (#1) and footboard (#3).
- II. Prepare 8 bolt assemblies by FIRST inserting the lock washer (#D) onto the bolt (#C) then the flat washer (#E) onto that SAME bolt (#C), in that order. Secure using the Allen wrench (#H).

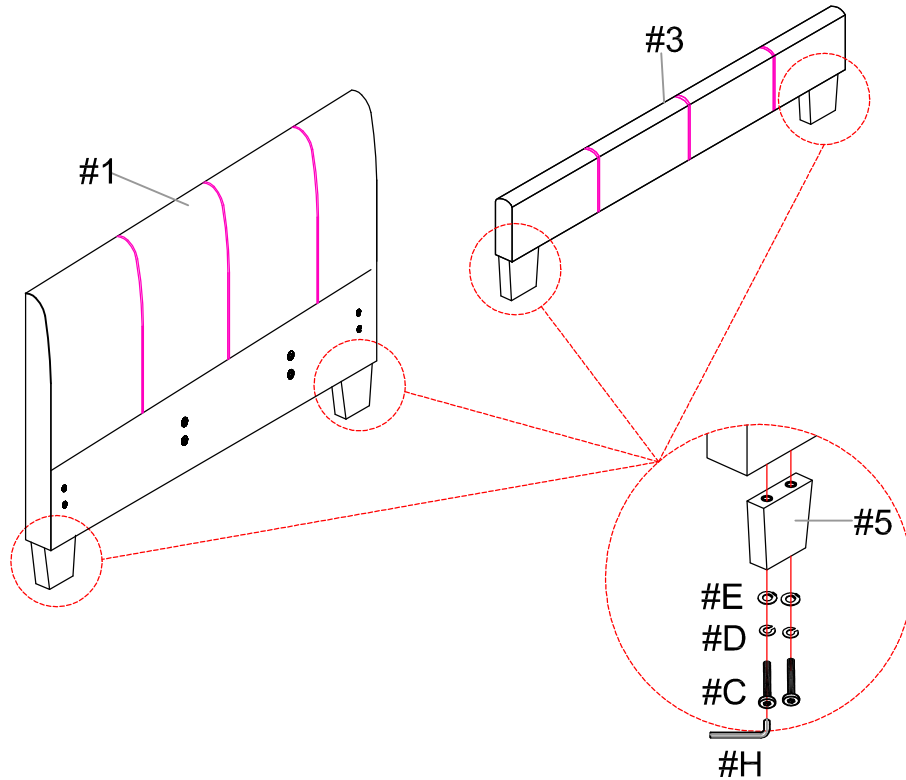

#2

#Ax 8pcs
#Dx 8pcs
#Ex 8pcs

- I. Align the hooks on the ends of the side rails (#2) to the pre-drilled holes on the headboard (#1) and footboard (#2).
- II. Prepare 8 bolt assemblies by FIRST inserting the lock washer (#D) onto the bolt (#A) then the flat washer (#E) onto that SAME bolt (#A), in that order. Secure using the Allen wrench (#H).

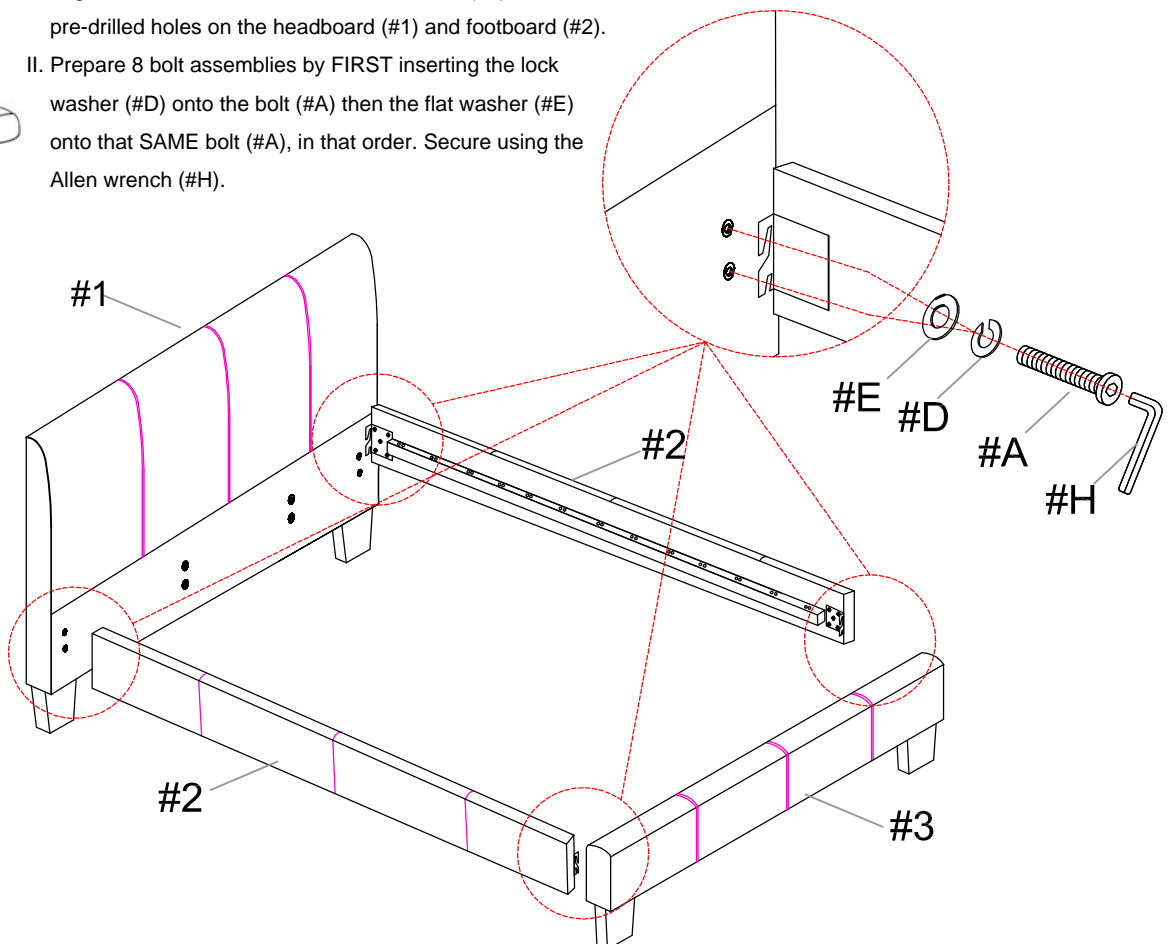



#3

#B x 6pcs
#D x 6pcs
#E x 6pcs

- I. Align the support rail legs (#7) to the pre-drilled holes on the central support rails (#4).
- II. Prepare 6 bolt assemblies by FIRST inserting the lock washer (#D) onto the bolt (#B) then the flat washer (#E) onto that SAME bolt (#B), in that order. Secure using the Allen wrench (#H).

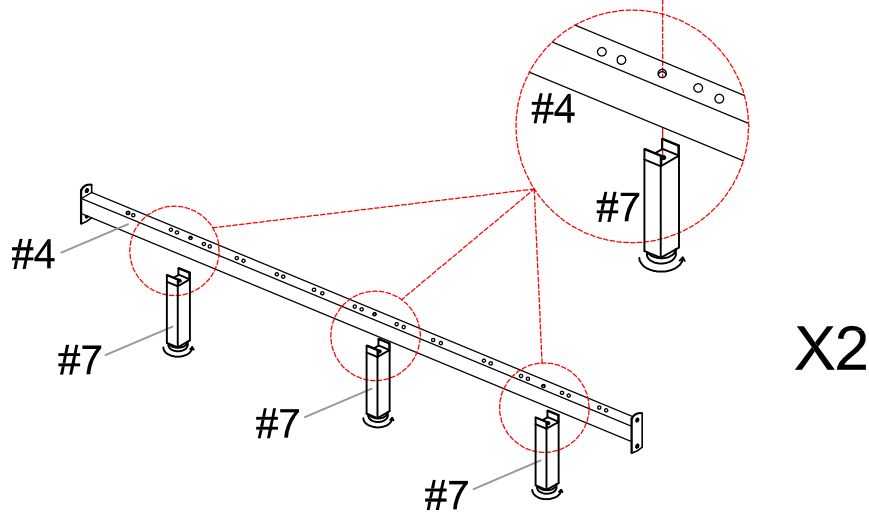
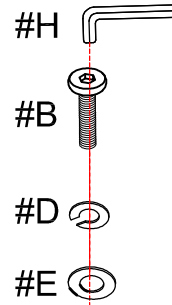

#4

#B x 8pcs
#D x 8pcs
#E x 8pcs

- I. Align the ends of the central support rails (#4) to the headboard (#1) and footboard (#3).
- II. Prepare 8 bolt assemblies by FIRST inserting the lock washer (#D) onto the bolt (#B) then the flat washer (#E) onto that SAME bolt (#B), in that order. Secure using the Allen wrench (#H).

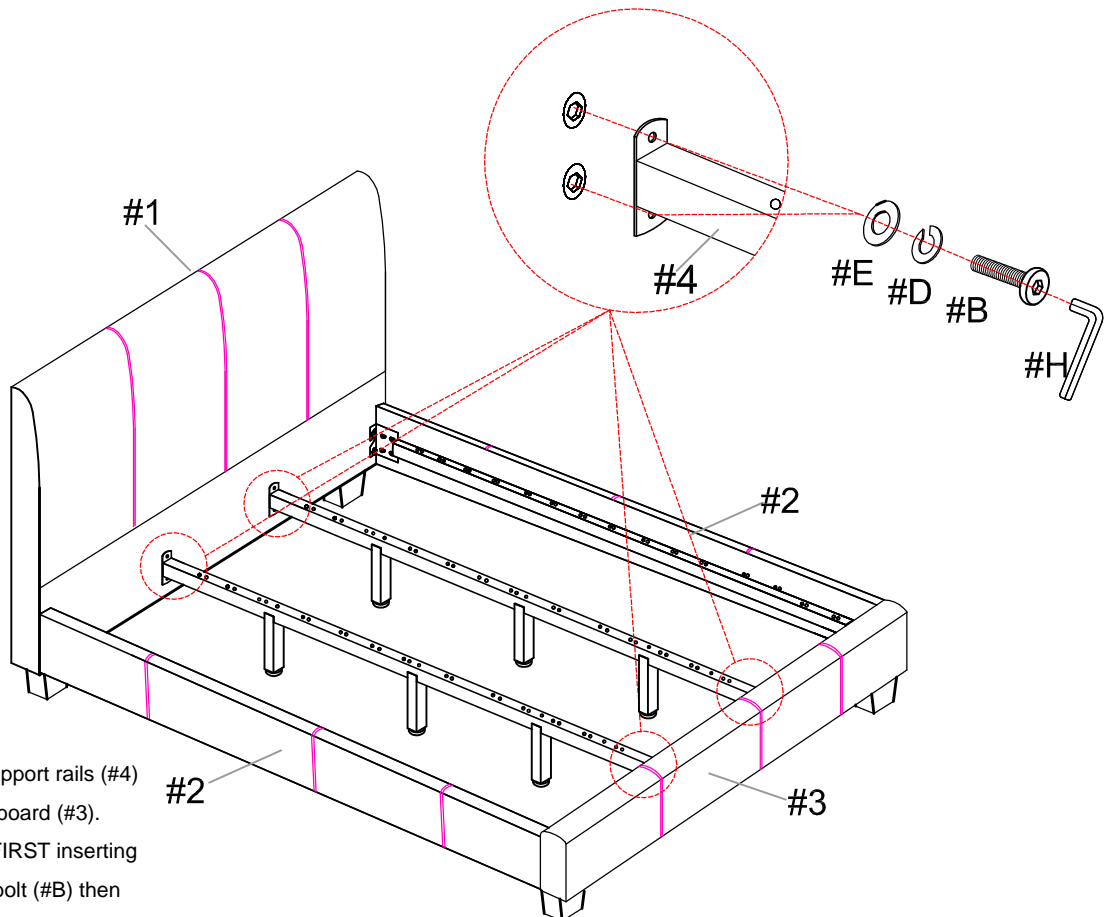



#F x 26pcs
#G x 26pcs

- I. Prepare a total of 13 complete slats by inserting an end cap (#G) onto a slat (#6) then the center connector (#F) followed by another slat (#6) a center connector (#F) another slat (#6) and finally an end cap (#G), in that order. (Displayed below)
- II. Place all 13 completed slats onto the rails.

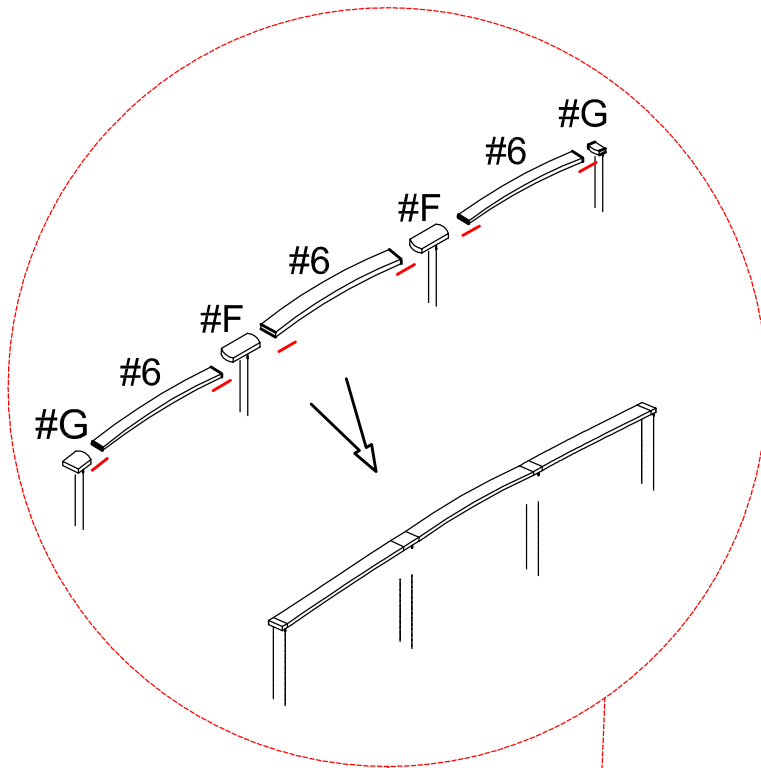

Note: The correct position of the bed slats should be arcing UPWARD when placing on the rails.

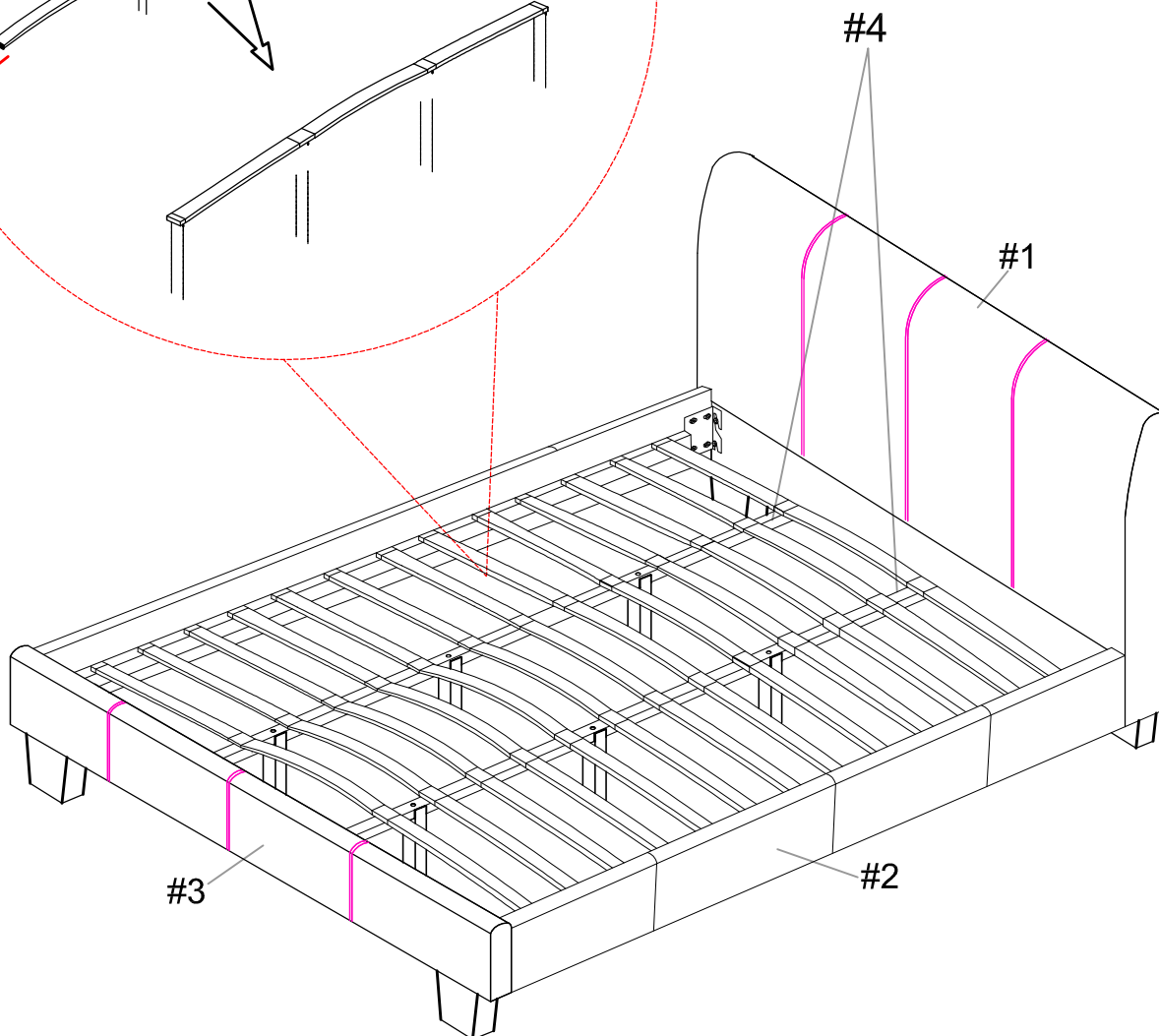

ASSEMBLY IS COMPLETED

Assembly Instructions

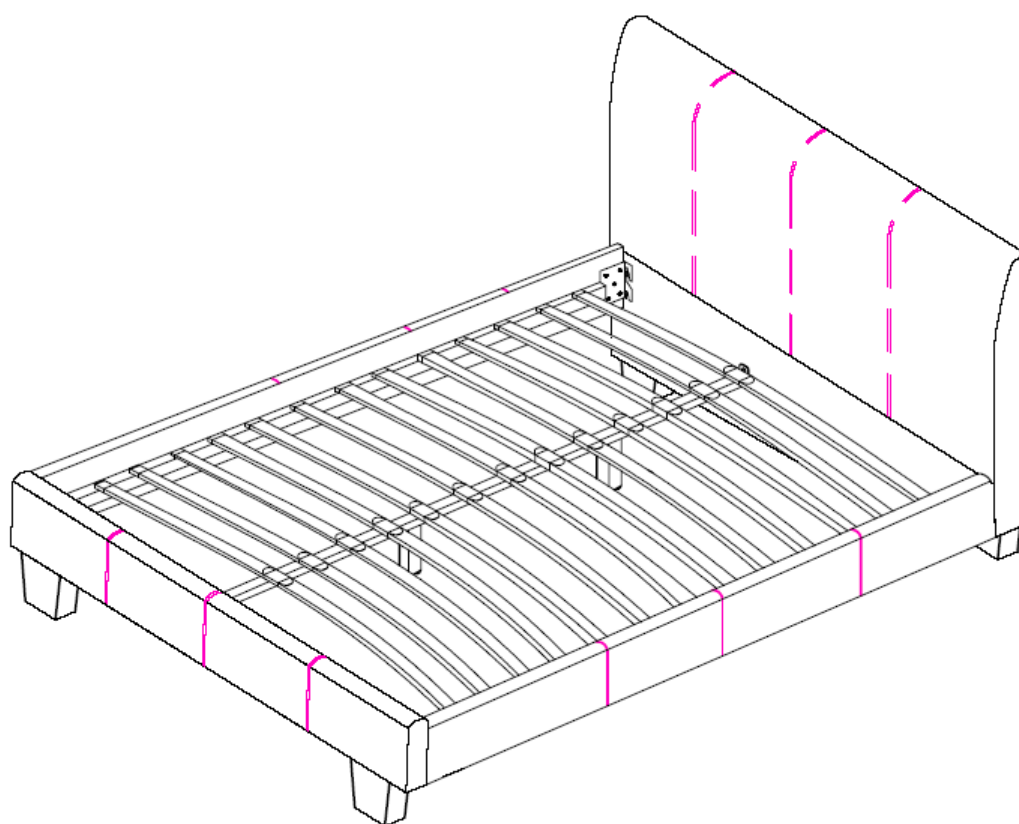

ASSEMBLY RATING

The Assembly Rating is a 5-point system that shows the degree of effort needed in assembling a specific product (with 1 being easy and 5 being difficult). For some products, two persons are recommended.

EASY  DIFFICULT

Tools Required for Assembly:

Allen Wrench

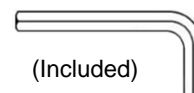

(Included)



2 PERSONS RECOMMENDED

ASSEMBLY & CARE ADVICE

FOR YOUR FURNITURE TO LAST, CORRECT ASSEMBLY AND PROPER MAINTENANCE ARE NECESSARY.
PLEASE FOLLOW THE INFORMATION PROVIDED BELOW TO FULLY ENJOY YOUR FURNITURE.

BASIC ASSEMBLY TECHNIQUES

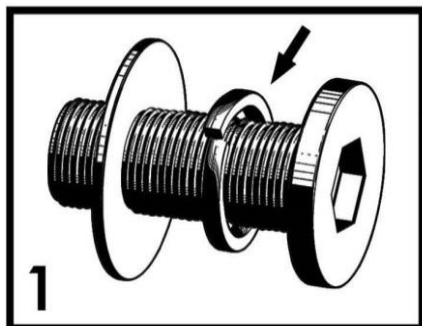

When lock or spring washer is used in an assembly, please make sure the lock or spring washer is placed between the larger flat washer and the head of the screw or bolt.

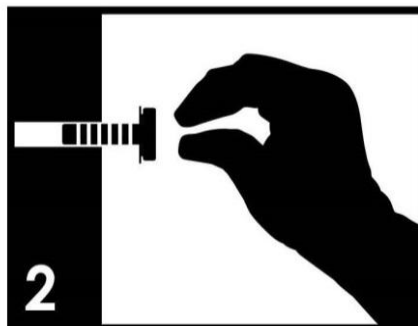

Position each part correctly and insert screws or bolts into their respective holes by hand tighten or using the proper hand tool. Only tighten when step is completed or when instructed to do so.

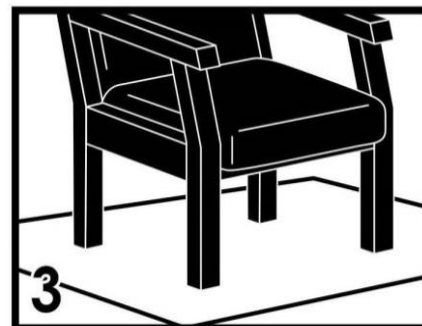

Use cardboard or carpet area when assembling furniture to prevent scratches. Make sure the furniture rests on a flat and level surface with each leg evenly touching the floor.

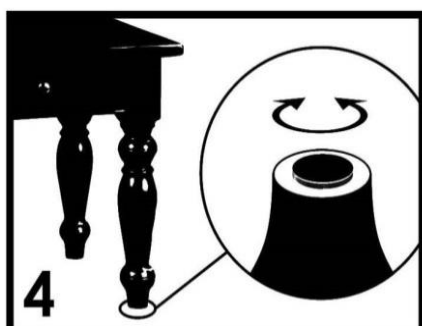

Some furniture comes with height adjustment knobs underneath each leg. To lower or to raise each leg, you need to turn clockwise or counterclockwise, respectively.

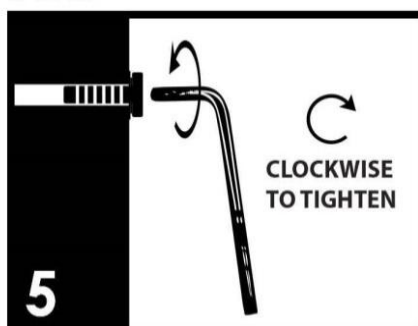

Make sure all parts are properly aligned, then use the appropriate hand tool to completely tighten the bolts or screws. Do not use power tools and do not overtighten.

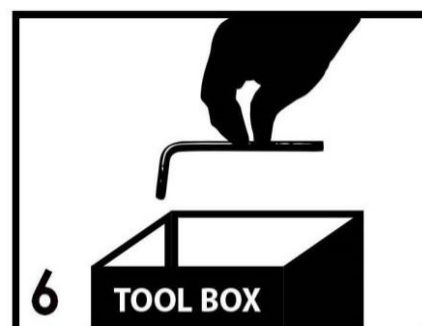

Save the instructions and store the Allen wrench or any supplied tool for later maintenance. After two weeks, check and tighten any loose hardware and repeat again every six months thereafter.

IT IS THE USER'S RESPONSIBILITY TO MAINTAIN THE FURNITURE. THE HARDWARE MAY LOOSEN OVER TIME AND MAY CAUSE THE FURNITURE TO BE WOBBLY AND UNABLE TO SUPPORT ITS INTENDED WEIGHT CAPACITY. THIS MAY LEAD TO COLLAPSE AND MAY CAUSE SERIOUS INJURY.



FAILURE TO FOLLOW THE GUIDELINES ABOVE MAY
RESULT IN INJURY AND/OR PROPERTY DAMAGE.

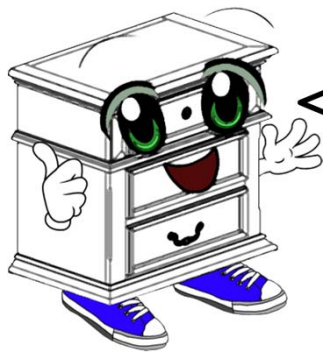



Before you begin, please read Page 2 of "Assembly and Care Advice".





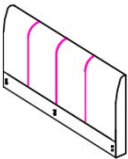
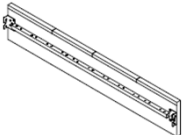
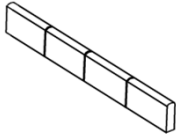

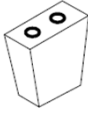
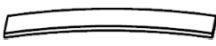
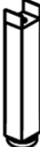
And remember, do not tighten until each step is completed or instructed.

MD

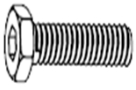
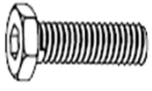
Parts List

	#1 x 1 pc Headboard
	#2 x 2 pcs Side Rail
	#3 x 1 pc Footboard
	#4 x 1 pc Support Rail
	#5 x 4 pcs HB/FB Foot
	#6 x 26 pcs Slat
	#7 x 2 pcs Support Rail Leg

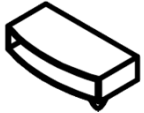
Hardware List

	#A x 8 pcs Bolt 5/16"x1"
	#B x 6 pcs Bolt 5/16"x1-1/2"
	#C x 8 pcs Bolt 5/16"x4"
	#D x 22 pcs Lock Washer
	#E x 22 pcs Flat Washer
	#F x 13 pcs Center Connector
	#G x 26 pcs End Cap
	#H x 1 pc Allen Wrench



Due to the size and/or weight of this product, it is highly recommended that the assembly should be done near the area of its intended location. Make sure you have enough space to move around during the assembly. ALWAYS have at least two people to help with transporting and assembling the product to avoid any potential injury and/or damage.



- I. Align the two HB/FB feet (#5) with the pre-drilled holes underneath the headboard (#1).
- II. Prepare 4 bolt assemblies by inserting FIRST the lock washer (#D) onto the bolt (#C) and then the flat washer (#E) onto the SAME bolt (#C), in that order.
- III. Insert the bolt assemblies through the holes of the two HB/FB feet (#5) and secure those bolts using the Allen wrench (#H) to lock them with the headboard (#1).
- IV. Repeat the process above to assemble the remaining two HB/FB feet (#5) onto the footboard (#3).

#C x 8 pcs
#D x 8 pcs
#E x 8 pcs

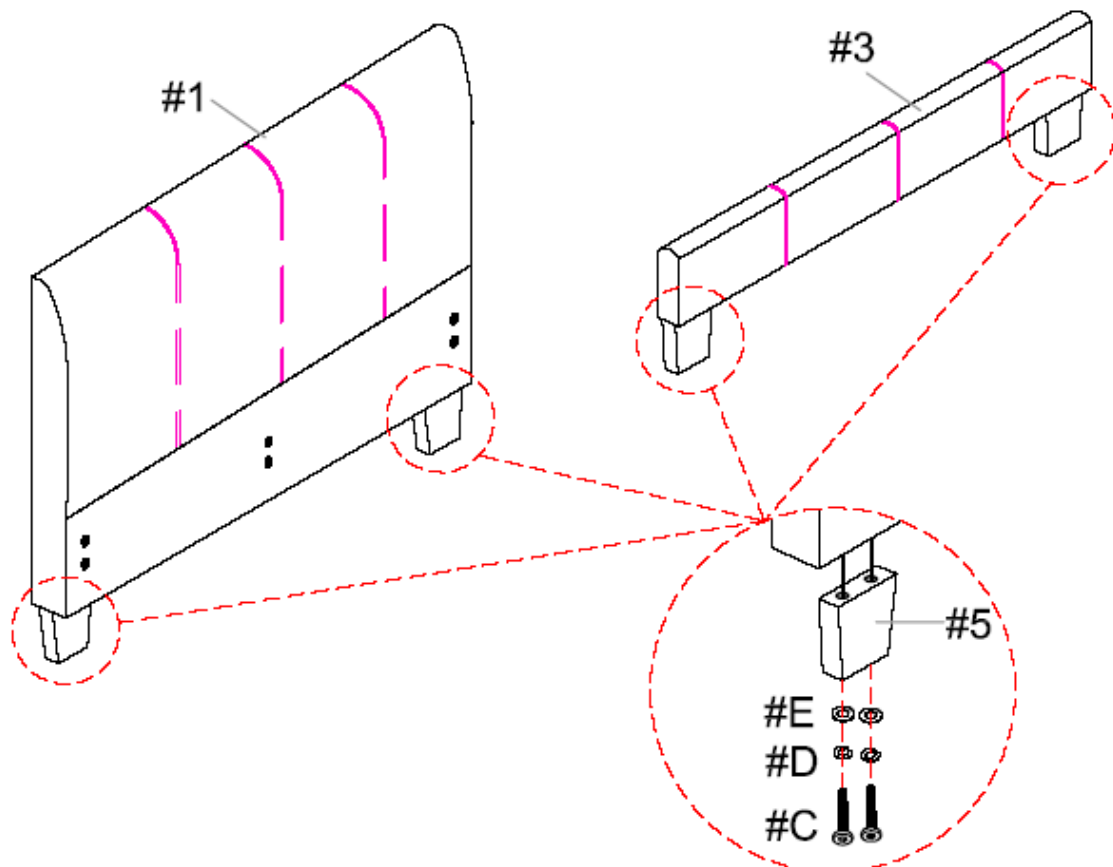

Turn right (clockwise) to tighten



Turn right (clockwise) to tighten

#B x 2 pcs
#D x 2 pcs
#E x 2 pcs

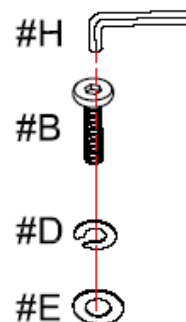

- I. Align the 2 support rail legs (#7) with the pre-drilled holes of the support rail (#4).
- II. Prepare 2 bolt assemblies by inserting FIRST the lock washer (#D) onto the bolt (#B) and then the flat washer (#E) onto the SAME bolt (#B), in that order.
- III. Insert the bolt assemblies through the pre-drilled holes of the support rail (#4) using the Allen wrench (#H) to lock them with the 2 slat support legs (#7).

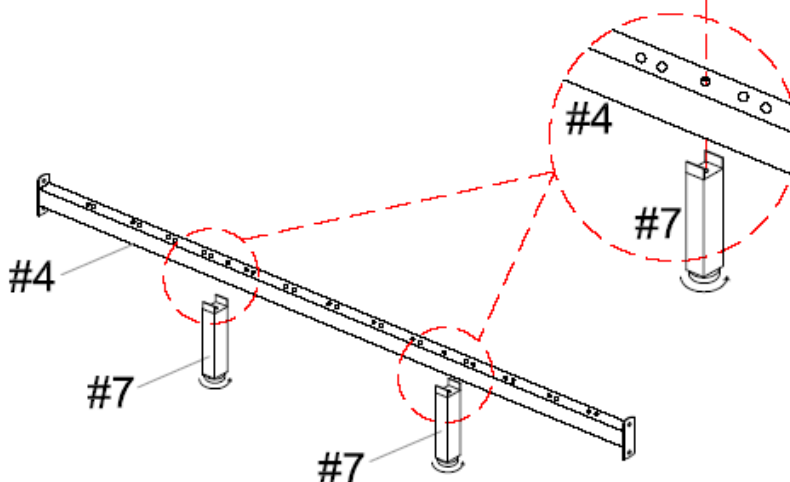

Adjust the levelers on the support rail legs (#7) according to the ground level on Step 4.



#A x 8 pcs
#D x 8 pcs
#E x 8 pcs

- I. Prepare 4 bolt assemblies by inserting FIRST the lock washer (#D) onto the bolt (#A) and then the flat washer (#E) onto the SAME bolt (#A), in that order.
- II. Insert the bolt assemblies through the right and left side of the pre-drilled holes of the headboard (#1) using the Allen wrench (#H) but expose about 1/2" of the bolts' threads.
- III. Mount the brackets on the side rails (#2) onto the bolts (#A) on each side of the headboard (#1). Make sure all the washers are in the FRONT of the brackets. Use the Allen wrench (#H) to further tighten the bolts to secure the two parts together.
- IV. Repeat the process above to assemble the other ends of the 2 side rails (#2) onto the footboard (#3).

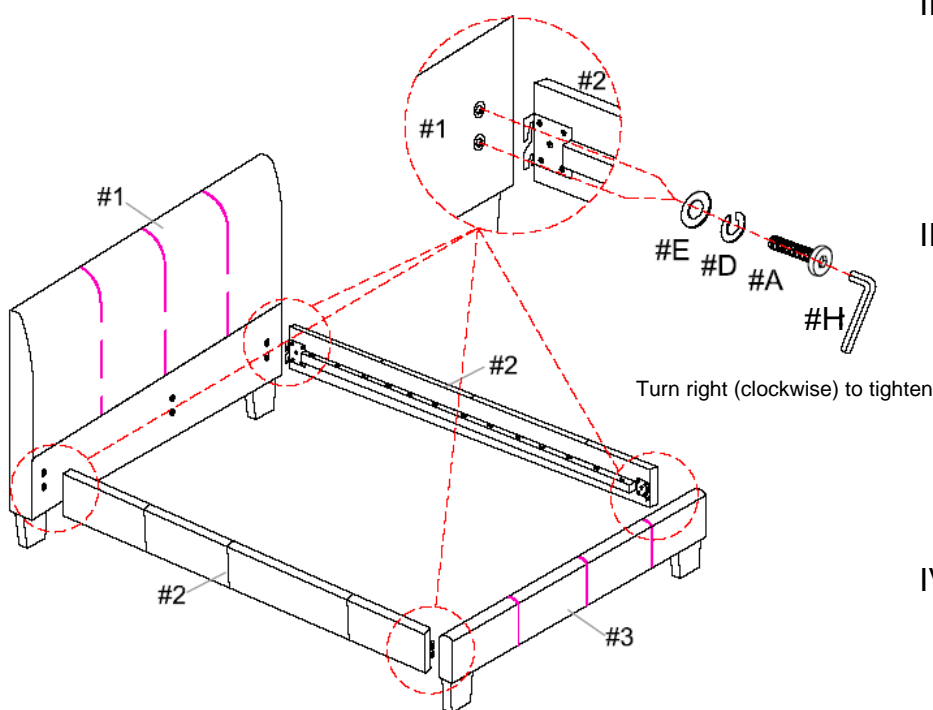



#B x 4 pcs
#D x 4 pcs
#E x 4 pcs

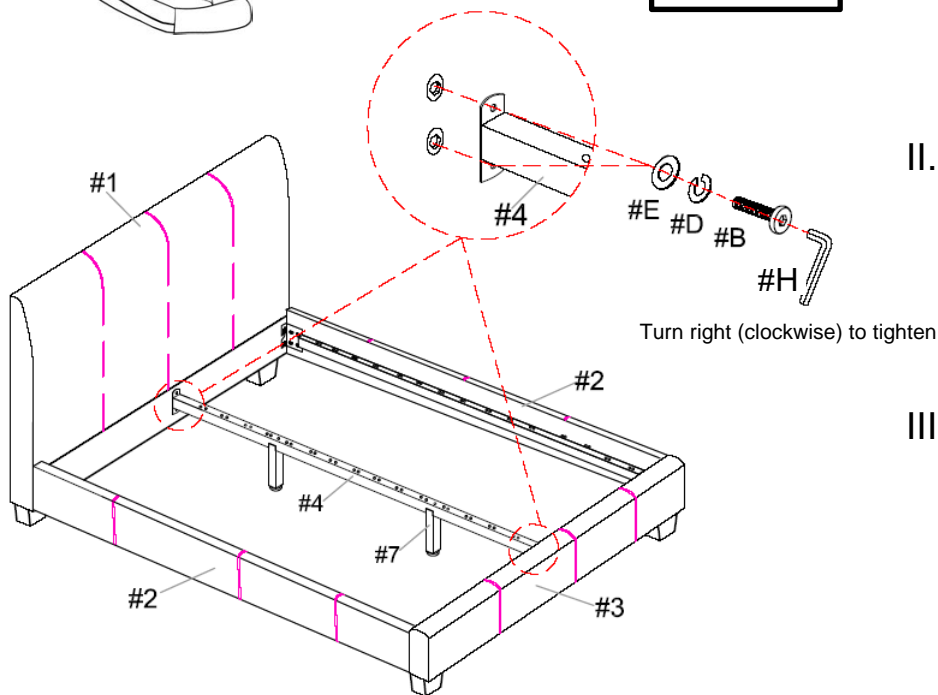

- I. Align the assembled support rail (#4) with the pre-drilled holes on the center of the headboard (#1) and the footboard (#3).
- II. Prepare 4 bolt assemblies by inserting FIRST the lock washer (#D) onto the bolt (#B) and then the flat washer (#E) onto the SAME bolt (#B), in that order.
- III. Insert the bolt assemblies through the brackets of the support rail (#4) using the Allen wrench (#H) to lock them with the headboard (#1) and the footboard (#3).

Adjust the levelers according to the ground level. To lower or to raise the support rail legs, turn the levelers clockwise or counterclockwise, respectively.



Note: The correct position of the bed slats should be arcing UPWARD when placing on the rails.

#F x 13 pcs
#G x 26 pcs

- I. Prepare a bed slat using two slats (#6), one center connector (#F) and two end caps (#G). See diagram for the correct sequence in connecting those parts.
- II. Align the end caps (#G) with the pre-drilled holes on each side of the side rails (#2) and press firmly down on both end caps (#G) to lock with the side rails (#2). Then press firmly down on the center connector (#F) to lock with the support rail (#4).
- III. Repeat the process above to assemble the remaining bed slats onto the side rails (#2) and the support rail (#4).
- IV. Make sure the bed is rested on a flat surface and does not feel loose or wobbly. If it does, double check that the bolts/screws are secured and properly tightened.

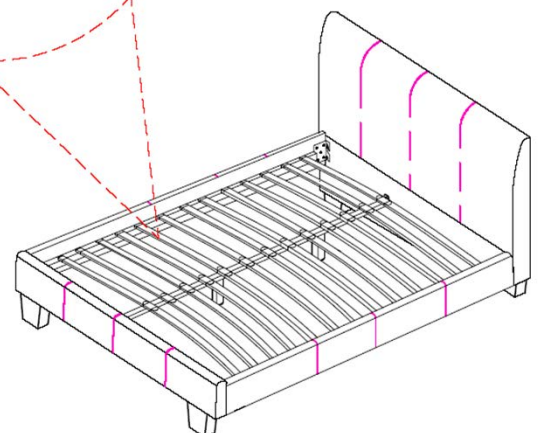
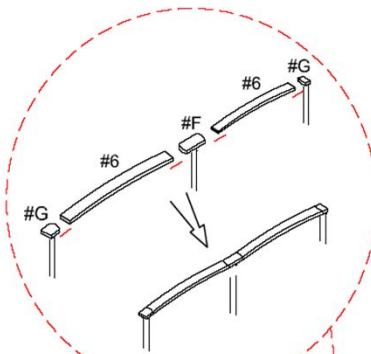

ASSEMBLY IS COMPLETED

Assembly Instructions

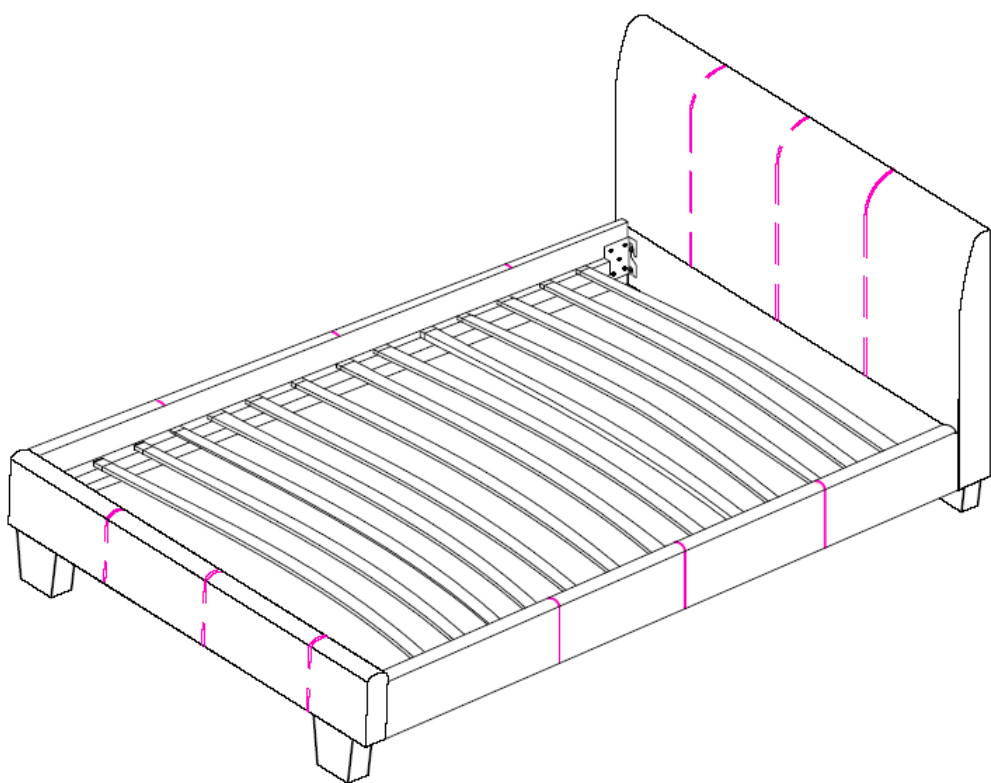

ASSEMBLY RATING

The Assembly Rating is a 5-point system that shows the degree of effort needed in assembling a specific product (with 1 being easy and 5 being difficult). For some products, two persons are recommended.

Tools Required for Assembly:

Allen Wrench

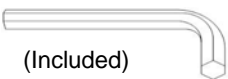

(Included)



2 PERSONS RECOMMENDED

EASY  DIFFICULT

ASSEMBLY & CARE ADVICE

FOR YOUR FURNITURE TO LAST, CORRECT ASSEMBLY AND PROPER MAINTENANCE ARE NECESSARY.
PLEASE FOLLOW THE INFORMATION PROVIDED BELOW TO FULLY ENJOY YOUR FURNITURE.

BASIC ASSEMBLY TECHNIQUES

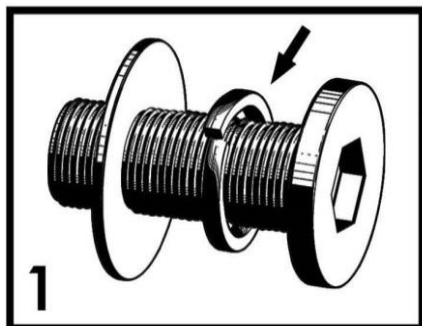

When lock or spring washer is used in an assembly, please make sure the lock or spring washer is placed between the larger flat washer and the head of the screw or bolt.

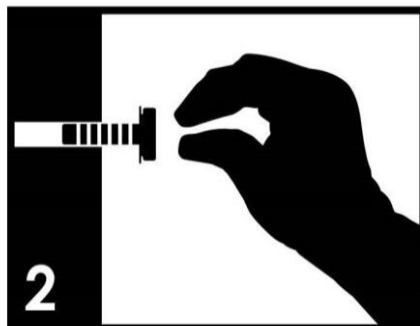

Position each part correctly and insert screws or bolts into their respective holes by hand tighten or using the proper hand tool. Only tighten when step is completed or when instructed to do so.

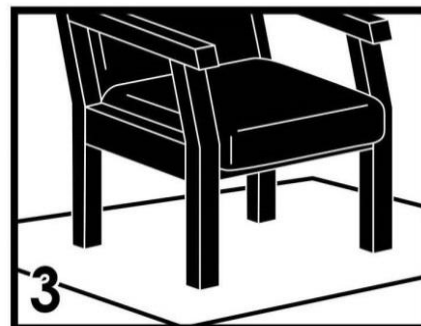

Use cardboard or carpet area when assembling furniture to prevent scratches. Make sure the furniture rests on a flat and level surface with each leg evenly touching the floor.

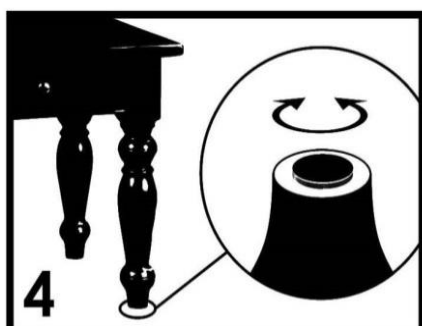

Some furniture comes with height adjustment knobs underneath each leg. To lower or to raise each leg, you need to turn clockwise or counterclockwise, respectively.

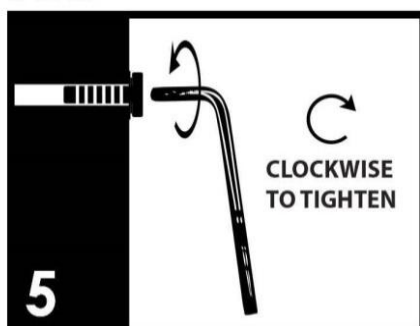

Make sure all parts are properly aligned, then use the appropriate hand tool to completely tighten the bolts or screws. Do not use power tools and do not overtighten.



Save the instructions and store the Allen wrench or any supplied tool for later maintenance. After two weeks, check and tighten any loose hardware and repeat again every six months thereafter.

IT IS THE USER'S RESPONSIBILITY TO MAINTAIN THE FURNITURE. THE HARDWARE MAY LOOSEN OVER TIME AND MAY CAUSE THE FURNITURE TO BE WOBBLY AND UNABLE TO SUPPORT ITS INTENDED WEIGHT CAPACITY. THIS MAY LEAD TO COLLAPSE AND MAY CAUSE SERIOUS INJURY.



FAILURE TO FOLLOW THE GUIDELINES ABOVE MAY
RESULT IN INJURY AND/OR PROPERTY DAMAGE.

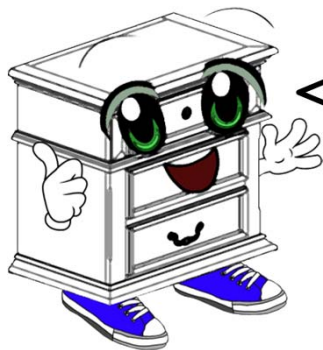



Before you begin, please read Page 2 of "Assembly and Care Advice".



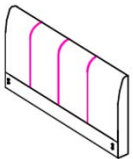
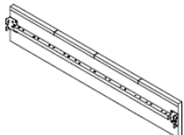
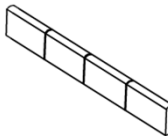
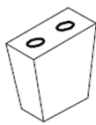

And remember, do not tighten until each step is completed or instructed.

MD

Parts List

	#1 x 1 pc Headboard
	#2 x 2 pcs Side Rail
	#3 x 1 pc Footboard
	#4 x 4 pcs HB/FB Foot
	#5 x 13 pcs Slat

Hardware List

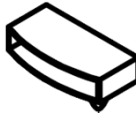
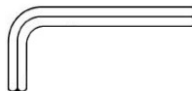
	#A x 8 pcs Bolt 5/16"x1"
	#B x 8 pcs Bolt 5/16"x4"
	#C x 16 pcs Lock Washer
	#D x 16 pcs Flat Washer
	#E x 26 pcs End Cap
	#F x 1 pc Allen Wrench



Due to the size and/or weight of this product, it is highly recommended that the assembly should be done near the area of its intended location. Make sure you have enough space to move around during the assembly. ALWAYS have at least two people to help with transporting and assembling the product to avoid any potential injury and/or damage.



- I. Align the two HB/FB feet (#4) with the pre-drilled holes underneath the headboard (#1).
- II. Prepare 4 bolt assemblies by inserting FIRST the lock washer (#C) onto the bolt (#B) and then the flat washer (#D) onto the SAME bolt (#B), in that order.
- III. Insert the bolt assemblies through the holes of the two HB/FB feet (#4) and secure those bolts using the Allen wrench (#F) to lock them with the headboard (#1).
- IV. Repeat the process above to assemble the remaining two HB/FB feet (#4) onto the footboard (#3).

#B x 8 pcs
#C x 8 pcs
#D x 8 pcs

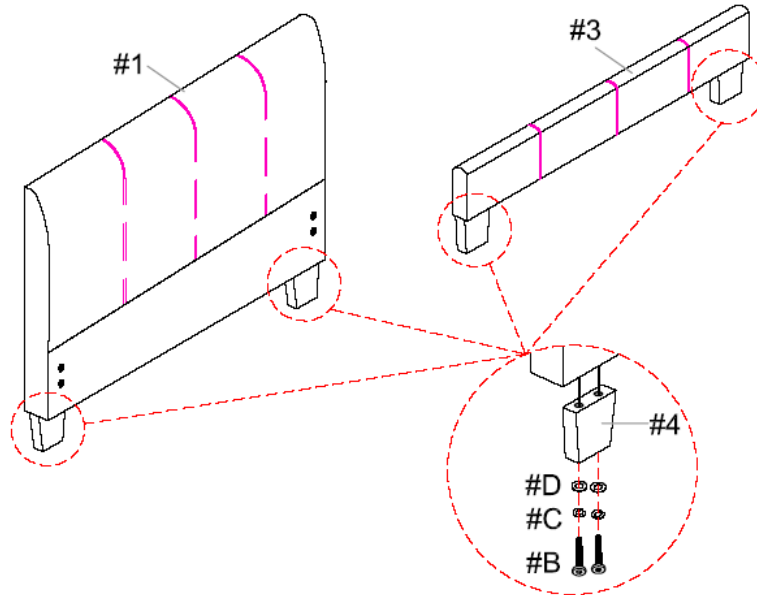

Turn right (clockwise) to tighten



#A x 8 pcs
#C x 8 pcs
#D x 8 pcs

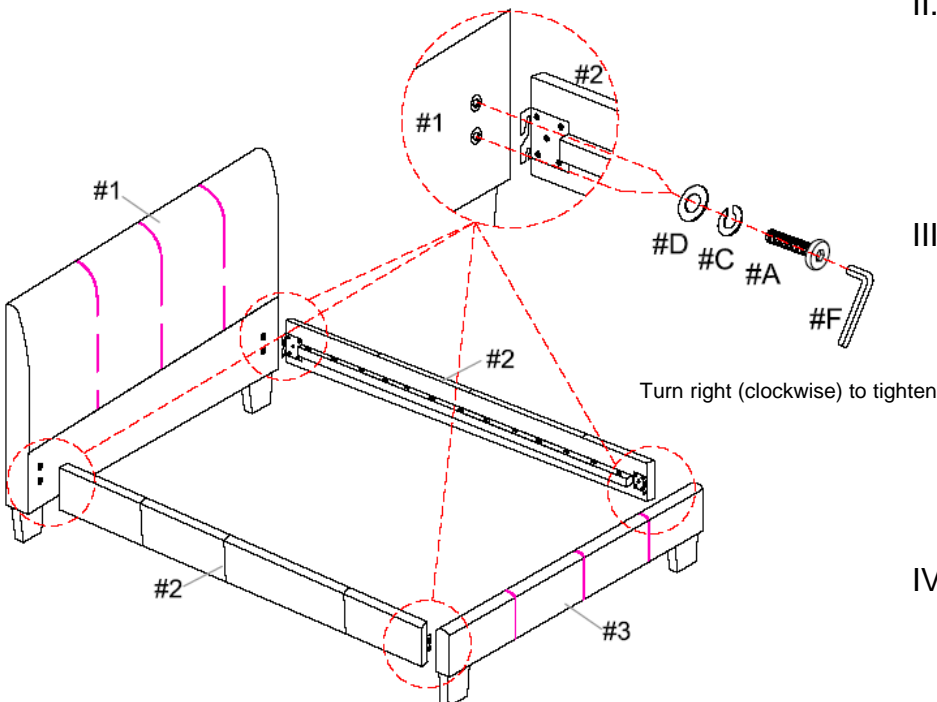

Turn right (clockwise) to tighten

- I. Prepare 4 bolt assemblies by inserting FIRST the lock washer (#C) onto the bolt (#A) and then the flat washer (#D) onto the SAME bolt (#A), in that order.
- II. Insert the bolt assemblies through the right and left side of the pre-drilled holes of the headboard (#1) using the Allen wrench (#F) but expose about 1/2" of the bolts' threads.
- III. Mount the brackets on the side rails (#2) onto the bolts (#A) on each side of the headboard (#1). Make sure all the washers are in the FRONT of the brackets. Use the Allen wrench (#F) to further tighten the bolts to secure the two parts together.
- IV. Repeat the process above to assemble the other ends of the two side rails (#2) onto the footboard (#3).



- I. Prepare a complete bed slat by connecting two end caps (#E) onto the ends of the slat (#5).
- II. Align the two end caps (#E) with the pre-drilled holes on each side of the side rails (#2) and press firmly down on both end caps (#E) to lock with the side rails (#2).
- III. Repeat the process above to assemble the remaining bed slats onto the side rails (#2).
- IV. Make sure the bed is rested on a flat surface and does not feel loose or wobbly. If it does, double check that the bolts/screws are secured and properly tightened.

#E x 26 pcs

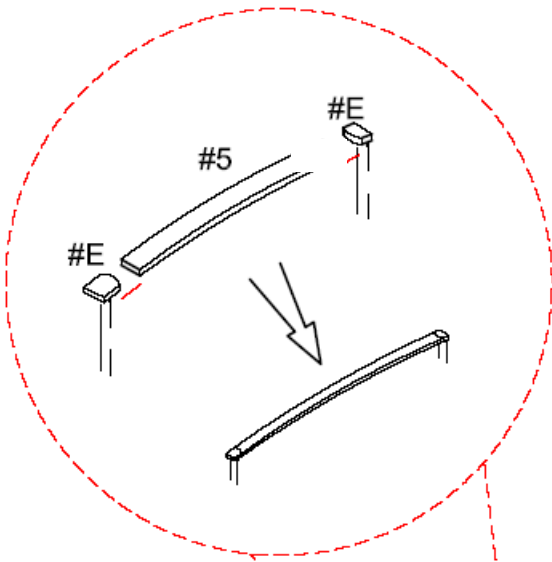

Note: The correct position of the slats should be arcing UPWARD when placing on the rails.

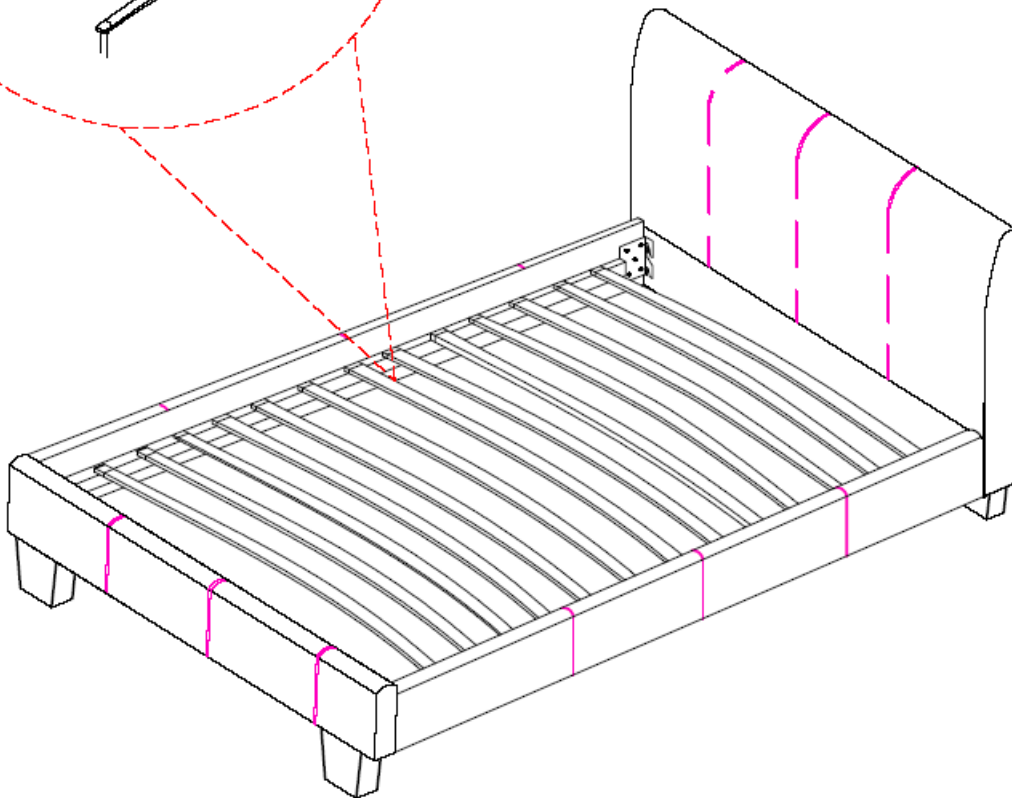

ASSEMBLY IS COMPLETED