

After sales email:
AwevscoHelp@outlook.com

General Guidelines

- Please read the following instruction carefully and use the product accordingly.
- Please keep this manual and hand it over when you transfer the product.
- This summary may not include every detail of all variations and considered steps. Please contact us when further information and help are needed.

Notes

- Do not place any hot objects on the surface of the product.
- If there are any defective or missing parts after unpacking, please cease assembly immediately and contact us.
- Please assemble the item on a spacious surface and do not place the unwrapped product directly on the ground to avoid product damage.
- Please do not stand or sit on the wooden boards.
- Please wear gloves during the assembly and/or disassembly process to avoid scratches from any sharp edges.
- Please match the corresponding part and fitting based on the part number in the manual.
- If the part does not match with the fitting, please check the piece as specified in this manual.
- During assembly, first loosely align all screws with the corresponding pre-drilled holes and then tighten the screws one by one.
- Periodically inspect screw tightness while the product is in use. If necessary, retighten to ensure structural integrity.
- Please keep the product away from sharp, pointed objects and corrosive substances to prevent product damage.
- Please place this item on level, solid ground during use.

Warnings

- During assembly, keep all small parts out of the reach of children. It may be fatal if swallowed or inhaled.
- Children should not climb or play on the product in order to avoid tipping over the furniture and causing serious injury.
- To avoid the potential dangers of suffocation, please keep all parts and packaging (film, plastic bags, foam, etc.) away from babies and children.
- Keep sharp objects and corrosive items away from the product to avoid any damage or injury.
- Do not shake or move violently during use to avoid tipping over the product.

Part list

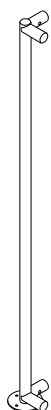

1 X3

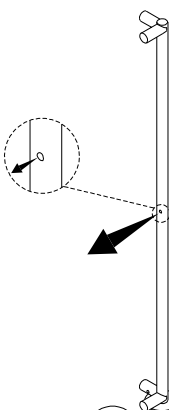

2 X1

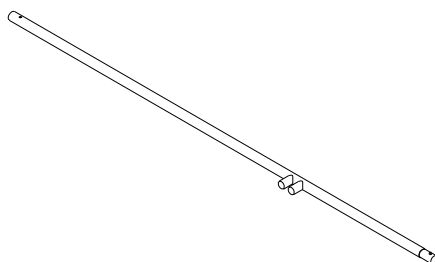

3 X1

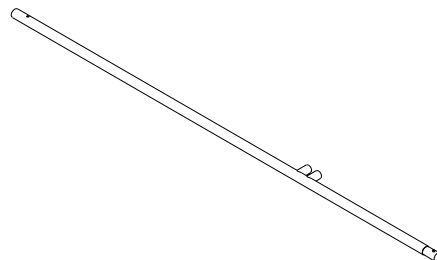

4 X1

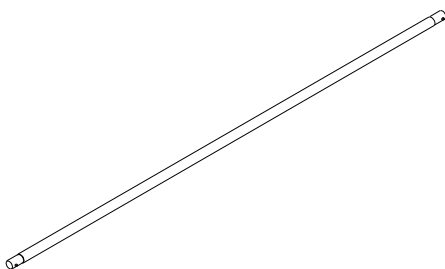

5 X9

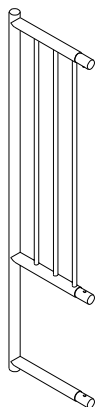

6 X1

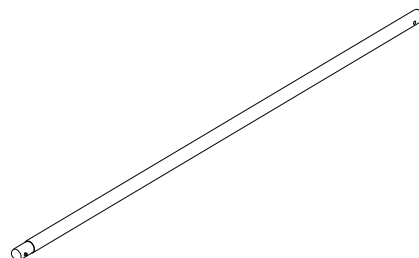

7 X7

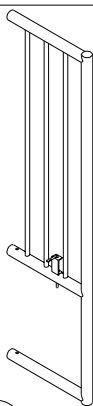

8 X1

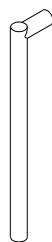

9 X2

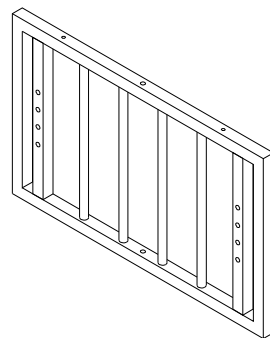

10 X1



11 X1

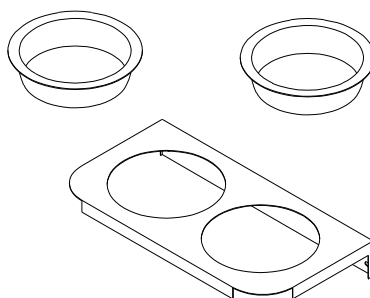

12 X1

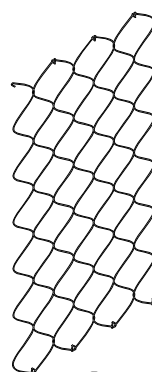

13 X1

Part list



14 X12



15 X2



16 X4



17 X3



18 X1



19 X2

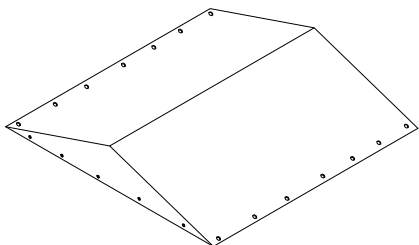

20 X1

Hardware list

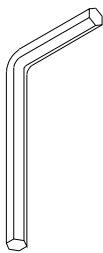

A X1



B X4

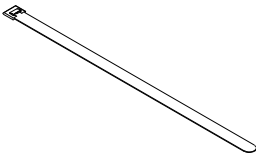

C X130



D X1

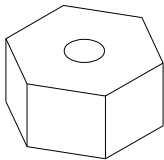
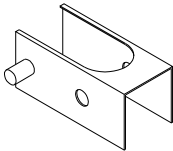

E X1

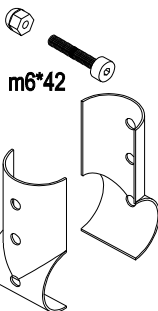

F X12



G X8

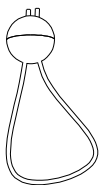

H X24

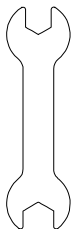

I X1

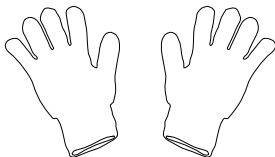

J X1

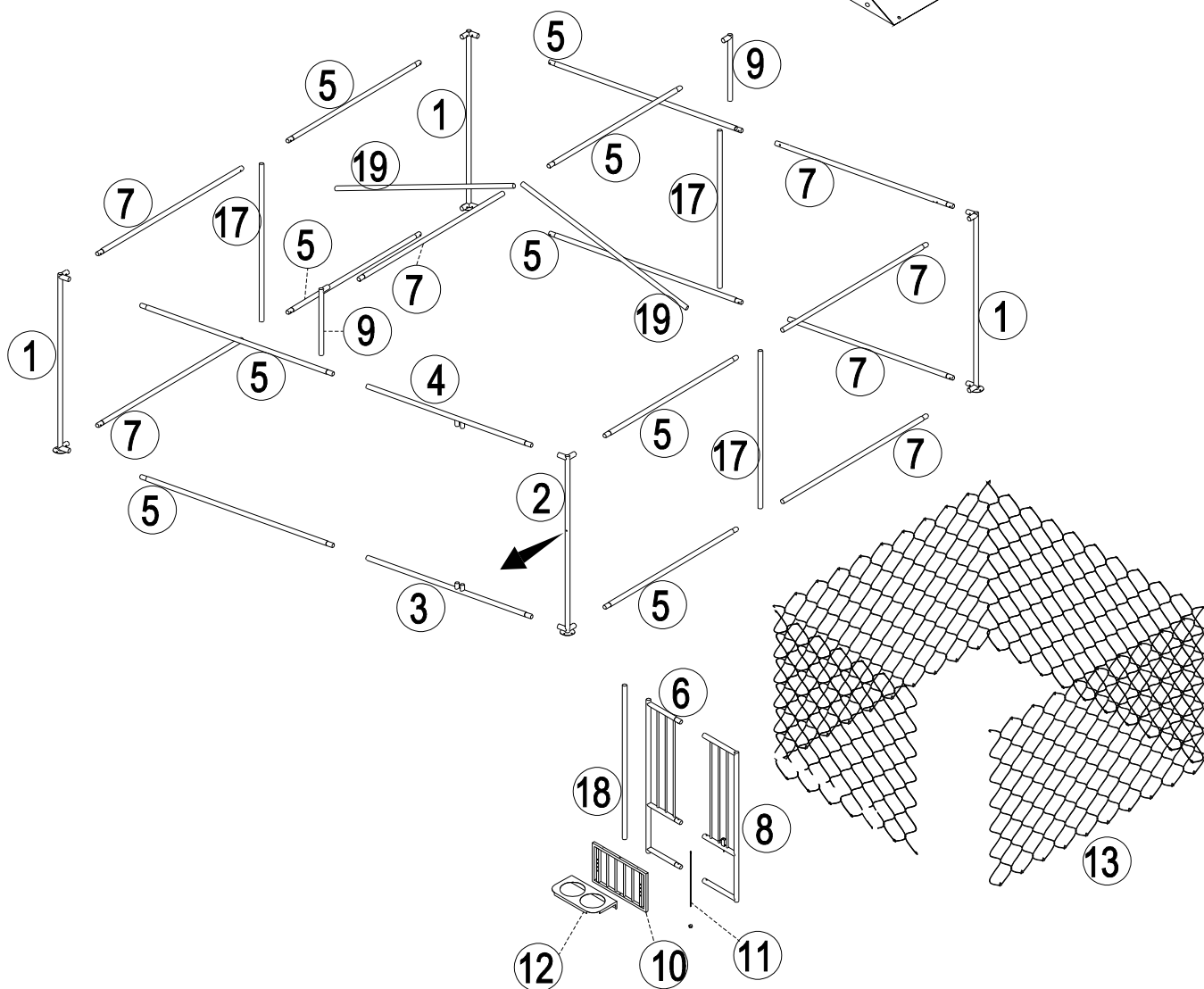
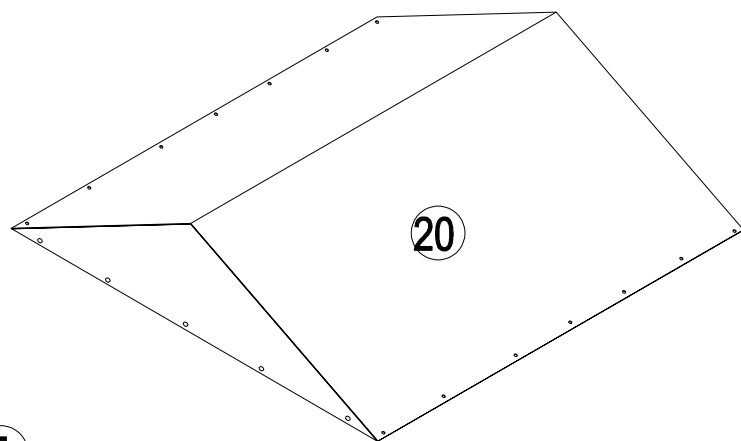

14 X12

15 X2

16 X4

1

Take out the rubber plug in the iron pipe

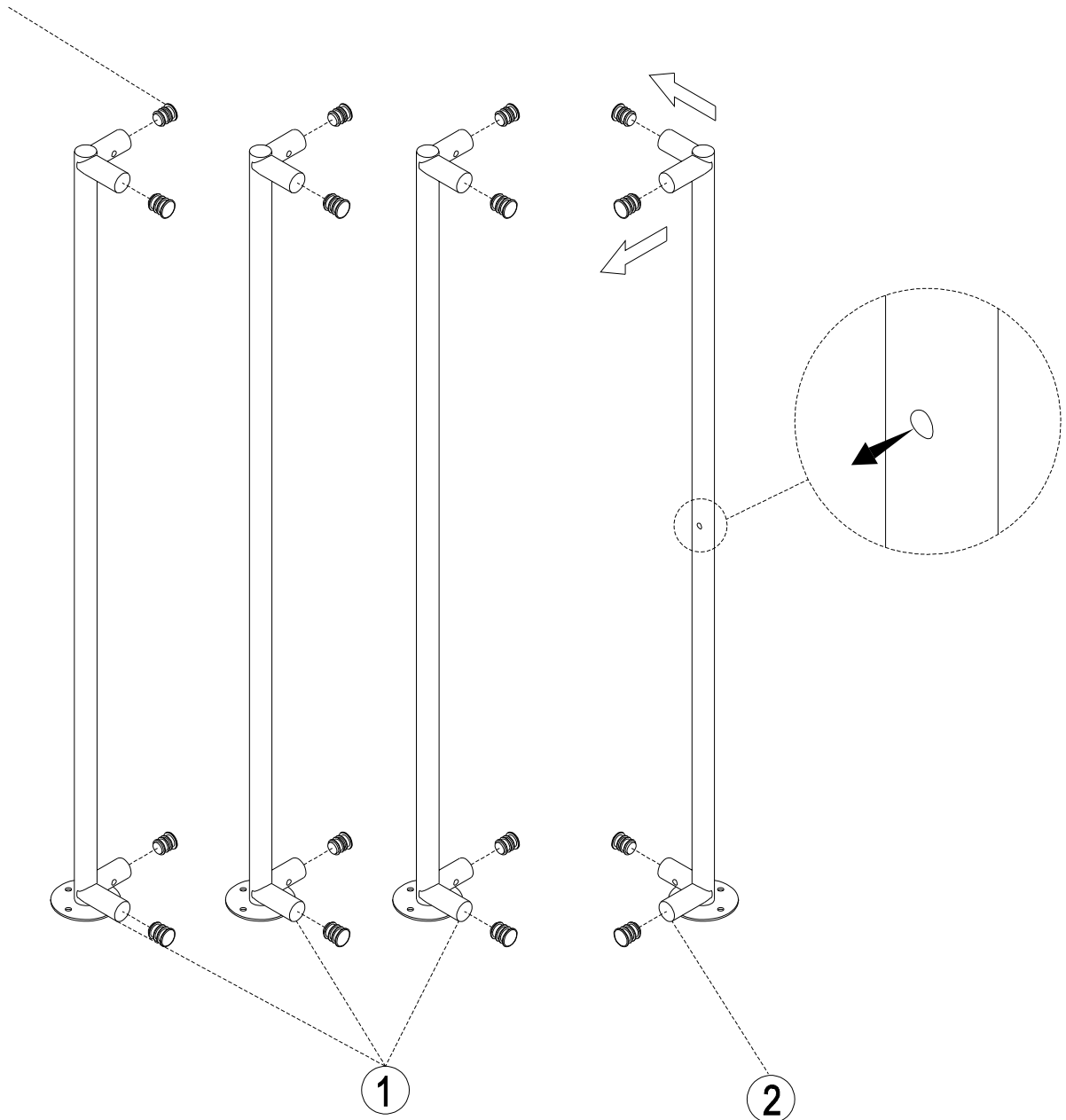

Please wear gloves for assembly

2

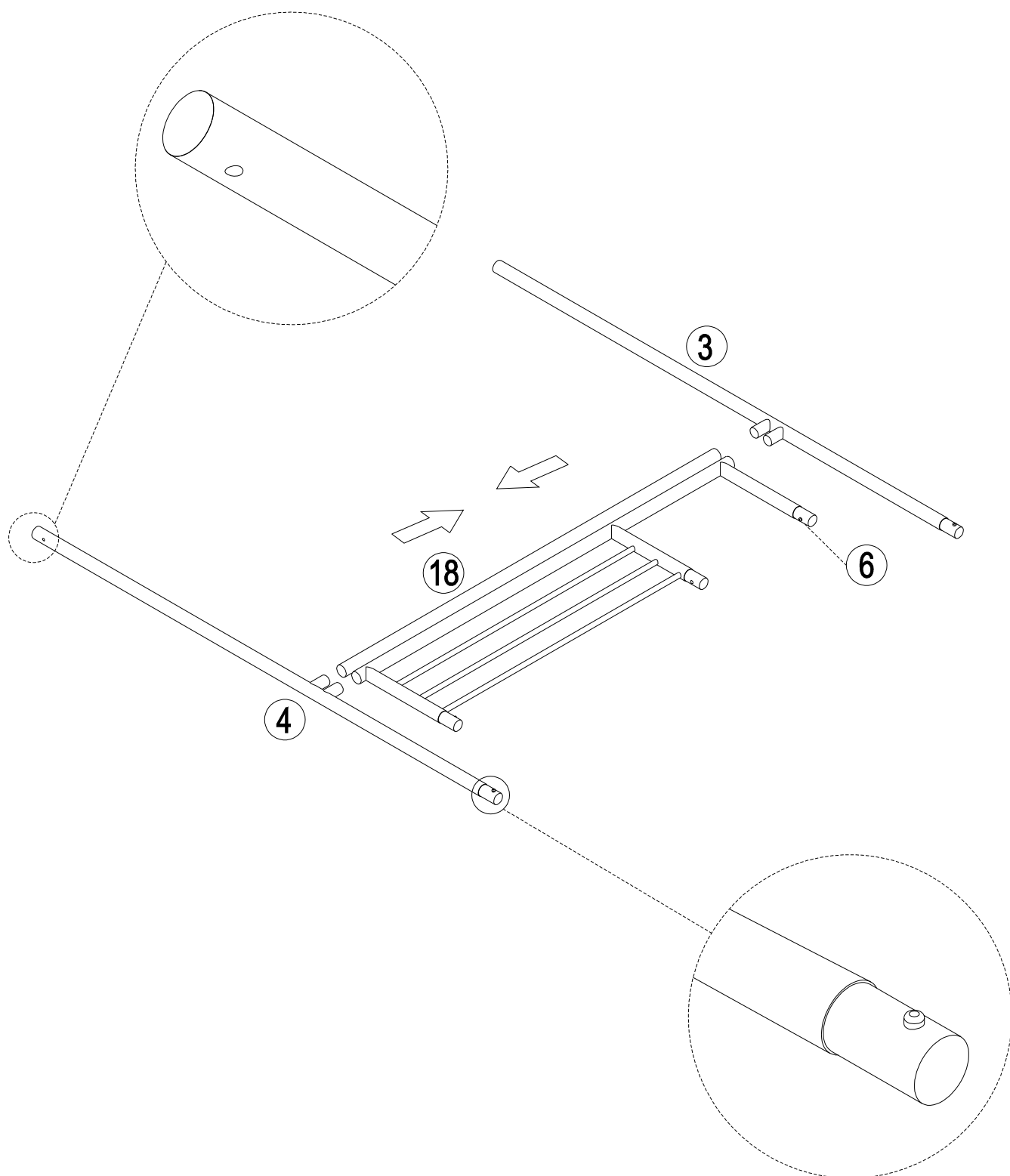

4

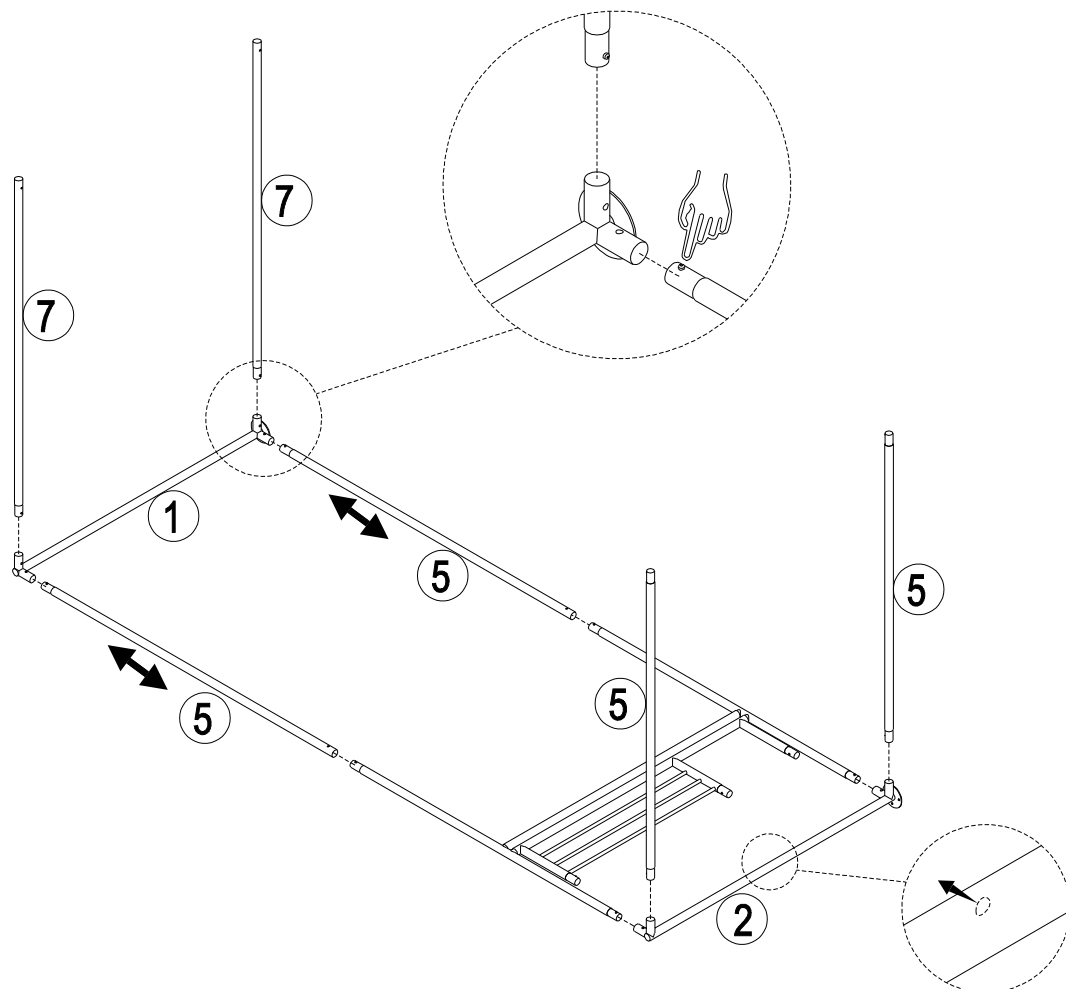

5

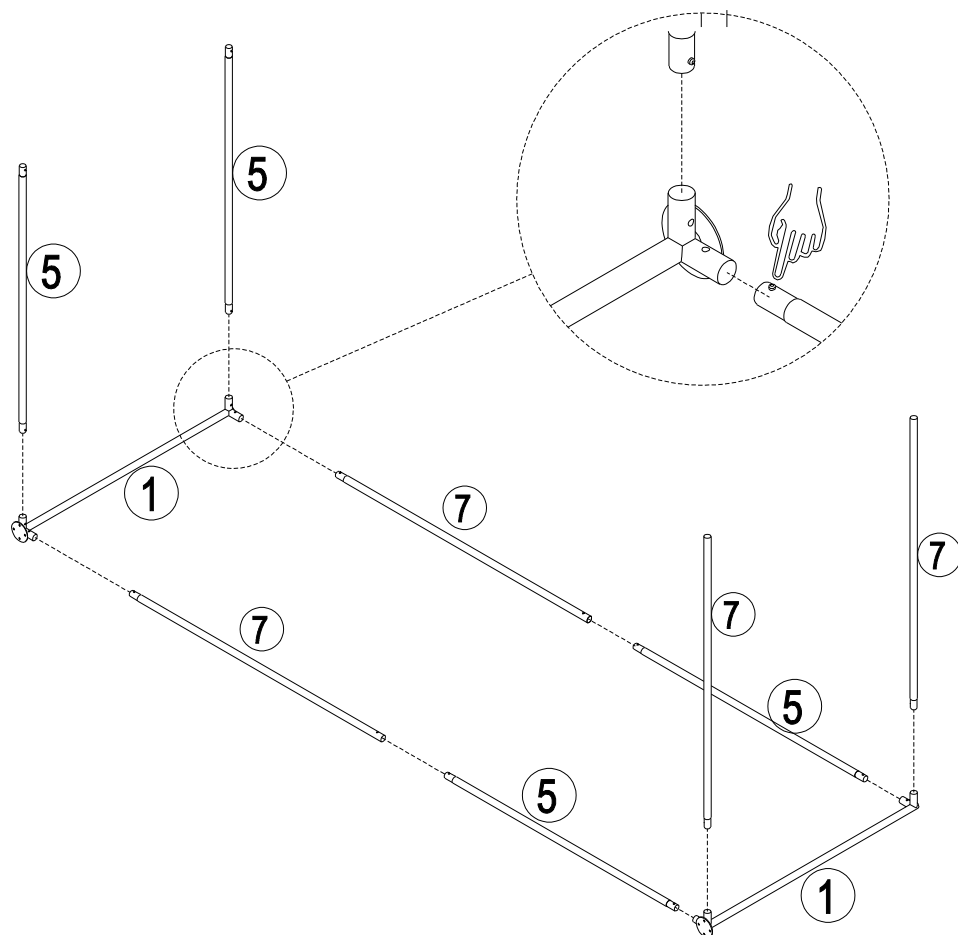

6

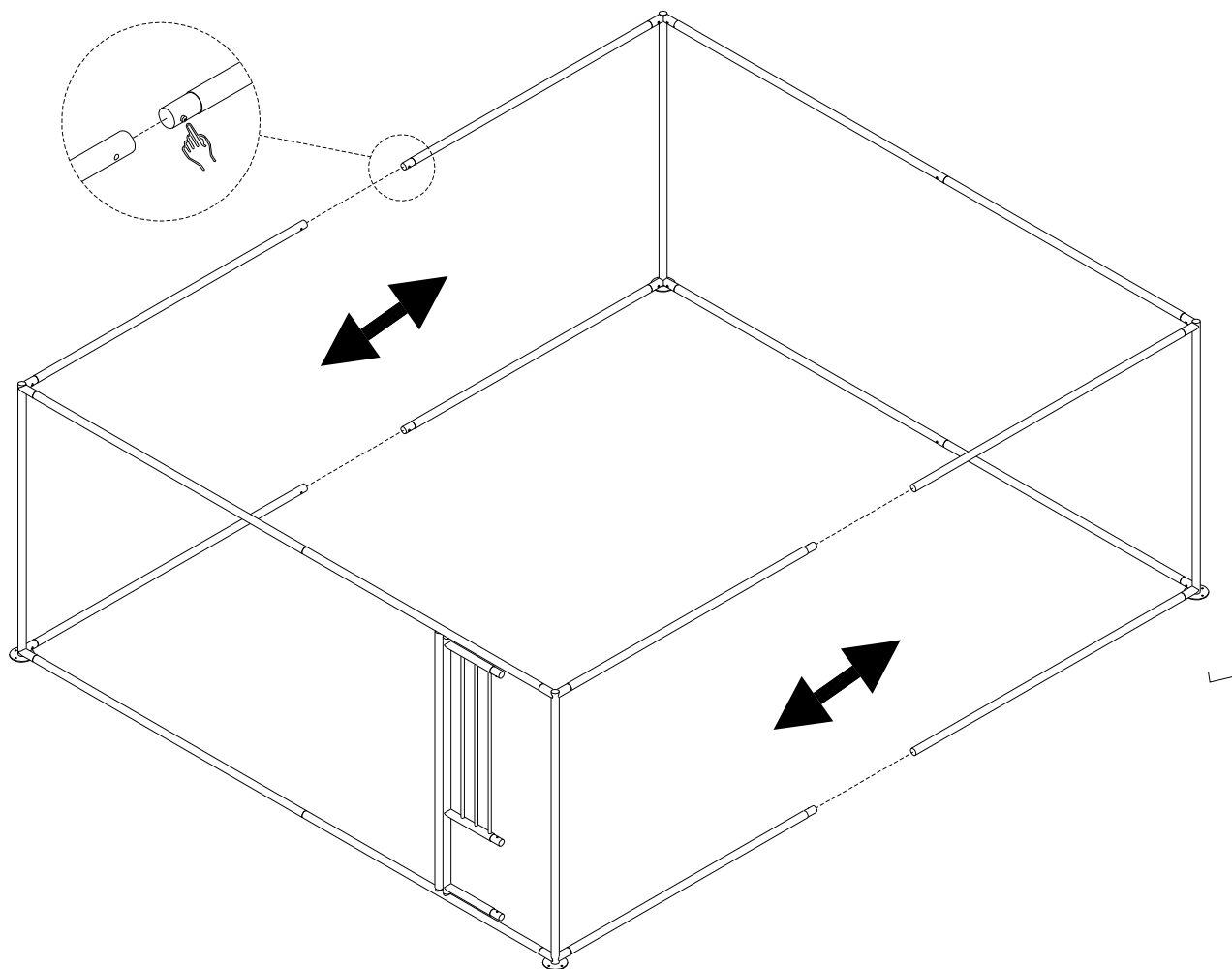

7

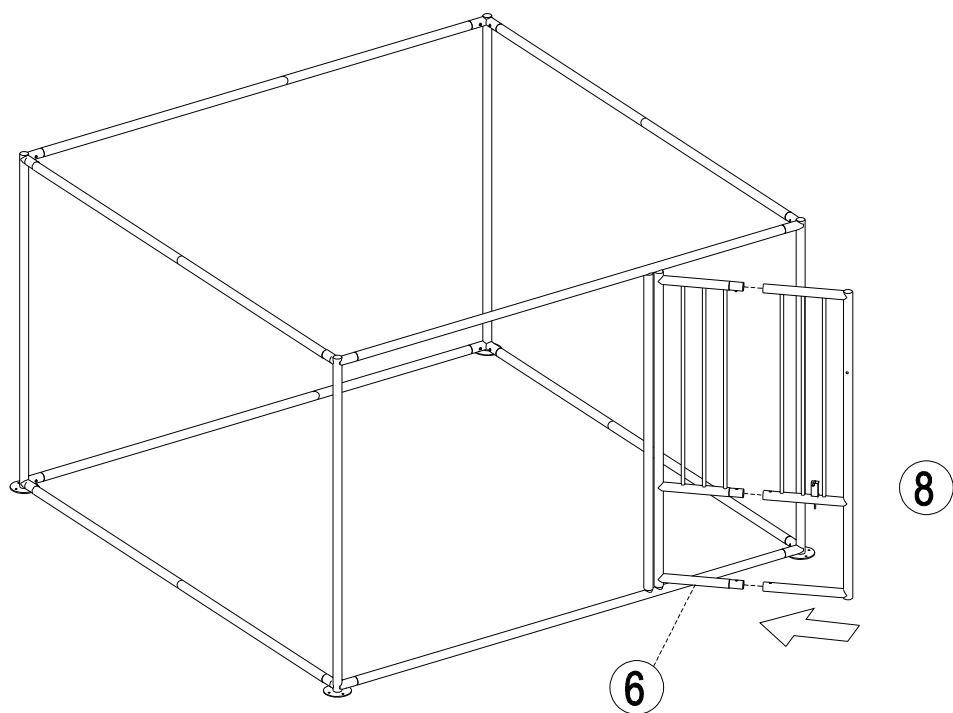

8

Screw through D and No. 2 piece and tighten the nut until D piece can rotate smoothly (as shown) .

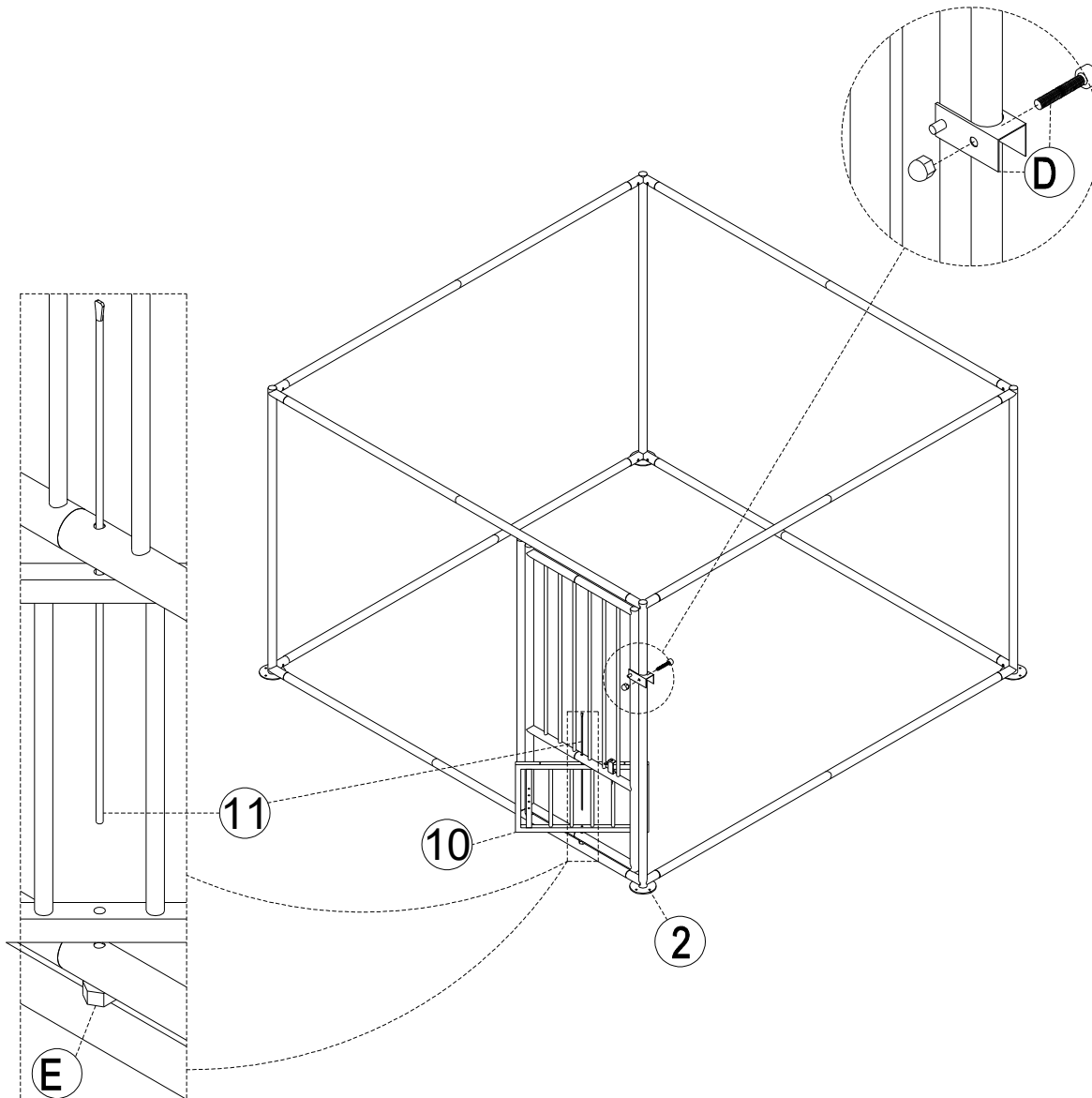

Put No. 10 in the vacant place under the door of the dog cage, and use No. 11 to pass through the door and place Part E at the junction of No. 10 to ensure smooth rotation (as shown).



(E) X1

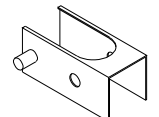
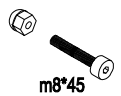

(D) X1

9

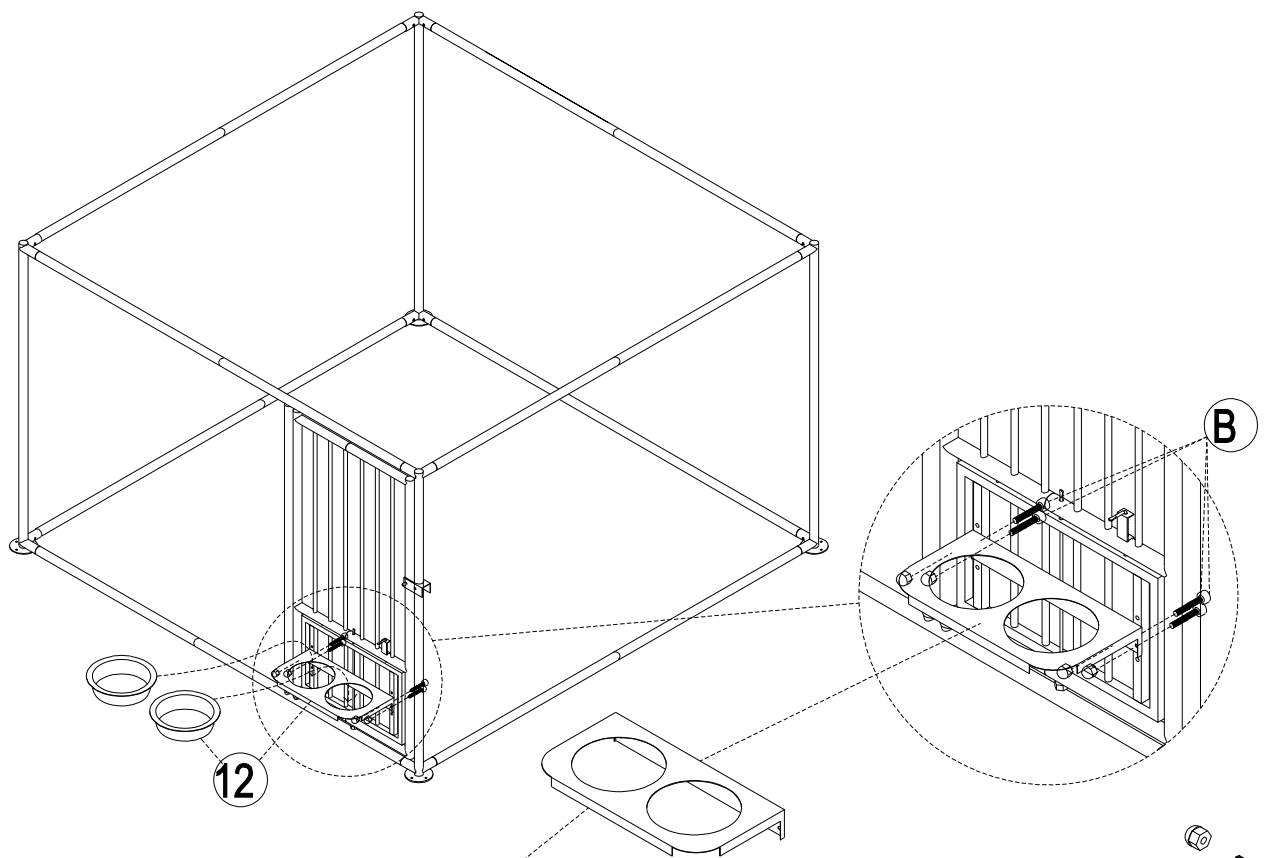

No. 12 is installed at this angle.

B X4

10

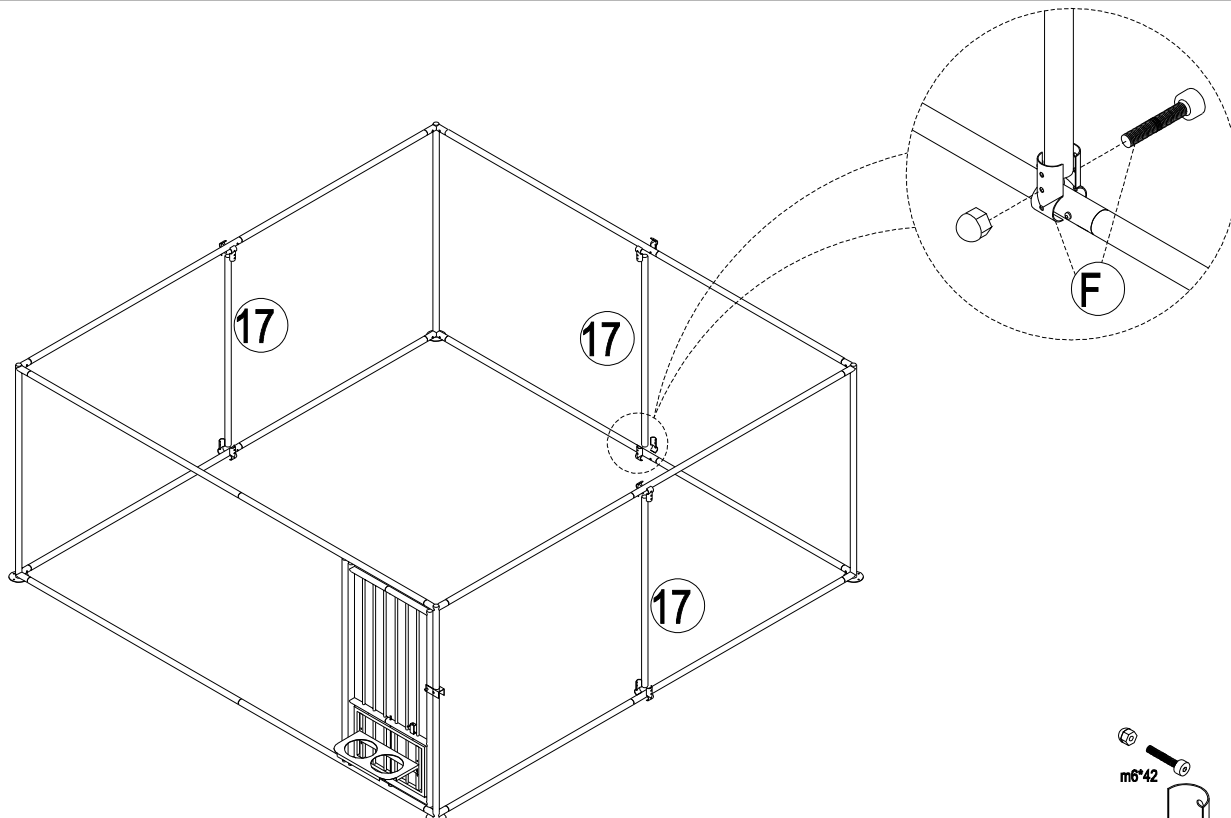

The metal fixings need to be installed close to the buckle, but should not affect the normal use of the buckle.

F X6

11

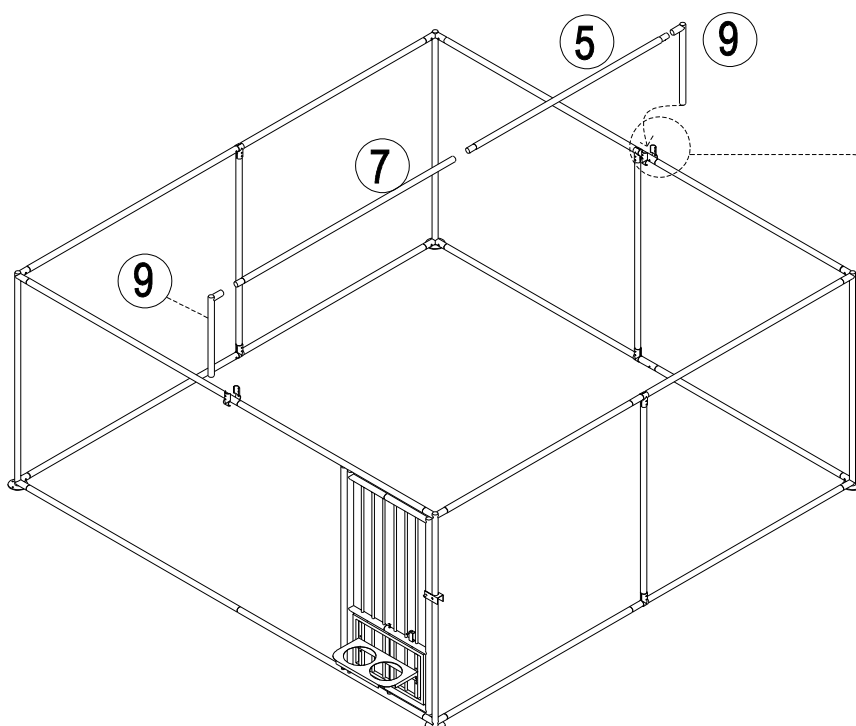

The metal fixings need to be installed close to the buckle, but should not affect the normal use of the buckle.

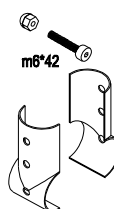

F X2

12

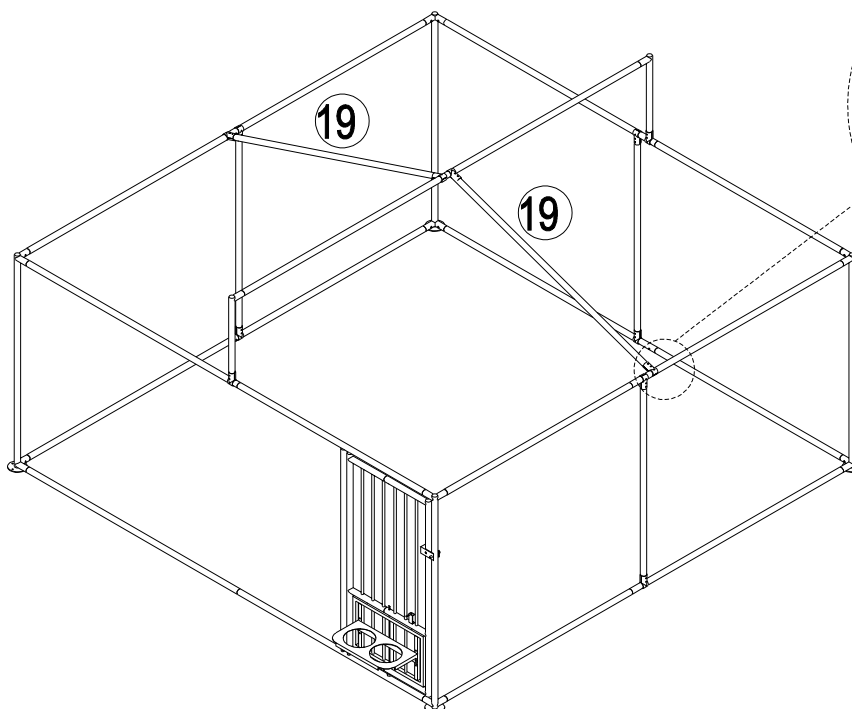

The metal fixings need to be installed close to the buckle, but should not affect the normal use of the buckle.

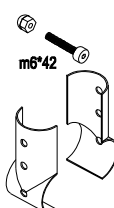

F X4

1. Insert No. 15 vertically into the iron net and fix and lock it with 4 stainless steel cable ties.

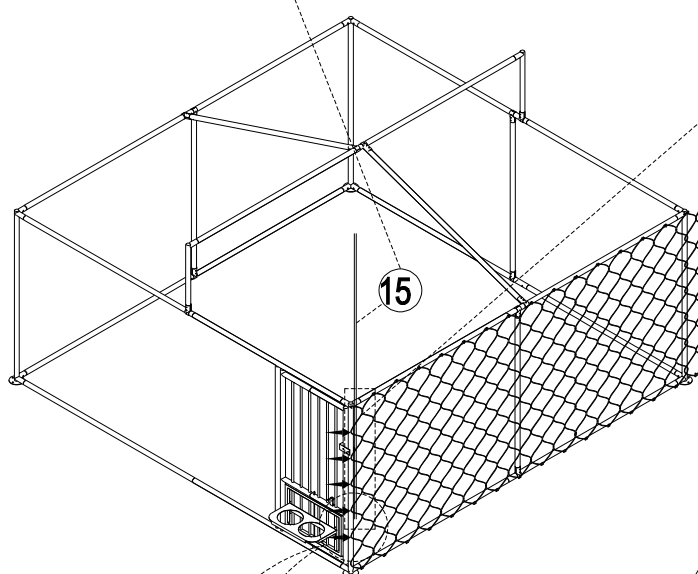

2. Iron mesh No. 13 surrounds the iron frame counterclockwise.

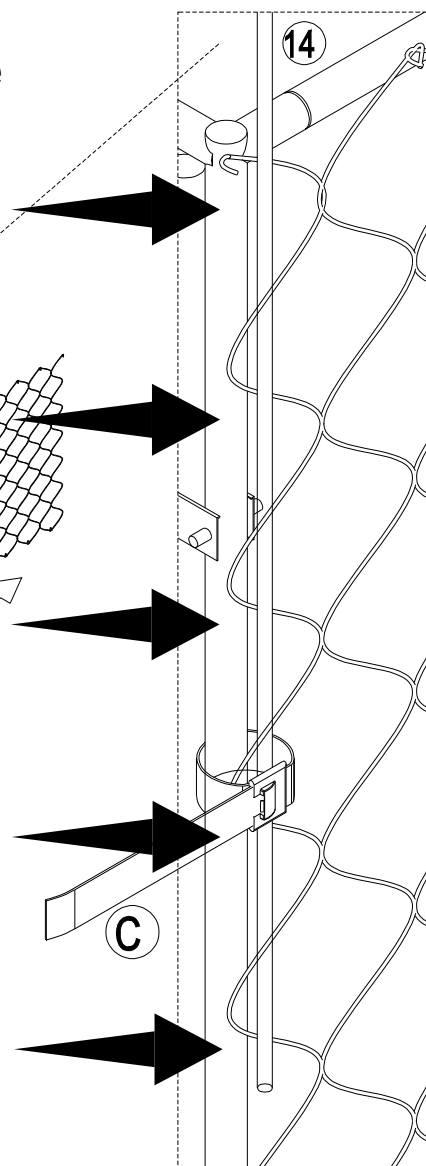
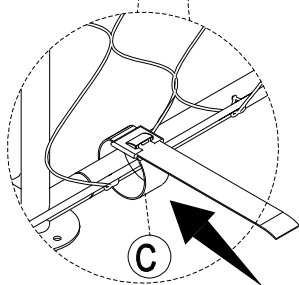

3. The parts indicated by the arrows need to be fixed with stainless steel cable ties.

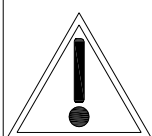

Please wear gloves for assembly

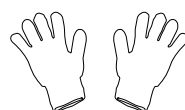

J X1

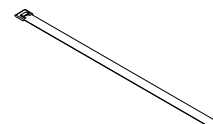

C X5



Please tighten the wire mesh when installing the second fitting No. 15

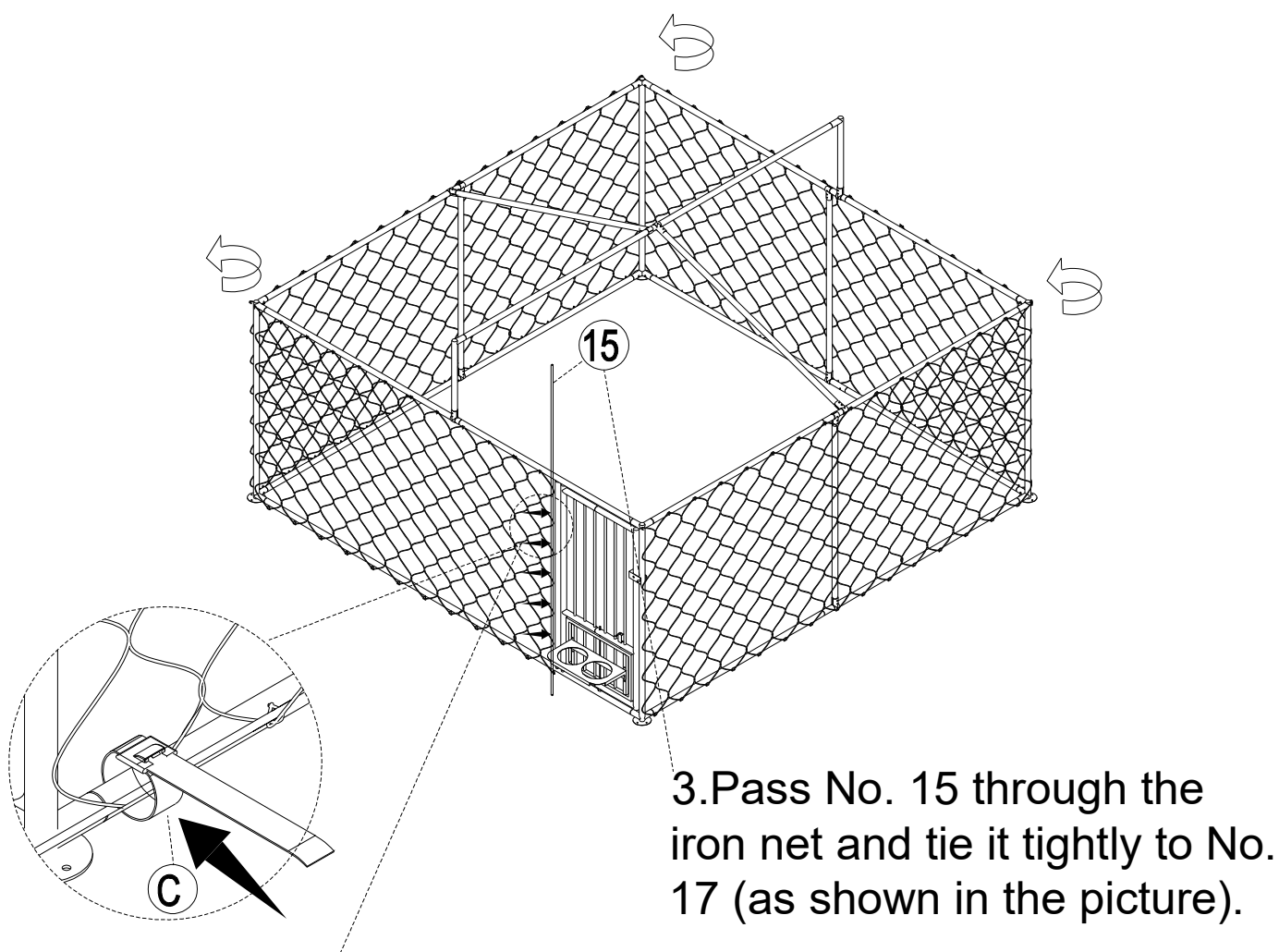

3. Pass No. 15 through the iron net and tie it tightly to No. 17 (as shown in the picture).

4. The parts indicated by the arrows need to be fixed with stainless steel cable ties.

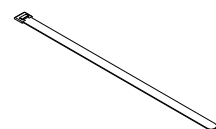

Ⓒ X5

2. Pass No. 16 horizontally through the iron grid and the main frame, and lock it tightly with stainless steel cable ties (as shown in the figure).

1. Put 2 pieces of No. 14 across the iron net and fix and lock them with 5 stainless steel cable ties.

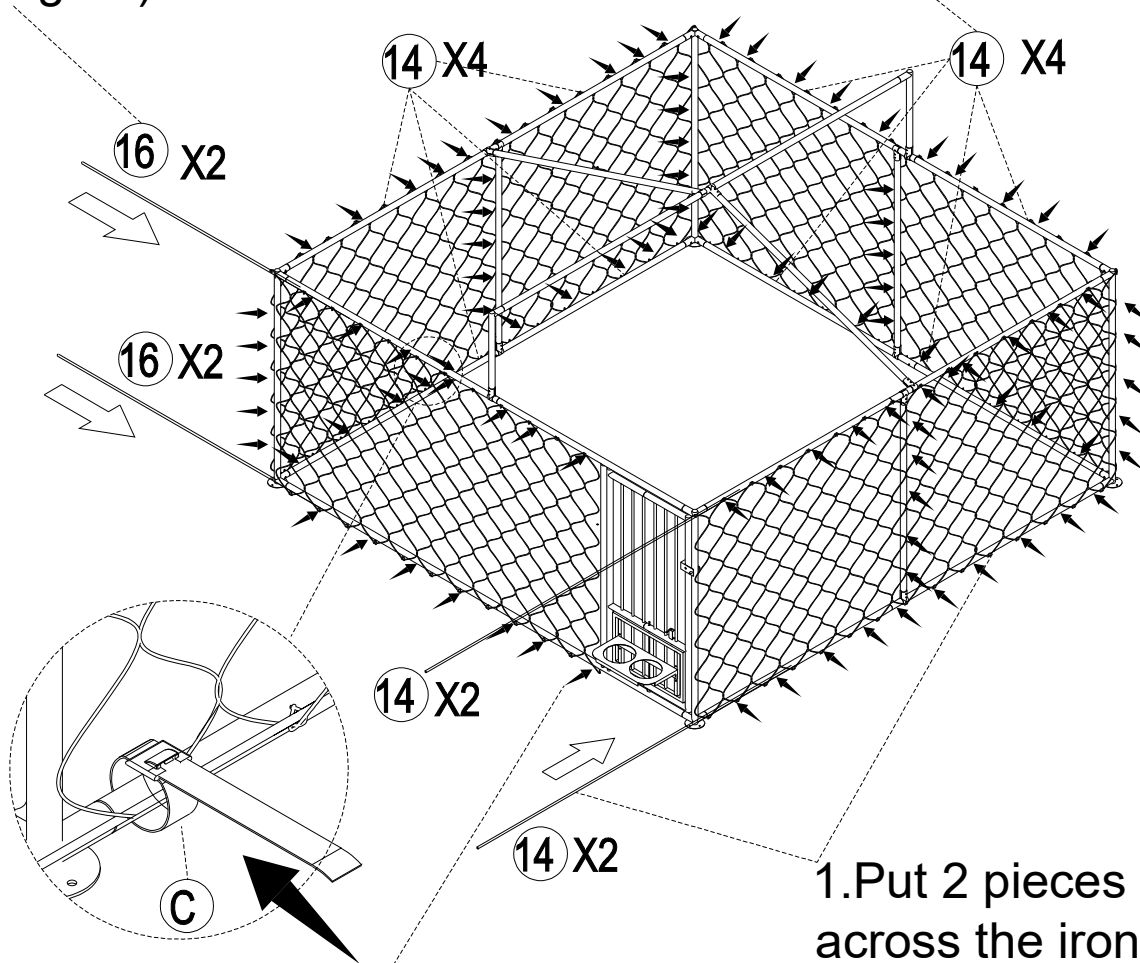

4. The parts indicated by the arrows need to be fixed with stainless steel cable ties.

1. Put 2 pieces of No. 14 across the iron net and fix and lock them with 5 stainless steel cable ties.

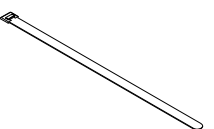

Ⓒ X120

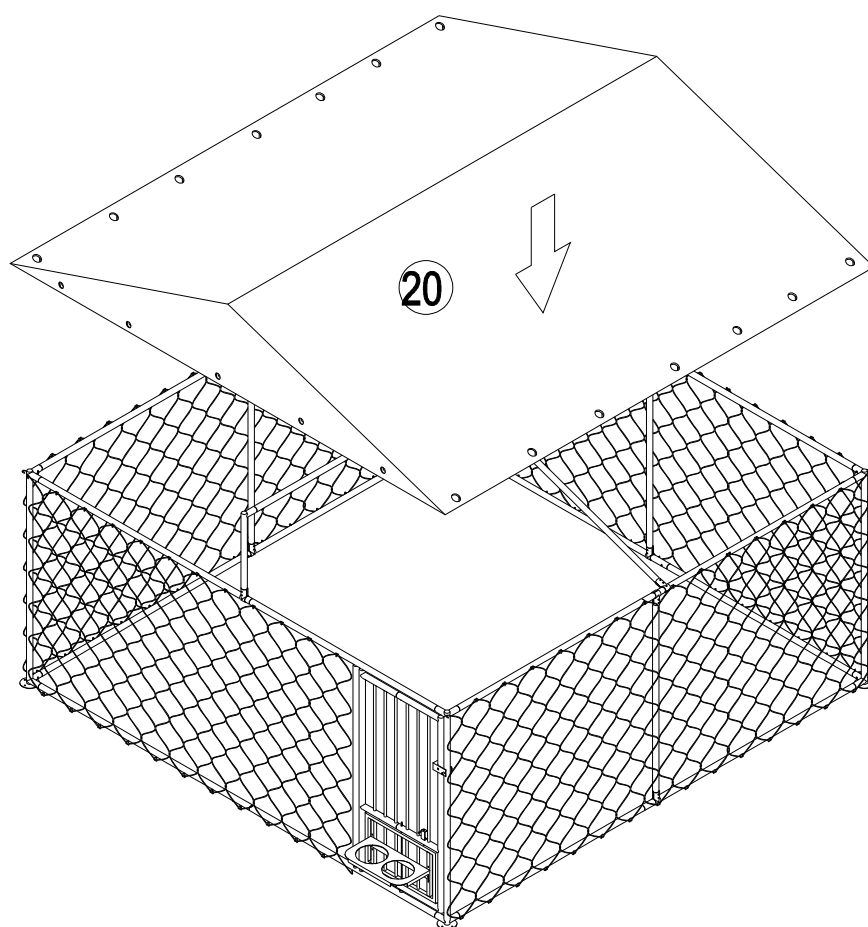

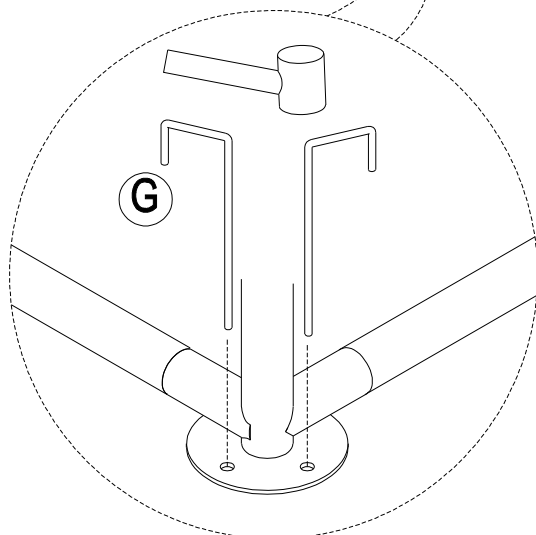
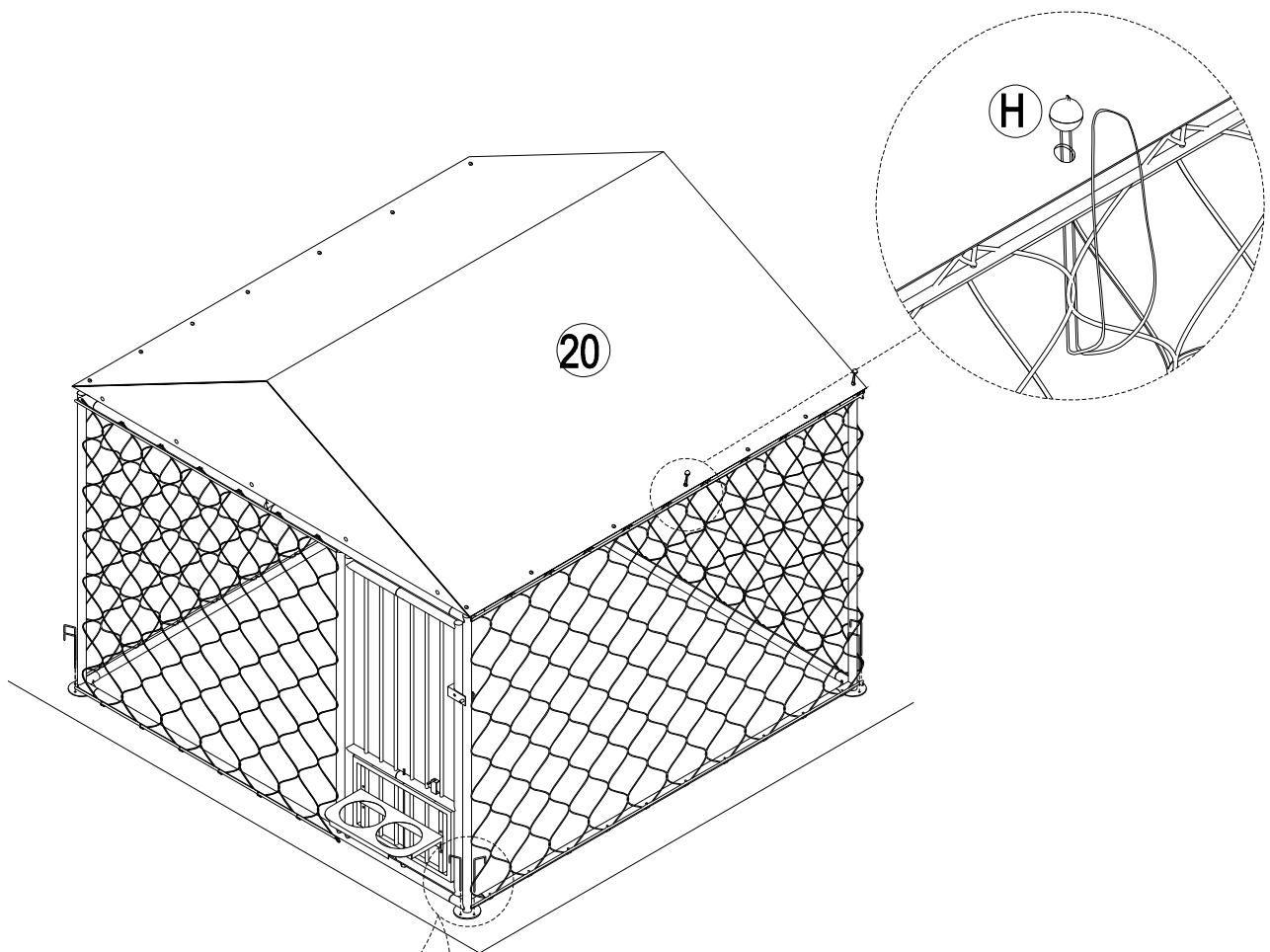

Pass the strap through the rain cloth and the iron net, then buckle it on the spherical button, and then insert it into the ground plug G to fix it (as shown in the picture).



G X8

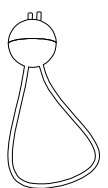

H X24