

MAINS SUPPLY

LIGHT FITTING

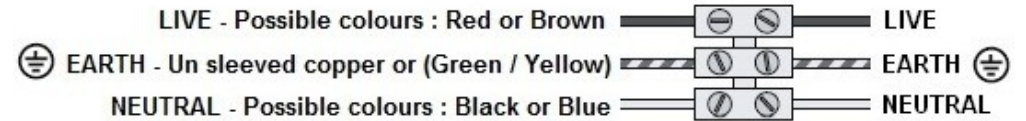

If required the fitting can be lengthened back to its original height

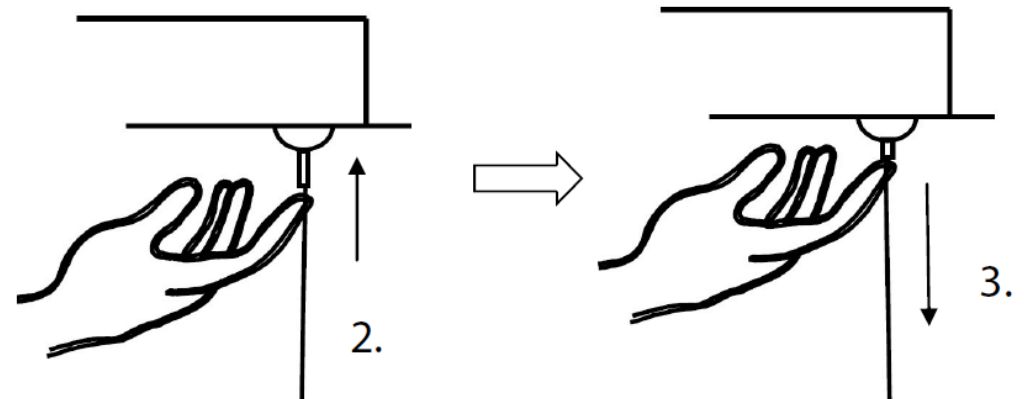

2. Push the 2 small metal release pins in individually, this will release the clamp and allow each support wire to become free to lengthen.

The weight of the fitting is normally sufficient to lower each support wire, however should the cable not move freely, gently hold the support wire whilst the pushing and the release pin and pull down on the cable.

SAFETY INFORMATION: (Please retain for future reference)

- Always turn off the mains supply before commencing the installation of this fitting .
- This is a Class 1 product and require san Earth connection – 230 (240) Volts – 50Hz AC.
- This product must be installed in accordance with the national building and wiring regulations, if in doubt consult a qualified electrician.
- This fitting is suitable for installation in Indoor locations only .
- Do not mount the fitting in a damp atmosphere.
- Ensure sufficient access to the fitting to enable safe maintenance.

LAMP INFORMATION:.

- Do not exceed the maximum wattage and bulb type stated on the lamp holder.
- The fitting is compatible with energy efficient LED lamps in their available maximum wattage or equivalent wattage.

DIMMING:

- This fitting maybe dimmed when using a suitable wall dimmer ,if using LED lamps the dimmer must be capable of dimming this type of lamp

ADDITIONAL INFORMATION:

- The fitting has a 'rise and fall' mechanism to allow height adjustment. To shorten the fitting hold each wire in turn and gently push upwards to the desire height, the support wire will freely move into the ceiling can. If required the fitting can be lengthened back to the original height, push the small metal release pin, this will release the clamp and allow each support wire to become free to lengthen.

AFTERCARE AND MAINTENANCE:

- Always disconnect power supply when servicing or cleaning.
- Clean only with a dry or slightly damp cloth.
- Do no use any abrasive cloths or cleaners as this may damage the product



This symbol on the product indicates that this product must not be disposed of with your normal household waste. Instead, it is your responsibility to dispose of your waste equipment by handing it over to a designated collection point for the recycling of wasted electrical and electronic equipment. For more information about recycling please contact your local council or your household waste disposal service or the shop where you purchased the product