

①

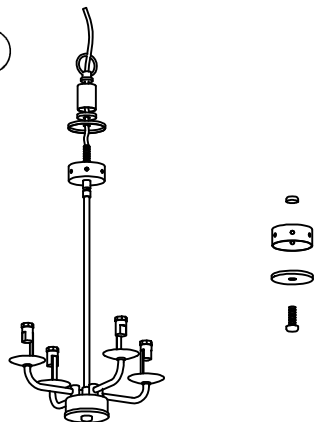

1.Release the HANG STRAIGHT and FASTENER from the CYLINDER UP and DOWN,take out the CYLINDER COVERS. Fasten the ROD to the rod joint of the lamp body.

②

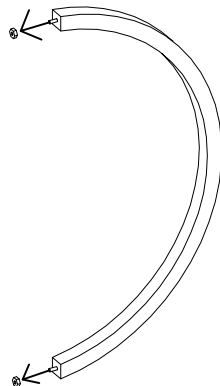

2.Release the screw nuts at the ends of the WOOD FRAME.

⑤

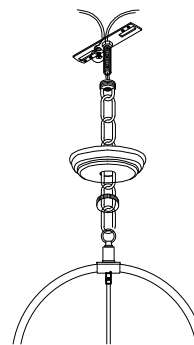

5.Open the quick link at one end of the CHAIN, attach it to the HANG STRAIGHT, let the cable go through the CHAIN.
6.Release the FASTENER RING from the HANG RING,let the FASTENER RING and CANOPY go through the CHAIN and cable.

⑥

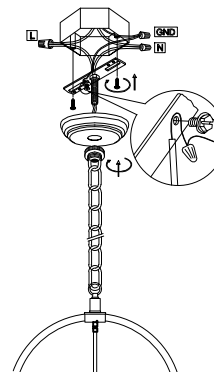

7.Open the quick link at the end of the CHAIN.Hang it to the HANG RING.Let the main wire go through the MOUNTING BRACKET.
8.Fasten the MOUNTING BRACKET to the ceiling Junction box,connect the wire.

③

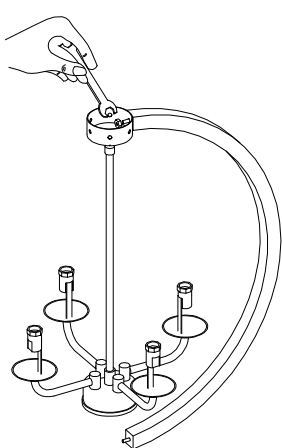

3.Attach one end of the WOOD FRAME to the CYLINDER UP,fastenit by the screw nuts.

④

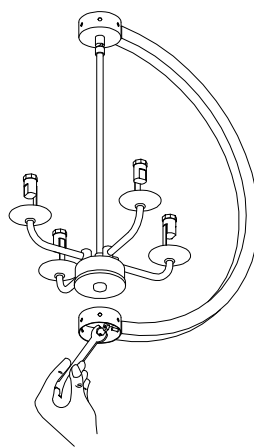

4.Attach the other end of the WOOD FRAME to the CYLINDER DOWN,fasten it by the screw nuts.

⑦

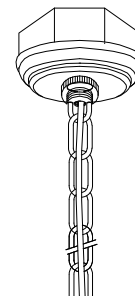

9.Position CANOPY over MOUNTING BRACKET,then lock the CANOPY by HANG RING.

⑧

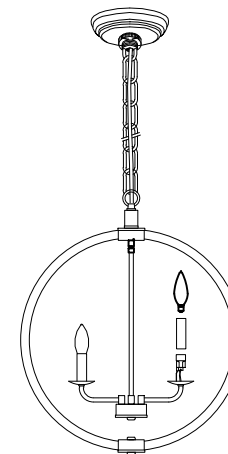

Put on the SOCKET COVER and then fasten the light bulbs to the lampholders,E12x4 pcs,type B, 60W Max is recommended.