

INSTALLATION GUIDE

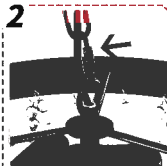

Slowly pass wire go through center hold, and tight the lamp holders by iron loop.



Connect the loop and chain for ready to hang the lamp on to the mounting bracket

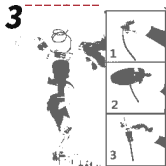

Unscrew the collar,then install the canopy and collar according to above steps.



Please check the accessory parts are placed in the correct position.



Fix the mounting bracket on the electrical box.



Connect the wire.



Screw the collar for fixing the lamp.



Screw 3 E12 bulbs, the light fixture is ready to use. (Bulb is not included)



Complete installation.

⚠ GAUTION

- TO AVOID THE RISK OF FIRE OR SHOCK, FIXTURE MUST BE INSTALLED IN COMPLIANCE WITH ALL APPLICABLE NATIONAL AND LOCAL ELECTRICAL/BUILDING CODES. DISCONNECT POWER BEFORE RELAMPING OR WIRING THE FIXTURE.

When wiring fixture is being replaced, remove and note to which of the wires in the outlet box the fixture was attached. DO NOT SEPARATE AND OTHER WIRES THAT MAY BE IN THE BOX. DO NOT DAMAGE THE INSULATION OF OLDER WIRING. In regular circumstances the black wire will be the "Hot/Lead" wire and the WHITE wire will be the "Neutral" or "Common" lead wire. A GREEN or BARE COPPER wire is the "Ground". In older buildings it is always good practice to reconfirm the polarity of the wiring.

NOTE: For your safety be certain that the circuit breakers controlling outdoor lighting and equipment are GFI breakers.