



CAUTION

• Warning: Cut off electric before installation to avoid electric shock.

Tools required



Ladder



Safety glasses



Electrical tape



Phillips screwdriver



Flat blade screwdriver



Pliers

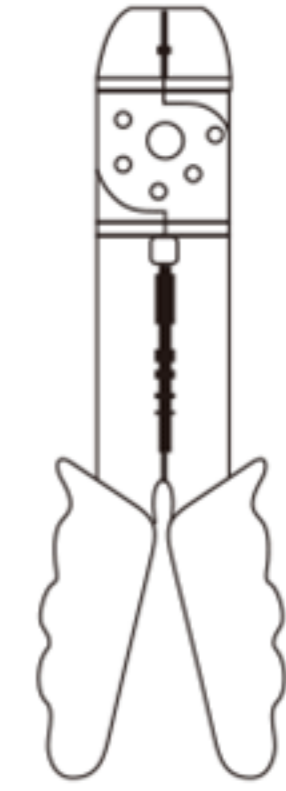

Wire strippers

Disconnect the power supply before installation

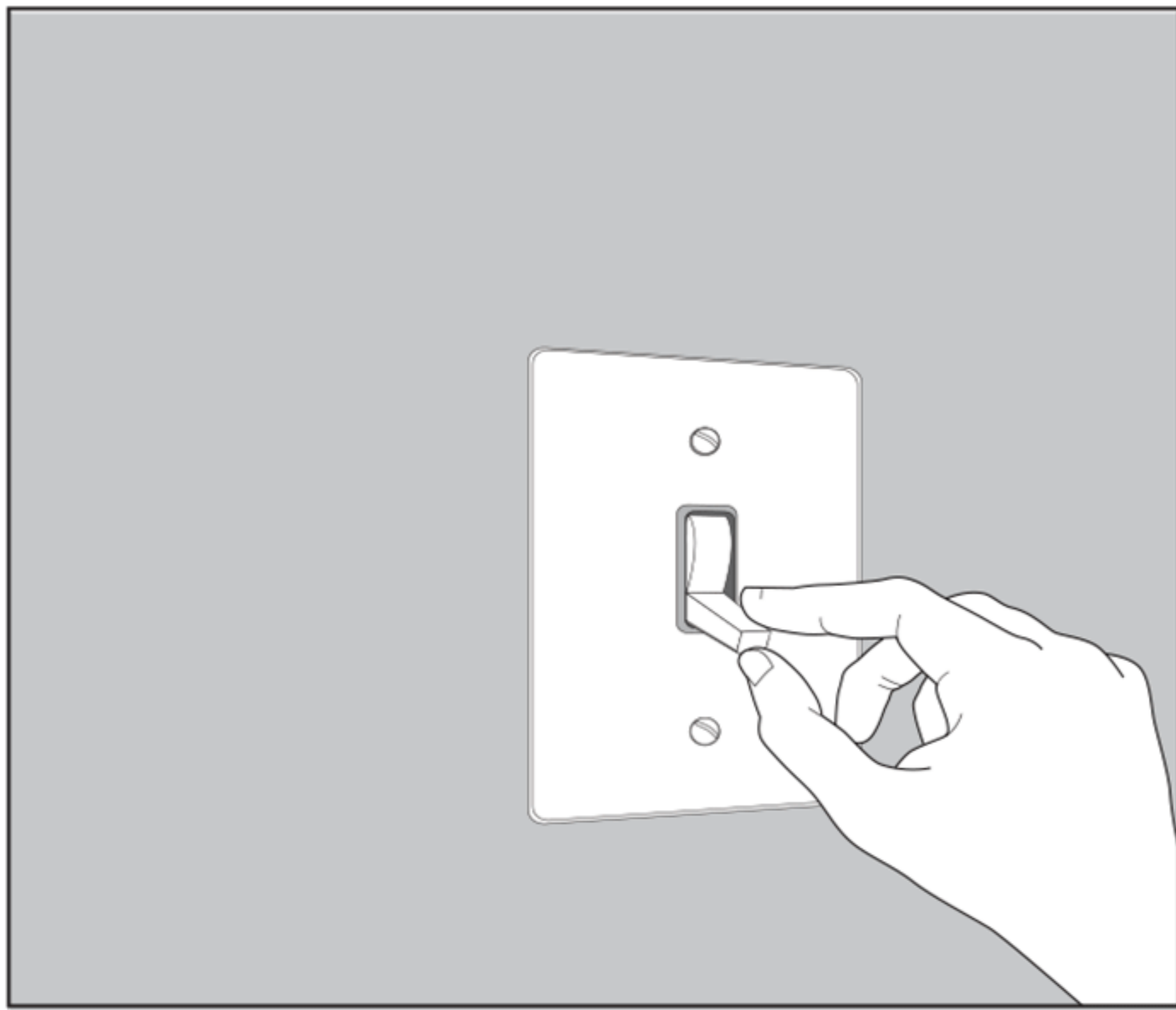

FIG. 1.

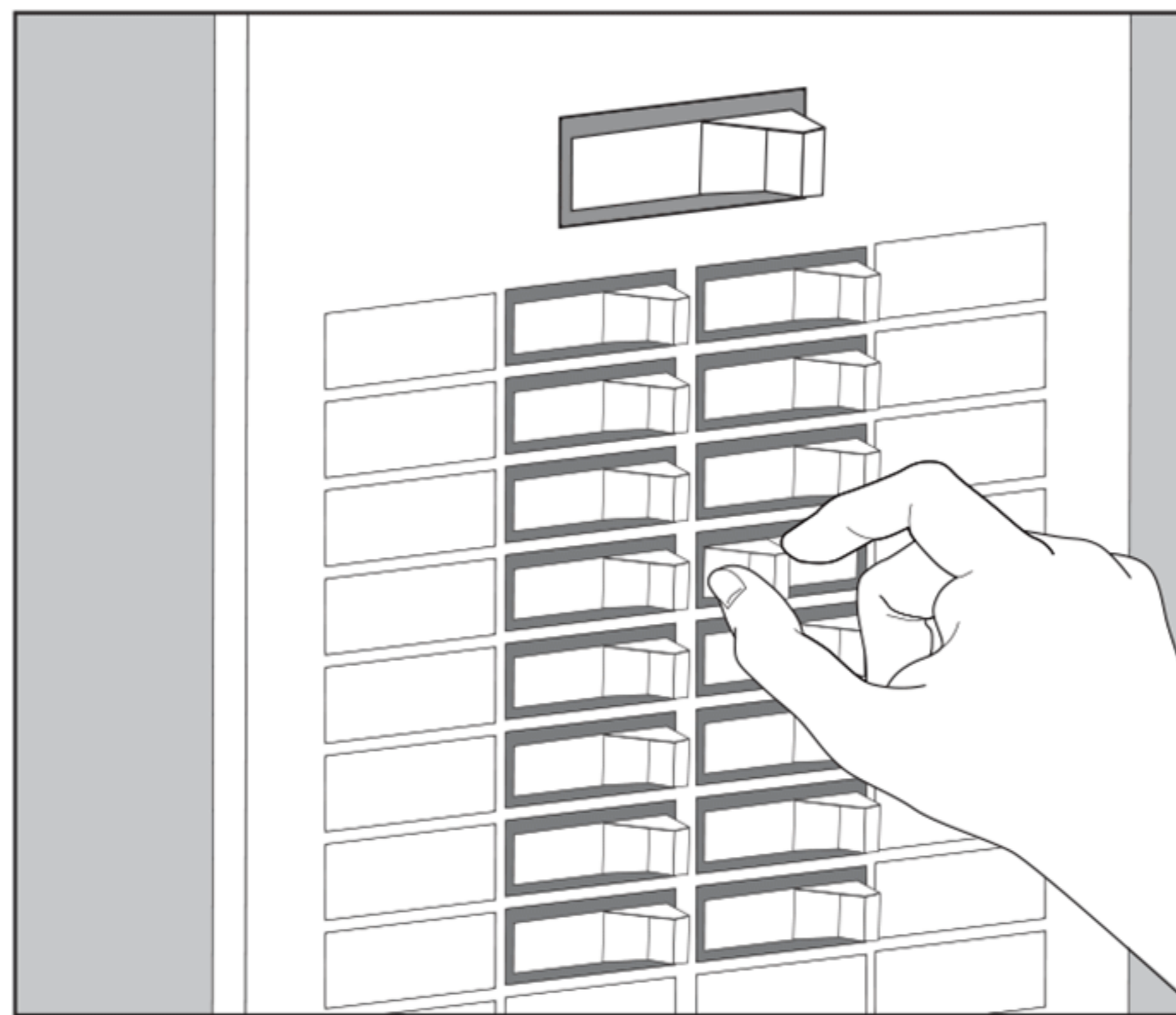

FIG. 2.

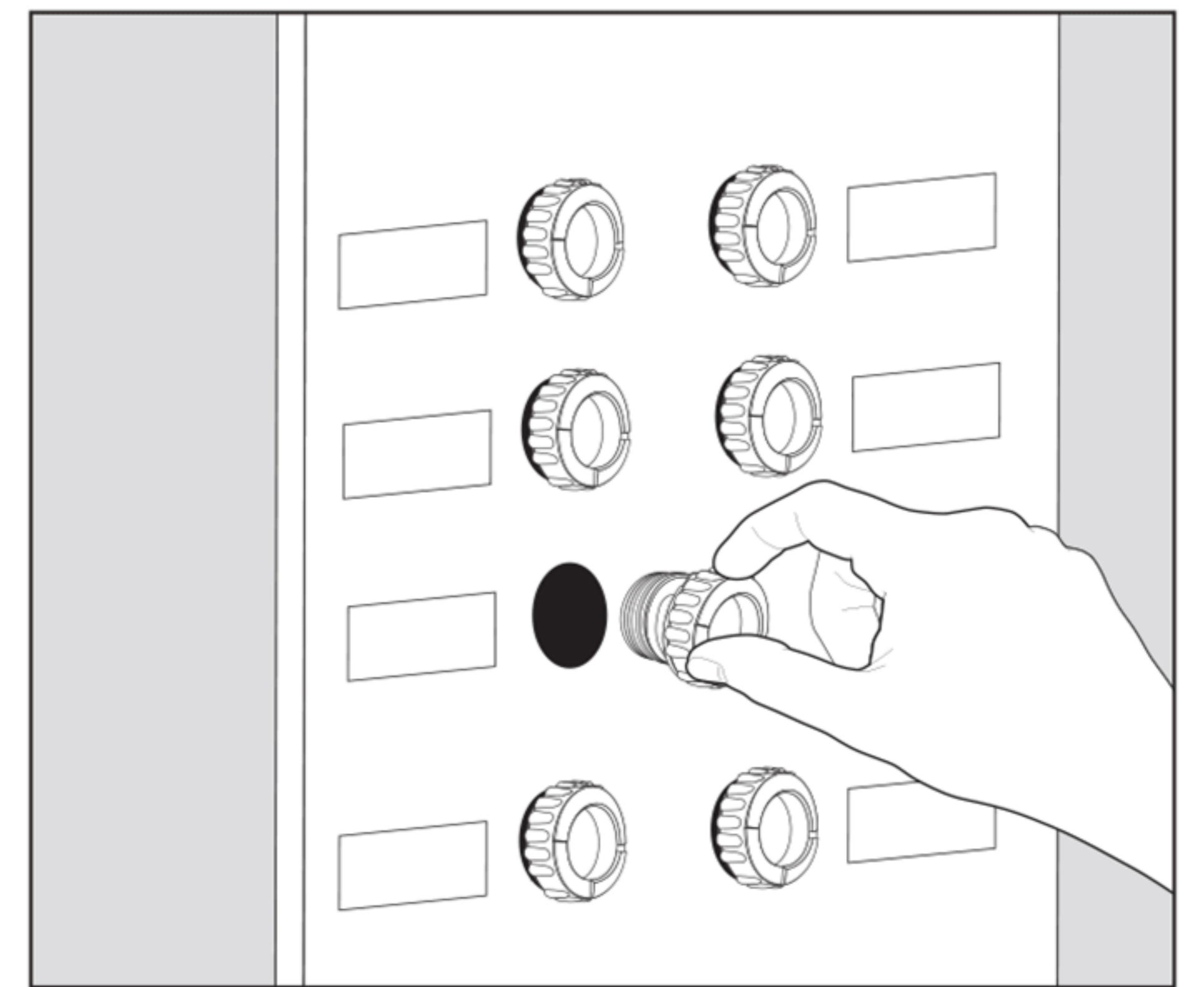

FIG. 3.

FIG. 1.

Place the wall switch to the "OFF" position Depending on which type of fuse box you have in your home.

FIG. 2.

Place either the main (Master) switch to the "OFF" position, cutting off power to your entire home OR turn off the individual switch that provides power to where the fixture will be installed.

OR

FIG. 3.

Place either the main (Master) switch to the "OFF" position, cutting off power to the entire home OR unscrew the fuse that provides power to where the fixture will be installed.

coding	Picture	number	coding	Picture	number	coding	Picture	number
A		4	H		1	①		18
B		4	I		2			
C		1	J		4			
D		1	K		1			
E		1	L		3			
F		1	M		1			
G			③		18			

Installation steps

Step3 Step1

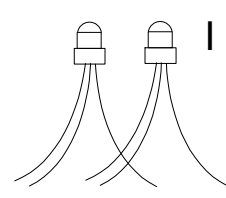
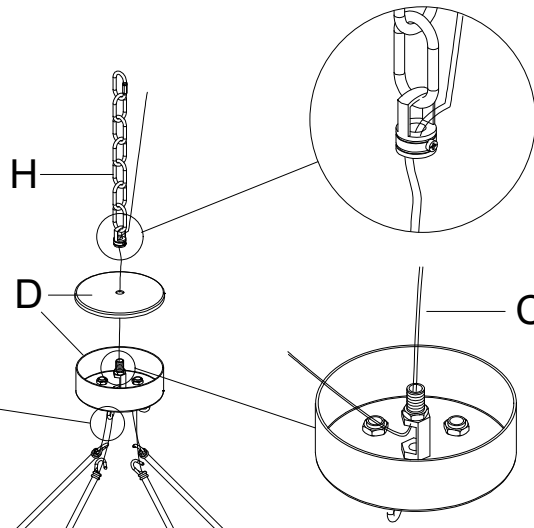
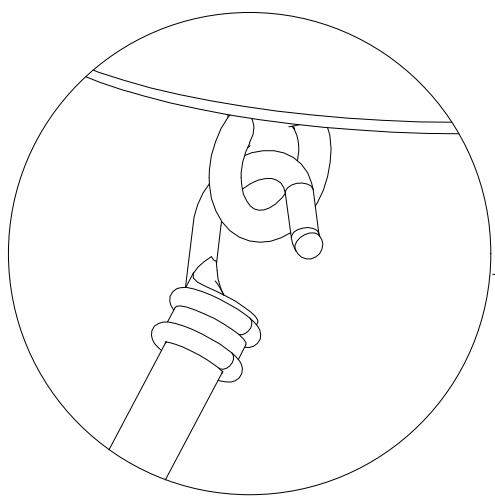

Step4

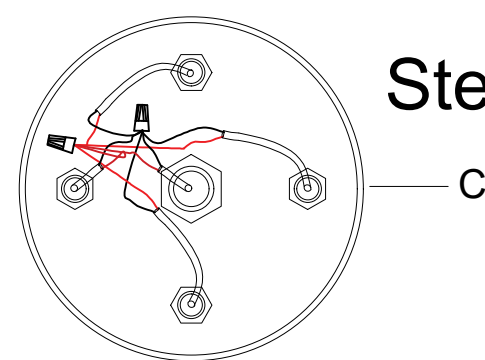

Step2

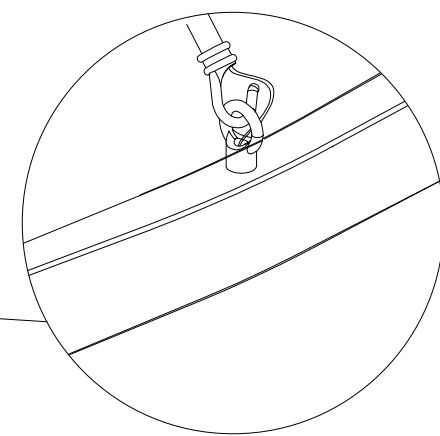

Step1

