

Quick Start Guide

Faux Panel Interior Installation Instructions

General Tools and Materials:

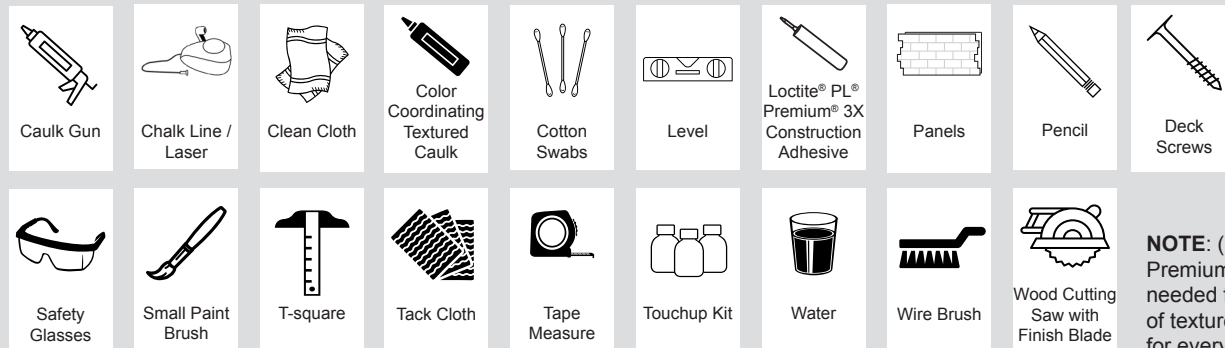

24 Hours Before Starting

Acclimate all panels by storing them flat in the installation location (but away from moisture and direct sunlight or other heat sources) for at least 24 hours.

NOTE: (1) tube of Loctite PL Premium 3X adhesive is typically needed for every (3) panels. (1) tube of textured caulk is typically needed for every (4) panels.



Consult full, project-specific installation guide before starting:

www.barrondesigns.com/project-resources/installation-instructions/panels-installation/

Panel Installation

1. Ensure that the installation surface is structurally sound and clean.
2. Orient the panels with the smooth, flat lip (A) facing up. Start with the bottom row and go up (*Figure A*).
3. Measure the wall and lay panels out. Make necessary cuts to start the row and accommodate obstacles. Trim the first panel and use the slot side to start the run. The style of panel you selected will dictate if the installation should go right to left (fingers on right) or left to right (fingers on left).
4. Apply construction adhesive to the back of the panel in vertical lines 4-6" apart (*Figure B*). Adhere the panel to the wall using a slight twisting motion to ensure good contact. Secure by inserting (1) screw per foot throughout the panel (*Figure C*). Screws need to be long enough to penetrate the panel and substrate.
5. Add a bead of caulk where the face meets the side lip of the panel to the slot side of the installed panel. Apply a bead of adhesive to the lip of the panel about 1 inch from the face (*Figure D*).
6. Install next panel ensuring that each panel interlocks and is straight (*Figure E*).
7. Once first row is complete, proceed to the next row, taking care to stagger the seams.
8. Touch-up by adding caulk to fill in screw holes and using the base coat, paint and wash (in that order) from the touch-up kit.

Figure A

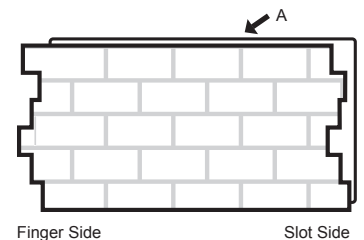

Figure B

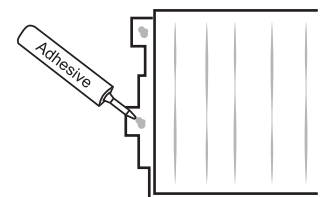

Figure C

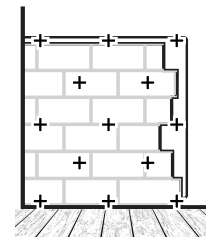

Figure D

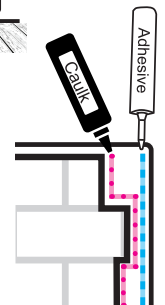
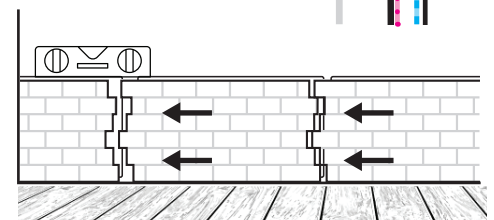

Figure E



WARNING:

- Be sure to obey all safety rules and recommendations set forth by tool manufacturers.
- Wear safety glasses during the entire installation process.
- Be sure to follow all applicable building codes.
- Always comply with clearances set forth by the manufacturer of stoves, fireplaces, furnaces, and any other heat source.