

# PETRABELLA WOOD HALL TREE WITH BENCH

DESIGN# SFV4214

Assembly Instructions

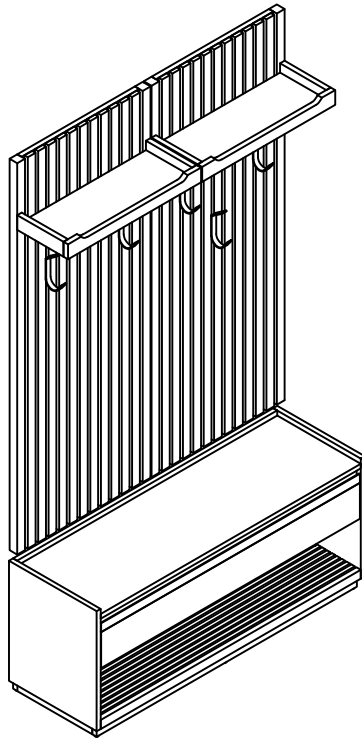

**SAFAVIEH**  
C O U T U R E

# Thanks for bringing Safavieh Couture into your home

Everything we make is incredibly simple to set up, including your new hall tree with bench. You won't need any additional tools.

## Parts List

A x 1  
Bench

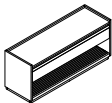

B x 2  
Wall panel

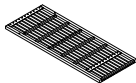

C x 2  
Shelf

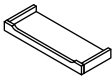

D x 2  
Long Wooden French Cleat

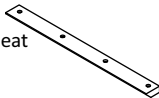

E x 2  
Short Wooden French Cleat



## Hardware List

HW1 x 5  
Metal Hook



HW2 x 10  
Bolt 6x40mm



HW3 x 1  
Allen key



HW4 x 4  
Plastic Brackets



HW5 x 2  
Restraint straps



HW6 x 4  
Short screws 4x20mm



HW7 x 18  
Plastic anchors 8x50mm



HW8 x 18  
Long screws 6x70mm



1

Attach the shelves (C) to the wall panel (B) by using the Allen Key (HW3) to screw in the bolts (HW2) as shown.

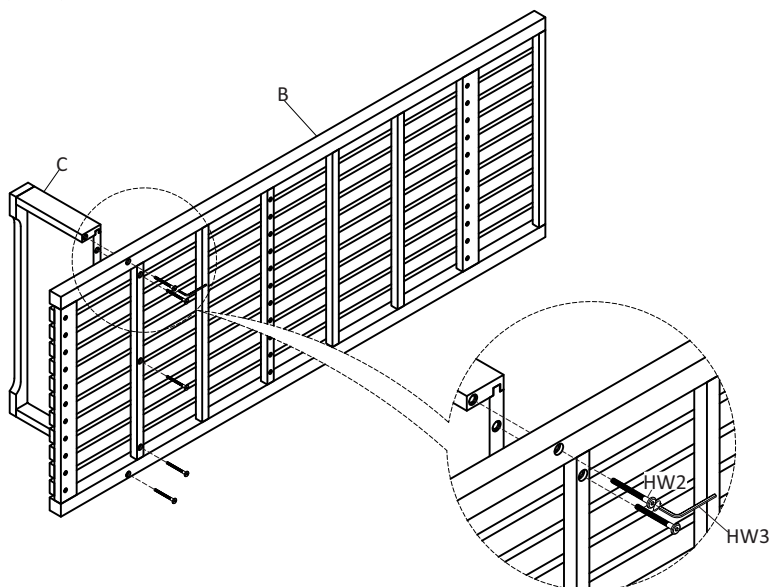

2

Install the plastic anchors (HW7) into the wall you will attach the hall tree to.

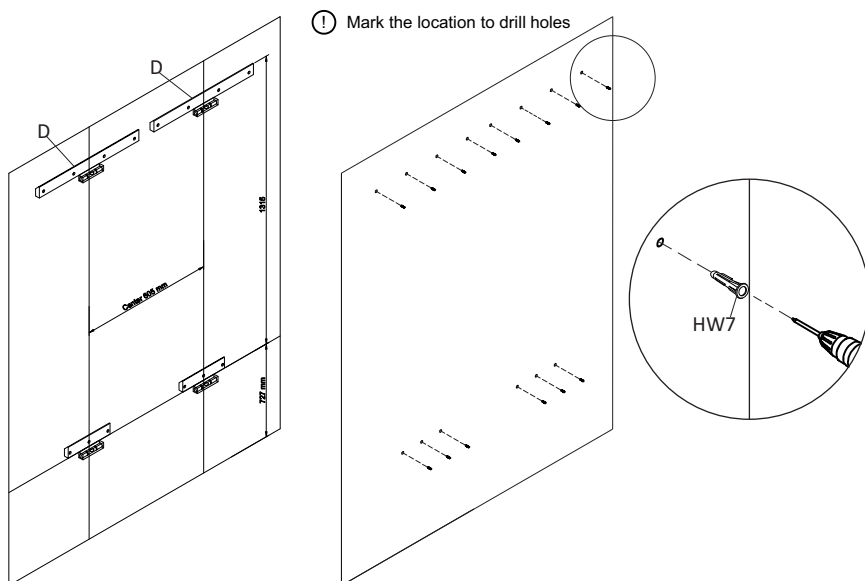

Attach the long wooden French cleats (D) and the short wooden French cleats (E) to the wall (where the ) plastic anchors are) by using the Allen Key (HW3) to screw in the long screws (HW8) as shown. Hang the wall panel (B) on the French cleats as shown.

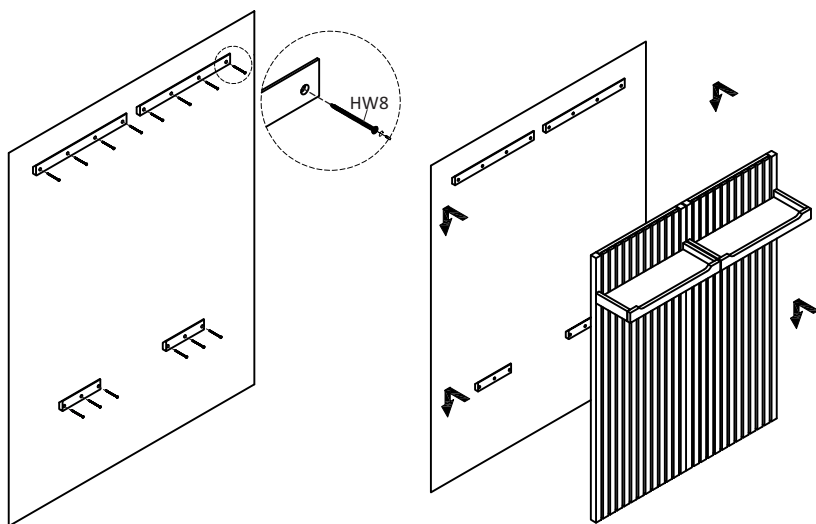

To help prevent the possibility of the bench tipping over, install the tip over kit. To install the tip over kit, install the plastic anchors (HW7) into the wall. Attach the plastic brackets to the wall and to the back of the bench by using a screwdriver to screw in the short screws (HW6). Place the restraint strap (HW5) through the plastic brackets on the back of the bench and on the wall. Tighten the restraint straps.

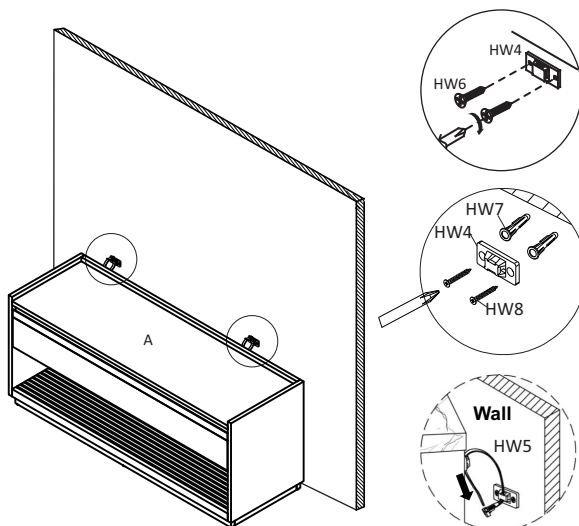

5

Hang the metal hooks (HW1) on the wall panel (B).

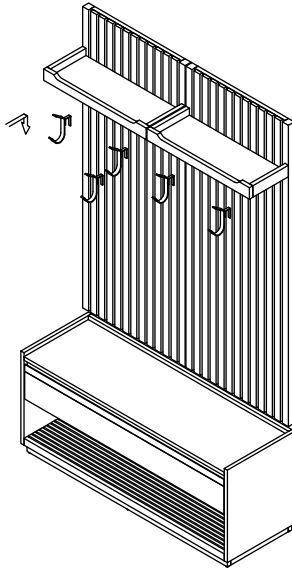

6

We'd love to see it – just tag us (we're @safavieh) and use the hashtag #safavieh on Instagram!

@safavieh

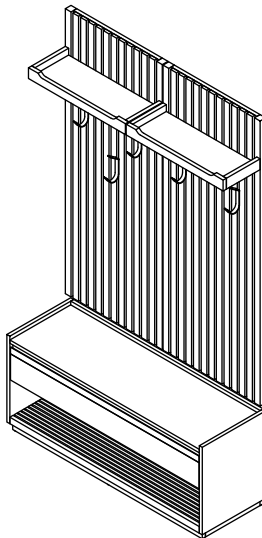

**Need help?**

Feel free to contact us via email or call  
if you have any specific questions!

**contact us:**

[cs@safavieh.com](mailto:cs@safavieh.com)

866-422-9070