

Installation instructions

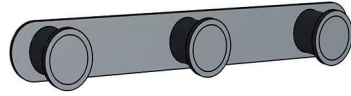

The tools you will use

pencil



Electric drill



screwdriver



Important note:

Please remove the components before installation
(Leftmost and rightmost)

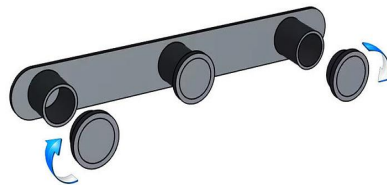

Lossless hidden installation
Drill Bit Size: 6mm

Installation steps

A

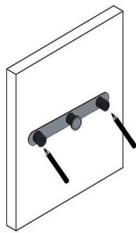

Put the mounting base
in the mounting position
and draw the position of
the opening with pencil

B

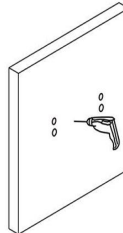

Use an electric drill to
open a hole with a
diameter of 6mm and a
depth of 15-20mm

C

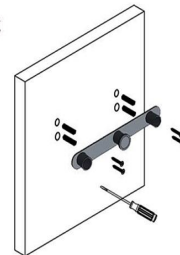

Install the mounting
base in the order
shown in the diagram