

## Hanging Instructions:

Quick and Easy Installation -D-ring hangers are attached to the backside of the mirror and is ready to hang right out of the box. *Hanging hardware not included*

### IMPORTANT NOTICE

Hanging Instructions for Mirrors  
with Strap Hangers

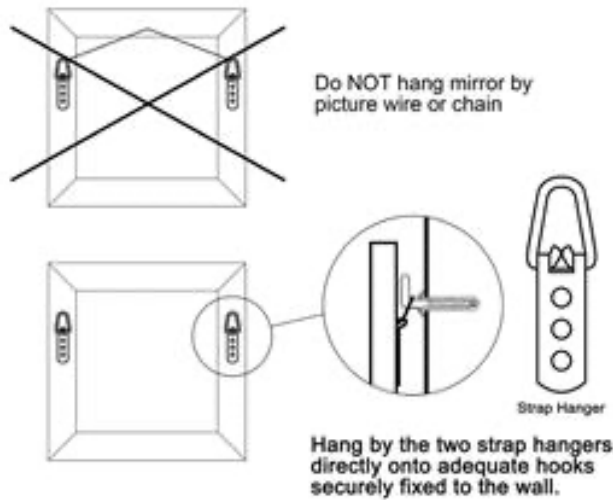

Never hang a mirror on damp wall as the backboard of the mirror will distort and possibly also cause damage to the mirror itself.

If in any doubt consult a competent Installation Specialist.